

\\10.120.108.5\ibishare\16558.D6 CO GES\5.0 Design (Work) Phase\Task 6-E-DEL-42-1.56 Safety Improvements\08685_GG002.dgn Sheet 2019-12-31 11:32:29 PM anthony.pisonen

SHEET NUM.											PART.				ITEM	ITEM EXT	GRAND TOTAL	UNIT	DESCRIPTION	SEE SHEET NO.	
6	7	26	27	27A	76	78	79	80	82	97	01/SAF/PV	02/SAF/PV	03/NHS/CV	04/SAF/CV							
DRAINAGE (CONT.)																					
			10										10		611	02000	10	FT	8" CONDUIT, TYPE C		
	50											50			611	03600	50	FT	10" CONDUIT, TYPE E		
	50											50			611	05200	50	FT	12" CONDUIT, TYPE F		
			171												611	05900	171	FT	15" CONDUIT, TYPE B		
			51												611	06100	51	FT	15" CONDUIT, TYPE C		
															611	06400	131	FT	15" CONDUIT, TYPE D		
			131												611	07900	50	FT	18" CONDUIT, TYPE D		
			50							190					611	16200	190	FT	36" CONDUIT, TYPE A, 706.02; OR 42" 707.02 (0.064) ALUMINIZED, 42" 707.04 (0.064), 42" 707.21, 36" 707.33 (WITH A WELDED BELL)		
			105										105		611	16400	105	FT	36" CONDUIT, TYPE B		
			125										125		611	16600	125	FT	36" CONDUIT, TYPE C		
										119					611	19200	119	FT	42" CONDUIT, TYPE A, 706.02; OR 707.02 (0.064) ALUMINIZED, 707.04 (0.064), 707.21, 707.33 (WITH A WELDED BELL)		
	10											10			611	97400	10	FT	CONDUIT, MISC.: 6" TYPE B FOR DRAINAGE DISCHARGE CONTINUANCE		
	10											10			611	97400	10	FT	CONDUIT, MISC.: 6" TYPE C FOR DRAINAGE DISCHARGE CONTINUANCE		
	10											10			611	97400	10	FT	CONDUIT, MISC.: 6" TYPE E FOR DRAINAGE DISCHARGE CONTINUANCE		
	10											10			611	97400	10	FT	CONDUIT, MISC.: 6" TYPE F FOR DRAINAGE DISCHARGE CONTINUANCE		
			3									1		2	611	98470	3	EACH	CATCH BASIN, NO. 2-2B		
			1										1		611	98700	1	EACH	INLET, SIDE DITCH		
			1									1			611	99574	1	EACH	MANHOLE, NO. 3		
	5		20									25			611	99710	25	EACH	PRECAST REINFORCED CONCRETE OUTLET		
	1											1			611	99720	1	EACH	INSPECTION WELL		
PAVEMENT																					
680												680			251	01041	680	SY	PARTIAL DEPTH PAVEMENT REPAIR (ASPHALT CONCRETE BASE), AS PER PLAN		
			12,484									9,269	3,215		254	01000	12,484	SY	PAVEMENT PLANING, ASPHALT CONCRETE (1.5")		
45			2,073	49								1,709	413	21	24	301	46000	2,167	CY	ASPHALT CONCRETE BASE, PG64-22	
			1,502	41								1,231	312			304	20000	1,543	CY	AGGREGATE BASE	
			2,587	22								2,030	579			407	20000	2,609	GAL	NON-TRACKING TACK COAT	
			842									582	260			411	10000	842	CY	STABILIZED CRUSHED AGGREGATE	
			1,323	13								973	363			442	10000	1,336	CY	ASPHALT CONCRETE SURFACE COURSE, 12.5 MM, TYPE A (446)	
			376									304	72			442	10100	376	CY	ASPHALT CONCRETE INTERMEDIATE COURSE, 19 MM, TYPE A (446)	
		76										38	38			609	24510	76	FT	CURB, TYPE 4-C	
			1.63									1.13	0.5			618	41000	1.63	MILE	RUMBLE STRIPES, EDGE LINE (ASPHALT CONCRETE)	
TRAFFIC CONTROL																					
								206				206				621	00100	206	EACH	RPM	
								136				136				621	54000	136	EACH	RAISED PAVEMENT MARKER REMOVED	
		58										36	18	4		626	00110	58	EACH	BARRIER REFLECTOR, TYPE 2 (BI-DIRECTIONAL)	
									240			240				630	02100	240	FT	GROUND MOUNTED SUPPORT, NO. 2 POST	
									480			480				630	03100	480	FT	GROUND MOUNTED SUPPORT, NO. 3 POST	
									15			15				630	08520	15	FT	STREET NAME SIGN SUPPORT, NO. 3 POST	
									303.7			303.7				630	80100	303.7	SF	SIGN, FLAT SHEET	
									61			61				630	84900	61	EACH	REMOVAL OF GROUND MOUNTED SIGN AND DISPOSAL	
									44			44				630	86002	44	EACH	REMOVAL OF GROUND MOUNTED POST SUPPORT AND DISPOSAL	
								1.7				1.7				644	00104	1.7	MILE	EDGE LINE, 6"	
								1.13				1.13				644	00300	1.13	MILE	CENTER LINE	
								841				841				644	00400	841	FT	CHANNELIZING LINE, 8"	
									188			188				644	00500	188	FT	STOP LINE	
									10			10				644	01300	10	EACH	LANE ARROW	
									0.21			0.21				646	10010	0.21	MILE	EDGE LINE, 6"	
									0.13			0.13				646	10200	0.13	MILE	CENTER LINE	
TRAFFIC SIGNALS																					
										1		1				625	18510	1	EACH	BRACKET ARM, 30'	
										41		41				625	25400	41	FT	CONDUIT, 2", 725.04	
										32		32				625	25600	32	FT	CONDUIT, 4", 725.04	
										73		73				625	29000	73	FT	TRENCH	
										2		2				625	30706	2	EACH	PULL BOX, 725.08, 24"	
										6		6				625	31510	6	EACH	PULL BOX REMOVED	
										10		10				625	32000	10	EACH	GROUND ROD	
AMP	12/30/19	ITEM 621	- RPM AND RPM REMOVED ADDED									8		8			630	97700	8	EACH	SIGNING, MISC.: "SIGNAL OPERATION CHANGED" SIGN
REV. BY	DATE	DESCRIPTION									16		16			632	05007	16	EACH	VEHICULAR SIGNAL HEAD, (LED), 3-SECTION, 12" LENS, 1-WAY, POLYCARBONATE, AS PER PLAN	
DATE COMPLETED										4		4				632	05087	4	EACH	VEHICULAR SIGNAL HEAD, (LED), 5-SECTION, 12" LENS, 1-WAY, POLYCARBONATE, AS PER PLAN	

GENERAL SUMMARY

DEL - 42 - 1.41

\\10.120.108.5\ibishare\16558.D6 CO GES\5.0 Design (Work) Phase\Task 6-E_DEL-42-1.56 Safety Improvements\08685_Sheets\TP001.dgn Sheet 2019-12-30 4:42:11 PM anthony.pisano

AMP	12/30/19	RPM NOTE ADDED
REV. BY	DATE	DESCRIPTION
DATE COMPLETED		

0 20 40
HORIZONTAL SCALE IN FEET

CALCULATED
JMK
CHECKED
KMK

SIGN AND PAVEMENT MARKING LEGEND

- EDGE LINE, 6" WHITE
- CENTER LINE
- CHANNELIZING LINE
- STOP LINE
- CROSSWALK LINE
- TRANSVERSE/DIAGONAL LINE
- LANE ARROW

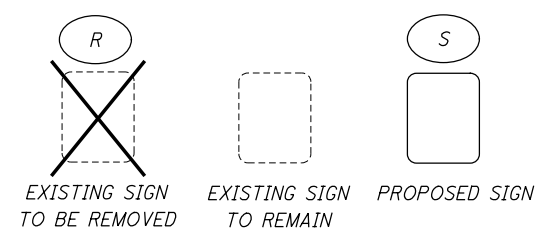

→ DIRECTION OF TRAVEL

NOTE
RPM'S SHALL BE INSTALLED PER SCD TC-65.10 & TC-65.11

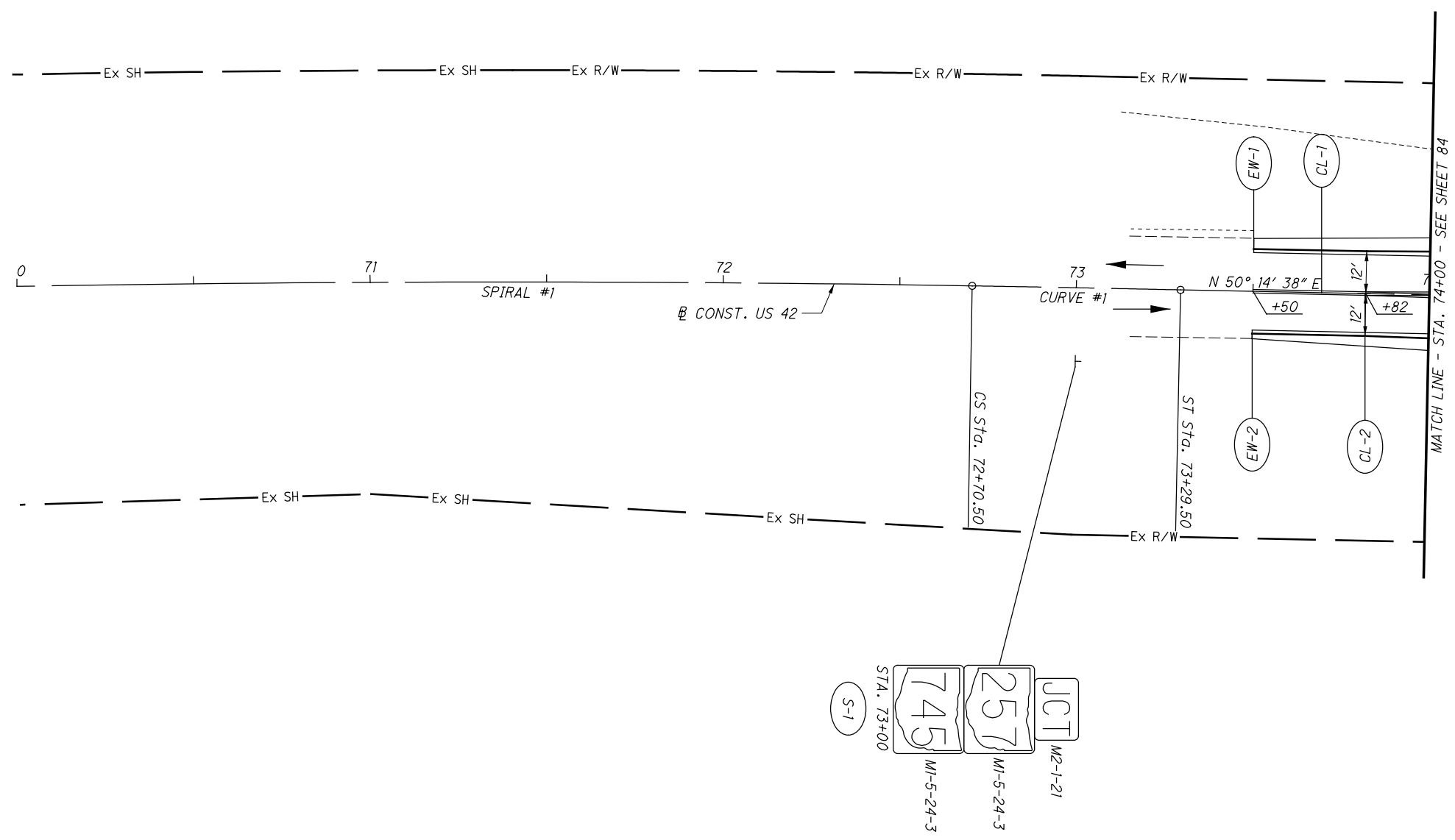
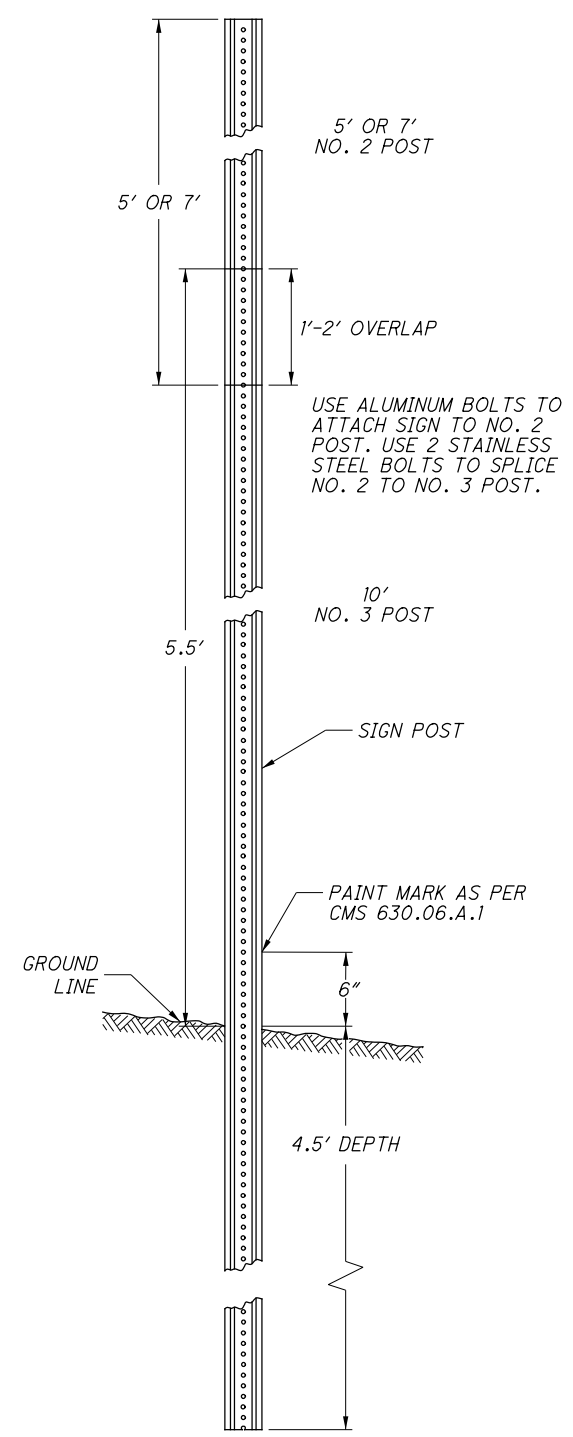

TYPICAL NO. 2 & NO. 3 U CHANNEL SPLICE WITH 10' DRIVEN SECTION INSTALLATION

SIGN & PAVEMENT MARKING PLAN - US 42
STA. 70+00 TO STA. 74+00

DEL-42-1.41