

SPECIAL PROVISIONS

Asbestos Survey Report

CRS: FAI-37-6.10

PID: 110412

Date: December 9, 2021



740.548.1500 ▪ www.augustmack.com
7830 North Central Drive, Suite B ▪ Lewis Center, Ohio 43035

December 9, 2021

Mr. James Howard
Heritage Land Services
635 Brooksedge Boulevard
Westerville, Ohio 43081

**Re: Pre-Demolition Asbestos Survey
7640 Lancaster-Newark Road NE
Baltimore, Ohio
August Mack Project Number JV2622.731**

Dear Mr. Howard:

In accordance with your request, August Mack Environmental, Inc. (August Mack) has completed a pre-demolition asbestos survey of the two (2) structures located at 7640 Lancaster-Newark Road NE, Baltimore, Ohio. The purpose of the survey was to determine if asbestos-containing materials (ACMs) are present on or within the structures prior to demolition. Mr. Joshua Hanes, State of Ohio Asbestos Hazard Evaluation Specialist (AHES #544805) performed the inspection and sampling activities on November 23, 2021. A copy of Mr. Hanes' AHES accreditation is provided in **Attachment A**. A summary of the inspection and sampling activities and laboratory results is presented in the following sections.

SITE DESCRIPTION

The subject buildings consisted of a one-story, concrete block structure and a one-story, metal framed structure located at 7640 Lancaster-Newark Road NE, Baltimore, Ohio. The interior of the concrete structure is largely degraded, consisting primarily of concrete block walls, a concrete floor, and wood framing. The metal structure consisted of metal siding, metal roofing, and a concrete floor. No HVAC systems are present in either structure.

ASBESTOS SAMPLE COLLECTION & ANALYSIS

A walk-through and inspection of the buildings was performed to identify all suspect ACMs using the United States Environmental Protection Agency's (U.S. EPA's) list of items suspected as ACMs and the inspector's experience. Following the walkthrough, bulk samples were collected of all suspect ACMs identified. Sample locations and the number of bulk samples for each homogenous area were determined and collected in



accordance with U.S. EPA 40 CFR 763.86. Standard sampling protocols were employed, sampling tools were cleaned between samples, and chain-of-custody procedures were observed. A complete listing of all suspect ACMs sampled, including the sample numbers, material description, and location has been provided as **Attachment B**, and a sample location diagram is provided as **Figure 1**.

All bulk sample layers were analyzed by EMSL Analytical, Inc. utilizing the polarized-light microscopy method as specified in *40 CFR Part 763, Section 1, Appendix E, Subpart E*. A copy of the laboratory analytical results is provided as **Attachment C**, and site photos are included in **Attachment D**.

DISCUSSION OF FINDINGS

The Ohio Environmental Protection Agency (OEPA) requires that if regulated ACMs (RACMs) are present in quantities equal to or greater than 50-linear-feet, 50-square-feet, or 35-cubic-feet of facility components, written notification is required prior to asbestos stripping or removal activities, or any other activities that would break up, dislodge, or disturb the asbestos. The notices must include among other things: RACMs which includes friable ACMs; Category I ACMs that have become friable or that will be subjected to sanding, grinding, cutting, or abrading; and Category II ACMs that are either friable or have the potential of becoming friable by being crumbled, pulverized, or reduced to powder by the forces expected to act on the materials in the course of renovation activities. More specifically, ACMs are designated as:

- **Regulated Asbestos-Containing Materials (RACM)** or friable asbestos - are materials that (a) are friable, (b) are Category I non-friable ACMs that have become friable, (c) Category I non-friable ACM that will be or has been subjected to sanding, grinding, cutting, or abrading, (d) Category II non-friable ACM that has a high probability of becoming friable in the course of demolition or renovation operation.
- **Category I non-friable (Cat. I)** - includes resilient floor coverings, asphalt roofing products, gaskets and packings.
- **Category II non-friable (Cat. II)** - any non-friable ACM that is not in Category I (i.e., Transite siding, cove base, & drywall).

Asbestos-containing materials as defined by the Federal Occupational Safety & Health Administration (OSHA) and the U.S. EPA are materials with an asbestos concentration of greater than 1% (> 1.0%). Based on the results from the inspection and laboratory analysis, the following ACMs were identified:

HA #	Material Description	Material Location	Condition	Category	Asbestos %	Quantity
4	9" x 9" Black with white streaks floor tile and mastic	Central and north areas of concrete structure	Significant Damage	RACM*	3% Chrysotile	65 SF
6	9" x 9" Tan floor tile and mastic	Central and north areas of concrete structure	Significant Damage	RACM*	5% Chrysotile	50 SF

HA= Homogeneous Area; SF = Square feet

* Considered RACMs for the purposes of demolition due to poor condition

Although not ACMs as defined by OSHA & U.S. EPA, the gray window caulking, white crack filler, and white window glaze on the concrete structure were found to contain < 0.25% chrysotile. Therefore, any activities that may impact these materials must be conducted in accordance with the OSHA Construction Industry Asbestos Standard 29 CFR 1926.1101 requirements for materials containing < 1% asbestos.

CONCLUSIONS

August Mack has completed a pre-demolition asbestos survey of the two (2) structures located at 7640 Lancaster-Newark Road NE, Baltimore, Ohio. The purpose of the survey was to determine if ACMs are present on or within the structures prior to demolition. As presented above, two (2) RACMs were identified in the concrete structure. These materials must be removed from the structure by a licensed asbestos abatement contractor prior to demolition in accordance with all state and federal regulatory requirements.

Although not ACMs as defined by OSHA & U.S. EPA, the gray window caulking, white crack filler, and white window glaze on the concrete structure were found to contain < 0.25% chrysotile. Therefore, any activities that may impact these materials must be conducted in accordance with the OSHA Construction Industry Asbestos Standard 29 CFR 1926.1101 requirements for materials containing < 1% asbestos.

August Mack has taken precautions to inspect the structures to identify all suspect ACMs, to the extent practicable. However, the interiors of operating mechanical equipment, energized electrical components, and permit required confined spaces, if present, were excluded from the inspection due to safety concerns.

It should be understood that some hidden ACMs may exist in areas that are impossible to inspect or that were not encountered during this inspection. If identified, these materials should be sampled prior to being impacted by demolition activities or assumed to contain asbestos and be abated in accordance with all state and federal regulatory requirements.

Mr. James Howard

December 9, 2021

We trust that this submittal is responsive to your needs and appreciate the opportunity to provide you with these environmental services. Please feel free to contact us if you have any questions.

Sincerely,



Fred Buescher
Building Science Manager



Josh Hanes
AHES # 544805

Attachments

FIGURES

Figure 1: Asbestos Sample Location Plan

Concrete Building

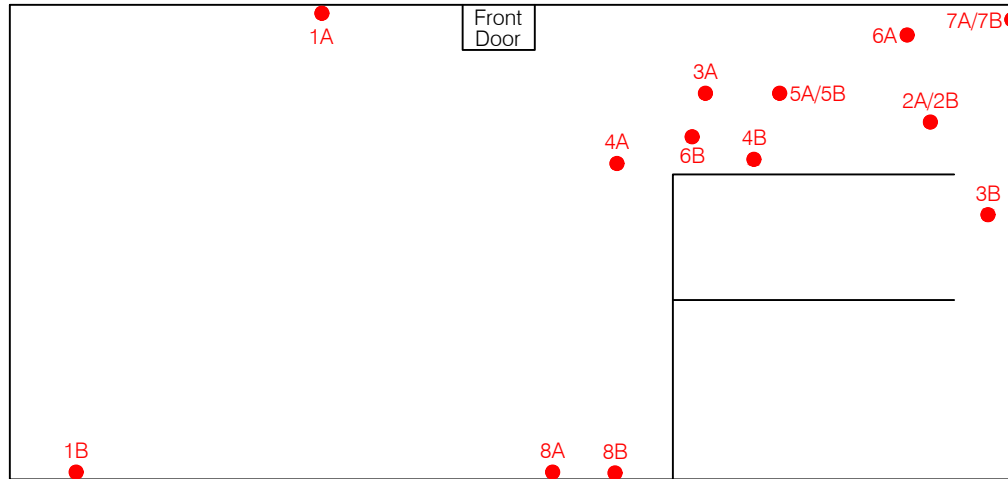

Metal Shed

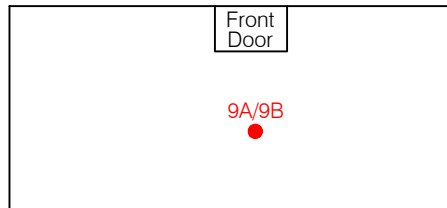

7830 N CENTRAL DR., SUITE B
LEWIS CENTER, OHIO 43035

740.548.1500
740.548.1531 FAX



Pre-demolition Asbestos Survey

7640 Lancaster-Newark Road NE
Baltimore, Ohio

Sample Location Diagram

PROJECT No.:	FILENAME:	DATE:
JV2622.731	O:\2021\Projects\JV2622\Figures\ Base.dwg	12/09/2021
DRAWN BY:	MODIFIED BY:	SCALE:
LB	LB	Not To Scale
		FIGURE:
		1

LEGEND

● = Asbestos Bulk Sample Location



ATTACHMENT A

Inspector License and Accreditation

State of Ohio
Environmental Protection Agency
Asbestos Program

Asbestos Hazard Evaluation Specialist

Joshua
Hanes



August Mack Environmental
7830 North Central Drive, Suite B
Lewis Center OH 43035

Certification Number Expiration Date
ES544805 **1/20/22**

DOB: 12/1/97

Card not Valid
if Altered

This certification is issued pursuant to Revised Code Chapter 3710 and Ohio Administrative Code Chapter 3745-22.

Your certification card is valid for a period of one (1) year, as indicated by the expiration date on the card.

Your card must be present on any project site where you are conducting asbestos-related work.

All questions regarding your certification should be directed to 614-644-0226

If found please return card to:

Ohio EPA, DAPC
P.O. Box 1049
Columbus, OH 43216



ATTACHMENT B

Asbestos Bulk Sample Results

Asbestos Bulk Sample Results
Concrete and Metal Structures
7640 Lancaster-Newark Road NE, Baltimore, OH
November 23, 2021

HA	Sample ID	Asbestos %/ Type		Material Description	Material Location
1	1A	<0.25*	Chrysotile	Gray window caulking	Concrete structure
	1B	<0.25*	Chrysotile		
2	2A	<0.25*	Chrysotile	White crack filler	Bewtween wood roof beams in concrete structure
	2B	<0.25*	Chrysotile		
3	3A	ND		Black roofing material	Concrete structure
	3B	ND			
4	4A	3	Chrysotile	9"x9" Black with white streaks floor tile	Concrete structure
	4B	Pos Stop			
5	5A-Floor tile	ND		12"x12" Beige with white streaks floor tile and mastic	Concrete structure
	5A-Mastic	ND			
	5B- Floor tile	ND			
	5B-Mastic	ND			
6	6A- Floor tile	4	Chrysotile	9"x9" Tan floor tile and mastic	Concrete structure
	6A-Mastic	5	Chrysotile		
	6B	Pos Stop			
7	7A-Drywall	ND		Drywall and joint compound	North wall of concrete structure
	7A-Joint compound	ND			
	7B-Drywall	ND			
	7B-Joint compound	ND			
8	8A	<0.25*	Chrysotile	White window glaze	Two small bathroom windows near toilets in concrete structure
	8B	<0.25*	Chrysotile		
9	9A	ND		Flange gaskets	Metal structure
	9B	ND			

HA = Homogeneous Area

Asbestos-containing material (ACM) = greater than 1% (>1%) asbestos

ND = None Detected

Pos.Stop = Positive stop

* = Sample concentration determined by 400 Point Count Method using PLM

ATTACHMENT C

Laboratory Analytical Results



EMSL Analytical, Inc.

6340 CastlePlace Dr. Indianapolis, IN 46250

Tel/Fax: (317) 803-2997 / (317) 803-3047

<http://www.EMSL.com> / indianapolislabs@emsl.com

EMSL Order: 162128072
Customer ID: AUGU51
Customer PO:
Project ID:

Attention: Domanic Martin
 August Mack Environmental, Inc.
 7830 N. Central Drive Suite B
 Lewis Center, OH 43035

Phone: (740) 548-1508
Fax:
Received Date: 11/24/2021 1:25 PM
Analysis Date: 11/30/2021 - 12/01/2021
Collected Date: 11/23/2021

Project: JV2622.731

Test Report: Asbestos Analysis of Bulk Materials via EPA 600/R-93/116 Method using Polarized Light Microscopy

Sample	Description	Appearance	Non-Asbestos		Asbestos
			% Fibrous	% Non-Fibrous	% Type
1A 162128072-0001	Grey Window Caulking	Gray Non-Fibrous Homogeneous		100.0% Non-fibrous (Other)	<1% Chrysotile
			HA: 1		
1B 162128072-0002	Grey Window Caulking	Gray Non-Fibrous Homogeneous		100.0% Non-fibrous (Other)	<1% Chrysotile
			HA: 1		
2A 162128072-0003	White Crack Filler	Tan/Black Non-Fibrous Homogeneous		100.0% Non-fibrous (Other)	<1% Chrysotile
			HA: 2		
2B 162128072-0004	White Crack Filler	Tan/Black Non-Fibrous Homogeneous		100.0% Non-fibrous (Other)	<1% Chrysotile
			HA: 2		
3A 162128072-0005	Black Roofing	Black Fibrous Heterogeneous	20% Cellulose 15% Synthetic	65.0% Non-fibrous (Other)	None Detected
			HA: 3		
3B 162128072-0006	Black Roofing	Black Fibrous Heterogeneous	20% Cellulose 15% Synthetic	65.0% Non-fibrous (Other)	None Detected
			HA: 3		
4A 162128072-0007	Black with White Streaks Floor Tile 9"x9"	Gray/Black Non-Fibrous Homogeneous		97.0% Non-fibrous (Other)	3% Chrysotile
			HA: 4		

EMSL maintains liability limited to cost of analysis. Interpretation and use of test results are the responsibility of the client. This report relates only to the samples reported above, and may not be reproduced, except in full, without written approval by EMSL. EMSL bears no responsibility for sample collection activities or analytical method limitations. The report reflects the samples as received. Results are generated from the field sampling data (sampling volumes and areas, locations, etc.) provided by the client on the Chain of Custody. Samples are within quality control criteria and met method specifications unless otherwise noted. The above analyses were performed in general compliance with Appendix E to Subpart E of 40 CFR (previously EPA 600/M4-82-020 "Interim Method") but augmented with procedures outlined in the 1993 ("final") version of the method. This report must not be used by the client to claim product certification, approval, or endorsement by NVLAP, NIST or any agency of the federal government. Non-friable organically bound materials present a problem matrix and therefore EMSL recommends gravimetric reduction prior to analysis. Unless requested by the client, building materials manufactured with multiple layers (i.e. linoleum, wallboard, etc.) are reported as a single sample. Estimation of uncertainty is available on request.

Samples analyzed by EMSL Analytical, Inc. Indianapolis, IN NVLAP Lab Code 200188-0, AZ0939, CA 2575, CO AL-15132, TX 300262

Initial report from: 12/01/2021 12:46:26



EMSL Analytical, Inc.

6340 CastlePlace Dr. Indianapolis, IN 46250

Tel/Fax: (317) 803-2997 / (317) 803-3047

<http://www.EMSL.com> / indianapolislaboratory@emsl.com

EMSL Order: 162128072

Customer ID: AUGU51

Customer PO:

Project ID:

Attention: Domanic Martin
August Mack Environmental, Inc.
7830 N. Central Drive Suite B
Lewis Center, OH 43035

Phone: (740) 548-1508

Fax:

Received Date: 11/24/2021 1:25 PM

Analysis Date: 11/30/2021 - 12/01/2021

Collected Date: 11/23/2021

Project: JV2622.731

Test Report: Asbestos Analysis of Bulk Materials via EPA 600/R-93/116 Method using Polarized Light Microscopy

Sample	Description	Appearance	Non-Asbestos		Asbestos
			% Fibrous	% Non-Fibrous	% Type
4B 162128072-0008	Black with White Streaks Floor Tile 9"x9"				Positive Stop (Not Analyzed)
			HA: 4		
5A-Floor Tile 162128072-0009	Beige with White Streaks Floor Tile 12"x12"	Gray Non-Fibrous Homogeneous		100.0% Non-fibrous (Other)	None Detected
			HA: 5		
5A-Mastic 162128072-0009A	Beige with White Streaks Floor Tile 12"x12"	Brown/Tan Non-Fibrous Homogeneous		100.0% Non-fibrous (Other)	None Detected
			HA: 5		
5B-Floor Tile 162128072-0010	Beige with White Streaks Floor Tile 12"x12"	Gray Non-Fibrous Homogeneous		100.0% Non-fibrous (Other)	None Detected
			HA: 5		
5B-Mastic 162128072-0010A	Beige with White Streaks Floor Tile 12"x12"	Brown/Tan Non-Fibrous Homogeneous		100.0% Non-fibrous (Other)	None Detected
			HA: 5		
6A-Floor Tile 162128072-0011	Tan Floor Tile 9"x9"	Tan Non-Fibrous Homogeneous		96.0% Non-fibrous (Other)	4% Chrysotile
			HA: 6		
6A-Mastic 162128072-0011A	Tan Floor Tile 9"x9"	Black Non-Fibrous Homogeneous		95.0% Non-fibrous (Other)	5% Chrysotile
			HA: 6		

EMSL maintains liability limited to cost of analysis. Interpretation and use of test results are the responsibility of the client. This report relates only to the samples reported above, and may not be reproduced, except in full, without written approval by EMSL. EMSL bears no responsibility for sample collection activities or analytical method limitations. The report reflects the samples as received. Results are generated from the field sampling data (sampling volumes and areas, locations, etc.) provided by the client on the Chain of Custody. Samples are within quality control criteria and met method specifications unless otherwise noted. The above analyses were performed in general compliance with Appendix E to Subpart E of 40 CFR (previously EPA 600/M4-82-020 "Interim Method") but augmented with procedures outlined in the 1993 ("final") version of the method. This report must not be used by the client to claim product certification, approval, or endorsement by NVLAP, NIST or any agency of the federal government. Non-friable organically bound materials present a problem matrix and therefore EMSL recommends gravimetric reduction prior to analysis. Unless requested by the client, building materials manufactured with multiple layers (i.e. linoleum, wallboard, etc.) are reported as a single sample. Estimation of uncertainty is available on request.

Samples analyzed by EMSL Analytical, Inc. Indianapolis, IN NVLAP Lab Code 200188-0, AZ0939, CA 2575, CO AL-15132, TX 300262

Initial report from: 12/01/2021 12:46:26



EMSL Analytical, Inc.

6340 CastlePlace Dr. Indianapolis, IN 46250
Tel/Fax: (317) 803-2997 / (317) 803-3047
<http://www.EMSL.com> / indianapolislab@emsl.com

EMSL Order: 162128072
Customer ID: AUGU51
Customer PO:
Project ID:

Attention: Domanic Martin
August Mack Environmental, Inc.
7830 N. Central Drive Suite B
Lewis Center, OH 43035
Phone: (740) 548-1508
Fax:
Received Date: 11/24/2021 1:25 PM
Analysis Date: 11/30/2021 - 12/01/2021
Collected Date: 11/23/2021
Project: JV2622.731

Test Report: Asbestos Analysis of Bulk Materials via EPA 600/R-93/116 Method using Polarized Light Microscopy

Sample	Description	Appearance	Non-Asbestos		Asbestos
			% Fibrous	% Non-Fibrous	% Type
6B 162128072-0012	Tan Floor Tile 9"x9"				Positive Stop (Not Analyzed)
HA: 6					
7A-Drywall 162128072-0013	Drywall and Joint Compound	Brown/White Fibrous Heterogeneous	10% Cellulose	80% Gypsum 10.0% Non-fibrous (Other)	None Detected
HA: 7					
7A-Joint Compound 162128072-0013A	Drywall and Joint Compound	White Non-Fibrous Homogeneous		100.0% Non-fibrous (Other)	None Detected
HA: 7					
7B-Drywall 162128072-0014	Drywall and Joint Compound	Brown/White Fibrous Heterogeneous	15% Cellulose	75% Gypsum 10.0% Non-fibrous (Other)	None Detected
HA: 7					
7B-Joint Compound 162128072-0014A	Drywall and Joint Compound	White Non-Fibrous Homogeneous		100.0% Non-fibrous (Other)	None Detected
HA: 7					
8A 162128072-0015	White Window Glaze	Gray/White Non-Fibrous Homogeneous		100.0% Non-fibrous (Other)	<1% Chrysotile
HA: 8					
8B 162128072-0016	White Window Glaze	Gray/White Non-Fibrous Homogeneous		100.0% Non-fibrous (Other)	<1% Chrysotile
HA: 8					

EMSL maintains liability limited to cost of analysis. Interpretation and use of test results are the responsibility of the client. This report relates only to the samples reported above, and may not be reproduced, except in full, without written approval by EMSL. EMSL bears no responsibility for sample collection activities or analytical method limitations. The report reflects the samples as received. Results are generated from the field sampling data (sampling volumes and areas, locations, etc.) provided by the client on the Chain of Custody. Samples are within quality control criteria and met method specifications unless otherwise noted. The above analyses were performed in general compliance with Appendix E to Subpart E of 40 CFR (previously EPA 600/M4-82-020 "Interim Method") but augmented with procedures outlined in the 1993 ("final") version of the method. This report must not be used by the client to claim product certification, approval, or endorsement by NVLAP, NIST or any agency of the federal government. Non-friable organically bound materials present a problem matrix and therefore EMSL recommends gravimetric reduction prior to analysis. Unless requested by the client, building materials manufactured with multiple layers (i.e. linoleum, wallboard, etc.) are reported as a single sample. Estimation of uncertainty is available on request.

Samples analyzed by EMSL Analytical, Inc. Indianapolis, IN NVLAP Lab Code 200188-0, AZ0939, CA 2575, CO AL-15132, TX 300262

Initial report from: 12/01/2021 12:46:26



EMSL Analytical, Inc.

6340 CastlePlace Dr. Indianapolis, IN 46250
Tel/Fax: (317) 803-2997 / (317) 803-3047
<http://www.EMSL.com> / indianapolislaboratory@emsl.com

EMSL Order: 162128072
Customer ID: AUGU51
Customer PO:
Project ID:

Attention: Domanic Martin
August Mack Environmental, Inc.
7830 N. Central Drive Suite B
Lewis Center, OH 43035
Phone: (740) 548-1508
Fax:
Received Date: 11/24/2021 1:25 PM
Analysis Date: 11/30/2021 - 12/01/2021
Collected Date: 11/23/2021
Project: JV2622.731

Test Report: Asbestos Analysis of Bulk Materials via EPA 600/R-93/116 Method using Polarized Light Microscopy

Sample	Description	Appearance	Non-Asbestos		Asbestos
			% Fibrous	% Non-Fibrous	% Type
9A 162128072-0017	Gasket	Gray/Tan Fibrous Homogeneous	95% Cellulose	5.0% Non-fibrous (Other)	None Detected
			HA: 9		
9B 162128072-0018	Gasket	Gray/Tan Fibrous Homogeneous	95% Cellulose	5.0% Non-fibrous (Other)	None Detected
			HA: 9		

EMSL maintains liability limited to cost of analysis. Interpretation and use of test results are the responsibility of the client. This report relates only to the samples reported above, and may not be reproduced, except in full, without written approval by EMSL. EMSL bears no responsibility for sample collection activities or analytical method limitations. The report reflects the samples as received. Results are generated from the field sampling data (sampling volumes and areas, locations, etc.) provided by the client on the Chain of Custody. Samples are within quality control criteria and met method specifications unless otherwise noted. The above analyses were performed in general compliance with Appendix E to Subpart E of 40 CFR (previously EPA 600/M4-82-020 "Interim Method") but augmented with procedures outlined in the 1993 ("final") version of the method. This report must not be used by the client to claim product certification, approval, or endorsement by NVLAP, NIST or any agency of the federal government. Non-friable organically bound materials present a problem matrix and therefore EMSL recommends gravimetric reduction prior to analysis. Unless requested by the client, building materials manufactured with multiple layers (i.e. linoleum, wallboard, etc.) are reported as a single sample. Estimation of uncertainty is available on request.

Samples analyzed by EMSL Analytical, Inc. Indianapolis, IN NVLAP Lab Code 200188-0, AZ0939, CA 2575, CO AL-15132, TX 300262

Initial report from: 12/01/2021 12:46:26



EMSL Analytical, Inc.

6340 CastlePlace Dr. Indianapolis, IN 46250

Tel/Fax: (317) 803-2997 / (317) 803-3047

<http://www.EMSL.com> / indianapolislaboratory@emsl.com

EMSL Order: 162128072
Customer ID: AUGU51
Customer PO:
Project ID:

Attention: Domanic Martin August Mack Environmental, Inc. 7830 N. Central Drive Suite B Lewis Center, OH 43035	Phone: (740) 548-1508 Fax: Received Date: 11/24/2021 1:25 PM Analysis Date: 11/30/2021 - 12/01/2021 Collected Date: 11/23/2021
Project: JV2622.731	

The samples in this report were submitted to EMSL for analysis by Asbestos Analysis of Bulk materials via EPA/600 (0513) Method using Polarized Light Microscopy. The reference number for these samples is the EMSL Order ID above. Please use this reference number when calling about these samples.

Report Comments:

Sample Receipt Date:	11/24/2021	Sample Receipt Time:	1:25 PM
Analysis Completed Date:	12/01/2021	Analysis Completed Time:	12:17 PM

Analyst(s):

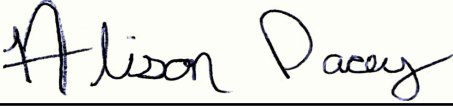

 Alison Pacey PLM (9)



 Ross Matlock PLM (12)

Samples Reviewed and approved by:



 Asbestos Laboratory Manager
 or other approved signatory

EMSL maintains liability limited to cost of analysis. Interpretation and use of test results are the responsibility of the client. This report relates only to the samples reported above, and may not be reproduced, except in full, without written approval by EMSL. EMSL bears no responsibility for sample collection activities or analytical method limitations. The report reflects the samples as received. Results are generated from the field sampling data (sampling volumes and areas, locations, etc.) provided by the client on the Chain of Custody. Samples are within quality control criteria and met method specifications unless otherwise noted. The above analyses were performed in general compliance with Appendix E to Subpart E of 40 CFR (previously EPA 600/M4-82-020 "Interim Method") but augmented with procedures outlined in the 1993 ("final") version of the method. This report must not be used by the client to claim product certification, approval, or endorsement by NVLAP, NIST or any agency of the federal government. Non-friable organically bound materials present a problem matrix and therefore EMSL recommends gravimetric reduction prior to analysis. Unless requested by the client, building materials manufactured with multiple layers (i.e. linoleum, wallboard, etc.) are reported as a single sample. Estimation of uncertainty is available on request.

Samples analyzed by EMSL Analytical, Inc. Indianapolis, IN NVLAP Lab Code 200188-0, AZ0939, CA 2575, CO AL-15132, TX 300262

Initial report from: 12/01/2021 12:46:26

**EMSL Analytical, Inc.**

6340 CastlePlace Dr., Indianapolis, IN 46250

Phone/Fax: (317) 803-2997 / (317) 803-3047

<http://www.EMSL.com>indianapolislab@emsl.com

EMSL Order:	162128072
CustomerID:	AUGU51
CustomerPO:	
ProjectID:	

Attn: **Domanic Martin**
August Mack Environmental, Inc.
7830 N. Central Drive Suite B
Lewis Center, OH 43035

Phone: (740) 548-1508
 Fax:
 Received: 11/24/2021 01:25 PM
 Analysis Date: 12/1/2021
 Collected: 11/23/2021

Project: **JV2622.731**

Test Report: Asbestos Analysis of Bulk Materials via EPA 600/R-93/116 Method using Polarized Light Microscopy. Quantitation using 400 Point Count Procedure

Sample	Description	Appearance	Non-Asbestos		Asbestos
			% Fibrous	% Non-Fibrous	% Type
1A 162128072-0001	Grey Window Caulking	Gray Non-Fibrous Homogeneous	HA: 1	100.00% Non-fibrous (other)	<0.25% Chrysotile
1B 162128072-0002	Grey Window Caulking	Gray Non-Fibrous Homogeneous	HA: 1	100.00% Non-fibrous (other)	<0.25% Chrysotile
2A 162128072-0003	White Crack Filler	Tan/Black Non-Fibrous Homogeneous	HA: 2	100.00% Non-fibrous (other)	<0.25% Chrysotile
2B 162128072-0004	White Crack Filler	Tan/Black Non-Fibrous Homogeneous	HA: 2	100.00% Non-fibrous (other)	<0.25% Chrysotile
8A 162128072-0015	White Window Glaze	Gray/White Non-Fibrous Homogeneous	HA: 8	100.00% Non-fibrous (other)	<0.25% Chrysotile
8B 162128072-0016	White Window Glaze	Gray/White Non-Fibrous Homogeneous	HA: 8	100.00% Non-fibrous (other)	<0.25% Chrysotile

EMSL maintains liability limited to cost of analysis. Interpretation and use of test results are the responsibility of the client. This report relates only to the samples reported above, and may not be reproduced, except in full, without written approval by EMSL. EMSL bears no responsibility for sample collection activities or analytical method limitations. The report reflects the samples as received. Results are generated from the field sampling data (sampling volumes and areas, locations, etc.) provided by the client on the Chain of Custody. Samples are within quality control criteria and met method specifications unless otherwise noted. The above analyses were performed in general compliance with Appendix E to Subpart E of 40 CFR (previously EPA 600/M4-82-020 "Interim Method") but augmented with procedures outlined in the 1993 ("final") version of the method. This report must not be used by the client to claim product certification, approval, or endorsement by NVLAP, NIST or any agency of the federal government. Non-friable organically bound materials present a problem matrix and therefore EMSL recommends gravimetric reduction prior to analysis. Unless requested by the client, building materials manufactured with multiple layers (i.e. linoleum, wallboard, etc.) are reported as a single sample. Estimation of uncertainty is available on request.

Samples analyzed by EMSL Analytical, Inc. Indianapolis, IN NVLAP Lab Code 200188-0

Initial report from 12/01/2021 12:46:31



EMSL Analytical, Inc.

6340 CastlePlace Dr., Indianapolis, IN 46250
Phone/Fax: (317) 803-2997 / (317) 803-3047
<http://www.EMSL.com> indianapolislab@emsl.com

EMSL Order: 162128072
CustomerID: AUGU51
CustomerPO:
ProjectID:

Attn: **Domanic Martin**
August Mack Environmental, Inc.
7830 N. Central Drive Suite B
Lewis Center, OH 43035

Phone: (740) 548-1508
Fax:
Received: 11/24/2021 01:25 PM
Analysis Date: 12/1/2021
Collected: 11/23/2021

Project: **JV2622.731**

The samples in this report were submitted to EMSL for analysis by Asbestos Analysis of Bulk Materials via EPA 600/R-93/116 Method using Polarized Light Microscopy. Quantitation using 400 Point Count Procedure. The reference number for these samples is the EMSL Order ID above. Please use this reference number when calling about these samples.

Report Comments:

Sample Receipt Date:: 11/24/2021 Sample Receipt Time: 1:25 PM
Analysis Completed Date: 12/1/2021 Analysis Completed Time: 12:13 PM

Analyst(s):

Alison Pacey PLM 400 Point Count (3)

Ross Matlock PLM 400 Point Count (3)

Samples reviewed and approved by:

Asbestos Laboratory Manager
or other approved signatory

EMSL maintains liability limited to cost of analysis. Interpretation and use of test results are the responsibility of the client. This report relates only to the samples reported above, and may not be reproduced, except in full, without written approval by EMSL. EMSL bears no responsibility for sample collection activities or analytical method limitations. The report reflects the samples as received. Results are generated from the field sampling data (sampling volumes and areas, locations, etc.) provided by the client on the Chain of Custody. Samples are within quality control criteria and met method specifications unless otherwise noted. The above analyses were performed in general compliance with Appendix E to Subpart E of 40 CFR (previously EPA 600/M4-82-020 "Interim Method") but augmented with procedures outlined in the 1993 ("final") version of the method. This report must not be used by the client to claim product certification, approval, or endorsement by NVLAP, NIST or any agency of the federal government. Non-friable organically bound materials present a problem matrix and therefore EMSL recommends gravimetric reduction prior to analysis. Unless requested by the client, building materials manufactured with multiple layers (i.e. linoleum, wallboard, etc.) are reported as a single sample. Estimation of uncertainty is available on request.
Samples analyzed by EMSL Analytical, Inc. Indianapolis, IN NVLAP Lab Code 200188-0

Initial report from 12/01/2021 12:46:31



EMSL ANALYTICAL INC.
LABORATORY PRODUCTS TRAINING

Asbestos Chain of Custody

EMSL Order Number (Lab Use Only):

162128072

PHONE:

FAX:

Company Name : August Mack Env.		EMSL Customer ID:	
Street: 7830 N. Central Drive Suite B		City: Lewis Center	State/Province: OHIO
Zip/Postal Code: 43035	Country: U.S.A	Telephone #: 740-548-1500	Fax #:
Report To (Name): Domanic Martin		Please Provide Results: <input type="checkbox"/> Fax <input checked="" type="checkbox"/> Email	
Email Address: dmartin@augustmack.com		Purchase Order:	
Project Name/Number: SV2622.731		EMSL Project ID (Internal Use Only):	
U.S. State Samples Taken: OHIO		CT Samples: <input type="checkbox"/> Commercial/Taxable <input type="checkbox"/> Residential/Tax Exempt	

EMSL-Bill to: Same Different - If Bill to is Different note instructions in Comments**
Third Party Billing requires written authorization from third party

Turnaround Time (TAT) Options* -- Please Check

3 Hour 6 Hour 24 Hour 48 Hour 72 Hour 96 Hour 1 Week 2 Week

*For TEM Air 3 hr through 6 hr, please call ahead to schedule. *There is a premium charge for 3 Hour TEM AHERA or EPA Level II TAT. You will be asked to sign an authorization form for this service. Analysis completed in accordance with EMSL's Terms and Conditions located in the Analytical Price Guide.

<p>PCM - Air <input type="checkbox"/> Check if samples are from NY</p> <input type="checkbox"/> NIOSH 7400 <input type="checkbox"/> w/ OSHA 8hr. TWA <p>PLM - Bulk (reporting limit)</p> <input checked="" type="checkbox"/> PLM EPA 600/R-93/116 (<1%) <input type="checkbox"/> PLM EPA NOB (<1%) Point Count <input type="checkbox"/> 400 (<0.25%) <input type="checkbox"/> 1000 (<0.1%) Point Count w/Gravimetric <input type="checkbox"/> 400 (<0.25%) <input type="checkbox"/> 1000 (<0.1%) <input type="checkbox"/> NYS 198.1 (friable in NY) <input type="checkbox"/> NYS 198.6 NOB (non-friable-NY) <input type="checkbox"/> NYS 198.8 SOF-V <input type="checkbox"/> NIOSH 9002 (<1%)	<p>TEM - Air <input type="checkbox"/> 4-4.5hr TAT (AHERA only)</p> <input type="checkbox"/> AHERA 40 CFR, Part 763 <input type="checkbox"/> NIOSH 7402 <input type="checkbox"/> EPA Level II <input type="checkbox"/> ISO 10312 <p>TEM - Bulk</p> <input type="checkbox"/> TEM EPA NOB <input type="checkbox"/> NYS NOB 198.4 (non-friable-NY) <input type="checkbox"/> Chatfield SOP <input type="checkbox"/> TEM Mass Analysis-EPA 600 sec. 2.5 <p>TEM - Water: EPA 100.2</p> Fibers >10µm <input type="checkbox"/> Waste <input type="checkbox"/> Drinking All Fiber Sizes <input type="checkbox"/> Waste <input type="checkbox"/> Drinking	<p>TEM- Dust</p> <input type="checkbox"/> Microvac - ASTM D 5755 <input type="checkbox"/> Wipe - ASTM D6480 <input type="checkbox"/> Carpet Sonication (EPA 600/J-93/167) <p>Soil/Rock/Vermiculite*</p> <input type="checkbox"/> PLM CARB 435 - A (0.25% sensitivity) <input type="checkbox"/> PLM CARB 435 - B (0.1% sensitivity) <input type="checkbox"/> TEM CARB 435 - B (0.1% sensitivity) <input type="checkbox"/> TEM CARB 435 - C (0.01% sensitivity) <input type="checkbox"/> TEM Qual. via Filtration Technique <input type="checkbox"/> TEM Qual. via Drop-Mount Technique <small>*Can not accept New York State Loose Fill Vermiculite Samples</small> <p>Other:</p> <input type="checkbox"/>
--	--	--

Check For Positive Stop - Clearly Identify Homogenous Group Filter Pore Size (Air Samples): 0.8µm 0.45µm

Samplers Name: ~~Domanic Martin~~ Josh Harey Samplers Signature: *Josh Harey*

Sample #	Sample Description	Volume/Area (Air) HA # (Bulk)	Date/Time Sampled
1A-1B	Grey Window Caulking	1	11/23/21
2A-2B	White Crack Filler	2	
3A-3B	Black Roofing	3	
4A-4B	Black with white streaks floor tile 9"x9"	4	
5A-5B	Beige with white streaks floor tile 12"x12"	5	
6A-6B	Tan floor tile 9"x9"	6	
7A-7B	Drywall and joint compound	7	✓

Client Sample # (s): - Total # of Samples:

Relinquished (Client): *Josh Harey* Date: 11/23/21 Time: 1410

Received (Lab): *Josh Harey* Date: 11/24/21 Time: 1250

Comments/Special Instructions:
ALSO EMAIL Fbuescher@augustmack.com



EMSL ANALYTICAL, INC.
LABORATORY • PRODUCTS • TRAINING

Asbestos Chain of Custody

EMSL Order Number (Lab Use Only):

28672

PHONE:
FAX:

Additional Pages of the Chain of Custody are only necessary if needed for additional sample information

Sample #	Sample Description	Volume/Area (Air) HA # (Bulk)	Date/Time Sampled
8A-8B	white window glaze	8	11/23/21
9A-9B	Gasket	9	↓

***Comments/Special Instructions:**

ATTACHMENT D

Site Photographs



Photo 1 – View of asbestos-containing black floor tile in the concrete structure.



Photo 2 – View of asbestos-containing tan floor tile in concrete structure.



Photo 3 – View of central area of concrete structure looking south.



Photo 4 – View of central area of concrete structure looking northeast.



Notification of Demolition and Renovation/Abatement

Section 1: General Information

Division of Air Pollution Control

Work on projects cannot begin until 10 working days after a COMPLETE original notification form, **including payment**, is submitted to Ohio EPA. Instructions and a worksheet for fee calculation are available at epa.ohio.gov/asbestos. This form can be completed, and payment made, at ebiz.epa.ohio.gov. Questions? asbestos@epa.ohio.gov or (614) 466-0061.

Ohio EPA Use Only	Notification #:	Postmarked: / /	Received: / /	<input type="checkbox"/> Hand-Delivered
-------------------	-----------------	-----------------	---------------	---

1) Notification Information (Check all that apply)

<input checked="" type="checkbox"/> Original	<input type="checkbox"/> Revision # (count):	<input type="checkbox"/> Installation	<input type="checkbox"/> Emergency	<input type="checkbox"/> Annual	<input type="checkbox"/> Cancellation	Project County: Fairfield
<input type="checkbox"/> NESHAP Residential Exemption						

2) Owner, Asbestos Abatement Contractor, Billing and Fire Department Information

Revised?

Owner		
Name: Ohio Department of Transportation - District	Is this a company? <input checked="" type="checkbox"/> Yes <input type="checkbox"/> No	
Address: 9600 Jacksontown Road	Contact Person: Justin Shotwell	
City: Jacksontown	State: OH	Zip: 43030 -
Email: transportation.ohio.gov	Phone: (740) 323 - 4400	Fax: () -
Asbestos Abatement Contractor (if applicable)		
Name:	License #: AC	Expiration Date: / /
Address:	Contact Person:	
City:	State:	Zip: -
Email:	Phone: () -	Fax: () -
Billing Contact (Entity paying for original notification)		
Is this contact associated with the <input type="checkbox"/> Owner, <input type="checkbox"/> Asbestos Abatement Contractor, or <input type="checkbox"/> Demolition Contractor (if not installation)?		
Address:	Contact Person:	
City:	State:	Zip: -
Email:	Phone: () -	Fax: () -
Fire Department (if applicable)		
Name:	Contact Person:	
Address:	Contact Person:	
City:	State:	Zip: -
Email:	Phone: () -	Fax: () -

3) Ohio Asbestos Hazard Evaluation Specialist and Evaluation Procedure

Revised?

Evaluation Specialist: Joshua Hanes	Certification #: ES 544805	Expiration Date: 01/20/22
Procedure, including analytical methods, employed to detect the presence of and to estimate the quantity of regulated asbestos-containing material (RACM) and Category I and Category II non-friable asbestos-containing material: <input checked="" type="checkbox"/> PLM <input type="checkbox"/> Point Count <input type="checkbox"/> TEM <input type="checkbox"/> Other Method (Explain Below):		

4) Procedures to be followed should unexpected RACM be discovered (check all that apply)

Revised?

<input checked="" type="checkbox"/> Stop work and keep wet	<input type="checkbox"/> Evacuate area	<input type="checkbox"/> Demarcate area	<input checked="" type="checkbox"/> Contact licensed abatement contractor
<input type="checkbox"/> Contact district office/local air authority			
<input type="checkbox"/> Other (Explain):			

5) Planned Demolition (check all that apply)

Revised?

Describe demolition work to be performed and method(s) to be employed, including demolition techniques to be used: <input type="checkbox"/> Implosion <input type="checkbox"/> Fire Training <input type="checkbox"/> Wet Methods <input type="checkbox"/> Manual Demolition <input checked="" type="checkbox"/> Mechanical Demolition <input type="checkbox"/> Other (Explain):
Description of affected facility components (include attachment if necessary): The entire structure will be impacted.

Notification of Demolition and Renovation/Abatement

Section 1: General Information

Continued

Mail completed form and payment to:
Ohio EPA, DAPC – Asbestos
P.O. Box 1049, Columbus, OH 43216-1049

6) Asbestos Description and Engineering Controls (if asbestos is being abated)

Revised?

For the material listed in each project, describe the type(s) of ACM to be abated, engineering controls and work practices to be used to minimize emissions and ensure proper waste handling:

Type of ACM to be abated:	<input type="checkbox"/> Surfacing	<input type="checkbox"/> Mechanical	<input type="checkbox"/> Other		
Engineering Controls:	<input type="checkbox"/> Wet Methods	<input type="checkbox"/> Glove Bag	<input type="checkbox"/> NPE	<input type="checkbox"/> AFD	<input type="checkbox"/> Other:
Work Practices:	<input type="checkbox"/> Intact Removal	<input type="checkbox"/> Manual	<input type="checkbox"/> Mechanical	<input type="checkbox"/> Other:	

7) Asbestos Waste Transporter (if applicable)

Revised?

Transporter #1 Name:					
Address:			Contact Person:		
City:	State:		Zip:		-
Email:	Phone: () -		Fax: () -		
Transporter #2 Name (if applicable):					
Address:			Contact Person:		
City:	State:		Zip:		-
Email:	Phone: () -		Fax: () -		

8) Asbestos Waste Disposal Site (if applicable)

Revised?

Name:					
Address:			Contact Person:		
City:	State:		Zip:		-
Email:	Phone: () -		Fax: () -		

9) Emergency Demolition (complete if you checked "Emergency" above and "Demolition" for any project)

Revised?

A copy of the issued order, including the following information, must be attached to this notification.					
Government Official Issuing Order:			Title:		
Agency:			Authority of Order (Citation of Code):		
Date of Order: / /			Demolition Date: / /		

10) Emergency Renovation/Abatement (complete if you checked "Emergency" above and "Renovation/Abatement" for any project)

Revised?

Date of Emergency: / /		Time of Emergency: : <input type="checkbox"/> a.m. <input type="checkbox"/> p.m.			
Description of Sudden, Unexpected Event:					
Explanation of how the event caused unsafe conditions or equipment damage:					

11) Attestation

Revised?

In accordance with Ohio Administrative Code rule 3745-20-03(A)(4)(p), I certify that at least one person trained as required by paragraph (B) of rule 3745-20-04 of the Administrative Code will supervise the stripping and removal described by this notification. I acknowledge that the submission of false or misleading statements is prohibited by law and I certify that facts contained in this notification are true, accurate, and complete.

Signature:		Date: / /			
Name:		Title:			
Organization:					



Notification of Demolition and Renovation/Abatement

Section 2: Project Address Specific Information

Division of Air Pollution Control

Please complete Section 2 for the address included with this notification. If the project is an "Installation" per OAC 3745-20, complete a separate Section 2 page for each address associated with this notification.

Ohio EPA Use Only	Project ID #: _____
-------------------	---------------------

A. Facility Description Revised?

Building Name (if applicable): Concrete block building		Site Location (specific): 39.84065278/-82.56818611	
Address: 7640 Lancaster-Newark Road NE			
City: Baltimore	State: OH	Zip: 43105 -	
Building Size (square feet): 2400	No. of Floors: 1.0	Age: Unknown	
Present Use: Vacant commercial (partially collapsed)		Prior Use: Commercial	

B. Type of Operation (check all that apply) Revised?

<input checked="" type="checkbox"/> Demolition	<input type="checkbox"/> Renovation/Abatement – Type: <input type="checkbox"/> Removal <input type="checkbox"/> Repair <input type="checkbox"/> Encapsulation <input type="checkbox"/> Enclosure
--	--

C. Asbestos Present (check one) Revised?

<input checked="" type="checkbox"/> Yes	<input type="checkbox"/> No	<input type="checkbox"/> No, previously abated	Year Abated: _____
---	-----------------------------	--	--------------------

D. Approximate Amount of Asbestos-Containing Materials (complete table below and Section 1 #6 if asbestos is present) Revised?

	Material to be Removed				Material NOT to be Removed	
	RACM	Non-friable Asbestos-Containing Material		Non-friable Asbestos-Containing Material		
		Category I	Category II	Category I	Category II	
Pipes (linear feet)						
Surface area on other facility components (ft ²)	115					
Volume if length or area cannot be measured (ft ³)						

E. Asbestos Abatement Schedule and Abatement Specialist (original notification is required 10 working days prior to the start of work) Revised?

Setup Date: / /			Abatement Date: / /			Complete Date: / /	
(Shift 1) Time start/end on site	Monday	Tuesday	Wednesday	Thursday	Friday	Saturday	Sunday
Abatement Specialist Name:				Certification #: AS		Expiration Date: / /	
(Shift 2) Time start/end on site	Monday	Tuesday	Wednesday	Thursday	Friday	Saturday	Sunday
Abatement Specialist Name:				Certification #: AS		Expiration Date: / /	

F. Demolition Contractor (if applicable) Revised?

Name:			
Address:			Contact Person:
City:	State:	Zip: -	
Email:	Phone: () -	Fax: () -	

G. Demolition Schedule (original notification is required 10 working days prior to the start of work) Revised?

Start Date: / /	Complete Date: / /
-----------------	--------------------

H. Project Hold Revised?

Asbestos Abatement Offsite/On Hold as of Date: / /	Asbestos Abatement On Site/Off Hold, Work Resume Date: / /
Demolition Offsite/On Hold as of Date: / /	Demolition On Site/Off Hold, Work Resume Date: / /



Notification of Demolition and Renovation/Abatement

Section 1: General Information

Division of Air Pollution Control

Work on projects cannot begin until 10 working days after a COMPLETE original notification form, **including payment**, is submitted to Ohio EPA. Instructions and a worksheet for fee calculation are available at epa.ohio.gov/asbestos. This form can be completed, and payment made, at ebiz.epa.ohio.gov. Questions? asbestos@epa.ohio.gov or (614) 466-0061.

<i>Ohio EPA Use Only</i>	Notification #:	Postmarked: / /	Received: / /	<input type="checkbox"/> Hand-Delivered
--------------------------	-----------------	-----------------	---------------	---

1) Notification Information (Check all that apply)

<input checked="" type="checkbox"/> Original	<input type="checkbox"/> Revision # (count):	<input type="checkbox"/> Installation	<input type="checkbox"/> Emergency	<input type="checkbox"/> Annual	<input type="checkbox"/> Cancellation	Project County: Fairfield
<input type="checkbox"/> NESHAP Residential Exemption						

2) Owner, Asbestos Abatement Contractor, Billing and Fire Department Information

Revised?

Owner		
Name: Ohio Department of Transportation - District		Is this a company? <input checked="" type="checkbox"/> Yes <input type="checkbox"/> No
Address: 9600 Jacksontown Road		Contact Person: Justin Shotwell
City: Jacksontown	State: OH	Zip: 43030 -
Email: transportation.ohio.gov	Phone: (740) 323 - 4400	Fax: () -
Asbestos Abatement Contractor (if applicable)		
Name:		License #: AC Expiration Date: / /
Address:		Contact Person:
City:	State:	Zip: -
Email:	Phone: () -	Fax: () -
Billing Contact (Entity paying for original notification)		
Is this contact associated with the <input type="checkbox"/> Owner, <input type="checkbox"/> Asbestos Abatement Contractor, or <input type="checkbox"/> Demolition Contractor (if not installation)?		
Address:		Contact Person:
City:	State:	Zip: -
Email:	Phone: () -	Fax: () -
Fire Department (if applicable)		
Name:		
Address:		Contact Person:
City:	State:	Zip: -
Email:	Phone: () -	Fax: () -

3) Ohio Asbestos Hazard Evaluation Specialist and Evaluation Procedure

Revised?

Evaluation Specialist: Joshua Hanes	Certification #: ES 544805	Expiration Date: 01/20/22
Procedure, including analytical methods, employed to detect the presence of and to estimate the quantity of regulated asbestos-containing material (RACM) and Category I and Category II non-friable asbestos-containing material: <input checked="" type="checkbox"/> PLM <input type="checkbox"/> Point Count <input type="checkbox"/> TEM <input type="checkbox"/> Other Method (Explain Below):		

4) Procedures to be followed should unexpected RACM be discovered (check all that apply)

Revised?

<input checked="" type="checkbox"/> Stop work and keep wet	<input type="checkbox"/> Evacuate area	<input type="checkbox"/> Demarcate area	<input checked="" type="checkbox"/> Contact licensed abatement contractor
<input type="checkbox"/> Contact district office/local air authority			
<input type="checkbox"/> Other (Explain):			

5) Planned Demolition (check all that apply)

Revised?

Describe demolition work to be performed and method(s) to be employed, including demolition techniques to be used: <input type="checkbox"/> Implosion <input type="checkbox"/> Fire Training <input type="checkbox"/> Wet Methods <input type="checkbox"/> Manual Demolition <input checked="" type="checkbox"/> Mechanical Demolition <input type="checkbox"/> Other (Explain):	
Description of affected facility components (include attachment if necessary): The entire structure will be impacted.	

Notification of Demolition and Renovation/Abatement

Section 1: General Information

Continued

Mail completed form and payment to:
Ohio EPA, DAPC – Asbestos
P.O. Box 1049, Columbus, OH 43216-1049

6) Asbestos Description and Engineering Controls (if asbestos is being abated)

Revised?

For the material listed in each project, describe the type(s) of ACM to be abated, engineering controls and work practices to be used to minimize emissions and ensure proper waste handling:

Type of ACM to be abated:	<input type="checkbox"/> Surfacing	<input type="checkbox"/> Mechanical	<input type="checkbox"/> Other		
Engineering Controls:	<input type="checkbox"/> Wet Methods	<input type="checkbox"/> Glove Bag	<input type="checkbox"/> NPE	<input type="checkbox"/> AFD	<input type="checkbox"/> Other:
Work Practices:	<input type="checkbox"/> Intact Removal	<input type="checkbox"/> Manual	<input type="checkbox"/> Mechanical	<input type="checkbox"/> Other:	

7) Asbestos Waste Transporter (if applicable)

Revised?

Transporter #1 Name:					
Address:			Contact Person:		
City:	State:		Zip:		-
Email:	Phone: () -		Fax: () -		
Transporter #2 Name (if applicable):					
Address:			Contact Person:		
City:	State:		Zip:		-
Email:	Phone: () -		Fax: () -		

8) Asbestos Waste Disposal Site (if applicable)

Revised?

Name:					
Address:			Contact Person:		
City:	State:		Zip:		-
Email:	Phone: () -		Fax: () -		

9) Emergency Demolition (complete if you checked "Emergency" above and "Demolition" for any project)

Revised?

A copy of the issued order, including the following information, must be attached to this notification.					
Government Official Issuing Order:			Title:		
Agency:			Authority of Order (Citation of Code):		
Date of Order: / /			Demolition Date: / /		

10) Emergency Renovation/Abatement (complete if you checked "Emergency" above and "Renovation/Abatement" for any project)

Revised?

Date of Emergency: / /		Time of Emergency: : <input type="checkbox"/> a.m. <input type="checkbox"/> p.m.			
Description of Sudden, Unexpected Event:					
Explanation of how the event caused unsafe conditions or equipment damage:					

11) Attestation

Revised?

In accordance with Ohio Administrative Code rule 3745-20-03(A)(4)(p), I certify that at least one person trained as required by paragraph (B) of rule 3745-20-04 of the Administrative Code will supervise the stripping and removal described by this notification. I acknowledge that the submission of false or misleading statements is prohibited by law and I certify that facts contained in this notification are true, accurate, and complete.

Signature:		Date: / /			
Name:		Title:			
Organization:					



Notification of Demolition and Renovation/Abatement

Section 2: Project Address Specific Information

Division of Air Pollution Control

Please complete Section 2 for the address included with this notification. If the project is an "Installation" per OAC 3745-20, complete a separate Section 2 page for each address associated with this notification.

Ohio EPA Use Only	Project ID #: _____
-------------------	---------------------

A. Facility Description Revised?

Building Name (if applicable): Metal Shed (10x20)		Site Location (specific): 39.84075833/-82.56761111	
Address: 1045 Baltimore - Somerset Road NE			
City: Baltimore	State: OH	Zip: 43105 -	
Building Size (square feet): 120	No. of Floors: 1.0	Age: 42 years	
Present Use: Commercial		Prior Use: Commercial	

B. Type of Operation (check all that apply) Revised?

<input checked="" type="checkbox"/> Demolition	<input type="checkbox"/> Renovation/Abatement – Type: <input type="checkbox"/> Removal <input type="checkbox"/> Repair <input type="checkbox"/> Encapsulation <input type="checkbox"/> Enclosure
--	--

C. Asbestos Present (check one) Revised?

<input type="checkbox"/> Yes	<input checked="" type="checkbox"/> No	<input type="checkbox"/> No, previously abated	Year Abated: _____
------------------------------	--	--	--------------------

D. Approximate Amount of Asbestos-Containing Materials (complete table below and Section 1 #6 if asbestos is present) Revised?

	Material to be Removed				Material NOT to be Removed	
	RACM	Non-friable Asbestos-Containing Material		Non-friable Asbestos-Containing Material		
		Category I	Category II	Category I	Category II	
Pipes (linear feet)						
Surface area on other facility components (ft ²)						
Volume if length or area cannot be measured (ft ³)						

E. Asbestos Abatement Schedule and Abatement Specialist (original notification is required 10 working days prior to the start of work) Revised?

Setup Date: / /			Abatement Date: / /			Complete Date: / /	
(Shift 1) Time start/end on site	Monday	Tuesday	Wednesday	Thursday	Friday	Saturday	Sunday
Abatement Specialist Name:				Certification #: AS		Expiration Date: / /	
(Shift 2) Time start/end on site	Monday	Tuesday	Wednesday	Thursday	Friday	Saturday	Sunday
Abatement Specialist Name:				Certification #: AS		Expiration Date: / /	

F. Demolition Contractor (if applicable) Revised?

Name:		
Address:		Contact Person:
City:	State:	Zip: -
Email:	Phone: () -	Fax: () -

G. Demolition Schedule (original notification is required 10 working days prior to the start of work) Revised?

Start Date: / /	Complete Date: / /
-----------------	--------------------

H. Project Hold Revised?

Asbestos Abatement Offsite/On Hold as of Date: / /	Asbestos Abatement On Site/Off Hold, Work Resume Date: / /
Demolition Offsite/On Hold as of Date: / /	Demolition On Site/Off Hold, Work Resume Date: / /