

J:\20190040\000T\FRA\08702\Design\Roadway\Sheets\Etna\08702_GY101.dgn 5/7/2021 11:18:06 AM RELY

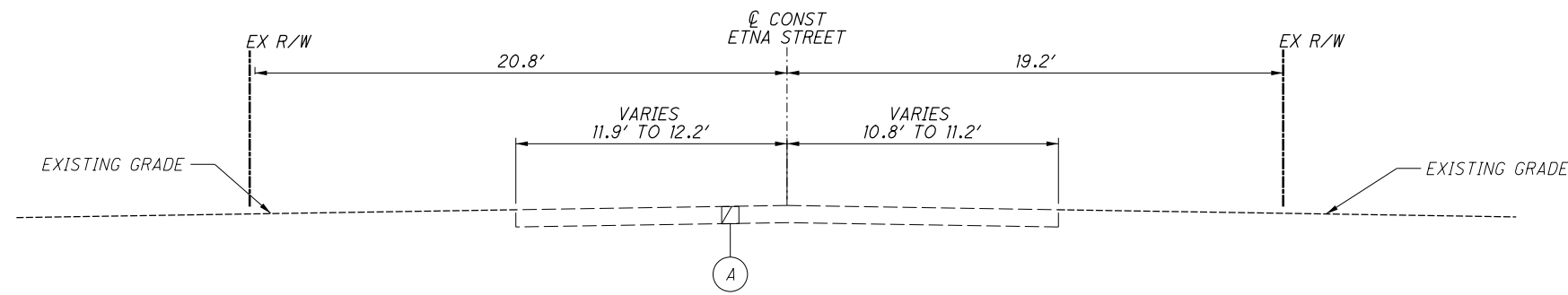

TYPICAL SECTION - EXISTING CONDITION

SECTION APPLIES:
STA 11+75.00 TO STA 13+25.00

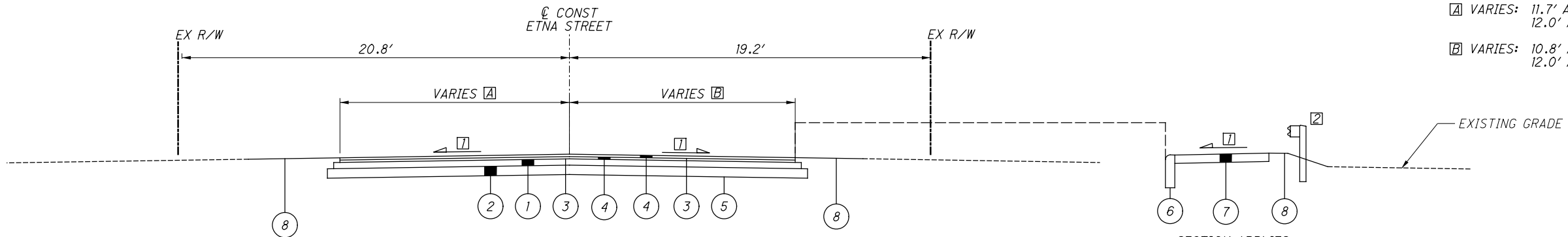

TYPICAL SECTION #1 - ETNA STREET

SECTION APPLIES:
STA 11+50.00 TO STA 12+13.16

SECTION APPLIES:
STA 11+75.00 TO STA 12+13.16

A VARIES: 11.7' AT STA 11+50.00 TO 12.0' AT STA 11+75.00
B VARIES: 10.8' AT STA 11+50.00 TO 12.0' AT STA 11+50.00

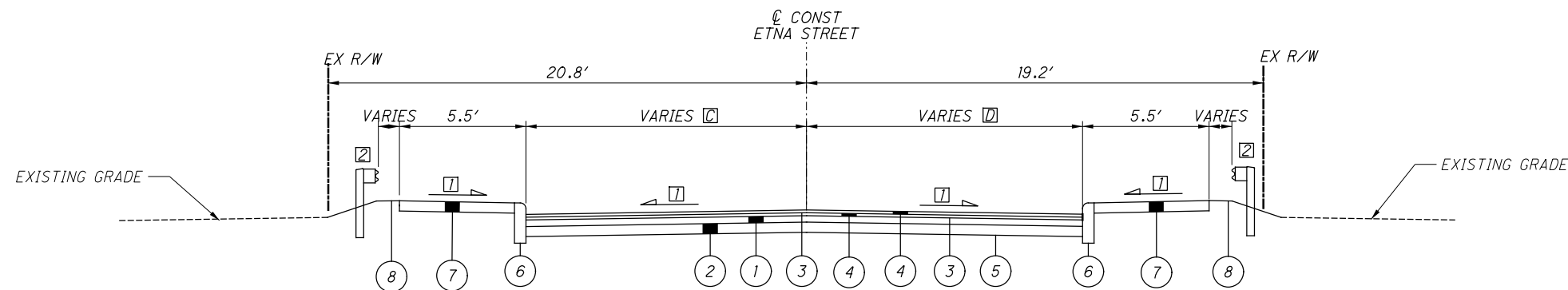

TYPICAL SECTION #2 - ETNA STREET

SECTION APPLIES:
STA 12+13.16 TO STA 12+17.56
STA 12+82.24 TO STA 13+25.00

C VARIES: 12.0' AT STA 13+00.00 TO 12.2' AT STA 13+25.00
D VARIES: 12.0' AT STA 13+00.00 TO 11.2' AT STA 13+25.00

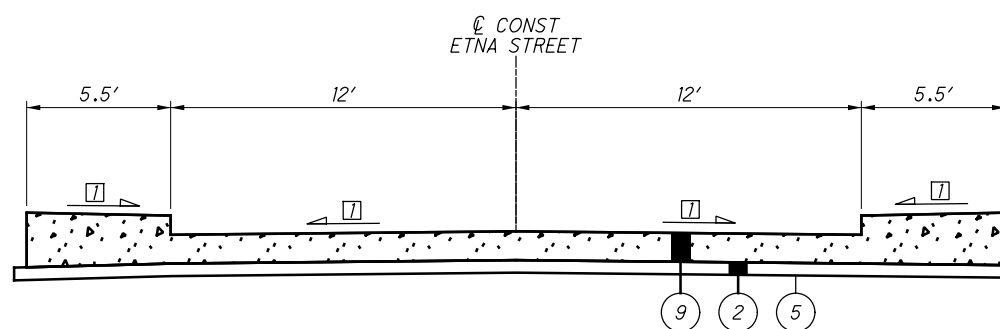

TYPICAL SECTION #3 - ETNA STREET (BRIDGE & APPROACH SLABS)

SECTION APPLIES:
STA 12+17.56 TO STA 12+32.56 (APPROACH SLAB)
STA 12+32.56 TO STA 12+67.24 (BRIDGE)
STA 12+67.24 TO STA 12+82.24 (APPROACH SLAB)

LEGEND

- 1 ITEM 301 - ASPHALT CONCRETE BASE (T=4")
- 2 ITEM 304 - AGGREGATE BASE (T=6")
- 3 ITEM 407 - NON-TRACKING TACK COAT (0.055 GAL/SY) (FOR FULL-DEPTH)
- 4 ITEM 441 - ASPHALT CONCRETE SURFACE COURSE, TYPE (446), PG64-22 (T=1.5")
- 5 ITEM 205 - SUBGRADE COMPACTION
- 6 ITEM 609 - CURB, STRAIGHT 18"
- 7 ITEM 608 - 4" CONCRETE WALK
- 8 ITEM 659 - SEEDING AND MULCHING, CLASS 1
- 9 SEE STRUCTURE SHEETS FOR APPROACH SLAB AND BRIDGE DETAILS

NOTES:

- 1 CROSS-SLOPE = 1.6%
- 2 SEE PLAN AND PROFILE SHEET FOR GUARDRAIL LOCATIONS

TYPICAL SECTIONS

FRA-ETNA ST/
ELBERN AVE

[A] VARIES: 10.37 AT STA 11+50.00 TO 12.00 AT STA 11+75.00
 [B] VARIES: 10.53 AT STA 11+50.00 TO 12.00 AT STA 11+75.00

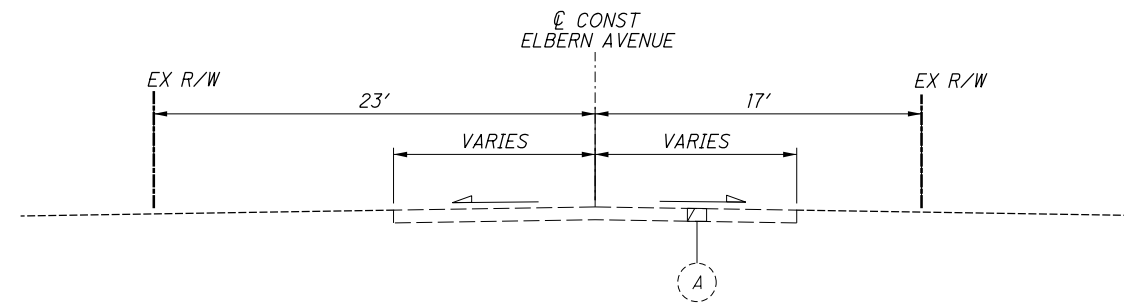

TYPICAL SECTION - EXISTING
 NOT TO SCALE
 SECTION APPLIES:
 STA 11+50.00 TO STA 13+45.00

NOTES:
 [] CROSS-SLOPE = 1.6%

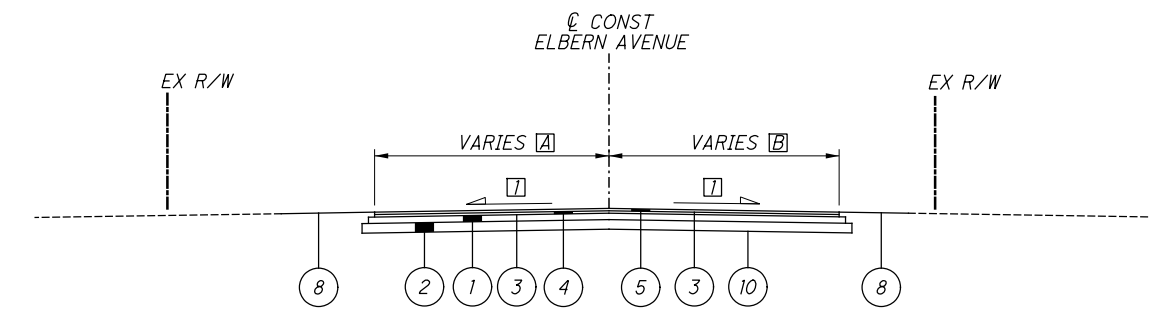

TYPICAL SECTION #1 - ELBERN AVENUE
 NOT TO SCALE
 SECTION APPLIES:
 STA 11+50.00 TO STA 11+83.78

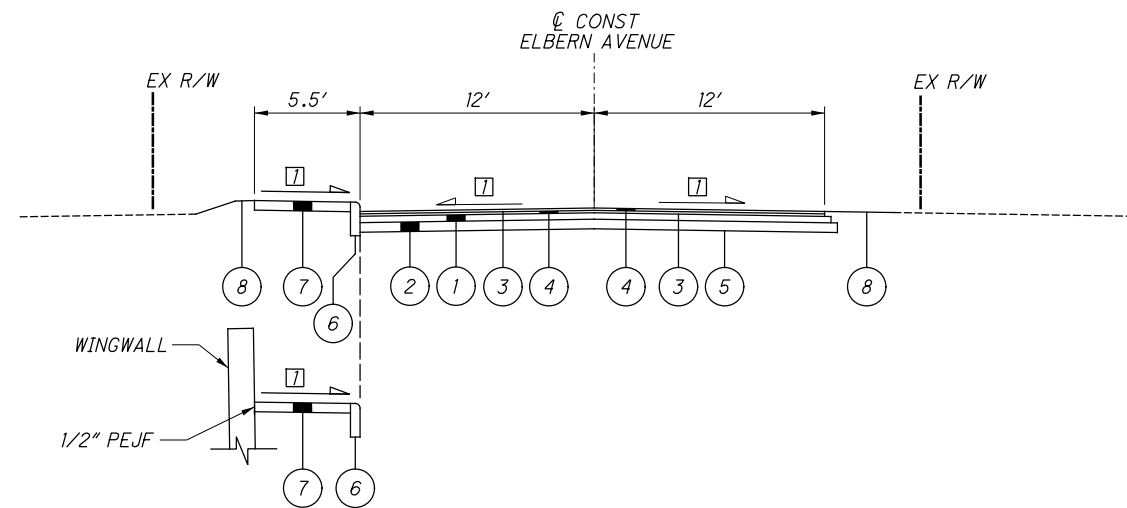

TYPICAL SECTION #2 - ELBERN AVENUE
 NOT TO SCALE
 SECTION APPLIES:
 STA 11+83.78 TO STA 12+53.40

SECTION APPLIES:
 STA 11+83.78 TO STA 12+12.28

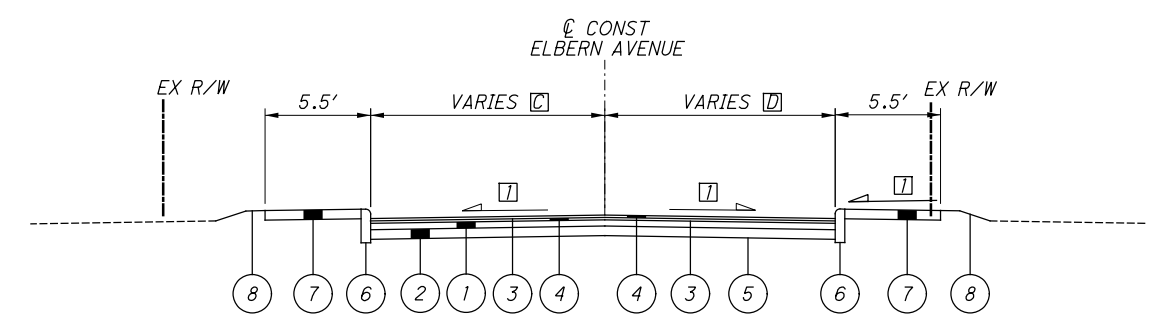

TYPICAL SECTION #3 - ELBERN AVENUE
 NOT TO SCALE
 SECTION APPLIES:
 STA 12+53.40 TO STA 12+89.23
 STA 13+16.23 TO STA 13+45.00

[C] VARIES: 12.0 AT STA 13+20.00 TO 15.8 AT STA 14+45.00
 [D] VARIES: 12.0 AT STA 13+22.60 TO 11.2 AT STA 14+45.00

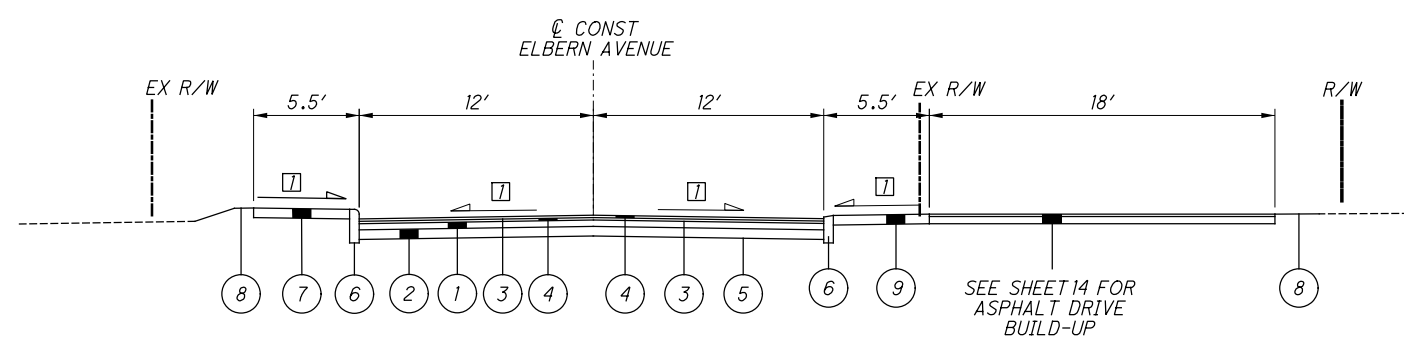

TYPICAL SECTION #4 - ELBERN AVENUE
 NOT TO SCALE
 SECTION APPLIES:
 STA 12+89.23 TO STA 13+16.23

LEGEND

- | | |
|----------------------------------------------------------------------------|----------------------------------------------|
| (1) ITEM 301 - ASPHALT CONCRETE BASE (T=4") | (7) ITEM 608 - 4" CONCRETE WALK |
| (2) ITEM 304 - AGGREGATE BASE (T=6") | (8) ITEM 659 - SEEDING AND MULCHING, CLASS 1 |
| (3) ITEM 407 - NON-TRACKING TACK COAT (0.055 GAL/SY) (FOR FULL-DEPTH) | (9) ITEM 608 - 6" CONCRETE WALK |
| (4) ITEM 441 - ASPHALT CONCRETE SURFACE COURSE, TYPE 441, PG64-22 (T=1.5") | (10) ITEM SPEC - GRAVEL REINFORCEMENT GRID |
| (5) ITEM 204 - SUBGRADE COMPACTION | (11) ITEM 304 - AGGREGATE BASE (T=8") |
| (6) ITEM 609 - CURB, STRAIGHT 18" | (A) EXISTING ASPHALT PAVEMENT |

J:\20190040\00DOT\FRA\08702\Design\Roadway\Sheets\Elbern\08702_GY001.dgn 5/7/2021 11:18:48 AM REJY

TYPICAL SECTIONS

**FRA-ETNA ST/
ELBERN AVE**

13 - W601 SERIES & 13 - F605 DOWELS, FF, SPA @ 6" MAX,
7 - W503 SERIES, NF, SPA @ 1'-0" = 6'-0"

12 SETS OF
2 - W504 SPA @ 1'-0" (MAX) = 10'-8"

23 - W602, FF, & 23 - F605 DOWELS, FF, SPA @ 6"
12 - W505, NF, SPA @ 1'-0" = 11'-0"

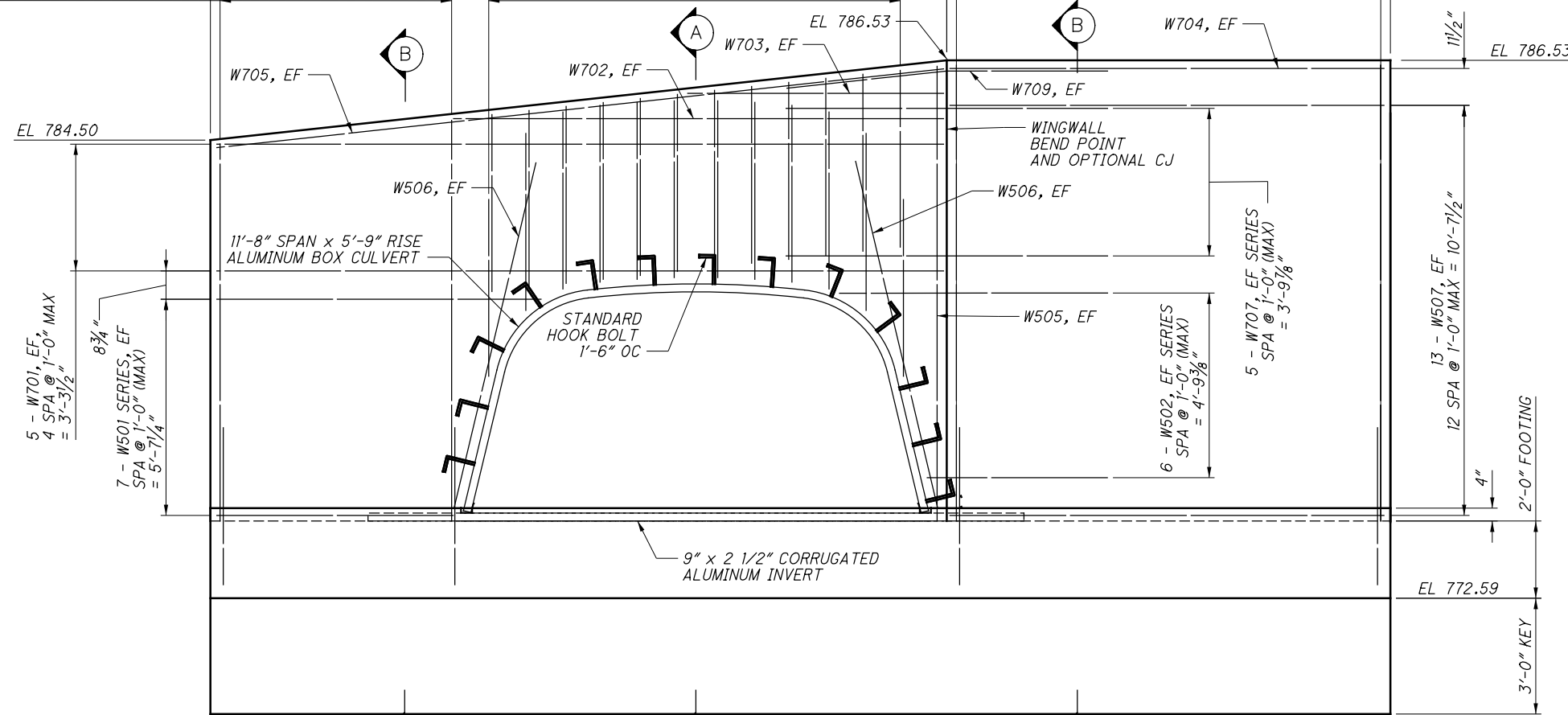

SOUTH (OUTLET) WINGWALL ELEVATION

(CONCRETE FORMLINER LIMITS NOT SHOWN FOR CLARITY)

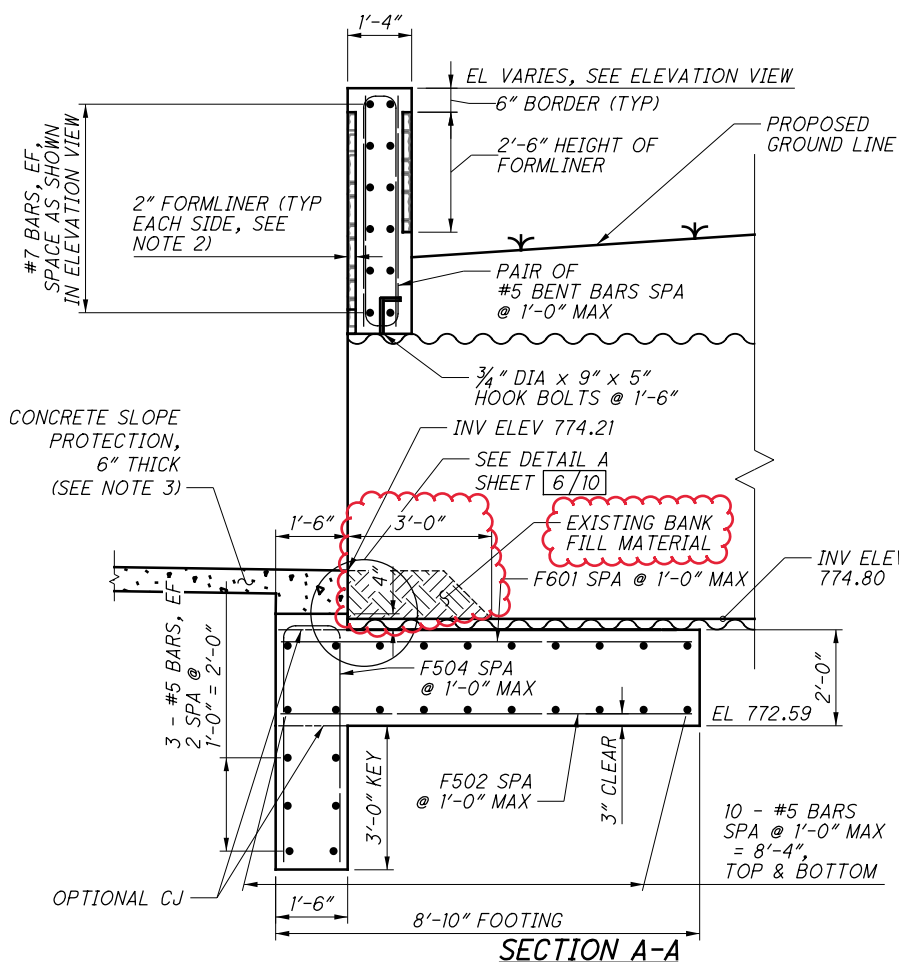

SECTION A-A

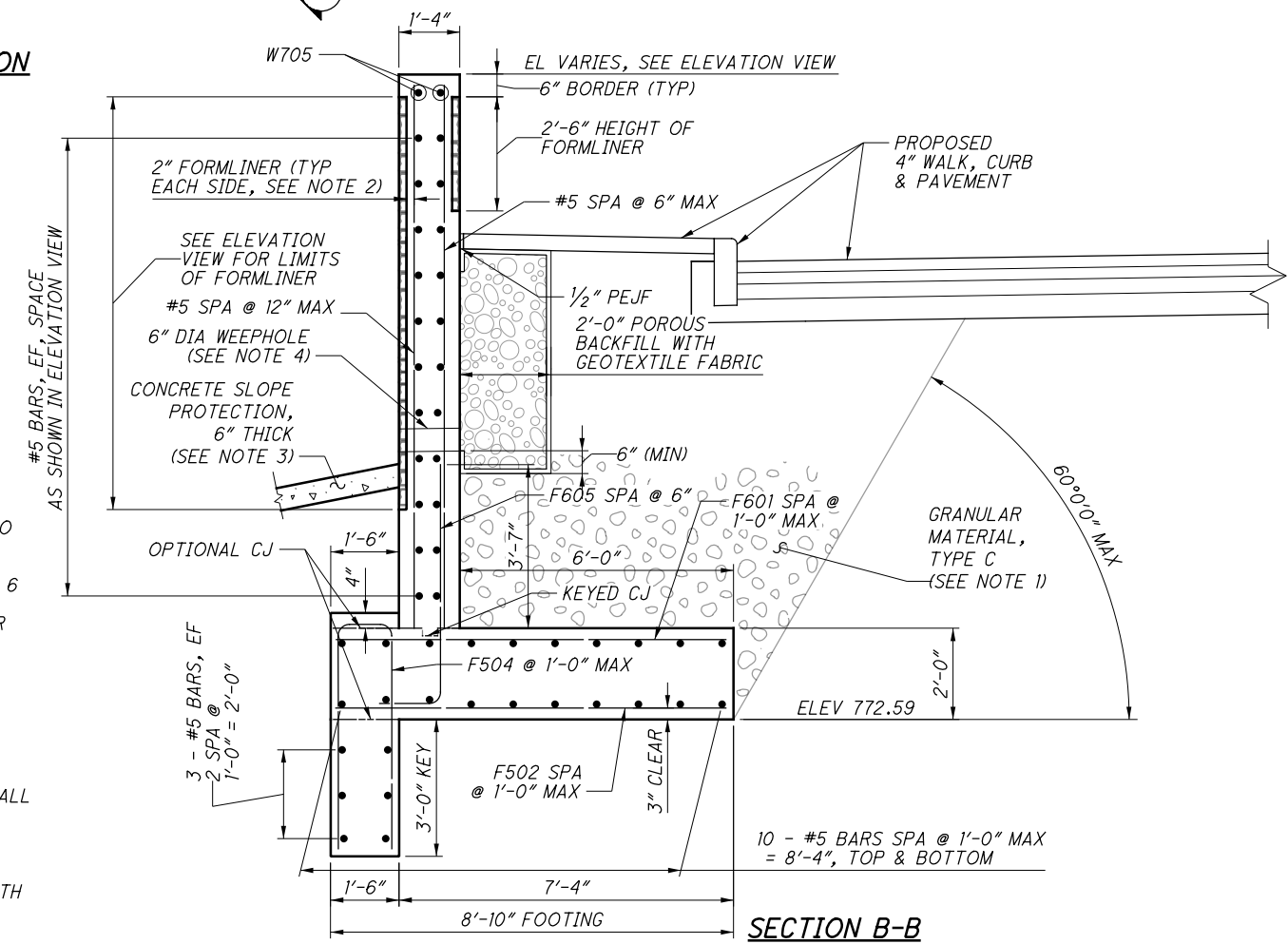

SECTION B-B

NOTES

1. GRANULAR MATERIAL, TYPE C SHALL CONFORM TO CMS 703.16C AND HAVE A MINIMUM INTERNAL FRICTION ANGLE OF 34°. PLACE GRANULAR MATERIAL IN COMPACTED LIFTS NOT TO EXCEED 6 INCHES. GRANULAR MATERIAL SHALL BE PLACED UP TO TOP OF POROUS BACKFILL ELEVATION OR BOTTOM OF PAVEMENT SUBGRADE. GRANULAR BACKFILL SHALL BE INCLUDED WITH ITEM 203, GRANULAR MATERIAL TYPE C, FOR PAYMENT.
2. FORMLINER PATTERN SHOWN IS FOR REFERENCE ONLY. FORMLINER SHALL BE APPLIED TO THE LIMITS SHOWN IN THE PLANS.
3. CONCRETE SLOPE PROTECTION AT SOUTH WINGWALL SHOWN. NORTH WINGWALL SIMILAR WITH ROCK CHANNEL PROTECTION AS SHOWN IN PLAN AND ELEVATION.
4. 6" DIAMETER WEEPHOLES SHALL BE INCLUDED WITH ITEM 518 - POROUS BACKFILL WITH GEOTEXTILE FABRIC, FOR PAYMENT.

J:\20190040\0DOT\FRA\08702\Design\Structures\FRA\ELB_1485C_Sheets\ELB_1485C_SM002.dgn 5/7/2021 4:15:56 PM REJ

DESIGN AGENCY EMH	DATE 12-22-20	REVIEWED CAS	STRUCTURE FILE NUMBER 2567696
DRAWN MSM	CHECKED RUE	DESIGNED MSM	REVISED -
SOUTH WINGWALL DETAILS FRA-M1485-00380 ELBERN AVENUE BRIDGE OVER TURKEY RUN			
FRA-ETNA ST / ELBERN AVE PID No. 108702		9 / 10 25 / 29	