

INDEX OF SHEETS

TITLE SHEET	1	
INDEX SHEET	2	
SCHEMATIC PLAN	3-4	
GEOMETRIC PLAN	5-7	
TYPICAL SECTIONS	8-25	
GENERAL NOTES	26-32	
CITY OF COLUMBUS STANDARD DRAWINGS	33-34	
CONCRETE BARRIER TAPERED END SECTION	35	
MAINTENANCE OF TRAFFIC	36-39, 39A, 40-121A, 122, 123	
GENERAL SUMMARY	124-130	
DEMOLITION PLAN	131-139	
PROJECT SITE PLAN	140-143	
PLAN & PROFILE - SR-665	144-155	
PLAN & PROFILE - RAMP "A"	156-158	
PLAN & PROFILE - RAMP "A RT"	159-160	
PLAN & PROFILE - RAMP "B"	161-163	
PLAN & PROFILE - RAMP "B RT"	164	
PLAN & PROFILE - RAMP "C"	165-167	
PLAN & PROFILE - RAMP "C RT"	168-169	
PLAN & PROFILE - RAMP "D"	170-172	
PLAN & PROFILE - RAMP "D RT"	173	
PLAN & PROFILE - GATEWAY WEST DRIVE	174	
PLAN & PROFILE - I-71	175-194	
PLAN & PROFILE - I-71	195-197	
PLAN & PROFILE - I-71	198-207	
CROSS SECTION LAYOUT INDEX	208-230	
CROSS SECTIONS SR-665	231-236	
CROSS SECTIONS RAMP "A"	237-241	
CROSS SECTIONS RAMP "A RT"	242-249	
CROSS SECTIONS RAMP "B"	250-252	
CROSS SECTIONS RAMP "B RT"	253-259	
CROSS SECTIONS RAMP "C"	260-263	
CROSS SECTIONS RAMP "C RT"	264-270	
CROSS SECTIONS RAMP "D"	271-273	
CROSS SECTIONS RAMP "D RT"	274-276	
CROSS SECTIONS GATEWAY WEST DRIVE	277-327	
CROSS SECTIONS I-71	328	
CROSS SECTIONS EARTHWORK QUANTITIES	328-335	
SUPERELEVATION TABLES	336-337A, 338-341	
CURB RAMP DETAILS	342	
CURB RAMP ESTIMATED QUANTITIES	343-369	
PAVEMENT DETAILS	370-387	
JOINT DETAILS		
GRADING DETAILS	388-398	
DRIVE DETAILS	399-402	
CONTAMINATED SOILS	403-404	
STORM SEWER SCHEMATICS	405-410	
DRAINAGE ESTIMATED QUANTITIES	411-414	
OFF SITE DRAINAGE PLAN	415	
STORM SEWER PROFILES	416-426	
HEADWALL DETAILS	427-428	
UNDERDRAIN SCHEMATICS	429-435	
UNDERDRAIN ESTIMATED QUANTITIES	436-440	
CULVERT DETAILS	441-471	
CULVERT ESTIMATED QUANTITIES	472	
RETAINING WALLS	473-481	
RETAINING WALL ESTIMATED QUANTITIES	482	
SWACO SANITARY FORCE MAIN	483-495	
GUARDRAIL/BARRIER SCHEMATICS	496-497	
TRAFFIC CONTROL PLAN	498-533	
TRAFFIC SIGNALS	534-554	
RAMP METERING	555-575	
LIGHTING	576-599	
SEEDING & SODDING PLAN	600-609	
SEEDING & SODDING ESTIMATED QUANTITIES	610-611	
LANDSCAPING PLAN	612-618, 618A, 619	
STRUCTURES (20'-AND OVER)	620-664	
FENCE PLAN	665-675	
RIGHT OF WAY	676-726	
SOIL PROFILES		

TIMING CHART

PHASE	φ1	φ2	φ3	φ4	φ5	φ6	φ7	φ8
MOVEMENT	EBLT	WB	NBLT	SB	WBLT	EB	SBLT	NB
MIN. INITIAL	8	25	8	3.0	4.0	25	8	3.0
PASS TIME	75	75	75	45	75	75	45	45
MAX. GRN 1	5.0	4.0	4.0	2.0	2.0	2.0	2.0	2.0
MAX. GRN 2	7	7	7	-	-	17	17	17
YELLOW	2.0	2.0	2.0	2.0	2.0	2.0	2.0	2.0
RED CLR.	7	7	7	-	-	17	17	17
WALK	ON	OFF	ON	OFF	ON	ON	OFF	OFF
PED. RECALL	ON	ON	ON	OFF	ON	ON	ON	OFF
VEH. RECALL	ON	ON	ON	OFF	ON	ON	ON	OFF
MEMORY	LOCK	LOCK	NON-LOCK	NON-LOCK	LOCK	LOCK	LOCK	NON-LOCK

LEGEND

- SIGNAL CABLE #14 AWG
- NO. 2 QUANTITY OF CONDUCTORS
- VEHICULAR SIGNAL HEAD
- PEDESTRIAN SIGNAL HEAD
- PEDESTRIAN PUSH BUTTON
- 3/C #14 AWG (SIGNAGE)
- DIST. CABLE #6 AWG (2-WIRE)
- 3/C #8 AWG
- 3/C #6 AWG
- DISCONNECT SWITCH
- POWER TAP-IN
- LIGHT FIXTURE
- PHOTOELECTRIC CELL
- NO. 10 AWG POLE & BRACKET CABLE
- CONNECTION FOR LIGHTING
- ILLUMINATED STREET NAME SIGN
- VIDEO DETECTION CAMERA
- VIDEO DETECTION CABLE

FIELD WIRING HOOK-UP CHART

SIGNAL HEAD #	INDICATION	FIELD TERMINAL	SIGNAL FLASH #	INDICATION	FIELD TERMINAL	FLASH
1	R	φ4 R	6	R	φ8 R	R
	Y	φ4 Y		Y	φ8 Y	R
	G	φ4 G		G	φ8 G	R
2	R	φ4 R	7	R	φ6 R	Y
	Y	φ4 Y		Y	φ6 Y	Y
	G	φ4 G		G	φ6 G	Y
3	R	φ2 R	8	R	φ6 R	Y
	Y	φ2 Y		Y	φ6 Y	Y
	G	φ2 G		G	φ6 G	Y
4	R	φ2 R	S	WALK	G φ6-W	OFF
	Y	φ2 Y		DON'T WALK	R φ6-DW	OFF
	G	φ2 G		WALK	G φ6-W	OFF
5	R	φ8 R	E	DON'T WALK	R φ8-DW	OFF
	Y	φ8 Y		WALK	G φ2-W	OFF
	G	φ8 G		DON'T WALK	R φ2-DW	OFF

VEHICLE DETECTOR DETAILS

DETECTOR	CAMERA SYMBOL	PHASE	SIZE	COUNT	PRESENCE	DIRECTIONALITY	DELAY
L-1	1	φ6	2' x 8'	X	DISABLED	0 SEC	0 SEC
L-2	2	φ2	2' x 8'	X	DISABLED	0 SEC	0 SEC
L-3	2	φ2	2' x 8'	X	DISABLED	0 SEC	0 SEC
L-4	3	φ6	2' x 30' x 2'	X	DISABLED	4 SEC	4 SEC
L-5	3	φ6	2' x 30' x 2'	X	DISABLED	4 SEC	4 SEC
L-6	3	φ6	2' x 8'	X	DISABLED	0 SEC	0 SEC
L-7	3	φ6	2' x 8'	X	DISABLED	0 SEC	0 SEC
L-8	4	φ4	2' x 30' x 2'	X	DISABLED	4 SEC	4 SEC
L-9	4	φ4	2' x 30' x 2'	X	DISABLED	4 SEC	4 SEC
L-10	4	φ4	2' x 8'	X	DISABLED	0 SEC	0 SEC
L-11	4	φ4	2' x 8'	X	DISABLED	0 SEC	0 SEC

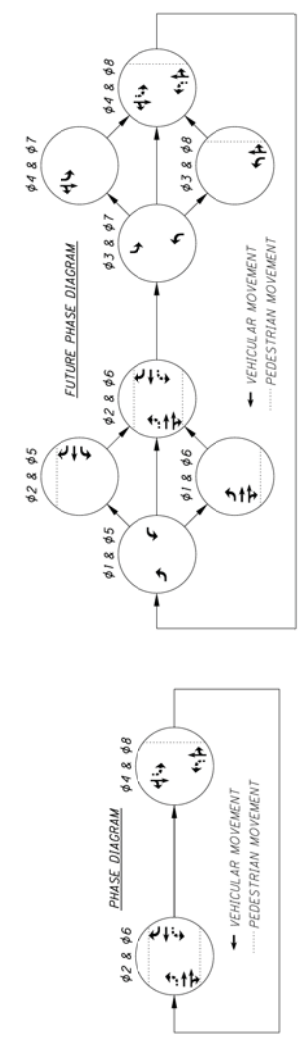
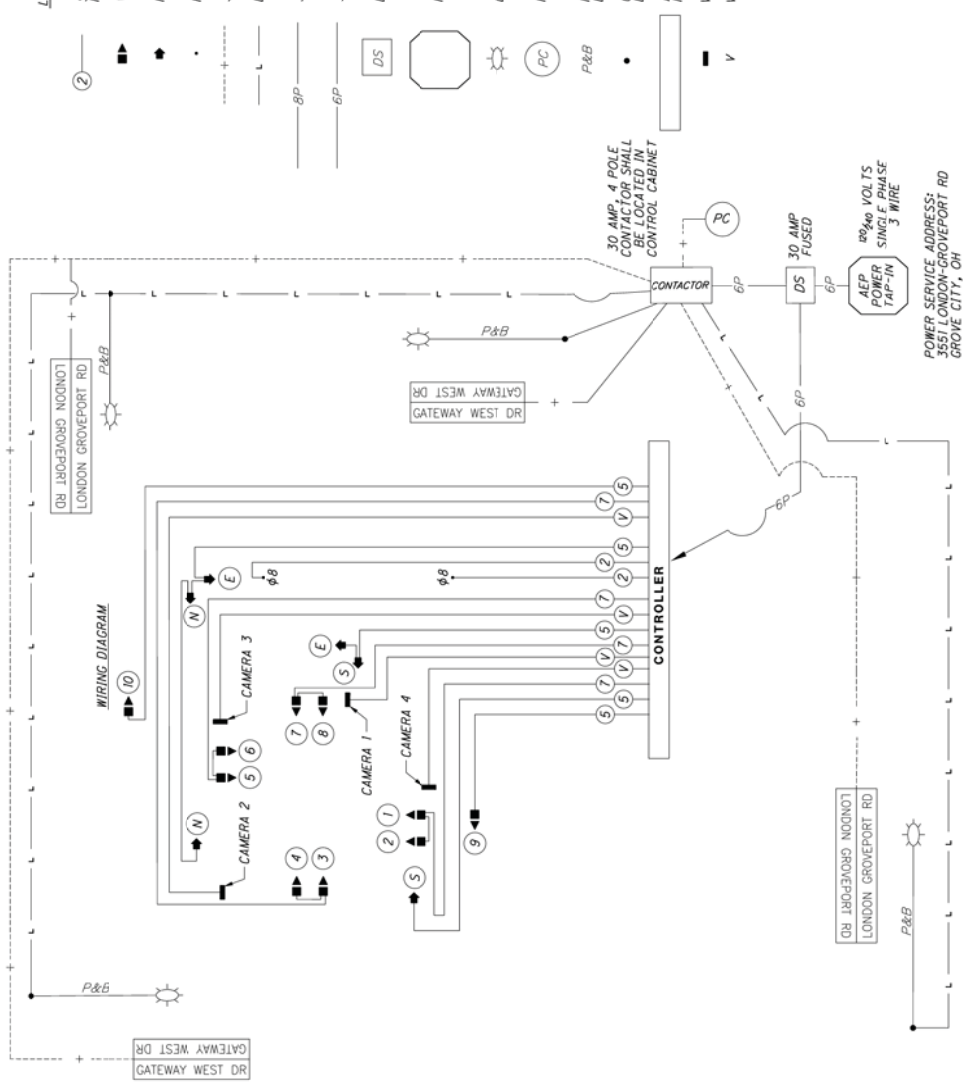
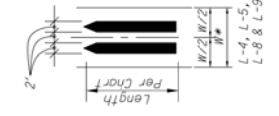

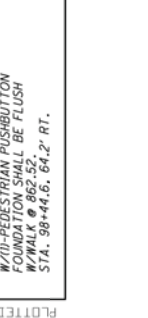
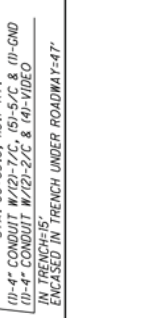
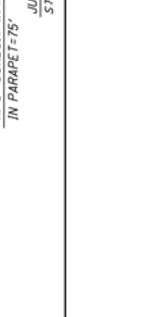
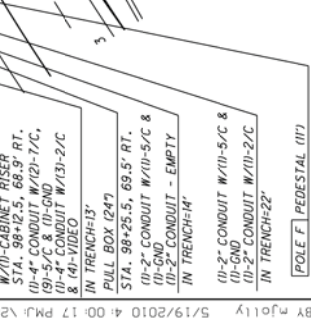
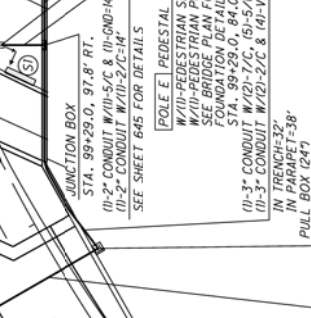
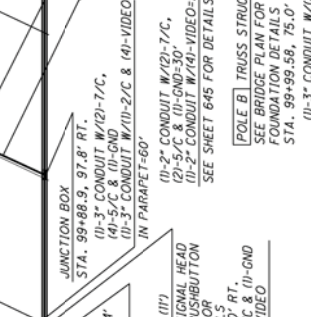
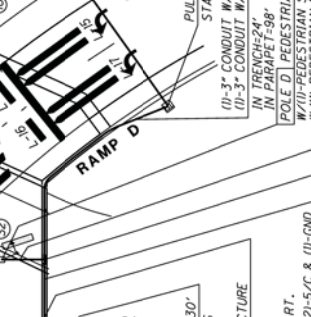
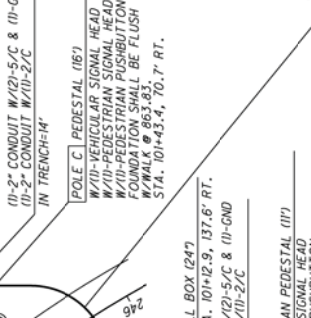
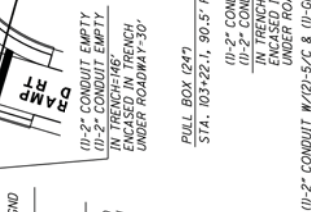
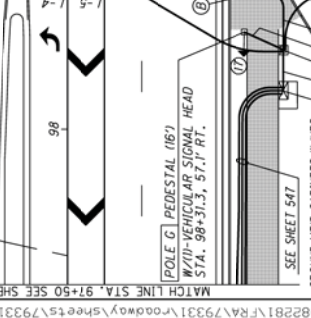
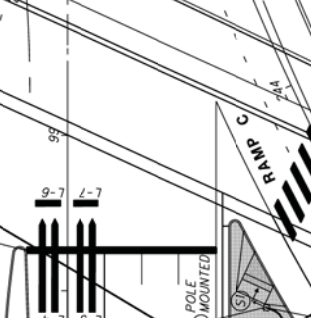
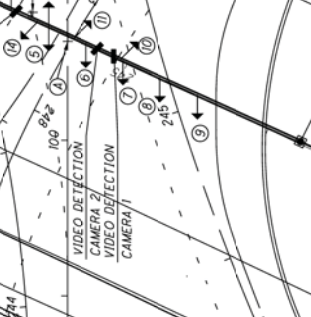
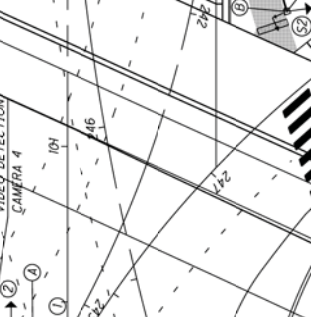
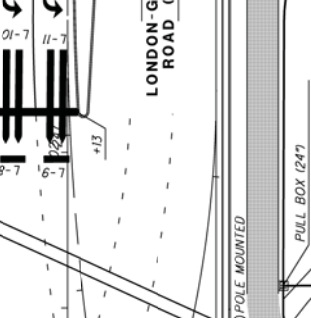
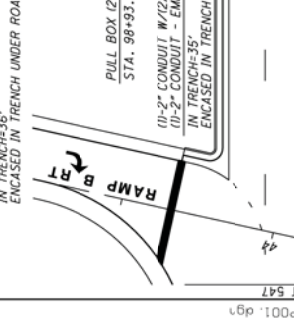
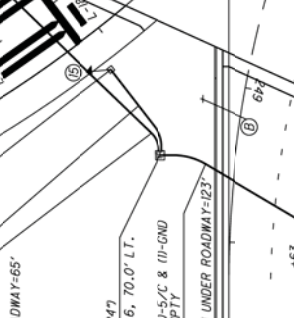
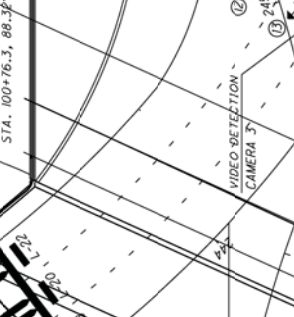
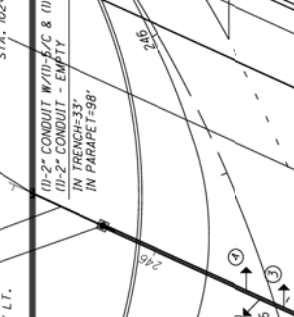
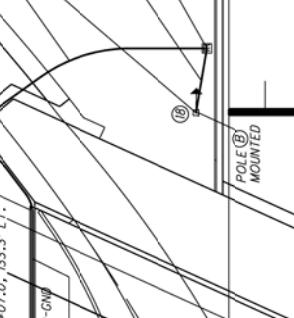
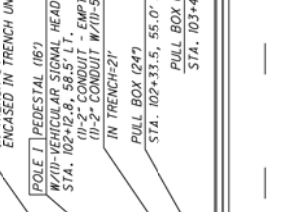
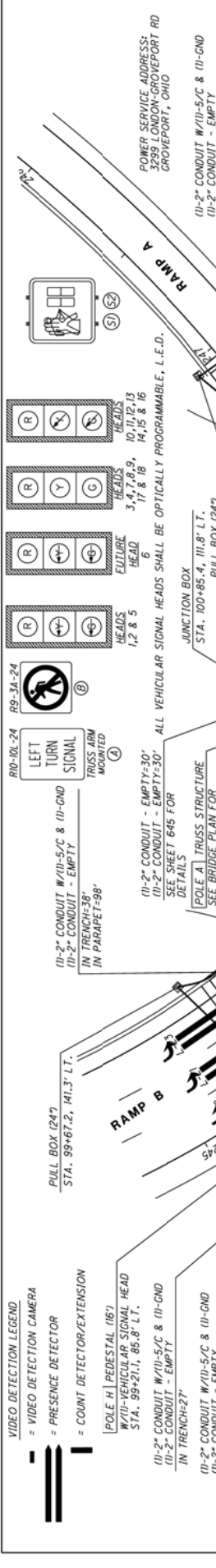

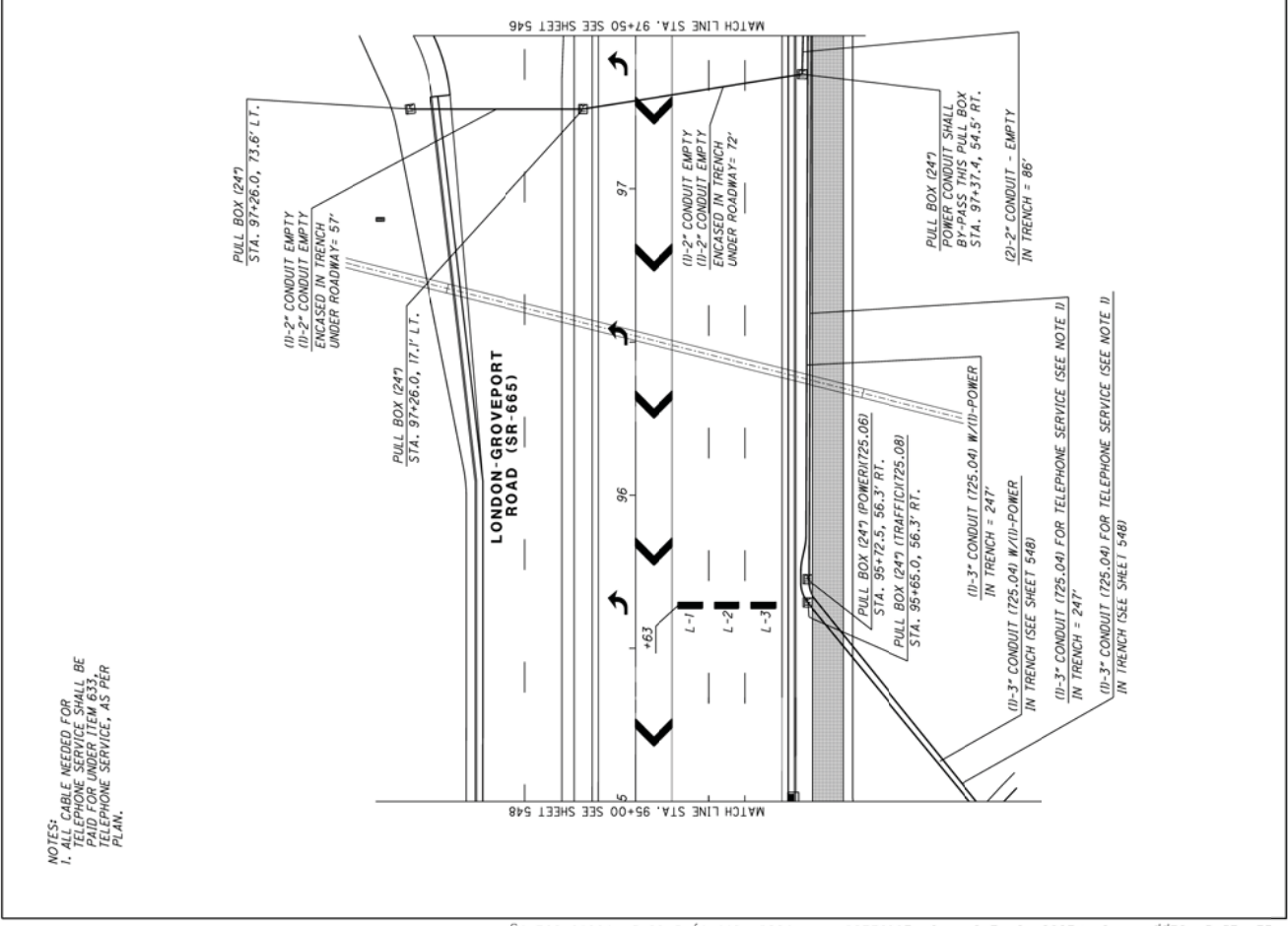
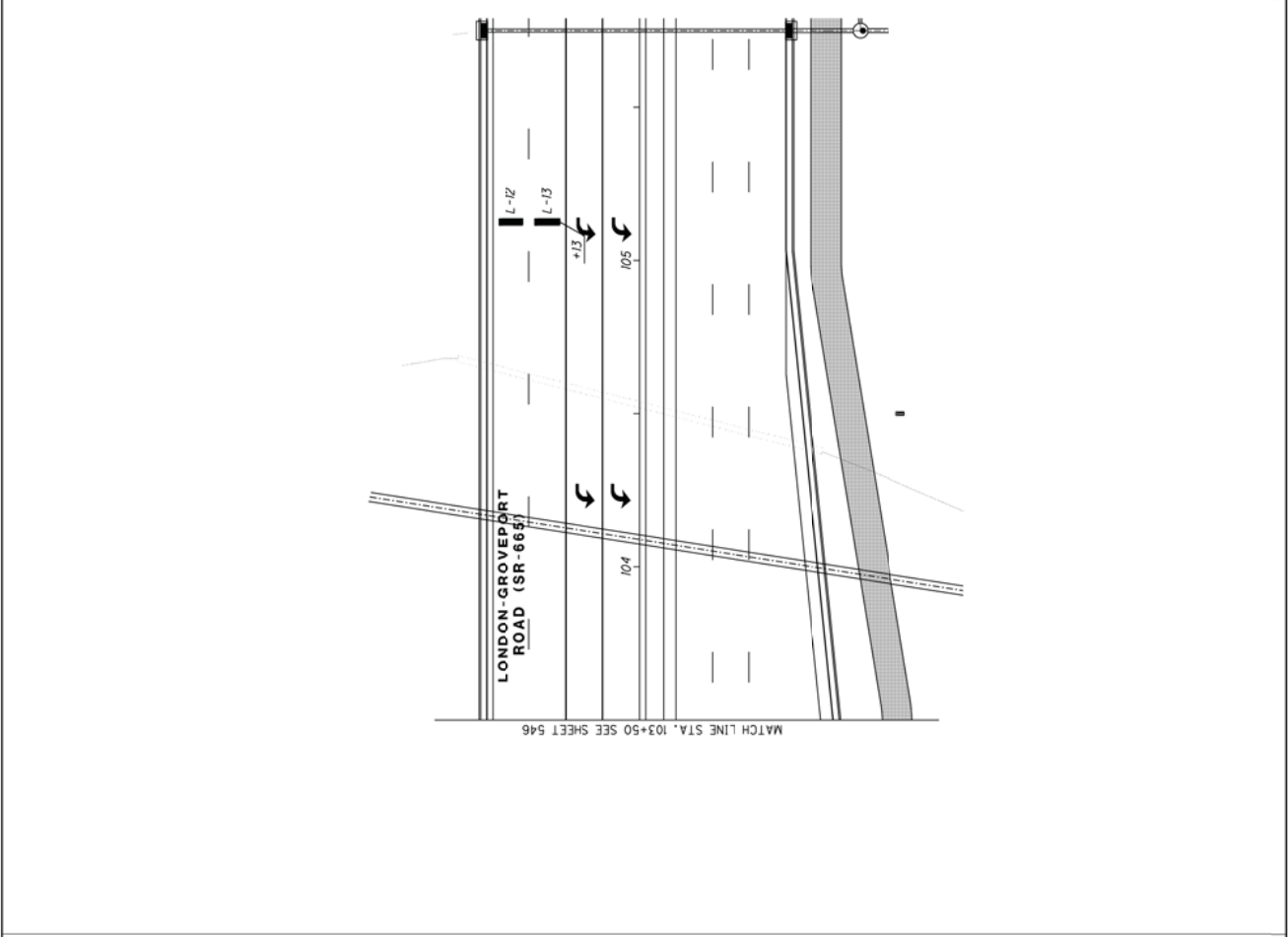

NOTES:
 1. ALL CABLE NEEDED FOR TRAFFIC SIGNAL SHALL BE PULLED UNDER ROADWAY AS PER TELEPHONE SERVICE, AS PER PLAN.

NOTES:
 1. ALL CABLE NEEDED FOR TELEPHONE SERVICE SHALL BE PAID FOR UNDER ITEM 833 TELEPHONE SERVICE, AS PER PLAN.

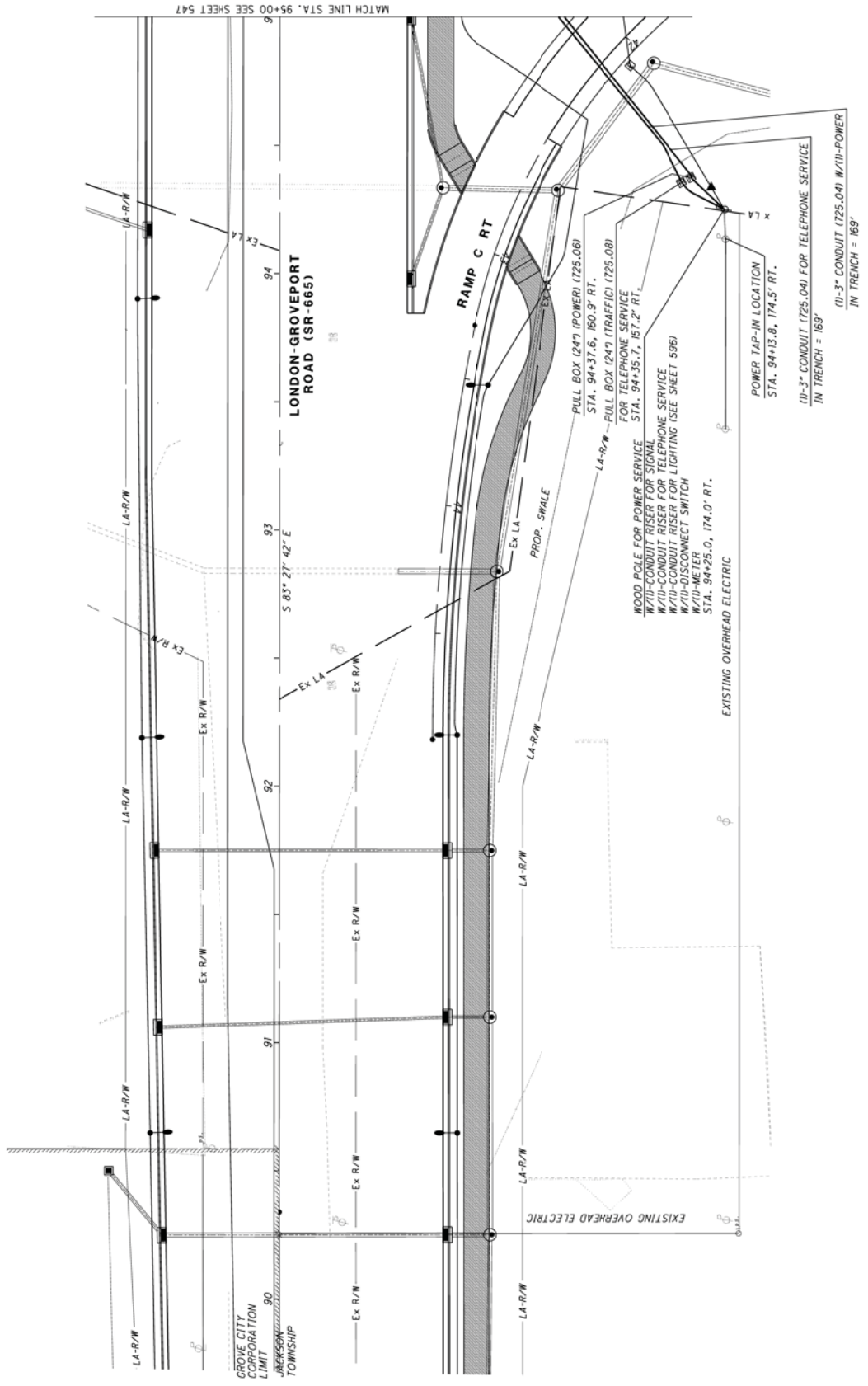

MATCH LINE STA. 95+00 SEE SHEET 547

LONDON-GROVEPORT ROAD (SR-665)

RAMP C RT

5.83° 27' 42" E

GROVE CITY CORPORATION LIMIT
 JERKSON TOWNSHIP

WOOD POLE FOR POWER SERVICE
 W/11-CONDUIT RISER FOR TELEPHONE SERVICE
 W/11-CONDUIT RISER FOR TELEPHONE SERVICE
 W/11-CONDUIT RISER FOR LIGHTING (SEE SHEET 596)
 W/11-DISCONNECT SWITCH
 W/11-METER
 STA. 94+25.0, 174.0' RT.

PULL BOX (247) (POWER) (725.06)
 STA. 94+37.6, 160.3' RT.
 PULL BOX (247) (TRAFFIC) (725.08)
 STA. 94+35.7, 157.2' RT.

POWER TAP-IN LOCATION
 STA. 94+13.8, 174.5' RT.
 (11-3" CONDUIT (725.04) FOR TELEPHONE SERVICE
 IN TRENCH = 169'
 (11-3" CONDUIT (725.04) W/11-POWER
 IN TRENCH = 169'

EXISTING OVERHEAD ELECTRIC

EXISTING OVERHEAD ELECTRIC

FIELD WIRING
HOOK-UP CHART

SIGNAL HEAD #	INDICATION	FIELD TERMINAL	FLASH
1,2 (NBLT)	R	φ5 R	R
	←	φ5 Y	R
	→	φ5 G	
3,4,18 (NB)	R	φ2 R	
	Y	φ2 Y	Y
	G	φ2 G	
5 (EBLT)	R	φ1 R	R
	←	φ1 Y	R
	→	φ1 G	
7,8,9,17 (EB)	R	φ6 R	
	Y	φ6 Y	Y
	G	φ6 G	
10,11,16 (NBLT)	R	φ3 R	R
	←	φ3 Y	R
	→	φ3 G	
12,13,14,15 (SBLT)	R	φ7 R	R
	←	φ7 Y	
	→	φ7 G	
⑤ & ⑥	WALK	G φ6-W	OFF
	DON'T WALK	R φ6-DW	OFF

TIMING CHART

PHASE	EBLT	NBLT	WBTL	FBTL	EB	SBLT	FUTURE	φ8
MOVEMENT	8	25	15	-	8	25	15	-
MIN. INITIAL	3.6	3.6	3.6	-	3.6	3.6	3.6	-
PASS TIME	45	45	45	-	45	45	45	-
MAX. GRN 1	45	45	45	-	45	45	45	-
MAX. GRN 2	45	45	45	-	45	45	45	-
YELLOW	4.3	4.3	3.6	-	4.3	4.3	3.6	-
RED CLR.	3.0	3.0	3.0	-	3.0	3.0	3.0	-
WALK	-	-	-	-	-	-	-	-
PED. CLR.	-	-	-	-	-	-	-	-
PED. RECALL	OFF	ON	OFF	-	OFF	ON	OFF	-
VEH. RECALL	OFF	ON	OFF	-	OFF	ON	OFF	-
MEMORY	NON-LOCK	LOCK	NON-LOCK	-	NON-LOCK	LOCK	NON-LOCK	-

DETECTOR CAMERA

DETECTOR CAMERA	SYMBOL	PHASE	SIZE	COUNT	PRESENCE	DIRECTIONALITY	DELAY
L-1, 2, 3	1	φ6	3'0" x 8'	X		DISABLED	0 SEC
L-4	1	φ1	2'0" x 2'		X	DISABLED	2 SEC
L-5	1	φ1	2'0" x 2'		X	DISABLED	2 SEC
L-6	1	φ1	2' x 8'		X	DISABLED	0 SEC
L-7	1	φ1	2' x 8'		X	DISABLED	0 SEC
L-8	4	φ5	2' x 8'		X	DISABLED	0 SEC
L-9	4	φ5	2' x 8'		X	DISABLED	0 SEC
L-10	4	φ5	2'0" x 2'		X	DISABLED	2 SEC
L-11	4	φ5	2'0" x 2'		X	DISABLED	2 SEC
L-12, 13	4	φ2	2'0" x 8'		X	DISABLED	0 SEC
L-14	2	φ3	2' x 8'		X	DISABLED	2 SEC
L-15	2	φ3	2'0" x 2'		X	DISABLED	2 SEC
L-16	2	φ3	2' x 8'		X	DISABLED	0 SEC
L-17	2	φ3	2'0" x 2'		X	DISABLED	2 SEC
L-18	3	φ7	2' x 8'		X	DISABLED	0 SEC
L-19	3	φ7	2'0" x 2'		X	DISABLED	0 SEC
L-20	3	φ7	2' x 8'		X	DISABLED	2 SEC
L-21	3	φ7	2'0" x 2'		X	DISABLED	0 SEC
L-22	3	φ7	2' x 8'		X	DISABLED	2 SEC
L-23	3	φ7	2'0" x 2'		X	DISABLED	2 SEC



VEHICLE DETECTOR DETAILS

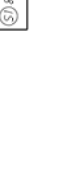

PHASE DIAGRAM



LEGEND

- SIGNAL CABLE #14 AWG
- NO. QUANTITY OF CONDUCTORS
- FUTURE SIGNAL CABLE/LOOP
- DISCONNECT SWITCH
- METER
- VEHICULAR SIGNAL HEAD
- PEDESTRIAN SIGNAL HEAD
- PEDESTRIAN PUSH BUTTON
- VIDEO DETECTION CABLE



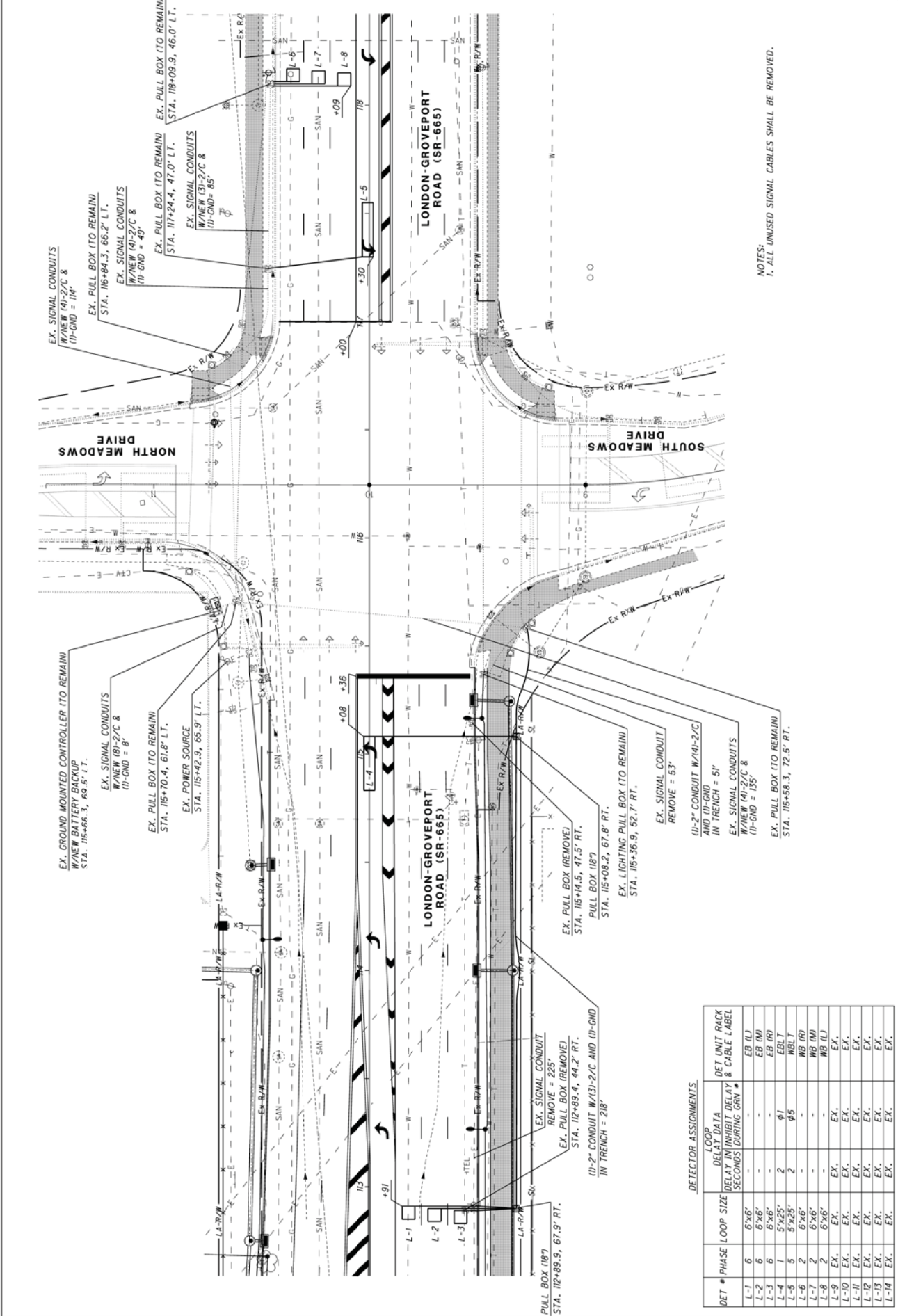

NOTES:
1. ALL UNUSED SIGNAL CABLES SHALL BE REMOVED.

DETECTOR ASSIGNMENTS.

DET #	PHASE	LOOP SIZE	LOOP DATA	DELAY IN INHIBIT DELAY SECONDS DURING GRN *	DET UNIT RACK DELAY & CABLE LABEL
L-1	6	6'x6'	-	-	EB (L)
L-2	6	6'x6'	-	-	EB (M)
L-3	6	6'x6'	-	-	EB (R)
L-4	1	5'x25'	φ1	EBLT	EBLT
L-5	5	5'x25'	2	φ5	WBLT
L-6	2	6'x6'	-	-	WB (R)
L-7	2	6'x6'	-	-	WB (M)
L-8	2	6'x6'	-	-	WB (L)
L-9	EX.	EX.	EX.	EX.	EX.
L-10	EX.	EX.	EX.	EX.	EX.
L-11	EX.	EX.	EX.	EX.	EX.
L-12	EX.	EX.	EX.	EX.	EX.
L-13	EX.	EX.	EX.	EX.	EX.
L-14	EX.	EX.	EX.	EX.	EX.