

FOR THE DIVISION OF FORESTRY

PUBLIC TREE IMPACT NOTE

ANY WORK ON OR WITHIN THE CRITICAL ROOT ZONE OF A PUBLIC TREE IS CONSIDERED AN IMPACT TO THE PUBLIC TREE. A PUBLIC TREE PLAN AND PERMIT FROM COLUMBUS RECREATION & PARKS FORESTRY IS REQUIRED FOR ANY PLAN WITH PUBLIC TREES IN THE WORK LIMITS. THE PUBLIC TREE PLAN SHALL DENOTE ALL PUBLIC TREES IN THE PROJECT'S WORK LIMITS. TREE INFORMATION SHALL CONFORM TO THE COLUMBUS TREE TECHNICAL MANUAL REQUIREMENTS AND BE PROVIDED BY A NATURAL RESOURCE PROFESSIONAL. FAILURE TO CONTACT THE CITY FORESTRY REPRESENTATIVE IN ADVANCE OF CONSTRUCTION WILL RESULT IN THE CONTRACTOR REIMBURSING FORESTRY FOR THE COST OF ANY AND ALL DAMAGE TO PUBLIC TREES.

PUBLIC TREE REMOVAL AND MITIGATION NOTE

NO PUBLIC TREE REMOVAL SHALL BE ATTEMPTED BY CONSTRUCTION PERSONNEL OR EQUIPMENT, ONLY UNDER THE SUPERVISION OF A CERTIFIED ARBORIST. ALL TREES REMOVED SHALL INCLUDE STUMP REMOVAL GROUND TO 18 INCHES; IF THE REMOVED TREE IS WITHIN 36" OF A PROTECTED TREE THE STUMP SHALL ONLY BE GROUND TO 2" DEPTH. ALL WOOD DEBRIS ON CITY OF COLUMBUS PROPERTY SHALL BE REMOVED AND DISPOSED OF BY THE CONTRACTOR BY THE END OF EACH WORK DAY. TREES APPROVED FOR REMOVAL BY CRPD FORESTRY SHALL BE MITIGATED IN ACCORDANCE WITH THE COLUMBUS TREE TECHNICAL MANUAL AND COLUMBUS CITY CODES CHAPTER 912.

FORESTRY PERMIT NOTE

ANY WORK ON OR WITHIN THE CRITICAL ROOT ZONE OF A PUBLIC TREE REQUIRES A FORESTRY PERMIT. ALL APPLICABLE FEES MUST BE PAID PRIOR TO PERMIT ISSUANCE. REFER TO THE CRPD TREE TECHNICAL MANUAL FOR TREE REMOVAL, PRUNING, PROTECTION, AND MITIGATION STANDARDS.

OAK WILT NOTE

TO PREVENT THE SPREAD OF OAK WILT, A FUNGAL DISEASE, OAK TREES SHALL ONLY BE PRUNED FROM NOVEMBER 1 TO MARCH 1.

FOR THE DIVISION OF PUBLIC UTILITIES

THIS PROJECT'S DISTURBANCE OF IMPERVIOUS AREA IS INTENDED TO BE TEMPORARY, AS THE DURATION OF THE DISTURBANCE IS INTENDED TO BE LESS THAN ONE YEAR. THEREFORE, THIS PROJECT SHALL NOT BE CONSIDERED APPLICABLE FOR FLOOD CONTROL REQUIREMENTS PER PAGE 5 OF THE STORMWATER DRAINAGE MANUAL.

CASTING ALLOWABLE TOLERANCE ON CITY OF COLUMBUS STREETS

FOR ALL MANHOLES, WATERVALVES, TRAFFIC AND INTERCONNECT PULL BOXES, ELECTRIC AND COMMUNICATION VAULTS, AND ANY OTHER UTILITY STRUCTURE IN THE ROADWAY OF CITY OF COLUMBUS STREETS AND ALLEYS WITHIN THE PAVING LIMITS OF THE PROJECT, THE MAXIMUM ALLOWABLE TOLERANCE IS MINUS 1/4 INCH BELOW THE FINISHED PAVEMENT SURFACE. THERE IS NO ALLOWABLE TOLERANCE ABOVE THE FINISHED PAVEMENT SURFACE. ALL PRIVATE UTILITY CASTINGS WILL BE ADJUSTED TO GRADE BY THE PRIVATE UTILITY COMPANY.

THE CONTRACTOR SHALL MAKE EVERY EFFORT TO INSTALL OR ADJUST CASTINGS TO BE WITHIN THIS TOLERANCE. IT IS ALSO THE RESPONSIBILITY OF THE CONTRACTOR TO NOTIFY THE ODOT PROJECT ENGINEER OF ANY CASTINGS THAT NEED TO BE ADJUSTED TO GRADE THAT WERE NOT PART OF THE PLAN QUANTITIES FOR NEW CONSTRUCTION OR ADJUSTMENT TO GRADE.

MEASUREMENT WILL BE BY PLACING A 10 FOOT STRAIGHTEDGE CENTERED OVER THE CENTER OF THE CASTING IN THE DIRECTION OF TRAFFIC, MEASURED TO VARIOUS POINTS ON THE TOP OF THE CASTING FRAME OF THE STRUCTURE. IF ANY MEASUREMENT EXCEEDS 1/4 INCH, THE CASTING WILL BE DEEMED OUT OF TOLERANCE AND ADJUSTED TO GRADE BY THE CONTRACTOR AT NO ADDITIONAL COST TO THE PROJECT.

THE ODOT PROJECT ENGINEER, ALONG WITH ATTENDANCE BY A REPRESENTATIVE OF THE CITY OF COLUMBUS, WILL CONDUCT THE MEASUREMENTS AFTER THE FINAL SURFACE COURSE IS PLACED.

TWO METHODS OF ADJUSTING CASTINGS TO GRADE WILL BE ACCEPTED:

1) SAWCUT THE PAVEMENT AROUND THE CASTING STRUCTURE IN A SQUARE SHAPE. SAWCUT LINE MUST BE AT LEAST 1 FOOT OUTSIDE OF THE OUTER DIAMETER OF THE CASTING. REMOVE PAVEMENT FULL DEPTH AROUND THE CASTING IN ORDER TO COMPLETELY REMOVE THE CASTING STRUCTURE, HEAVY DUTY VALVE BOX, OR OTHER TYPE OF UTILITY STRUCTURE. REMOVE AND CLEAN THE EXISTING FRAME, ADJUST THE HEIGHT OF THE SUPPORTING WALLS, AND RESET THE EXISTING FRAME IN A BED OF CONCRETE MORTAR OR STRUCTURE CONCRETE TO THE NEW GRADE. PLACE CONCRETE PAVEMENT AROUND THE STRUCTURE, HOLDING THE CONCRETE 2 INCHES BELOW THE FINISHED PAVMENT SURFACE. FOR PULLBOXES, MANHOLES AND CASTINGS GREATER THAN 30 INCHES, INCLUDE TWO #4 REBAR EVENLY SPACED ON ALL FOUR SIDES OF THE CASTING IN THE CONCRETE PAVEMENT. ONCE THE CONCRETE HAS PROPERLY CURED, PLACE TACK COAT AND SURFACE ASPHALT PAVEMENT NEATLY AROUND THE STRUCTURE AND SEAL THE JOINT WITH A HOT APPLIED JOINT SEALER PER CITY OF COLUMBUS CMSC ITEM 705.04

2) SAWCUT THE PAVEMENT AROUND THE CASTING STRUCTURE WITH A LARGER CIRCULAR CUTTING SAW. SAWCUT LINE MUST BE AT LEAST 1 FOOT OUTSIDE OF THE OUTER DIAMETER OF THE CASTING. REMOVE PAVEMENT FULL DEPTH AROUND THE CASTING IN ORDER TO COMPLETELY REMOVE THE CASTING STRUCTURE, HEAVY DUTY VALVE BOX, OR OTHER TYPE OF UTILITY STRUCTURE. REMOVE AND CLEAN THE EXISTING FRAME, ADJUST THE HEIGHT OF THE SUPPORTING WALLS, AND RESET THE EXISTING FRAME IN A BED OF CONCRETE MORTAR OR STRUCTURE CONCRETE TO THE NEW GRADE. PLACE CONCRETE PAVEMENT AROUND THE STRUCTURE FULL DEPTH NEATLY AROUND THE STRUCTURE AND UP TO THE FINISHED GRADE. FOR PULLBOXES, MANHOLES AND CASTINGS GREATER THAN 30 INCHES, INCLUDE TWO CIRCULAR RINGS OF #4 REBAR EVENLY SPACED IN THE CONCRETE PAVEMENT. SEAL JOINT WITH A HOT APPLIED JOINT SEALER PER CITY OF COLUMBUS CMSC ITEM 705.04

ALL CASTINGS BEING ADJUSTED TO GRADE WITH EITHER METHOD MUST BE PROPERLY COVERED WITH A STEEL PLATE DURING THE ADJUSTMENT WORK AND UNTIL THE CONCRETE MATERIAL USED IS PROPERLY CURED. FULL DEPTH IS DEFINED AS FROM THE TOP SURFACE OF THE SURFACE COURSE PAVEMENT TO THE BOTTOM OF THE PAVEMENT BASE MATERIAL. PRIVATE UTILITY COMPANY CASTINGS WILL BE ADJUSTED TO GRADE BY THE PRIVATE UTILITY, WITH NOTICE GIVEN BY THE ODOT PROJECT ENGINEER.

DESIGN AGENCY



DESIGNER
ACW

REVIEWER
TAZ 02/24/26

PROJECT ID
123987

SHEET TOTAL
P.13B | 122

SHEET NUMBER												PART.	ITEM	ITEM	GRAND	UNIT	DESCRIPTION	SEE SHEET NO.
OFFICE	P.17	P.41	P.42	P.43	P.44	P.109	P.110	P.111	P.112			01/SAF/03	EXT	TOTAL				
					22							22	611	07600	22	FT	DRAINAGE (CONT.)	
					1							1	611	98150	1	EACH	CATCH BASIN, NO. 3	
					5							5	611	98180	5	EACH	CATCH BASIN, NO. 3A	
					3							3	611	98410	3	EACH	CATCH BASIN, NO. 8	
					2							2	611	98430	2	EACH	CATCH BASIN, NO. 8 WITHOUT APRON	
					1							1	611	98800	1	EACH	INLET, NO. 3B	
					6							6	611	98820	6	EACH	INLET, NO. 3D	
					1							1	611	98821	1	EACH	INLET, NO. 3D, AS PER PLAN	P.13
					1							1	611	99660	1	EACH	MANHOLE RECONSTRUCTED TO GRADE	
					1							1	SPECIAL	69098000	1	EACH	12" CONDUIT, TYPE 1	P.12
					6							6	SPECIAL	69098100	6	FT	60" CURB INLET	P.12
																	PAVEMENT	
3,610	10,895	1,260										1,260	252	01500	1,260	FT	FULL DEPTH PAVEMENT SAWING	
461												14,505	254	01000	14,505	SY	PAVEMENT PLANING, ASPHALT CONCRETE, 1.50"	
649												461	254	01000	461	SY	PAVEMENT PLANING, ASPHALT CONCRETE, 3.25"	
3,043												649	254	01000	649	SY	PAVEMENT PLANING, ASPHALT CONCRETE, VARIABLE DEPTH	
												3,043	301	56000	3,043	CY	ASPHALT CONCRETE BASE, PG64-22, (449)	
1,641												1,641	304	20000	1,641	CY	AGGREGATE BASE	
2,177	981											3,158	407	20000	3,158	GAL	NON-TRACKING TACK COAT	
1,085												1,085	442	00100	1,085	CY	ANTI-SEGREGATION EQUIPMENT	
573	454											1,027	442	10000	1,027	CY	ASPHALT CONCRETE SURFACE COURSE, 12.5 MM, TYPE A (446)	
512												512	442	10080	512	CY	ASPHALT CONCRETE INTERMEDIATE COURSE, 12.5 MM, TYPE A (446)	
					1,374							1,374	609	24510	1,374	FT	CURB, TYPE 4-C	
					376							376	609	26000	376	FT	CURB, TYPE 6	
3,100												3,100	872	10000	3,100	FT	VOID REDUCING ASPHALT MEMBRANE (VRAM)	
																	WATER WORK	
					27							27	SPECIAL	63811602	27	FT	6" WATER MAIN DIP AND FITTINGS (COL 801)	P.13
					5							5	SPECIAL	63811604	5	FT	8" WATER MAIN DIP AND FITTINGS (COL 801)	P.13
					3							3	SPECIAL	63820500	3	EACH	VALVE BOX ADJUSTED TO GRADE (COL 807)	P.13
					2							2	SPECIAL	63820536	2	EACH	6" GATE VALVE (COL 802)	P.13
					1							1	SPECIAL	63820750	1	EACH	6" FIRE HYDRANT (COL 809)	P.13
					1							1	SPECIAL	63820758	1	EACH	FIRE HYDRANT ABANDONED (COL 809)	P.13
																	LIGHTING	
									8			8	625	00450	8	EACH	CONNECTION, FUSED PULL APART	
									8			8	625	00460	8	EACH	CONNECTION, UNFUSED PULL APART	
									10			10	625	00480	10	EACH	CONNECTION, UNFUSED PERMANENT	
									6			6	625	10490	6	EACH	LIGHT POLE, CONVENTIONAL, AT15B40	
									6			6	625	14100	6	EACH	LIGHT POLE FOUNDATION, 24" X 8' DEEP	
									402			402	625	23200	402	FT	NO. 4 AWG 2400 VOLT DISTRIBUTION CABLE	
									1,006			1,006	625	23400	1,006	FT	NO. 10 AWG POLE AND BRACKET CABLE	
									648			648	625	24100	648	FT	1-1/2" DUCT CABLE WITH TWO NO. 4 AWG 2400 VOLT CABLES	
									181			181	625	25500	181	FT	CONDUIT, 3", 725.04	
									6			6	625	26253	6	EACH	LUMINAIRE, CONVENTIONAL, SOLID STATE (LED), AS PER PLAN (IES-III, LED, 12,500-13,500 LUMENS)	P.110
									765			765	625	29002	765	FT	TRENCH, 24" DEEP	
									3			3	625	30700	3	EACH	PULL BOX, 725.08, 18"	
									2			2	625	31510	2	EACH	PULL BOX REMOVED	
									6			6	625	32000	6	EACH	GROUND ROD	
									765			765	625	36010	765	FT	UNDERGROUND WARNING/MARKING TAPE	
										LS		LS	SPECIAL	62540000	LS		MAINTAIN EXISTING LIGHTING	P.110
										1		1	SPECIAL	62540010	1	EACH	REPLACEMENT OF EXISTING LIGHTING UNIT	P.110
									8			8	625	75400	8	EACH	LIGHT POLE REMOVED	
									8			8	625	75500	8	EACH	LIGHT POLE FOUNDATION REMOVED	
									8			8	625	75506	8	EACH	LUMINAIRE REMOVED	
									4			4	625	75800	4	EACH	DISCONNECT CIRCUIT	
									2			2	625	98000	2	EACH	LIGHTING, MISC.: STREET LIGHT FOUNDATION, 6" (MIS-201)	P.108
									1			1	625	98000	1	EACH	LIGHTING, MISC.: ALUMINUM, 12' BRACKET, T-BASE, 30' MOUNTING HEIGHT (MIS-300)	P.108
									1			1	625	98000	1	EACH	LIGHTING, MISC.: ALUMINUM, 8' BRACKET, T-BASE, 30' MOUNTING HEIGHT (MIS-300)	P.108
									3			3	625	98000	3	EACH	LIGHTING, MISC.: POLE TO BE WIRED, 2-WIRE (MIS-500)	P.108

GENERAL SUMMARY

DESIGN AGENCY

 ms consultants, inc.
 DESIGNER
ACW
 REVIEWER
TAZ 11/30/25
 PROJECT ID
123987
 SHEET TOTAL
P.37 | 122

SHEET NUMBER											PART.	ITEM	ITEM	GRAND	UNIT	DESCRIPTION	SEE SHEET NO.
P.15	P.16	P.18	P.22	P.42	P.92	P.104	P.120				01/SAF/03	EXT	TOTAL				
					1,308						1,308	807	14410	1,308	FT	TRAFFIC CONTROL (CONT.)	
					1						1	814	00010	1	EACH	WET REFLECTIVE THERMOPLASTIC PAVEMENT MARKING, DOTTED LINE, 6"	
					1.43						1.43	850	10010	1.43	MILE	INTERSTATE ELONGATED ROUTE SHIELD SYMBOL MARKING, TYPE B125	
					1,308						1,308	850	10110	1,308	FT	GROOVING FOR 6" RECESSED PAVEMENT MARKING, (ASPHALT)	
					3,497						3,497	850	10130	3,497	FT	GROOVING FOR 6" RECESSED PAVEMENT MARKING, (ASPHALT)	
																TRAFFIC SIGNALS	
						4					4	625	32000	4	EACH	GROUND ROD	
						8					8	632	05006	8	EACH	VEHICULAR SIGNAL HEAD, (LED), 3-SECTION, 12" LENS, 1-WAY, POLYCARBONATE	
						8					8	632	25000	8	EACH	COVERING OF VEHICULAR SIGNAL HEAD	
						435					435	632	30300	435	FT	MESSENGER WIRE, 7 STRAND, 3/16" DIAMETER WITH ACCESSORIES	
						435					435	632	30600	435	FT	TETHER WIRE, WITH ACCESSORIES	
						478					478	632	40700	478	FT	SIGNAL CABLE, 7 CONDUCTOR, NO. 14 AWG	
					42						42	632	62810	42	FT	INTERCONNECT CABLE, MISC.: CAT 5E CABLE, OUTDOOR RATED	P.103
					1						1	632	62820	1	EACH	INTERCONNECT, MISC.: SPREAD SPECTRUM RADIO ASSEMBLY RELOCATED	P.103
					4						4	632	64000	4	EACH	STRAIN POLE FOUNDATION, AS PER PLAN, 20' DEEP	P.103
						4					4	632	83600	4	EACH	STRAIN POLE, MISC.:TYPE 4170, DESIGN 11	P.103
						1					1	632	90100	1	EACH	REMOVAL OF TRAFFIC SIGNAL INSTALLATION	
						1					1	632	90400	1	EACH	SIGNALIZATION, MISC.:FOUNDATION PRE-EXCAVATION	P.103
						1					1	632	90400	1	EACH	SIGNALIZATION, MISC.:STOP LINE RADAR DETECTION	P.103
																RETAINING WALLS	
						LS					LS	503	21300	LS		UNCLASSIFIED EXCAVATION	
						LS					LS	505	11100	LS		PILE DRIVING EQUIPMENT MOBILIZATION	
						1,770					1,770	507	00200	1,770	FT	STEEL PILES HP12X53, FURNISHED	
						960					960	507	92200	960	FT	PREBORED HOLES	
						8,550					8,550	509	10000	8,550	LB	EPOXY COATED STEEL REINFORCEMENT	
							28				28	511	71100	28	CY	CONCRETE, MISC.: 8"x 24"x 69" PRECAST CONCRETE LAGGING	P.118
							25				25	511	71100	25	CY	CONCRETE, MISC.: 8"x 36"x 69" PRECAST CONCRETE LAGGING	P.118
							1				1	511	71100	1	CY	CONCRETE, MISC.: 8"x 24"x 117" PRECAST CONCRETE LAGGING	P.118
							3				3	511	71100	3	CY	CONCRETE, MISC.: 8"x 36"x 117" PRECAST CONCRETE LAGGING	P.118
							219				219	518	21200	219	CY	POROUS BACKFILL WITH GEOTEXTILE FABRIC	
																MISCELLANEOUS STRUCTURE	
					1,638						1,638	512	10000	1,638	SY	SEALING OF CONCRETE SURFACES	
																MAINTENANCE OF TRAFFIC	
											1	SPECIAL	61411300	1	EACH	WORK ZONE TRAFFIC SIGNAL	P.20
											136	614	11110	136	HOUR	LAW ENFORCEMENT OFFICER WITH PATROL CAR FOR ASSISTANCE	
											2,704	614	11630	2,704	FT	INCREASED BARRIER DELINEATION	
											3	614	12380	3	EACH	WORK ZONE IMPACT ATTENUATOR, 24" WIDE HAZARDS, (UNIDIRECTIONAL)	
LS											LS	614	12420	LS		DETOUR SIGNING	
											536	614	12801	536	EACH	WORK ZONE RAISED PAVEMENT MARKER, AS PER PLAN	P.17
											26	614	13310	26	EACH	BARRIER REFLECTOR, TYPE 1, ONE WAY	
											20	614	13312	20	EACH	BARRIER REFLECTOR, TYPE 2, ONE WAY	
											90	614	13350	90	EACH	OBJECT MARKER, ONE WAY	
											28	614	18601	28	SNMT	PORTABLE CHANGEABLE MESSAGE SIGN, AS PER PLAN	P.16
											0.19	614	20010	0.19	MILE	WORK ZONE LANE LINE, CLASS I, 6"	
											0.17	614	21000	0.17	MILE	WORK ZONE CENTER LINE, CLASS I	
											0.25	614	22010	0.25	MILE	WORK ZONE EDGE LINE, CLASS I, 6"	
											1.22	614	22056	1.22	MILE	WORK ZONE EDGE LINE, CLASS I, 6", 807 PAINT	
											6,857	614	23110	6,857	FT	WORK ZONE CHANNELIZING LINE, CLASS I, 12", 807 PAINT	
											74	614	24000	74	FT	WORK ZONE DOTTED LINE, CLASS I	
											268	614	25000	268	FT	WORK ZONE TRANSVERSE/DIAGONAL LINE, CLASS I	
											81	614	26000	81	FT	WORK ZONE STOP LINE, CLASS I	
											87	614	28000	87	FT	WORK ZONE GORE MARKING, CLASS II	
											22	614	30000	22	EACH	WORK ZONE ARROW, CLASS I	
											81	615	20000	81	SY	PAVEMENT FOR MAINTAINING TRAFFIC, CLASS A	
53											53	616	10000	53	MGAL	WATER	
											2,600	622	41100	2,600	FT	PORTABLE BARRIER, UNANCHORED	

GENERAL SUMMARY

DESIGN AGENCY

 ms consultants - inc.
 DESIGNER
 ACW
 REVIEWER
 TAZ 11/30/25
 PROJECT ID
 123987
 SHEET TOTAL
 P.39 | 122

ITEM 630 SIGNING, MISC.: TRAFFIC SIGNAL SIGNS

WHEN USED, THE CONTRACTOR SHALL INSTALL W3-3-36 "SIGNAL AHEAD" SIGNS WITH W16-15P-24 "NEW" SUPPLEMENTAL PLACARDS AND POSTS IF REQUIRED JUST PRIOR TO THE SIGNAL BEING PLACED ON FLASH. THE "NEW SIGNAL" AND "SIGNAL AHEAD" SIGNS SHALL BE COVERED UNTIL THE SIGNAL IS PLACED ON REGULAR OPERATION AT WHICH TIME THE CONTRACTOR SHALL UNCOVER THEM.

WHEN USED, THE CONTRACTOR SHALL INSTALL THE W23-H2B-30 "SIGNAL OPERATION CHANGED" SIGN JUST PRIOR TO ACTIVATING THE CHANGE IN SIGNAL OPERATION. THE "SIGNAL OPERATION CHANGED" SIGN SHALL BE COVERED UNTIL THE SIGNAL OPERATION CHANGE IS IN EFFECT AT WHICH TIME THE CONTRACTOR SHALL UNCOVER IT. IN ORDER TO INSTALL THE "SIGNAL OPERATION CHANGED" SIGN AS SHOWN IN THE PLANS, THE CONTRACTOR SHALL SHIFT AN ADJACENT PERMANENT SIGN, WHEN NECESSARY, TO CREATE ENOUGH SPACE TO INSTALL THE "SIGNAL OPERATION CHANGED" SIGN IN THE LOCATION SHOWN IN THE PLANS.

THE CONTRACTOR SHALL REMOVE THESE ITEMS 3 WEEKS AFTER THEY ARE UNCOVERED. AT THE SAME TIME, THE CONTRACTOR SHALL RETURN ANY PERMANENT SIGN, WHICH HAS BEEN TEMPORARILY SHIFTED IN ORDER TO ACCOMMODATE THE "SIGNAL OPERATION CHANGED" SIGN, TO THE LOCATION SPECIFIED IN THE PLANS. FAILURE TO REMOVE THESE ITEMS AND RELOCATE PERMANENT SIGNS SHALL RESULT IN THE CITY REMOVING THEM, ALONG WITH RELOCATING PERMANENT SIGNS, AND BILLING THE CONTRACTOR FOR ALL COSTS INVOLVED. ALL REMOVED MATERIAL SHALL BE CONSIDERED FORFEITED TO THE CITY.

MOUNTING HARDWARE AND POSTS SHALL BE INCIDENTAL TO THIS BID ITEM.

PAYMENT SHALL BE PER THE UNIT PRICE BID TO INSTALL AND REMOVE ALL NECESSARY SIGNS AT EACH INTERSECTION. 11/5/15

ITEM 632 SIGNALIZATION, MISC.: FOUNDATION PRE-EXCAVATION

THE SIGNAL SUPPORT FOUNDATION FOR MAIN ST. S/W-1 SHALL BE EXCAVATED OR VACUUM EXCAVATED TO TEST FOR CONFLICTS PRIOR TO SHOP DRAWINGS APPROVAL.

PAYMENT FOR ITEM 632 SIGNALIZATION, MISC.: FOUNDATION PRE-EXCAVATION SHALL BE MADE AT THE CONTRACT UNIT PRICE FOR EACH FOUNDATION REQUIRING PRE-EXCAVATION. 3/16/18

ITEM 632 INTERCONNECT CABLE, MISC.: CAT 5E CABLE, OUTDOOR RATED

THE CONTRACTOR SHALL INSTALL OUTDOOR RATED CATEGORY 5E CABLE FOR ALL OUTDOOR APPLICATIONS SUSCEPTIBLE TO WATER OR MOISTURE PENETRATION. OUTDOOR RATED CATEGORY 5E CABLE SHALL BE USED TO PROVIDE INTERCONNECTION BETWEEN THE ETHERNET SWITCHES, ITS DEVICES, AND NETWORK INTERFACES AS SHOWN ON THE PLANS.

THE SPECIFICATIONS FOR THE OUTDOOR RATED CATEGORY 5E CABLES SHALL MEET THE FOLLOWING SPECIFICATIONS:

- DOUBLE SHIELD
- ALUMINUM ARMORED
- BARE (AKA PURE) COPPER CONDUCTORS
- CM PVC JACKET
- BLACK COLOR
- 24 AWG
- SOLID CONDUCTOR
- TIA/EIA-568A,ISO/IEC11801,YD/T1019-2001

ALL COMPLETE CABLES (INCLUDING CABLE AND CONNECTORS) SHALL BE CAT 5E CERTIFIED AND TESTED. THE CONTRACTOR SHALL TEST AND CERTIFY EACH CAT 5E CABLE (EXCLUDING PATCH CABLES 10 FEET OR LESS).

ALL CABLING SHALL BE CUT TO PROPER LENGTH BEFORE ASSEMBLY. CABLES SHALL BE NEATLY LASHED TO THE MESSENGER WIRE CABLE WHERE SHOWN IN THE PLANS.

OUTDOOR RATED CATEGORY 5E CABLE WILL BE MEASURED TO THE CABINET, OR DEVICE, PLUS AN ALLOWANCE OF FIVE (5) FEET ON EACH END.

OUTDOOR RATED CATEGORY 5E CABLE WILL BE PAID FOR PER LINEAR FOOT, AND WILL INCLUDE FURNISHING ALL MATERIALS, EQUIPMENT, LABOR AND INCIDENTALS NECESSARY TO COMPLETE THE WORK SPECIFIED. 3/4/16

ITEM 632 INTERCONNECT, MISC.:SPREAD SPECTRUM RADIO ASSEMBLY RELOCATED

THIS ITEM OF WORK SHALL CONSIST OF RELOCATING THE EXISTING EAST FACING SPREAD SPECTRUM RADIO ASSEMBLY FROM THE EXISTING TRAFFIC SIGNAL POLE TO THE PROPOSED TRAFFIC SIGNAL POLE AS SHOWN ON THE PLAN. THE CONTRACTOR SHALL RELOCATE THE EXISTING EAST FACING SPREAD SPECTRUM RADIO, MOUNTING HARDWARE, AND ANY OTHER MISCELLANEOUS ITEMS ASSOCIATED WITH RADIO ASSEMBLY NOT REQUIRED TO MAINTAIN THE WEST FACING RADIO ON THE EXISTING POLE.

PRIOR TO RELOCATION, THE CONTRACTOR AND THE ENGINEER SHALL INSPECT THE EQUIPMENT AND DOCUMENT ANY EXISTING DAMAGE. ANY DAMAGE IDENTIFIED AFTER THE RELOCATION PROCESS AND NOT PREVIOUSLY DOCUMENTED WILL BE PRESUMED TO HAVE BEEN CAUSED BY THE CONTRACTOR. ANY DAMAGED EQUIPMENT WILL BE REPAIRED OR REPLACED AS DIRECTED BY THE ENGINEER AT THE CONTRACTOR'S EXPENSE.

THE CONTRACTOR SHALL BE RESPONSIBLE FOR PROVIDING A COMPLETE, FUNCTIONAL SYSTEM INCLUDING ALL APPURTENANCES NECESSARY TO ATTACH THE RADIOS ASSEMBLY TO THE PROPOSED POLE.

THE WORK AS DESCRIBED WILL BE MEASURED AS ONE UNIT FOR EACH SPECIFIED RADIO ASSEMBLY TO BE RELOCATED AND SHALL INCLUDE ALL MATERIALS, EQUIPMENT, AND INCIDENTALS, COMPLETE IN PLACE. MOUNTING HARDWARE, EXTENSION POLES, AND OTHER MISCELLANEOUS ITEMS AND MATERIALS SHALL BE CONSIDERED INCIDENTAL TO THIS WORK AND NO SEPARATE PAYMENT WILL BE MADE.

ITEM 632 SIGNALIZATION, MISC.: STOP LINE RADAR DETECTION SYSTEM

THIS ITEM OF WORK SHALL CONSIST OF FURNISHING AND INSTALLING A STOP LINE RADAR DETECTION SYSTEM. EACH RADAR DETECTOR UNIT SHALL BE MOUNTED DIRECTLY TO A POLE, MAST ARM, OR BRACKET ARM AS SHOWN ON THE PLAN OR AS RECOMMENDED BY THE MANUFACTURER. MOUNTING HARDWARE AND CABLE CONNECTIONS SHALL BE INSTALLED PER CURRENT MANUFACTURER SPECIFICATIONS. THE SENSOR SHALL BE GROUNDED TO THE GROUND LUG OF THE SIGNAL POLE PER CURRENT MANUFACTURER SPECIFICATIONS.

THE DETECTION SYSTEM SHALL INCLUDE THE FOLLOWING:

1. RADAR DETECTOR UNITS APPROVED THROUGH THE OHIO DEPARTMENT OF TRANSPORTATION'S TRAFFIC AUTHORIZED PRODUCTS LIST AND AS SHOWN IN THE PLANS.
2. SHELF-MOUNTED CABINET INTERFACE DEVICE WITH FOUR (4) RADAR UNIT CABLE INPUTS, COMPATIBLE WITH ITEM 1 IN THIS NOTE, TO PROVIDE POWER, SURGE PROTECTION, AND ETHERNET CONNECTIVITY FOR THE RADAR DETECTOR UNITS.
3. CONTACT CLOSURE DEVICES IF NECESSARY OR AS RECOMMENDED BY THE MANUFACTURER TO CONNECT TO THE TRAFFIC CONTROLLER AND BE COMPATIBLE WITH CITY OF COLUMBUS SIGNAL CABINETS. IF USED, THE DEVICES SHALL BE SECURED TO A SINGLE PANEL THAT CAN BE MOUNTED INTERIOR TO THE TRAFFIC SIGNAL CABINET.
4. SENSOR CABLE(S) SHALL BE PROVIDED AS REQUIRED AND AS RECOMMENDED BY THE MANUFACTURER. THE CABLE SHALL BE SUITABLE FOR INSTALLATION IN CONDUIT AND OVERHEAD WITH APPROPRIATE SPAN WIRE. THE DETECTOR CABLE SHALL BE RUN CONTINUOUSLY FROM THE DETECTOR UNIT TO THE CONTROLLER CABINET (NO SPLICES).
5. AN ETHERNET CABLE (MINIMUM 7 FEET).

A CITY SIGNAL MAINTENANCE REPRESENTATIVE SHALL BE ON SITE DURING INSTALLATION AND TESTING OF THE UNIT.

PAYMENT FOR ITEM 632 SIGNALIZATION, MISC.: STOP LINE RADAR DETECTION SYSTEM SHALL BE MADE AT THE CONTRACT UNIT PRICE FOR EACH SYSTEM, COMPLETE AND IN PLACE INCLUDING ALL REQUIRED DETECTOR UNITS, CABINET HARDWARE, MOUNTING BRACKETS, CABLES, AND CONNECTIONS TESTED AND ACCEPTED. 6/8/18

TRAFFIC CONDUIT CONTROLLER CABINET DAMAGE

THE EXISTING TRAFFIC SIGNAL CONTROLLER CABINET AND CONDUITS SHALL NOT BE DISTURBED. CAUTION SHALL BE USED TO AVOID DAMAGING THE EXISTING CABINET, CABINET FOUNDATION, CONDUITS, AND CABLES CONTAINED WITHIN.

THE CONTRACTOR SHALL BE RESPONSIBLE FOR THE REPAIR OR REPLACEMENT OF THE ABOVE ITEMS IN THE EVENT THAT THEY ARE DAMAGED, AS DETERMINED BY THE CITY OF COLUMBUS DIVISION OF TRAFFIC MANAGEMENT. IF FULL CABINET REPLACEMENT IS NECESSARY AS A RESULT OF THE DAMAGE, DETAILED PLANS FOR THE CABINET WILL BE REQUIRED AND WILL BE PROVIDED AT THE CONTRACTOR'S EXPENSE.

THE CONTRACTOR SHALL BE RESPONSIBLE FOR ANY REPAIRS RESULTING FROM EXCAVATION IN WHICH THE SOIL SURROUNDING THE CABINET BECOMES COMPROMISED CAUSING THE CABINET TO LEAN OR SHIFT FROM ITS ORIGINAL LOCATION AS DETERMINED BY THE CITY OF COLUMBUS DIVISION OF TRAFFIC MANAGEMENT.

IN THE EVENT THAT DAMAGE CAUSES THE TRAFFIC SIGNAL TO BECOME NON-OPERATIONAL, A LAW ENFORCEMENT OFFICER SHALL BE USED AT THE CONTRACTOR'S EXPENSE TO DIRECT TRAFFIC AT THE SIGNAL UNTIL THE SIGNAL IS RETURNED TO FULL OPERATION. 3/3/17

ITEM 632 STRAIN POLE FOUNDATION, AS PER PLAN, (BY DEPTH)

FOR SIGNAL POLES MOUNTED TO DEEP FOUNDATIONS CONSTRUCTED UNDER THIS ITEM, THE ALUMINUM POLE IDENTIFICATION TAG, AS REQUIRED AND IN ACCORDANCE WITH 732.11 AND 732.12, SHALL ALSO BE LABELED WITH "DEEP FOUNDATION" FOLLOWED BY THE DEPTH OF THE FOUNDATION (E.G. DEEP FOUNDATION, 18 FT). THE FOUNDATION SHALL BE CONSTRUCTED IN ACCORDANCE WITH 632.14, SCD 4160, AND SCD 4161. 5/15/18

ITEM 632 STRAIN POLE, MISC.: TYPE 4170, (BY DESIGN)

THIS ITEM OF WORK SHALL COMPLY WITH CITY OF COLUMBUS STANDARD CONSTRUCTION DRAWING 4170 AND CMSC REQUIREMENTS OF 732.11 AND 732.12.

THIS ITEM OF WORK SHALL BE MEASURED AS EACH COMPLETE SIGNAL SUPPORT OR STRAIN POLE IN PLACE IN ESSENTIALLY A VERTICAL POSITION UNDER FULL PLAN LOADING. ALL LABOR, EQUIPMENT, AND MATERIALS NECESSARY TO PURCHASE, TRANSPORT, STORE, ERECT, ADJUST, AND REPAIR THE SIGNAL SUPPORT OR STRAIN POLE SHALL BE INCLUDED FOR PAYMENT IN THE BID ITEM. PAYMENT SHALL BE AS PER ITEM 632.

DESIGN AGENCY



DESIGNER
CLM

REVIEWER
KWR 11/12/25

PROJECT ID
123987

SHEET TOTAL
P.103 122

REF NO.	SHEET NO.	STATION TO STATION	625	630	630	630	630	632	632	632	632	632	632	632	632	632	632	632	632	632
			GROUND ROD	SIGN HANGER ASSEMBLY, SPAN WIRE	SIGN SUPPORT ASSEMBLY, POLE MOUNTED	SIGN, FLAT SHEET	SIGNING, MISC.:TRAFFIC SIGNAL SIGNS	COVERING OF VEHICULAR SIGNAL HEAD	MESSENGER WIRE, 7 STRAND, 7/16" DIAMETER WITH ACCESSORIES	TETHER WIRE, WITH ACCESSORIES	SIGNAL CABLE, 7 CONDUCTOR, NO. 14 AWG	VEHICULAR SIGNAL HEAD, (LED), 3-SECTION, 12" LENS, 1-WAY, POLYCARBONATE	INTERCONNECT CABLE, MISC.:CAT 5E CABLE, OUTDOOR RATED	INTERCONNECT, MISC.:SPREAD SPECTRUM RADIO ASSEMBLY RELOCATED	STRAIN POLE FOUNDATION, AS PER PLAN, 20' DEEP	STRAIN POLE, MISC.:TYPE 4170, DESIGN 11	REMOVAL OF TRAFFIC SIGNAL INSTALLATION	SIGNALIZATION, MISC.:FOUNDATION PRE-EXCAVATION	SIGNALIZATION, MISC.:STOP LINE RADAR DETECTION	
EACH	EACH	EACH	SF	EACH	EACH	FT	FT	FT	EACH	FT	EACH	EACH	EACH	EACH	EACH	EACH	EACH	EACH	EACH	EACH
P.105		MAIN ST. INTERSECTION	4	3	1	25	1	8	435	435	478	8	42	1	4	4	1	1	1	
TOTALS CARRIED TO GENERAL SUMMARY			4	3	1	25	1	8	435	435	478	8	42	1	4	4	1	1	1	

TRAFFIC SIGNAL
SUB-SUMMARY

DESIGN AGENCY

 ms consultants, inc.
 DESIGNER
 CLM
 REVIEWER
 JML 11/12/25
 PROJECT ID
 123987
 SHEET TOTAL
 P.104 122

TRAFFIC SIGNAL INSTALLATION REMOVAL CHART

ALL EXISTING SIGNAL ITEMS NOT LISTED IN THE REMOVAL CHART ARE EXISTING TO REMAIN

QUANTITY	REMOVED ITEM DESCRIPTION	DISPOSED OF BY PROJECT	RELOCATED BY THE PROJECT
LUMP	SIGNAL CABLE, CONDUIT & MESSENGER WIRE	X	
2	VEHICULAR SIGNAL HEAD, 1-WAY	X	
2	VEHICULAR SIGNAL HEAD, 2-WAY	X	
2	SPAN MTD. SIGN	X	
1	EMBEDDED SIGNAL POLE	X	
1	POLE FOUNDATION	X	
1	SPREAD SPECTRUM RADIO ASSEMBLY		X

EX. PEDESTAL (TO REMAIN)
W/(1) - EX. PEDESTRIAN SIGNAL HEAD (TO REMAIN)
STA. 28+84.4, 52.2' LT.

EX. CONDUIT (DO NOT DISTURB)
W/- EX. SIGNAL CABLE (TO REMAIN)

POLE N/W-1 STRAIN POLE
W/(1) - DEEP FOUNDATION (20')
W/(1) - EX. WIRELESS ETHERNET RADIO - EAST (RELOCATED)
STA. 28+61.7, 44.8' LT.

MESSENGER WIRE W/ (3)-7/C, (1)-CAT5E, & (1)-RADAR AERIAL = 9'

EX. STRAIN POLE (TO REMAIN)
W/(1) - EX. POLE MOUNTED CABINET AND CONTROLLER (TO REMAIN)
W/(1) - EX. WIRELESS ETHERNET RADIO - WEST (TO REMAIN)
STA. 28+52.3, 44.9' LT.

EX. POLE (TO REMAIN)
W/(1) - EX. BRACKET ARM WITH LUMINIARE (TO REMAIN)
W/(1) - EX. TRAFFIC FLOW MONITOR (TO REMAIN)
STA. 28+54.3, 36.6' LT.

EX. SIGNAL CABLE (DND)

EX. POLE (TO REMAIN)
W/(1) - EX. BRACKET ARM WITH LUMINIARE (TO REMAIN)
W/(1) - EX. PEDESTRIAN SIGNAL HEAD (TO REMAIN)
STA. 29+33.4, 38.6' LT.

POLE N/E-1 STRAIN POLE
W/(1) - DEEP FOUNDATION (20')
STA. 29+77.3, 55.8' LT.

- NOTES:**
1. CENTER ALL LOOPS OR DETECTION ZONES IN THE CENTER OF THEIR LANE, UNLESS SPECIFIED OTHERWISE. INSTALL LOOPS AFTER THE ASPHALT SURFACE COURSE IS LAID.
 2. DO NOT ENCASE THE GROUND ROD, THE GROUNDING WIRE, OR THE CONDUIT ENDS IN CONCRETE THAT FALL OUTSIDE OF THE FOUNDATION. FULL ACCESS TO THESE ITEMS MUST BE MAINTAINED AT ALL TIMES. PERMANENTLY MARK THE TOP OF FOUNDATION CONCRETE, WITH A MARKER OR SYMBOL SO THE ROD LOCATION CAN BE IDENTIFIED BY OTHERS.
 3. THE CONTRACTOR SHALL NOT INSTALL POLE FOUNDATIONS UNTIL THE POLE LOCATION AREA IS AT FINISHED GRADE.
 4. EXPANSION MATERIAL SHALL BE USED BETWEEN ALL FOUNDATIONS AND ADJACENT SIDEWALKS.
 5. N/A.
 6. N/A.
 7. N/A.
 8. N/A.
 9. TAGGING OF CABLE IN THE PULL BOX IMMEDIATELY ADJACENT TO THE CONTROLLER CABINET IS NOT REQUIRED EXCEPT FOR TAGGING OF CERTAIN CABLE AS DIRECTED BY THE PROJECT ENGINEER, OR AS PER PLAN.
 10. ALL CABLES, UNLESS SPECIFIED IN THE PLANS, ARE TO BE ROUTED INSIDE THE ANCHOR BASE SIGNAL SUPPORT POLE OR PEDESTAL. CABLES NOT SERVING A GIVEN POLE OR PEDESTAL SHALL NOT BE ROUTED THROUGH THE POLE.
 11. N/A.
 12. N/A.
 13. ALL CLAMPS AND BANDING MATERIAL SHALL BE PAINTED TO MATCH THE SIGNAL SUPPORTS.

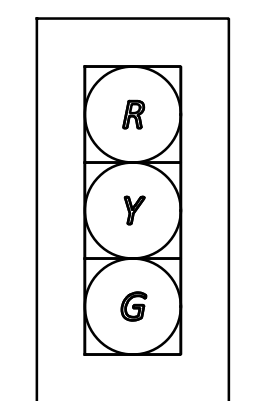
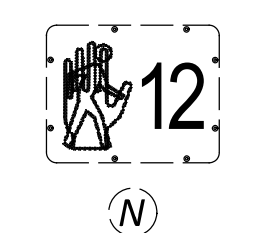
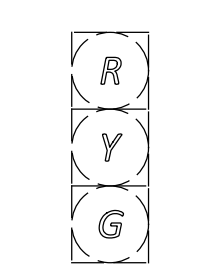
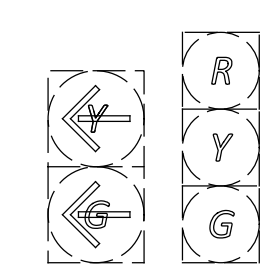
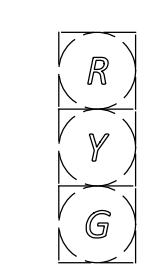
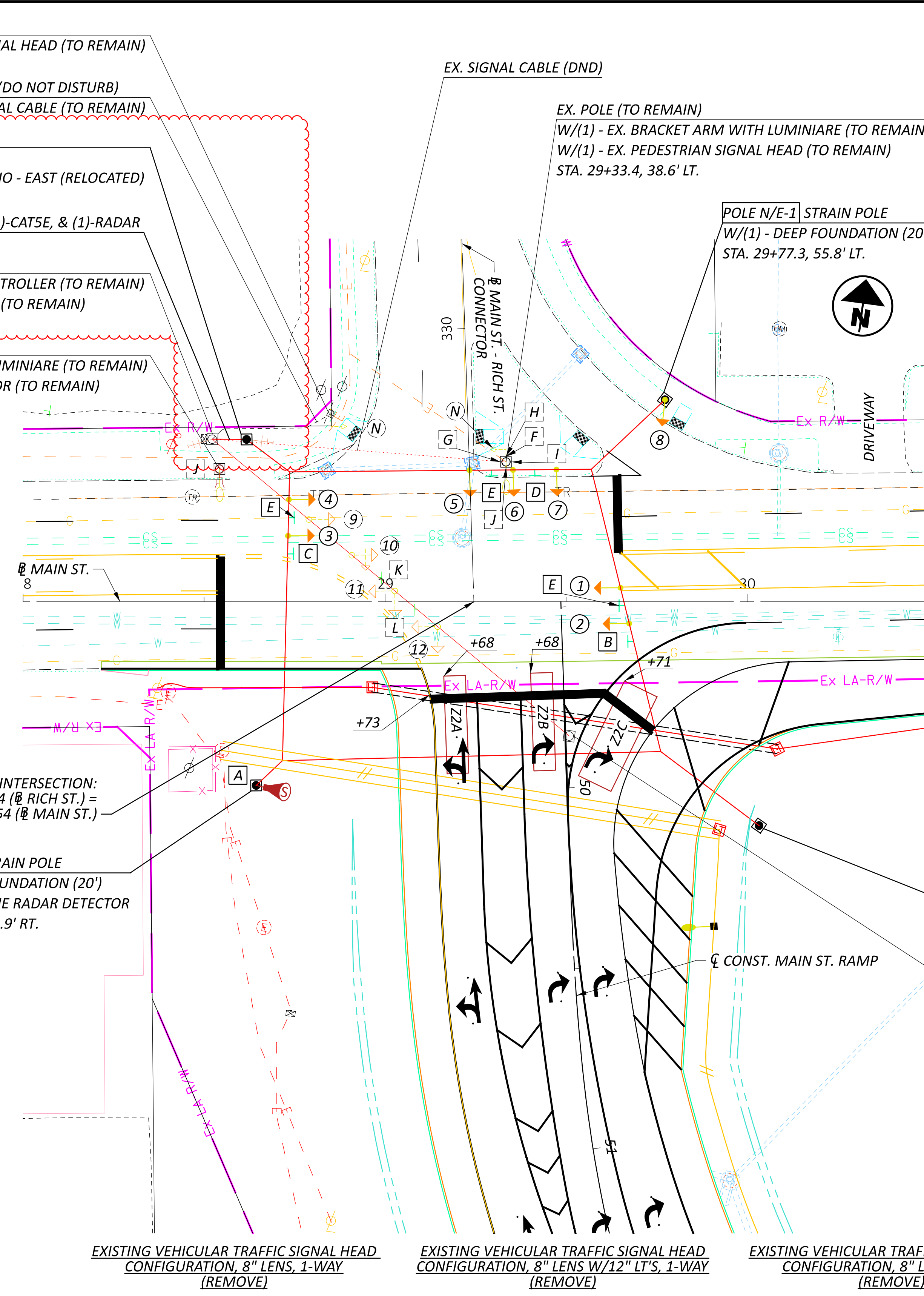
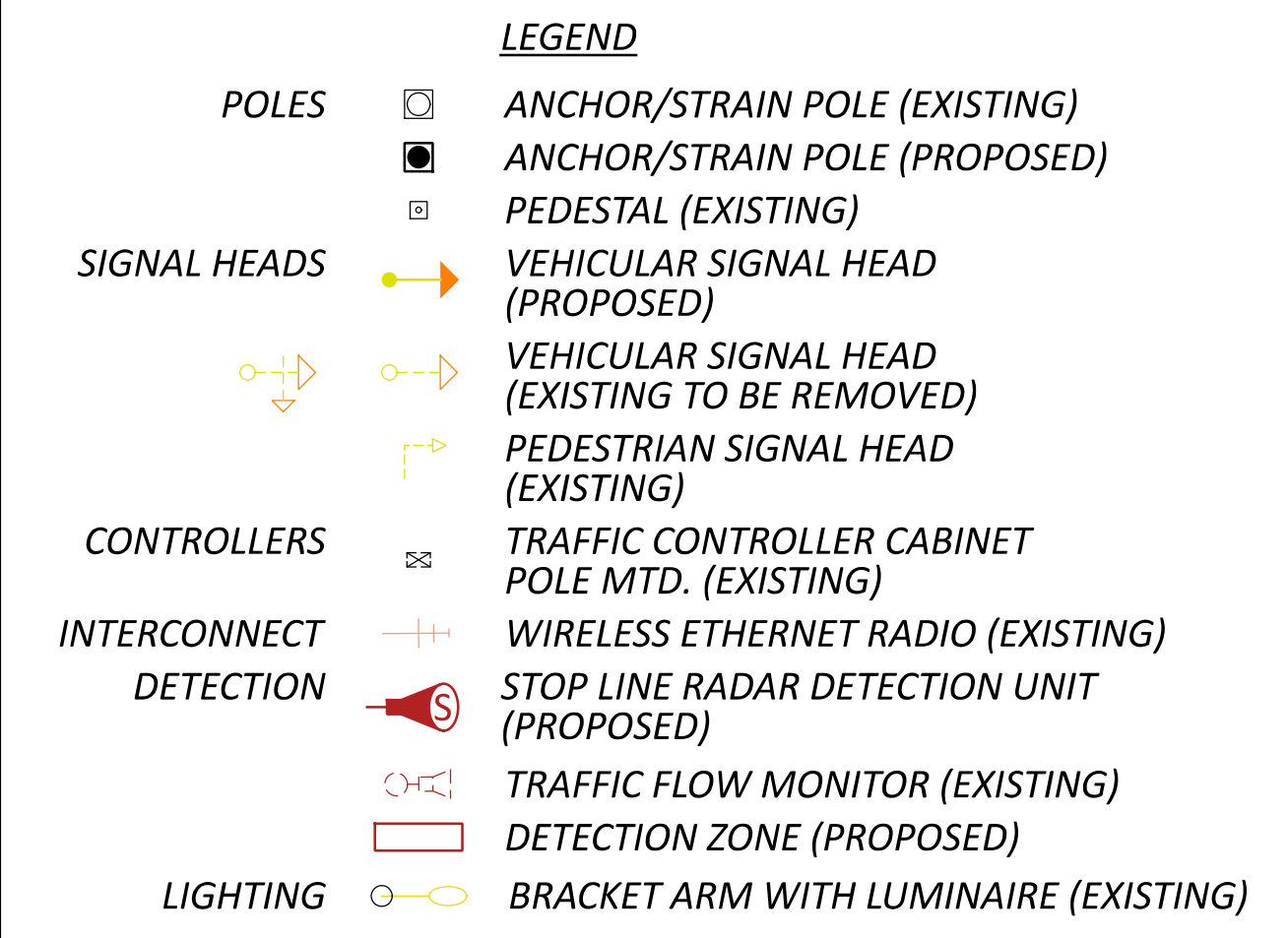
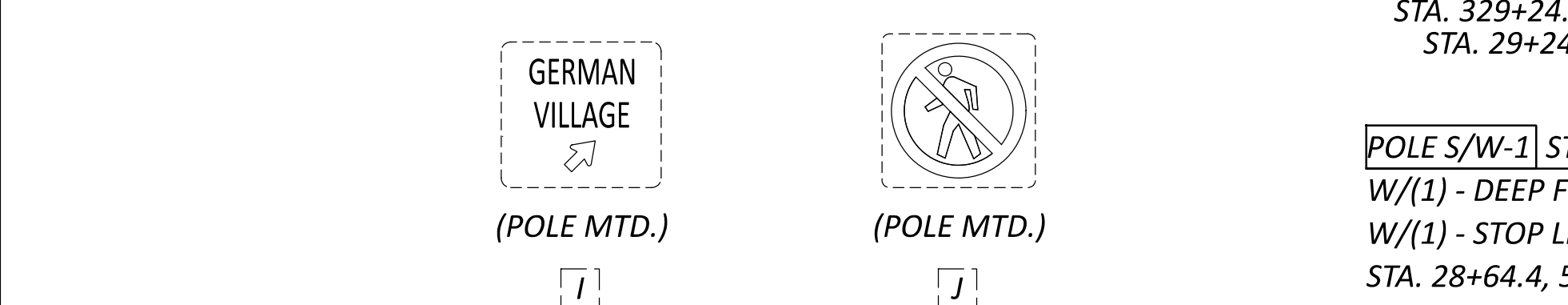
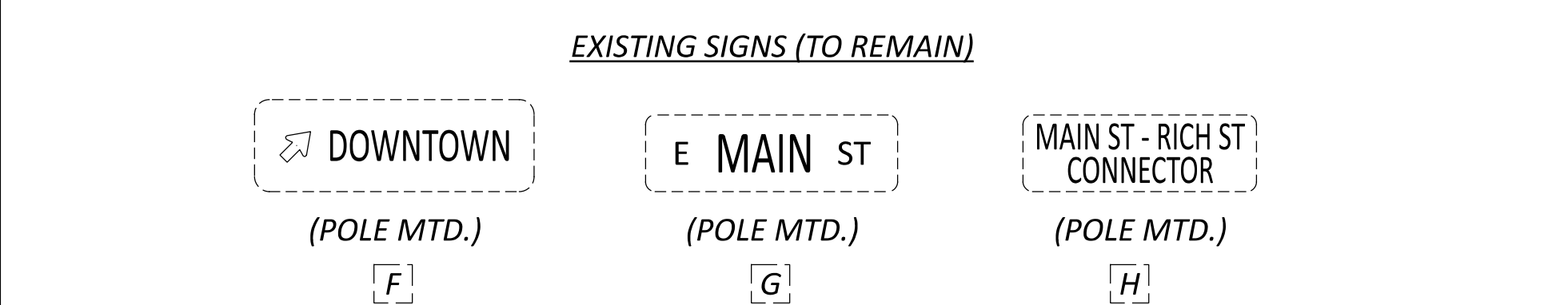
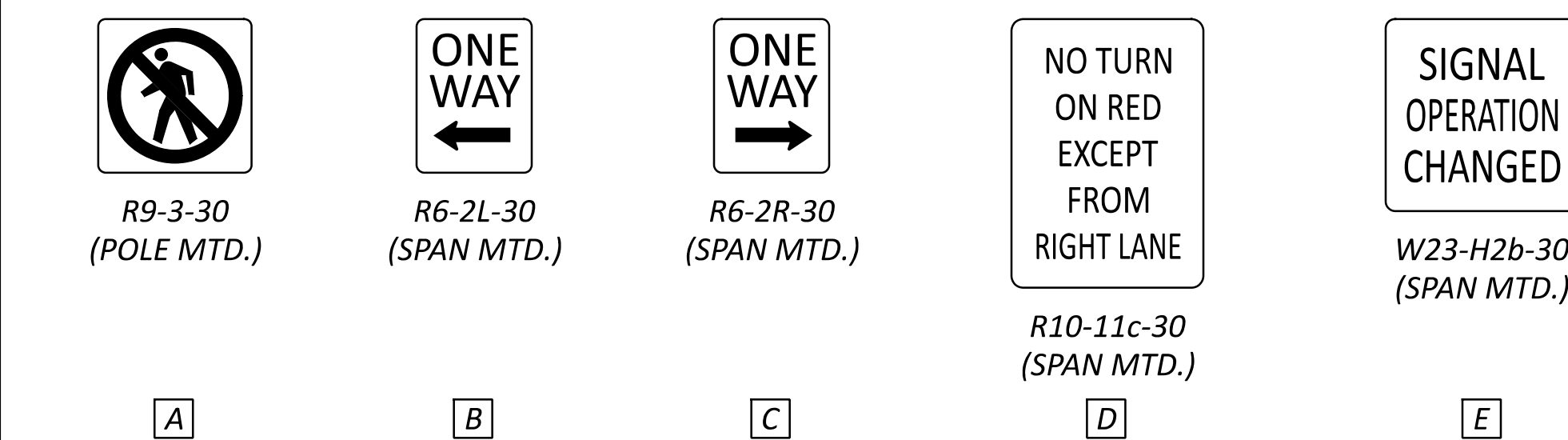

HEADS 1, 2, 3, 4, 5, 6, 7, 8

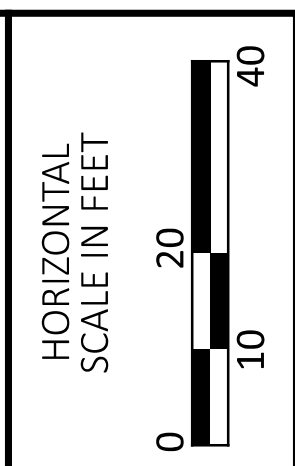

TRAFFIC SIGNAL MODIFICATION PLAN
I-71 SOUTHBOUND EXIT RAMP AT MAIN ST.

DESIGN AGENCY

DESIGNER: CLM
REVIEWER: JML 08/14/25
PROJECT ID: 123987
SHEET: P.105 TOTAL: 122

FIELD WIRING HOOK-UP CHART

SIGNAL HEAD #	INDICATION	FIELD TERMINAL	FLASH
1, 2, 3, 4 (EB, WB)	R	Ø1 R	R
	Y	Ø1 Y	
	G	Ø1 G	
5, 6, 7, 8 (NB)	R	Ø2 R	R
	Y	Ø2 Y	
	G	Ø2 G	
N (NORTH)	WALK	G (Ø1) - W (EXISTING)	OFF
	DON'T WALK	G (Ø1) - DW (EXISTING)	

DETECTOR ASSIGNMENTS

DETECTION ZONE (#)	RADAR DETECTOR (#)	PHASE	DETECTION ZONE SIZE (W' X L')	PRESENCE	PURPOSE	DELAY DATA	
						DELAY (SEC.)	INHIBIT DELAY DURING GREEN (PHASE)
Z2A	1	Ø2	6' X 40'	X	CALL/EXTEND	0	2
Z2B	1	Ø2	6' X 40'	X	CALL/EXTEND	0	2
Z2C	1	Ø2	5.5' X 40'	X	CALL/EXTEND	12	2

TIMING CHART

PHASE	Ø1	Ø2	Ø3	Ø4
MOVEMENT	WB/EB	NB	-	-
MIN INITIAL	20	10	-	-
WALK	7	-	-	-
PED CHANGE	4	-	-	-
PASS / EXIT	-	3.7	-	-
YELLOW	3.4	3.2	-	-
RED CL	2.3	1	-	-
MAX GRN 1	45	35	-	-
MAX GRN 2	60	35	-	-
MAX GRN 3	30	35	-	-
PED RECAL	ON	OFF	-	-
VEH RECALL	MAX	OFF	-	-
MEMORY	ON	OFF	-	-

WIRING DIAGRAM

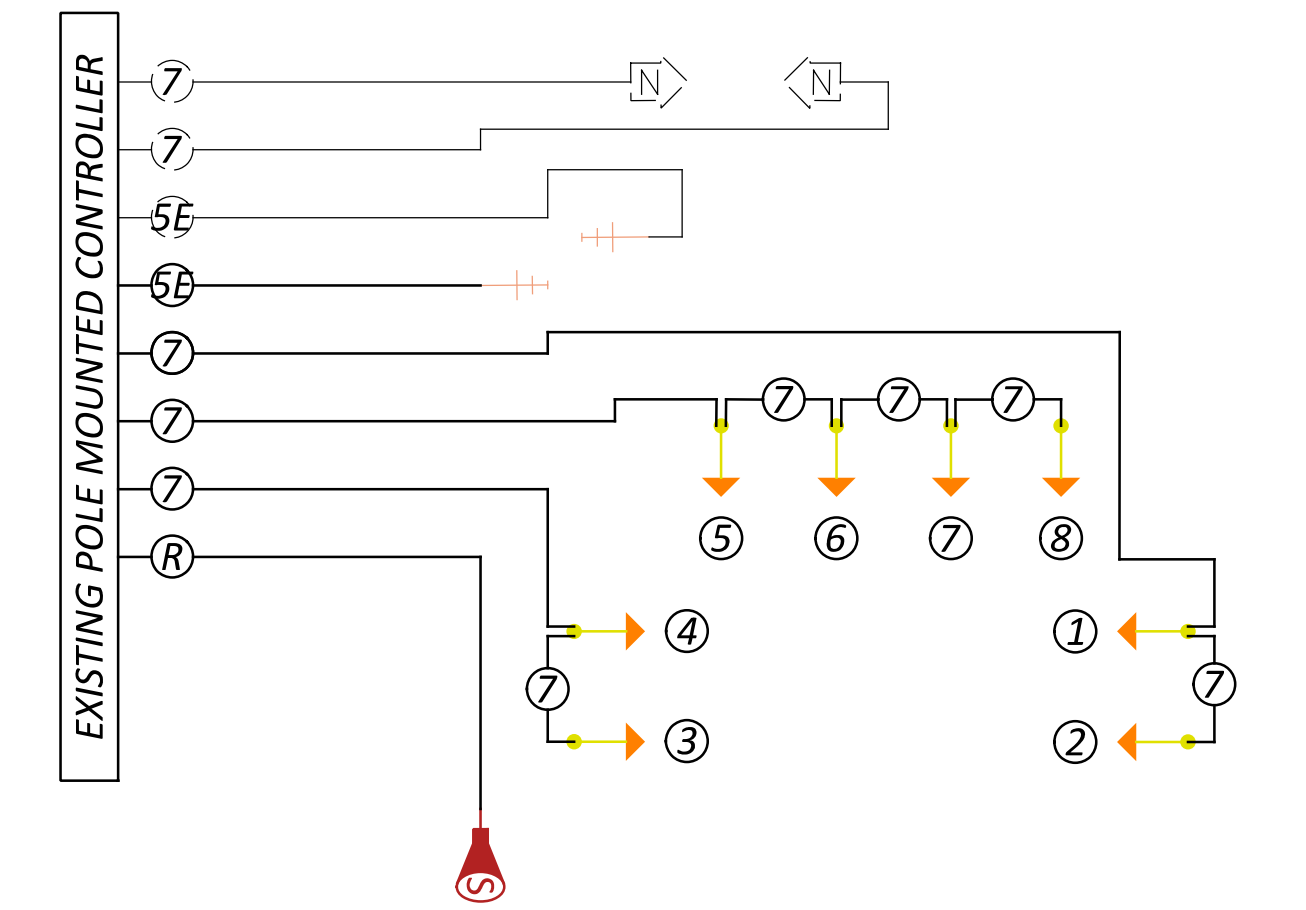

WIRING DIAGRAM LEGEND

- PR. 3-SECTION VEHICULAR SIGNAL HEAD
- PR. SIGNAL CABLE, # OF CONDUCTORS
- EX. SIGNAL CABLE, # OF CONDUCTORS
- RADAR DETECTION CABLE
- EX. CAT 5E CABLE
- PR. CAT 5E CABLE
- EX. PEDESTRIAN SIGNAL HEAD
- STOP LINE RADAR UNIT
- EX. WIRELESS ETHERNET RADIO

NOTE: ONLY PROPOSED SIGNAL ITEMS AND EXISTING PEDESTRIAN SIGNALS ARE SHOWN. ALL OTHER SIGNAL ITEMS, INCLUDING POWER AND INTERCONNECT, ARE EXISTING TO REMAIN.

GROUNDING & BONDING DIAGRAM LEGEND

- EX. SIGNAL POLE/PEDESTAL
- PR. SIGNAL POLE
- GROUND ROD & #4 AWG WIRE
- EXISTING CABINET GROUND TERMINAL
- EXISTING ATTACHMENT POINT
- PROPOSED ATTACHMENT POINT
- EX. CONTROLLER CABINET
- GROUND CLAMP WITH #4 AWG WIRE

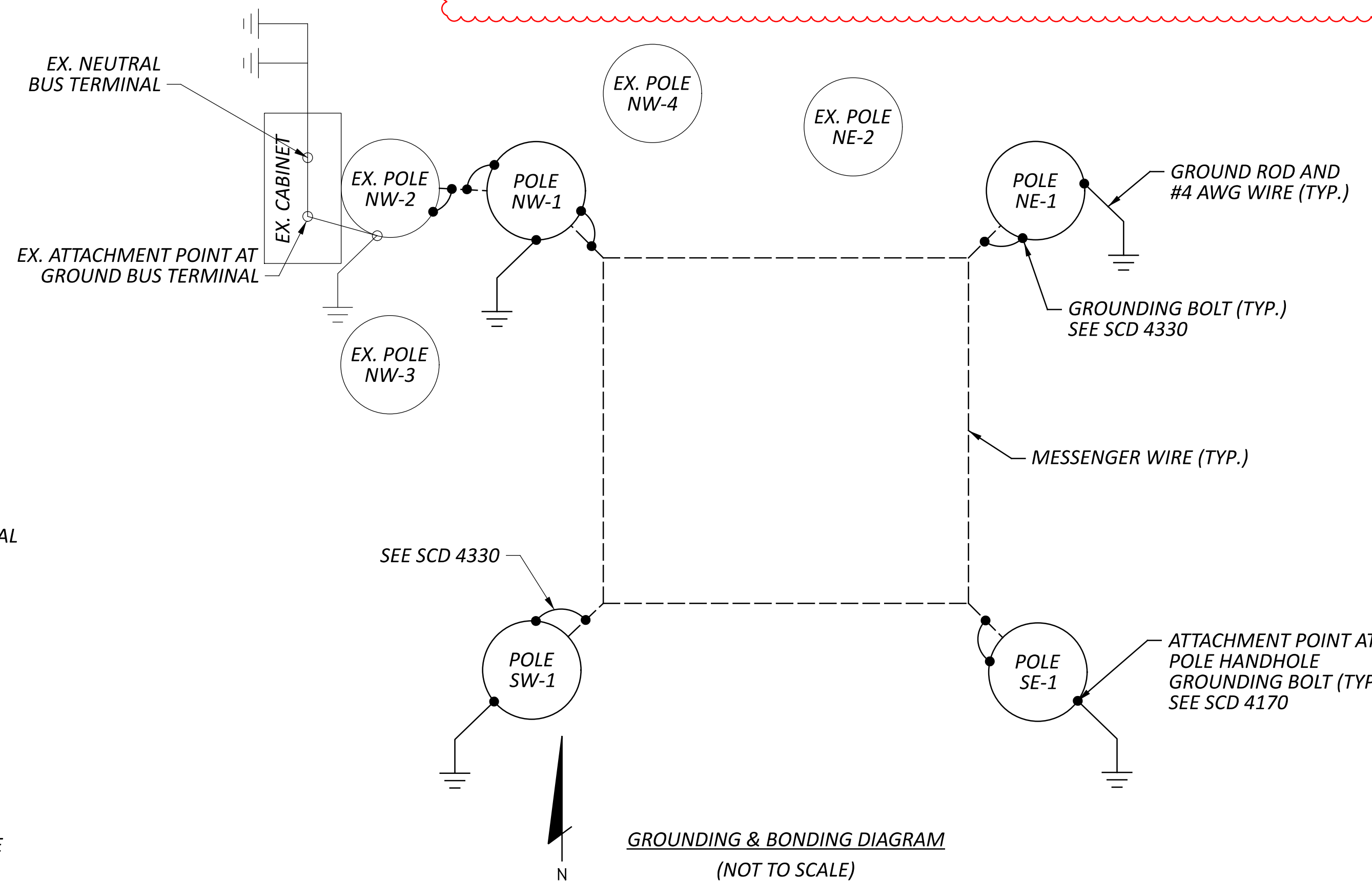

GROUNDING & BONDING DIAGRAM (NOT TO SCALE)

NOTE: ONLY PROPOSED GROUNDING IS SHOWN. ALL OTHER GROUNDING IS EXISTING TO REMAIN.

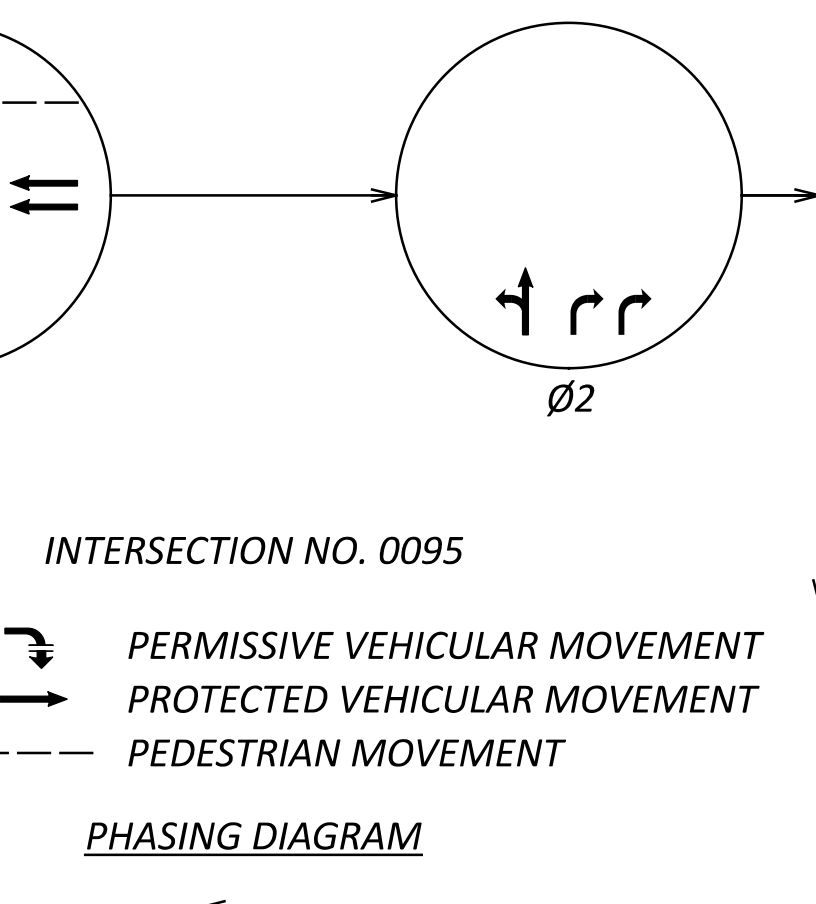

INTERSECTION NO. 0095

- PERMISSIVE VEHICULAR MOVEMENT
- PROTECTED VEHICULAR MOVEMENT
- PEDESTRIAN MOVEMENT

PHASING DIAGRAM



CITY OF COLUMBUS

THE CITY STREET LIGHT INSTALLATIONS SHALL CONFORM TO THE CITY OF COLUMBUS, DIVISION OF POWER (DOP) MATERIAL AND INSTALLATION SPECIFICATIONS (MIS) SUPPLEMENTED BY THE 2025 CITY OF COLUMBUS CONSTRUCTION AND MATERIAL SPECIFICATIONS (CMSC)

POWER SERVICE

THE POWER SUPPLY AGENCY FOR THE CITY STREETS PORTION OF THIS PROJECT IS:

CITY OF COLUMBUS, DIVISION OF POWER (DOP)
 3500 INDIANOLA AVENUE
 COLUMBUS, OH 43214
 614-645-7627

- EXISTING CONTROL CENTER (CIRCUIT #55) ON S. WASHINGTON AVENUE BETWEEN E. MAIN STREET & E. CHERRY STREET.

FOR THE DIVISION OF POWER

THE DIVISION OF POWER (DOP) MAY HAVE OVERHEAD AND UNDERGROUND PRIMARY, SECONDARY, AND STREET LIGHTING AT THIS WORK LOCATION. THE CONTRACTOR IS HEREBY REQUIRED TO CONTACT OHIO 811 (PREVIOUSLY OUPS) AT 811 OR 1-800-362-2764 FORTY-EIGHT HOURS PRIOR TO CONDUCTING ANY ACTIVITY WITHIN THE CONSTRUCTION AREA.

ANY PROJECT, BOTH PUBLIC OR PRIVATE, WITH IMPACTS REQUIRING RELOCATION, SUPPORT, PROTECTION, OR ANY OTHER ACTIVITY CONCERNED WITH THE CITY'S ELECTRICAL FACILITIES IN THE CONSTRUCTION AREA IS TO BE PERFORMED BY THE CONTRACTOR UNDER THE DIRECTION OF DOP PERSONNEL AND AT THE EXPENSE OF THE PROJECT.

UNLESS PREVIOUSLY AUTHORIZED, DOP SHALL MAKE ALL FINAL CONNECTIONS TO DOP'S EXISTING ELECTRICAL SYSTEM AT THE EXPENSE OF THE PROJECT.

NO PERSON SHALL WORK ON DOP FACILITIES UNLESS THEY HAVE COMPLETED CONTRACTOR SAFETY ORIENTATION WITH DOP. ANY PERSON WORKING ON DOP FACILITIES ON LIVE CONDUCTORS OR CONDUCTORS THAT MAY BECOME LIVE SHALL COMPLY WITH DOP'S CONDUCTOR SAFETY POLICY (TDMIS-1603), HOLD CARD SYSTEM (TDMIS-1604) AND STREET LIGHT LOCK OUT TAG OUT PROCEDURE (MIS-1). PRIOR TO BEGINNING WORK ON DOP FACILITIES, EACH PERSON SHALL CONTACT DOP'S DISPATCH OFFICE AT 614-645-7627 AND PROVIDE THEIR NAME, PHONE NUMBER, LOCATION, DESCRIPTION OF WORK AND CIRCUIT NUMBER. AT COMPLETION OF WORK, EACH PERSON SHALL NOTIFY DOP'S DISPATCH OFFICE.

THE CONTRACTOR SHALL USE MATERIAL AND MAKE REPAIRS TO A CITY OF COLUMBUS STREET LIGHTING SYSTEM BY FOLLOWING DOP'S "MATERIAL AND INSTALLATION SPECIFICATIONS" (MIS) AND THE CITY OF COLUMBUS "CONSTRUCTION AND MATERIAL SPECIFICATIONS" (CMSC). ANY NEW OR RE-INSTALLED STREET LIGHT SYSTEM SHALL REQUIRE TESTING AS REFERRED TO IN SECTION 1001.18 OF THE CMSC MANUAL. CONTRACTORS WORKING ON STREET LIGHTING SHALL CONFORM TO DOP'S EXISTING STREET LIGHT LOCKOUT/TAGOUT (LOTO) PROCEDURE, MIS-1, COPIES OF WHICH ARE AVAILABLE FROM DOP AND ON THE CITY WEBSITE.

EMERGENCIES: IF ANY ELECTRIC FACILITY BELONGING TO DOP IS DAMAGED IN ANY MANNER BY THE CONTRACTOR, ITS AGENTS, SERVANTS, OR EMPLOYEES, AND REQUIRES EMERGENCY REPAIRS, THE DOP DISPATCH OFFICE SHOULD BE CONTACTED IMMEDIATELY AT (614) 645-7627. DOP SHALL MAKE ALL NECESSARY REPAIRS, AND THE EXPENSE OF SUCH REPAIRS AND OTHER RELATED COSTS SHALL BE PAID BY THE CONTRACTOR TO THE DIVISION OF POWER, CITY OF COLUMBUS, OHIO.

STREET LIGHTING NOTES

THE STREET LIGHTING SHALL BE CONSTRUCTED IN ACCORDANCE WITH THE CURRENT CITY OF COLUMBUS, OHIO "CONSTRUCTION AND MATERIAL SPECIFICATIONS" (2018 EDITION, SECTION 1001, TITLED "STREET LIGHTING"), INCLUDING ALL SUPPLEMENTS THERETO, IN FORCE ON THE DATE OF THE CONTRACT, SHALL GOVERN ALL MATERIALS AND WORKMANSHIP INVOLVED IN THE IMPROVEMENTS SHOWN ON THESE PLANS, EXCEPT AS SUCH SPECIFICATIONS ARE MODIFIED BY THE FOLLOWING SPECIFICATIONS OR BY THE CONSTRUCTION DETAILS SET FORTH HEREIN.

CIRCUIT VOLTAGE FOR ALL LUMINAIRES SHALL BE 480 VOLT, UNLESS OTHERWISE NOTED.

CENTERLINE OF WOOD POLES AND CONDUIT TRENCH TO BE PLACED IN ACCORDANCE WITH THE PLAN DETAILS.

ALL PROPOSED LUMINAIRES SHALL BE 3000K LED.

NO SPLICES SHALL BE MADE TO CIRCUIT CABLES EXCEPT IN POLES OR PULL BOXES.

TRENCH LOCATION SHALL BE DEFLECTED AROUND OBSTACLES AS NOTED IN THIS PLAN.

WHERE THE TRENCH IS OFFSET FROM THE CENTERLINE OF THE FOUNDATIONS, THE CONDUIT SHALL BE DIRECTED TOWARD THE ELL OF THE FOUNDATION AT APPROXIMATELY 45 DEGREE ANGLE. THE FOUNDATION ELLS MAY BE AIMED OUT OF FOUNDATION AT APPROXIMATELY 45 DEGREE ANGLES TO FACILITATE CONNECTION TO CONDUIT WITH THE LEAST AMOUNT OF BENDS.

THE PLAN DETAILS SHALL BE CONSIDERED SUPPLEMENTAL TO MIS SPECIFICATIONS.

POLES SHALL BE LOCATED APPROXIMATELY WHERE SHOWN ON PLANS WITH EXACT LOCATIONS TO BE DETERMINED IN THE FIELD AFTER CONSIDERATION IS GIVEN TO THE LOCATION OF UNDERGROUND AND OVERHEAD UTILITIES, PAVEMENTS AND GRADES.

ALL ITEMS OF WORK CALLED FOR ON THE PLANS, FOR WHICH NO SPECIFIC METHOD OF PAYMENT IS PROVIDED, SHALL BE PERFORMED BY THE CONTRACTOR AND THE COST OF THESE SHALL BE INCLUDED IN THE UNIT PRICE BID FOR THE VARIOUS RELATED ITEMS. THIS INCLUDES, BUT IS NOT LIMITED TO, SUCH INCIDENTAL ITEMS AS RELOCATION OF MAIL BOXES, SAW CUTTING AND REMOVAL AND/OR RELOCATION OF SIGNS, RAILROAD TIES, SPRINKLERS, RELOCATING ROOF OR SUMP DRAINS AROUND LIGHT POLE FOUNDATIONS, HAND DIGGING AROUND UNDERGROUND UTILITIES OR OTHER MISCELLANEOUS ITEMS.

AS BUILT RECORD

THE CONTRACTOR SHALL MAINTAIN A SET OF PROJECT RECORD DOCUMENTS. THESE DOCUMENTS SHALL INCLUDE REVIEWED SHOP DRAWINGS, CHANGE ORDERS, EQUIPMENT OPERATING INSTRUCTIONS, FIELD TEST RECORDS, AND AS BUILT DRAWINGS. THE AS BUILT DRAWING SHALL BE MARKED LEGIBLY IN RED, THE ACTUAL LOCATION OF EQUIPMENT AND CONDUITS AS CONSTRUCTED. ALL EQUIPMENT AND UNDERGROUND CONDUITS INSTALLED SHALL HAVE LOCATIONS MARKED IN DISTANCES OFF A LANDMARK AT LEAST EVERY 25 FEET AND AS NECESSARY AT BENDS FOR LOCATION AT A LATER DATE. ADDITIONALLY, THE CONTRACTOR SHALL FILL-IN THE AS-BUILT COORDINATE TABLE AS SHOWN BELOW.

As-Built Coordinate Table			
Reference No.	Proposed Item	As-Built	
		Northing	Easting
55-B-1	Street Light Pole		
55-B-2	Street Light Pole		
PB-1	Pull Box		
PB-2	Pull Box		

UTILITY CLEARANCE REQUIREMENTS AND CONFLICT RESOLUTION

OUPS- THE CONTRACTOR SHALL CAUSE NOTICE TO BE GIVEN TO THE OHIO UTILITY PROTECTION SERVICE (OUPS- PHONE: 1-800-362-2764, TOLL FREE) AND THE OWNERS OF UNDERGROUND FACILITIES LOCATED WITHIN THE PROJECT AREA WHO ARE NOT MEMBERS OF THE REGISTERED UNDERGROUND PROTECTION SERVICE IN ACCORDANCE WITH SECTION 153.64 OF THE OHIO REVIEW CODE. THE ABOVE-MENTIONED NOTICE SHALL BE GIVEN AT LEAST TWO WORKING DAYS PRIOR TO THE START OF CONSTRUCTION.

NON-PAYMENT ITEMS (MIS-01, MIS-02, MIS-03, MIS-04, AND MIS-58)

THE CONTRACTOR SHALL CONFORM TO THE REQUIREMENTS OF MIS-01 (LOCKOUT/TAGOUT SAFETY POLICY), MIS-02 (INSPECTION & ACCEPTANCE GUIDELINES), MIS-03 (MATERIALS FOR APPROVAL SUBMITTAL GUIDELINES), MIS-04 (INSPECTION CHECKLIST), AND MIS-58 (MINIMUM TREE CLEARANCE FOR DOWNTOWN, URBAN AND RURAL AREAS). DETAILS CAN BE FOUND ON THE CITY OF COLUMBUS WEBSITE: www.columbus.gov/Services/Columbus-Water-Power/About-Columbus-Water-Power/Columbus-Water-Power-FAQs/Power-Specifications-Street-Lighting-MIS-Specifications

ITEM 625 - LIGHTING, MISC.: 13 INCH X 24 INCH PULL BOX (MIS-54)

THIS ITEM OF WORK SHALL COMPLY WITH CITY OF COLUMBUS, DIVISION OF POWER (DOP) MATERIAL AND INSTALLATION SPECIFICATION MIS-54.

ITEM 625 - LIGHTING, MISC.: STREET LIGHT FOUNDATION, 6' (MIS-201)

THIS ITEM OF WORK SHALL COMPLY WITH CITY OF COLUMBUS, DIVISION OF POWER (DOP) MATERIAL AND INSTALLATION SPECIFICATION MIS-201.

ITEM 625 - LIGHTING, MISC.: POLE, ALUMINUM, 8' BRACKET, T-BASE, 30' MOUNTING HEIGHT (MIS-300)
ITEM 625 - LIGHTING, MISC.: POLE, ALUMINUM, 12' BRACKET, T-BASE, 30' MOUNTING HEIGHT (MIS-300)

THIS ITEM OF WORK SHALL COMPLY WITH CITY OF COLUMBUS, DIVISION OF POWER (DOP) MATERIAL AND INSTALLATION SPECIFICATION MIS-300.

ITEM 625 - LIGHTING, MISC.: UNDERGROUND CIRCUIT, 2 WIRE (MIS-403)

THIS ITEM OF WORK SHALL COMPLY WITH CITY OF COLUMBUS, DIVISION OF POWER (DOP) MATERIAL AND INSTALLATION SPECIFICATION MIS-403.

ITEM 625 - LIGHTING, MISC.: POLE TO BE WIRED, 2-WIRE (MIS-500)

THIS ITEM OF WORK SHALL COMPLY WITH CITY OF COLUMBUS, DIVISION OF POWER (DOP) MATERIAL AND INSTALLATION SPECIFICATION MIS-500.

ITEM 625 - LIGHTING, MISC.: 2" CONDUIT, CONCRETE ENCASED (MIS-700)

THIS ITEM OF WORK SHALL COMPLY WITH CITY OF COLUMBUS, DIVISION OF POWER (DOP) MATERIAL AND INSTALLATION SPECIFICATION MIS-700.

ITEM 625 - LIGHTING, MISC.: 3" RIGID STEEL WITH 2" CONDUIT INSERT (MIS-702)

THIS ITEM OF WORK SHALL COMPLY WITH CITY OF COLUMBUS, DIVISION OF POWER (DOP) MATERIAL AND INSTALLATION SPECIFICATION MIS-702.

DESIGN AGENCY

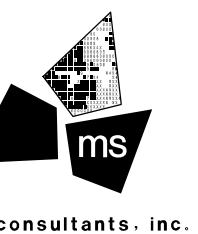

DESIGNER

KWR

REVIEWER

JML 01-30-26

PROJECT ID

123987

SHEET TOTAL

P.108 | 122

ITEM 625 - LIGHTING, MISC.: LUMINAIRE, LED, COBRA HEAD (MIS-800)

THIS ITEM OF WORK SHALL COMPLY WITH CITY OF COLUMBUS, DIVISION OF POWER (DOP) MATERIAL AND INSTALLATION SPECIFICATION MIS-800. THE COOPER LIGHTING ARCHEON SERIES (ARCH-L-PA3-120-730-8-T2R-AP-PR7) WAS USED AS THE BASIS OF DESIGN FOR THIS PROJECT.

ITEM 625 - LIGHTING, MISC.: FOUNDATION REMOVAL (MIS-900)

THIS ITEM OF WORK SHALL COMPLY WITH CITY OF COLUMBUS, DIVISION OF POWER (DOP) MATERIAL AND INSTALLATION SPECIFICATION MIS-900.

ITEM 625 - LIGHTING, MISC.: EXISTING UNDERGROUND SYSTEM REMOVAL (MIS-902)

THIS ITEM OF WORK SHALL COMPLY WITH CITY OF COLUMBUS, DIVISION OF POWER (DOP) MATERIAL AND INSTALLATION SPECIFICATION MIS-902.

MISCELLANEOUS WORK ITEMS

THE CONTRACTOR SHALL PERFORM ALL ITEMS OF WORK CALLED FOR ON THE PLANS, FOR WHICH NO SPECIFIED METHOD OF PAYMENT IS PROVIDED. THE COST OF IT SHALL BE INCLUDED IN THE VARIOUS UNIT PRICES BID FOR THE PROJECT IMPROVEMENT.

ITEM 625 - LIGHTING, MISC.: MAINTAIN EXISTING AND TEMPORARY LIGHTING

STREET LIGHTING OUTAGES DURING THE COURSE OF CONSTRUCTION ARE PROHIBITED WITHOUT PRIOR APPROVAL FROM THE DIVISION OF POWER. ADEQUATE LIGHT LEVELS ARE TO BE MAINTAINED TO THE SATISFACTION OF THE CITY OF COLUMBUS THROUGHOUT THE COURSE OF CONSTRUCTION OF THE PROJECT.

EXISTING ROADWAYS WHICH ARE TO REMAIN OPEN TO TRAFFIC DURING THE CONSTRUCTION OF THE PROJECT AND LIGHTED SHALL HAVE THE LIGHTING MAINTAINED.

WHEN THE SEQUENCE OF CONSTRUCTION ACTIVITIES REQUIRES, OR SHOULD THE CONTRACTOR DESIRE, THE CONTRACTOR SHALL BE RESPONSIBLE FOR PROVIDING TEMPORARY LIGHTING WHEN THE REMOVAL OF THE EXISTING LIGHTING OCCURS BEFORE THE NEW LIGHTING IS FULLY OPERATIONAL.

BEFORE INSTALLING SUCH LIGHTING, THE CONTRACTOR SHALL PREPARE AND SUBMIT A TEMPORARY LIGHTING PLAN TO THE DESIGNER FOR REVIEW AND APPROVAL BY THE DIVISION OF POWER. THIS PLAN SHALL SHOW THE LOCATIONS OF POLES, LENGTHS OF BRACKET ARMS, DETAILS OF LUMINAIRES, MOUNTING HEIGHTS, WIRING METHODS, AND OTHER PERTINENT INFORMATION. MOUNTING HEIGHT FOR TEMPORARY LUMINAIRES SHALL NOT BE LESS THAN 28 FEET, AND MINIMUM OVERHEAD CONDUCTOR CLEARANCE SHALL BE ABOVE NESC MINIMUM.

THE TEMPORARY LIGHTING SHALL MATCH THE EXISTING OR PROPOSED AVERAGE FOOT-CANDLE INTENSITY AND AVERAGE MINIMUM UNIFORMITY RATIO, AS DIRECTED BY THE DESIGNER. IT IS THE RESPONSIBILITY OF THE CONTRACTOR TO REMOVE AND DISPOSE OF THE TEMPORARY LIGHTING MATERIAL ONCE THE PROPOSED STREET LIGHTING IS OPERATIONAL.

THE CONTRACTOR SHALL PROVIDE INSTALLATIONS IN ACCORDANCE WITH THE IEEE, NATIONAL ELECTRICAL SAFETY CODE, AND CONFORM TO LOCAL LAWS AND CODES GOVERNING SUCH WORK. WOOD POLES WITH OVERHEAD WIRING MAY BE USED. HOWEVER, TEMPORARY LIGHTING SHALL MEET FEDERAL AND STATE SAFETY CRITERIA. IF BREAKAWAY POLES ARE USED TO MEET THESE CRITERIA, THEN UNDERGROUND WIRING SHALL BE USED. RECONDITIONED OR USED MATERIALS MAY BE FURNISHED FOR A TEMPORARY LIGHTING SYSTEM. WHERE NEW ELECTRICAL SERVICE IS NECESSARY TO POWER TEMPORARY LIGHTING, THE CONTRACTOR IS RESPONSIBLE FOR ARRANGING NEW SERVICE AND PAYING ALL ELECTRICAL COSTS. THE CONTRACTOR IS RESPONSIBLE FOR OBTAINING POLE OWNER PERMISSION FOR ATTACHMENTS. THESE COSTS SHALL BE PAID FOR UNDER THE LUMP SUM ITEM 625 "LIGHTING, MISC.: MAINTAIN EXISTING AND TEMPORARY LIGHTING". WHEN NO LONGER NEEDED THE TEMPORARY LIGHTING INSTALLATION SHALL BE TOTALLY REMOVED AND PROPERLY DISPOSED OF BY THE CONTRACTOR.

DESIGN AGENCY



DESIGNER

KWR

REVIEWER

JML 01-30-26

PROJECT ID

123987

SHEET TOTAL

P.109 | 122

SUB-SUMMARY OF LIGHTING ITEMS					
ITEM NO. (ODOT)	ITEM NAME (ODOT)	ITEM NO. (COC)	QTY	UNIT	ITEM DESCRIPTION
625	LIGHTING, MISC.:	1001	2	EACH	13 INCH X 24 INCH PULL BOX (MIS-54)
625	LIGHTING, MISC.:	1001	2	EACH	STREET LIGHT FOUNDATION, 6' (MIS-201)
625	LIGHTING, MISC.:	1001	1	EACH	POLE, ALUMINUM, 8' BRACKET, T-BASE, 30' MOUNTING HEIGHT (MIS-300)
625	LIGHTING, MISC.:	1001	1	EACH	POLE, ALUMINUM, 12' BRACKET, T-BASE, 30' MOUNTING HEIGHT (MIS-300)
625	LIGHTING, MISC.:	1001	548	CIRCUIT FOOT	UNDERGROUND CIRCUIT, 2 WIRE (MIS-403)
625	LIGHTING, MISC.:	1001	3	EACH	POLE TO BE WIRED, 2-WIRE (MIS-500)
625	LIGHTING, MISC.:	1001	384	LINEAR FOOT	2" CONDUIT, CONCRETE ENCASED (MIS-700)
625	LIGHTING, MISC.:	1001	113	LINEAR FOOT	3" RIGID STEEL WITH 2" CONDUIT INSERT (MIS-702)
625	LIGHTING, MISC.:	1001	2	EACH	LUMINAIRE, LED, COBRA HEAD (MIS-800)
625	LIGHTING, MISC.:	1001	3	EACH	FOUNDATION REMOVAL (MIS-900)
625	LIGHTING, MISC.:	1001	LS	LUMP SUM	EXISTING UNDERGROUND SYSTEM REMOVAL (MIS-902)
625	LIGHTING, MISC.:	1001	LS	LUMP SUM	MAINTAIN EXISTING AND TEMPORARY LIGHTING

NON-PAYMENT MIS SPECIFICATIONS	
MIS	ITEM DESCRIPTION
1	STREET LIGHT LOCKOUT/TAGOUT (LOTO)
2	GUIDELINES FOR INSPECTION & ACCEPTANCE OF STREET LIGHTING SYSTEMS
3	GUIDELINES FOR STREET LIGHTING "MATERIALS FOR APPROVAL" SUBMITTAL PACKAGES
4	INSPECTION CHECKLIST
58	MINIMUM TREE CLEARANCE FOR DOWNTOWN, URBAN, & RURAL AREAS



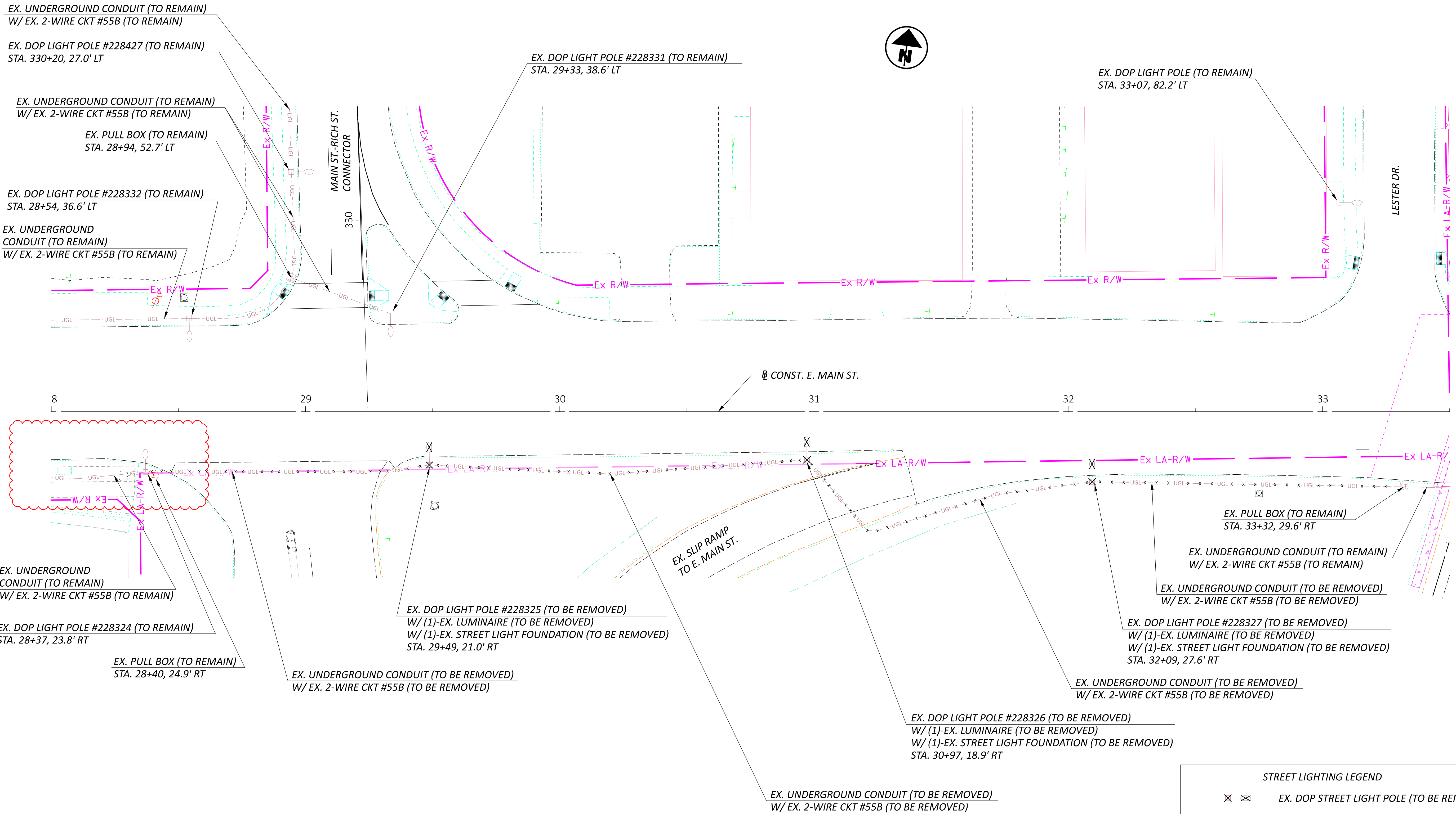

STREET LIGHTING LEGEND

	EX. DOP STREET LIGHT POLE (TO BE REMOVED)
	EX. DOP STREET LIGHT POLE (TO REMAIN)
	EX. LIGHTING CONDUIT (TO REMAIN) W/ EX. 2 WIRE CIRCUIT CABLE (TO REMAIN)
	EX. LIGHTING CONDUIT (TO BE REMOVED) W/ EX. 2 WIRE CIRCUIT CABLE (TO BE REMOVED)

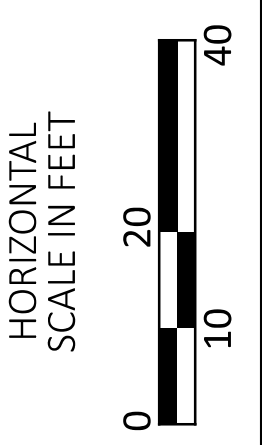

LIGHTING REMOVAL PLAN (CITY)
 MAIN STREET

DESIGN AGENCY

 ms consultants, inc.
 DESIGNER
 KWR
 REVIEWER
 JML 01-30-26
 PROJECT ID
 123987
 SHEET TOTAL
 P.112A | 122

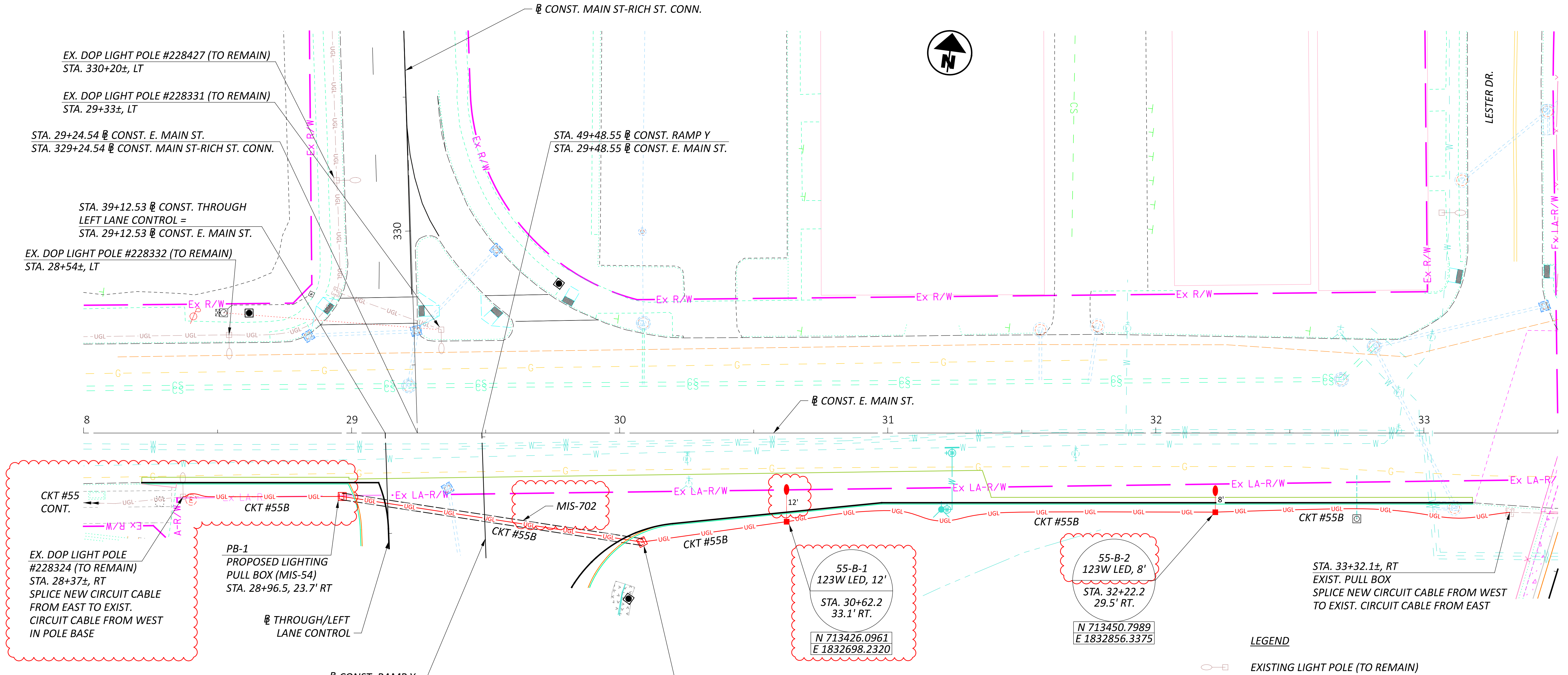

EX. DOP LIGHT POLE #228427 (TO REMAIN)
STA. 330+20±, LT

EX. DOP LIGHT POLE #228331 (TO REMAIN)
STA. 29+33±, LT

STA. 29+24.54 @ CONST. E. MAIN ST.
STA. 329+24.54 @ CONST. MAIN ST-RICH ST. CONN.

STA. 39+12.53 @ CONST. THROUGH
LEFT LANE CONTROL =
STA. 29+12.53 @ CONST. E. MAIN ST.

EX. DOP LIGHT POLE #228332 (TO REMAIN)
STA. 28+54±, LT

EX. DOP LIGHT POLE
#228324 (TO REMAIN)
STA. 28+37±, RT
SPlice NEW CIRCUIT CABLE
FROM EAST TO EXIST.
CIRCUIT CABLE FROM WEST
IN POLE BASE

PB-1
PROPOSED LIGHTING
PULL BOX (MIS-54)
STA. 28+96.5, 23.7' RT

PB-2
PROPOSED LIGHTING PULL BOX (MIS-54)
STA. 30+08.3, 40.7' RT

55-B-1
123W LED, 12'
STA. 30+62.2
33.1' RT.
N 713426.0961
E 1832698.2320

55-B-2
123W LED, 8'
STA. 32+22.2
29.5' RT.
N 713450.7989
E 1832856.3375

STA. 33+32.1±, RT
EXIST. PULL BOX
SPlice NEW CIRCUIT CABLE FROM WEST
TO EXIST. CIRCUIT CABLE FROM EAST

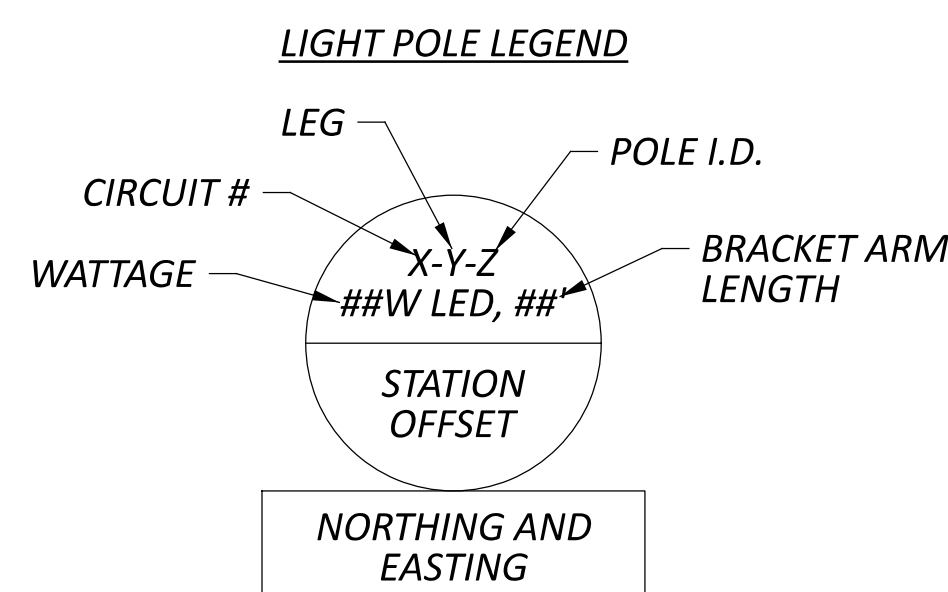

- LEGEND**
- EXISTING LIGHT POLE (TO REMAIN)
 - PROPOSED LIGHT POLE W/ 8' BRACKET ARM (MIS-300)
W/ LED COBRA HEAD LUMINAIRE (MIS-800)
W/ 6' STREET LIGHT FOUNDATION (MIS-201)
 - PROPOSED LIGHT POLE W/ 12' BRACKET ARM (MIS-300)
W/ LED COBRA HEAD LUMINAIRE (MIS-800)
W/ 6' STREET LIGHT FOUNDATION (MIS-201)
 - EXISTING PULL BOX (TO REMAIN)
 - PROPOSED LIGHTING PULL BOX (MIS-54)
 - CKT # PROPOSED 2" ENCASED CONDUIT (MIS-700)
W/ 2-NO. 4 AWG CIRCUIT CABLE (MIS-403)
 - CKT # PROPOSED 3" RIGID STEEL CONDUIT W/ 2" CONDUIT INSERT (MIS-702)
W/ 2-NO. 4 AWG CIRCUIT CABLE (MIS-403)
 - EXISTING CONDUIT W/ 2-NO. 4 AWG CIRCUIT CABLE (TO REMAIN)

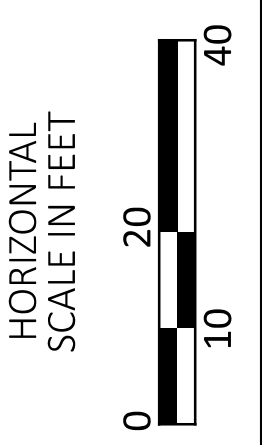

LIGHTING PLAN (CITY)
MAIN ST. STA. 28+00 TO 33+50

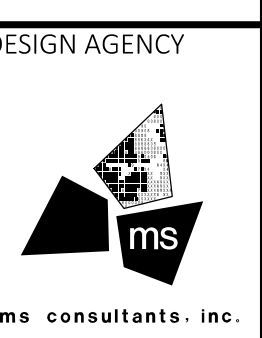

DESIGNER	KWR
REVIEWER	JML
PROJECT ID	01-30-26
	123987
SHEET	TOTAL
P.113	122

LUMINAIRE SCHEDULE							
STYLE	MANUFACTURER	CATALOG NUMBER	DESCRIPTION	FILE NAME	LUMENS PER LAMP	LIGHT LOSS FACTOR	WATTAGE
COBRA HEAD (MIS-800)	COOPER	ARCH-L-PA3-120-730-8-T2R-AP-PR7	ARCHEON-L-ROADWAY AND AREA LUMINAIRE (3) 70 CRI, 3000K, 530MA LIGHT ENGINES WITH 24 LEDS AND TYPE II ROADWAY OPTICS	ARCH-L-PA3-120-730-U-T2R.IES	18,074	0.88	123
EX. SHOEBOX (250W)	KIM	AR3/250HPS-E18	ARCHETYPE FULL CUTOFF LUMINAIRE DIE CAST ALUM. REFLECTOR SYSTEM WITH HIGH SPECULAR PANELS DIE CAST ALUM. HOUSING AND LENS FRAME CLEAR FLAT GLASS LENS	AR3-250S.IES	28,500	0.81	250
EX. COBRAHEAD (250W)	COOPER	OVZ25SXX2EG	250W HPS TYPE II ROADWAY	OVZ25SXX2EG.IES	27,500	0.81	250

STATISTICS						
DESCRIPTION	CLASSIFICATION (PER COLUMBUS THOROUGHFARE PLAN)	TARGET AVG.	ACHIEVED AVG.	ACHIEVED MIN.	TARGET AVG/MIN	ACHIEVED AVG/MIN
E. MAIN STREET	ARTERIAL, MEDIUM PEDS	1.3 FC	1.33 FC	0.19 FC	3.0:1	7.0:1

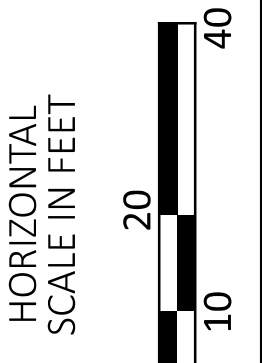
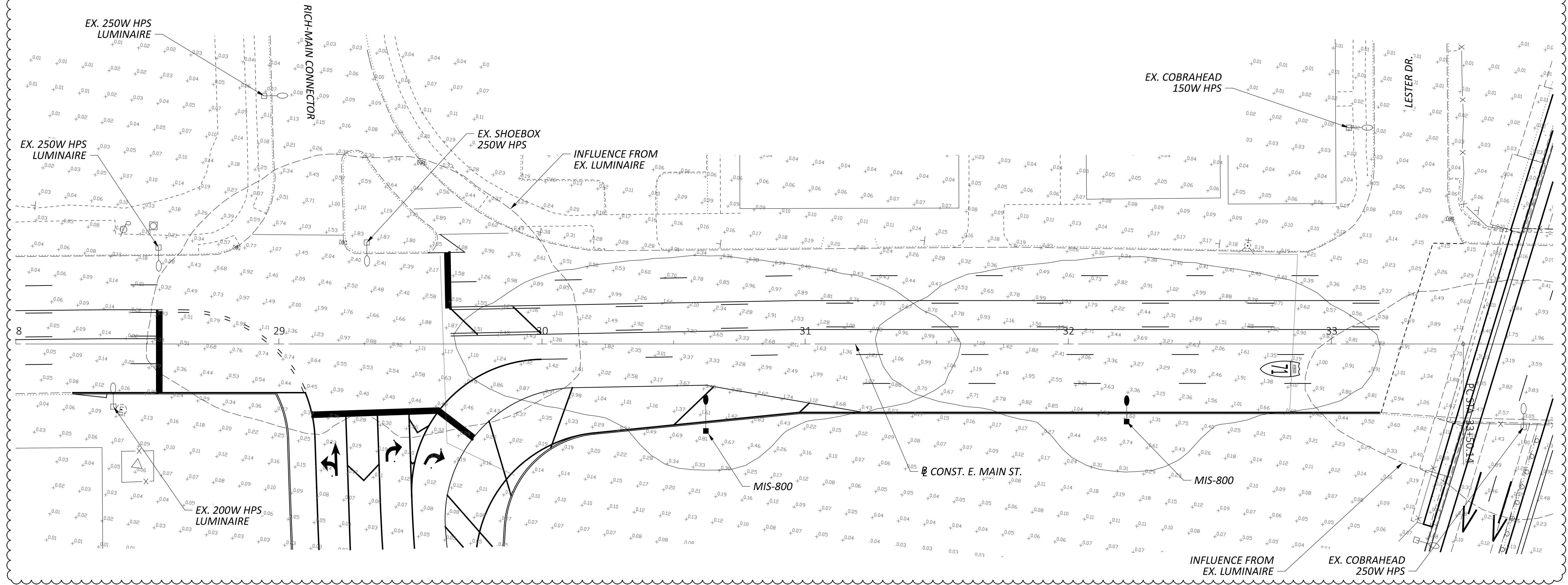

PHOTOMETRIC PLAN SHEET - E. MAIN STREET
 STA. 28+00 TO STA. 34+00



DESIGN AGENCY

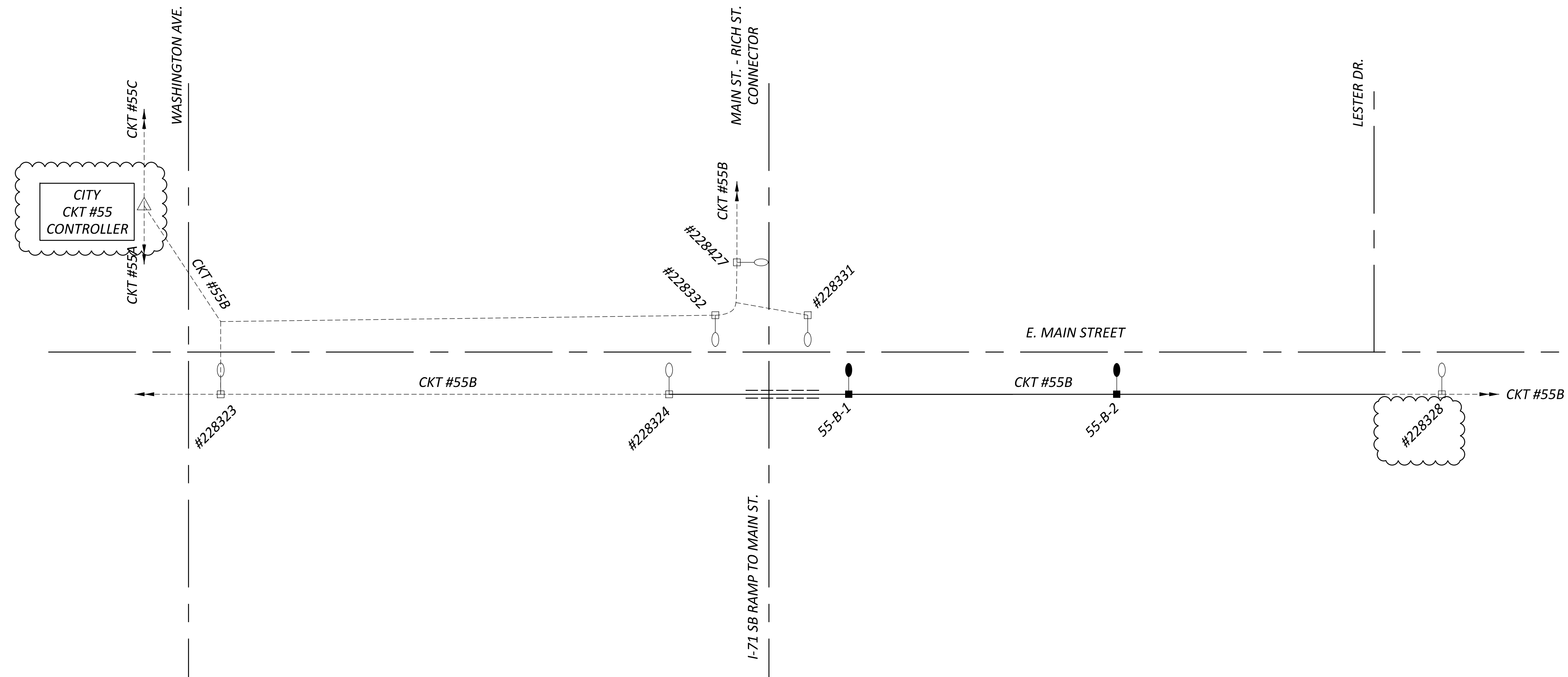

DESIGNER
 KWR
 REVIEWER
 JML 01-30-26
 PROJECT ID
 123987
 SHEET TOTAL
 P.113A 122

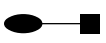
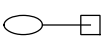
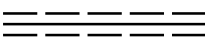

LEGEND

-  **PROPOSED LIGHT POLE (MIS-302)**
W/ LED COBRA HEAD LUMINAIRE (MIS-800)
-  **EXISTING LIGHT POLE (TO REMAIN)**
W/ EXISTING COBRA HEAD LUMINAIRE (TO REMAIN)
- **PROPOSED 2" ENCASED CONDUIT (MIS-700)**
W/ 2-WIRE UNDERGROUND CIRCUIT CABLE (MIS-403)
-  **PROPOSED 3" RIGID STEEL CONDUIT WITH 2" CONDUIT INSERT (MIS-702)**
W/ 2-WIRE UNDERGROUND CIRCUIT CABLE (MIS-403)
- **EXISTING UNDERGROUND CONDUIT (TO REMAIN)**
W/ EX. 2-WIRE UNDERGROUND CIRCUIT CABLE (TO REMAIN)
-  **EXISTING POLE MOUNTED LIGHTING CONTROL CENTER (TO REMAIN)**

DESIGN AGENCY



DESIGNER
KWR

REVIEWER
JML 01-30-26

PROJECT ID
123987

SHEET TOTAL
P.115 | 122