

ITEM 614, MAINTAINING TRAFFIC

THREE LANES OF TRAFFIC ALONG I-71 SB, TWO LANES OF TRAFFIC ALONG RAMP B, AND ALL ORIGINAL LANES OF TRAFFIC ALONG FIELDS- ERTEL ROAD, MASON- MONTGOMERY ROAD, AND ESCORT DRIVE SHALL BE MAINTAINED AT ALL TIMES EXCEPT AS NOTED IN THESE PLANS, BY USE OF THE EXISTING PAVEMENT, THE COMPLETED PAVEMENT, ITEM 615 PAVEMENT FOR MAINTAINING TRAFFIC CLASS A OR B AND TEMPORARY SURFACES USING ITEM 614.

SEE PERMITTED LANE CLOSURE TIMES AND UNAUTHORIZED LANE USE TABLE.

NO WORK SHALL BE PERFORMED AND ALL EXISTING LANES SHALL BE OPEN TO TRAFFIC DURING THE FOLLOWING DESIGNATED HOLIDAYS OR EVENTS:

CHRISTMAS FOURTH OF JULY
NEW YEARS LABOR DAY
MEMORIAL DAY THANKSGIVING

THE PERIOD OF TIME THAT THE LANES ARE TO BE OPEN DEPENDS ON THE DAY OF THE WEEK ON WHICH THE HOLIDAY OR EVENT FALLS. THE FOLLOWING SCHEDULE SHALL BE USED TO DETERMINE THIS PERIOD:

DAY OF HOLIDAY OR EVENT	TIME ALL LANES MUST BE OPEN TO TRAFFIC
SUNDAY	12:00N FRIDAY THROUGH 6:00AM MONDAY
MONDAY	12:00N FRIDAY THROUGH 6:00AM TUESDAY
TUESDAY	12:00N MONDAY THROUGH 6:00AM WEDNESDAY
WEDNESDAY	12:00N TUESDAY THROUGH 6:00AM THURSDAY
THURSDAY	12:00N WEDNESDAY THROUGH 6:00AM FRIDAY (THANKSGIVING ONLY)
FRIDAY	6:00AM WEDNESDAY THROUGH 6:00AM MONDAY
SATURDAY	12:00N THURSDAY THROUGH 6:00AM MONDAY

SHOULD THE CONTRACTOR FAIL TO MEET ANY OF THESE REQUIREMENTS, THE CONTRACTOR SHALL BE ASSESSED A DISINCENTIVE PER THE PERMITTED LANE CLOSURE TIMES AND UNAUTHORIZED LANE USE TABLE.

NOTICE OF CLOSURE SIGNS, AS DETAILED IN THESE PLANS, SHALL BE ERECTED BY THE CONTRACTOR AT LEAST ONE WEEK IN ADVANCE OF THE SCHEDULED ROAD CLOSURE.

THE SIGNS SHALL BE ERECTED ON THE RIGHT-HAND SIDE OF THE ROAD FACING TRAFFIC. THEY SHALL BE PLACED SO AS NOT TO INTERFERE WITH THE VISIBILITY OF ANY OTHER TRAFFIC CONTROL SIGNS. ON ROADWAYS, THEY SHOULD BE ERECTED AT THE POINT OF CLOSURE.



W20-H14-60

THE CONTRACTOR SHALL PROVIDE, ERECT AND MAINTAIN STANDARD 48 X 30 INCH ROAD CLOSED SIGNS, SIGN SUPPORTS, BARRICADES, GATES AND LIGHTS, AS DETAILED IN SCD MT-101.60 AT THE FOLLOWING LOCATIONS DURING PERIODS IN WHICH THE AFFECTED ROADS ARE CLOSED TO TRAFFIC:

FIELDS ERTEL ROAD JUST EAST OF ESCORT DRIVE AND JUST WEST OF MASON- MONTGOMERY ROAD.

LENGTH AND DURATION OF LANE CLOSURES AND RESTRICTIONS SHALL BE AT THE APPROVAL OF THE ENGINEER. IT IS THE INTENT TO MINIMIZE THE IMPACT TO THE TRAVELING PUBLIC. LANE CLOSURES OR RESTRICTIONS OVER SEGMENTS OF THE PROJECT IN WHICH NO WORK IS ANTICIPATED WITHIN A REASONABLE TIME FRAME, AS DETERMINED BY THE ENGINEER, SHALL NOT BE PERMITTED. THE LEVEL OF UTILIZATION OF MAINTENANCE OF TRAFFIC DEVICES SHALL BE COMMENSURATE WITH THE WORK IN PROGRESS.

ALL WORK AND TRAFFIC CONTROL DEVICES SHALL BE IN ACCORDANCE WITH C&MS 614 AND OTHER APPLICABLE PORTIONS OF THE SPECIFICATIONS, AS WELL AS THE OHIO MANUAL OF UNIFORM TRAFFIC CONTROL DEVICES. PAYMENT FOR ALL LABOR, EQUIPMENT AND MATERIALS SHALL BE INCLUDED IN THE LUMP SUM CONTRACT PRICE FOR ITEM 614, MAINTAINING TRAFFIC, UNLESS SEPARATELY ITEMIZED IN THE PLAN.

ITEM 611, CATCH BASIN RECONSTRUCTED TO GRADE, AS PER PLAN

THIS WORK CONSISTS OF REMOVING THE UPPER PORTION OF THE EXISTING CATCH BASIN, COVERING THE OPENING WITH A STEEL PLATE SUITABLE FOR TRAFFIC, THEN WHEN TRAFFIC IS RETURNED TO THE ORIGINAL TRAFFIC PATTERN RECONSTRUCT THE CATCH BASIN TO MEET THE REQUIREMENTS OF CATCH BASIN NO. 3 OR 3A, AS APPROPRIATE.

REMOVED PORTIONS SHALL INCLUDE THE CURB AND CASTINGS, AND IF NECESSARY THE FRAME, GRATE(S), AND STEEL BEAM.

COVER THE INLET WITH A STEEL PLATE SUITABLE FOR TRAFFIC. PLATES SHALL BE 1" MINIMUM THICKNESS IN SMOOTH CONDITION WITHOUT BOWS OR ROUGH EDGES. PLATES SHALL BE RECESSED TO FIT NEATLY IN THE PAVEMENT AS SHOWN ON THE SKETCH ON SHEET 18 SUITABLE FOR PASSAGE OF TRAFFIC AND SNOW REMOVAL EQUIPMENT.

RECONSTRUCT CATCH BASIN ACCORDING TO SCD CB-2.1 OR CB-2.2 AS APPROPRIATE. IF EXISTING CONCRETE WAS SAWCUT AND/OR BROKEN, PROVIDE STEEL DOWELS HAVING DIAMETER >=0.5", LENGTH >=8" (HALF EMBEDDED), SPACING <=18".

ALL MATERIALS, EQUIPMENT, LABOR, AND INCIDENTALS REQUIRED TO PERFORM THIS WORK SHALL BE INCLUDED IN THE PRICE BID PER EACH FOR ITEM 611, CATCH BASIN RECONSTRUCTED TO GRADE, AS PER PLAN.

ITEM 615, PAVEMENT FOR MAINTAINING TRAFFIC, CLASS B

THIS WORK SHALL INCLUDE ANY NEEDED RESTORATION OF PERMANENT FLEXIBLE PAVEMENT ALONG THE OUTSIDE EDGES OF FIELDS ERTEL ROAD. CONCRETE CURB AND GUTTER SHALL BE REPLACED IN THE SAME LOCATION AS ORIGINAL AND SHALL BE SEPARATELY ITEMIZED.

ALL MATERIALS, EQUIPMENT, LABOR, AND INCIDENTALS REQUIRED TO PERFORM THIS WORK SHALL BE INCLUDED IN THE PRICE BID PER SQUARE YARD FOR ITEM 615, PAVEMENT FOR MAINTAINING TRAFFIC, CLASS B, UNLESS OTHERWISE INCLUDED IN THESE PLANS.

PLACEMENT OF ASPHALT CONCRETE

TRAFFIC SHALL BE MAINTAINED AT ALL TIMES EXCEPT THAT LANE RESTRICTIONS WILL BE PERMITTED FOR MINIMUM PERIODS OF TIME CONSISTENT WITH THE REQUIREMENTS OF THE SPECIFICATIONS FOR PROTECTION OF COMPLETED ASPHALT CONCRETE COURSES.

TRENCH FOR WIDENING

TRENCH EXCAVATION FOR BASE WIDENING SHALL BE ONLY ON ONE SIDE OF THE PAVEMENT AT A TIME. THE OPEN TRENCH SHALL BE ADEQUATELY MAINTAINED AND PROTECTED WITH DRUMS OR BARRICADES AT ALL TIMES. PLACEMENT OF PROPOSED SUBBASE AND BASE MATERIAL SHALL FOLLOW AS CLOSELY AS POSSIBLE BEHIND EXCAVATION OPERATIONS. THE LENGTH OF WIDENING TRENCH WHICH IS OPEN AT ANY ONE TIME SHALL BE HELD TO A MINIMUM AND SHALL AT ALL TIMES BE SUBJECT TO APPROVAL OF THE ENGINEER.

OVERNIGHT TRENCH CLOSING

THE BASE WIDENING SHALL BE COMPLETED TO A DEPTH OF NO MORE THAN 13.25 INCHES BELOW THE EXISTING PAVEMENT BY THE END OF EACH WORK DAY. NO TRENCH SHALL BE LEFT OPEN OVERNIGHT EXCEPT FOR A SHORT LENGTH (25 FEET OR LESS) OF A WORK SECTION AT THE END OF THE TRENCH. IN CASE WORK MUST BE SUSPENDED BECAUSE OF INCLEMENT WEATHER OR OTHER REASONS, THE TRENCH FOR THE UNCOMPLETED BASE WIDENING SHALL BE BACKFILLED AT THE DIRECTION OF THE ENGINEER.

DUST CONTROL

THE CONTRACTOR SHALL FURNISH AND APPLY WATER FOR DUST CONTROL AS DIRECTED BY THE ENGINEER. THE FOLLOWING ESTIMATED QUANTITIES HAVE BEEN INCLUDED FOR DUST CONTROL PURPOSES:

ITEM 616, WATER 30 M. GAL.

WORK ZONE MARKINGS AND SIGNS

THE FOLLOWING ESTIMATED QUANTITIES HAVE BEEN CARRIED TO THE GENERAL SUMMARY FOR USE AT LOCATIONS IDENTIFIED BY THE ENGINEER FOR WORK ZONE PAVEMENT MARKINGS AND SIGNS PER THE REQUIREMENTS OF C&MS 614.04 AND 614.11.

ITEM 614 WORK ZONE LANE LINE, 4", 0.25 MILE
ITEM 614 WORK ZONE EDGE LINE, 4", 0.50 MILE
ITEM 614 WORK ZONE CENTERLINE, 0.10 MILE
ITEM 614 WORK ZONE, CHANNELIZING LINE, 1,000 FT

FLOODLIGHTING

FLOODLIGHTING OF THE WORK SITE FOR OPERATIONS CONDUCTED DURING NIGHTTIME PERIODS SHALL BE ACCOMPLISHED SO THAT THE LIGHTS DO NOT CAUSE GLARE TO THE DRIVERS ON THE ROADWAY. TO ENSURE THE ADEQUACY OF THE FLOODLIGHT PLACEMENT, THE CONTRACTOR AND THE ENGINEER SHALL DRIVE THROUGH THE WORK SITE EACH NIGHT WHEN THE LIGHTING IS IN PLACE AND OPERATIVE PRIOR TO COMMENCING ANY WORK. IF GLARE IS DETECTED, THE LIGHT PLACEMENT AND SHIELDING SHALL BE ADJUSTED TO THE SATISFACTION OF THE ENGINEER BEFORE WORK PROCEEDS.

PAYMENT FOR ALL LABOR, EQUIPMENT AND MATERIALS SHALL BE INCLUDED IN THE LUMP SUM CONTRACT PRICE FOR ITEM 614, MAINTAINING TRAFFIC.

ITEM 614, WORK ZONE IMPACT ATTENUATOR FOR MORE THAN 24" WIDE BUT LESS THAN 36" HAZARDS. HAZARDS (UNIDIRECTIONAL OR BIDIRECTIONAL)

THIS ITEM SHALL CONSIST OF FURNISHING AND INSTALLING A NON GATING IMPACT ATTENUATOR. FURNISH AN IMPACT ATTENUATOR FROM THE OFFICE OF ROADWAY ENGINEERING'S APPROVED LIST FOR WORK ZONE IMPACT ATTENUATORS, FROM THE ROADWAY STANDARDS APPROVED PRODUCTS WEB PAGE.

INSTALLATION SHALL BE AT THE LOCATIONS SPECIFIED IN THE PLANS IN ACCORDANCE WITH THE MANUFACTURER'S SPECIFICATIONS.

THE CONTRACTOR SHALL REPAIR OR REPLACE A DAMAGED UNIT WITHIN 24 HOURS OF A DAMAGING IMPACT.

WHEN BIDIRECTIONAL DESIGNS ARE SPECIFIED, THE CONTRACTOR SHALL SUPPLY APPROPRIATE TRANSITIONS.

WHEN GATING IMPACT ATTENUATORS ARE DESIRED, THE CONTRACTOR SHALL SUBMIT DOCUMENTATION TO THE ENGINEER FOR ACCEPTANCE.

THE COST FOR THE ADDITIONAL BARRIER REQUIRED FOR A GATING IMPACT ATTENUATOR SHALL BE INCLUDED IN THE COST OF THE GATING IMPACT ATTENUATOR.

PAYMENT FOR THE ABOVE WORK SHALL BE MADE AT THE UNIT PRICE BID AND SHALL INCLUDE ALL LABOR, TOOLS, EQUIPMENT AND MATERIALS NECESSARY TO CONSTRUCT AND MAINTAIN A COMPLETE AND FUNCTIONAL IMPACT ATTENUATOR SYSTEM, INCLUDING ALL RELATED BACKUPS, TRANSITIONS, LEVELING PADS, HARDWARE AND GRADING, NOT SEPARATELY SPECIFIED, AS REQUIRED BY THE MANUFACTURER.

ITEM 614, WORK ZONE IMPACT ATTENUATOR OVER 24" AND LESS THAN 36" HAZARDS, BIDIRECTIONAL, AS PER PLAN (GATING).

THIS ITEM SHALL CONSIST OF FURNISHING AND INSTALLING A GATING IMPACT ATTENUATOR. FURNISH AN IMPACT ATTENUATOR FROM THE OFFICE OF ROADWAY ENGINEERING'S APPROVED LIST FOR WORK ZONE IMPACT ATTENUATORS, FROM THE ROADWAY STANDARDS APPROVED PRODUCTS WEB PAGE.

INSTALLATION SHALL BE AT THE LOCATION SPECIFIED IN THE PLANS IN ACCORDANCE WITH THE MANUFACTURER'S SPECIFICATIONS.

L:\DCS\Projects\TRN\60546197_WCTDFEINT\0DOT\104844\Design\W0T\Sheets\104844_MN002.dgn Sheet 5/7/2021 2:47:37 PM dave.wormaid

CALCULATED
CAL
CHECKED
DLW

MAINTENANCE OF TRAFFIC GENERAL NOTES

HAM / WAR-71
19.83 / 0.00

L:\DCS\Projects\TRN\6054697_WCTDFEINT\000T\04844\Design\Roadway\Sheets\104844_G600.dgn Sheet 5/10/2021 2:54:47 PM dave.wormald

SHEET NUM.										PART.			ITEM	ITEM EXT	GRAND TOTAL	UNIT	DESCRIPTION	SEE SHEET NO.
28	29	71	130							01MPOOT	02ENHOT							
ROADWAY																		
LS										LS			201	11000	LS		CLEARING AND GRUBBING	
2										2			202	20010	2	EACH	HEADWALL REMOVED	
22										22			202	23000	22	SY	PAVEMENT REMOVED	
360											360		202	30000	360	SF	WALK REMOVED	
55										55			202	30700	55	FT	CONCRETE BARRIER REMOVED	
287										287			202	32000	287	FT	CURB REMOVED	
465										465			202	32500	465	FT	CURB AND GUTTER REMOVED	
93										93			202	34900	93	FT	PIPE REMOVED	
601										601			202	38000	601	FT	GUARDRAIL REMOVED	
2										2			202	58200	2	EACH	INLET REMOVED	
			835							835			202	75000	835	FT	FENCE REMOVED	
61										61			202	98200	61	FT	REMOVAL MISC.: PAVED GUTTER	28
2,397		79								2,476			203	10000	2,476	CY	EXCAVATION	
23,096										23,096			203	20000	23,096	CY	EMBANKMENT	
		118								118			203	35120	118	CY	GRANULAR MATERIAL, TYPE C	11
2										2			SPECIAL	20365000	2	EACH	SETTLEMENT PLATFORM	11
2										2			204	45000	2	HOUR	PROOF ROLLING	
		768								768			204	50000	768	SY	GEOTEXTILE FABRIC	
149										149			206	10500	149	TON	CEMENT	
5,754										5,754			206	11000	5,754	SY	CURING COAT	
5,754										5,754			206	15010	5,754	SY	CEMENT STABILIZED SUBGRADE, 12 INCHES DEEP	
LS										LS			206	30000	LS		MIXTURE DESIGN FOR CHEMICALLY STABILIZED SOILS	
	1,038									1,038			606	15050	1,038	FT	GUARDRAIL, TYPE MGS	
	2									2			606	26150	2	EACH	ANCHOR ASSEMBLY, MGS TYPE E MASH 2016	
	1									1			606	26550	1	EACH	ANCHOR ASSEMBLY, MGS TYPE T	
	2									2			606	35002	2	EACH	MGS BRIDGE TERMINAL ASSEMBLY, TYPE 1	
	1									1			606	35102	1	EACH	MGS BRIDGE TERMINAL ASSEMBLY, TYPE 2	
	1									1			606	60028	1	EACH	IMPACT ATTENUATOR, TYPE 2 (BIDIRECTIONAL)	
			718							718			607	23000	718	FT	FENCE, TYPE CLT	
	2,495										2,495		608	10000	2,495	SF	4" CONCRETE WALK	
	428										428		608	52000	428	SF	CURB RAMP	
	148									148			622	10060	148	FT	CONCRETE BARRIER, SINGLE SLOPE, TYPE B	
	1									1			622	24841	1	EACH	CONCRETE BARRIER END SECTION, TYPE B, AS PER PLAN	67
										4			623	38500	4	EACH	MONUMENT ASSEMBLY	132
		1,745								1,745			863	00100	1,745	SY	GEOGRID, TYPE P1	
		462								462			863	00600	462	SY	GEOGRID, TYPE S1	
		1,295								1,295			863	00800	1,295	CY	REINFORCED EMBANKMENT	
LS										LS			878	25000	LS		INSPECTION AND COMPACTION TESTING OF UNBOUND MATERIALS	

GENERAL SUMMARY

HAM / WAR-71
19.83 / 0.00

L:\DCS\Projects\TRN\6054697_WCTDFEINT\000T\04844\Design\Roadway\Sheets\104844_G6002.dgn Sheet 5/10/2021 9:54:41 AM dave.wormald

SHEET NUM.											PART.		ITEM	ITEM EXT	GRAND TOTAL	UNIT	DESCRIPTION	SEE SHEET NO.	CALCULATED CAL	CHECKED	SCC
30	31	32	71								01MPOOT	02ENHOT									
											EROSION CONTROL										
		1.8									1.8		601	21050	1.8	SY	TIED CONCRETE BLOCK MAT WITH TYPE 1 UNDERLAYMENT				
9											13		601	21060	13	SY	TIED CONCRETE BLOCK MAT WITH TYPE 2 UNDERLAYMENT	9			
9											9		601	32200	9	CY	ROCK CHANNEL PROTECTION, TYPE C WITH FILTER				
20											20		601	32300	20	CY	ROCK CHANNEL PROTECTION, TYPE D WITH FILTER				
287											287		601	37500	287	FT	PAVED GUTTER, TYPE 1-2				
139											139		601	38400	139	FT	PAVED GUTTER, TYPE 2				
148											148		601	39500	148	FT	PAVED GUTTER, TYPE 5				
											62		616	10000	62	MGAL	WATER			10	
											2		659	00100	2	EACH	SOIL ANALYSIS TEST			10	
67											1,299		659	00300	1,299	CY	TOPSOIL			10	
			435								435		659	00530	435	SY	SEEDING AND MULCHING, CLASS 3B				
											11,533		659	10000	11,533	SY	SEEDING AND MULCHING			10	
											576		659	14000	576	SY	REPAIR SEEDING AND MULCHING			10	
											1.5		659	20000	1.5	TON	COMMERCIAL FERTILIZER			10	
											2.38		659	31000	2.38	ACRE	LIME				
											25		659	40000	25	MSF	MOWING				
600			435								1,035		670	00500	1,035	SY	SLOPE EROSION PROTECTION				
271											271		670	00700	271	SY	DITCH EROSION PROTECTION				
270											270		670	00710	270	SY	DITCH EROSION PROTECTION MAT, TYPE A				
											LS		832	15000	LS		STORM WATER POLLUTION PREVENTION PLAN				
											LS		832	15002	LS		STORM WATER POLLUTION PREVENTION INSPECTIONS				
											LS		832	15010	LS		STORM WATER POLLUTION PREVENTION INSPECTION SOFTWARE				
											74,280		832	30000	74,280	EACH	EROSION CONTROL				
											DRAINAGE										
	2										2		602	20000	2	CY	CONCRETE MASONRY				
		3,415									3,415		605	14000	3,415	FT	6" BASE PIPE UNDERDRAINS				
		377									387		611	00510	387	FT	6" CONDUIT, TYPE F FOR UNDERDRAIN OUTLETS			9	
		21									31		611	01500	31	FT	6" CONDUIT, TYPE F			9	
		1									2		611	99710	2	EACH	PRECAST REINFORCED CONCRETE OUTLET			9	
	46										46		611	04600	46	FT	12" CONDUIT, TYPE C				
	12										12		611	05200	12	FT	12" CONDUIT, TYPE F				
	185										185		611	05900	185	FT	15" CONDUIT, TYPE B				
	47										47		611	06100	47	FT	15" CONDUIT, TYPE C				
	65										65		611	06700	65	FT	15" CONDUIT, TYPE F, 707.05 TYPE C OR 707.21				
	249										249		611	07400	249	FT	18" CONDUIT, TYPE B				
	81										81		611	13400	81	FT	30" CONDUIT, TYPE B				
	663										663		611	16400	663	FT	36" CONDUIT, TYPE B				
	24										24		611	16600	24	FT	36" CONDUIT, TYPE C				
	173										173		611	22600	173	FT	54" CONDUIT, TYPE C				
	24										24		611	23800	24	FT	60" CONDUIT, TYPE B				
	8										8		611	53104	8	FT	43" X 68" CONDUIT, TYPE C, 706.04				
	26										26		611	97010	26	FT	SLOTTED DRAIN, TYPE 2 (15")				
	2										2		611	98150	2	EACH	CATCH BASIN, NO. 3				
	2										2		611	98180	2	EACH	CATCH BASIN, NO. 3A				
	2										2		611	98370	2	EACH	CATCH BASIN, NO. 6				
	2										2		611	98450	2	EACH	CATCH BASIN, NO. 2-2A				
	6										6		611	99574	6	EACH	MANHOLE, NO. 3				
	4										4		611	99155	4	EACH	INLET RECONSTRUCTED TO GRADE, AS PER PLAN			13	
	2										2		611	99654	2	EACH	MANHOLE ADJUSTED TO GRADE				

GENERAL SUMMARY

HAM / WAR-71
19.83 / 0.00

SHEET NUM.											PART.		ITEM	ITEM EXT	GRAND TOTAL	UNIT	DESCRIPTION	SEE SHEET NO.	CALCULATED	CAL	CHECKED	SCC
29	33	81	82	95	97						01MPOOT	02ENHOT										
												PAVEMENT										
	92										92		254	01000	92	SY	PAVEMENT PLANING, ASPHALT CONCRETE 1.5"					
	3,035										3,035		254	01000	3,035	SY	PAVEMENT PLANING, ASPHALT CONCRETE VARIABLE DEPTH					
	853										853		302	46000	853	CY	ASPHALT CONCRETE BASE, PG64-22					
	1,138										1,138		304	20000	1,138	CY	AGGREGATE BASE					
	438										438		407	10000	438	GAL	TACK COAT					
	289										289		442	20000	289	CY	ASPHALT CONCRETE SURFACE COURSE, 12.5 MM, TYPE A (448)					
	151										151		442	20200	151	CY	ASPHALT CONCRETE INTERMEDIATE COURSE, 19 MM, TYPE A (448)					
	2,329										2,329		452	12010	2,329	SY	8" NON-REINFORCED CONCRETE PAVEMENT, CLASS QC 1P					
1,583											1,583		609	12000	1,583	FT	COMBINATION CURB AND GUTTER, TYPE 2					
480											480		609	23001	480	FT	COMBINATION CURB AND GUTTER, TYPE 4, AS PER PLAN				10	
29											29		609	24510	29	FT	CURB, TYPE 4-C					
265											265		609	30001	265	FT	CURB, TYPE 8, AS PER PLAN				10	
		1,021									1,021		618	40100	1,021	FT	RUMBLE STRIPS, SHOULDER (ASPHALT CONCRETE)					
	5										5		617	10100	5	CY	COMPACTED AGGREGATE					
											LS		SPECIAL	69098400	LS		CONSULTANT FOR CONCRETE QUALITY CONTROL INCLUDING TESTING AND INSPECTION				10	
												LIGHTING										
					8						8		625	00450	8	EACH	CONNECTION, FUSED PULL APART					
					2						2		625	00460	2	EACH	CONNECTION, UNFUSED PULL APART					
					6						6		625	00480	6	EACH	CONNECTION, UNFUSED PERMANENT					
					3						3		625	10490	3	EACH	LIGHT POLE, CONVENTIONAL					
					3						3		625	14000	3	EACH	LIGHT POLE FOUNDATION, 24" X 6' DEEP					
					2						2		625	18200	2	EACH	BRACKET ARM, 15'					
					735						735		625	23400	735	FT	NO. 10 AWG POLE AND BRACKET CABLE					
					1,652						1,652		625	24000	1,652	FT	1-1/2" DUCT CABLE WITH TWO NO. 4 AWG 600 VOLT CABLES					
					62						62		625	25500	62	FT	CONDUIT, 3", 725.04					
					62						62		625	25900	62	FT	CONDUIT, JACKED OR DRILLED, 3"					
					8						8		625	26252	8	EACH	LUMINAIRE, CONVENTIONAL, SOLID STATE (LED), 150W					
					1,530						1,530		625	29002	1,530	FT	TRENCH, 24" DEEP					
					3						3		625	30706	3	EACH	PULL BOX, 725.08, 24"					
					3						3		625	32000	3	EACH	GROUND ROD					
					1						1		625	34001	1	EACH	POWER SERVICE, AS PER PLAN				96	
					1,592						1,592		625	36010	1,592	FT	UNDERGROUND WARNING/MARKING TAPE					
					2						2		625	39520	2	EACH	PULL BOX CLEANED					
					LS						LS		SPECIAL	62540000	LS		MAINTAIN EXISTING LIGHTING				95	
					3						3		625	75506	3	EACH	LUMINAIRE REMOVED					
					1						1		625	75801	1	EACH	DISCONNECT CIRCUIT, AS PER PLAN				96	
					1						1		632	89300	1	EACH	WOOD POLE					
												TRAFFIC SURVEILLANCE										
					235						235		625	25752	235	FT	CONDUIT, 4", MULTICELL, 725.20 , EPC-80, AS PER PLAN				92	
					1						1		625	25930	1	EACH	CONDUIT, MISC.:CONDUIT REMOVED				92	
					44						44		625	29000	44	FT	TRENCH					
					1						1		625	30700	1	EACH	PULL BOX, 725.08, 18"					
					2						2		625	30710	2	EACH	PULL BOX, 725.08, 32"					
					1						1		625	31510	1	EACH	PULL BOX REMOVED					
					1						1		625	32000	1	EACH	GROUND ROD					
					44						44		625	36010	44	FT	UNDERGROUND WARNING/MARKING TAPE				92	
					1						1		625	39520	1	EACH	PULL BOX CLEANED					
					1						1		633	67100	1	EACH	CABINET FOUNDATION					
					1						1		633	67200	1	EACH	CONTROLLER WORK PAD					
					1						1		804	30000	1	EACH	FAN-OUT KIT, 6 FIBER					
					2						2		804	32000	2	EACH	DROP CABLE, 6 FIBER					
					4						4		804	35000	4	EACH	FUSION SPLICE					
					1						1		809	60040	1	EACH	CCTV IP-CAMERA SYSTEM, QUAD MULTI-VIEW FIXED WITH PTZ					
					1						1		809	65000	1	EACH	ITS CABINET - GROUND MOUNTED					

GENERAL SUMMARY

**HAM / WAR-71
19.83 / 0.00**

L:\DCS\Projects\TRN\6054697_WCTDFEINT\000T\04844\Design\Roadway\Sheets\04844_G6003.dgn Sheet 5/10/2021 11:33:29 AM dave.wormald

SHEET NUM.											PART.		ITEM	ITEM EXT	GRAND TOTAL	UNIT	DESCRIPTION	SEE SHEET NO.	CALCULATED CAL	CHECKED DLW
16											01MPOOT	02ENHOT								
																	FOR STRUCTURE HAM 71 19.83 GENERAL SUMMARY SEE SHEET 102			
																	MAINTENANCE OF TRAFFIC			
200											200		614	1110	200	HOUR	LAW ENFORCEMENT OFFICER WITH PATROL CAR FOR ASSISTANCE			
											1,461		614	11630	1,461	FT	INCREASED BARRIER DELINEATION			13
5											5		614	12394	5	EACH	WORK ZONE IMPACT ATTENUATOR, OVER 24" AND LESS THAN 36" WIDE HAZARDS, (BIDIRECTIONAL)			16
1											1		614	12400	1	EACH	WORK ZONE IMPACT ATTENUATOR, OVER 24" AND LESS THAN 36" WIDE HAZARDS, AS PER PLAN, GATING			16
LS											LS		614	12420	LS	LS	DETOUR SIGNING			
462											462		614	12800	462	EACH	WORK ZONE RAISED PAVEMENT MARKER			
											5		614	13000	5	CY	ASPHALT CONCRETE FOR MAINTAINING TRAFFIC			10
											15		614	13310	15	EACH	BARRIER REFLECTOR, TYPE 1 ONE-WAY			15
											15		614	13350	15	EACH	OBJECT MARKER, ONE WAY			15
12											12		614	18601	12	SNMT	PORTABLE CHANGEABLE MESSAGE SIGN, AS PER PLAN			14
0.25											0.5		614	20000	0.5	MILE	WORK ZONE LANE LINE, CLASS I, 4"			13
											0.77		614	20010	0.77	MILE	WORK ZONE LANE LINE, CLASS I, 6"			13
0.32											0.57		614	21000	0.57	MILE	WORK ZONE CENTER LINE, CLASS I			13
0.1											0.1		614	22010	0.1	MILE	WORK ZONE EDGE LINE, CLASS I, 6"			
3,252											4,252		614	23000	4,252	FT	WORK ZONE CHANNELIZING LINE, CLASS I, 8"			13
225											225		614	24000	225	FT	WORK ZONE DOTTED LINE, CLASS I			
											44		614	26000	44	FT	WORK ZONE STOP LINE, CLASS I			
LS											LS		615	10000	LS		ROADS FOR MAINTAINING TRAFFIC			13
448											448		615	20000	448	SY	PAVEMENT FOR MAINTAINING TRAFFIC, CLASS A			
766											766		615	25000	766	SY	PAVEMENT FOR MAINTAINING TRAFFIC, CLASS B			13
											30		616	10000	30	MGAL	WATER			13
2,796											2,796		622	41100	2,796	FT	PORTABLE BARRIER, UNANCHORED			
																	INCIDENTALS			
											LS		614	11001	LS		MAINTAINING TRAFFIC, AS PER PLAN			13
											22		619	16011	22	MNTH	FIELD OFFICE, TYPE B, AS PER PLAN			9
											LS		623	10000	LS		CONSTRUCTION LAYOUT STAKES AND SURVEYING			
											LS		624	10000	LS		MOBILIZATION			

L:\DCS\Projects\TRN\6054697_WCTDFEINT\000T\04844\Design\Roadway\Sheets\04844_G6006.dgn Sheet 5/7/2021 3:46:44 PM dave.wormald

GENERAL SUMMARY

**HAM / WAR-71
19.83 / 0.00**

L:\DCS\Projects\TRN\6054697_WCTIDFEINT\0DOT\104844\Design\Roadway\Sheets\104844_GS002.dgn Sheet 5/10/2021 12:29:05 PM dave.wormald

REF NO.	SHEET NO.	STATION TO STATION				201	202	202	202	202	202	202	202	630	203	203	SPECIAL	202	202	204	206	206	206	206	
						CLEARING AND GRUBBING	PAVEMENT REMOVED	WALK REMOVED	CONCRETE BARRIER REMOVED	CURB REMOVED	CURB AND GUTTER REMOVED	GUARDRAIL REMOVED	INLET REMOVED	PIPE REMOVED	REMOVAL OF WOOD POLE AND DISPOSAL	EXCAVATION	EMBANKMENT	SETTLEMENT PLATFORM	HEADWALL REMOVED	REMOVAL MISC.-PAVED GUTTER	PROOF ROLLING	CEMENT STABILIZED SUBGRADE, 12 INCHES DEEP	MIXTURE DESIGN FOR CHEMICALLY STABILIZED SOILS	CEMENT	CURING COAT
					LS	SY	SF	FT	FT	FT	FT	EACH	FT	EACH	CY	CY	EACH	EACH	FT	HOUR	SY	LS	TON	SY	
					1																				
R1	37	1000+38	RT	1005+72								536													
R2	37	1003+82	LT	1004+20															61						
R3	37	1003+83	LT	1004+12														1							
R4	39	1005+25	LT	1006+15									44												
R5	39	1005+25	LT	1005+25														1							
R6	41	1012+21	LT	1012+50		2.6																			
R7	41	1014+67	LT	1014+67																					
R8	41	51+85	LT	52+66					113																
R9	41	50+39	LT	51+03							65														
R10	41	50+68	LT	51+27			290																		
R11	41	52+04	LT	52+04								1													
R12	41	50+38	LT	54+56						465															
R13	44	52+62	LT	52+62																					
R14	44	53+34	LT	54+49					129																
R15	44	53+54	LT	53+90								1													
R16	41	51+95	LT	53+86																					
R17	44	53+94	LT	53+94																					
R18	44	54+01	LT	54+56		19			45																
R19	44	54+35	LT	54+48			70																		
R20	41	51+39	LT	51+05								49													
R21	41	1013+07	RT	1013+07									1												
R22	41	51+44	LT	51+44									1												
R23	45	18+28	RT	18+84				55																	
SP-1	41	1005+00	LT	1005+00													1								
SP-2	41	1009+00	LT	1009+00													1								
RAMP C	41	1008+44.85		1008+69.85																			115	3	115
	35,37,39	997+90.00		1005+26.21															1		2059		53	2059	
	39,41	1005+26.21		1005+51.21																	120		3	120	
	41	1008+19.85		1008+44.85																	114		3	114	
	41,43	1008+69.85		1014+69.51															1		2689		70	2689	
MMR	41,43	50+37.51	LT	51+25.54																					
	43	51+25.54	LT	54+56.18																			657	17	657
FE	45	17+79.29	RT	18+86.42																					
RAMP C	46	997+90		999+00										182	11										
	47	999+50		1001+00										155	643										
	48	1005+50		1002+50										292	1382										
	49	1003+00		1004+00										427	2889										
	50	1004+50		1005+00										124	2670										
	51	1005+50		1006+00										29	760										
	52	1006+50		1007+00										0	0										
	53	1007+50		1008+00										35	2819										
	54	1008+50		1009+00										7	4015										
	55	1009+50		1010+00										16	3187										
	56	1010+50		1111+00										25	2548										
	57	1111+50		1012+00										56	1625										
	58	1012+50		1013+00										83	487										
	59	1013+50		1014+50										298	44										
MMR																									
	60	50+00	LT	51+00										129	15										
	61	51+50	LT	52+50										327											
	62	53+00	LT	54+50										212											
TOTALS CARRIED TO GENERAL SUMMARY					1	22	360	55	287	465	601	2	93	2	2397	23096	2	2	61	2	5754	LS	149	5754	

<p>ROADWAY SUBSUMMARY</p>	<p>HAM / WAR-71 19.83 / 0.00</p>
<p>CALCULATED CAL CHECKED SCC</p>	<p>28 146</p>

L:\DCS\Projects\TRN\6054697_WCTDFEINT\0DOT\04844\Design\Roadway\Sheets\04844_G5003.dgn Sheet 5/10/2021 12:29:04 AM dave.wormaid

REF NO.	SHEET NO.	STATION TO STATION				606	606	606	606	606	606	608	608	609		609	609	609	622		622				
						GUARDRAIL, TYPE MGS	ANCHOR ASSEMBLY, MGS TYPE E	ANCHOR ASSEMBLY, MGS TYPE T	MGS BRIDGE TERMINAL ASSEMBLY, TYPE 1	MGS BRIDGE TERMINAL ASSEMBLY, TYPE 2	IMPACT ATTENUATOR, TYPE 2 (BIDIRECTIONAL)	4" CONCRETE WALK	CURB RAMP	COMBINATION CURB AND GUTTER, TYPE 2		COMBINATION CURB AND GUTTER, TYPE 4, AS PER PLAN	CURB, TYPE 4-C	CURB, TYPE 8, AS PER PLAN	CONCRETE BARRIER, SINGLE SLOPE, TYPE B		CONCRETE BARRIER END SECTION, TYPE B, AS PER PLAN				
				TO	FT	EACH	EACH	EACH	EACH	EACH	SF	SF	FT		FT	FT	FT	FT		EACH					
C-1	39	1005+10.04	LT	1005+13.56																					
C-2	39	1008+69.85	LT	1013+50.31											480	4									
C-3	41	1014+10.00	RT/LT	50+37.87									156												
C-4	41	1014+15.83	LT	54+24.24									323												
C-11	39	1008+44.85	LT	1008+69.85												25									
C-5	42	51+75.00	LT	54+00.00													229								
C-6	44	54+39.99	LT	54+54.43									42												
C10	44	54+01.00	LT	54+01.00													36								
C-7	45	15+00.00	RT	21+19.00										620											
C-8	45	16+36.00	LT	17+11.00										75											
C-9	45	17+55.00	LT	21+19.00										367											
G-1	35	1000+27.50	LT	1005+15.56	475		1		1																
G-2	37	1008+30.90	LT	1013+79.63	475	1		1																	
G-3	37	1008+60.46	RT	1010+23.42	87.5	1		1																	
W-1	41	1014+06.00	RT								99														
W-2	41	1014+06.00	RT									101													
W-3	41	1014+06.00	LT									152													
W-4	44	1014+15.75	LT	54+23.12							2396														
W-5	44	54+36.51	LT									175													
AU1	45	17+60.42	RT							1															
B-1	45	17+79.42	RT	18+09.42																	1				
B-2	45	18+09.42	RT	18+83.63																		148			
TOTALS CARRIED TO GENERAL SUMMARY					1038	2	1	2	1	1	2495	428	1583		480	29	265	148		1					

<p>HAM / WAR-71 19.83 / 0.00</p>	<p>ROADWAY SUBSUMMARY</p>
<p>29 146</p>	<p>CALCULATED CAL CHECKED SCC</p>

L:\DCS\Projects\TRN\60546197_wctidfeint\000T\04844\Design\Drainage\Sheets\04844_DS003.dgn - 5/6/2021 4:54:32 PM - christopher.yjkins

REF NO.	SHEET NO.	STATION TO STATION				602	611	611	611	611	611	611	611	611	611	611	611	611	611	611	611	611	611	611	611
						CONCRETE MASONRY	12" CONDUIT, TYPE C	12" CONDUIT, TYPE F	15" CONDUIT, TYPE B	15" CONDUIT, TYPE C	15" CONDUIT, TYPE F, 707.05 TYPE C OR 707.21	18" CONDUIT, TYPE B	30" CONDUIT, TYPE B	36" CONDUIT, TYPE B	36" CONDUIT, TYPE C	54" CONDUIT, TYPE C	60" CONDUIT, TYPE B	43" X 68" CONDUIT, TYPE C, 706.04	SLOTTED DRAIN, TYPE 2 (15")	CATCH BASIN, NO. 3	CATCH BASIN, NO. 3A	CATCH BASIN, NO. 6	CATCH BASIN, NO. 2-2A	MANHOLE, NO. 3	INLET RECONSTRUCTED TO GRADE, AS PER PLAN
					CY	FT	FT	FT	FT	FT	FT	FT	FT	FT	FT	FT	FT	EACH	EACH	EACH	EACH	EACH	EACH	EACH	
D3	44	54+19.00	LT	52+86.00	LT																				
D4	41	52+86.00	LT	51+70.00	LT																				
D5	41	51+70.61	LT																						
D6	41	51+38.75	LT	1013+90.00	RT																				
D9	41	1014+97.92	LT	1014+70.47	LT																				
D10	41	1014+70.47	LT	1014+21.25	LT																				
D11	41	1014+21.25	LT	1013+90.00	LT																				
D12	41	1013+90.00	RT	1013+90.00	LT																				
D13	41	1013+90.00	LT	1012+00.00	LT																				
D14	41	1013+90.00	LT	1013+90.00	LT																				
D15	41	1013+90.00	RT	1013+90.00	RT																				
D16	41	1012+00.00	LT	1012+00.00	LT																				
D17	41	1012+00.00	LT	1009+30.00	LT																				
D18	41	1012+00.00	RT	1012+00.00	LT																				
D19	39	1010+03.00	RT	1010+03.00	RT	0.21																			
D20	39	1009+30.00	LT	1007+61.74	LT	0.76																			
D21	39	1005+80.00	LT	1004+04.15	LT																				
D22	39	1006+17.50	LT	1005+80.00	LT																				
D23	39	1005+87.00	LT	1005+80.00	LT																				
D24	37	1004+04.15	LT	1003+96.00	LT																				
D25	37	1004+04.23	LT	1004+04.15	LT	0.76																			
D26	39	1005+61.60	RT	1005+35.60	RT																				
D27	39	1005+35.60	RT	1005+07.30	LT																				
D28	39	1005+07.30	LT	1005+06.10	LT	0.27																			
D29	45	17+07	LT	17+07	LT																				
D30	45	19+04	LT	19+04	LT																				
D31	45	17+75	RT	17+75	RT																				
D32	45	18+75	RT	18+75	RT																				
TOTALS CARRIED TO GENERAL SUMMARY						2	46	12	185	47	65		249		81	663	24	173	24	8	26	2	2	2	2

DRAINAGE SUBSUMMARY	HAM / WAR-71 19.83 / 0.00
CALCULATED JNR CHECKED SCC	<div style="border: 1px solid black; border-radius: 50%; width: 30px; height: 30px; display: flex; align-items: center; justify-content: center; margin: 0 auto;"> 31 146 </div>



10 HORIZONTAL SCALE IN FEET

CALCULATED
CAL
CHECKED
SCC

PLAN - RAMP C
STA. 1004+50 - STA. 1010+50

HAM / WAR-71
19.83 / 0.00

39
146

RAMP C	RAMP C
P.I. Sta. 1004+25.04	P.I. Sta. 1010+56.24
$\Delta = 3^\circ 12' 04''$ (LT)	$\Delta = 4^\circ 00' 41''$ (RT)
$D_c = 1^\circ 59' 59''$	$D_c = 1^\circ 59' 59''$
$R = 2,865.00'$	$R = 2,865.00'$
$T = 80.05'$	$T = 100.33'$
$L = 160.07'$	$L = 200.58'$
$E = 1.12'$	$E = 1.76'$
$C = 160.05'$	$C = 200.54'$
C.B. = N 44° 01' 11" E	C.B. = N 44° 25' 29" E
$e_{max} = 0.053$	$e_{max} = 0.045$

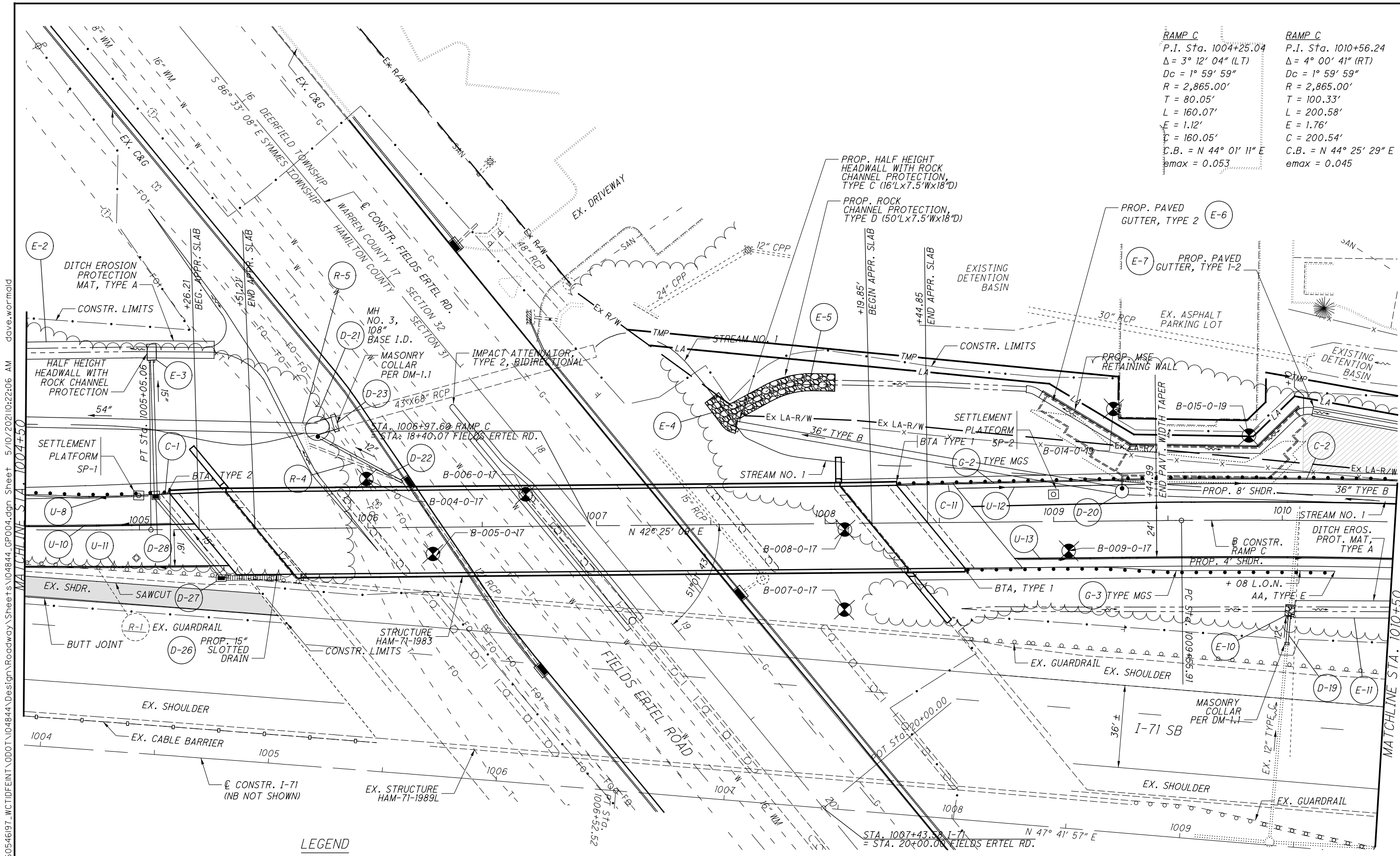

LEGEND

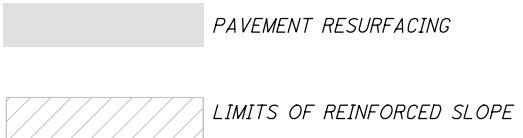

CONTRACTOR SHALL COORDINATE GUARDRAIL POST INSTALLATION TO AVOID DAMAGING GEOGRID/C FOR REINFORCED SOIL SLOPE

CROSS REFERENCES

FOR ADDITIONAL DETAILS, SEE BRIDGE SITE PLAN
 FOR PLAN FIELDS ERIEL RD, SEE SHEET 45
 FOR ESTIMATED QUANTITIES SEE SHEET 22
 FOR B & C REFERENCES SEE SHEET 2
 FOR PROJECT CONTROL SEE SHEET 10

FOR ADDITIONAL DETAILS, SEE RETAINING WALL PLANS
 FOR REINFORCED SOIL SLOPE DETAILS, SEE SHEET 70
 SEE BRIDGE PLANS FOR APPROACH SLAB PARAPET DETAILS
 FOR FENCING PLAN, SEE SHEET 130

L:\DCS\Projects\TRN\60546197_WCTDFEINT\000T\104844\Design\Roadway\Sheets\104844.GP004.dgn Sheet 5/10/2021 10:22:06 AM dave.wormald

L:\DCS\Projects\TRN\60546197_WCTIDFEINT\000T\104844\Design\Roadway\Sheets\104844_GPO08.dgn Sheet 5/6/2021 3:48:24 PM dave.wormald

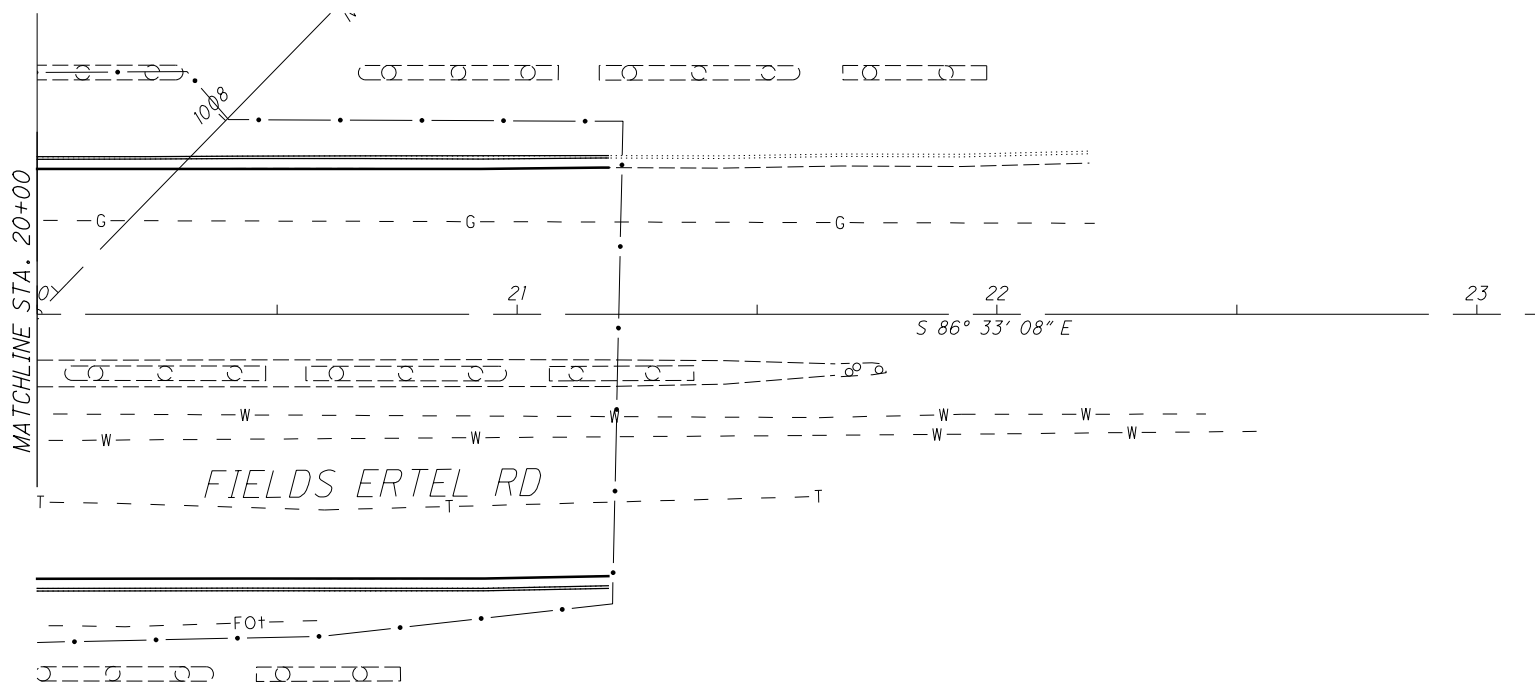
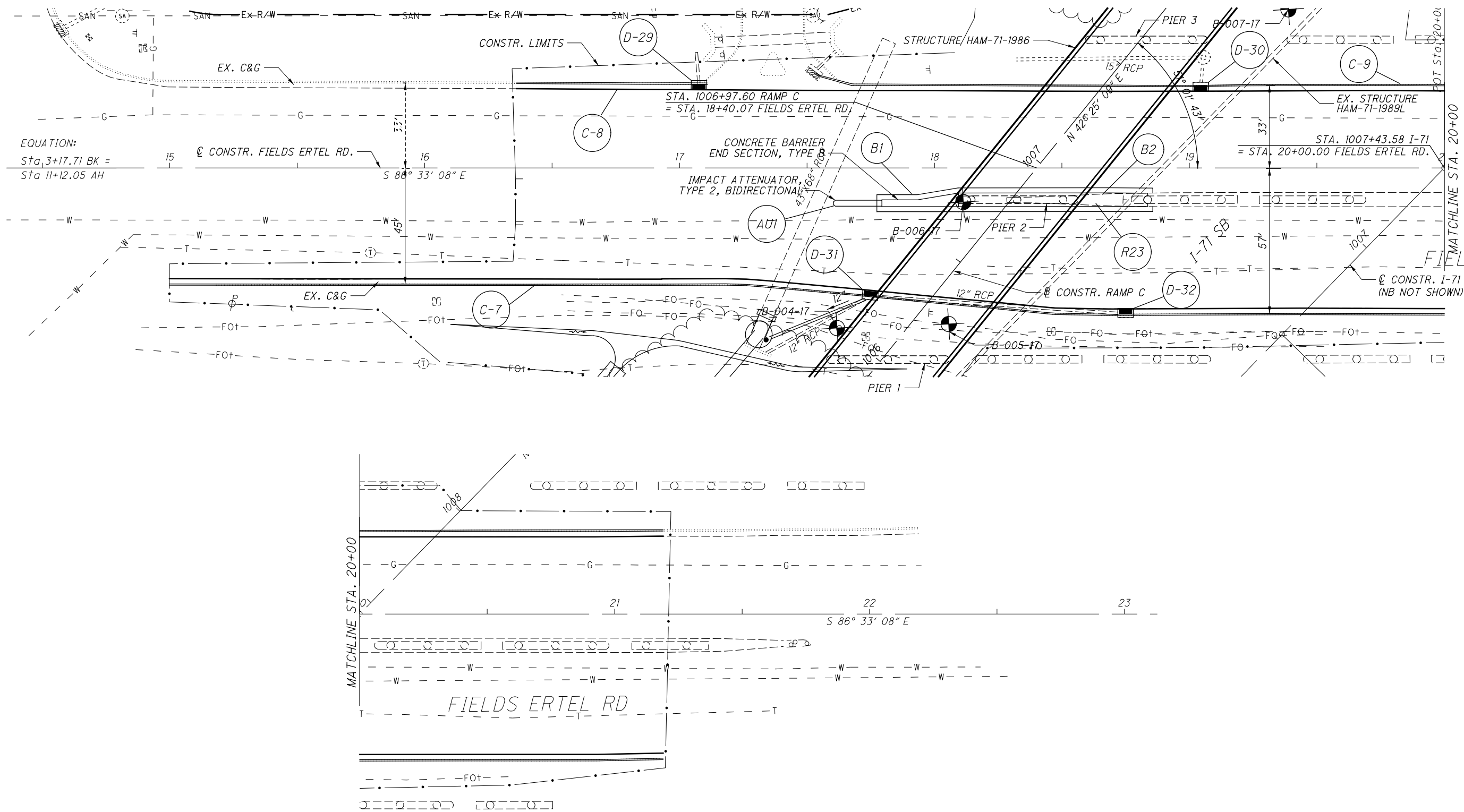

I-71
 P.I. Sta. 999+93.14
 $\Delta = 3^\circ 31' 04''$ (RT)
 $Dc = 0^\circ 16' 00''$
 $R = 21,485.88'$
 $T = 659.79'$
 $L = 1,319.17'$
 $E = 10.13'$
 $C = 1,318.96'$
 $C.B. = N 45^\circ 56' 25'' E$

CROSS REFERENCES
 SEE BRIDGE SITE PLAN FOR DETAILS
 FOR PAVEMENT DETAILS, SEE SHEET 67
 FOR ESTIMATED QUANTITIES SEE SHEET 22
 FOR \square & \square REFERENCES SEE SHEET 2
 FOR PROJECT CONTROL SEE SHEET 10



 HORIZONTAL SCALE IN FEET
 CALCULATED CAL CHECKED SCC

PLAN - FIELDS-ERTEL ROAD
STA. 15+00 - STA. 23+00

HAM / WAR-71
19.83 / 0.00

L:\DCS\Projects\TRN\60546197_WCTIDFEINT\0DOT\104844\Design\Roadway\Sheets\104844_X5013.dgn_Sheet 5/10/2021 11:50:59 AM dave.wormald

SEEDING	END WIDTH	SO. YDS.	END AREA		VOLUME		CALCULATED CAL	CHECKED SCC
			CUT	FILL	CUT	FILL		
	38	222						
	18		14	124				
	117				33	343		
	20		22	246				
	106							
	36	370	83	487				

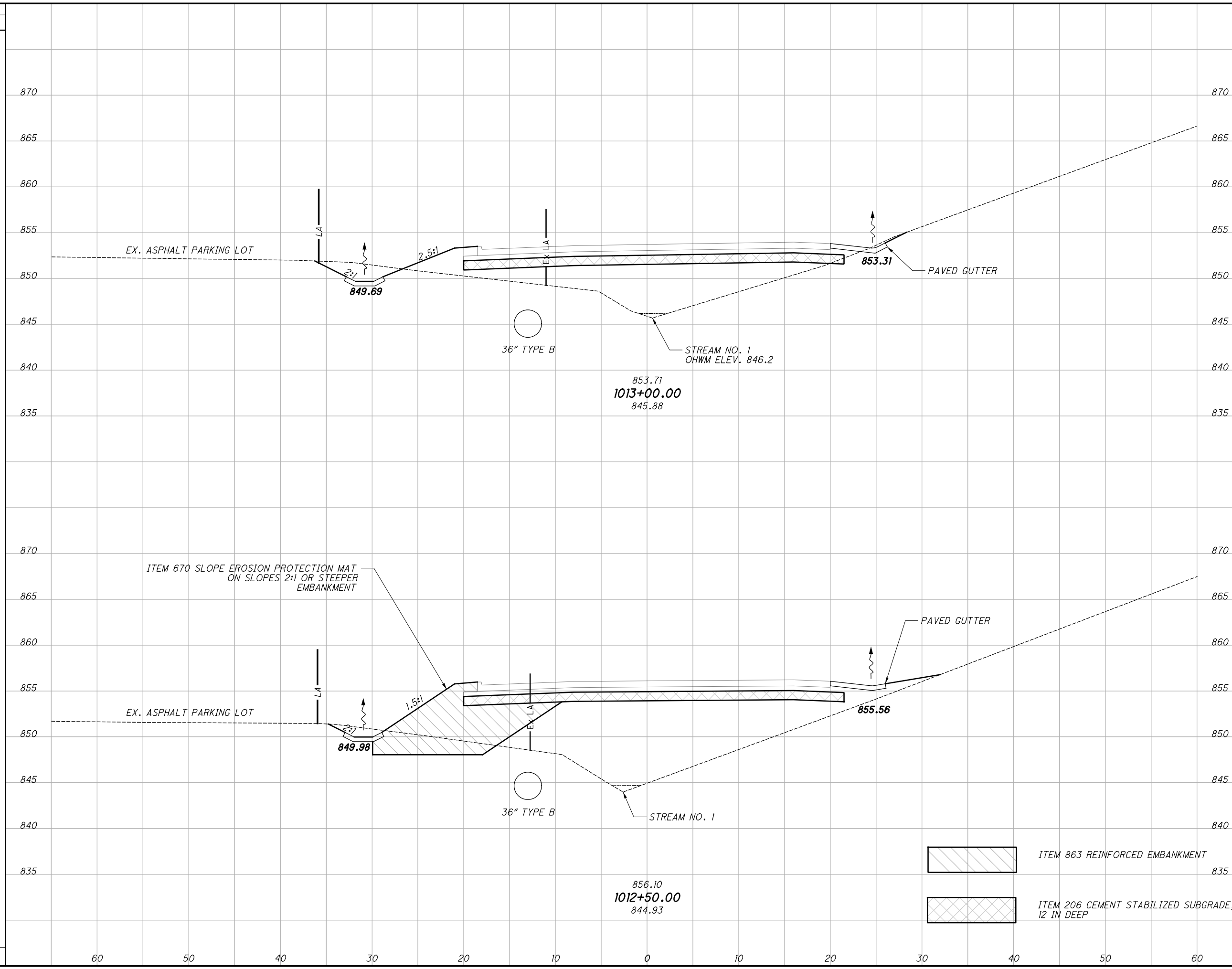

SEEDING	END WIDTH	SO. YDS.	END AREA		VOLUME		CALCULATED CAL	CHECKED SCC
			CUT	FILL	CUT	FILL		
	38	222						
	18		14	124				
	117				33	343		
	20		22	246				
	106							
	36	370	83	487				

CROSS SECTIONS RAMP C
STA. 1012+50.00 TO STA. 1013+00.00

HAM / WAR-71
19.83 / 0.00

58
146

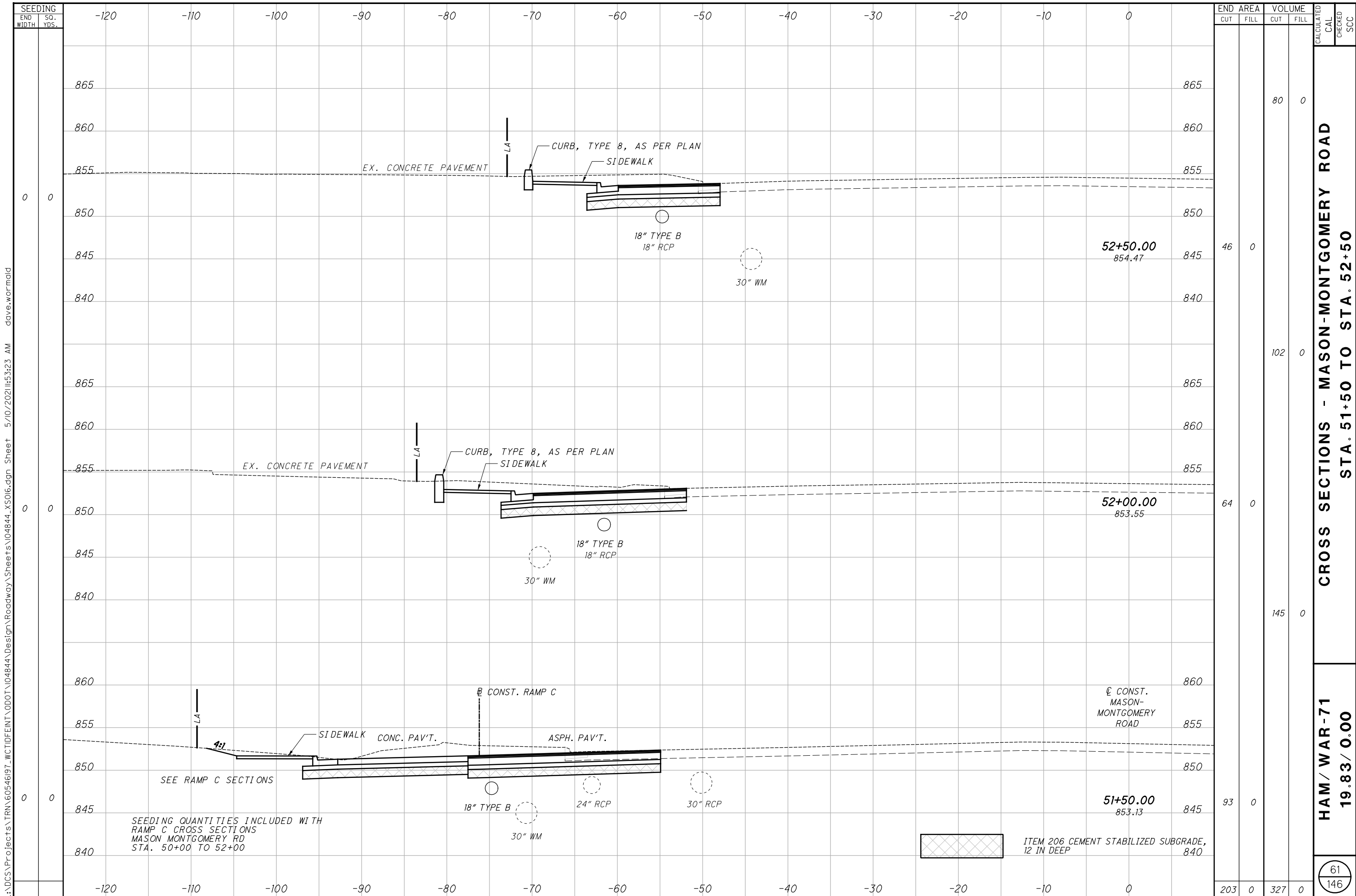

L:\DCS\Projects\TRN\60546197_WCTIDFEINT\000T\04844\Design\Roadway\Sheets\04844_X5016.dgn_Sheet 5/10/2021 11:53:23 AM dave.wormald

SEEDING		END AREA		VOLUME		CALCULATED	
END WIDTH	SO. YDS.	CUT	FILL	CUT	FILL	CAL	CHKD
0	0	46	0	80	0		
0	0	64	0	102	0		
0	0	93	0	145	0		
0	0	203	0	327	0		

CROSS SECTIONS - MASON-MONTGOMERY ROAD
STA. 51+50 TO STA. 52+50
HAM / WAR-71
19.83 / 0.00

61
 146

SEEDING QUANTITIES INCLUDED WITH
 RAMP C CROSS SECTIONS
 MASON MONTGOMERY RD
 STA. 50+00 TO 52+00

ITEM 206 CEMENT STABILIZED SUBGRADE,
 12 IN DEEP

L:\DCS\Projects\TRN\6054697_WCTIDFEINT\0DOT\04844\Design\Structures\WAR071_0000P\Sheets\04844_S0001.dgn Sheet 5/7/2021 10:02:57 AM dave.wormald

ITEM ODOT	EXT.	PARTICIPATION 01/MPO/OT	TOTAL	UNIT	DESCRIPTION	QUANTITIES		CALC BY:	ERM	5/30/2019	
						HAM-71-19.83		CHECK BY:	ESH	11/18/2019	
						ABUTMENTS		PIERS	SUPER.	GENERAL	REF. SHEET
REAR	FWD.										
202	11301	24	24	CY	PORTIONS OF STRUCTURE REMOVED, AS PER PLAN					24	2/31 5/31
203	98500	LS	LS	LS	TEMPORARY SURCHARGE					LS	2/31 5/31
503	11101	LS	LS	LS	COFFERDAMS AND EXCAVATION BRACING, AS PER PLAN					LS	
509	10000	140,406	140,406	LB	EPOXY COATED REINFORCING STEEL	6238	7121	23943	101294	1810	
509	30020	6,362	6,362	FT	NO. 4 GFRP DEFORMED BARS				6267	95	
511	33500	4	4	EACH	SEMI-INTEGRAL DIAPHRAGM GUIDE	2	2				
511	53014	43	43	CY	CLASS QC3 CONCRETE WITH QC/QA, SUPERSTRUCTURE, AS PER PLAN				43		3/31
511	53014	308	308	CY	CLASS QC3 CONCRETE WITH QC/QA, BRIDGE DECK, AS PER PLAN				308		3/31
511	53014	90	90	CY	CLASS QC3 CONCRETE WITH QC/QA, BRIDGE DECK (PARAPET), AS PER PLAN				81	9	3/31
511	53014	110	110	CY	CLASS QC3 CONCRETE WITH QC/QA, PIER ABOVE FOOTINGS, AS PER PLAN			110			3/31
511	53014	136	136	CY	CLASS QC3 CONCRETE WITH QC/QA, ABUTMENT INCLUDING FOOTING, AS PER PLAN	59	77				3/31
512	10100	1,021	1,021	SY	SEALING OF CONCRETE SURFACES (EPOXY-URETHANE)	50	62	342	567		
513	10240	323,996	323,996	LB	STRUCTURAL STEEL MEMBERS, LEVEL 2				323996		
513	20000	3,875	3,875	EACH	WELDED STUD SHEAR CONNECTORS				3875		
514	00060	15,535	15,535	SF	FIELD PAINTING STRUCTURAL STEEL, INTERMEDIATE COAT				15535		
514	00066	15,535	15,535	SF	FIELD PAINTING STRUCTURAL STEEL, FINISH COAT				15535		
516	13600	14	14	SF	1" PREFORMED EXPANSION JOINT FILLER	5	9				
516	13900	130	130	SF	2" PREFORMED EXPANSION JOINT FILLER	75	55				
516	14020	105	105	FT	SEMI-INTEGRAL ABUTMENT EXPANSION JOINT SEAL	53	52				
516	44200	10	10	EACH	ELASTOMERIC BEARING WITH INTERNAL LAMINATES AND LOAD PLATE (NEOPRENE) (12" x 12" x 2.5" WITH 13" x 13" x 1.50" PLATE)	5	5				
516	44200	15	15	EACH	ELASTOMERIC BEARING WITH INTERNAL LAMINATES AND LOAD PLATE (NEOPRENE) (17" x 15" x 2.5" WITH 18" x 16" x 1.50" PLATE)			15			
518	21200	97	97	CY	POROUS BACKFILL WITH GEOTEXTILE FABRIC	47	50				
518	40000	164	164	FT	6" PERFORATED CORRUGATED PLASTIC PIPE	75	89				
518	40010	14	14	FT	6" NON-PERFORATED CORRUGATED PLASTIC PIPE, INCLUDING SPECIALS	8	6				
524	94605	86	86	FT	DRILLED SHAFTS, 30" DIAMETER INTO BEDROCK, AS PER PLAN	32	54				2/31
524	94703	696	696	FT	DRILLED SHAFTS, 36" DIAMETER, ABOVE BEDROCK, AS PER PLAN	264	432				2/31
524	94705	45	45	FT	DRILLED SHAFTS, 36" DIAMETER, INTO BEDROCK, AS PER PLAN			45			2/31
524	94803	486	486	FT	DRILLED SHAFTS, 42" DIAMETER, ABOVE BEDROCK, AS PER PLAN			486			2/31
526	25001	216	216	SY	REINFORCED CONCRETE APPROACH SLABS (T=15"), AS PER PLAN					216	26/31 27/31
526	90010	94	94	FT	TYPE A INSTALLATION					94	
601	20000	471	471	SY	CRUSHED AGGREGATE SLOPE PROTECTION	230	241				
625	25600	319	319	LF	CONDUIT, 4", 725.04				319		

DESIGN AGENCY
AECOM
525 Vine Street, Suite 1800
Phoenix, AZ 85004
www.aecom.com

DATE: 12/19
REVIEWED: TMB
STRUCTURE FILE NUMBER: 3107754

DRAWN: ERM
CHECKED: ESH
REVISER: ---

ESTIMATED QUANTITIES
BRIDGE NO. HAM-71-19.83
I-71 SB RAMP C OVER FIELDS ETEL ROAD

HAM / WAR - 71
- 19.83 / 0.00
PID No. 104844

4 / 31

102
146