

STATE OF OHIO
DEPARTMENT OF TRANSPORTATION
EMBSHOFF WOODS
RESURFACING
 CITY OF CINCINNATI
 HAMILTON COUNTY

FEDERAL PROJECT NUMBER N/A STATE PROJECT NUMBER 481488

RAILROAD INVOLVEMENT

N/A

PROJECT DESCRIPTION

PROJECT DESCRIPTION: REPAIR AND RESURFACE APPROXIMATELY 160,000 S.F. OF EXISTING ASPHALT PARK DRIVES, PARKING LOTS, AND PATHS; REPLACE CULVERTS; AND PROVIDE ADA ACCESSIBLE ROUTES

EARTH DISTURBED AREAS

PROJECT EARTH DISTURBED AREA: 0.9 ACRES
 ESTIMATED CONTRACTOR EARTH DISTURBED AREA: 0.05 ACRES
 NOTICE OF INTENT EARTH DISTURBED AREA: 0.95 ACRES

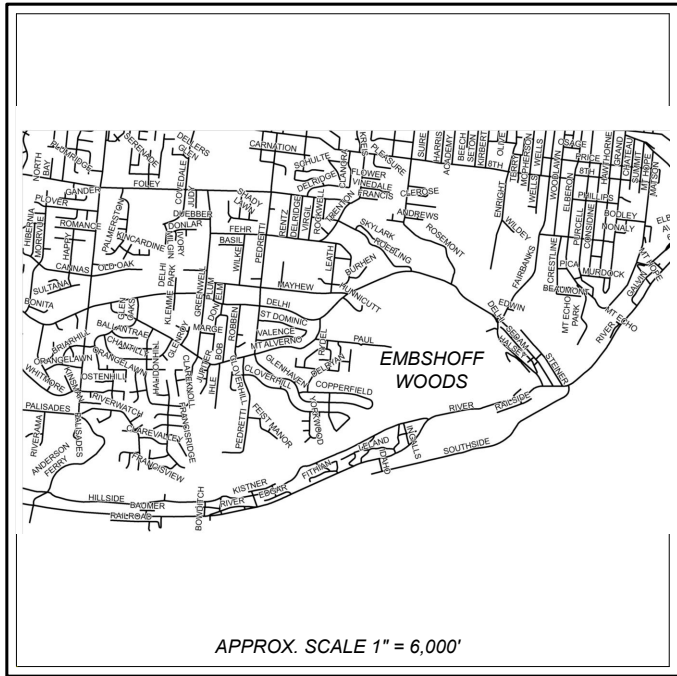

APPROX. SCALE 1" = 6,000'

LOCATION MAP

LATITUDE: 39°5'26" LONGITUDE: -84°35'18"



PORTION TO BE IMPROVED	
INTERSTATE HIGHWAY	
FEDERAL ROUTES	
STATE ROUTES	
COUNTY & TOWNSHIP ROADS	
OTHER ROADS	

DESIGN DESIGNATION

CURRENT ADT (20__)	N/A
DESIGN YEAR ADT (20__)	N/A
DESIGN HOURLY VOLUME (20__)	N/A
DIRECTIONAL DISTRIBUTION	N/A
TRUCKS (24 HOUR B&C)	N/A
DESIGN SPEED	N/A
LEGAL SPEED	25 MPH
DESIGN FUNCTIONAL CLASSIFICATION:	
N/A	
NHS PROJECT	N/A

DESIGN EXCEPTIONS

NONE REQUIRED

ADA DESIGN WAIVERS

NONE REQUIRED

UNDERGROUND UTILITIES
 Contact Two Working Days
 Before You Dig

OHIO811, 8-1-1, or 1-800-362-2764
 (Non members must be called directly)

PLAN PREPARED BY:
 Great Parks
 10245 WINTON ROAD
 CINCINNATI, OH 45231
 513-521-7275
 WWW.GREATPARKS.ORG

ENGINEER'S SEAL:



SIGNED: *Ronald C. Masella*
 DATE: APRIL 13, 2023

INDEX OF SHEETS:

TITLE SHEET	P.1
GENERAL NOTES & DETAILS	P.2 - P.5
GENERAL SUMMARY	P.6
PLAN	P.7 - P.9
PAVEMENT MARKING PLAN	P.10
GRADING PLAN	P.11
SURVEY	P.12
SUBSUMMARY SHEET	P.13 - P.14
ADA PLAN	P.15 - P.19

STANDARD CONSTRUCTION DRAWINGS	SUPPLEMENTAL SPECIFICATIONS		SPECIAL PROVISIONS
	886	4/19/19	
	800-2019	1/20/2023	
RM-6.1	7/18/14		
TC-42.20	10/18/13		
TC-71.10	07/15/22		

2019 SPECIFICATIONS

THE STANDARD SPECIFICATIONS OF THE STATE OF OHIO, DEPARTMENT OF TRANSPORTATION, INCLUDING SUPPLEMENTAL SPECIFICATIONS LISTED IN THE PLANS AND CHANGES LISTED IN THE PROPOSAL SHALL GOVERN THIS IMPROVEMENT.

I HEREBY APPROVE THESE PLANS AND DECLARE THAT THE MAKING OF THIS IMPROVEMENT WILL NOT REQUIRE THE CLOSING TO TRAFFIC OF THE HIGHWAY AND THAT PROVISIONS FOR THE MAINTENANCE AND SAFETY OF TRAFFIC WILL BE AS SET FORTH ON THE PLANS AND ESTIMATES

DISTRICT DEPUTY DIRECTOR

Tammy K. Campbell 4-13-23
 DIRECTOR, DEPARTMENT OF TRANSPORTATION

Justin Maden 4-13-23

EMBSHOFF WOODS RESURFACING

TITLE SHEET

DESIGN AGENCY	Great Parks
DESIGNER	RM
REVIEWER	TZ
PROJECT ID	04-13-23
SHEET	117816
TOTAL	
P.1	19

UTILITIES - LISTED BELOW ARE ALL KNOWN UTILITIES LOCATED WITHIN THE PROJECT CONSTRUCTION LIMITS:

- | | |
|---|---|
| GREAT PARKS OF HAMILTON COUNTY
10245 WINTON ROAD
CINCINNATI, OH 45231
513-521-7275 | DUKE ENERGY (ELECTRIC)
2010 DANA AVE.
CINCINNATI, OH 45207
800-544-6900 |
| ALTA FIBER
201 EAST FOURTH ST.
CINCINNATI, OH 45202
513-397-9900 | DUKE ENERGY (GAS)
139 E. 4TH/ STREET
CINCINNATI, OH 45202
800-544-6900 |
| BP OIL
3575 CINCINNATI-DAYTON ROAD
MIDDLETOWN, OH 45044
513-479-4076 | GREATER CINCINNATI WATER WORKS
4747 SPRING GROVE AVE.
CINCINNATI, OH 45232-1986
513-591-7700 |
| CHARTER COMMUNICATIONS/SPECTRUM/TIME WARNER
6006 GLENWAY AVE
CINCINNATI, OH 45211
888-406-7063 | METROPOLITAN SEWER DISTRICT OF GREATER CINCINNATI
1600 GEST STREET
CINCINNATI, OH 45202
513-557-3594 |

GENERAL NOTES

"OWNER" REFERS TO GREAT PARKS OF HAMILTON COUNTY (GPHC) ALSO REFERENCED AS GREAT PARKS. COPY WITH ALL DOCUMENTATION.

"ENGINEER" REFERS TO OHIO DEPARTMENT OF TRANSPORTATION (ODOT) ENGINEER. PROVIDE DOCUMENTATION TO ENGINEER AS REQUIRED.

ALL ODOT ITEMS TO CONFORM TO THE ODOT CONSTRUCTION AND MATERIAL SPECIFICATIONS (CMS) FOR PAYMENT.

* ASTERISK DENOTES OWNER APPROVAL REQUIRED
PARKS SHALL TAKE NO MORE THAN 7 DAYS FOR THIS APPROVAL ONCE REQUEST HAS BEEN MADE

CENTERLINE STATIONING IS FOR PLAN REFERENCE ONLY

WORK SCHEDULE

ALL WORK SHALL BE PERFORMED DURING DAYLIGHT HOURS (DAWN TO DUSK), EXCEPT FROM MEMORIAL DAY TO LABOR DAY WORK CAN ONLY BE PERFORMED BETWEEN THE HOURS OF 6:30 A.M. AND 3:30 P.M. NO WORK WILL BE PERMITTED ON SATURDAY, SUNDAY, & FEDERAL HOLIDAYS WITHOUT WRITTEN APPROVAL FROM THE GREAT PARKS OF HAMILTON COUNTY.

* THE CONTRACTOR IS REQUIRED TO COORDINATE WORK SCHEDULES AT PROJECT SITES THAT CONTAIN RESERVABLE SHELTERS WITH THE ENGINEER AND GREAT PARKS OF HAMILTON COUNTY.

PARK IS TO REMAIN OPEN DURING CONSTRUCTION. CONTRACTOR IS RESPONSIBLE FOR MAINTAINING SAFE ACCESS OF GUESTS AND WORKERS TO PARK FACILITIES.

* SECTIONS OF THE PARK ARE PERMITTED TO BE CLOSED FOR A ONE-WEEK DURATION. PROVIDE SKETCH OF PROPOSED CLOSURE LIMITS AND DATES TO GREAT PARKS, AND OBTAIN WRITTEN APPROVAL PRIOR TO WORK.

MAINTAIN A MINIMUM OF 25% PARKING CAPACITY IN THE PARK AT ALL TIMES. THE PREFERRED PARKING AREA OF THE PARK IS NEAR THE RIVER MOUNT PAVILLION AND PLAYGROUND AREA.

MAINTAIN SAFE ACCESS TO RESTROOMS AT ALL TIMES. DURING WORK NEAR THE RIVER MOUNT PAVILLION RESTROOM, MAINTAIN ACCESS FROM THE DISC GOLF COURSE PARKING LOT TO THE RIVER MOUNT PAVILLION, AND MAINTAIN ACCESS TO THE HORSESHOE HAVEN RESTROOM.

CONSTRUCTION ACCESS ROUTES & STAGING AREAS

THE CONTRACTOR'S STAGING AREAS SHALL BE LIMITED TO THE USE OF PARKING LOTS WITHIN THE PROJECT LIMITS OF CONSTRUCTION TO COMPLETE ALL WORK OR AS APPROVED BY GREAT PARKS.

* ALL CONSTRUCTION ACTIVITIES INCLUDING EQUIPMENT, VEHICLES, MATERIALS, AND DELIVERIES SHALL BE CONFINED WITHIN THE CONSTRUCTION LIMITS AND STAGING AREAS SHOWN ON THE PLANS AS DIRECTED BY GREAT PARKS. NO ADDITIONAL PARK PROPERTY MAY BE USED WITHOUT OBTAINING WRITTEN APPROVAL FROM THE GREAT PARKS OF HAMILTON COUNTY.

THE CONTRACTOR SHALL REPAIR ANY DAMAGE TO EXISTING PAVEMENT, LAWN, OR OTHER SURFACES CAUSED BY CONTRACTOR'S EQUIPMENT AND / OR LABOR AT CONTRACTOR'S EXPENSE. ALL EXISTING PAVEMENTS SHALL BE RESTORED IN KIND MEETING LIKE MATERIALS AND THICKNESS. THE CONTRACTOR SHALL RESTORE LAWN AREAS WITH TOPSOIL, SEEDING, AND MULCHING.

MAXIMUM LOAD LIMITS

THE FOLLOWING MAXIMUM LOAD LIMITS SHALL APPLY ON PARK PROPERTY UNLESS LOWER LIMITS ARE SHOWN TO BE NECESSARY TO AVOID DAMAGE:

VEHICLE TYPE / GROSS VEHICLE WEIGHT

1. SINGLE UNIT TRUCKS
 - A. 2-AXLE, WITH 1 REAR AXLE 24,000 LBS.
 - B. 3-AXLE, WITH 2 REAR AXLES 35,000 LBS.
 - C. 4-AXLE, WITH 3 REAR AXLES 45,000 LBS.
2. TRACTOR-TRAILER COMBINATIONS 60,000 LBS.

* THE CONTRACTORS VEHICLES, VEHICLES BELONGING TO THE EMPLOYEES OF THE CONTRACTOR AND SUBCONTRACTOR SHALL USE ONLY THE ACCESS ROUTES AND PARKING AREAS APPROVED BY GREAT PARKS.

WORKING NEAR TREES / TREE PROTECTION

THE CONTRACTOR SHALL PERFORM ALL WORK IN SUCH A MANNER TO MINIMIZE DAMAGE TO EXISTING TREES WITHIN OR ADJACENT TO THE WORK AREA. NO PAYMENT WILL BE MADE FOR THE SPECIAL REQUIREMENTS INVOLVED IN "WORKING NEAR TREES"; THEREFORE, ALL COSTS ARE TO BE INCLUDED UNDER OTHER ITEMS OF THE CONTRACT.

IF ENTERING THE NATURAL AREAS TO FILL/CAP CULVERTS THEY SHOULD CHOOSE ONE CORRIDOR IN AND OUT AND AVOID MATURE TREES AND KEEP THE CORRIDOR AS NARROW AS POSSIBLE. AVOIDING BANK COMPACTION AS MUCH AS POSSIBLE LIKE IN THE LAWN AREAS. IF CONSTRUCTION ACTIVITIES ARE ALLOWED WITHIN THE TREE PROTECTION ZONE ALTRUNA MATS OR APPROVED EQUAL OR A MINIMUM FOUR-INCH LAYER OF PROCESSED PINE BARK OR WOOD CHIPS MUST BE PLACED TO PREVENT COMPACTION. THE CONTRACTOR SHALL PROTECT ANY TREES, BUSHES AND VEGETATION, NOT DESIGNATED FOR REMOVAL, WITHIN THE AREA OF CONTRACTOR'S OPERATION. THE CONTRACTOR SHALL PROTECT EXISTING TREES AGAINST UNNECESSARY CUTTING, BREAKING OR SKINNING OF ROOTS, SKINNING OF BARK, SMOTHERING OF TREES BY STOCKPILING CONSTRUCTION MATERIALS OR EXCAVATED MATERIALS WITHIN THE DRIP LINE, EXCESS FOOT OR VEHICULAR TRAFFIC, OR PARKING OF VEHICLES WITHIN THE DRIP LINE.

TREE PROTECTION FENCE SHALL BE LOCATED PER PLAN. FOR TREE PROTECTION ALONG EDGE OF PAVEMENT, LOCATE 2- FEET OFF EDGE OF PAVEMENT, TYPICAL. FOR TREE PROTECTION NOT NEAR PAVEMENT EDGE, LOCATE AT 3- FEET BEYOND THE DRIP LINE, TYPICAL AT EACH ENCLOSED AREA, PROVIDE ACCESS POINT FOR GREAT PARKS STAFF TO ENTER AND MAINTAIN THE GRASS. SIGNS STATING, "TREE PROTECTION ZONE: KEEP OUT" SHALL BE POSTED ON THE FENCING AND VISIBLE ON ALL SIDES OF THE TREE PROTECTION ZONE (MINIMUM ONE PER SIDE AND EVERY 300 LINEAR FEET OF FENCING). FONT MUST BE A MINIMUM 1.5" TALL AND SIGN DIMENSIONS SHALL BE A MINIMUM 18" X 12". TREE PROTECTION WRAP SHALL BE LOCATED PER PLAN. TREE PROTECTION WRAP TO CONSIST OF BURLAP WRAP, BOARDS LEANED AT ANGLE ONTO THE BURLAP, AND WIRE WRAP AROUND THE BOARDS TO SECURE THE BOARDS FROM MOVEMENT. USE CARE TO NOT DAMAGE TREE BARK OR TREE ROOTS. WIRE WRAP TO BE ANCHORED TO THE BOARDS AND/OR ITSELF. NO ACHORAGE IS PERMITTED TO CONTACT THE TREE.

* FOR ALL TREE PROTECTION APPROVALS, CONTACT GREAT PARKS' URBAN FORESTER, STEVE GRIMM (513-326-0131 EXT 2920).

*** APPROVAL FOR PROTECTION INSTALLATION**

PRIOR TO ANY WORK AND/OR MOBILIZATION, TREE PROTECTION SHALL BE INSTALLED. INSPECT TREE PROTECTION WITH GREAT PARKS AUTHORIZED REPRESENTATIVE AND OBTAIN GREAT PARKS WRITTEN APPROVAL OF TREE PROTECTION INSTALLATION PRIOR TO BEGINNING WORK.

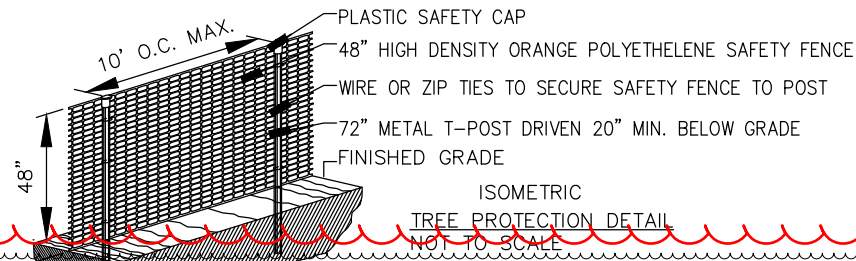

*** APPROVAL FOR PROTECTION REPAIR/REPLACEMENT**

ANY TREE REMOVAL SHALL BE PERFORMED BETWEEN OCTOBER 1ST AND MARCH 31ST. NO TREE REMOVAL IS ANTICIPATED WITH THIS PLAN. TREES REMOVED ARE TO BE REPLACED WITH NEW TREES, INCH FOR INCH OF DIAMETER REMOVED, WITHIN A LOCATION OF THE PARK AS DIRECTED BY GREAT PARKS. PRIOR TO ANY TREE TRIMMING OR REMOVAL OF A TREE THAT IS NOT NOTED FOR REMOVAL, OBTAIN GREAT PARKS APPROVAL. DURING THE COURSE OF ALL CONSTRUCTION, BRANCHES EXTENDING OVER THE WORK AREA MUST BE PROTECTED. IF THESE LIMBS ARE DAMAGED OR BROKEN, THE CONTRACTOR IS RESPONSIBLE AND BEARS THE COST OF ANY REASONABLE CORRECTION DEEMED NECESSARY, INCLUDING PROPER PRUNING, AND/OR FULL TREE REPLACEMENT AS DIRECTED BY GREAT PARKS.

*** APPROVAL FOR PROTECTION CHANGE**

SAFETY FENCE SHOULD BE FASTENED SECURELY TO THE T-POSTS. THE FENCING MUST BE INSTALLED PRIOR TO ANY SOIL DISTURBANCE AND REMAIN IN PLACE DURING ALL PHASES OF CONSTRUCTION. ANY CHANGE OF THE TEMPORARY FENCING MUST BE APPROVED BY GREAT PARKS AUTHORIZED REPRESENTATIVE. THE CONTRACTOR SHALL BE PROHIBITED FROM STORING ANY MATERIAL OR EQUIPMENT IN THE LAWN AREA UNDER OR NEAR EXISTING TREES. THE OWNER SHALL GIVE PRIOR APPROVAL OF AN AREA BEFORE IT IS USED FOR THE STORAGE OF ANY MATERIAL OR EQUIPMENT. CONSTRUCTION ACTIVITIES MAY ONLY BE ALLOWED WITHIN THE TREE PROTECTION ZONE WITH PERMISSION OF GREAT PARKS.

AIRWAY/HIGHWAY CLEARANCE FOR PUBLIC AIRPORTS

THIS PROJECT HAS BEEN IDENTIFIED AS BEING WITHIN THE INFLUENCE AREA OF ONE (1) PUBLIC USE AIRPORTS WHICH ARE LISTED IN THE TABLE BELOW. NO TEMPORARY STRUCTURES OR CONSTRUCTION EQUIPMENT AT MAXIMUM OPERATING HEIGHT SHALL EXCEED THE HEIGHTS (Z) PROVIDED IN THE TABLE BELOW:

POTENTIALLY IMPACTED AIRPORTS	AIRPORT ELEVATION "A"	PROJECT ELEVATION "B" + 25 FEET (CONTROLLING CRITERIA)	DISTANCE BETWEEN AIRPORT & PROJECT "C"	NOTIFICATION SLOPE X:1	USE TYPE	AMOUNT OF CLEARANCE ABOVE NOTIFICATION SLOPE "Z"
CINCINNATI-ORTHERN KENTUCKY INTL AIRPORT - CVG	883 FT.	863+50=913 FT.	20,805.40 FT.	100:1	+178.054 FT.	NO

IF ANY TEMPORARY STRUCTURES OR CONSTRUCTION EQUIPMENT WILL EXCEED THESE HEIGHTS, FURTHER COORDINATION WITH THE FEDERAL AVIATION ADMINISTRATION (FAA), AND ODOT OFFICE OF AVIATION, WILL BE NECESSARY PRIOR TO ERECTING SUCH TEMPORARY STRUCTURES OR OPERATING SUCH EQUIPMENT ON THE PROJECT. THE CONTRACTOR WILL BE REQUIRED TO SUBMIT FORM 7460-1 TO THE FAA. NOTIFY THE ODOT OFFICE OF AVIATION WHEN SUBMITTING FAA FORM 7460-1. NO TEMPORARY STRUCTURES OR CONSTRUCTION EQUIPMENT SHALL EXCEED THE PERMISSIBLE HEIGHT, UNTIL A COPY OF THE FAA APPROVAL AND THE ODOT OFFICE OF AVIATION PERMIT HAS BEEN FURNISHED TO THE PROJECT ENGINEER.

FAA CONTACT INFORMATION	ODOT OFFICE OF AVIATION CONTACT INFORMATION
EXPRESS PROCESSING CENTER THE FEDERAL AVIATION ADMINISTRATION SOUTHWEST REGIONAL OFFICE AIR TRAFFIC AIRSPACE BRANCH ASW-520 2601 MEACHAN BLVD. FORT WORTH, TX 76137-4298	OHIO DEPARTMENT OF TRANSPORTATION OFFICE OF AVIATION 2829 WEST DUBLIN-GRANVILLE ROAD COLUMBUS, OHIO 43235 (614)-387-2346

AIRWAY/HIGHWAY CLEARANCE FOR PRIVATE AIRPORTS

THIS PROJECT HAS BEEN IDENTIFIED AS BEING WITHIN THE INFLUENCE AREA OF ONE (1) PRIVATE USE AIRPORTS LISTED IN THE TABLE BELOW.

POTENTIALLY IMPACTED AIRPORTS	AIRPORT ELEVATION "A"	PROJECT ELEVATION "B" + 25 FEET (CONTROLLING CRITERIA)	DISTANCE BETWEEN AIRPORT & PROJECT "C"	NOTIFICATION SLOPE X:1	USE TYPE	AMOUNT OF CLEARANCE ABOVE NOTIFICATION SLOPE "Z"
BROWN HELIPORT - 810I	870 FT.	863+50=913 FT.	5,265.91 FT..	25:1	+167.64 FT.	NO

NO TEMPORARY STRUCTURES OR CONSTRUCTION EQUIPMENT, AT MAXIMUM OPERATING HEIGHT, SHALL EXCEED THE HEIGHTS (Z) PROVIDED IN THE TABLE ABOVE. IF ANY TEMPORARY STRUCTURES OR CONSTRUCTION EQUIPMENT WILL EXCEED THIS HEIGHT, COORDINATION WITH THE AIRPORT OWNER AND THE ODOT OFFICE OF AVIATION WILL BE NECESSARY PRIOR TO ERECTING SUCH TEMPORARY STRUCTURES OR OPERATING SUCH EQUIPMENT ON THE PROJECT. FOR PRIVATE USE AIRPORTS, COORDINATION SHALL BE WITH THE AIRPORT OWNER AND THE ODOT OFFICE OF AVIATION. NO TEMPORARY STRUCTURES OR CONSTRUCTION EQUIPMENT SHALL EXCEED THE PERMISSIBLE HEIGHT, UNTIL COORDINATION IS MET AND DOCUMENTATION HAS BEEN FURNISHED TO THE PROJECT ENGINEER. IF COORDINATION IS NOT OBTAINED, THEN THE PROJECT ENGINEER WILL HAVE THE AUTHORITY TO PROVIDE RESTRICTIONS AS REQUIRED.

OWNER/MANAGER:
BROWN HELIPORT - 810I
JAMES L. BROWN
171 PEDRETTI RD
CINCINNATI, OH 45238
(513) 921-2191

DESIGN AGENCY



DESIGNER

RM

REVIEWER

TZ 04-13-23

PROJECT ID

117816

SHEET

P.2

TOTAL 19

PAVEMENT NOTES

* REPAIR LOCATIONS & QUANTITIES ARE SHOWN FOR BID. PRIOR TO CONSTRUCTION, FIELD VERIFY EXACT LOCATIONS. INSPECT EXISTING PAVEMENT CONDITIONS WITH ENGINEER & GREAT PARKS AUTHORIZED REPRESENTATIVE TO DELINEATE EXACT LOCATIONS OF SAMI PRIOR TO ANY PAVEMENT PLACEMENT FOR PARTIAL DEPTH REPAIR INTERMEDIATE COURSE & SURFACE COURSE OVERLAY WORK. SCRAPE/REMOVE SOIL TO EXPOSE TOP OF PAVEMENT EDGE PRIOR TO BEGINNING PAVEMENT WORK. MINIMIZE THE NUMBER OF COLD JOINTS ALONG THE MAIN DRIVE PER WORK SHIFT TO ONE LONGITUDINAL JOINT, & TRANSVERSE JOINTS TO ONE AT THE START, ONE AT THE END, & ACROSS THE DRIVE ACCESS TO EACH PARKING LOT. AT PAVEMENT JOINTS, PROVIDE FULL PAVEMENT COURSE THICKNESS BY SAW CUTTING OLD OR NEW PAVEMENT IF NECESSARY FOR BUTT JOINT. CRACK SEAL JOINTS AFTER CONSTRUCTION. PROVIDE POSITIVE DRAINAGE AWAY FROM ALL PAVED SURFACES. COORDINATE WITH ROADWAY EROSION CONTROL & DRAINAGE WORK.

201 - CLEARING AND GRUBBING, AS PER PLAN

PERFORM CLEARING AND GRUBBING ONLY AFTER TREE PROTECTION INSTALLATION & APPROVAL.

ITEM SPECIAL - 202 - PARKING BLOCK REMOVED, AS PER PLAN

THIS WORK SHALL CONSIST OF REMOVING & DISPOSING OF EXISTING CONCRETE PARKING BLOCKS & PINS AS SHOWN ON THE PLANS. THE EXISTING CURB BLOCKS SHALL BECOME PROPERTY OF THE CONTRACTOR & SHALL BE SATISFACTORILY REMOVED FROM THE PROJECT SITE. NO STOCKPILING OF BLOCKS WILL BE PERMITTED AT THE PROJECT SITE. AFTER THE BLOCKS ARE REMOVED, THE PINS SHALL BE IMMEDIATELY REMOVED, CUT OR DRIVEN INTO THE GROUND TO PREVENT A HAZARDOUS CONDITION. PAYMENT SHALL INCLUDE, BUT NOT BE LIMITED TO, ALL SERVICES, MATERIALS, LABOR, EQUIPMENT, TOOLS & INCIDENTALS NECESSARY TO COMPLETE THE WORK ABOVE & SHALL BE INCLUDED IN THE UNIT PRICE BID FOR ITEM 202 - PARKING BLOCK REMOVED.

ITEM SPECIAL - 202 - FILL AND PLUG EXISTING CONDUIT

THIS ITEM CONSISTS OF THE CONSTRUCTION OF BULKHEADS IN AN EXISTING 12" DIAMETER CONDUIT & FILLING THE AREA SEALED OFF WITH ITEM 613, SAND, OR OTHER MATERIAL APPROVED BY THE ENGINEER & GREAT PARKS.

LOCATE THE BULKHEADS AT THE LIMITS OF THE AREA TO BE FILLED, AS INDICATED ON THE PLANS. THE BULKHEADS CONSIST OF BRICK OR CONCRETE MASONRY WITH A MINIMUM THICKNESS OF 12 INCHES. TYPICALLY, CONSTRUCT ONE BULKHEAD AT THE PIPE OUTLET, & ONE BULKHEAD 2- FEET OUTSIDE THE EXISTING PAVEMENT EDGE.

PUMP THE FILL MATERIAL INTO PLACE OR BY OTHER MEANS APPROVED BY THE ENGINEER, SO THAT AFTER SETTLEMENT, AT LEAST 90 PERCENT OF THE CROSS-SECTIONAL AREA OF THE CONDUIT, FOR ITS ENTIRE LENGTH (TO REMAIN) IS FILLED. THE LENGTH OF FILLED & PLUGGED CONDUIT TO BE PAID FOR IS THE ACTUAL NUMBER OF FEET (MEASURED ALONG THE CENTERLINE OF EACH CONDUIT FROM OUTER FACE TO OUTER FACE OF BULKHEADS) FILLED & PLUGGED AS DESCRIBED IN THE ABOVE TEXT.

ITEM 202 - REMOVAL MISC., AS PER PLAN

SEE PLAN CALLOUTS SHEETS 7-9. ITEMS REMOVED ARE PROPERTY OF CONTRACTOR.

* ITEM 204 - SUBGRADE COMPACTION, AS PER PLAN

SEE DETAILS SHOWN ON PLAN SHEET 4. ENGINEER & GREAT PARKS REPRESENTATIVE TO WITNESS SUBGRADE COMPACTION WORK.

4 DAYS NOTICE IS REQUIRED BEFORE BEGINNING SUBGRADE COMPACTION

ITEM 204 - GEOTEXTILE FABRIC, AS PER PLAN

FURNISH & INSTALL TYPE A FABRIC AT PAVEMENT LOW POINT CONDUITS APPROX. STA. 4+75 & 28+50. WRAP ENTIRE TRENCH BEDDING & BACKFILL WITH FABRIC, & OVERLAP 18-INCHES AT TOP.

ITEM 204 - GEOGRID, AS PER PLAN

SEE GEOGRID FULL DEPTH PAVEMENT DETAIL SHOWN ON PLAN SHEET 4. GEOGRID SHALL BE TENSAR BX-2, OR EQUAL, ON ODOT SS-861 QUALIFIED PRODUCTS LIST. TYPICAL ROLL WIDTH IS 12.5- FEET. INSTALL PER MANUFACTURER'S INSTRUCTIONS.

ITEM 251 - PARTIAL DEPTH PAVEMENT REPAIR

SEE DETAIL SHOWN ON PLAN SHEET 4. UNIT BID PRICE SHALL INCLUDE REMOVING EXISTING DETERIORATED ASPHALT TO A MINIMUM DEPTH OF 1 1/2 INCHES OR AS DIRECTED BY THE ENGINEER. PROVIDE DENSITY TESTING FOR ALL 448 PLACED.

ITEM 253 - FULL DEPTH PAVEMENT REPAIR

SEE DETAILS SHOWN ON PLAN SHEET 4. VEHICULAR AREA EXISTING ASPHALT & GRAVEL BASE SHALL BE REMOVED TO AN AVERAGE DEPTH OF 8.5" OR AS DIRECTED BY THE ENGINEER & REPLACED WITH ITEM 301 - ASPHALT CONCRETE BASE. THE 301 SHALL BE COMPACTED AS PER 401.16 & IN APPROXIMATELY EQUAL LAYERS. THE LOCATION & SIZE OF THE REPAIRS SHALL BE DETERMINED BY THE ENGINEER.

FOR WALKS, REMOVE EXISTING PAVEMENT & EXCAVATE TO FOR NEW SECTION

ITEM 304 - AGGREGATE BASE, AS PER PLAN

SEE FULL DEPTH PAVEMENT REPAIR DETAIL & GEOGRID FULL DEPTH PAVEMENT DETAIL SHOWN ON PLAN SHEET 4.

ITEM 441 - ASPHALT CONCRETE SURFACE COURSE, TYPE 1, (448) PG64-22

SEE DETAILS SHOWN ON PLAN SHEET 4. UNIT BID PRICE FOR THIS ITEM SHALL INCLUDE THE COST TO FURNISH & INSTALL ITEM 407 NON-TRACKING TACK COAT & 1 1/2" DEEP BY 2" WIDE BUTT JOINTS. PROVIDE DENSITY TESTING FOR ALL 448 PLACED. ANY ADDITIONAL SURFACE COURSE THICKNESS NECESSARY TO CONSTRUCT PROPER SLOPES IN AREAS SUCH AS ADA PLAN SHEETS, TECH BOOTH AREA, TCBM FLASHING ANCHOR, & TO PROVIDE POSITIVE DRAINAGE, SHALL BE PAID AT UNIT COST OF THIS ITEM.

886 - FOG SEAL

TEST STRIP TO BE LOCATED IN AN AREA TO NOT RECEIVE FOG SEAL, SUCH AS AN AREA TO BE MILLED, SO THAT THE TEST STRIP IS REMOVED AS PART OF OTHER WORK IN THIS PLAN SET.

ITEM 607 - FENCE, MISC., AS PER PLAN

WORK INCLUDES ALL TREE PROTECTION ACTIVITY INCLUDING BUT NOT LIMITED TO "WORK NEAR TREES" NOTES (PLAN SHEET 2), TREE PROTECTION FENCE, TREE PROTECTION WRAP, TREE PROTECTION MAT, & COORDINATION WITH GREAT PARKS OF HAMILTON COUNTY.

ITEM 608 - 5" CONCRETE WALK, AS PER PLAN

THIS WORK INCLUDES EXCAVATION, SUBGRADE COMPACTION, FURNISHING & INSTALLING ITEM 304 AGGREGATE BASE, & 5" THICK AIR ENTRAINED PLAIN CONCRETE. ALL CONCRETE TO HAVE INITIAL SOLAR REFLECTANCE (SR) OF AT LEAST 0.33. PROVIDE 4" THICK AGGREGATE BASE EXCEPT FOR RIVER MOUNT PAVILION AREA, PROVIDE 6" THICK AGGREGATE BASE. FOR EACH CONCRETE PAD, PROVIDE MIX DESIGN DATA, & TEST FOR 28-DAY COMPRESSIVE STRENGTH.

* ITEM 623 - CONSTRUCTION LAYOUT STAKES & SURVEYING

THIS WORK SHALL BE IN ACCORDANCE WITH ALL APPLICABLE PROVISIONS UNDER ITEM 623. THE CONTRACTOR SHALL BE RESPONSIBLE FOR HAVING THE FINISHED WORK CONFORMING TO THE LINES, GRADES, & DIMENSIONS CALLED FOR ON THE PLANS. THE CONTRACTOR SHALL BE RESPONSIBLE FOR FURNISHING, PLACING & MAINTAINING CONSTRUCTION LAYOUT STAKES NECESSARY FOR THE PROPER PROSECUTION OF THE WORK UNDER THE CONTRACT, & AS DIRECTED BY THE ENGINEER OR GREAT PARKS. PRIOR TO WORK AT ADA AREAS, CONTRACTOR TO PROVIDE OFFSET LAYOUT STAKES/HUBS TO CONFIRM ADA GRADE LINES & ELEVATIONS. INSPECT STAKES/HUBS WITH ENGINEER & GREAT PARKS AUTHORIZED REPRESENTATIVE PRIOR TO CONSTRUCTION AT ADA AREAS. PROVIDE POSITIVE DRAINAGE AWAY FROM ALL PAVED SURFACES.

ITEM SPECIAL - 690 - PAVEMENT CRACK AND JOINT REINFORCING FABRIC

STRESS ABSORBING MEMBRANE INTERLAYER (SAMI)

THE PRODUCT SPECIFIED FOR THIS PROJECT IS 24" WIDE PETROTAC. THE PRODUCT SHALL BE INSTALLED IN ACCORDANCE WITH MANUFACTURER'S INSTRUCTIONS, & SHALL INCLUDE SWEEPING THE PAVEMENT, & BLOWING OFF EACH CRACK WITH A LEAF BLOWER, OR SIMILAR, IMMEDIATELY PRIOR TO PLACEMENT.

ITEM SPECIAL - 690 - CONCRETE PARKING BLOCK

PARKING BLOCK TO BE SIMILAR TO ODOT SCD RM-6.1, EXCEPT PLAN LENGTH TO BE 6- FEET, & SECTION CHAMFER TO BE 2" AT 45-DEGREE (BOTH SIDES). MAINTAIN ANCHOR PIN POSITION PER DETAIL 9" FROM OUTSIDE EDGE. CONCRETE TO BE WHITE COLOR, NOT GRAY. THE CONTRACTOR SHALL POSITION THE PARKING BLOCKS ON TOP OF THE FINAL ASPHALT CONCRETE SURFACE COURSE AS DIRECTED BY THE ENGINEER. THE NEW PARKING BLOCKS & PINS SHALL BE INSTALLED WITHIN 5 DAYS AFTER THE FINAL SURFACE COURSE IS COMPLETED ON THE PARKING LOT. PAYMENT SHALL INCLUDE, BUT NOT BE LIMITED TO, ALL SERVICES, MATERIAL, LABOR, EQUIPMENT, TOOLS & INCIDENTALS TO COMPLETE THE WORK ABOVE & SHALL BE INCLUDED IN THE UNIT BID PRICE FOR ITEM 609 - CONCRETE PARKING BLOCK.

ITEM 601 - TIED-CONCRETE BLOCK MAT W/ TYPE 1 UNDERLAYMENT, APP

PAYMENT FOR TIED-CONCRETE BLOCK MAT (TCBM) INCLUDES FURNISHING & INSTALLING NO NET WOOD FIBER MULCH BLANKET, NAG COIR JUTE NET, OR EQUAL, & STANDARD FLEXAMAT, OR EQUAL, WITHOUT UNDERLAYMENT, AT LOCATIONS SHOWN ON THE PLAN, PROVIDE INSTALL PER MANUFACTURER'S INSTRUCTIONS, & DETAILS ON THESE PLANS. SEE DETAILS ON PLAN SHEET 5.

ITEM 659 - SEEDING AND MULCHING, AS PER PLAN

PROVIDE TYPE 1 LAWN MIXTURE, EXCEPT IN AREAS WITHIN THE WOODS (DOWNSTREAM ENDS OF CONDUITS), PROVIDE TYPE 5B NATIVE WILDFLOWER AND GRASS MIXTURE. QUANTITY INCLUDES AREAS OF LINEAR GRADING (SEE PAVEMENT

DETAILS & PLAN CALLOUTS, & TCBM UNDER MAT & OVER MAT.

THE FOLLOWING QUANTITIES ARE PROVIDED TO PROMOTE GROWTH & CARE OF PERMANENT SEEDING AREAS:

AREA = 4,065.5 SQ. YD. = 36,589.5 SQ. FT.

ITEM 659, SOIL ANALYSIS TEST 2 EACH

ITEM 659, TOPSOIL 451 CU. YD.
111 CU.YD. PER 1000 SQ.YD.

ITEM 659, SEEDING AND MULCHING 4,065.5 SQ. YD.

ITEM 659, COMMERCIAL FERTILIZER 0.55 TON
30 LBS. PER 1000 SQ.FT.

ITEM 659, LIME 0.84 ACRES

ITEM 659, WATER 21.95 M. GAL
2 X 300 GAL. PER 1000 SQ.FT.

APPLY SEEDING & MULCHING TO ALL AREAS OF EXPOSED SOIL WITHIN THE CONSTRUCTION LIMITS. QUANTITY CALCULATIONS FOR SEEDING & MULCHING ARE BASED ON THESE LIMITS.

ITEM 602 - CONCRETE MASONRY, AS PER PLAN

PAYMENT FOR THIS ITEM INCLUDES FURNISHING & INSTALLING CONCRETE HEADWALLS PER SIZE & LOCATION SHOWN ON THE PLAN.

605 - 4" BASE PIPE UNDERDRAINS, AS PER PLAN

PROVIDE PERFORATED PVC PER 707.41. FOR LOCATIONS ADJACENT TO CULVERT, PLACE IN COMMON TRENCH, WITHIN 4-INCHES OF OUTER TRENCH WALL, AT SAME INVERT ELEVATIONS AS CULVERT. CONSTRUCT UPSTREAM END WITH SOLID GLUED ON CAP WHEN TERMINATING UNDER PAVEMENT. TERMINATE DOWNSTREAM OUTLET THROUGH HEADWALL, PROVIDE REMOVABLE (THREADED) END CAP, SLOTTED VERTICALLY TO ALLOW PIPE TO DRAIN, FINISH FLUSH WITH FACE OF HEADWALL.

605 - 4" BASE PIPE UNDERDRAINS WITH GEOTEXTILE FABRIC, AS PER PLAN

SEE GEOGRID FULL DEPTH PAVEMENT DETAIL SHOWN ON PLAN SHEET 4. FOR LOCATIONS NOTED ON PLAN, TERMINATE WITH CLEANOUT (PAY ITEM 611) OR HEADWALL (PAY ITEMS 602 OR 611). TRANSITION DOWNSTREAM 50- FEET TO PROPER ALIGNMENT & ELEVATION PER OUTLET HEADWALL LOCATION. TERMINATE DOWNSTREAM OUTLET THROUGH HEADWALL, PROVIDE REMOVABLE (THREADED) END CAP, SLOTTED VERTICALLY TO ALLOW PIPE TO DRAIN, FINISH FLUSH WITH FACE OF HEADWALL.

ITEM 611 - 6" CONDUIT AND 12" CONDUIT, TYPE A, 707.45

INSTALL NEW CONDUIT. PAYMENT SHALL INCLUDE BUT IS NOT LIMITED TO ANY GRADING IN THE VICINITY OF THE PIPE TO PROVIDE POSITIVE DRAINAGE INTO & OUT OF THE PIPE; MATERIAL & INSTALLATION OF PIPE BEDDING & BACKFILL. FOLLOW CMS 611 PERFORMANCE INSPECTION REQUIREMENTS. SEE SEPARATE PAY ITEMS FOR PAVEMENT, MASONRY (HEADWALLS), & TIED-CONCRETE BLOCK MAT (TCBM). VERIFY POSITIVE DRAINAGE FROM INLET TO OUTLET END (NORTHEAST), MATCH EXISTING INVERTS. PROVIDE STRUCTURAL BACKFILL FOR ENTIRE TRENCH, & PER MANUFACTURERS INSTRUCTIONS. EXTEND STRUCTURAL BACKFILL FROM TOP OF BEDDING TO BOTTOM OF PAVEMENT SECTION OR SEED & MULCH SECTION (4-INCH DEPTH, PAY ITEM 659). AT PAVEMENT LOW POINT CONDUITS, APPROX. STA. 4+75 & 28+50, PROVIDE FREE DRAINING STRUCTURAL BACKFILL TYPE 3. PROTECT BACKFILL FROM BEING CONTAMINATED WITH SOIL.

PAVEMENT MARKING NOTES

SEE PLAN SHEET 10. THE CONTRACTOR SHALL REFERENCE ALL PAVEMENT MARKINGS INCLUDING AUXILIARY PAVEMENT MARKINGS BEFORE THE START OF THE RESURFACING OPERATION. THIS WILL BE NECESSARY TO ASSURE THE CORRECT PLACEMENT OF THE MARKINGS IN ORIGINAL LOCATIONS. PAYMENT FOR THIS OPERATION SHALL BE INCLUDED WITH EACH RESPECTIVE PAVEMENT MARKING ITEM. THE CONTRACTOR IS RESPONSIBLE FOR REPLACING ALL EXISTING PERMANENT MARKINGS WITH THIS CONTRACT AS SHOWN ON THE PLANS. THE OWNER SHALL INSPECT & CONCUR WITH THE LAYOUT. LAYOUT WORK SHALL BE PERFORMED BY THE CONTRACTOR & INCLUDED IN THE PRICE BID FOR THESE ITEMS. UNLESS OTHERWISE NOTED, ALL PAVEMENT MARKINGS INDICATED IN THE PLANS SHALL BE PAINTED OVER. APPLY GLASS BEADS TO THE WET PAINT SO THAT BEADS ARE EMBEDDED & RETAINED IN THE PAINT & PROVIDE UNIFORM RETROREFLECTIVITY IN THE PAINT SURFACE. ALL WORK SHALL BE IN ACCORDANCE WITH ODOT CMS ITEMS 641 & 642. PROVIDE DOCUMENTATION VERIFYING THAT ALL PAINT MATERIAL IS APPROVED BY ODOT. USE ONLY ODOT PREQUALIFIED TYPE 1A COLD WEATHER PAINT MATERIALS WHEN THE TEMPERATURE IS BETWEEN 35 & 50 DEGREES F.

* ASTERISK DENOTES APPROVAL BY OWNER REQUIRED

APP DENOTES "AS PER PLAN"

DESIGN AGENCY	RM
DESIGNER	RM
REVIEWER	TZ
	04-13-23
PROJECT ID	117816
SHEET	TOTAL
P.3	19

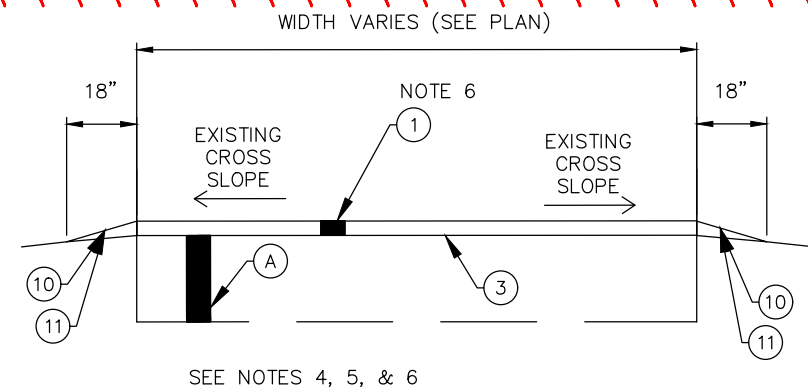

PAVEMENT SURFACE OVERLAY DETAIL (SU)

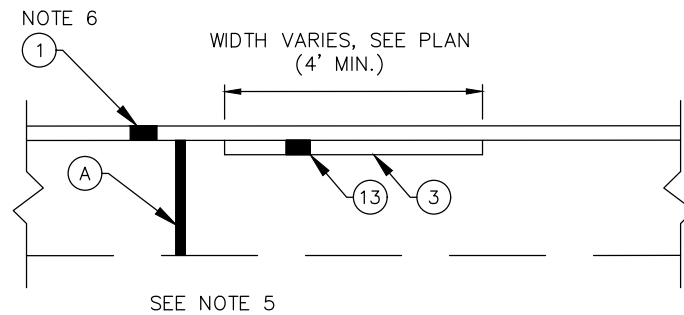

PARTIAL DEPTH PAVEMENT REPAIR DETAIL (PD)

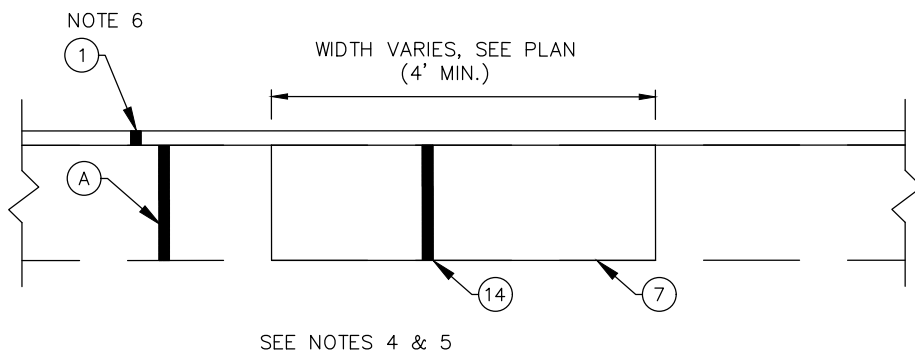

FULL DEPTH PAVEMENT REPAIR DETAIL (FD)

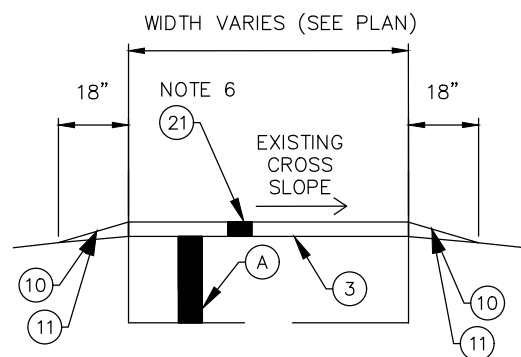

PART 02/NFA/28 -PEDESTRIAN WALK PAVEMENT SURFACE OVERLAY DETAIL (SU)

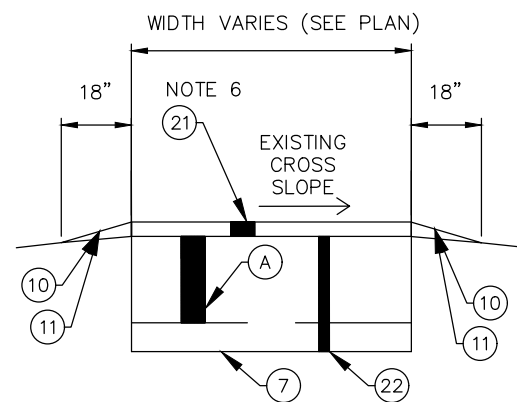

PART 02/NFA/28 -PEDESTRIAN WALK FULL DEPTH PAVEMENT REPAIR DETAIL (FD)

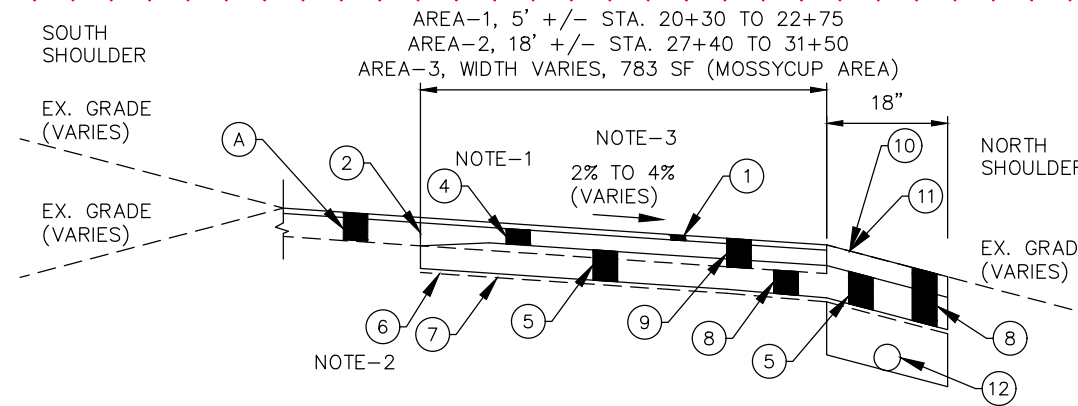

GEOGRID FULL DEPTH PAVEMENT DETAIL (GR)

- (A) EXISTING ASPHALT PAVEMENT (AVERAGE 8.5" DEPTH)
- (1) ITEM 441 - 1 1/2" ASPHALT CONCRETE SURFACE COURSE, TYPE 1, (448) PG64-22
• INCLUDES ITEM 407 - NON-TRACKING COAT
- (2) ITEM 407 - NON-TRACKING TACK COAT
- (3) ITEM 690 - CRACK & JOINT REINFORCING FABRIC, STRESS ABSORBING MEMBRANE INTERLAYER (SAMI),
• AT PLAN LOCATIONS, & AFTER PLANING ANY REMAINING CRACKS 1" WIDE & GREATER AT UNIT COST AS DIRECTED BY THE ENGINEER
- (4) ITEM 301 - 6" ASPHALT CONCRETE BASE, (449) PG64-22
- (5) ITEM 304 - 4" AGGREGATE BASE
- (6) ITEM 204 - GEOGRID
- (7) ITEM 204 - SUBGRADE COMPACTION
• REPLACE ANY YIELDING MATERIAL WITH ITEM 304 AGGREGATE BASE AT 304 UNIT COST AS DIRECTED BY THE ENGINEER
- (8) ITEM 203 - EXCAVATION
- (9) ITEM 202 - PAVEMENT REMOVAL
- (10) ITEM 209 - LINEAR GRADING (MATCH EX. GRADE)
- (11) ITEM 659 - SEEDING & MULCHING
- (12) ITEM 605 - UNDERDRAIN
• ONLY AT STA. 27+40 TO 31+40, SOUTH SHOULDER, 12" BELOW PAVEMENT SECTION AGGREGATE BASE/GEOGRID
- (13) ITEM 251 - PARTIAL DEPTH PAVEMENT REPAIR
• INCLUDES ITEM 254 - PAVEMENT PLANING; ASPHALT DEPTH = 1 1/2"
• INCLUDES ITEM 407 - NON-TRACKING COAT, AFTER PLANING
• INCLUDES ITEM 441 - 1 1/2" ASPHALT CONCRETE INTERMEDIATE COURSE, TYPE 1, (448)
- (14) ITEM 253 - FULL DEPTH PAVEMENT REPAIR
• INCLUDES ITEM 202 - PAVEMENT REMOVAL
• INCLUDES ITEM 203 - EXCAVATION
• INCLUDES ITEM 301 - ASPHALT CONCRETE BASE, 8.5" AVERAGE (MATCH EXISTING DEPTH), (449) PG64-22
• INCLUDES ITEM 407 - NON-TRACKING COAT, ON VERTICAL SURFACES
- (21) PART 02/NFA/28
ITEM 441 - 2" ASPHALT CONCRETE SURFACE COURSE, TYPE 1, (448) PG64-22
• INCLUDES ITEM 407 - NON-TRACKING COAT
- (22) PART 02/NFA/28
ITEM 253 - FULL DEPTH PAVEMENT REPAIR
• INCLUDES ITEM 202 - PAVEMENT REMOVAL
• INCLUDES ITEM 203 - EXCAVATION
• INCLUDES ITEM 301 - 2" ASPHALT CONCRETE BASE, (449) PG64-22
• INCLUDES ITEM 304 - 6" AGGREGATE BASE

NOTES

1. WHEN ABUTTING EXISTING PAVEMENT, & GREATER THAN 6-INCH DEPTH IS ENCOUNTERED, MATCH EXISTING DEPTH AT 301 UNIT COST.
2. IN AREAS OF FULL ROAD WIDTH GEOGRID, OVERLAP EXCESS GEOGRID ROLL WIDTH ALONG CENTERLINE OF PAVEMENT AS NECESSARY.
3. IN AREAS OF FULL ROAD WIDTH GEOGRID, CONSTRUCT ENTIRE ROAD SECTION WITH CROSS SLOPE FROM SOUTH DOWN TO NORTH (NO CROWN).
4. SEE PART 02/NFA/28 - PEDESTRIAN WALK DETAILS (THIS SHEET).
5. SEE TECH BOOTH AREA SECTIONS (SHEET 7).
6. PROVIDE ADDITIONAL SURFACE COURSE AS NECESSARY FOR ADA GRADING, TECH BOOTH & FOR POSITIVE DRAINAGE AWAY FROM PAVEMENT.

NO SCALE

DESIGN AGENCY



DESIGNER

RM

REVIEWER

TZ 04-13-23

PROJECT ID

117816

SHEET

P.4

TOTAL

19

PIPE DIA. OR EQUIV. DIA.	SHAPE	DIMENSIONS						CLASS A CONC. C. Y.	REINF. STEEL LBS.
		C	E	F	L	W	T		
12"	○	1'-9"	2'-6"	2'-3"	3'-6"	4'-0"	2"	0.58	7
15"	○	2'-0"	2'-9"	2'-9"	4'-0"	4'-9"	2 1/4"	0.68	7
18"	○	1'-9"	3'-0"	3'-6"	4'-6"	4'-9"	2 1/2"	0.93	8
21"	○	2'-0"	3'-9"	3'-0"	4'-0"	5'-6"	2 3/4"	1.14	9
24"	○	2'-6"	3'-3"	3'-6"	5'-0"	6'-0"	3"	1.35	8
27"	○	2'-0"	3'-9"	3'-0"	4'-6"	6'-9"	3 1/4"	1.57	9
27"	○	2'-9"	4'-6"	4'-3"	5'-3"	7'-3"	3 1/2"	1.51	10

NOTES

- DIMENSIONS AND QUANTITIES ARE BASED ON CONCRETE PIPE AND WILL VARY INSIGNIFICANTLY FOR ALTERNATE PIPE MATERIALS.
- REINFORCING STEEL: MINIMUM GRADE 40, BARS EVENLY SPACED.
- 6 - NO. 4 x 1'-0" DOMEL BARS.
- 2 - NO. 4 x (E DIMENSION MINUS 4")
- SLOPES SHALL BE WARPED TO FIT HEADWALL WHEN PIPE IS SKEWED AND/OR NORMAL SLOPE VARIES FROM 2:1.
- VOLUME DISPLACED BY PIPE COMPUTED USING INSIDE DIAMETER OF PIPE.
- WING ANGLES AND/OR DIMENSIONS MAY BE ALTERED DURING CONSTRUCTION TO ACCOMMODATE FLOW OF WATER.
- APRON BETWEEN WINGS SHALL BE SLOPED IN DIRECTION OF FLOW EQUAL TO SLOPE OF PIPE. FRONT FACE OF HEADWALL SHALL REMAIN VERTICAL.
- HEADWALLS ARE FOR CIRCULAR, ARCH, AND HORIZONTAL ELLIPTICAL 12"-27" EQUIVALENT PIPE SIZES. SEE CURRENT KDOT STD. DWG. R01-016, FOR NON-CIRCULAR PIPE EQUIVALENT SIZES.
- ENCLOSURE GRATE SHALL BE INSTALLED PER DETAIL STM-19 FOR PIPE SIZES 24 INCHES DIAMETER AND UNDER.

PLAN VIEW

SECTION A-A

ISOMETRIC VIEW

TOE OF SLOPES:
 a. STEEPER THAN 2:1
 b. 2:1
 c. FLATTER THAN 2:1

SLOPED & FLARED HEADWALLS (12"-27" PIPE)
 (STM-16)
 N.T.S.
 (REFERENCE KYTC STANDARD DRAWING RDH-020)

- TCBM NOTES:**
- "TCBM" DENOTES "TIED CONCRETE BLOCK MAT".
 - TCBM DIMENSION VARIES, SEE PLAN.
 - PROVIDE U-ANCHORS, 18-INCH LONG NO.3 EPOXY COATED REBAR, INSTALLED IN 2-FOOT INCREMENTS BEHIND FIRST EXPOSED BLOCK SO THAT ANCHOR IS TIGHT WITH SUBGRADE.
 - "FG" DENOTES "FINISHED GRADE"
 - PRIOR TO INSTALLATION OF BLOCK MAT, PROVIDE SUBGRADE ELEVATION SUCH THAT FINISHED GRADE OF THE MAT ALLOWS ALL NEARBY PAVEMENT AND SURROUNDING SURFACE RUNOFF TO DRAIN ONTO THE MAT AND CONTINUE TO FLOW OFF THE LOW END OF THE MAT (INCLUDED IN PAY ITEMS FOR EXCAVATION, EMBANKMENT, OR LINEAR GRADING AS NOTED ON THE PLAN).
 - AFTER SUBGRADE PREP, PROVIDE SEEDING MIX PER ITEM 659 (PAY ITEM 659). PROVIDE NO NET WOOD FIBER MULCH BLANKET, NAG COIR JUTE NET, OR EQUAL, OVER SEEDING, & STANDARD FLEXAMAT WITHOUT UNDERLAYMENT, OR EQUAL, OVER BLANKET.
 - PROVIDE FINISHED LENGTH & WIDTH DIMENSIONS SHOWN/NOTED ON PLAN. DIMENSIONS SHOWN/NOTED DO NOT INCLUDE ADDITIONAL MAT NEEDED FOR ANCHORING & MANUFACTURING VARIATIONS. PAYMENT SHALL INCLUDE, BUT NOT LIMITED TO, ANY ADDITIONAL MAT NECESSARY, ALL SERVICES, MATERIALS, LABOR, EQUIPMENT, TOOLS & INCIDENTALS NECESSARY TO COMPLETE THE WORK SHOWN IN THESE DETAILS, & SHALL BE INCLUDED IN THE UNIT BID PRICE FOR 601 - TIED CONCRETE BLOCK MAT.
 - ASPHALT FOR FLASHING ANCHOR SHALL BE PAID AT UNIT BID PRICE FOR ASPHALT SURFACE COURSE.

- HEADWALL NOTES:**
- DIMENSION NOTE, FOR CONDUIT SIZE LESS THAN 12", USE REDUCED HEADWALL DIMENSIONS, SIMILAR TO ODOT SCD DM-1.1, 1/15/16.
 - PER PLAN LOCATIONS, PROVIDE ADDITIONAL PIPE PENETRATION HOLE FOR UNDERDRAIN OUTLET.

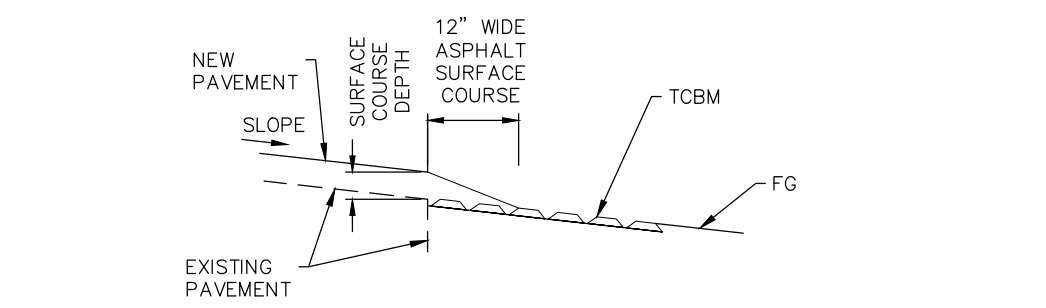

- TCBM FLASHING ANCHOR NOTES:**
- FLASHING ANCHOR WITH NEW ASPHALT SURFACE COURSE "FLASHING" OVER MAT TO FACILITATE SHEET FLOW RUNOFF FROM PAVEMENT ONTO MAT, AND TO ANCHOR MAT
 - PLACE ASPHALT AT SAME TIME AS ABUTTING ASPHALT PAVEMENT PLACEMENT.

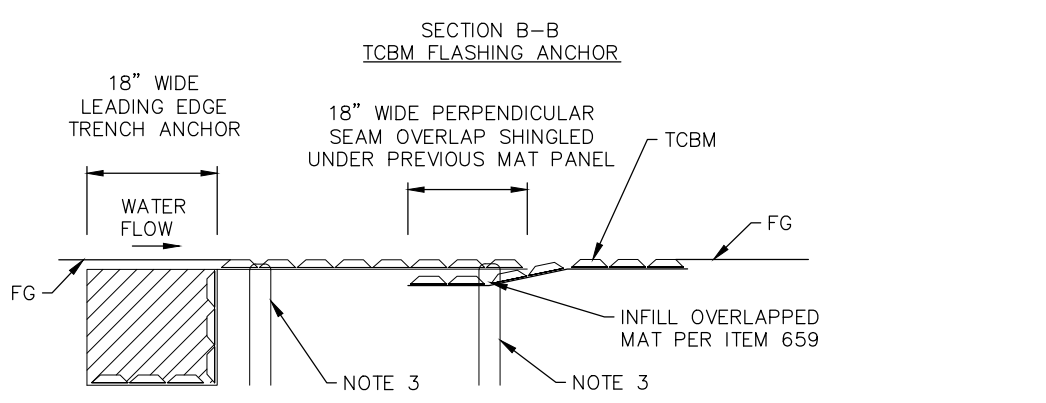

- TCBM LEADING EDGE TRENCH ANCHOR NOTES:**
- 18" DEEP X 18" WIDE LEADING EDGE TRENCH ANCHOR AT LEADING EDGE OF MAT EXPOSED TO RUNOFF.
 - EXTEND MAT 18" VERTICALLY INTO GROUND AT LEADING EDGE OF MAT.
 - UNDER HEADWALL, EXTEND MAT 18" VERTICALLY INTO GROUND AND 18" HORIZONTALLY ACROSS TRENCH BOTTOM.
 - FILL & COMPACT TRENCH WITH STRUCTURAL BACKFILL TYPE-1.
 - FOR LAWN AREAS, LOWER STRUCTURAL FILL FINAL ELEVATION FOR ITEM 659.

SECTION C-C
TCBM LEADING EDGE TRENCH ANCHOR

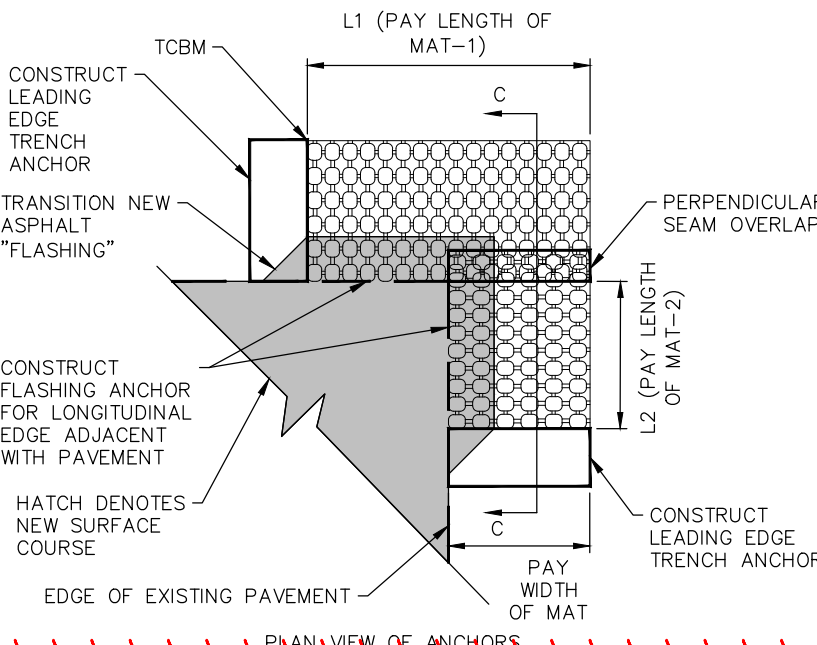
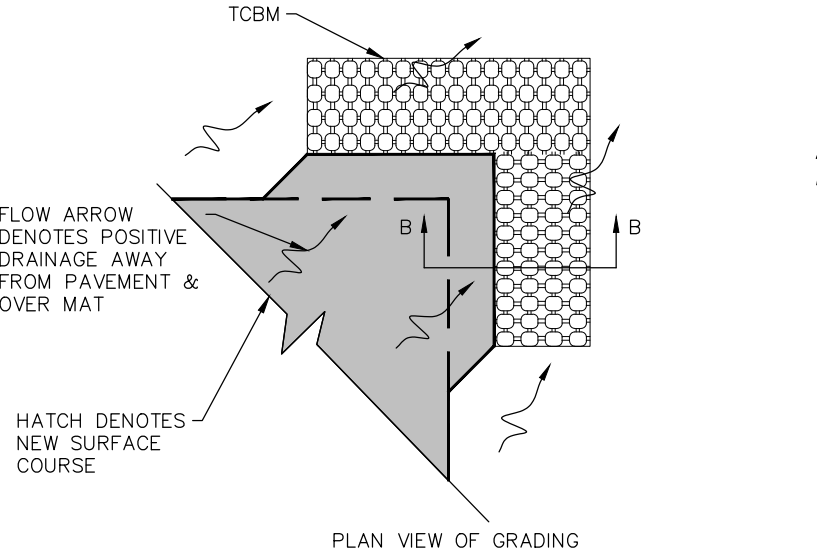

TCBM ABUTTING PAVEMENT DETAIL

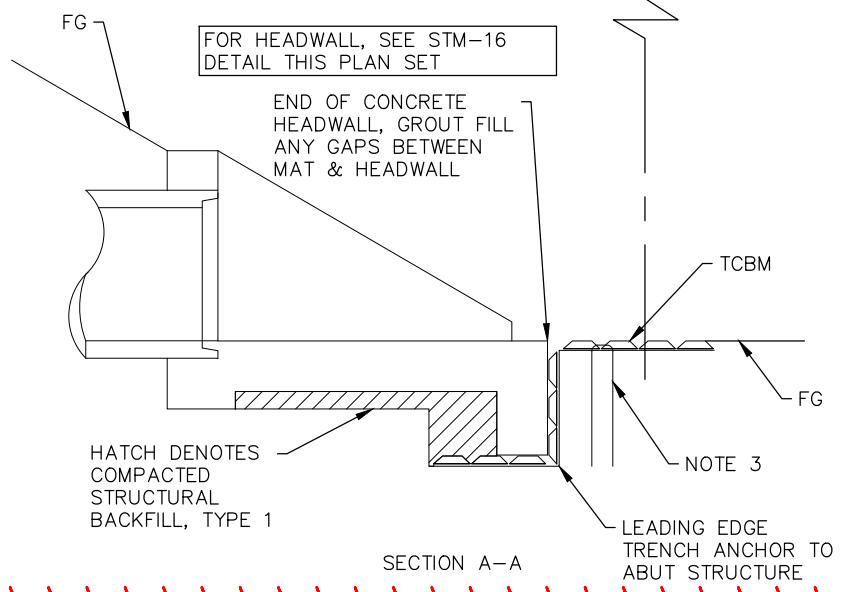
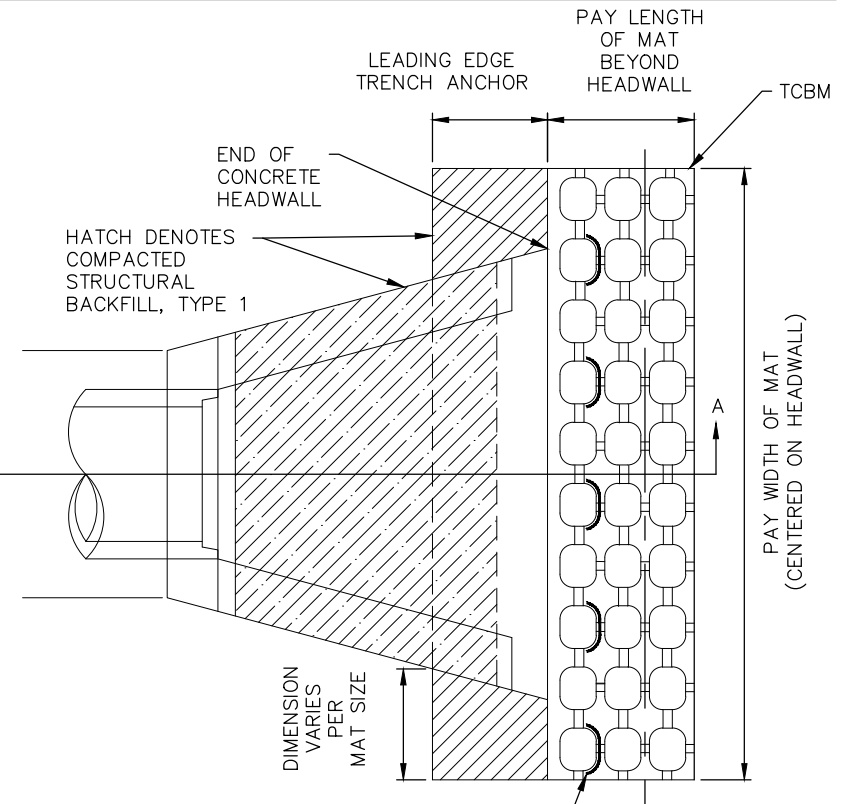

TCBM AT HEADWALL DETAIL
 (OUTLET PROTECTION)

SHEET NUM.										PART.		ITEM	ITEM EXT	GRAND TOTAL	UNIT	DESCRIPTION	SEE SHEET NO.
7	8	9	10	11	3	7	01/NFP/0 4/GPHC	02/NFA/2 8									
										LS	201	11001	LS			ROADWAY	
		71.2	1,090				1,115	46.2		202	23001	1,161.2	SY		CLEARING AND GRUBBING, AS PER PLAN	3	
100	338	101					488	51		202	35100	539	FT		PAVEMENT REMOVED, AS PER PLAN	4	
					293		293			SPECIAL	20252990	293	EACH		PIPE REMOVED, 24" AND UNDER	7	
	85	30					115			SPECIAL	20270000	115	FT		PARKING BLOCK REMOVED	3	
							LS			202	98000	LS			FILL AND PLUG EXISTING CONDUIT 12"	3	
	11.8	140.1					151.9			203	10001	152	CY		REMOVAL MISC.: AS PER PLAN	3	
15	15	15					45			203	20001	45	CY		EXCAVATION, AS PER PLAN	4	
343.8	343.1	1,210.2					1,507.2	389.9		204	10001	1,897.1	SY		EMBANKMENT, AS PER PLAN	7	
80		54					134			204	50001	134	SY		SUBGRADE COMPACTION, AS PER PLAN	4	
	86	1,210.2					1,296.2			204	51001	1,296.2	SY		GEOTEXTILE FABRIC, AS PER PLAN	3	
782.2	2,164.7	984					3,375.5	555.4		209	98300	3,930.9	SY		GEOGRID, AS PER PLAN	3	
1,183	2,121	522					3,081	745		607	98000	3,826	FT		LINEAR GRADING, MISC.: AS PER PLAN	4	
	764	98						862		608	12001	862	SF		FENCE, MISC.: AS PER PLAN	3	
															5" CONCRETE WALK, AS PER PLAN	3	
122	148	47					317			SPECIAL	69012040	317	SY		PAVEMENT CRACK AND JOINT REINFORCING FABRIC	3	
					255		255			SPECIAL	69050500	255	EACH		CONCRETE PARKING BLOCK	3	
																EROSION CONTROL	
86.4	39.8	35.7					158.2	3.7		601	21051	161.9	SY		TIED CONCRETE BLOCK MAT WITH TYPE 1 UNDERLAYMENT, AS PER PLAN	3	
865.6	2,202.5	997.4					3,786.4	279.1		659	10001	4,065.5	SY		SEEDING AND MULCHING, AS PER PLAN	3	
																DRAINAGE	
2.32	6.96	2.32					10.44	1.16		602	20001	11.6	CY		CONCRETE MASONRY, AS PER PLAN	5	
56		36					92			605	06001	92	FT		4" BASE PIPE UNDERDRAINS, AS PER PLAN	3	
		473					473			605	06021	473	FT		4" BASE PIPE UNDERDRAINS WITH GEOTEXTILE FABRIC, AS PER PLAN	3	
100	311	100					473	38		611	04200	511	FT		12" CONDUIT, TYPE A, 707.45	3	
12	13	27					27	25		611	97400	52	FT		CONDUIT, MISC.: 6" CONDUIT, 707.45	3	
2	2	2					2	4		611	99710	6	EACH		PRECAST REINFORCED CONCRETE OUTLET	5	
		4					4			611	99900	4	EACH		DRAINAGE STRUCTURE, MISC.: CLEANOUT	7	
100	311	100					473	38		611	04200	511	FT		12" CONDUIT, TYPE A, 707.04	7	
100	311	100					473	38		611	04200	511	FT		12" CONDUIT, TYPE A, 706.02	7	
																PAVEMENT	
2,219.3	1,944.8	2,346.4					6,510.5			251	01001	6,510.5	SY		PARTIAL DEPTH PAVEMENT REPAIR (441), AS PER PLAN	4	
79.3	183.7	54.1					230.5	86.6		253	02001	317.1	CY		PAVEMENT REPAIR, AS PER PLAN	4	
	11	174								301	56001	185	CY		ASPHALT CONCRETE BASE, (449), AS PER PLAN PG64-22	4	
	9.6	134.5					144.1			304	20001	144.1	CY		AGGREGATE BASE, AS PER PLAN	4	
	6	13.2					19.2			407	20001	19.2	GAL		NON-TRACKING TACK COAT, AS PER PLAN	4	
1,791	855						2,646			423	00204	2,646	SY		CRACK SEALING, TYPE II	7	
201.9	238	194.1					598.7	35.3		441	50000	634	CY		ASPHALT CONCRETE SURFACE COURSE, TYPE 1, (448), PG64-22	4	
268.7	128.2						396.9			886	11000	396.9	GAL		FOG SEAL	4	
																WATER WORK	
									2	638	10800	2	EACH		VALVE BOX ADJUSTED TO GRADE	11	
																TRAFFIC CONTROL	
7	4	1					12			630	84901	12	EACH		REMOVAL OF GROUND MOUNTED SIGN AND DISPOSAL, AS PER PLAN	7	
8	7	4					19			630	97700	19	EACH		SIGNING, MISC.: AS PER PLAN	7	
							1.11			642	00100	1.11	MILE		EDGE LINE, 4", TYPE 1		
							0.57			642	00300	0.57	MILE		CENTER LINE, TYPE 1		
							10			642	00500	10	FT		STOP LINE, TYPE 1		
							400			642	00701	400	FT		TRANSVERSE/DIAGONAL LINE, TYPE 1, AS PER PLAN	10	
							5,000			642	01200	5,000	FT		PARKING LOT STALL MARKING, TYPE 1		
							14			642	01703	14	EACH		HANDICAP SYMBOL MARKING, TYPE 1, AS PER PLAN	10	
																MAINTENANCE OF TRAFFIC	
							LS			614	11000	LS			MAINTAINING TRAFFIC	2	
																INCIDENTALS	
							LS			624	10000	LS			MOBILIZATION	2	
							LS			623	10000	LS			CONSTRUCTION LAYOUT STAKES AND SURVEYING	3	

*** TECH BOOTH AREA NOTES**
 TECH BOOTH AREA REQUIRES DIFFERENT FINISHED GRADES THAN OTHER AREAS IN ORDER TO MAINTAIN EXISTING CONCRETE CURB REVEAL & DRAINAGE. MODIFY PLAN SHEET 4 DETAILS TO PROVIDE FINISHED GRADES PER SECTIONS ON THIS SHEET.

- (A) EXISTING ASPHALT PAVEMENT
- (B) EXISTING GRADE
- (C) FINISHED GRADE
- (D) SURFACE COURSE
- (E) PAVEMENT PLANING

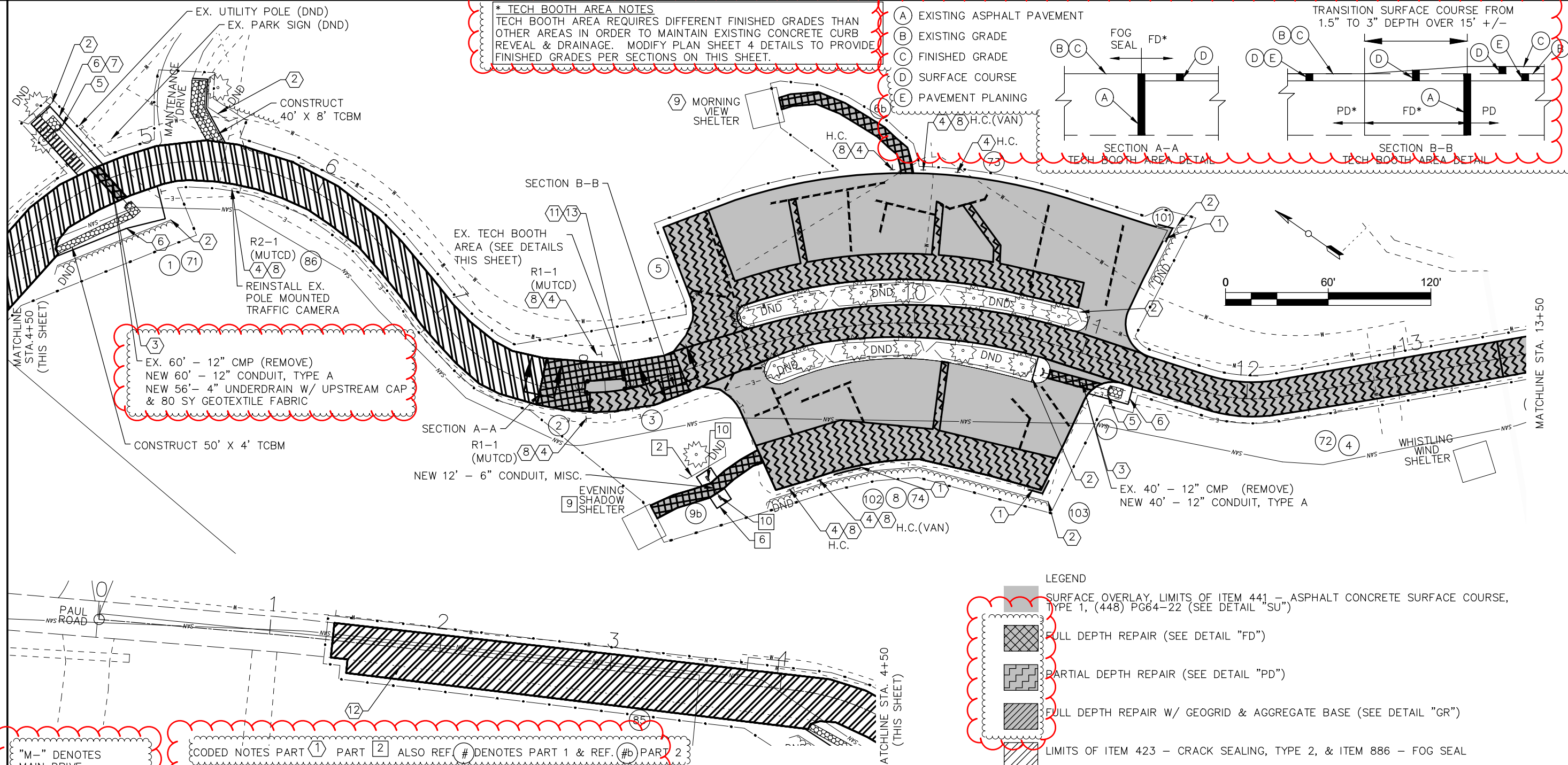
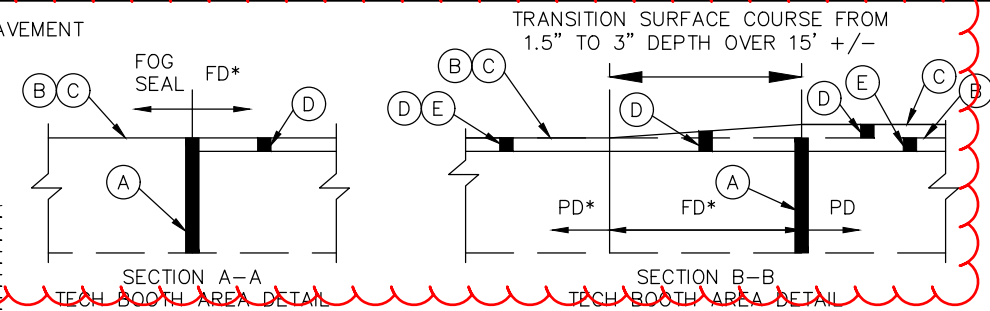

EX. 60' - 12" CMP (REMOVE)
 NEW 60' - 12" CONDUIT, TYPE A
 NEW 56' - 4" UNDERDRAIN W/ UPSTREAM CAP & 80 SY GEOTEXTILE FABRIC

EX. 40' - 12" CMP (REMOVE)
 NEW 40' - 12" CONDUIT, TYPE A

- LEGEND**
- SURFACE OVERLAY, LIMITS OF ITEM 441 - ASPHALT CONCRETE SURFACE COURSE, TYPE 1, (448) PG64-22 (SEE DETAIL "SU")
 - FULL DEPTH REPAIR (SEE DETAIL "FD")
 - PARTIAL DEPTH REPAIR (SEE DETAIL "PD")
 - FULL DEPTH REPAIR W/ GEOGRID & AGGREGATE BASE (SEE DETAIL "GR")
 - LIMITS OF ITEM 423 - CRACK SEALING, TYPE 2, & ITEM 886 - FOG SEAL
 - STRESS-ABSORBING MEMBRANE INTERLAYER (SAMI). 24" WIDE, APPROXIMATE LOCATION (SEE GEN. NOTES)
 - DND TREE PROTECTION FENCE, DND (DO NOT DISTURB) (SEE GEN. NOTES & DETAILS)
 - TREE PROTECTION WRAP AROUND EXIST. TREE (SEE GEN. NOTES & DETAILS)
 - TREE PROTECTION MAT PLACED ON GRADE (SEE GEN. NOTES & DETAILS)
 - HEADWALL (SEE DETAILS)
 - TIED-CONCRETE BLOCK MAT (TCBM), STANDARD FLEXAMAT WITHOUT UNDERLAYMENT, OR EQUAL (SEE DETAILS)
 - LIMITS OF CONSTRUCTION
 - SHLD SHOULDER
 - H.C. HANDICAP PARKING (SEE ADA PLAN SHEET DETAIL)
 - MUTCD MANUAL OF UNIFORM TRAFFIC CONTROL DEVICES

"M-" DENOTES MAIN DRIVE

DESC.	Ref. #	Area (SF)
FD	1	123
FD M-	2	1634
PD M-	3	514
PD M-	4	9883
PD	5	5595
FD	7	143
PD	8	3982
SU M-	71	123
SU M-	72	12195
SU	73	17792
SU	74	11865
SEAL M-	85	9406
SEAL M-	86	6714
TCBM	101	15
TCBM	102	16
TCBM	103	15
FD	6b	659
FD	9b	535

- CODED NOTES PART 1 PART 2 ALSO REF. # DENOTES PART 1 & REF. #b PART 2
1. CONSTRUCT TIED CONCRETE BLOCK MAT, STANDARD FLEXAMAT WITHOUT UNDERLAYMENT (OR EQUAL), 4'-WIDE BY LENGTH SHOWN
 2. CONSTRUCT TREE PROTECTION FENCE
 3. REMOVE EX. CONDUIT; CONSTRUCT NEW CONDUIT, (SEE PLAN LENGTHS & SIZE). CONSTRUCT INLET & OUTLET HEADWALLS.
 4. ITEM 630 - INSTALL NEW OWNER FURNISHED COMPOSITE SIGN POST. PROVIDE & INSTALL NEW SIGN (SEE ADA PLAN SHEET 16).
 5. CONSTRUCT OUTLET PROTECTION WITH TIED CONCRETE BLOCK MAT, STANDARD FLEXAMAT WITHOUT UNDERLAYMENT (OR EQUAL), 5.5'-WIDE BY 6'-BEYOND HEADWALL.
 6. GRADING/RESHAPE GRASS AREA PROVIDE 4H:1V SLOPE, (3H:1V MAX) (280 SY)
 7. CONSTRUCT EMBANKMENT TO FILL EX. ERODED AREA (15 CY)
 8. ITEM 630 - REMOVE EX. SIGN POST & RETURN SIGN TO OWNER.
 9. SEE GRADING/ADA PLAN SHEETS (VARIABLE OVERLAY DEPTH)
 10. CONSTRUCT HEADWALL (NO OUTLET PROTECTION)
 11. REMOVE & RESET EX. SITE FURNISHING (PLANTERS)
 12. EX. PARKING BLOCKS ALONG ENTRANCE DRIVE TO REMAIN.
 13. EX. BOLLARDS TO REMAIN.

DESIGN AGENCY

 DESIGNER
 RM
 REVIEWER
 TZ 04-13-23
 PROJECT ID
 117816
 SHEET TOTAL
 P.7 19

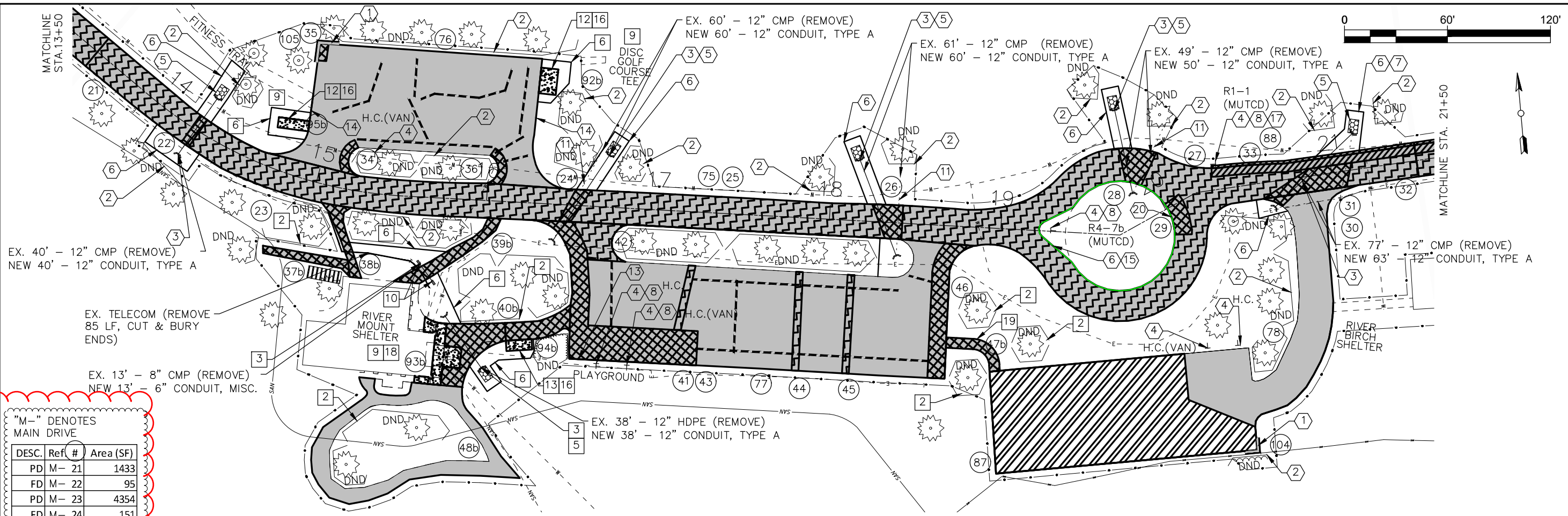

"M-" DENOTES MAIN DRIVE

DESC.	Ref. #	Area (SF)
PD	M- 21	1433
FD	M- 22	95
PD	M- 23	4354
FD	M- 24	151
PD	M- 25	3304
FD	M- 26	271
PD	M- 27	6836
FD	M- 28	316
FD	M- 29	219
FD	M- 30	48
FD	M- 31	498
PD	M- 32	540
GR	M- 33	596
FD	M- 34	105
FD	M- 35	50
FD	M- 36	111
FD	M- 41	2144
PD	M- 42	422
PD	M- 43	154
PD	M- 44	230
PD	M- 45	230
FD	M- 46	815
SU	M- 75	18614
SU	M- 76	8550
SU	M- 77	13934
SU	M- 78	4264
SEAL	M- 87	7695
SHLD	M- 88	178
TCBM	M- 104	15
TCBM	M- 105	23
FD	M- 37b	255
FD	M- 38b	256
FD	M- 39b	446
FD	M- 40b	1127
FD	M- 47b	230
SU	M- 48b	2186
CONC	M- 92b	150
CONC	M- 93b	416
CONC	M- 94b	90
CONC	M- 95b	108

CODING NOTES PART 1 PART 2 ALSO REF. # DENOTES PART 1 & REF. #b PART 2

1. CONSTRUCT TIED CONCRETE BLOCK MAT, STANDARD FLEXAMAT WITHOUT UNDERLAYMENT (OR EQUAL), 4'-WIDE BY LENGTH SHOWN
2. CONSTRUCT TREE PROTECTION FENCE
3. REMOVE EX. CONDUIT; CONSTRUCT NEW CONDUIT, (SEE PLAN LENGTHS & SIZE). CONSTRUCT INLET & OUTLET HEADWALLS
4. ITEM 630 - INSTALL NEW OWNER FURNISHED COMPOSITE SIGN POST. PROVIDE & INSTALL NEW SIGN (SEE ADA PLAN SHEET 16).
5. CONSTRUCT OUTLET PROTECTION WITH TIED CONCRETE BLOCK MAT, STANDARD FLEXAMAT WITHOUT UNDERLAYMENT (OR EQUAL), 5.5'-WIDE BY 6'-BEYOND HEADWALL.
6. GRADE/RESHAPE GRASS AREA PROVIDE 4H:1V SLOPE, (3H:1V MAX) (940 SY)
7. CONSTRUCT EMBANKMENT TO FILL EX. ERODED AREA (15 CY)
8. ITEM 630 - REMOVE EX. SIGN POST & RETURN SIGN TO OWNER.
9. SEE GRADING ADA PLAN SHEETS (VARIABLE OVERLAY DEPTH)
10. CONSTRUCT HEADWALL (NO OUTLET PROTECTION)
11. CUT EX. CONDUIT 2' BEYOND EDGE OF PAVEMENT; REMOVE CONDUIT UNDER PAVEMENT; FILL & PLUG REMAINING CONDUIT SECTION NEAR TREE.
12. REMOVE AND DISPOSE OF EX. BENCH; EXCAVATE & REMOVE EX. FOOTING, BACKFILL WITH SELECT BACKFILL.
13. REMOVE & RESET EX. SITE FURNISHING (BICYCLE RACK, BENCH)
14. REMOVE & DISPOSE OF EX. TIMBERS ALONG PAVEMENT (APPROX. 40 LF TOTAL)
15. REMOVE ASPHALT OUTSIDE/BEYOND PAVEMENT LANE (5 SY). REGRADE CENTER OF ISLAND (385 SY), PROVIDE POSITIVE DRAINAGE TO NEW CULVERT PIPE.
16. CONSTRUCT NEW CONCRETE TO ACHIEVE ADA COMPLIANT SLOPES ALONG PATH & FOR FUTURE BENCH (ACCESSIBLE ROUTE)
17. STOP BAR MARKING
18. REMOVE EX. CONCRETE, SEE GRADING PLAN (46.2 SY)
19. CONSTRUCT NEW WALK (SEE DETAIL "FD", PEDESTRIAN WALK NOTES)
20. CONSTRUCT VARIABLE OVERLAY FOR POSITIVE DRAINAGE AWAY FROM PAVEMENT (EX. AREA OF PONDING WATER)

LEGEND

- SURFACE OVERLAY, LIMITS OF ITEM 441 - ASPHALT CONCRETE SURFACE COURSE, TYPE 1 (448) PG64-22 (SEE DETAIL "SU")
- FULL DEPTH REPAIR (SEE DETAIL "FD")
- PARTIAL DEPTH REPAIR (SEE DETAIL "PD")
- FULL DEPTH REPAIR W/ GEOGRID & AGGREGATE BASE (SEE DETAIL "GR")
- LIMITS OF ITEM 423 - CRACK SEALING, TYPE 2, & ITEM 886 - FOG SEAL
- STRESS-ABSORBING MEMBRANE INTERLAYER (SAMI), 24" WIDE, APPROXIMATE LOCATION (SEE GEN. NOTES)
- TREE PROTECTION FENCE, DND (DO NOT DISTURB) (SEE GEN. NOTES & DETAILS)
- TREE PROTECTION WRAP AROUND EXIST. TREE (SEE GEN. NOTES & DETAILS)
- TREE PROTECTION MAT PLACED ON GRADE (SEE GEN. NOTES & DETAILS)
- HEADWALL (SEE DETAILS)
- TIED-CONCRETE BLOCK MAT (TCBM), STANDARD FLEXAMAT WITHOUT UNDERLAYMENT, OR EQUAL (SEE DETAILS)
- LIMITS OF CONSTRUCTION
- SHLD SHOULDER
- H.C. HANDICAP PARKING (SEE ADA PLAN SHEET DETAIL)
- MUTCD MANUAL OF UNIFORM TRAFFIC CONTROL DEVICES
- CONCRETE PAVEMENT (SEE GEN. NOTES & DETAILS SHEET 3)

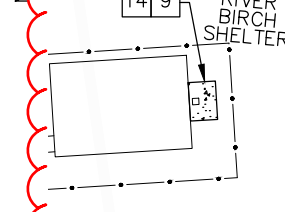
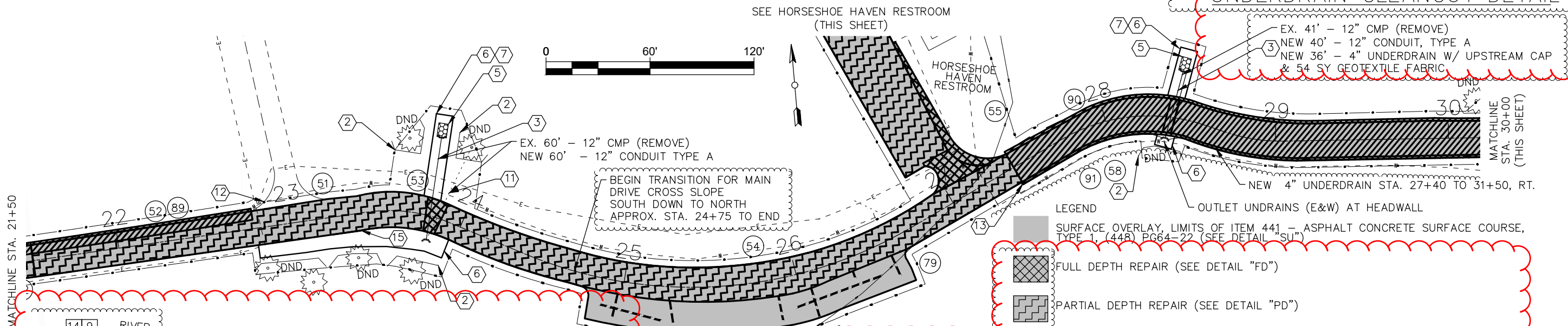
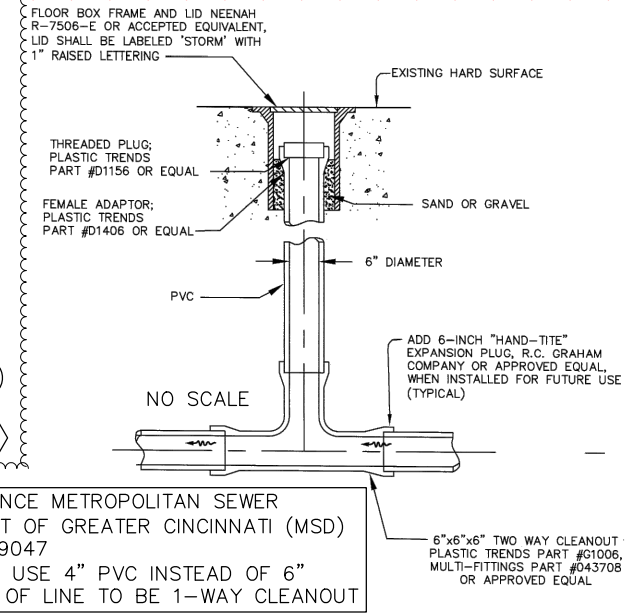
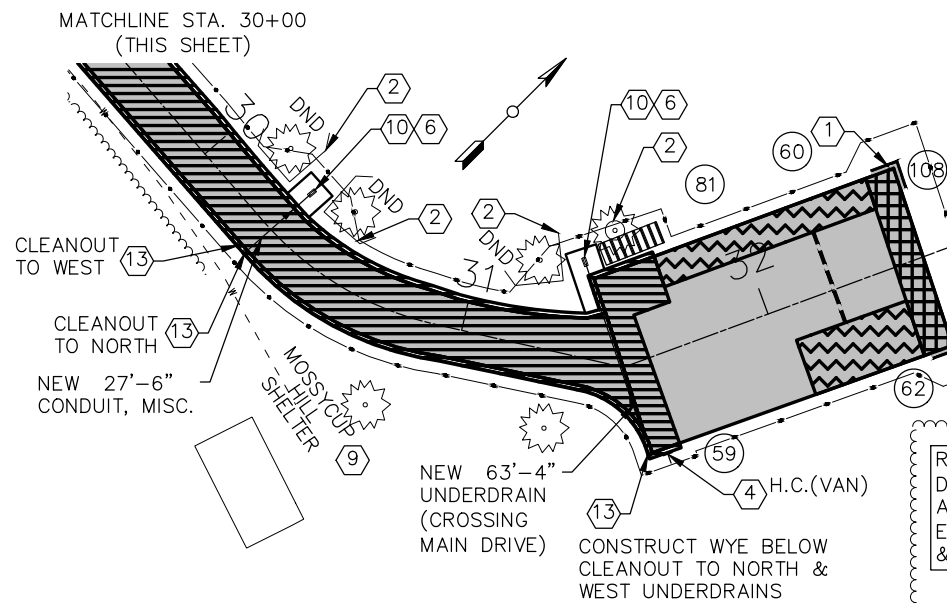
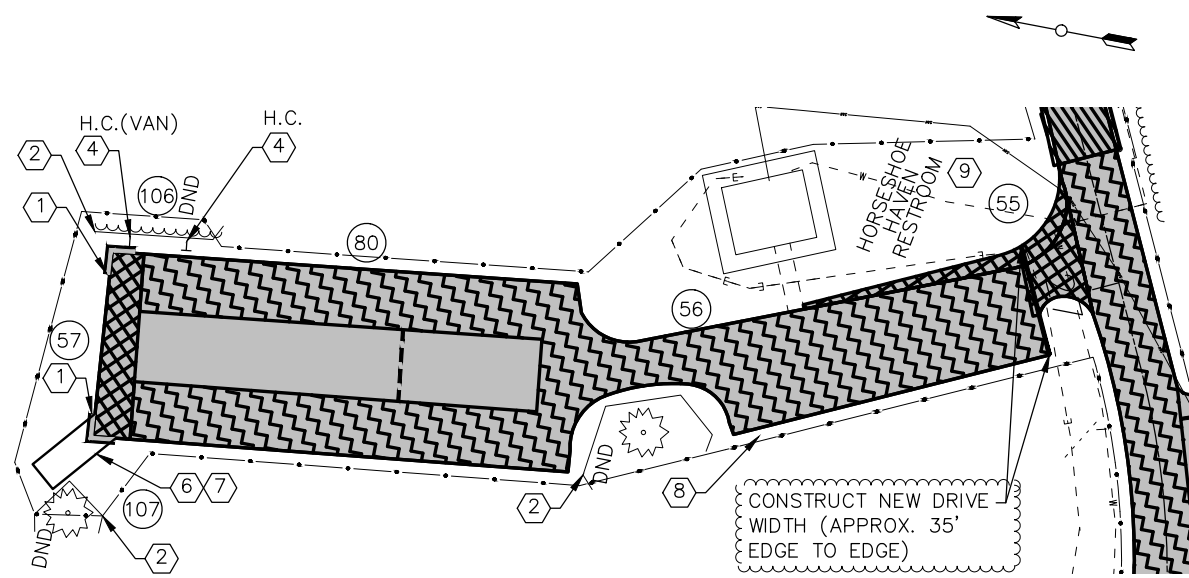

- CODED NOTES PART 1 PART 2 ALSO REF. (#) DENOTES PART 1 & REF. (#) PART 2 MEADOW IN PROGRESS**
1. CONSTRUCT TIED CONCRETE BLOCK MAT, STANDARD FLEXAMAT WITHOUT UNDERLAYMENT (OR EQUAL), 4'-WIDE BY LENGTH SHOWN
 2. CONSTRUCT TREE PROTECTION FENCE
 3. REMOVE EX. CONDUIT; CONSTRUCT NEW CONDUIT, (SEE PLAN LENGTHS & SIZE). CONSTRUCT INLET & OUTLET HEADWALLS.
 4. ITEM 630 - INSTALL NEW OWNER FURNISHED COMPOSITE SIGN POST. PROVIDE & INSTALL NEW SIGN (SEE ADA PLAN SHEET 16).
 5. CONSTRUCT OUTLET PROTECTION WITH TIED CONCRETE BLOCK MAT, STANDARD FLEXAMAT WITHOUT UNDERLAYMENT (OR EQUAL), 5.5'-WIDE BY 6'-BEYOND HEADWALL.
 6. GRADE/RESHAPE GRASS AREA PROVIDE 4H:1V SLOPE, (3H:1V MAX) (270 SY)
 7. CONSTRUCT EMBANKMENT TO FILL EX. ERODED AREA (15 CY)
 8. ITEM 630 - REMOVE EX. SIGN POST & RETURN SIGN TO OWNER.
 9. SEE GRADING/ADA PLAN SHEETS (VARIABLE OVERLAY DEPTH)
 10. CONSTRUCT HEADWALL (NO OUTLET PROTECTION)
 11. CUT EX. CONDUIT 2' BEYOND EDGE OF PAVEMENT; REMOVE CONDUIT UNDER PAVEMENT; FILL & PLUG REMAINING CONDUIT SECTION NEAR TREE.
 12. EX. CONCRETE BLOCKS AT THIS DRIVE TO REMAIN.
 13. CONSTRUCT CLEANOUT FROM UNDERDRAIN UP TO FINISHED GRADE
 14. CONSTRUCT NEW CONCRETE, SEE GRADING PLAN (98 SF)
 15. CONSTRUCT VARIABLE OVERLAY FOR POSITIVE DRAINAGE AWAY FROM PAVEMENT (EX. AREA OF PONDING WATER)

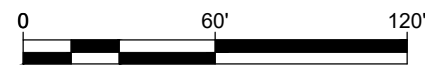

"M-" DENOTES MAIN DRIVE

DESC.	Ref #	Area (SF)
PD	M- 51	3841
GR	M- 52	643
FD	53	183
PD	54	6753
FD	55	706
PD	56	9168
FD	57	630
GR	M- 58	8079
GR	M- 59	672
PD	60	704
FD	61	544
PD	62	652
SU	M- 79	22939
SU	80	13322
SU	81	5778
SHLD	M- 89	183
SHLD	M- 90	649
SHLD	M- 91	665
TCBM	106	15
TCBM	107	15
TCBM	108	15
TCBM	109	15

- LEGEND**
- SURFACE OVERLAY, LIMITS OF ITEM 441 - ASPHALT CONCRETE SURFACE COURSE, TYPE 1, (448) PG64-22 (SEE DETAIL "SU")
 - FULL DEPTH REPAIR (SEE DETAIL "FD")
 - PARTIAL DEPTH REPAIR (SEE DETAIL "PD")
 - FULL DEPTH REPAIR W/ GEOGRID & AGGREGATE BASE (SEE DETAIL "GR")
 - LIMITS OF ITEM 423 - CRACK SEALING, TYPE 2, & ITEM 886 - FOG SEAL
 - STRESS-ABSORBING MEMBRANE INTERLAYER (SAMI), 24" WIDE, APPROXIMATE LOCATION (SEE GEN. NOTES)
 - DND TREE PROTECTION FENCE, DND (DO NOT DISTURB) (SEE GEN. NOTES & DETAILS)
 - TREE PROTECTION WRAP AROUND EXIST. TREE (SEE GEN. NOTES & DETAILS)
 - TREE PROTECTION MAT PLACED ON GRADE (SEE GEN. NOTES & DETAILS)
 - HEADWALL (SEE DETAILS)
 - TIED-CONCRETE BLOCK MAT (TCBM), STANDARD FLEXAMAT WITHOUT UNDERLAYMENT, OR EQUAL (SEE DETAILS)
 - LIMITS OF CONSTRUCTION
 - SHLD SHOULDER
 - H.C. HANDICAP PARKING (SEE ADA PLAN SHEET DETAIL)
 - MUTCD MANUAL OF UNIFORM TRAFFIC CONTROL DEVICES
 - CONCRETE PAVEMENT (SEE GEN. NOTES & DETAILS SHEET 3)

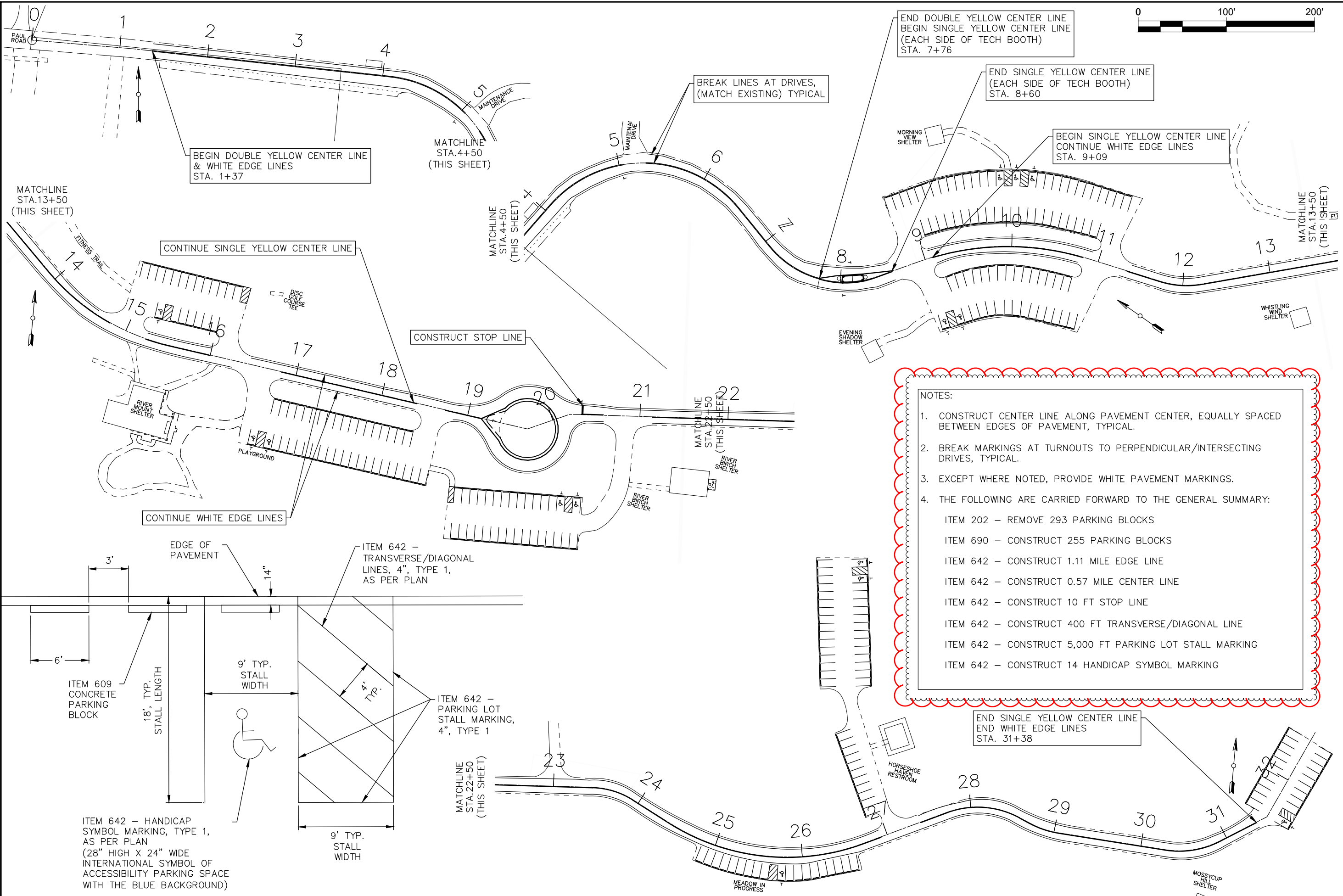

- NOTES:**
1. CONSTRUCT CENTER LINE ALONG PAVEMENT CENTER, EQUALLY SPACED BETWEEN EDGES OF PAVEMENT, TYPICAL.
 2. BREAK MARKINGS AT TURNOUTS TO PERPENDICULAR/INTERSECTING DRIVES, TYPICAL.
 3. EXCEPT WHERE NOTED, PROVIDE WHITE PAVEMENT MARKINGS.
 4. THE FOLLOWING ARE CARRIED FORWARD TO THE GENERAL SUMMARY:
 - ITEM 202 - REMOVE 293 PARKING BLOCKS
 - ITEM 690 - CONSTRUCT 255 PARKING BLOCKS
 - ITEM 642 - CONSTRUCT 1.11 MILE EDGE LINE
 - ITEM 642 - CONSTRUCT 0.57 MILE CENTER LINE
 - ITEM 642 - CONSTRUCT 10 FT STOP LINE
 - ITEM 642 - CONSTRUCT 400 FT TRANSVERSE/DIAGONAL LINE
 - ITEM 642 - CONSTRUCT 5,000 FT PARKING LOT STALL MARKING
 - ITEM 642 - CONSTRUCT 14 HANDICAP SYMBOL MARKING

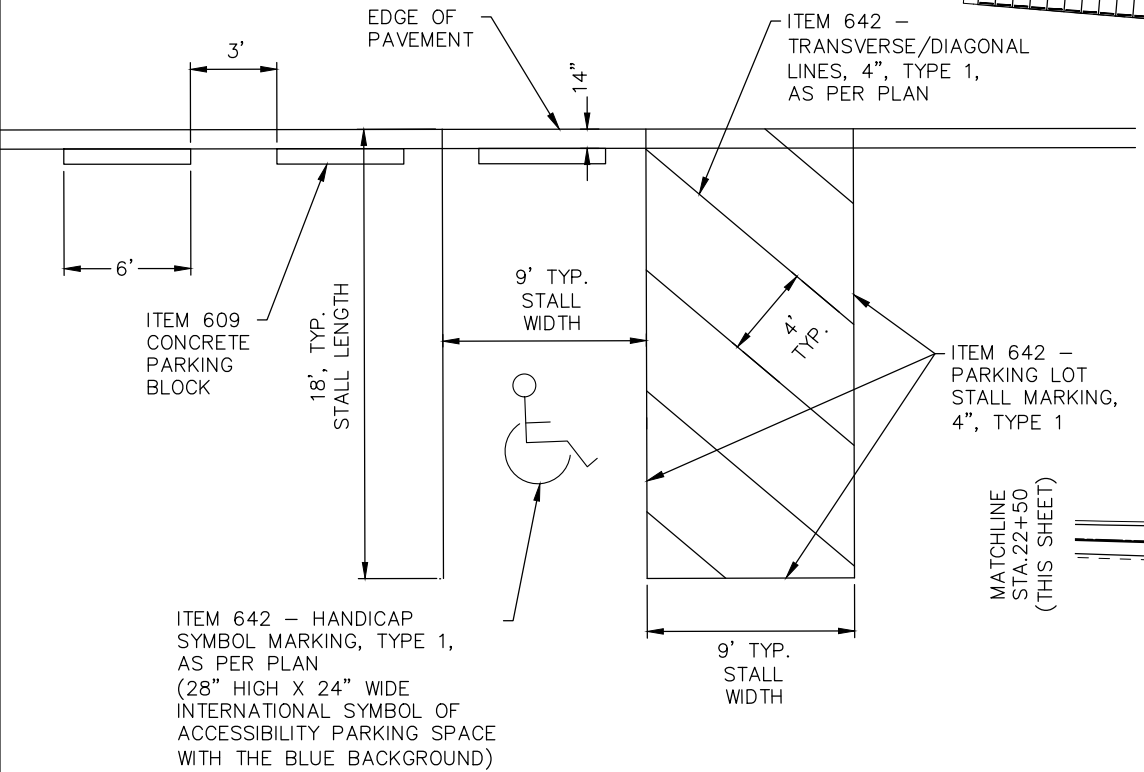

PARKING LOT STALL DETAIL

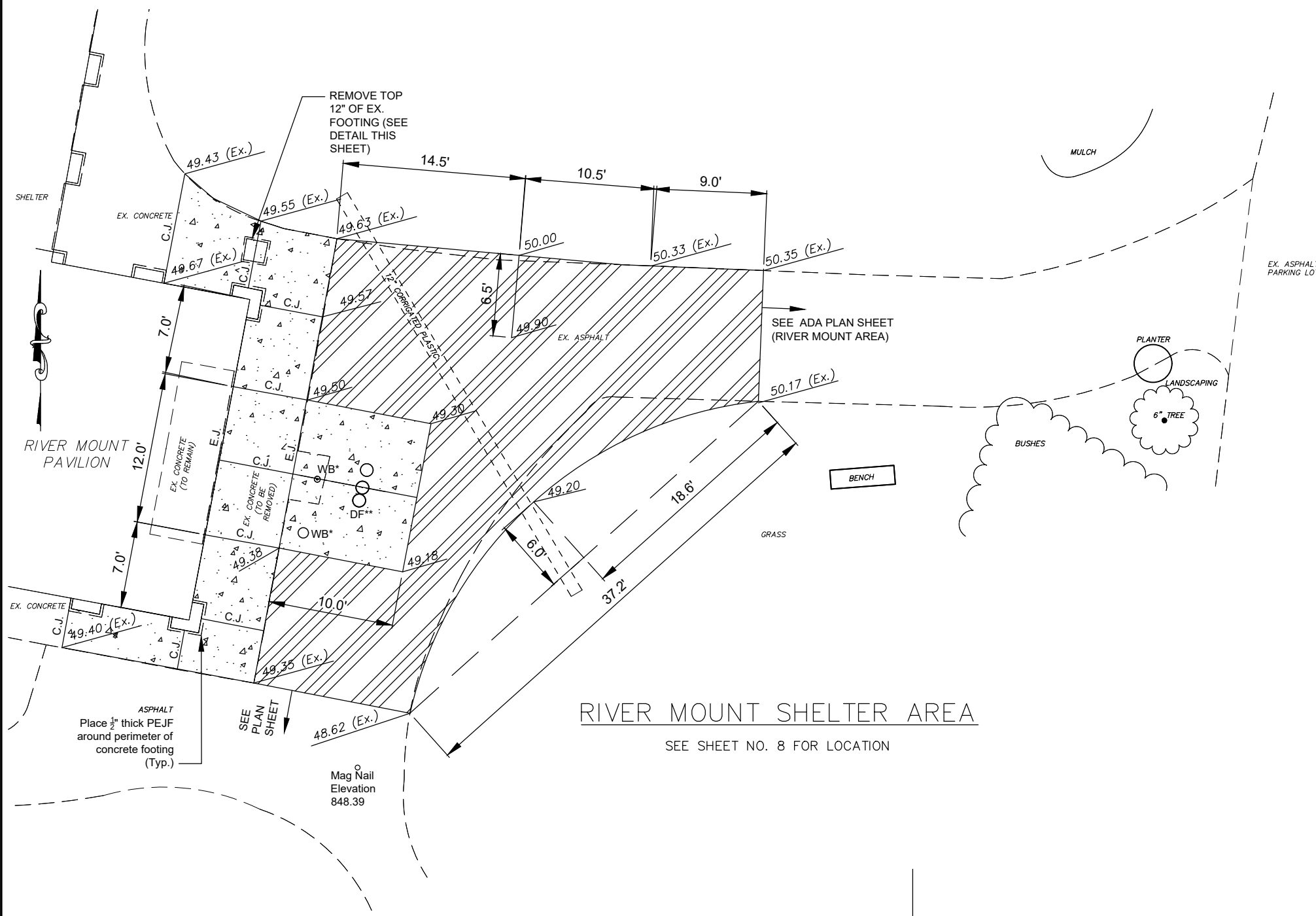

- NOTES:
1. PROVIDE 4.9% MAX. LONGITUDINAL SLOPE ALONG ADA ACCESSIBLE ROUTE (WALKS)
 2. PROVIDE 1.9% MAX. CROSS SLOPE ALONG ADA ACCESSIBLE ROUTE (WALKS)
 3. MATCH NEW FINISHED GRADE ELEVATION AT ADJACENT PAVEMENT.
 4. OWNER TO REMOVE RIVER MOUNT SHELTER FENCE PRIOR TO CONSTRUCTION; COORDINATE WITH OWNER.
 5. THE FOLLOWING ARE CARRIED TO THE GENERAL SUMMARY:
 ITEM 202 – INCLUDE FOOTING REMOVAL IN REMOVAL MISC.
 ITEM 638 – (2 EA) WATER BOX ADJUSTED TO GRADE

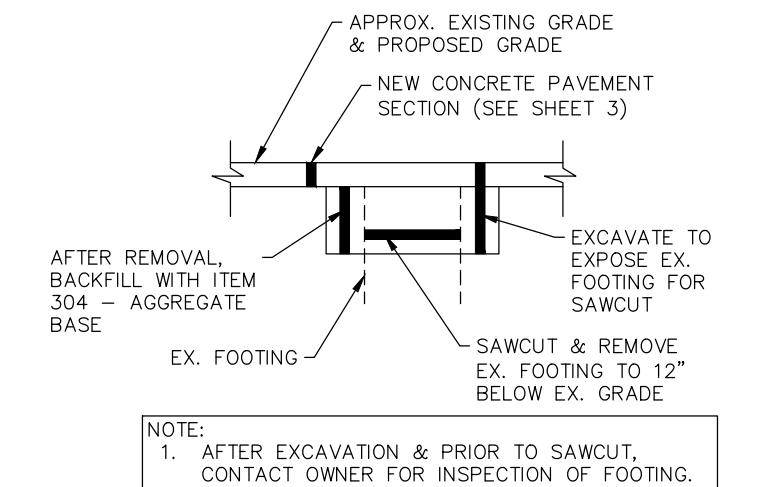

- NOTE:
1. AFTER EXCAVATION & PRIOR TO SAWCUT, CONTACT OWNER FOR INSPECTION OF FOOTING.

FOOTING REMOVAL DETAIL
NO SCALE

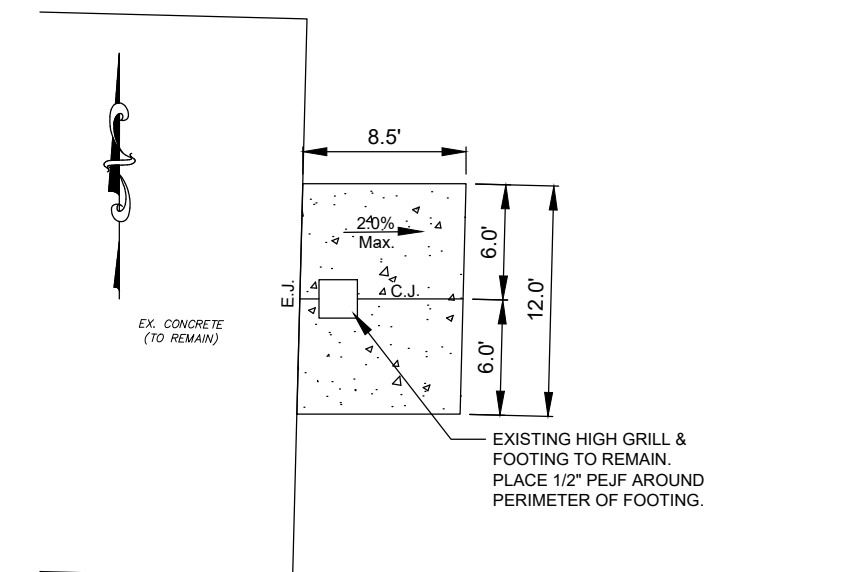

RIVER BIRCH SHELTER AREA
SEE SHEET NO. 9 FOR LOCATION

LEGEND

E.J. - DENOTES EXPANSION JOINT WITH 1/2" THICK PREFORMED EXPANSION JOINT FILLER.		- DENOTES NEW CONCRETE.
C.J. - DENOTES CONTROL JOINT		- DENOTES REVISED ASPHALT PERIMETER.
WB* - DENOTES EXISTING WATER BOX TO BE ADJUSTED TO GRADE	<u>50.00</u>	- DENOTES PROPOSED
DF** - DENOTES EXISTING DRINKING FOUNTAINS. PLACE 1/2" THICK PREFORMED EXPANSION JOINT FILLER AROUND PERIMETER OF CONCRETE FOUNDATION.	<u>50.33 (Ex.)</u>	- DENOTES EXISTING



CONTRACT PART	DESCRIPTION	UNIT	ITEM EXT	ITEM
1	PD 8 21	1433		
1	FD 8 22	95		
1	PD 8 23	4354		
1	FD 8 24	151		
1	PD 8 25	3304		
1	FD 8 26	271		
1	PD 8 27	6836		
1	FD 8 28	316		
1	FD 8 29	219		
1	FD 8 30	48		
1	FD 8 31	498		
1	PD 8 32	540		
1	GR 8 33	596	66.2	
1	FD 8 34	105		
1	FD 8 35	50		
1	FD 8 36	111		
1	FD 8 41	2144		
1	PD 8 42	422		
1	PD 8 43	154		
1	PD 8 44	230		
1	PD 8 45	230		
1	FD 8 46	815		
1	SU 8 75	18614		
1	SU 8 76	8550		
1	SU 8 77	13934		
1	SU 8 78	4264		
1	SEAL 8 87	7695		
1	SHLD 8 88	178		
1	TCBM 8 104	15		
1	TCBM 8 105	23		
2	FD 8 37b	255		
2	FD 8 38b	256		
2	FD 8 39b	446		
2	FD 8 40b	1127		
2	FD 8 47b	230		
2	SU 8 48b	2186		
2	CONC 8 92b	150		
2	CONC 8 93b	416		
2	CONC 8 94b	90		
2	CONC 8 95b	108		
1	NOTE 8		5.0	287.0
2	NOTE 8			51.0
SUM			71.2	338.0

SUBSUMMARY

DESIGN AGENCY



DESIGNER RM

REVIEWER TZ

PROJECT ID 117816

SHEET TOTAL P.14 19

NOTE: QUANTITIES ARE CARRIED FORWARD TO THE GENERAL SUMMARY.

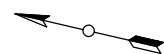
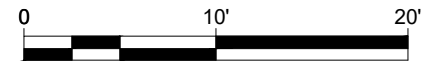

LINE REPRESENTS EXIST. PAVEMENT APPROXIMATE CENTERLINE

MATCH EXIST. CONCRETE ELEVATION

- ADA GRADING NOTES:
1. PROVIDE 1.9% MAX. SLOPE IN ALL DIRECTIONS IN ADA PARKING STALLS
 2. PROVIDE 4.9% MAX. LONGITUDINAL SLOPE ALONG ADA ACCESSIBLE ROUTE (WALKS)
 3. PROVIDE 1.9% MAX. CROSS SLOPE ALONG ADA ACCESSIBLE ROUTE (WALKS)
 4. PROVIDE VARIABLE DEPTH SURFACE OVERLAY TO ACHIEVE PROPER SLOPES, 1.5" MIN. DEPTH
 5. MATCH NEW FINISHED GRADE ELEVATION AT ADJACENT PAVEMENT.
 6. (-) NEGATIVE SIGN DENOTES SLOPING DOWNWARD IN DIRECTION OF ARROW.

EMBSHOFF WOODS RESURFACING

MATCH EXIST. CONCRETE ELEVATION

LINE REPRESENTS EXIST. PAVEMENT APPROXIMATE CENTERLINE

MORNING VIEW AREA

EVENING SHADOW AREA

ADA PLAN 1

DESIGN AGENCY	Great Parks
DESIGNER	RM
REVIEWER	TZ 04-13-23
PROJECT ID	117816
SHEET TOTAL	P.15 19

- Roadside vehicular signs shall be installed per the current version of the Ohio Manual of Uniform Traffic Control Devices (OMUTCD). Consult the Design & Land Acquisition department (D&LA) for guidance.
- For purposes of this document roadside vehicular signs include regulatory or warning signs as described in the OMUTCD that are intended to direct people traveling in a motorized vehicle on roadways within Great Parks of Hamilton County property. These include Speed Limit, Stop, Yield and Pedestrian Crossing signs. Installation of other types of signs will be described in the future.
- Sign posts shall be 4x4 composite that can be acquired by contacting the Design & Land Acquisition department (D&LA).
- Hardware for installation of posts and sign plaques shall be as described or directed by D&LA.
- All sign plaques shall be as supplied by Terrabit wayfinding systems or constructed of .080 gauge aluminum. All sign plaques shall be retroreflective meeting OMUTCD Section 2A.07 Retroreflectivity and Illumination.
- Signs and posts shall be installed per the attached Terrabit wayfinding systems Assembly Instructions for Single Post-Single Sided Assemblies. D&LA may direct sign plaques to be installed without HDPE Receiver Panels or associated hardware.
- The minimum height, measured vertically from the bottom of the sign plaque to the elevation of the near edge of the road pavement shall be 5 feet. Where parking or pedestrian movements are likely to occur, the minimum height shall be 7 feet. Refer to the example below and to OMUTCD Section 2A.18 Mounting Height.
- The distance from the edge of pavement to the near edge of the sign plaque shall be a minimum of 2 feet, 3 feet where possible. Refer to the example below and to OMUTCD Section 2A.19 Lateral Offset. Consult D&LA for guidance on sign placement.

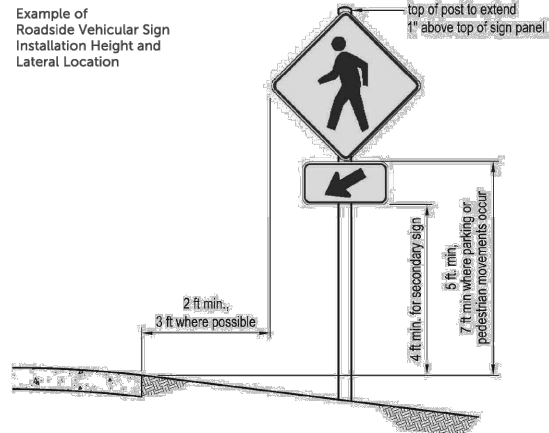

Handicap Parking

- Adopted January 2023
- Single post may include up to 3 signs:
 - 12"x18" .080 aluminum sign, white background with green text and blue symbol (required)
 - 12"x6" \$250 fine sign (required)
 - 12"x6" Van Accessible sign (as needed)
- Installation: Bottom of the main 12x18" sign needs to be 60" minimum from the bottom edge of the sign to the ground. The \$250 fine sign or van accessible sign can be below that 60" mark
- Can be purchased off the shelf from Kleem Inc.

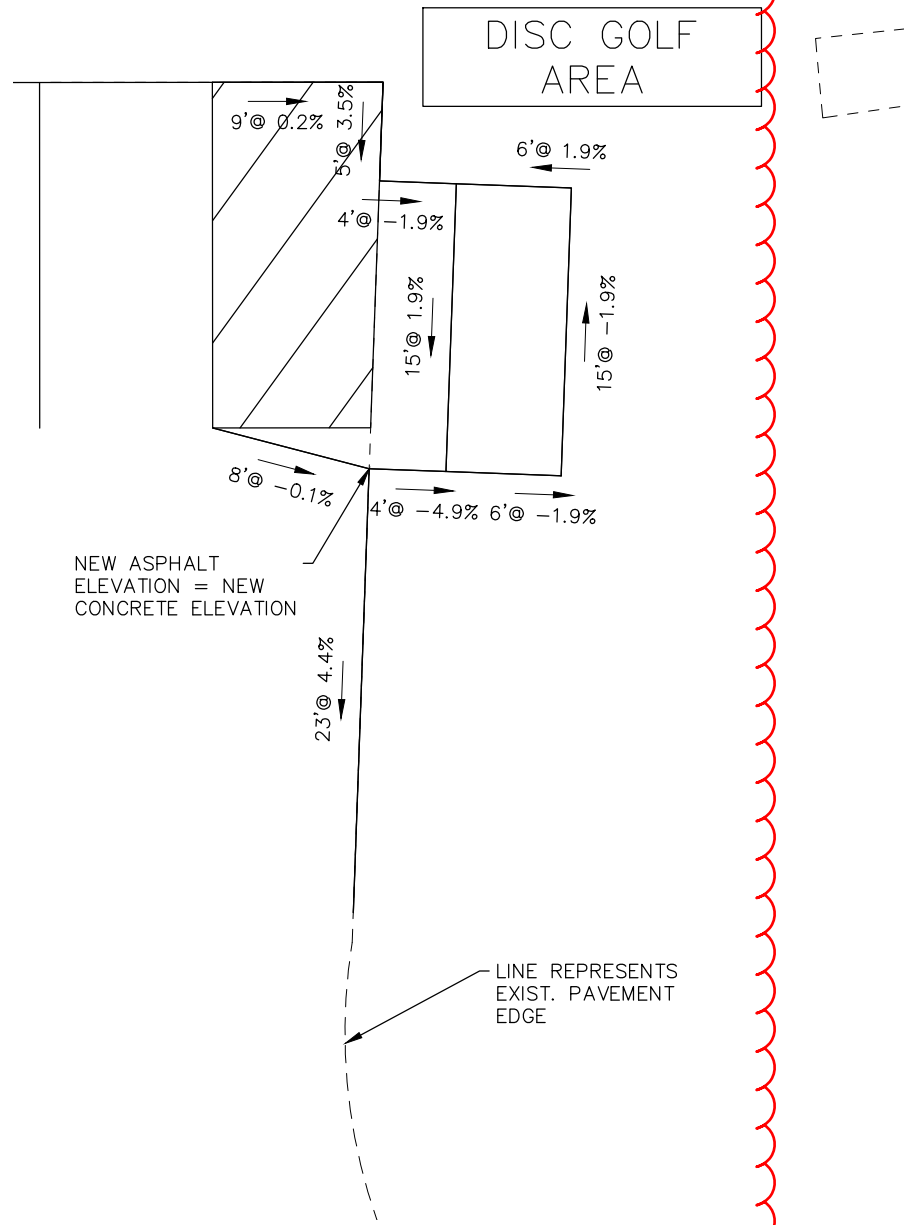

EMBSHOFF WOODS RESURFACING

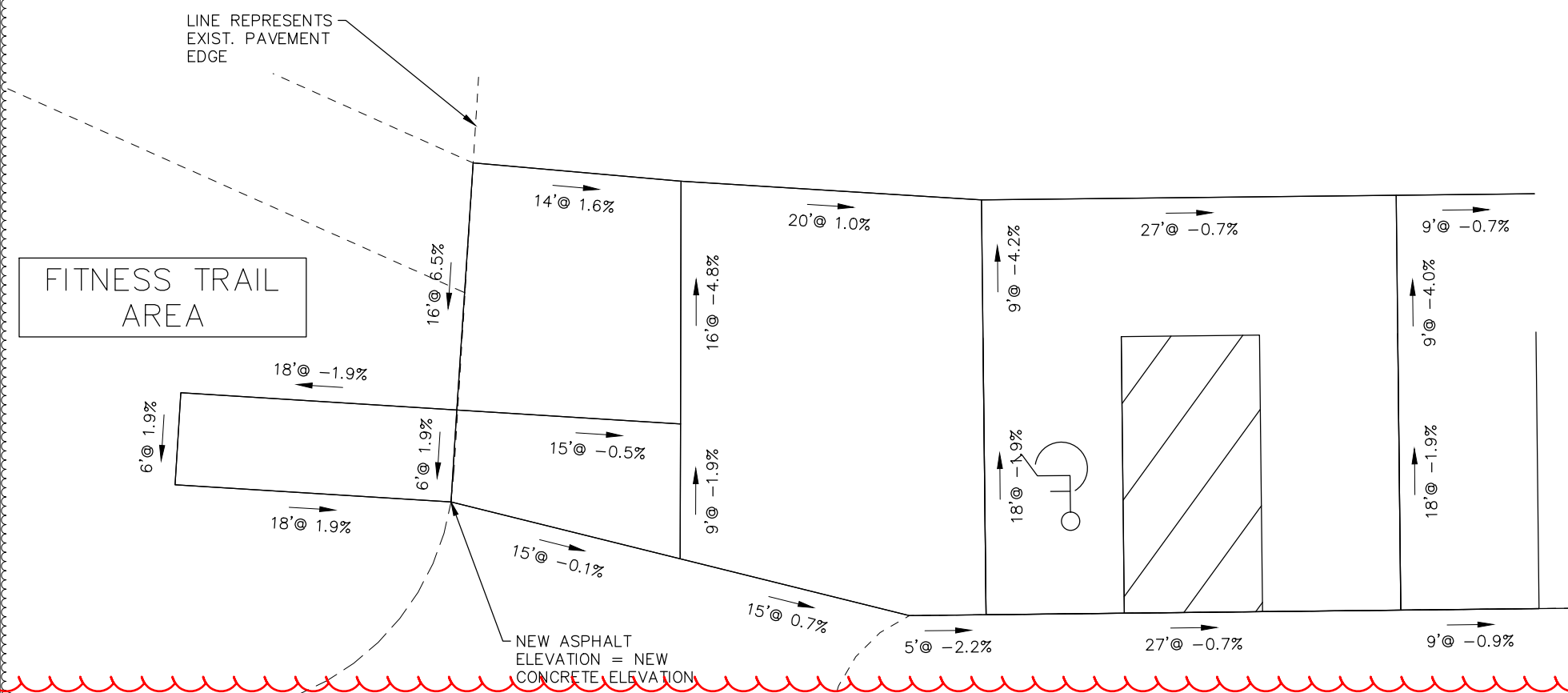

- ADA GRADING NOTES:
- PROVIDE 1.9% MAX. SLOPE IN ALL DIRECTIONS IN ADA PARKING STALLS
 - PROVIDE 4.9% MAX. LONGITUDINAL SLOPE ALONG ADA ACCESSIBLE ROUTE (WALKS)
 - PROVIDE 1.9% MAX. CROSS SLOPE ALONG ADA ACCESSIBLE ROUTE (WALKS)
 - PROVIDE VARIABLE DEPTH SURFACE OVERLAY TO ACHIEVE PROPER SLOPES, 1.5" MIN. DEPTH
 - MATCH NEW FINISHED GRADE ELEVATION AT ADJACENT PAVEMENT.
 - (-) NEGATIVE SIGN DENOTES SLOPING DOWNWARD IN DIRECTION OF ARROW.



ADA PLAN 2

DESIGN AGENCY	Great Parks
DESIGNER	RM
REVIEWER	TZ 04-13-23
PROJECT ID	117816
SHEET	TOTAL
P.16	19

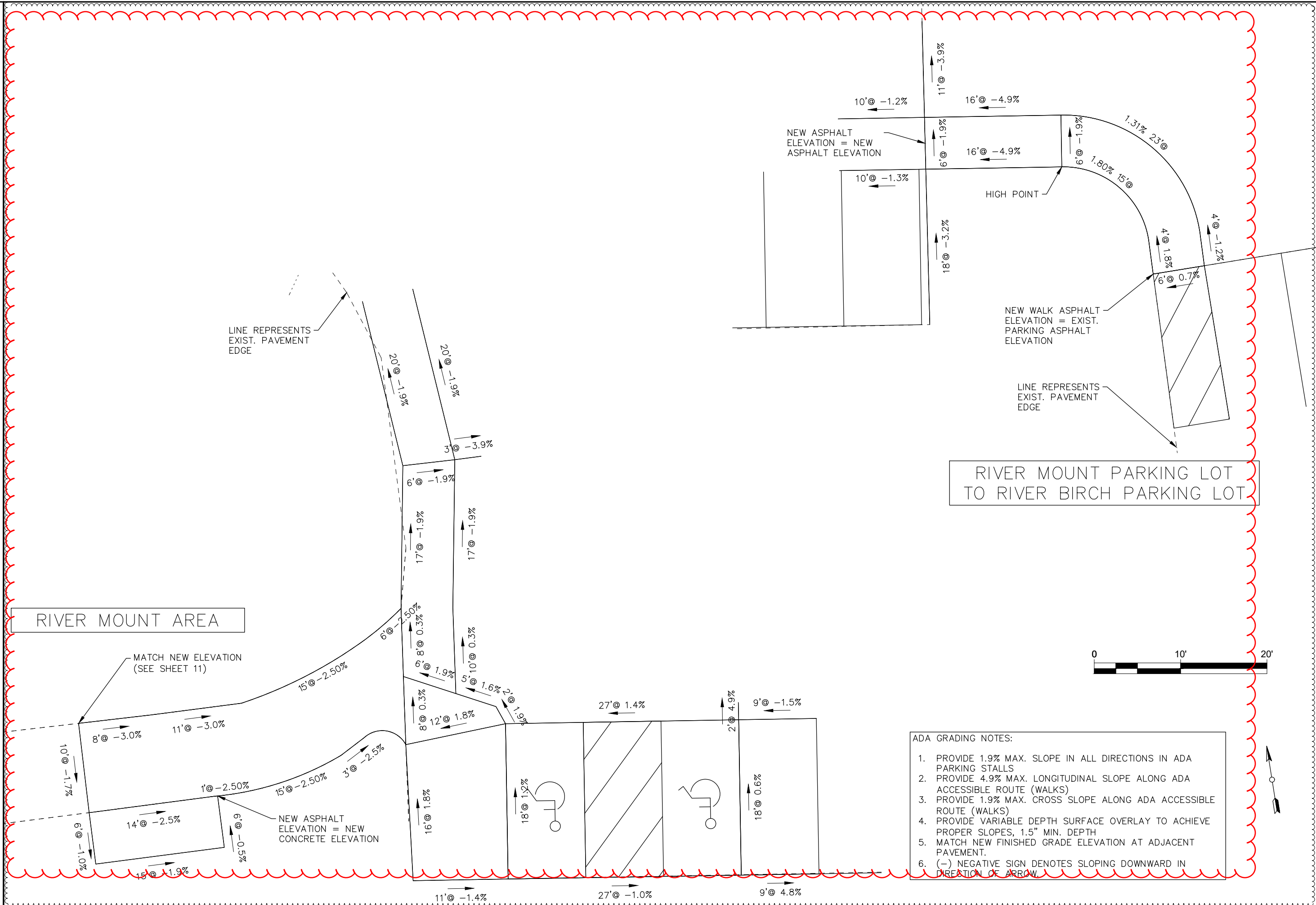

RIVER MOUNT PARKING LOT TO RIVER BIRCH PARKING LOT

RIVER MOUNT AREA

- ADA GRADING NOTES:
1. PROVIDE 1.9% MAX. SLOPE IN ALL DIRECTIONS IN ADA PARKING STALLS
 2. PROVIDE 4.9% MAX. LONGITUDINAL SLOPE ALONG ADA ACCESSIBLE ROUTE (WALKS)
 3. PROVIDE 1.9% MAX. CROSS SLOPE ALONG ADA ACCESSIBLE ROUTE (WALKS)
 4. PROVIDE VARIABLE DEPTH SURFACE OVERLAY TO ACHIEVE PROPER SLOPES, 1.5" MIN. DEPTH
 5. MATCH NEW FINISHED GRADE ELEVATION AT ADJACENT PAVEMENT.
 6. (-) NEGATIVE SIGN DENOTES SLOPING DOWNWARD IN DIRECTION OF ARROW.

DESIGN AGENCY	Great Parks
DESIGNER	RM
REVIEWER	TZ 04-13-23
PROJECT ID	117816
SHEET	TOTAL
P.17	19

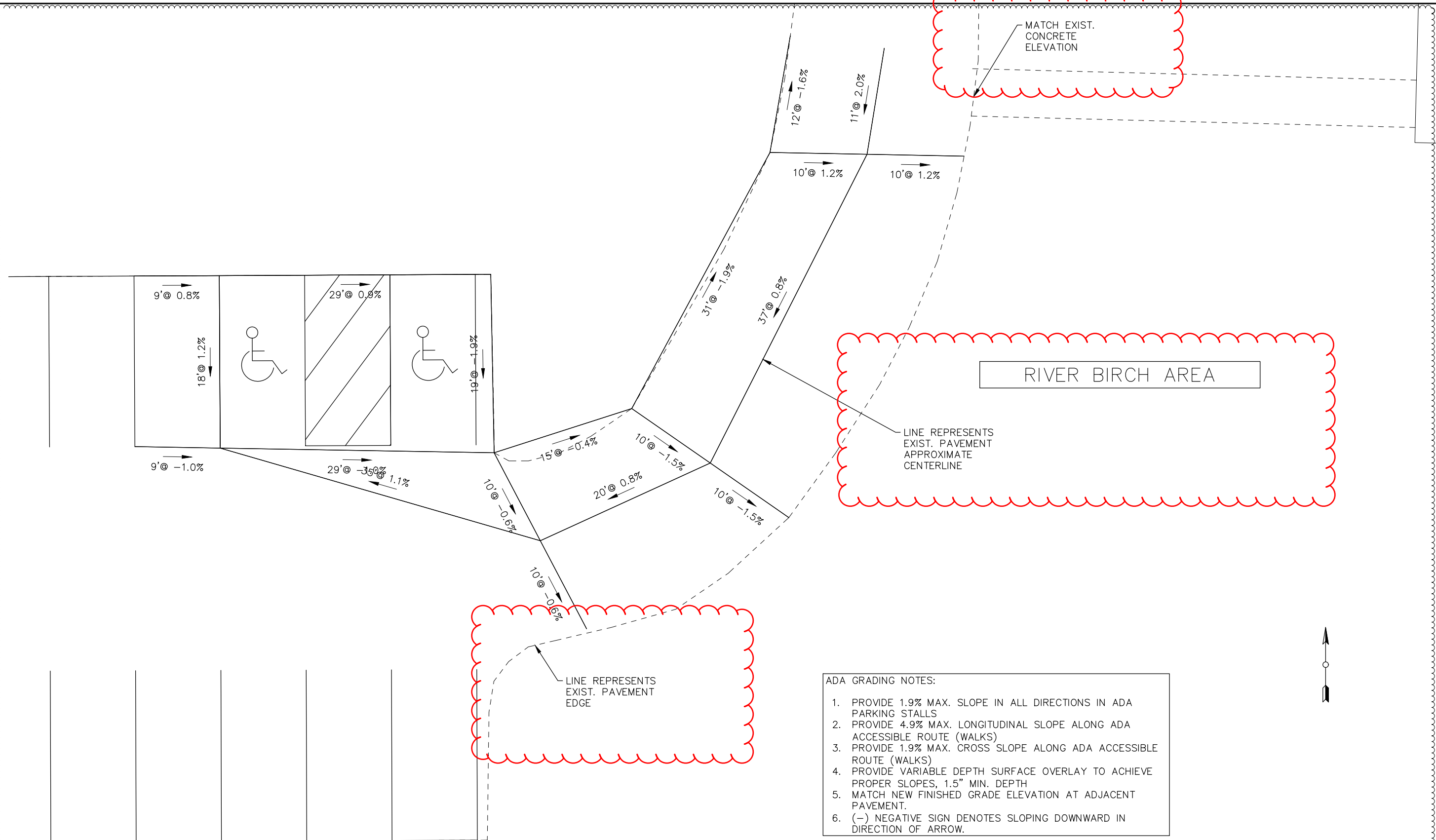

LINE REPRESENTS EXIST. PAVEMENT EDGE

- ADA GRADING NOTES:
1. PROVIDE 1.9% MAX. SLOPE IN ALL DIRECTIONS IN ADA PARKING STALLS
 2. PROVIDE 4.9% MAX. LONGITUDINAL SLOPE ALONG ADA ACCESSIBLE ROUTE (WALKS)
 3. PROVIDE 1.9% MAX. CROSS SLOPE ALONG ADA ACCESSIBLE ROUTE (WALKS)
 4. PROVIDE VARIABLE DEPTH SURFACE OVERLAY TO ACHIEVE PROPER SLOPES, 1.5" MIN. DEPTH
 5. MATCH NEW FINISHED GRADE ELEVATION AT ADJACENT PAVEMENT.
 6. (-) NEGATIVE SIGN DENOTES SLOPING DOWNWARD IN DIRECTION OF ARROW.

RIVER BIRCH AREA

LINE REPRESENTS EXIST. PAVEMENT APPROXIMATE CENTERLINE

MATCH EXIST. CONCRETE ELEVATION

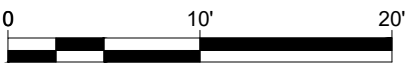
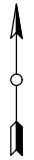

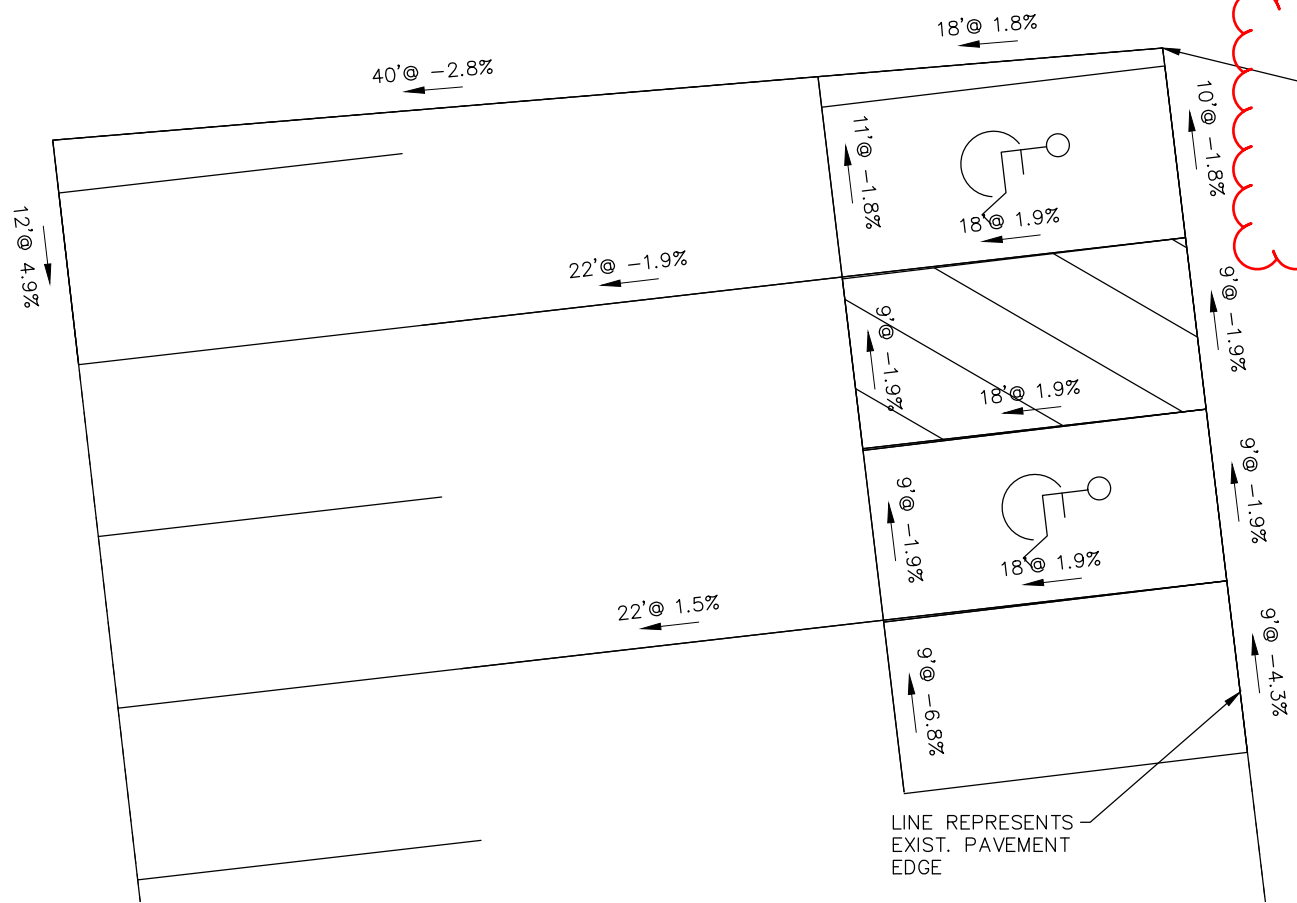

HORSESHOE HAVEN AREA

THE LAST TWO STALL AREAS REQUIRE CONSTRUCTING NEW ELEVATION APPROX. 1' TO 2' HIGHER THAN EXIST. ELEVATION. GRADE/RESHAPE GRASS BEYOND PAVEMENT 4H:1V SLOPE (3H:1V MAX)

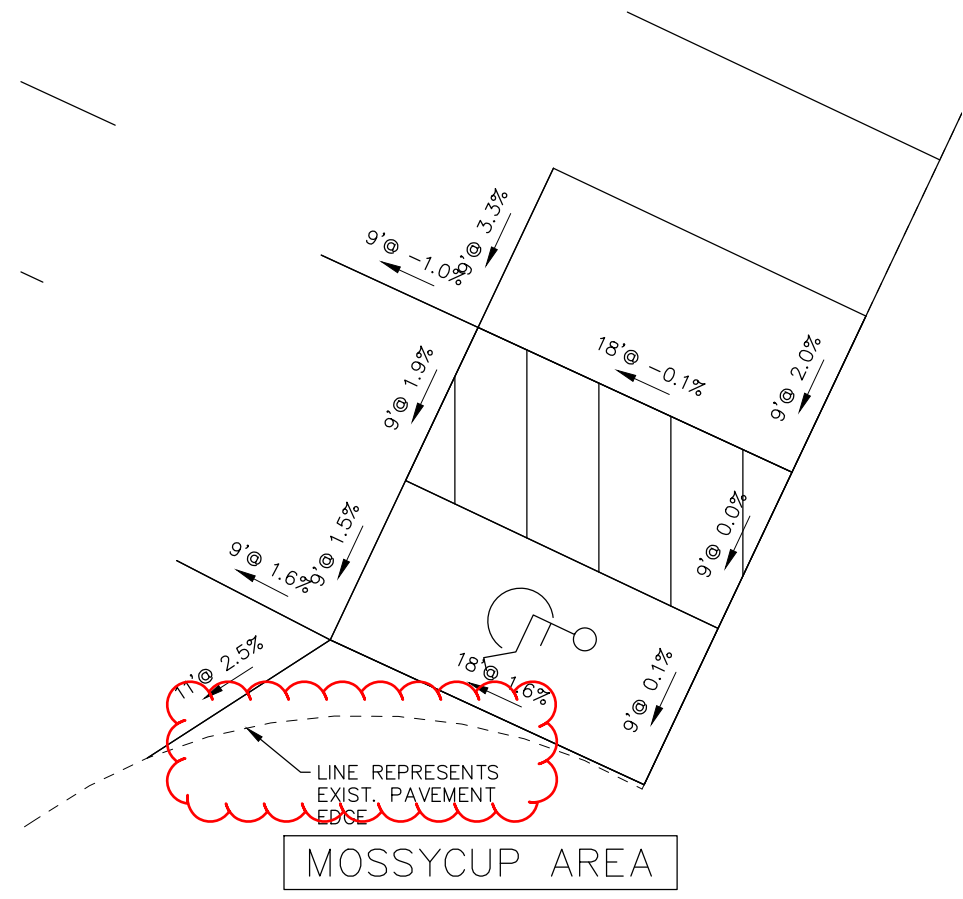

MOSSYCUP AREA

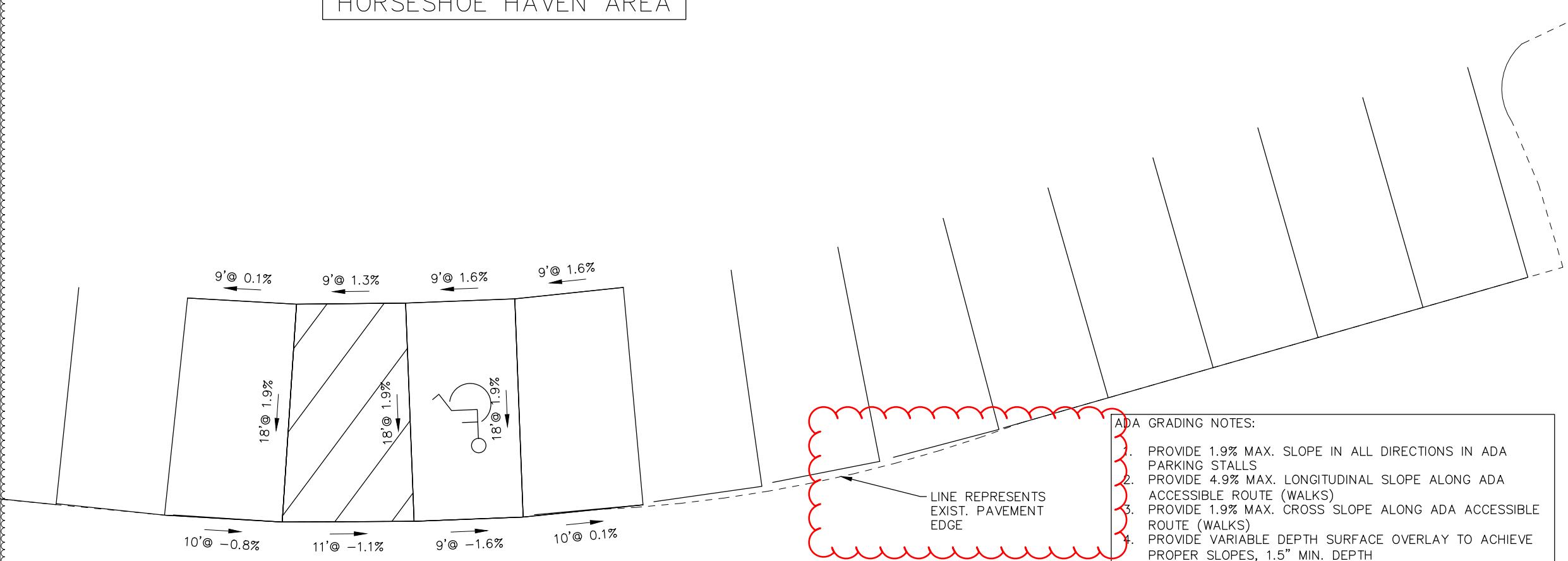

MEADOW AREA

- ADA GRADING NOTES:
1. PROVIDE 1.9% MAX. SLOPE IN ALL DIRECTIONS IN ADA PARKING STALLS
 2. PROVIDE 4.9% MAX. LONGITUDINAL SLOPE ALONG ADA ACCESSIBLE ROUTE (WALKS)
 3. PROVIDE 1.9% MAX. CROSS SLOPE ALONG ADA ACCESSIBLE ROUTE (WALKS)
 4. PROVIDE VARIABLE DEPTH SURFACE OVERLAY TO ACHIEVE PROPER SLOPES, 1.5" MIN. DEPTH
 5. MATCH NEW FINISHED GRADE ELEVATION AT ADJACENT PAVEMENT.
 6. (-) NEGATIVE SIGN DENOTES SLOPING DOWNWARD IN DIRECTION OF ARROW.

