

PAVEMENT NOTES

* REPAIR LOCATIONS & QUANTITIES ARE SHOWN FOR BID. PRIOR TO CONSTRUCTION, FIELD VERIFY EXACT LOCATIONS. INSPECT EXISTING PAVEMENT CONDITIONS WITH ENGINEER & GREAT PARKS AUTHORIZED REPRESENTATIVE TO DELINEATE EXACT LOCATIONS OF SAMI PRIOR TO ANY PAVEMENT PLACEMENT FOR PARTIAL DEPTH REPAIR INTERMEDIATE COURSE & SURFACE COURSE OVERLAY WORK. SCRAPE/REMOVE SOIL TO EXPOSE TOP OF PAVEMENT EDGE PRIOR TO BEGINNING PAVEMENT WORK. MINIMIZE THE NUMBER OF COLD JOINTS ALONG THE MAIN DRIVE PER WORK SHIFT TO ONE LONGITUDINAL JOINT, & TRANSVERSE JOINTS TO ONE AT THE START, ONE AT THE END, & ACROSS THE DRIVE ACCESS TO EACH PARKING LOT. AT PAVEMENT JOINTS, PROVIDE FULL PAVEMENT COURSE THICKNESS BY SAW CUTTING OLD OR NEW PAVEMENT IF NECESSARY FOR BUTT JOINT. CRACK SEAL JOINTS AFTER CONSTRUCTION. PROVIDE POSITIVE DRAINAGE AWAY FROM ALL PAVED SURFACES. COORDINATE WITH ROADWAY EROSION CONTROL & DRAINAGE WORK.

201 – CLEARING AND GRUBBING, AS PER PLAN

PERFORM CLEARING AND GRUBBING ONLY AFTER TREE PROTECTION INSTALLATION & APPROVAL.

ITEM SPECIAL – 202 – PARKING BLOCK REMOVED, AS PER PLAN

THIS WORK SHALL CONSIST OF REMOVING & DISPOSING OF EXISTING CONCRETE PARKING BLOCKS & PINS AS SHOWN ON THE PLANS. THE EXISTING CURB BLOCKS SHALL BECOME PROPERTY OF THE CONTRACTOR & SHALL BE SATISFACTORILY REMOVED FROM THE PROJECT SITE. NO STOCKPILING OF BLOCKS WILL BE PERMITTED AT THE PROJECT SITE. AFTER THE BLOCKS ARE REMOVED, THE PINS SHALL BE IMMEDIATELY REMOVED, CUT OR DRIVEN INTO THE GROUND TO PREVENT A HAZARDOUS CONDITION. PAYMENT SHALL INCLUDE, BUT NOT BE LIMITED TO, ALL SERVICES, MATERIALS, LABOR, EQUIPMENT, TOOLS & INCIDENTALS NECESSARY TO COMPLETE THE WORK ABOVE & SHALL BE INCLUDED IN THE UNIT PRICE BID FOR ITEM 202 – PARKING BLOCK REMOVED.

ITEM SPECIAL – 202 – FILL AND PLUG EXISTING CONDUIT

THIS ITEM CONSISTS OF THE CONSTRUCTION OF BULKHEADS IN AN EXISTING 12" DIAMETER CONDUIT & FILLING THE AREA SEALED OFF WITH ITEM 613, SAND, OR OTHER MATERIAL APPROVED BY THE ENGINEER & GREAT PARKS.

LOCATE THE BULKHEADS AT THE LIMITS OF THE AREA TO BE FILLED, AS INDICATED ON THE PLANS. THE BULKHEADS CONSIST OF BRICK OR CONCRETE MASONRY WITH A MINIMUM THICKNESS OF 12 INCHES. TYPICALLY, CONSTRUCT ONE BULKHEAD AT THE PIPE OUTLET, & ONE BULKHEAD 2- FEET OUTSIDE THE EXISTING PAVEMENT EDGE.

PUMP THE FILL MATERIAL INTO PLACE OR BY OTHER MEANS APPROVED BY THE ENGINEER, SO THAT AFTER SETTLEMENT, AT LEAST 90 PERCENT OF THE CROSS-SECTIONAL AREA OF THE CONDUIT, FOR ITS ENTIRE LENGTH (TO REMAIN) IS FILLED. THE LENGTH OF FILLED & PLUGGED CONDUIT TO BE PAID FOR IS THE ACTUAL NUMBER OF FEET (MEASURED ALONG THE CENTERLINE OF EACH CONDUIT FROM OUTER FACE TO OUTER FACE OF BULKHEADS) FILLED & PLUGGED AS DESCRIBED IN THE ABOVE TEXT.

ITEM 202 – REMOVAL MISC., AS PER PLAN

SEE PLAN CALLOUTS SHEETS 7-9. ITEMS REMOVED ARE PROPERTY OF CONTRACTOR.

* ITEM 204 – SUBGRADE COMPACTION, AS PER PLAN

SEE DETAILS SHOWN ON PLAN SHEET 4. ENGINEER & GREAT PARKS REPRESENTATIVE TO WITNESS SUBGRADE COMPACTION WORK.

ITEM 204 – GEOTEXTILE FABRIC, AS PER PLAN

FURNISH & INSTALL TYPE A FABRIC AT PAVEMENT LOW POINT CONDUITS APPROX. STA. 4+75 & 28+50. WRAP ENTIRE TRENCH BEDDING & BACKFILL WITH FABRIC, & OVERLAP 18-INCHES AT TOP.

ITEM 204 – GEOGRID, AS PER PLAN

SEE GEOGRID FULL DEPTH PAVEMENT DETAIL SHOWN ON PLAN SHEET 4. GEOGRID SHALL BE TENSAR BX-2, OR EQUAL, ON ODOT SS-861 QUALIFIED PRODUCTS LIST. TYPICAL ROLL WIDTH IS 12.5- FEET. INSTALL PER MANUFACTURER'S INSTRUCTIONS.

ITEM 251 – PARTIAL DEPTH PAVEMENT REPAIR

SEE DETAIL SHOWN ON PLAN SHEET 4. UNIT BID PRICE SHALL INCLUDE REMOVING EXISTING DETERIORATED ASPHALT TO A MINIMUM DEPTH OF 1 1/2 INCHES OR AS DIRECTED BY THE ENGINEER. PROVIDE DENSITY TESTING FOR ALL 448 PLACED.

ITEM 253 – FULL DEPTH PAVEMENT REPAIR

SEE DETAILS SHOWN ON PLAN SHEET 4. VEHICULAR AREA EXISTING ASPHALT & GRAVEL BASE SHALL BE REMOVED TO AN AVERAGE DEPTH OF 8.5" OR AS DIRECTED BY THE ENGINEER & REPLACED WITH ITEM 301 – ASPHALT CONCRETE BASE. THE 301 SHALL BE COMPACTED AS PER 401.16 & IN APPROXIMATELY EQUAL LAYERS. THE LOCATION & SIZE OF THE REPAIRS SHALL BE DETERMINED BY THE ENGINEER.

FOR WALKS, REMOVE EXISTING PAVEMENT & EXCAVATE TO FOR NEW SECTION.

ITEM 304 – AGGREGATE BASE, AS PER PLAN

SEE FULL DEPTH PAVEMENT REPAIR DETAIL & GEOGRID FULL DEPTH PAVEMENT DETAIL SHOWN ON PLAN SHEET 4.

ITEM 441 – ASPHALT CONCRETE SURFACE COURSE, TYPE 1, (448) PG64-22

SEE DETAILS SHOWN ON PLAN SHEET 4. UNIT BID PRICE FOR THIS ITEM SHALL INCLUDE THE COST TO FURNISH & INSTALL ITEM 407 NON-TRACKING TACK COAT & 1 1/2" DEEP BY 2" WIDE BUTT JOINTS. PROVIDE DENSITY TESTING FOR ALL 448 PLACED. ANY ADDITIONAL SURFACE COURSE THICKNESS NECESSARY TO CONSTRUCT PROPER SLOPES IN AREAS SUCH AS ADA PLAN SHEETS, TECH BOOTH AREA, TCBM FLASHING ANCHOR, & TO PROVIDE POSITIVE DRAINAGE, SHALL BE PAID AT UNIT COST OF THIS ITEM.

886 – FOG SEAL

TEST STRIP TO BE LOCATED IN AN AREA TO NOT RECEIVE FOG SEAL, SUCH AS AN AREA TO BE MILLED, SO THAT THE TEST STRIP IS REMOVED AS PART OF OTHER WORK IN THIS PLAN SET.

ITEM 607 – FENCE, MISC., AS PER PLAN

WORK INCLUDES ALL TREE PROTECTION ACTIVITY INCLUDING BUT NOT LIMITED TO "WORK NEAR TREES" NOTES (PLAN SHEET 2), TREE PROTECTION FENCE, TREE PROTECTION WRAP, TREE PROTECTION MAT, & COORDINATION WITH GREAT PARKS OF HAMILTON COUNTY.

ITEM 608 – 5" CONCRETE WALK, AS PER PLAN

THIS WORK INCLUDES EXCAVATION, SUBGRADE COMPACTION, FURNISHING & INSTALLING ITEM 304 AGGREGATE BASE, & 5" THICK AIR ENTRAINED PLAIN CONCRETE. ALL CONCRETE TO HAVE INITIAL SOLAR REFLECTANCE (SR) OF AT LEAST 0.33 . PROVIDE 4" THICK AGGREGATE BASE EXCEPT FOR RIVER MOUNT PAVILION AREA, PROVIDE 6" THICK AGGREGATE BASE. FOR EACH CONCRETE PAD, PROVIDE MIX DESIGN DATA, & TEST FOR 28-DAY COMPRESSIVE STRENGTH.

* ITEM 623 – CONSTRUCTION LAYOUT STAKES & SURVEYING

THIS WORK SHALL BE IN ACCORDANCE WITH ALL APPLICABLE PROVISIONS UNDER ITEM 623. THE CONTRACTOR SHALL BE RESPONSIBLE FOR HAVING THE FINISHED WORK CONFORMING TO THE LINES, GRADES, & DIMENSIONS CALLED FOR ON THE PLANS. THE CONTRACTOR SHALL BE RESPONSIBLE FOR FURNISHING, PLACING & MAINTAINING CONSTRUCTION LAYOUT STAKES NECESSARY FOR THE PROPER PROSECUTION OF THE WORK UNDER THE CONTRACT, & AS DIRECTED BY THE ENGINEER OR GREAT PARKS. PRIOR TO WORK AT ADA AREAS, CONTRACTOR TO PROVIDE OFFSET LAYOUT STAKES/HUBS TO CONFIRM ADA GRADE LINES & ELEVATIONS. INSPECT STAKES/HUBS WITH ENGINEER & GREAT PARKS AUTHORIZED REPRESENTATIVE PRIOR TO CONSTRUCTION AT ADA AREAS. PROVIDE POSITIVE DRAINAGE AWAY FROM ALL PAVED SURFACES.

ITEM SPECIAL – 690 – PAVEMENT CRACK AND JOINT REINFORCING FABRIC STRESS ABSORBING MEMBRANE INTERLAYER (SAMI)

THE PRODUCT SPECIFIED FOR THIS PROJECT IS 24" WIDE PETROTAC. THE PRODUCT SHALL BE INSTALLED IN ACCORDANCE WITH MANUFACTURER'S INSTRUCTIONS, & SHALL INCLUDE SWEEPING THE PAVEMENT, & BLOWING OFF EACH CRACK WITH A LEAF BLOWER, OR SIMILAR, IMMEDIATELY PRIOR TO PLACEMENT.

ITEM SPECIAL – 690 – CONCRETE PARKING BLOCK

PARKING BLOCK TO BE SIMILAR TO ODOT SCD RM-6.1, EXCEPT PLAN LENGTH TO BE 6- FEET, & SECTION CHAMFER TO BE 2" AT 45-DEGREE (BOTH SIDES). MAINTAIN ANCHOR PIN POSITION PER DETAIL 9" FROM OUTSIDE EDGE. CONCRETE TO BE WHITE COLOR, NOT GRAY. THE CONTRACTOR SHALL POSITION THE PARKING BLOCKS ON TOP OF THE FINAL ASPHALT CONCRETE SURFACE COURSE AS DIRECTED BY THE ENGINEER. THE NEW PARKING BLOCKS & PINS SHALL BE INSTALLED WITHIN 5 DAYS AFTER THE FINAL SURFACE COURSE IS COMPLETED ON THE PARKING LOT. PAYMENT SHALL INCLUDE, BUT NOT BE LIMITED TO, ALL SERVICES, MATERIAL, LABOR, EQUIPMENT, TOOLS & INCIDENTALS TO COMPLETE THE WORK ABOVE & SHALL BE INCLUDED IN THE UNIT BID PRICE FOR ITEM 609 – CONCRETE PARKING BLOCK.

ITEM 601 – TIED-CONCRETE BLOCK MAT W/ TYPE 1 UNDERLAYMENT, APP

PAYMENT FOR TIED-CONCRETE BLOCK MAT (TCBM) INCLUDES FURNISHING & INSTALLING NO NET WOOD FIBER MULCH BLANKET, NAG COIR JUTE NET, OR EQUAL, & STANDARD FLEXAMAT, OR EQUAL, WITHOUT UNDERLAYMENT, AT LOCATIONS SHOWN ON THE PLAN, PROVIDE INSTALL PER MANUFACTURER'S INSTRUCTIONS, & DETAILS ON THESE PLANS. SEE DETAILS ON PLAN SHEET 5.

ITEM 659 – SEEDING AND MULCHING, AS PER PLAN

PROVIDE TYPE 1 LAWN MIXTURE, EXCEPT IN AREAS WITHIN THE WOODS (DOWNSTREAM ENDS OF CONDUITS), PROVIDE TYPE 5B NATIVE WILDFLOWER AND GRASS MIXTURE. QUANTITY INCLUDES AREAS OF LINEAR GRADING (SEE PAVEMENT

DETAILS & PLAN CALLOUTS), & TCBM (UNDER MAT & OVER MAT).

THE FOLLOWING QUANTITIES ARE PROVIDED TO PROMOTE GROWTH & CARE OF PERMANENT SEEDING AREAS:

AREA = 4,105.5 SQ. YD. = 36,949.5 SQ. FT.

ITEM 659, SOIL ANALYSIS TEST 2 EACH

ITEM 659, TOPSOIL 456 CU. YD.
111 CU.YD. PER 1000 SQ.YD.

ITEM 659, SEEDING AND MULCHING 4,105.5 SQ. YD.

ITEM 659, COMMERCIAL FERTILIZER 0.55 TON
30 LBS. PER 1000 SQ.FT.

ITEM 659, LIME 0.85 ACRES

ITEM 659, WATER 22.17 M. GAL
2 X 300 GAL. PER 1000 SQ.FT.

* ASTERISK DENOTES APPROVAL BY OWNER REQUIRED

APP DENOTES "AS PER PLAN"

APPLY SEEDING & MULCHING TO ALL AREAS OF EXPOSED SOIL WITHIN THE CONSTRUCTION LIMITS. QUANTITY CALCULATIONS FOR SEEDING & MULCHING ARE BASED ON THESE LIMITS.

ITEM 602 – CONCRETE MASONRY, AS PER PLAN

PAYMENT FOR THIS ITEM INCLUDES FURNISHING & INSTALLING CONCRETE HEADWALLS PER SIZE & LOCATION SHOWN ON THE PLAN.

* 605 – 4" BASE PIPE UNDERDRAINS, AS PER PLAN

PROVIDE PERFORATED PVC PER 707.41. FOR LOCATIONS ADJACENT TO CULVERT, PLACE IN COMMON TRENCH, WITHIN 4-INCHES OF OUTER TRENCH WALL, AT SAME INVERT ELEVATIONS AS CULVERT. CONSTRUCT UPSTREAM END WITH SOLID GLUED ON CAP WHEN TERMINATING UNDER PAVEMENT. TERMINATE DOWNSTREAM OUTLET THROUGH HEADWALL. PROVIDE REMOVABLE (THREADED) END CAP, SLOTTED VERTICALLY TO ALLOW PIPE TO DRAIN, FINISH FLUSH WITH FACE OF HEADWALL. OBSERVE OPEN TRENCH & PIPE LAYOUT WITH OWNER PRIOR TO BACKFILL.

* 605 – 4" BASE PIPE UNDERDRAINS WITH GEOTEXTILE FABRIC, AS PER PLAN

SEE GEOGRID FULL DEPTH PAVEMENT DETAIL SHOWN ON PLAN SHEET 4. FOR LOCATIONS NOTED ON PLAN, TERMINATE WITH CLEANOUT (PAY ITEM 611) OR HEADWALL (PAY ITEMS 602 OR 611). TRANSITION DOWNSTREAM 50- FEET TO PROPER ALIGNMENT & ELEVATION PER OUTLET HEADWALL LOCATION. TERMINATE DOWNSTREAM OUTLET THROUGH HEADWALL. PROVIDE REMOVABLE (THREADED) END CAP, SLOTTED VERTICALLY TO ALLOW PIPE TO DRAIN, FINISH FLUSH WITH FACE OF HEADWALL. VERIFY OUTLET LOCATION WITH OWNER PRIOR TO START OF WORK.

* ITEM 611 – 6" CONDUIT AND 12" CONDUIT, TYPE A, 707.45

INSTALL NEW CONDUIT. PAYMENT SHALL INCLUDE BUT IS NOT LIMITED TO ANY GRADING IN THE VICINITY OF THE PIPE TO PROVIDE POSITIVE DRAINAGE INTO & OUT OF THE PIPE; MATERIAL & INSTALLATION OF PIPE BEDDING & BACKFILL. FOLLOW CMS 611 PERFORMANCE INSPECTION REQUIREMENTS. SEE SEPARATE PAY ITEMS FOR PAVEMENT, MASONRY (HEADWALLS), & TIED-CONCRETE BLOCK MAT (TCBM). VERIFY POSITIVE DRAINAGE FROM INLET TO OUTLET END (NORTHEAST), MATCH EXISTING INVERTS. PROVIDE STRUCTURAL BACKFILL FOR ENTIRE TRENCH, & PER MANUFACTURERS INSTRUCTIONS. EXTEND STRUCTURAL BACKFILL FROM TOP OF BEDDING TO BOTTOM OF PAVEMENT SECTION OR SEED & MULCH SECTION (4-INCH DEPTH, PAY ITEM 659). AT PAVEMENT LOW POINT CONDUITS, APPROX. STA. 4+75 & 28+50, PROVIDE FREE DRAINING STRUCTURAL BACKFILL TYPE 3. PROTECT BACKFILL FROM BEING CONTAMINATED WITH SOIL. FIELD VERIFY LOCATION WITH OWNER PRIOR TO START OF WORK.

PAVEMENT MARKING NOTES

SEE PLAN SHEET 10. THE CONTRACTOR SHALL REFERENCE ALL PAVEMENT MARKINGS INCLUDING AUXILIARY PAVEMENT MARKINGS BEFORE THE START OF THE RESURFACING OPERATION. THIS WILL BE NECESSARY TO ASSURE THE CORRECT PLACEMENT OF THE MARKINGS IN ORIGINAL LOCATIONS. PAYMENT FOR THIS OPERATION SHALL BE INCLUDED WITH EACH RESPECTIVE PAVEMENT MARKING ITEM. THE CONTRACTOR IS RESPONSIBLE FOR REPLACING ALL EXISTING PERMANENT MARKINGS WITH THIS CONTRACT AS SHOWN ON THE PLANS. THE OWNER SHALL INSPECT & CONCUR WITH THE LAYOUT. LAYOUT WORK SHALL BE PERFORMED BY THE CONTRACTOR & INCLUDED IN THE PRICE BID FOR THESE ITEMS. UNLESS OTHERWISE NOTED, ALL PAVEMENT MARKINGS INDICATED IN THE PLANS SHALL BE PAINTED OVER. APPLY GLASS BEADS TO THE WET PAINT SO THAT BEADS ARE EMBEDDED & RETAINED IN THE PAINT & PROVIDE UNIFORM RETROREFLECTIVITY IN THE PAINT SURFACE. ALL WORK SHALL BE IN ACCORDANCE WITH ODOT CMS ITEMS 641 & 642. PROVIDE DOCUMENTATION VERIFYING THAT ALL PAINT MATERIAL IS APPROVED BY ODOT. USE ONLY ODOT PREQUALIFIED TYPE 1A COLD WEATHER PAINT MATERIALS WHEN THE TEMPERATURE IS BETWEEN 35 & 50 DEGREES F.

DESIGN AGENCY



DESIGNER

RM

REVIEWER
RM 06-01-23

PROJECT ID

117816

SHEET TOTAL

P.3 19

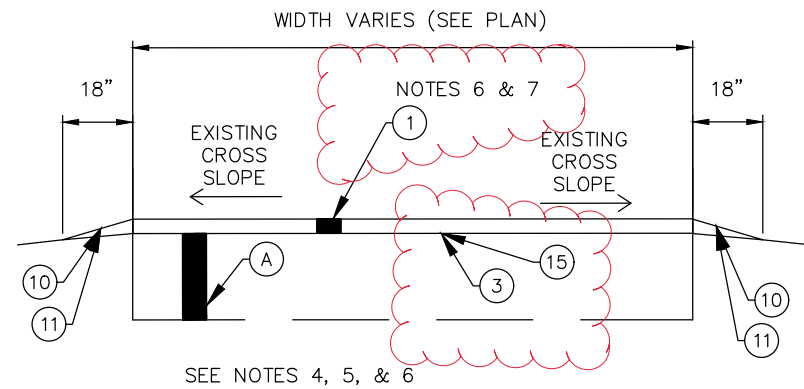

PAVEMENT SURFACE OVERLAY DETAIL (SU)

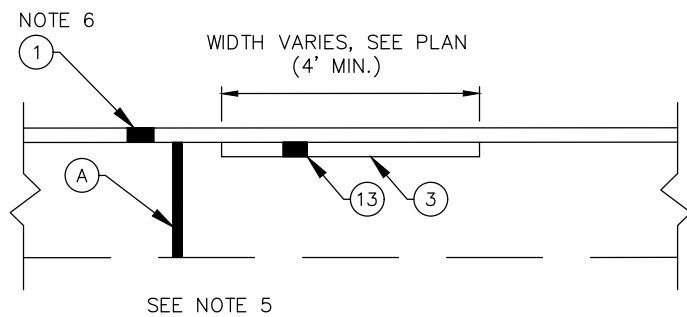

PARTIAL DEPTH PAVEMENT REPAIR DETAIL (PD)

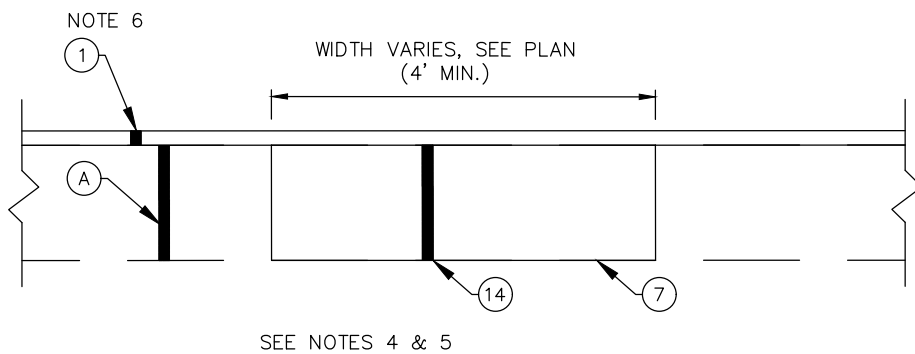

FULL DEPTH PAVEMENT REPAIR DETAIL (FD)

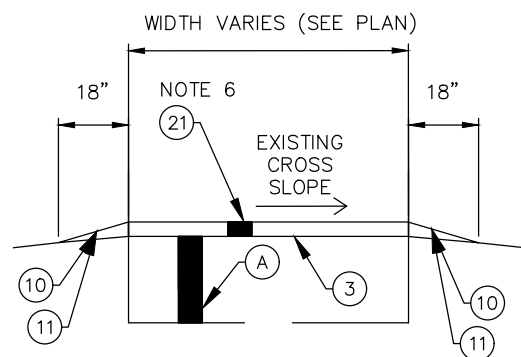

PART 02/NFA/28 -PEDESTRIAN WALK PAVEMENT SURFACE OVERLAY DETAIL (SU)

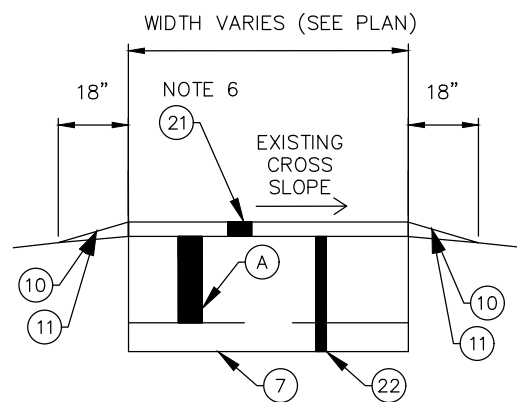

PART 02/NFA/28 -PEDESTRIAN WALK FULL DEPTH PAVEMENT REPAIR DETAIL (FD)

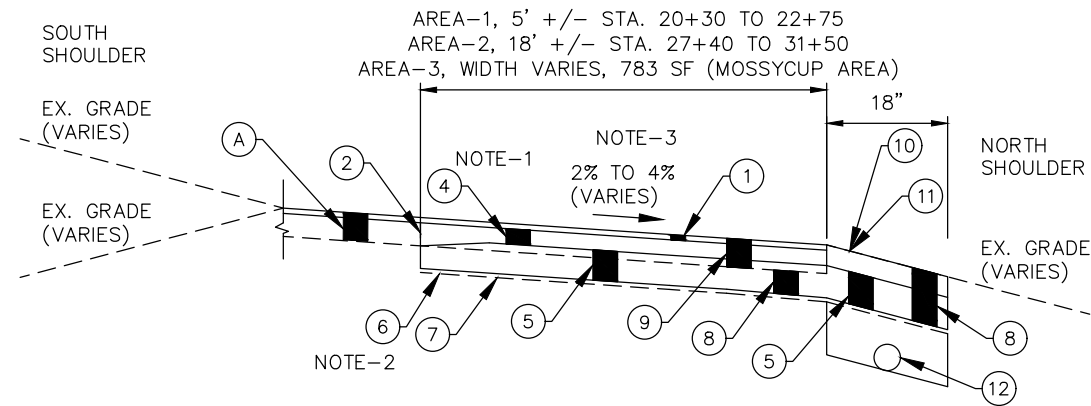

GEOGRID FULL DEPTH PAVEMENT DETAIL (GR)

- (A) EXISTING ASPHALT PAVEMENT (AVERAGE 8.5" DEPTH)
- (1) ITEM 441 - 1 1/2" ASPHALT CONCRETE SURFACE COURSE, TYPE 1, (448) PG64-22
 - INCLUDES ITEM 407 - NON-TRACKING COAT
- (2) ITEM 407 - NON-TRACKING TACK COAT
- (3) ITEM 690 - CRACK & JOINT REINFORCING FABRIC, STRESS ABSORBING MEMBRANE INTERLAYER (SAMI),
 - AT PLAN LOCATIONS, & AFTER PLANING ANY REMAINING CRACKS 1" WIDE & GREATER AT UNIT COST AS DIRECTED BY THE ENGINEER
- (4) ITEM 301 - 6" ASPHALT CONCRETE BASE, (449) PG64-22
- (5) ITEM 304 - 4" AGGREGATE BASE
- (6) ITEM 204 - GEOGRID
- (7) ITEM 204 - SUBGRADE COMPACTION
 - REPLACE ANY YIELDING MATERIAL WITH ITEM 304 AGGREGATE BASE AT 304 UNIT COST AS DIRECTED BY THE ENGINEER
- (8) ITEM 203 - EXCAVATION
- (9) ITEM 202 - PAVEMENT REMOVAL
- (10) ITEM 209 - LINEAR GRADING (MATCH EX. GRADE)
- (11) ITEM 659 - SEEDING & MULCHING
- (12) ITEM 605 - UNDERDRAIN
 - ONLY AT STA. 27+40 TO 31+40, SOUTH SHOULDER, 12" BELOW PAVEMENT SECTION AGGREGATE BASE/GEOGRID
- (13) ITEM 251 - PARTIAL DEPTH PAVEMENT REPAIR
 - INCLUDES ITEM 254 - PAVEMENT PLANING; ASPHALT DEPTH = 1 1/2"
 - INCLUDES ITEM 407 - NON-TRACKING COAT, AFTER PLANING
 - INCLUDES ITEM 441 - 1 1/2" ASPHALT CONCRETE INTERMEDIATE COURSE, TYPE 1, (448)
- (14) ITEM 253 - FULL DEPTH PAVEMENT REPAIR
 - INCLUDES ITEM 202 - PAVEMENT REMOVAL
 - INCLUDES ITEM 203 - EXCAVATION
 - INCLUDES ITEM 301 - ASPHALT CONCRETE BASE, 8.5" AVERAGE (MATCH EXISTING DEPTH), (449) PG64-22
 - INCLUDES ITEM 407 - NON-TRACKING COAT, ON VERTICAL SURFACES
- (15) ITEM 441 - ASPHALT CONCRETE INTERMEDIATE COURSE, TYPE 1, (LEVELING), AS DIRECTED BY ENGINEER (INCLUDE 50 CY FOR BID)
- (21) PART 02/NFA/28
ITEM 441 - 2" ASPHALT CONCRETE SURFACE COURSE, TYPE 1, (448) PG64-22
 - INCLUDES ITEM 407 - NON-TRACKING COAT
- (22) PART 02/NFA/28
ITEM 253 - FULL DEPTH PAVEMENT REPAIR
 - INCLUDES ITEM 202 - PAVEMENT REMOVAL
 - INCLUDES ITEM 203 - EXCAVATION
 - INCLUDES ITEM 301 - 2" ASPHALT CONCRETE BASE, (449) PG64-22
 - INCLUDES ITEM 304 - 6" AGGREGATE BASE

NOTES

1. WHEN ABUTTING EXISTING PAVEMENT, & GREATER THAN 6-INCH DEPTH IS ENCOUNTERED, MATCH EXISTING DEPTH AT 301 UNIT COST.
2. IN AREAS OF FULL ROAD WIDTH GEOGRID, OVERLAP EXCESS GEOGRID ROLL WIDTH ALONG CENTERLINE OF PAVEMENT AS NECESSARY.
3. IN AREAS OF FULL ROAD WIDTH GEOGRID, CONSTRUCT ENTIRE ROAD SECTION WITH CROSS SLOPE FROM SOUTH DOWN TO NORTH (NO CROWN).
4. SEE PART 02/NFA/28 - PEDESTRIAN WALK DETAILS (THIS SHEET).
5. SEE TECH BOOTH AREA SECTIONS (SHEET 7).
6. PROVIDE ADDITIONAL SURFACE COURSE AS NECESSARY FOR ADA GRADING, TECH BOOTH, & FOR POSITIVE DRAINAGE AWAY FROM PAVEMENT.
7. MAINTAIN EXISTING CROWN & CROSS SLOPE

NO SCALE

DESIGN AGENCY



DESIGNER

RM

REVIEWER

RM 06-01-23

PROJECT ID

117816

SHEET

P.4

TOTAL

19

SHEET NUM.											PART.		ITEM	ITEM EXT	GRAND TOTAL	UNIT	DESCRIPTION	SEE SHEET NO.
7	8	9	10	11	3	4	01/NFP/0 4/GPHC	02/NFA/2 8										
ROADWAY																		
					LS		LS		201	11001	LS					CLEARING AND GRUBBING, AS PER PLAN	3	
	71.2	1,090					1,115	46.2	202	23001	1,161.2	SY				PAVEMENT REMOVED, AS PER PLAN	4	
100	338	101					488	51	202	35100	539	FT				PIPE REMOVED, 24" AND UNDER	7	
			293				293		SPECIAL	20252990	293	EACH				PARKING BLOCK REMOVED	3	
	85	30					115		SPECIAL	20270000	115	FT				FILL AND PLUG EXISTING CONDUIT 12"	3	
									202	98000	LS					REMOVAL MISC.: AS PER PLAN	3	
	11.8	140.1					152		203	10001	152	CY				EXCAVATION, AS PER PLAN	4	
15	15	15					45		203	20001	45	CY				EMBANKMENT, AS PER PLAN	7	
343.8	343.1	1,210.2					1,507.2	389.9	204	10001	1,897.1	SY				SUBGRADE COMPACTION, AS PER PLAN	4	
80		54					134		204	50001	134	SY				GEOTEXTILE FABRIC, AS PER PLAN	3	
	86	1,210.2					1,296.2		204	51001	1,296.2	SY				GEOGRID, AS PER PLAN	3	
782.2	2,164.7	984					3,375.5	555.4	209	98300	3,930.9	SY				LINEAR GRADING, MISC.: AS PER PLAN	4	
1,183	2,121	522					3,081	745	607	98000	3,826	FT				FENCE, MISC.: AS PER PLAN	3	
	716	98						814	608	12001	814	SF				5" CONCRETE WALK, AS PER PLAN	3	
	290							290	608	30000	290	SF				AGGREGATE WALK	8	
122	148	47					317		SPECIAL	69012040	317	SY				PAVEMENT CRACK AND JOINT REINFORCING FABRIC	3	
			255				255		SPECIAL	69050500	255	EACH				CONCRETE PARKING BLOCK	3	
EROSION CONTROL																		
	86.4	39.8	35.7				158.2	3.7	601	21051	161.9	SY				TIED CONCRETE BLOCK MAT WITH TYPE 1 UNDERLAYMENT, AS PER PLAN	3	
	865.6	2,242.5	997.4				3,786.4	319.1	659	10001	4,105.5	SY				SEEDING AND MULCHING, AS PER PLAN	3	
DRAINAGE																		
	2.32	6.96	2.32				10.44	1.16	602	20001	11.6	CY				CONCRETE MASONRY, AS PER PLAN	5	
	56		36				92		605	06001	92	FT				4" BASE PIPE UNDERDRAINS, AS PER PLAN	3	
			473				473		605	06021	473	FT				4" BASE PIPE UNDERDRAINS WITH GEOTEXTILE FABRIC, AS PER PLAN	3	
	12	13	27				27	25	611	97400	52	FT				CONDUIT, MISC.: 6" CONDUIT, 707.45	3	
	2	2	2				2	4	611	99710	6	EACH				PRECAST REINFORCED CONCRETE OUTLET	5	
			4				4		611	99900	4	EACH				DRAINAGE STRUCTURE, MISC.: CLEANOUT	7	
DRAINAGE ALTERNATES																		
	100	311	100				473	38	611	04200	511	FT				12" CONDUIT, TYPE A, 707.04	7	
	100	311	100				473	38	611	04200	511	FT				12" CONDUIT, TYPE A, 706.02	7	
	100	311	100				473	38	611	04200	511	FT				12" CONDUIT, TYPE A, 707.45	7	
PAVEMENT																		
	2,219.3	1,944.8	2,346.4				6,510.5		251	01001	6,510.5	SY				PARTIAL DEPTH PAVEMENT REPAIR (441), AS PER PLAN	4	
	79.3	183.7	54.1				230.5	86.6	253	02001	317.1	CY				PAVEMENT REPAIR, AS PER PLAN	4	
		125					125		254	01000	125	SY				PAVEMENT PLANING, ASPHALT CONCRETE 1.5"	8	
		11	174				185		301	56001	185	CY				ASPHALT CONCRETE BASE, (449), AS PER PLAN PG64-22	4	
		9.6	134.5				144.1		304	20001	144.1	CY				AGGREGATE BASE, AS PER PLAN	4	
		6	13.2				19.2		407	20001	19.2	GAL				NON-TRACKING TACK COAT, AS PER PLAN	4	
	1,791	855					2,646		423	00204	2,646	SY				CRACK SEALING, TYPE II	7	
	201.9	238	194.1				598.7	35.3	441	50000	634	CY				ASPHALT CONCRETE SURFACE COURSE, TYPE 1, (448), PG64-22	4	
						50	50		441	50200	50	CY				ASPHALT CONCRETE INTERMEDIATE COURSE, TYPE 1, (448)	4	
	268.7	128.2					396.9		886	11000	396.9	GAL				FOG SEAL	4	
WATER WORK																		
				2				2	638	10800	2	EACH				VALVE BOX ADJUSTED TO GRADE	11	
LIGHTING																		
	90	75	240				405		625	25605	405	FT				CONDUIT, 4", 725.051, AS PER PLAN	7	
TRAFFIC CONTROL																		
	7	4	1				12		630	84901	12	EACH				REMOVAL OF GROUND MOUNTED SIGN AND DISPOSAL, AS PER PLAN	7	
	8	7	4				19		630	97700	19	EACH				SIGNING, MISC.: AS PER PLAN	7	
				1.11			1.11		642	00100	1.11	MILE				EDGE LINE, 4", TYPE 1		
				0.57			0.57		642	00300	0.57	MILE				CENTER LINE, TYPE 1		
			10				10		642	00500	10	FT				STOP LINE, TYPE 1		
				400			400		642	00701	400	FT				TRANSVERSE/DIAGONAL LINE, TYPE 1, AS PER PLAN	10	
				5,000			5,000		642	01200	5,000	FT				PARKING LOT STALL MARKING, TYPE 1		
				14			14		642	01703	14	EACH				HANDICAP SYMBOL MARKING, TYPE 1, AS PER PLAN	10	
MAINTENANCE OF TRAFFIC																		
							LS		614	11000	LS					MAINTAINING TRAFFIC	2	
INCIDENTALS																		
							LS		624	10000	LS					MOBILIZATION	2	
							LS		623	10000	LS					CONSTRUCTION LAYOUT STAKES AND SURVEYING	3	

*** TECH BOOTH AREA NOTES**
 TECH BOOTH AREA REQUIRES DIFFERENT FINISHED GRADES THAN OTHER AREAS IN ORDER TO MAINTAIN EXISTING CONCRETE CURB REVEAL & DRAINAGE. MODIFY PLAN SHEET 4 DETAILS TO PROVIDE FINISHED GRADES PER SECTIONS ON THIS SHEET.

- (A) EXISTING ASPHALT PAVEMENT
- (B) EXISTING GRADE
- (C) FINISHED GRADE
- (D) SURFACE COURSE
- (E) PAVEMENT PLANING

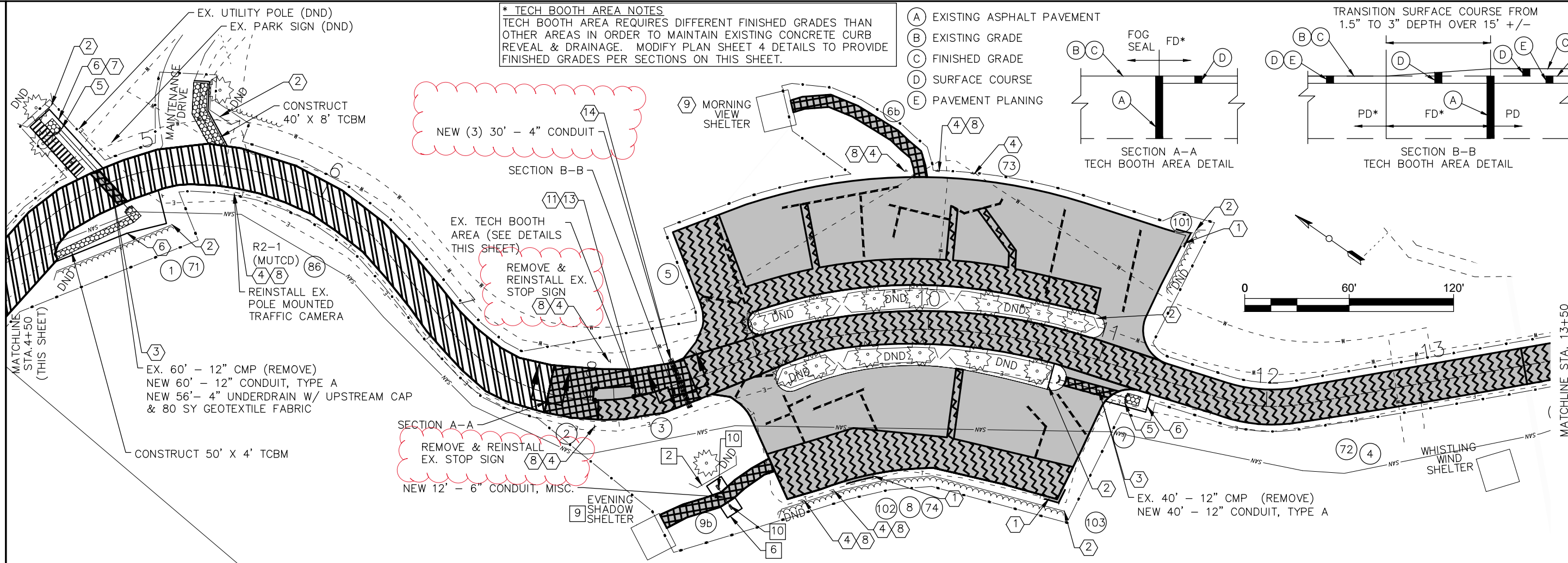
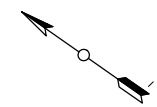
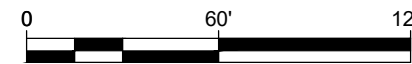
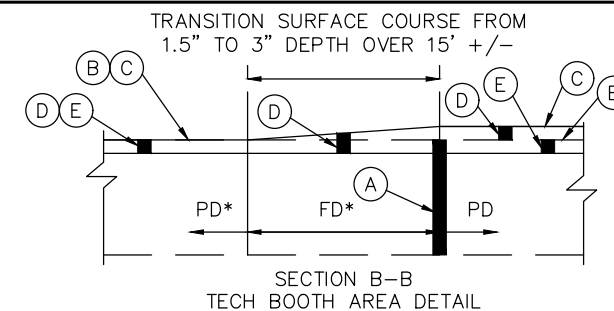
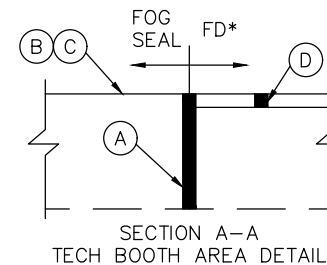

SECTION A-A
 REMOVE & REINSTALL EX. STOP SIGN
 NEW 12' - 6" CONDUIT, MISC.

SECTION B-B
 EX. TECH BOOTH AREA (SEE DETAILS THIS SHEET)
 REMOVE & REINSTALL EX. STOP SIGN

EX. 60' - 12" CMP (REMOVE)
 NEW 60' - 12" CONDUIT, TYPE A
 NEW 56' - 4" UNDERDRAIN W/ UPSTREAM CAP & 80 SY GEOTEXTILE FABRIC

EX. 40' - 12" CMP (REMOVE)
 NEW 40' - 12" CONDUIT, TYPE A

LEGEND

- SURFACE OVERLAY, LIMITS OF ITEM 441 - ASPHALT CONCRETE SURFACE COURSE, TYPE 1, (448) PG64-22 (SEE DETAIL "SU")
- FULL DEPTH REPAIR (SEE DETAIL "FD")
- PARTIAL DEPTH REPAIR (SEE DETAIL "PD")
- FULL DEPTH REPAIR W/ GEOGRID & AGGREGATE BASE (SEE DETAIL "GR")
- LIMITS OF ITEM 423 - CRACK SEALING, TYPE 2, & ITEM 886 - FOG SEAL
- STRESS-ABSORBING MEMBRANE INTERLAYER (SAMI), 24" WIDE, APPROXIMATE LOCATION (SEE GEN. NOTES)
- TREE PROTECTION FENCE, DND (DO NOT DISTURB) (SEE GEN. NOTES & DETAILS)
- TREE PROTECTION WRAP AROUND EXIST. TREE (SEE GEN. NOTES & DETAILS)
- TREE PROTECTION MAT PLACED ON GRADE (SEE GEN. NOTES & DETAILS)
- HEADWALL (SEE DETAILS)
- TIED-CONCRETE BLOCK MAT (TCBM), STANDARD FLEXAMAT WITHOUT UNDERLAYMENT, OR EQUAL (SEE DETAILS)
- LIMITS OF CONSTRUCTION

LEGEND CONTINUED

- PART 1 CODED NOTE (SEE THIS SHEET)
- PART 2 CODED NOTE (SEE THIS SHEET)
- PART 1 AREA (SEE TABLE THIS SHEET)
- PART 2 AREA (SEE TABLE THIS SHEET)

AREA TABLE

"M-", MAIN DRIVE
 "SHLD", SHOULDER

DESC.	Ref. #	Area (SF)
FD	1	123
FD M-	2	1634
PD M-	3	514
PD M-	4	9883
PD	5	5595
FD	7	143
PD	8	3982
SU M-	71	123
SU M-	72	12195
SU	73	17792
SU	74	11865
SEAL M-	85	9406
SEAL M-	86	6714
TCBM	101	15
TCBM	102	16
TCBM	103	15
FD	6b	659
FD	9b	535

CODED NOTES

1. CONSTRUCT TIED CONCRETE BLOCK MAT, STANDARD FLEXAMAT WITHOUT UNDERLAYMENT (OR EQUAL), 4'-WIDE BY LENGTH SHOWN
2. CONSTRUCT TREE PROTECTION FENCE
3. REMOVE EX. CONDUIT; CONSTRUCT NEW CONDUIT, (SEE PLAN LENGTHS & SIZE). CONSTRUCT INLET & OUTLET HEADWALLS.
4. ITEM 630 - INSTALL NEW OWNER FURNISHED COMPOSITE SIGN POST. PROVIDE & INSTALL NEW SIGN, UNLESS NOTED OTHERWISE (SEE ADA PLAN SHEET 16).
5. CONSTRUCT OUTLET PROTECTION WITH TIED CONCRETE BLOCK MAT, STANDARD FLEXAMAT WITHOUT UNDERLAYMENT (OR EQUAL), 5.5'-WIDE BY 6'-BEYOND HEADWALL.
6. GRADING/RESHAPE GRASS AREA PROVIDE 4H:1V SLOPE, (3H:1V MAX) (280 SY)
7. CONSTRUCT EMBANKMENT TO FILL EX. ERODED AREA (15 CY)
8. ITEM 630 - REMOVE EX. SIGN POST & RETURN SIGN TO OWNER.
9. SEE GRADING/ADA PLAN SHEETS (VARIABLE OVERLAY DEPTH)
10. CONSTRUCT HEADWALL (NO OUTLET PROTECTION)
11. REMOVE & RESET EX. SITE FURNISHING (PLANTERS)
12. EX. PARKING BLOCKS ALONG ENTRANCE DRIVE TO REMAIN.
13. EX. BOLLARDS TO REMAIN.
14. ITEM 625 - CONSTRUCT CONDUIT, 725.051, SEAL ENDS, BURY VERTICAL 12" TALL NO.4 REBAR AT CENTER END OF EACH COMMON TRENCH, WRAP TRACER AT REBAR.

DESIGN AGENCY



DESIGNER
RM

REVIEWER
RM 06-01-23

PROJECT ID
117816

SHEET TOTAL
P.7 19

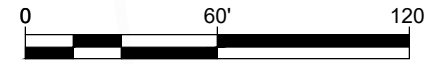
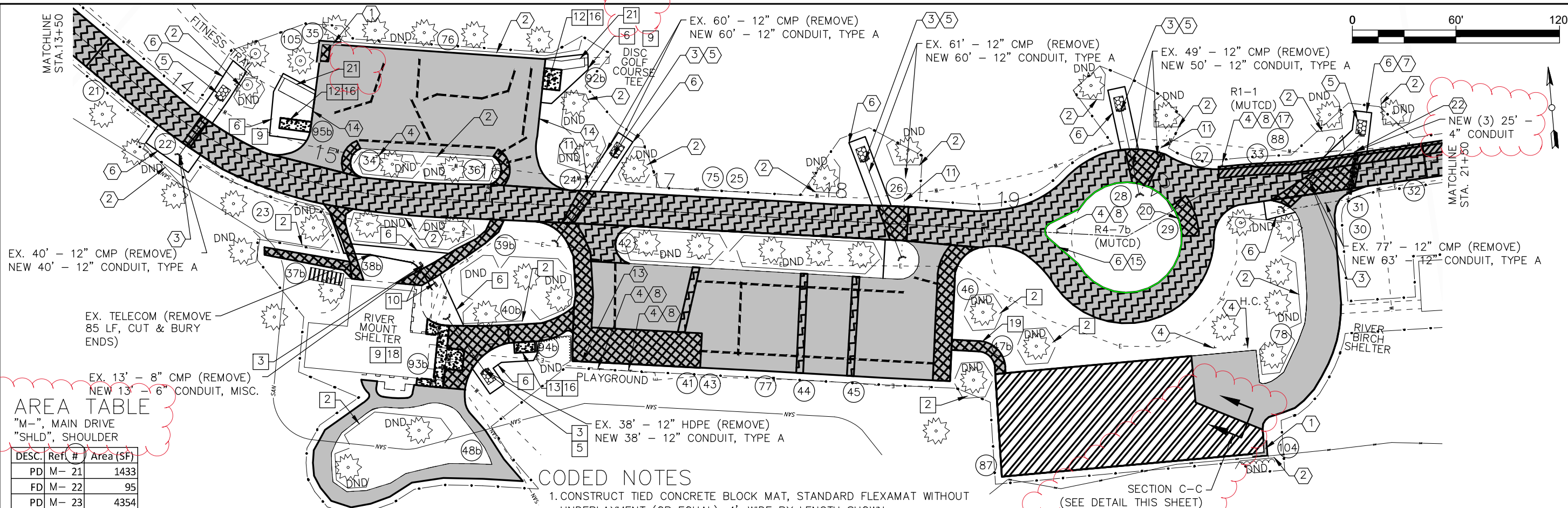

AREA TABLE
"M-", MAIN DRIVE
"SHLD", SHOULDER

DESC.	Ref. #	Area (SF)
PD	M- 21	1433
FD	M- 22	95
PD	M- 23	4354
FD	M- 24	151
PD	M- 25	3304
FD	M- 26	271
PD	M- 27	6836
FD	M- 28	316
FD	M- 29	219
FD	M- 30	48
FD	M- 31	498
PD	M- 32	540
GR	M- 33	596
FD	M- 34	105
FD	M- 35	50
FD	M- 36	111
FD	M- 41	2144
PD	M- 42	422
PD	M- 43	154
PD	M- 44	230
PD	M- 45	230
FD	M- 46	815
SU	M- 75	18614
SU	M- 76	8550
SU	M- 77	13934
SU	M- 78	4264
SEAL	M- 87	7695
SHLD	M- 88	178
TCBM	M- 104	15
TCBM	M- 105	23
FD	M- 37b	255
FD	M- 38b	256
FD	M- 39b	446
FD	M- 40b	1127
FD	M- 47b	230
SU	M- 48b	2186
CONC	M- 92b	120
CONC	M- 93b	416
CONC	M- 94b	72
CONC	M- 95b	108

*** RIVER BIRCH PARKING AREA NOTES**
AT RIVER BIRCH PARKING LOT BETWEEN NEW SURFACE COURSE AREA AND FOG SEAL AREA, PERFORM PAVEMENT PLANING (ODOT ITEM 254, 125 SY) TO ACHIEVE GRADUAL FINISHED SLOPE IN SURFACE COURSE OF 1% +/-.

- (A) EXISTING ASPHALT PAVEMENT
- (B) EXISTING GRADE
- (C) FINISHED GRADE
- (D) SURFACE COURSE
- (E) PAVEMENT PLANING

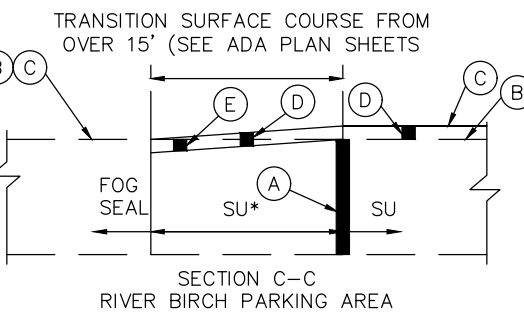

LEGEND CONTINUED

- # PART 1 CODED NOTE (SEE THIS SHEET)
- # PART 2 CODED NOTE (SEE THIS SHEET)
- # PART 1 AREA (SEE TABLE THIS SHEET)
- #b PART 2 AREA (SEE TABLE THIS SHEET)

CODED NOTES

1. CONSTRUCT TIED CONCRETE BLOCK MAT, STANDARD FLEXAMAT WITHOUT UNDERLAYMENT (OR EQUAL), 4'-WIDE BY LENGTH SHOWN
2. CONSTRUCT TREE PROTECTION FENCE
3. REMOVE EX. CONDUIT; CONSTRUCT NEW CONDUIT, (SEE PLAN LENGTHS & SIZE). CONSTRUCT INLET & OUTLET HEADWALLS.
4. ITEM 630 - INSTALL NEW OWNER FURNISHED COMPOSITE SIGN POST. PROVIDE & INSTALL NEW SIGN, UNLESS NOTED OTHERWISE (SEE ADA PLAN SHEET 16).
5. CONSTRUCT OUTLET PROTECTION WITH TIED CONCRETE BLOCK MAT, STANDARD FLEXAMAT WITHOUT UNDERLAYMENT (OR EQUAL), 5.5'-WIDE BY 6'-BEYOND HEADWALL.
6. GRADE/RESHAPE GRASS AREA PROVIDE 4H:1V SLOPE, (3H:1V MAX) (980 SY)
7. CONSTRUCT EMBANKMENT TO FILL EX. ERODED AREA (15 CY)
8. ITEM 630 - REMOVE EX. SIGN POST & RETURN SIGN TO OWNER.
9. SEE GRADING/ADA PLAN SHEETS (VARIABLE OVERLAY DEPTH)
10. CONSTRUCT HEADWALL (NO OUTLET PROTECTION)
11. CUT EX. CONDUIT 2' BEYOND EDGE OF PAVEMENT; REMOVE CONDUIT UNDER PAVEMENT; FILL & PLUG REMAINING CONDUIT SECTION NEAR TREE.
12. REMOVE AND DISPOSE OF EX. BENCH; EXCAVATE & REMOVE EX. FOOTING, BACKFILL WITH SELECT BACKFILL.
13. REMOVE & RESET EX. SITE FURNISHING (BICYCLE RACK, BENCH)
14. REMOVE & DISPOSE OF EX. TIMBERS ALONG PAVEMENT (ARPROX. 40 LF TOTAL)
15. REMOVE ASPHALT OUTSIDE/BEYOND PAVEMENT LANE (5 SY). REGRADE CENTER OF ISLAND (385 SY), PROVIDE POSITIVE DRAINAGE TO NEW CULVERT PIPE.
16. CONSTRUCT NEW CONCRETE TO ACHIEVE ADA COMPLIANT SLOPES ALONG PATH & FOR FUTURE BENCH (ACCESSIBLE ROUTE)
17. STOP BAR MARKING
18. REMOVE EX. CONCRETE, SEE GRADING PLAN (46.2 SY)
19. CONSTRUCT NEW WALK (SEE DETAIL "FD", PEDESTRIAN WALK NOTES)
20. CONSTRUCT VARIABLE OVERLAY FOR POSITIVE DRAINAGE AWAY FROM PAVEMENT (EX. AREA OF PONDING WATER)
21. CONSTRUCT ITEM 608 AGGREGATE WALK, INCLUDING EXCAVATION, SUBGRADE COMPACTION, 4" COMPACTED 304 AGGREGATE BASE, AND 2" COMPACTED LIMESTONE SCREENINGS SIZE #10 PER ODOT TABLE 703.01 (290 SF).
22. ITEM 625 - CONSTRUCT CONDUIT, 725.051, SEAL ENDS, BURY VERTICAL 12" TALL NO.4 REBAR AT CENTER END OF EACH COMMON TRENCH, WRAP TRACER AT REBAR.

LEGEND

- SURFACE OVERLAY, LIMITS OF ITEM 441 - ASPHALT CONCRETE SURFACE COURSE, TYPE 1, (448) PG64-22 (SEE DETAIL "SU")
- FULL DEPTH REPAIR (SEE DETAIL "FD")
- PARTIAL DEPTH REPAIR (SEE DETAIL "PD")
- FULL DEPTH REPAIR W/ GEOGRID & AGGREGATE BASE (SEE DETAIL "GR")
- LIMITS OF ITEM 423 - CRACK SEALING, TYPE 2, & ITEM 886 - FOG SEAL
- STRESS-ABSORBING MEMBRANE INTERLAYER (SAMI), 24" WIDE, APPROXIMATE LOCATION (SEE GEN. NOTES)
- TREE PROTECTION FENCE, DND (DO NOT DISTURB) (SEE GEN. NOTES & DETAILS)
- TREE PROTECTION WRAP AROUND EXIST. TREE (SEE GEN. NOTES & DETAILS)
- TREE PROTECTION MAT PLACED ON GRADE (SEE GEN. NOTES & DETAILS)
- HEADWALL (SEE DETAILS)
- TIED-CONCRETE BLOCK MAT (TCBM), STANDARD FLEXAMAT WITHOUT UNDERLAYMENT, OR EQUAL (SEE DETAILS)
- LIMITS OF CONSTRUCTION
- MUTCD MANUAL OF UNIFORM TRAFFIC CONTROL DEVICES
- CONCRETE PAVEMENT (SEE GEN. NOTES & DETAILS SHEET 3)

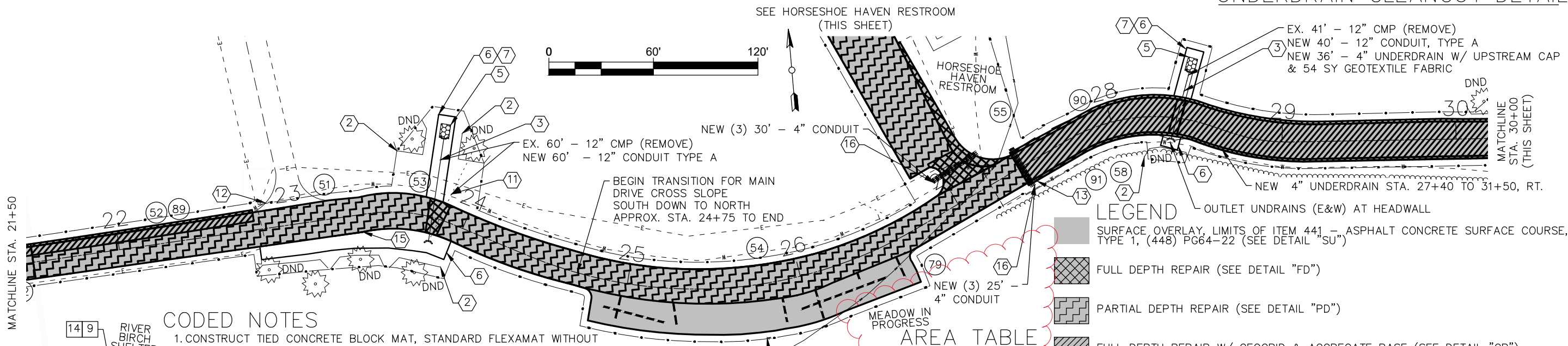
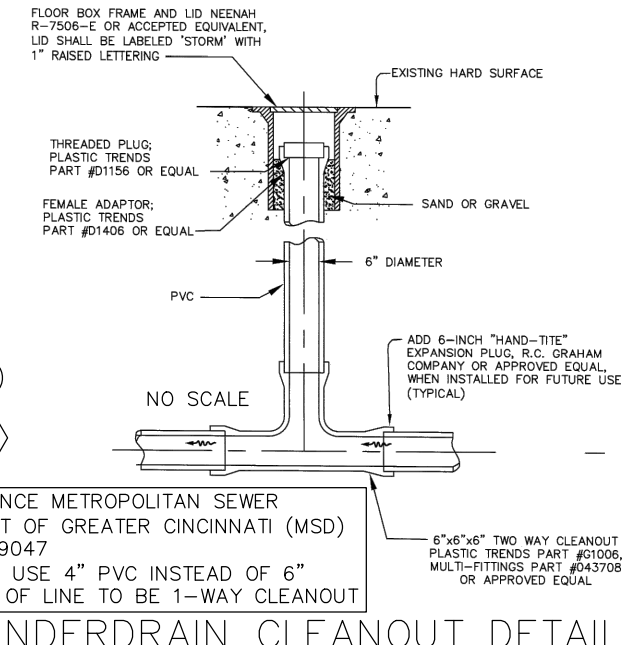
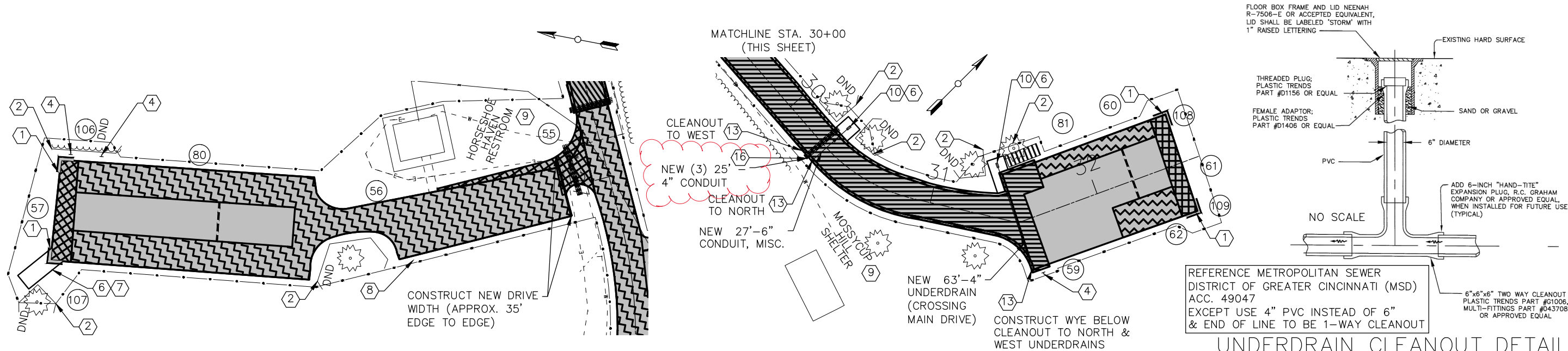

CODED NOTES

1. CONSTRUCT TIED CONCRETE BLOCK MAT, STANDARD FLEXAMAT WITHOUT UNDERLAYMENT (OR EQUAL), 4'-WIDE BY LENGTH SHOWN
2. CONSTRUCT TREE PROTECTION FENCE
3. REMOVE EX. CONDUIT; CONSTRUCT NEW CONDUIT, (SEE PLAN LENGTHS & SIZE). CONSTRUCT INLET & OUTLET HEADWALLS.
4. ITEM 630 - INSTALL NEW OWNER FURNISHED COMPOSITE SIGN POST. PROVIDE & INSTALL NEW SIGN, UNLESS NOTED OTHERWISE (SEE ADA PLAN SHEET 16).
5. CONSTRUCT OUTLET PROTECTION WITH TIED CONCRETE BLOCK MAT, STANDARD FLEXAMAT WITHOUT UNDERLAYMENT (OR EQUAL), 5.5'-WIDE BY 6'-BEYOND HEADWALL.
6. GRADE/RESHAPE GRASS AREA PROVIDE 4H:1V SLOPE, (3H:1V MAX) (270 SY)
7. CONSTRUCT EMBANKMENT TO FILL EX. ERODED AREA (15 CY)
8. ITEM 630 - REMOVE EX. SIGN POST & RETURN SIGN TO OWNER.
9. SEE GRADING/ADA PLAN SHEETS (VARIABLE OVERLAY DEPTH)
10. CONSTRUCT HEADWALL (NO OUTLET PROTECTION)
11. CUT EX. CONDUIT 2' BEYOND EDGE OF PAVEMENT; REMOVE CONDUIT UNDER PAVEMENT; FILL & PLUG REMAINING CONDUIT SECTION NEAR TREE.
12. EX. CONCRETE BLOCKS AT THIS DRIVE TO REMAIN.
13. CONSTRUCT CLEANOUT FROM UNDERDRAIN UP TO FINISHED GRADE
14. CONSTRUCT NEW CONCRETE, SEE GRADING PLAN (98 SF)
15. CONSTRUCT VARIABLE OVERLAY FOR POSITIVE DRAINAGE AWAY FROM PAVEMENT (EX. AREA OF PONDING WATER)
16. ITEM 625 - CONSTRUCT CONDUIT, 725.051, SEAL ENDS, BURY VERTICAL 12" TALL NO.4 REBAR AT CENTER END OF EACH COMMON TRENCH, WRAP TRACER AT REBAR.

LEGEND CONTINUED

- # PART 1 CODED NOTE (SEE THIS SHEET)
- # PART 2 CODED NOTE (SEE THIS SHEET)
- # PART 1 AREA (SEE TABLE THIS SHEET)
- #b PART 2 AREA (SEE TABLE THIS SHEET)

AREA TABLE

Desc.	Ref #	Area (SF)
PD	M- 51	3841
GR	M- 52	643
FD	53	183
PD	54	6753
FD	55	706
PD	56	9168
FD	57	630
GR	M- 58	8079
GR	M- 59	672
PD	60	704
FD	61	544
PD	62	652
SU	M- 79	22939
SU	80	13322
SU	81	5778
SHLD	M- 89	183
SHLD	M- 90	649
SHLD	M- 91	665
TCBM	106	15
TCBM	107	15
TCBM	108	15
TCBM	109	15

- LEGEND**
- OUTLET UNDRAINS (E&W) AT HEADWALL
 - SURFACE OVERLAY, LIMITS OF ITEM 441 - ASPHALT CONCRETE SURFACE COURSE, TYPE 1, (448) PG64-22 (SEE DETAIL "SU")
 - FULL DEPTH REPAIR (SEE DETAIL "FD")
 - PARTIAL DEPTH REPAIR (SEE DETAIL "PD")
 - FULL DEPTH REPAIR W/ GEOGRID & AGGREGATE BASE (SEE DETAIL "GR")
 - LIMITS OF ITEM 423 - CRACK SEALING, TYPE 2, & ITEM 886 - FOG SEAL
 - STRESS-ABSORBING MEMBRANE INTERLAYER (SAMI), 24" WIDE, APPROXIMATE LOCATION (SEE GEN. NOTES)
 - DND TREE PROTECTION FENCE, DND (DO NOT DISTURB) (SEE GEN. NOTES & DETAILS)
 - TREE PROTECTION WRAP AROUND EXIST. TREE (SEE GEN. NOTES & DETAILS)
 - TREE PROTECTION MAT PLACED ON GRADE (SEE GEN. NOTES & DETAILS)
 - HEADWALL (SEE DETAILS)
 - TIED-CONCRETE BLOCK MAT (TCBM), STANDARD FLEXAMAT WITHOUT UNDERLAYMENT, OR EQUAL (SEE DETAILS)
 - LIMITS OF CONSTRUCTION
 - MUTCD MANUAL OF UNIFORM TRAFFIC CONTROL DEVICES
 - CONCRETE PAVEMENT (SEE GEN. NOTES & DETAILS SHEET 3)

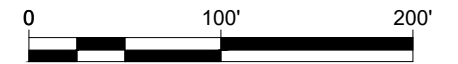
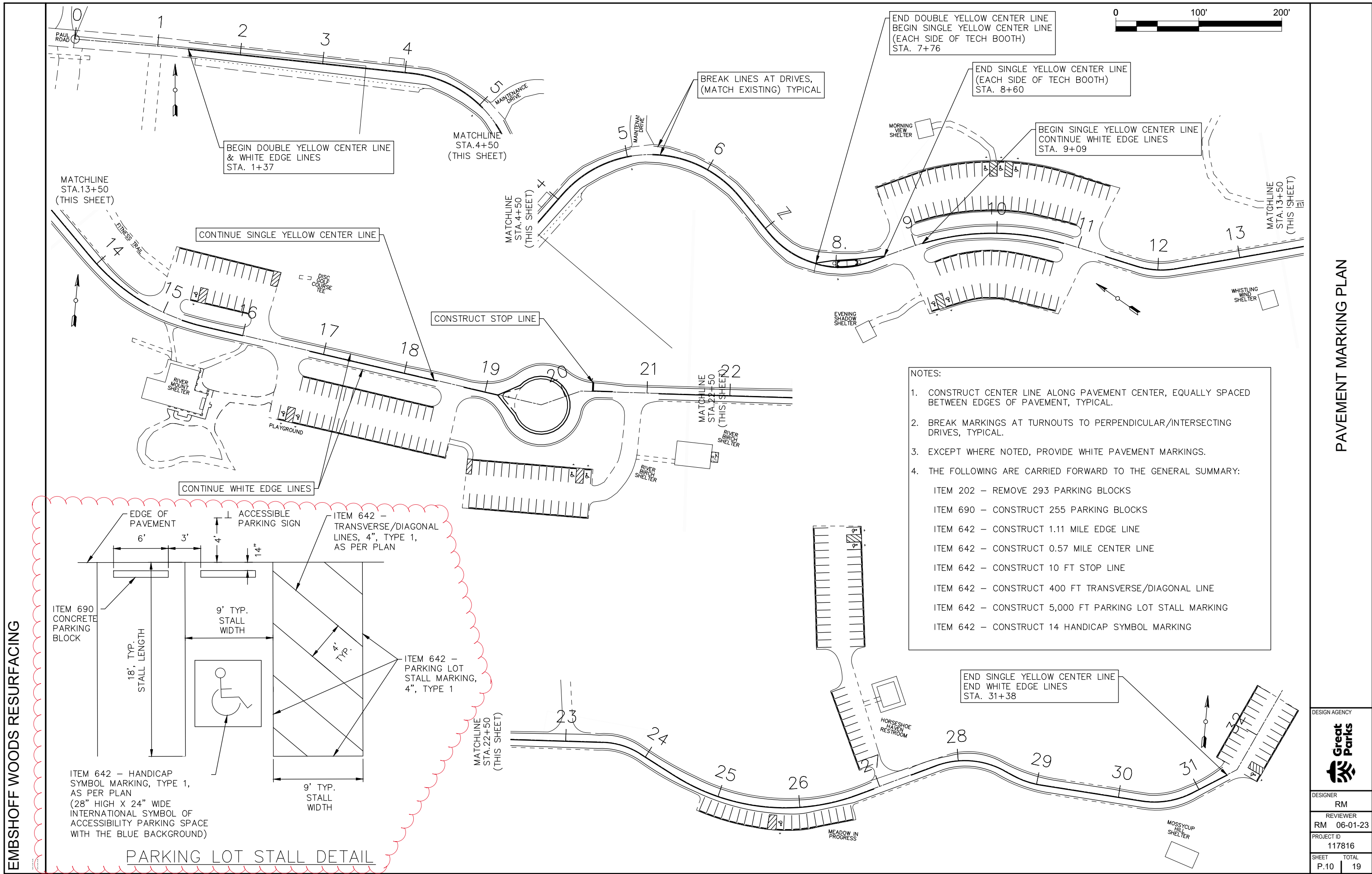

BEGIN DOUBLE YELLOW CENTER LINE & WHITE EDGE LINES STA. 1+37

MATCHLINE STA. 4+50 (THIS SHEET)

BREAK LINES AT DRIVES, (MATCH EXISTING) TYPICAL

END DOUBLE YELLOW CENTER LINE
BEGIN SINGLE YELLOW CENTER LINE
(EACH SIDE OF TECH BOOTH)
STA. 7+76

END SINGLE YELLOW CENTER LINE
(EACH SIDE OF TECH BOOTH)
STA. 8+60

BEGIN SINGLE YELLOW CENTER LINE
CONTINUE WHITE EDGE LINES
STA. 9+09

MATCHLINE STA. 13+50 (THIS SHEET)

CONTINUE SINGLE YELLOW CENTER LINE

MATCHLINE STA. 4+50 (THIS SHEET)

CONSTRUCT STOP LINE

MATCHLINE STA. 22+50 (THIS SHEET)

CONTINUE WHITE EDGE LINES

- NOTES:
1. CONSTRUCT CENTER LINE ALONG PAVEMENT CENTER, EQUALLY SPACED BETWEEN EDGES OF PAVEMENT, TYPICAL.
 2. BREAK MARKINGS AT TURNOUTS TO PERPENDICULAR/INTERSECTING DRIVES, TYPICAL.
 3. EXCEPT WHERE NOTED, PROVIDE WHITE PAVEMENT MARKINGS.
 4. THE FOLLOWING ARE CARRIED FORWARD TO THE GENERAL SUMMARY:
 - ITEM 202 – REMOVE 293 PARKING BLOCKS
 - ITEM 690 – CONSTRUCT 255 PARKING BLOCKS
 - ITEM 642 – CONSTRUCT 1.11 MILE EDGE LINE
 - ITEM 642 – CONSTRUCT 0.57 MILE CENTER LINE
 - ITEM 642 – CONSTRUCT 10 FT STOP LINE
 - ITEM 642 – CONSTRUCT 400 FT TRANSVERSE/DIAGONAL LINE
 - ITEM 642 – CONSTRUCT 5,000 FT PARKING LOT STALL MARKING
 - ITEM 642 – CONSTRUCT 14 HANDICAP SYMBOL MARKING

EMBSHOFF WOODS RESURFACING

PAVEMENT MARKING PLAN

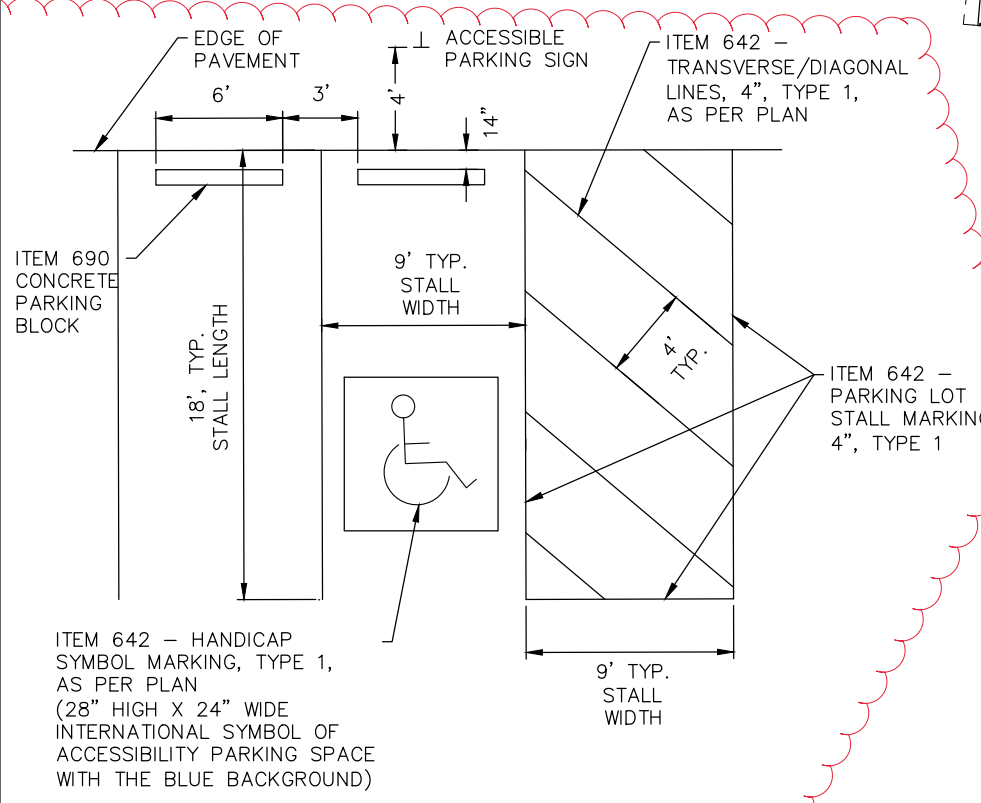

PARKING LOT STALL DETAIL

MATCHLINE STA. 22+50 (THIS SHEET)

END SINGLE YELLOW CENTER LINE
END WHITE EDGE LINES
STA. 31+38

DESIGN AGENCY	Great Parks
DESIGNER	RM
REVIEWER	RM 06-01-23
PROJECT ID	117816
SHEET TOTAL	P.10 19

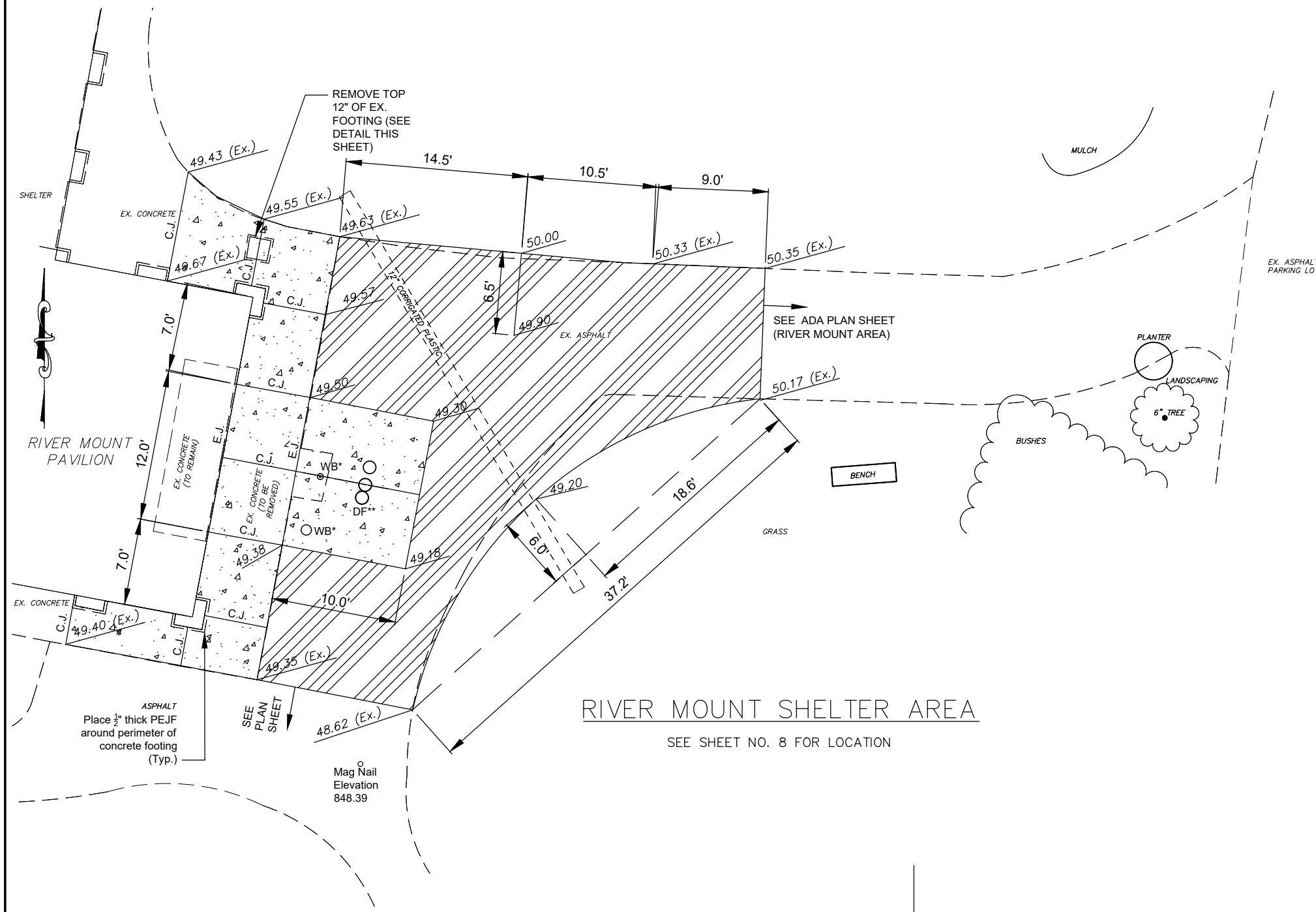

- NOTES:
1. PROVIDE 4.9% MAX. LONGITUDINAL SLOPE ALONG ADA ACCESSIBLE ROUTE (WALKS)
 2. PROVIDE 1.9% MAX. CROSS SLOPE ALONG ADA ACCESSIBLE ROUTE (WALKS)
 3. MATCH NEW FINISHED GRADE ELEVATION AT ADJACENT PAVEMENT.
 4. OWNER TO REMOVE RIVER MOUNT SHELTER WOOD FENCE PRIOR TO CONSTRUCTION; COORDINATE WITH OWNER.
 5. THE FOLLOWING ARE CARRIED TO THE GENERAL SUMMARY:
- ITEM 202 – INCLUDE FOOTING REMOVAL IN REMOVAL MISC.
 ITEM 638 – (2 EA) WATER BOX ADJUSTED TO GRADE

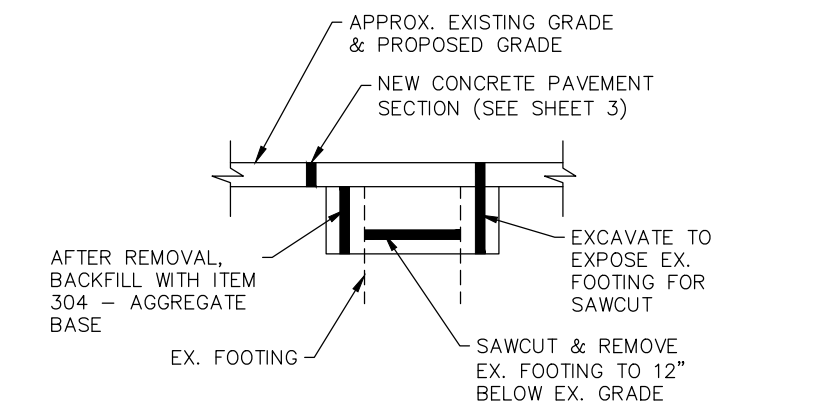
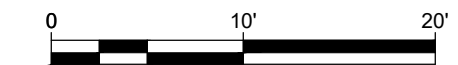

- NOTE:
1. AFTER EXCAVATION & PRIOR TO SAWCUT, CONTACT OWNER FOR INSPECTION OF FOOTING.

FOOTING REMOVAL DETAIL
NO SCALE

RIVER MOUNT SHELTER AREA
SEE SHEET NO. 8 FOR LOCATION

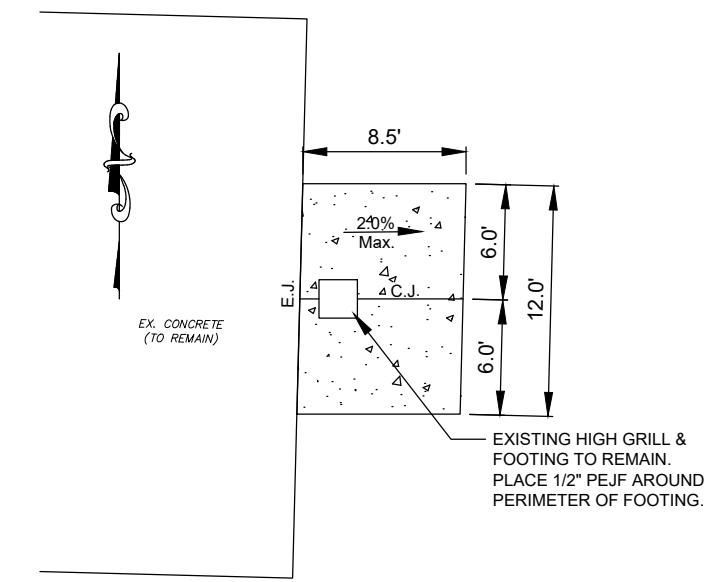

RIVER BIRCH SHELTER AREA
SEE SHEET NO. 9 FOR LOCATION

- E.J. - DENOTES EXPANSION JOINT WITH 1/2" THICK PREFORMED EXPANSION JOINT FILLER.
- C.J. - DENOTES CONTROL JOINT
- WB* - DENOTES EXISTING WATER BOX TO BE ADJUSTED TO GRADE
- DF** - DENOTES EXISTING DRINKING FOUNTAINS. PLACE 1/2" THICK PREFORMED EXPANSION JOINT FILLER AROUND PERIMETER OF CONCRETE FOUNDATION.
- ASPHALT Place 1/2" thick PEJF around perimeter of concrete footing (Typ.)
- Mag Nail Elevation 848.39
- 50.00 - DENOTES PROPOSED
- 50.33 (Ex.) - DENOTES EXISTING
- DENOTES NEW CONCRETE.
- /// DENOTES REVISED ASPHALT PERIMETER.

LEGEND

ID	2	3	4	CONTRACT PART	DESCRIPTION	Ref. #	Area (SF)	SY	FT	FT	CY	CY	SY	SY	SY	SY	FT	SF	SY	SY	CY	FT	FT	FT	FT	EACH	EACH	SY	CY	CY	CY	CY	GAL	SY	CY	GAL	EACH	EACH
ITEM EXT	ITEM	UNIT																																				
					PAVEMENT REMOVED, APP																																	
	23001				PIPE REMOVED, 24" AND UNDER																																	
	35100				FILL AND PLUG EXISTING CONDUIT																																	
	2027000(SPECIAL)				EXCAVATION, APP																																	
	10001				EMBANKMENT, APP																																	
	20001				SUBGRADE COMPACTION, APP																																	
	10001				GEOTEXTILE FABRIC, APP																																	
	50001				GEOGRID, APP																																	
	51001				LINEAR GRADING, MISC.																																	
	98300				FENCE, MISC.																																	
	98000				5" CONCRETE WALK, APP																																	
	12001				PAVEMENT CRACK AND JOINT REINFORCING FABRIC																																	
	6901204(SPECIAL)				TIED CONCRETE BLOCK MAT WITH TYPE 1 UNDERLAYMENT, APP																																	
	21051				SEEDING AND MULCHING, APP																																	
	10001				CONCRETE MASONRY, APP																																	
	20001				4" BASE PIPE UNDERDRAINS, APP																																	
	06001				4" BASE PIPE UNDERDRAINS WITH GEOTEXTILE FABRIC, APP																																	
	06021				12" CONDUIT, TYPE A, 707.45																																	
	04200				CONDUIT, MISC.: 6" CONDUIT, 707.45																																	
	97400				PRECAST REINFORCED CONCRETE OUTLET																																	
	99710				DRAINAGE STRUCTURE, MISC.:																																	
	99900				PARTIAL DEPTH PAVEMENT REPAIR (441), APP																																	
	01001				PAVEMENT REPAIR, APP																																	
	02001				ASPHALT CONCRETE BASE, PG64-22, APP																																	
	46001				AGGREGATE BASE, APP																																	
	20001				NON-TRACKING TACK COAT, APP																																	
	20001				CRACK SEALING, TYPE II																																	
	00204				ASPHALT CONCRETE SURFACE COURSE, TYPE 1, (448), PG64-22																																	
	50000				FOG SEAL																																	
	11000				REMOVAL OF GROUND MOUNTED SIGN AND DISPOSAL, APP																																	
	84901				SIGNING, MISC.: APP																																	
	97700																																					

SUBSUMMARY

DESIGN AGENCY

 DESIGNER
 RM
 REVIEWER
 RM 06-01-23
 PROJECT ID
 117816
 SHEET TOTAL
 P.14 19

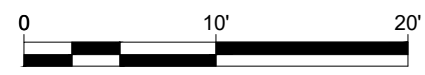
NOTE:
 QUANTITIES ARE CARRIED FORWARD TO THE GENERAL SUMMARY.



- ADA GRADING NOTES:
1. PROVIDE 1.9% MAX. SLOPE IN ALL DIRECTIONS IN ADA PARKING STALLS
 2. PROVIDE 4.9% MAX. LONGITUDINAL SLOPE ALONG ADA ACCESSIBLE ROUTE (WALKS)
 3. PROVIDE 1.9% MAX. CROSS SLOPE ALONG ADA ACCESSIBLE ROUTE (WALKS)
 4. PROVIDE VARIABLE DEPTH SURFACE OVERLAY TO ACHIEVE PROPER SLOPES, 1.5" MIN. DEPTH
 5. MATCH NEW FINISHED GRADE ELEVATION AT ADJACENT PAVEMENT.
 6. (-) NEGATIVE SIGN DENOTES SLOPING DOWNWARD IN DIRECTION OF ARROW.
 7. (VA#) DENOTES EXISTING ELEVATION PER ODOT PROVIDED POINTS FOR REFERENCE ONLY. FIELD VERIFY ALL LAYOUT PER ITEM 623 PRIOR TO BEGINNING PAVEMENT WORK.
 8. VARIATION BETWEEN DEPICTED LINEWORK & POINTS IS DUE TO DIFFERENCE IN PROVIDED POINTS & CAGIS LINEWORK.

LINE REPRESENTS EXIST. PAVEMENT APPROXIMATE CENTERLINE

MATCH EXIST. CONCRETE ELEVATION

GRADING NOTE-8

GRADING NOTE-8

GRADING NOTE-8

GRADING NOTE-8

MORNING VIEW AREA

EVENING SHADOW AREA

ODOT PROVIDED POINTS

Point	Easting	Northing	Elevation
VA1	1375955.41	404058.92	859.85
VA2	1375959.88	404054.79	859.44
VA3	1375966.80	404045.71	858.82
VA4	1375960.52	403975.29	862.87
VA5	1375719.53	403984.85	864.78
VA6	1375779.63	403953.82	863.07
VA7	1376190.68	403569.14	849.86
VA8	1376174.05	403576.72	849.74
VA9	1376176.02	403582.49	849.40
VA10	1376311.75	403441.63	849.49
VA11	1376311.47	403435.40	849.49
VA12	1376296.39	403435.12	849.34
VA13	1376576.98	403400.71	848.35
VA14	1376549.00	403414.51	848.13
VA15	1376549.66	403420.57	847.76
VA16	1376565.76	403419.80	848.33
VA17	1376698.45	403380.45	847.79
VA18	1376727.84	403381.86	847.59
VA19	1376728.17	403371.69	847.70
VA20	1376768.91	403424.42	846.84
VA21	1377314.53	403797.60	805.38
VA22	1377257.88	403793.35	805.70
VA23	1377317.88	403769.54	806.74
VA100	1375742.73	403968.30	863.29
VA101	1375970.48	403991.40	862.14
VA102	1376192.91	403576.51	849.48
VA103	1376296.15	403442.04	849.61
VA104	1376579.99	403414.63	848.22
VA105	1376583.37	403401.00	848.24
VA107	1376765.17	403405.94	847.44
VA108	1377283.64	403795.21	806.04
VA109	1377289.17	403764.87	807.56
VA110	1377260.31	403762.10	807.47

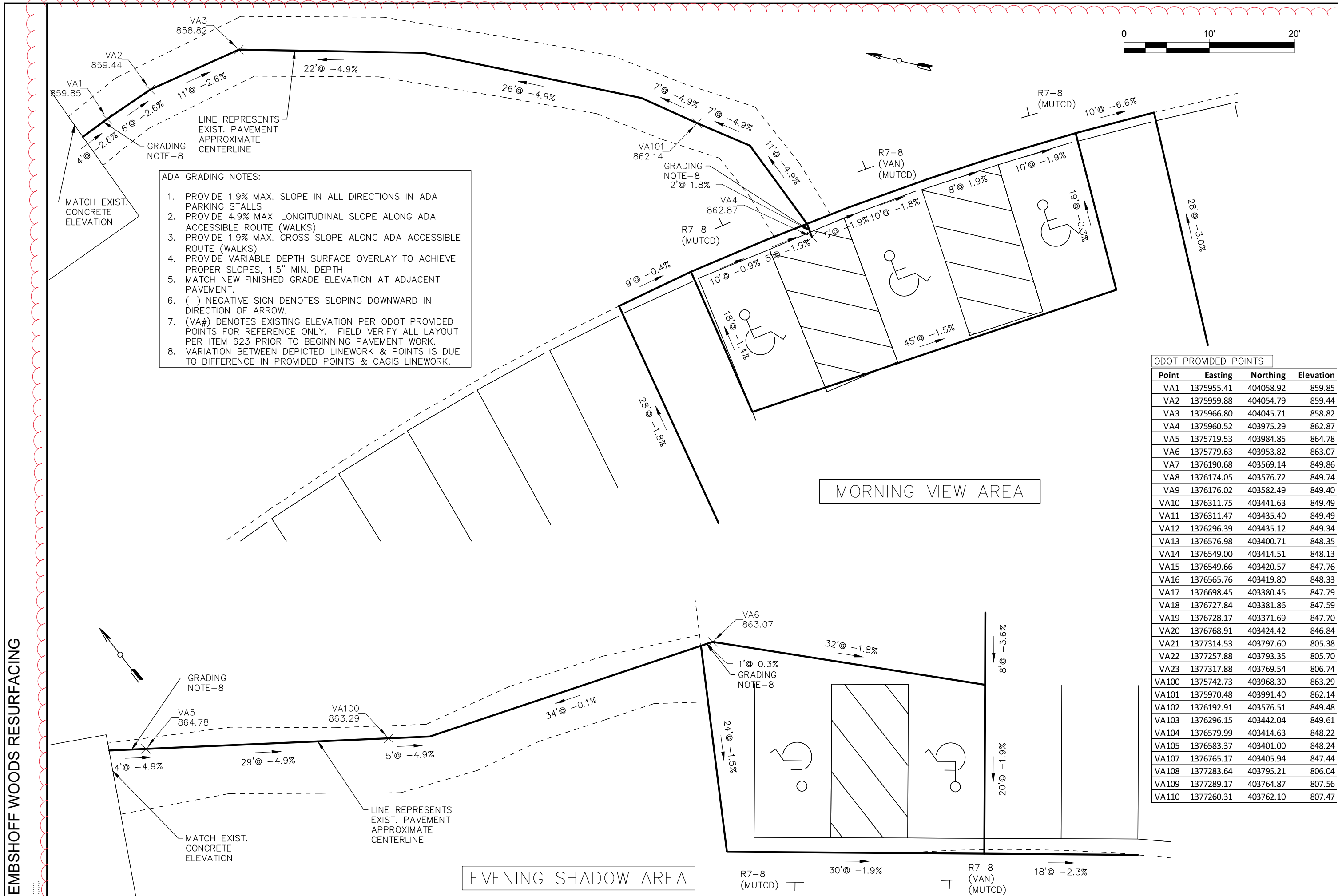

DESIGN AGENCY
Great Parks

DESIGNER
 RM

REVIEWER
 RM 06-01-23

PROJECT ID
 117816

SHEET TOTAL
 P.15 | 19

- The minimum height, measured vertically from the bottom of the sign plaque to the elevation of the near edge of the road pavement shall be 5 feet. Where parking or pedestrian movements are likely to occur, the minimum height shall be 7 feet. Refer to the example below and to ODOT Section 2A.18 Mounting Height.
- The distance from the edge of pavement to the near edge of the sign plaque shall be a minimum of 2 feet, 3 feet where possible. Refer to the example below and to ODOT Section 2A.19 Lateral Offset. Consult D&LA for guidance on sign placement.

Example of Roadside Vehicular Sign Installation Height and Lateral Location

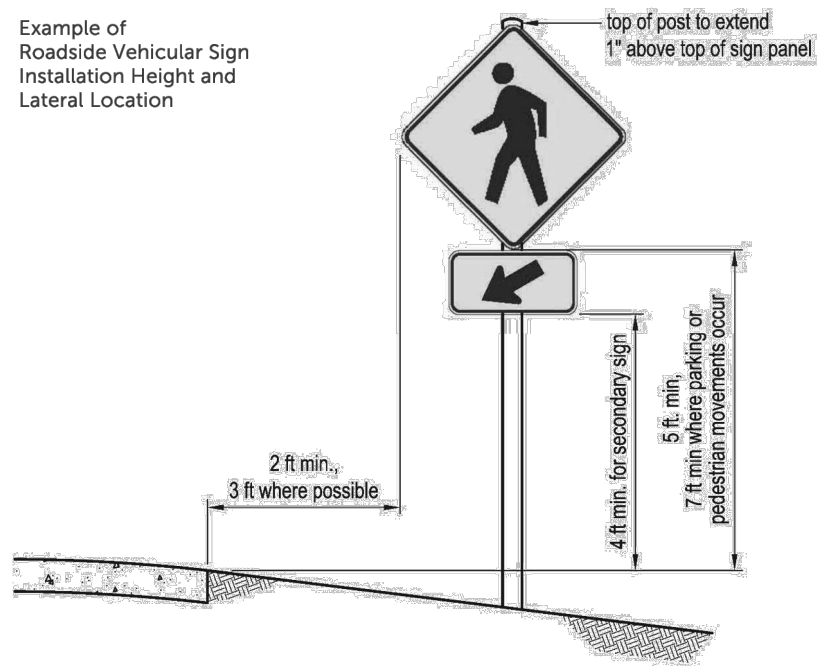

ROADSIDE SIGN DETAIL

- INSTALLATION INSTRUCTIONS FOR SIGN POSTS:
- GATHER OWNER PROVIDED MATERIALS. FOR EACH POST, THIS INCLUDES 4" X 4" COMPOSITE SLOTTED POST, HDPE STABILIZER PANEL, & HARDWARE
 - CUT BOTTOM OF POST TO REQUIRED LENGTH IF NECESSARY.
 - ATTACH STABILIZER PANEL TO BOTTOM OF POST BY PLACING POST ON A FLAT HARD SURFACE. USE THE (2) 1/4"-20 X 4-1/2" CARRIAGE BOLTS & SECURE USING THE 1/4" FLAT WASHERS & 1/4"-20 HEX NUTS.
 - AUGER DRILL OR POST HOLE DIG A HOLE 33" DEEP BY 12" DIAMETER HOLE (LOCATION VARIES, SEE NOTES THIS SHEET).
 - PLACE 3" GRAVEL (SIZE NO. 8 PER ODOT TABLE 703.01) IN BASE OF HOLE & TAMP FIRM.
 - USING TWO PERSONS, CAREFULLY LIFT THE POST & STABILIZER ASSEMBLY & LOWER THE PANEL INTO THE HOLE.
 - ENSURE ASSEMBLY IS LEVEL IN ALL DIRECTIONS.
 - VALIDATE THE PROPER HEIGHT OF THE SIGN, OR HEIGHT ABOVE GRADE LEVEL (HAGL).
 - WITH ONE PERSON HOLDING THE ASSEMBLY, HAND SHOVEL & DISTRIBUTE GRAVEL EVENLY BETWEEN THE FRONT & BACK OF THE STABILIZER PANEL.
 - TAMP FILL EVERY 6" DEPTH, & FILL APPROXIMATELY 28" DEPTH (TO WITHIN 2" OF FINISHED GRADE).
 - COMPLETE PER ODOT ITEM 659.

- ACCESSIBLE PARKING SIGN NOTES:
- LOCATE SIGN SO THAT FACE OF SIGN IS 4 FEET BEHIND EDGE OF PAVEMENT & CENTERED ON PARKING STALL.
 - BOTTOM OF THE MAIN SIGN (R7-8) TO BE 60 INCHES OFF THE GROUND.
 - SECONDARY FINE SIGN (R7-H8bP) TO BE BELOW MAIN SIGN
 - SECONDARY VAN ACCESSIBLE SIGN (R7-8P) TO BE BELOW FINE SIGN (ONLY IN "VAN" PLAN CALLOUT LOCATIONS)

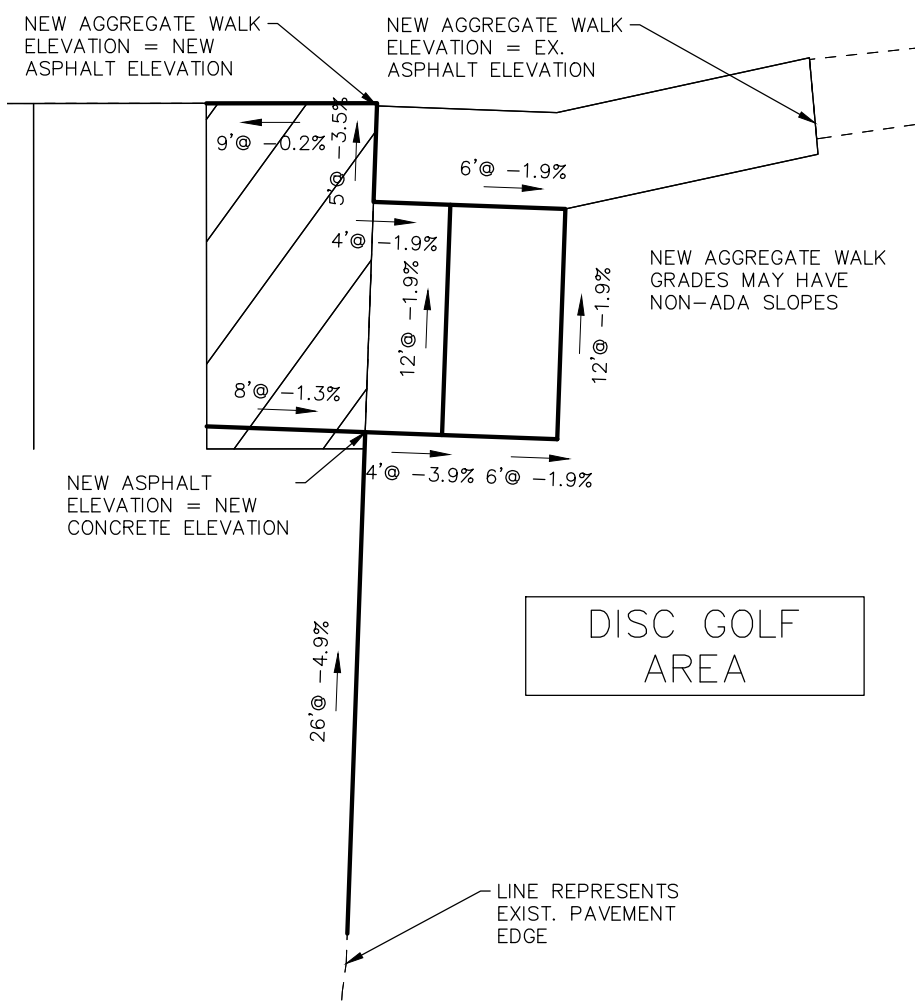

- ADA GRADING NOTES:
- PROVIDE 1.9% MAX. SLOPE IN ALL DIRECTIONS IN ADA PARKING STALLS
 - PROVIDE 4.9% MAX. LONGITUDINAL SLOPE ALONG ADA ACCESSIBLE ROUTE (WALKS)
 - PROVIDE 1.9% MAX. CROSS SLOPE ALONG ADA ACCESSIBLE ROUTE (WALKS)
 - PROVIDE VARIABLE DEPTH SURFACE OVERLAY TO ACHIEVE PROPER SLOPES, 1.5" MIN. DEPTH
 - MATCH NEW FINISHED GRADE ELEVATION AT ADJACENT PAVEMENT.
 - (-) NEGATIVE SIGN DENOTES SLOPING DOWNWARD IN DIRECTION OF ARROW.
 - (VA#) DENOTES EXISTING ELEVATION PER ODOT PROVIDED POINTS FOR REFERENCE ONLY. FIELD VERIFY ALL LAYOUT PER ITEM 623 PRIOR TO BEGINNING PAVEMENT WORK.
 - VARIATION BETWEEN DEPICTED LINEWORK & POINTS IS DUE TO DIFFERENCE IN PROVIDED POINTS & CAGIS LINEWORK.

EMBSHOFF WOODS RESURFACING

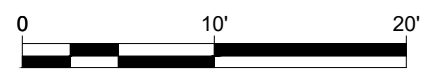
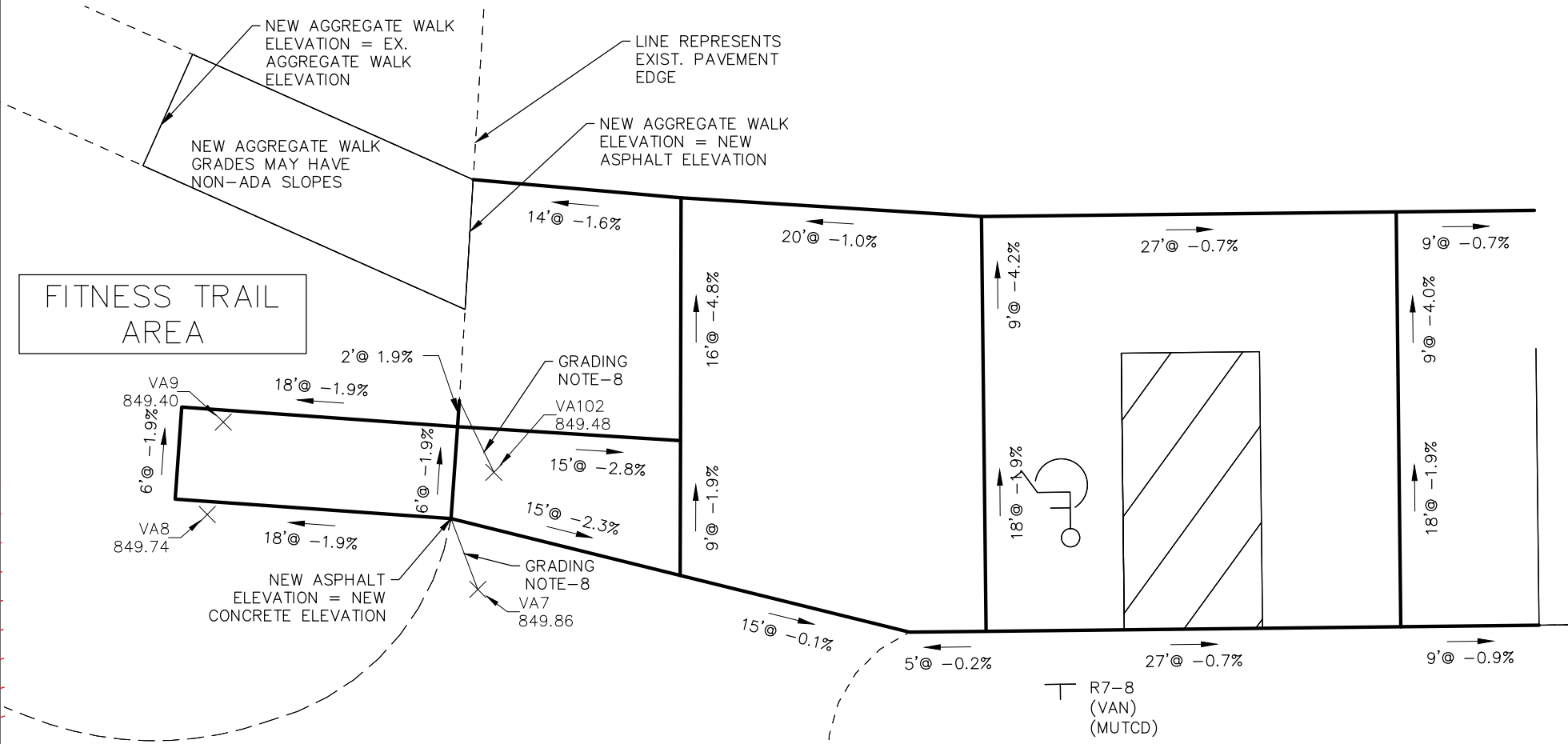

ADA PLAN 2

DESIGN AGENCY	Great Parks
DESIGNER	RM
REVIEWER	RM 06-01-23
PROJECT ID	117816
SHEET	TOTAL
P.16	19

RIVER MOUNT AREA

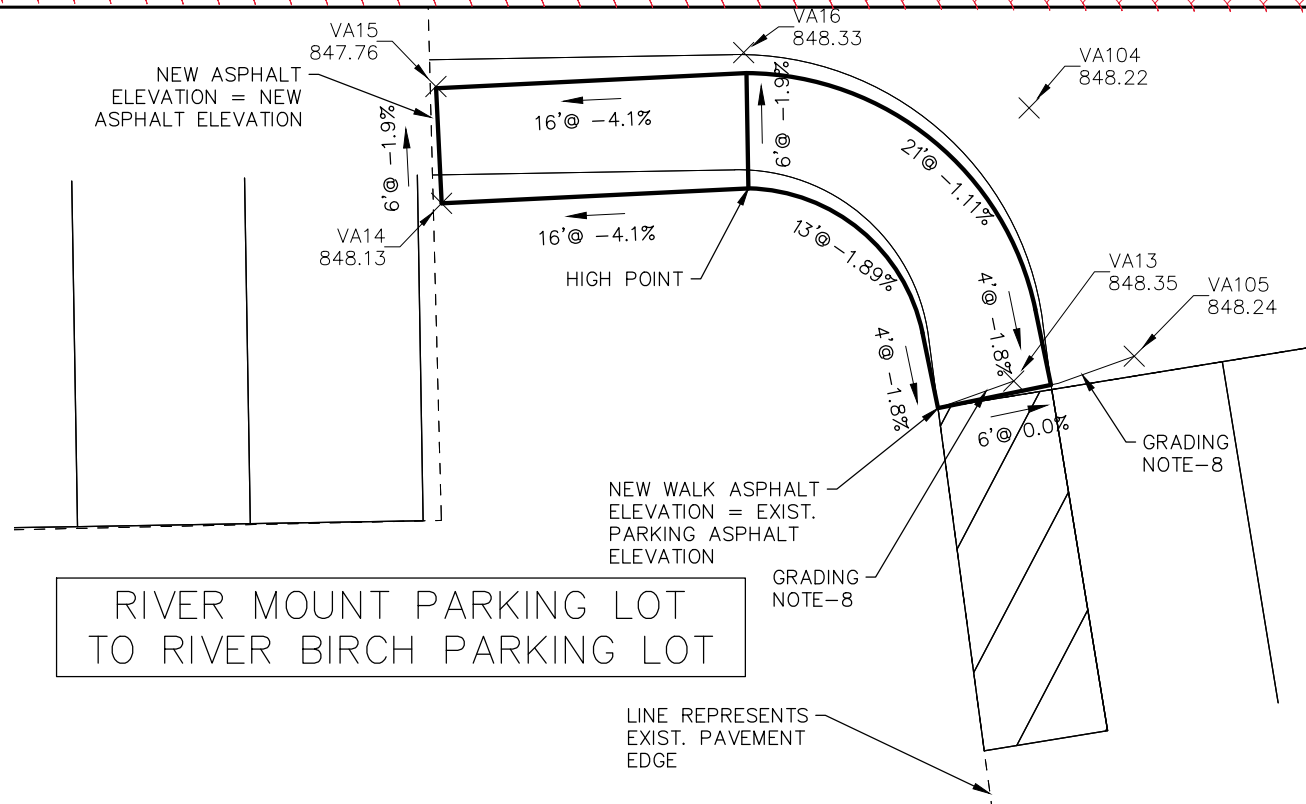
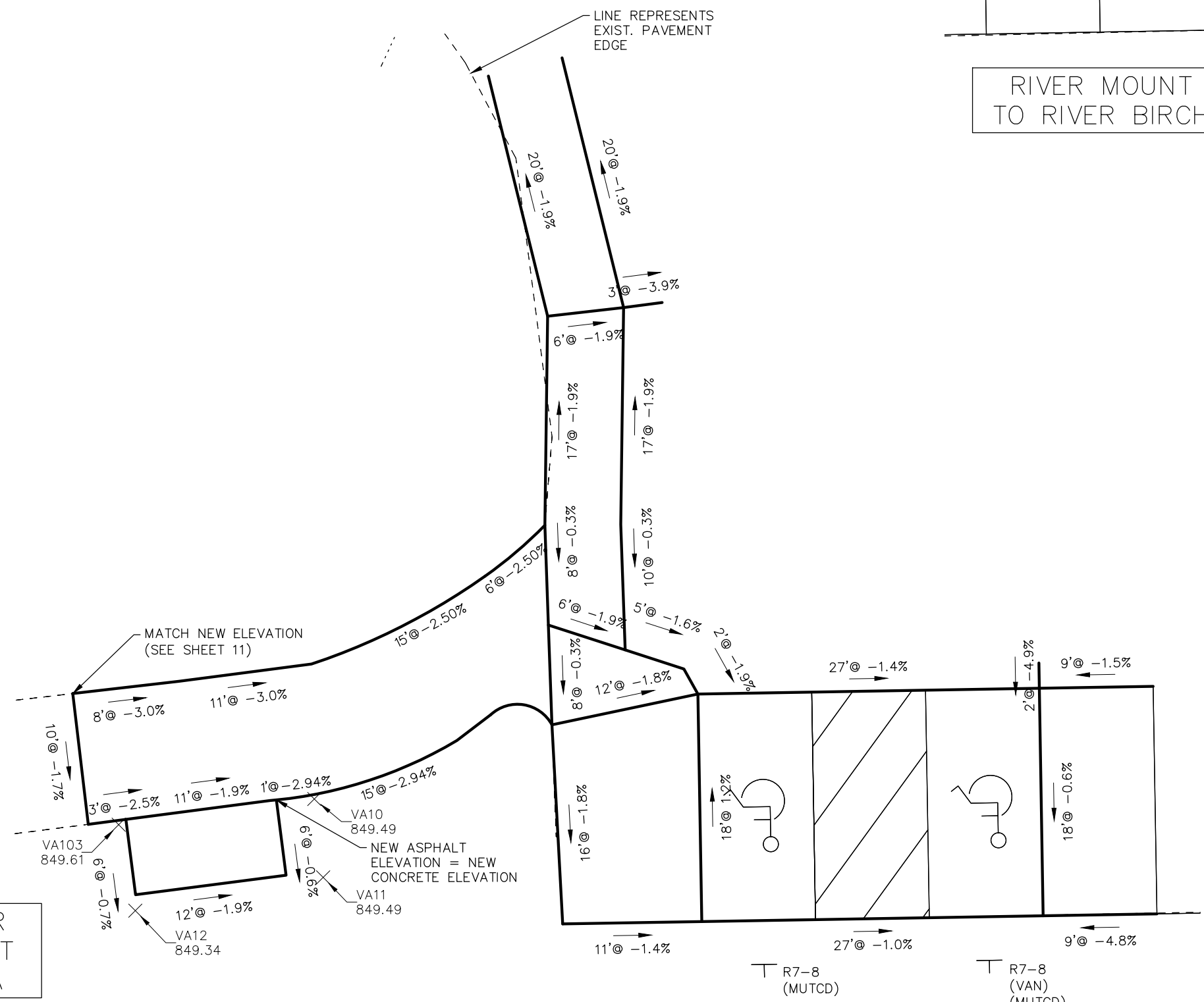

RIVER MOUNT PARKING LOT TO RIVER BIRCH PARKING LOT

- ADA GRADING NOTES:
1. PROVIDE 1.9% MAX. SLOPE IN ALL DIRECTIONS IN ADA PARKING STALLS
 2. PROVIDE 4.9% MAX. LONGITUDINAL SLOPE ALONG ADA ACCESSIBLE ROUTE (WALKS)
 3. PROVIDE 1.9% MAX. CROSS SLOPE ALONG ADA ACCESSIBLE ROUTE (WALKS)
 4. PROVIDE VARIABLE DEPTH SURFACE OVERLAY TO ACHIEVE PROPER SLOPES, 1.5" MIN. DEPTH
 5. MATCH NEW FINISHED GRADE ELEVATION AT ADJACENT PAVEMENT.
 6. (-) NEGATIVE SIGN DENOTES SLOPING DOWNWARD IN DIRECTION OF ARROW.
 7. (VA#) DENOTES EXISTING ELEVATION PER ODOT PROVIDED POINTS FOR REFERENCE ONLY. FIELD VERIFY ALL LAYOUT PER ITEM 623 PRIOR TO BEGINNING PAVEMENT WORK.
 8. VARIATION BETWEEN DEPICTED LINWORK & POINTS IS DUE TO DIFFERENCE IN PROVIDED POINTS & CAGIS LINWORK.

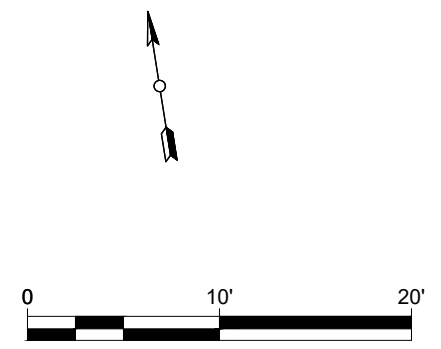

T R7-8 (MUTCD) T R7-8 (VAN) (MUTCD)

DESIGN AGENCY	RM
DESIGNER	RM
REVIEWER	RM
PROJECT ID	06-01-23
SHEET	117816
TOTAL	
P.17	19

N: 403421.22
E: 1376717.25

APPROX. CENTER OF
40' RADIUS PER
ODOT POINTS

R7-8
(VAN)
(MUTCD)

R7-8
(MUTCD)

MATCH EXIST.
CONCRETE
ELEVATION

RIVER BIRCH AREA

ADA GRADING NOTES:

1. PROVIDE 1.9% MAX. SLOPE IN ALL DIRECTIONS IN ADA PARKING STALLS
2. PROVIDE 4.9% MAX. LONGITUDINAL SLOPE ALONG ADA ACCESSIBLE ROUTE (WALKS)
3. PROVIDE 1.9% MAX. CROSS SLOPE ALONG ADA ACCESSIBLE ROUTE (WALKS)
4. PROVIDE VARIABLE DEPTH SURFACE OVERLAY TO ACHIEVE PROPER SLOPES, 1.5" MIN. DEPTH
5. MATCH NEW FINISHED GRADE ELEVATION AT ADJACENT PAVEMENT.
6. (-) NEGATIVE SIGN DENOTES SLOPING DOWNWARD IN DIRECTION OF ARROW.
7. (VA#) DENOTES EXISTING ELEVATION PER ODOT PROVIDED POINTS FOR REFERENCE ONLY. FIELD VERIFY ALL LAYOUT PER ITEM 623 PRIOR TO BEGINNING PAVEMENT WORK.
8. VARIATION BETWEEN DEPICTED LINWORK & POINTS IS DUE TO DIFFERENCE IN PROVIDED POINTS & CAGIS LINWORK.

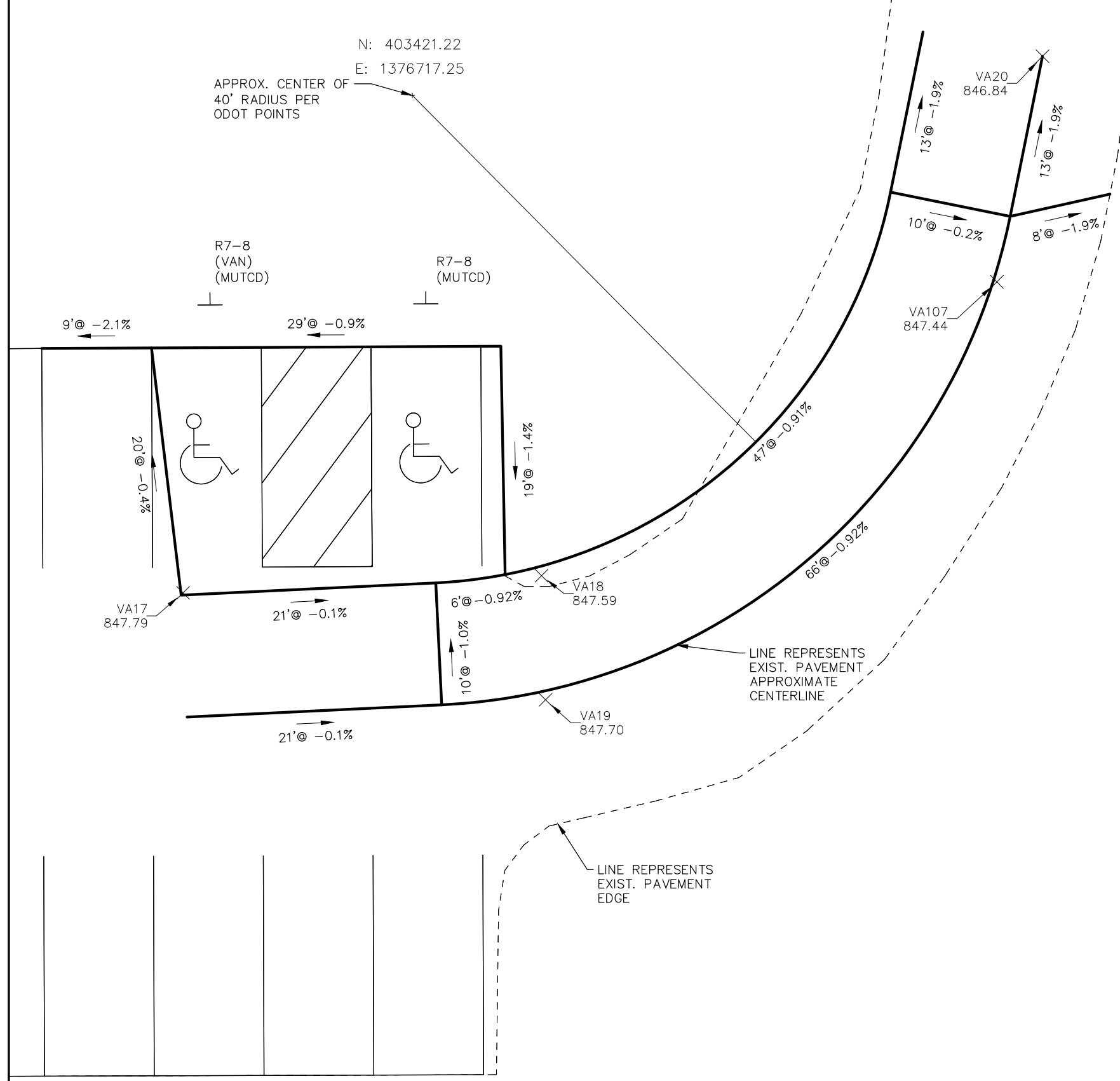

THE LAST TWO STALL AREAS REQUIRE CONSTRUCTING NEW ELEVATION APPROX. 1' TO 2' HIGHER THAN EXIST. ELEVATION. GRADE/RESHAPE GRASS BEYOND PAVEMENT 4H:1V SLOPE (3H:1V MAX)

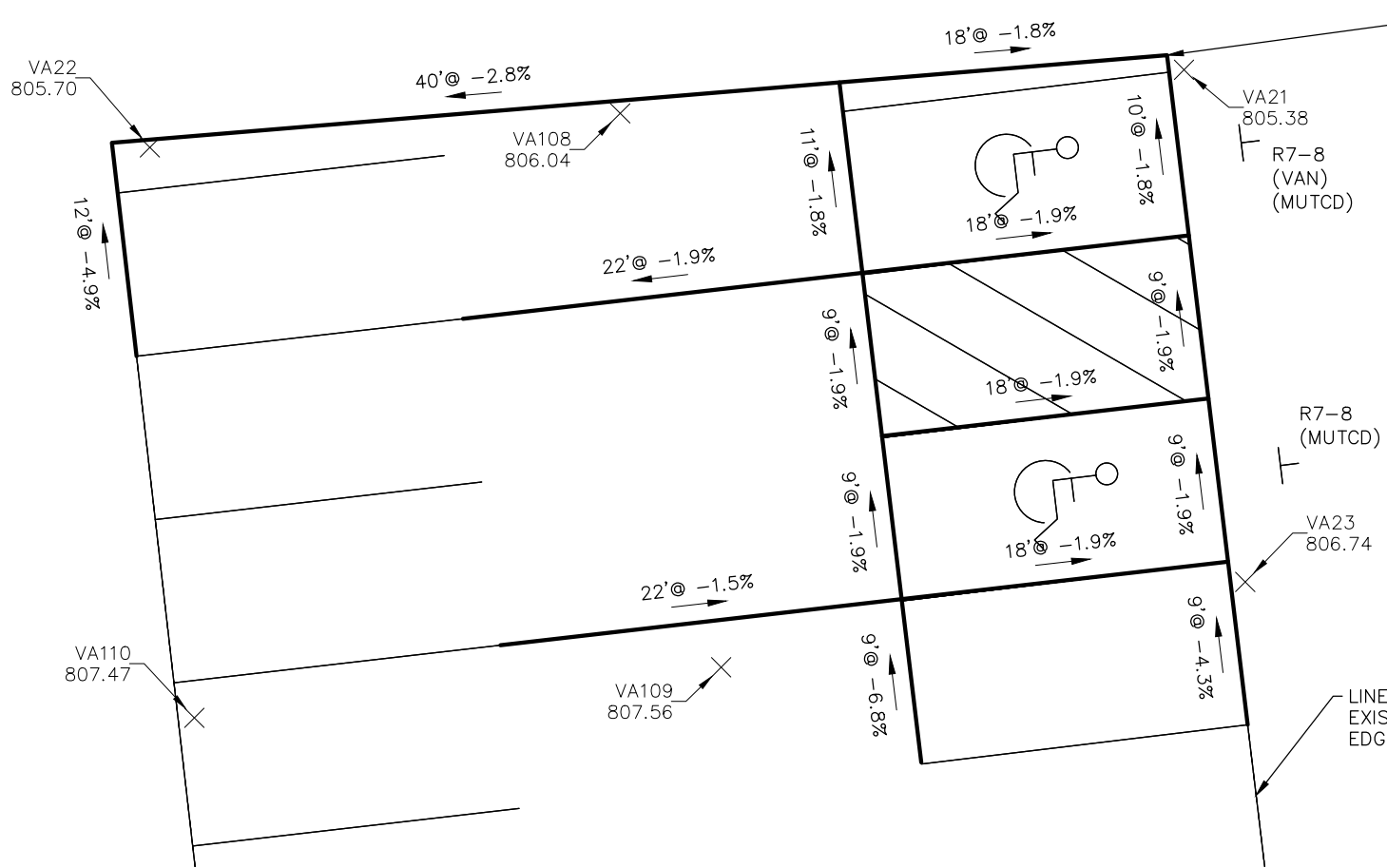

HORSESHOE HAVEN AREA

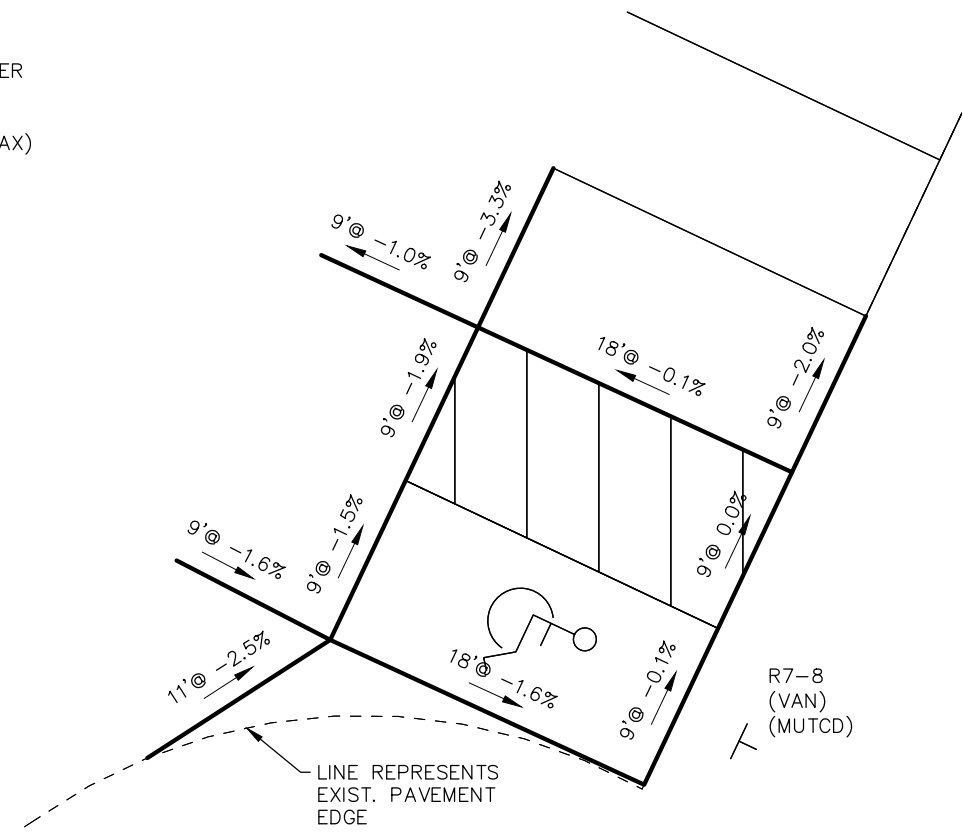

MOSSYCUP AREA

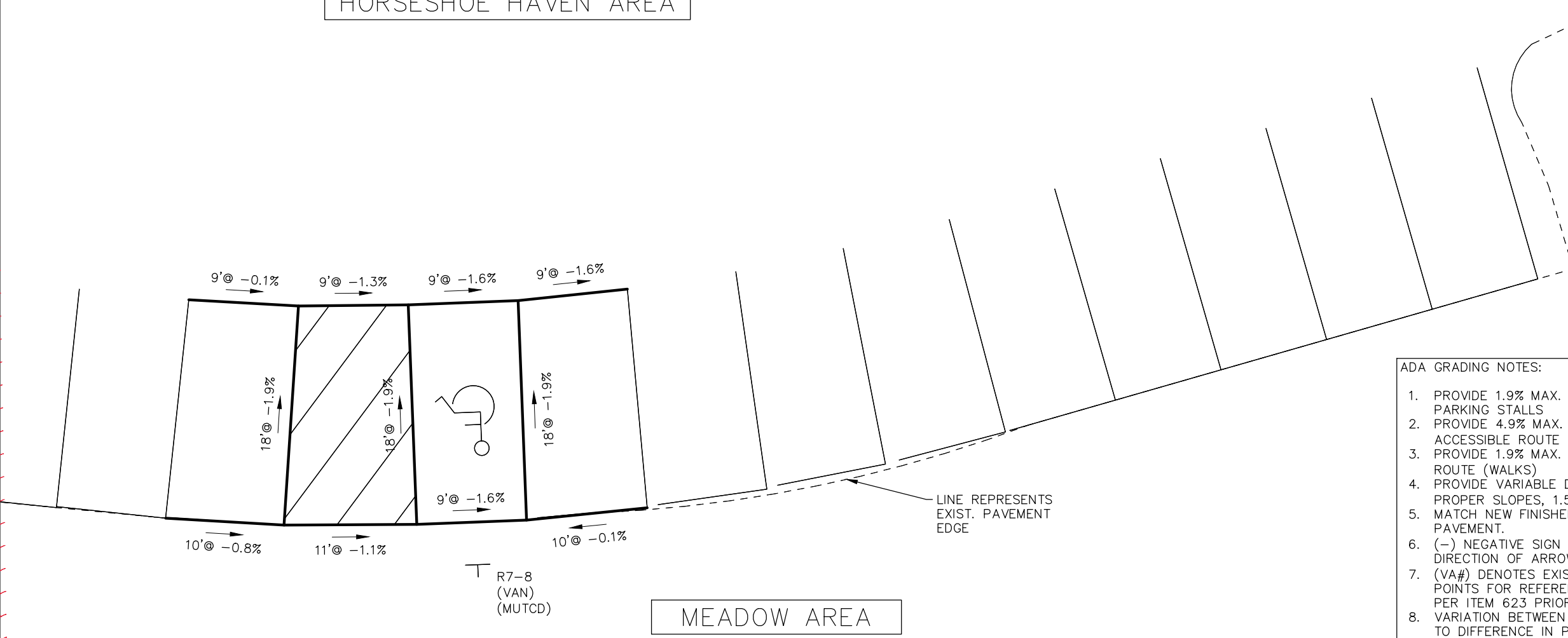
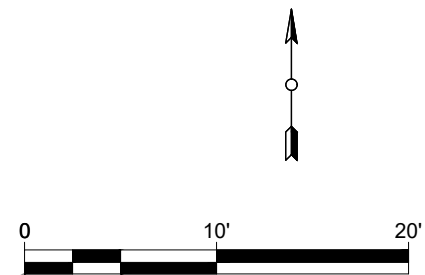

MEADOW AREA

- ADA GRADING NOTES:
1. PROVIDE 1.9% MAX. SLOPE IN ALL DIRECTIONS IN ADA PARKING STALLS
 2. PROVIDE 4.9% MAX. LONGITUDINAL SLOPE ALONG ADA ACCESSIBLE ROUTE (WALKS)
 3. PROVIDE 1.9% MAX. CROSS SLOPE ALONG ADA ACCESSIBLE ROUTE (WALKS)
 4. PROVIDE VARIABLE DEPTH SURFACE OVERLAY TO ACHIEVE PROPER SLOPES, 1.5" MIN. DEPTH
 5. MATCH NEW FINISHED GRADE ELEVATION AT ADJACENT PAVEMENT.
 6. (-) NEGATIVE SIGN DENOTES SLOPING DOWNWARD IN DIRECTION OF ARROW.
 7. (VA#) DENOTES EXISTING ELEVATION PER ODOT PROVIDED POINTS FOR REFERENCE ONLY. FIELD VERIFY ALL LAYOUT PER ITEM 623 PRIOR TO BEGINNING PAVEMENT WORK.
 8. VARIATION BETWEEN DEPICTED LINWORK & POINTS IS DUE TO DIFFERENCE IN PROVIDED POINTS & CAGIS LINWORK.

DESIGN AGENCY	Great Parks
DESIGNER	RM
REVIEWER	RM 06-01-23
PROJECT ID	117816
SHEET	TOTAL
P.19	19