

1.78 MILES WEST OF WINTERSVILLE

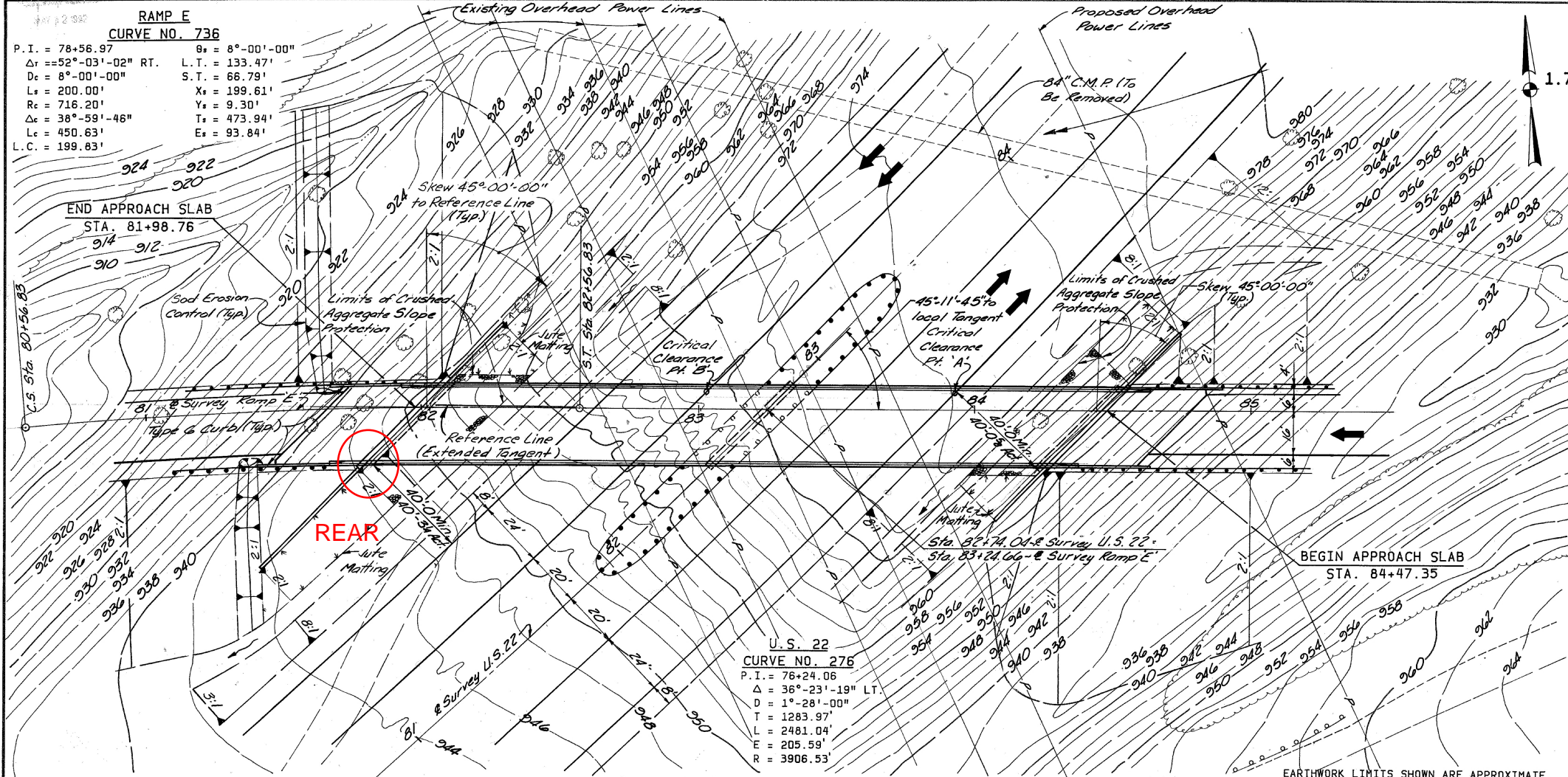

B.M. 2A ELEV 344.40
 Sta. 81+80 - 130' R/L
 Mine spike in 5' Elm,
 25'± N of U.S. 22 and
 450'± N.E. of C.R. 22A

DESIGN DESIGNATION

1985 ADT	4104
2005 ADT	4988
2005 ADTT	200

NOTE: ALL PILING TO BE HP 10X42 PILES
 ESTIMATED AVERAGE PILE LENGTH:
 REAR ABUTMENT ----- 40'
 FWD. ABUTMENT ----- 20'
 PIER ----- 15'

PROPOSED STRUCTURE

TYPE: CONTINUOUS COMPOSITE STEEL GIRDERS WITH REINFORCED CONCRETE DECK AND SUBSTRUCTURE UNITS.
 SPANS: 122.69'-119.5' MEASURED ALONG OF SURVEY
 ROADWAY: 28'-0" F/F PARAPETS
 SKEW: 45°-00' L.F.
 SURFACE COURSE: MONOLITHIC CONCRETE
 LIVE LOAD: HS20-44 CASE II AND THE ALTERNATE MILITARY LOADING
 APPROACH SLABS: A5-1-81, 30' LONG
 ALIGNMENT: SPIRAL AND TANGENT
 SUPERELEVATION: 0.0283 '/(MAX.)

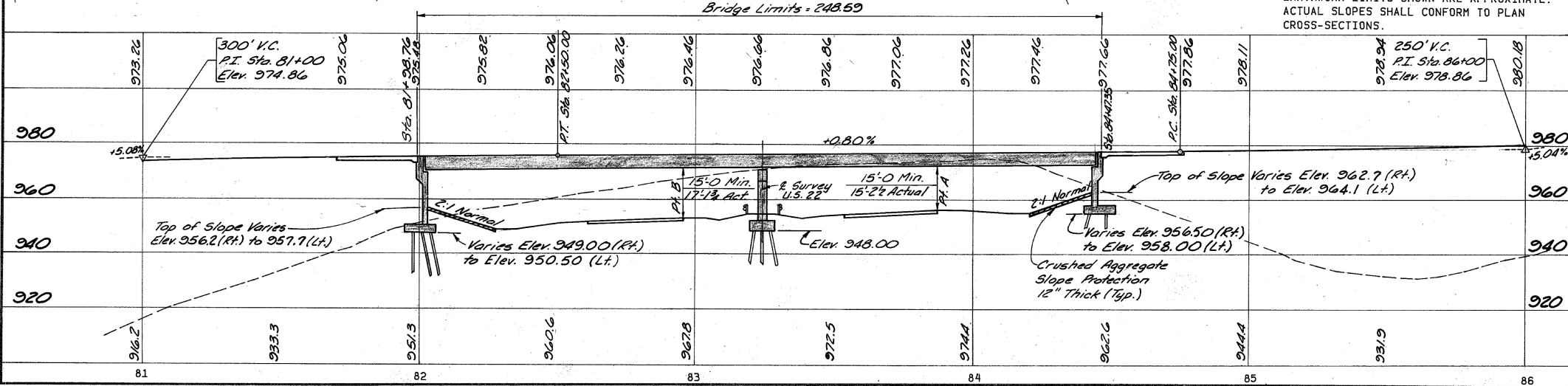

SHEET 1 / 28
 W.E. QUICKSALL AND ASSOCIATES, INC.
 NEW PHILADELPHIA, OHIO

SITE PLAN
 BRIDGE NO. JEF-22-0761
 RAMP 'E' OVER U.S. 22

EXIST. TOPO	PROPOSED
SURVEY DRAWN	DESIGN CHECKED
W.E.Q. FDH	FDH WLS wls 7/05