

JEF-22-13.85  
JEFFERSON COUNTY

**BASELINE CURVE DATA**

PI. STA. 75+24.44  
 $\Delta S = 36^\circ 38' 38.5"$   
 $E_s = 6'$   
 $L_s = 200'$   
 $T_s = 416.45'$   
 $E_s = 50.99'$   
 $R_c = 954.93'$   
 $LT = 133.41'$   
 $ST = 66.74'$

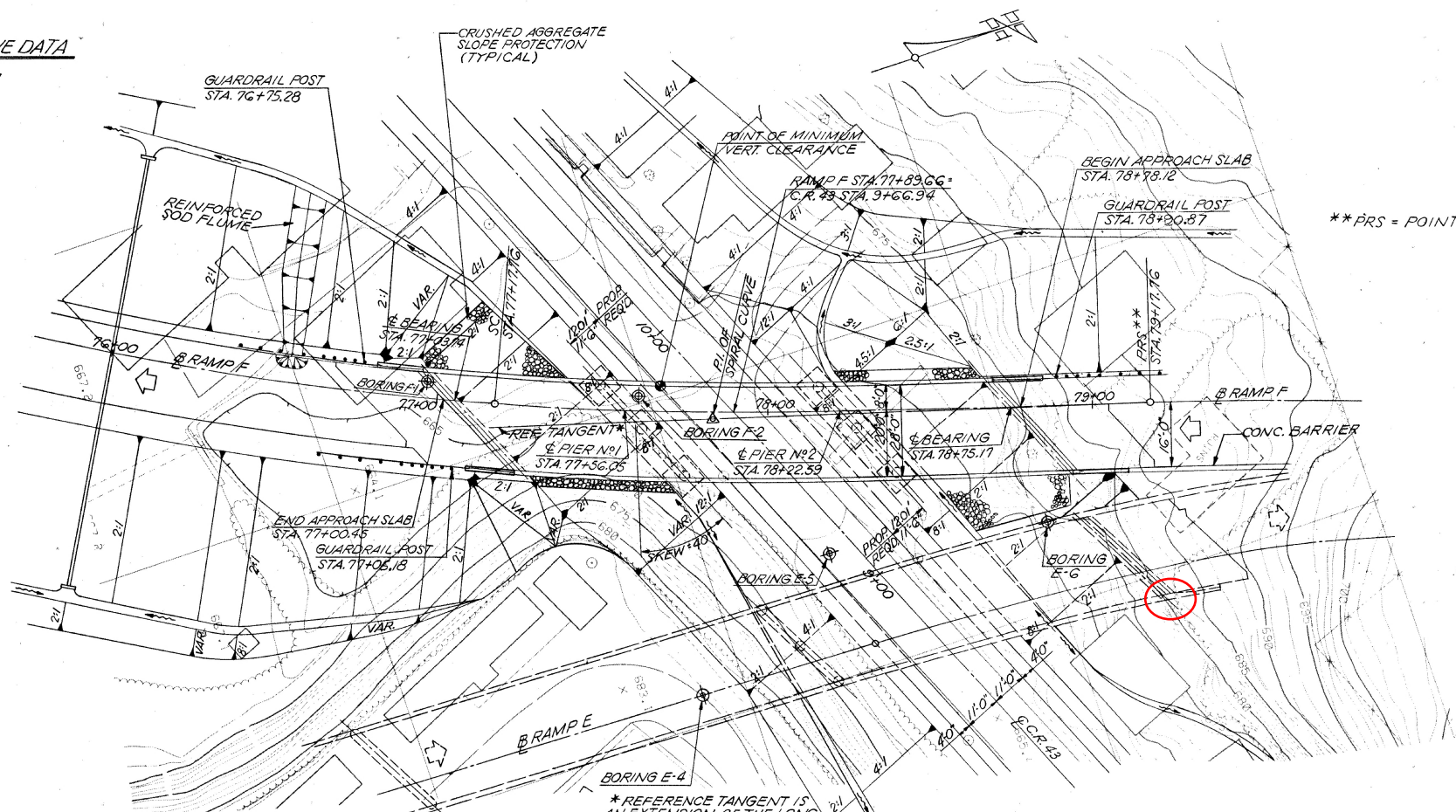

\*\* PRS = POINT OF REVERSE SPIRAL.

\* REFERENCE TANGENT IS AN EXTENSION OF THE LONG TANGENT OF THE SPIRAL CURVE WITH ITS P.I. AT STA. 77+84.35.

NOTE: ESTIMATED PILE LENGTHS FOR  
 HP 10X42 PILES IS:  
 REAR ABUTMENT = 45'-0"  
 PIER NO. 1 = 30'-0"  
 PIER NO. 2 = 30'-0"  
 FWD. ABUTMENT = 45'-0"

**PROPOSED STRUCTURE**  
 TYPE: CONTINUOUS COMPOSITE STEEL BEAMS (A572-50 PAINTED) WITH CONCRETE PIERS AND STUB ABUTMENTS.  
 SPANS: 46'-0", 64'-0" AND 52'-0" (ON REF TANGENT)  
 ROADWAY: 28'-0" TOE TO TOE OF BARRIER.  
 SKEW: 40°-00'-00" R.F. (TO REFERENCE TANGENT)  
 DESIGN LOADING: HS20-44 CASE II AND ALTERNATE MILITARY LOADING.  
 APPROACH SLAB: 45'-1-81 (25'-0" LONG)  
 ALIGNMENT: 6° SPIRAL LT.  
 SUPERELEVATION: VARIES (0.003 FT/FT. MAX.)  
 WEARING SURFACE: 1" MONOLITHIC CONCRETE  
 AVERAGE DAILY TRAFFIC: 3000 (2005)  
 AVERAGE DAILY TRUCK TRAFFIC: 150 (2005)

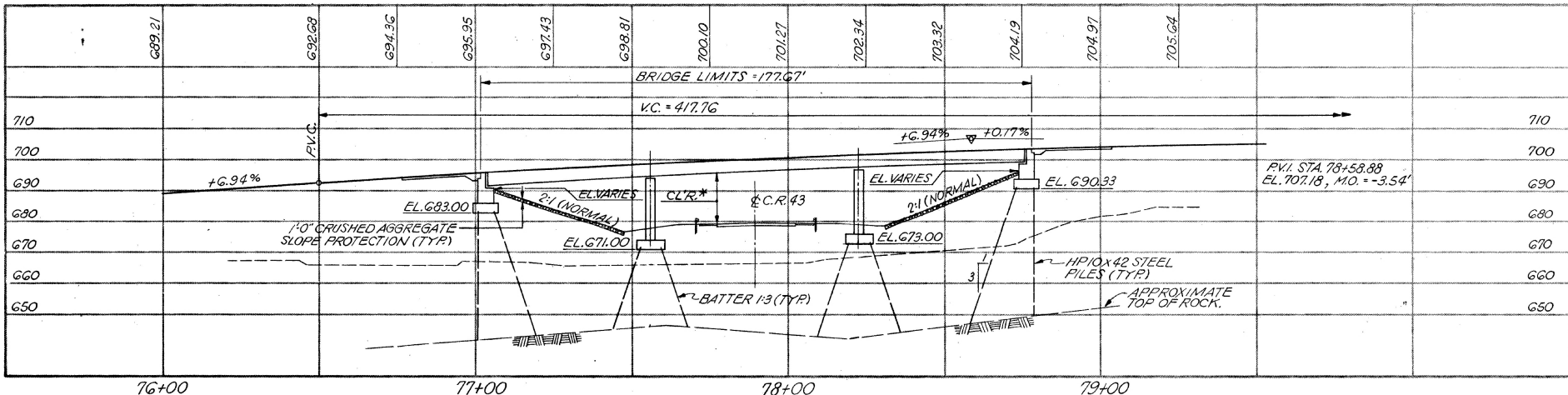

\* REQ'D. MIN. CLR. = 14.5'  
 PROP. MIN. CLR. = 16.91'

NOTE: EARTHWORK LIMITS SHOWN ARE APPROXIMATE. ACTUAL SLOPES SHALL CONFORM TO PLAN CROSS-SECTIONS.

MOSURE AND SYRAKIS CO.  
YOUNGSTOWN, OHIO

**SITE PLAN**  
BRIDGE NO. JEF-22-1483  
RAMP F  
OVER  
EXISTING C.R. 43 STA. 77+00.45  
JEFFERSON COUNTY, OHIO STA. 78+78.12

DESIGNED	DRAWN	CALC.	CHECKED	REVIEWED
A.C.	J.M.O.	A.C.	W.H.	D.S.
8-87	8-87	8-87	9-87	11-89