

O.D.O.T. DISTRICT 2 SURVEY OFFICE (USE ONLY)

PERSONNEL

REFERENCE NO. 33 A

SHEET 10 OF 15

NOTES NUHFER

DATE 8/14/07

ROUTE US 20

H.C. HUSS

WEATHER CLOUDY

COUNTY LUCAS

R.C. MOSER

TEMP. 70°

TOWNSHIP SYLVANIA

DWG BY MILLER PID 102808

SECTION 21

T 9 N R 6 E

TYPE MONUMENT MONBOX W/3/4" IPIN

ON SURFACE - ~~BELOW~~ ON

OFFSET 0 PAVEMENT 17.8' LT : ~~RT~~

22.1' TO LT EDGE PAVEMENT

STATION: 463+00

HORZ. DATUM: NAD83(2011)

GEOID: 2012A

GRID: NORTHING: 733712.184

EASTING: 1638054.421

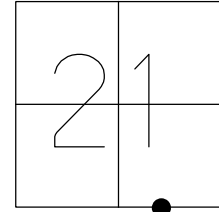

RES. #6953

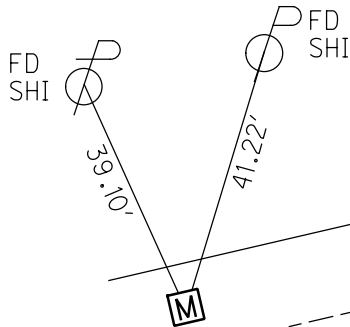

☒ PERCENTUM RD

☒ SEQUOIA RD

☒ US 20

RECORD:
 FD MONBOX
 W/ 1" IPIN
 7-08-98, CAL
 FD MONBOX
 W/3/4" IPIN
 REFA33
 4-24-18, JFO
 RAISED BOX
 10-1-18, JFO

O.D.O.T. DISTRICT 2 SURVEY OFFICE (USE ONLY)

PERSONNEL

REFERENCE NO. 34

SHEET 11 OF 15

NOTES NUHFER
 H.C. HUSS
 R.C. MOSER

DATE 8/14/07
 WEATHER CLOUDY
 TEMP. 70°

ROUTE US 20
 COUNTY LUCAS
 TOWNSHIP SYLVANIA
 SECTION 21
 T 9 N R 6 E

DWG BY MILLER PID 102808

TYPE MONUMENT 5/8" IPIN MONBOX

ON SURFACE - ~~BELOW~~ ON

OFFSET C PAVEMENT 17.8' LT : ~~RT~~

22.1' TO LT EDGE PAVEMENT

STATION: 464+23

HORZ. DATUM: NAD83(2011)

GEOID: 2012A

GRID: NORTHING: 733737.228

EASTING: 1638174.204

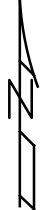
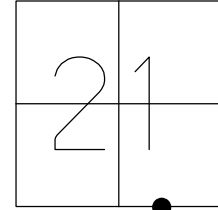

RECORD:
 FD MONBOX
 W/ 5/8" IPIN
 7-08-98, CAL
 FD MONBOX
 W/ 5/8" IPIN
 REF34
 4-24-18, JFO
 RAISED BOX
 10-1-18, JFO

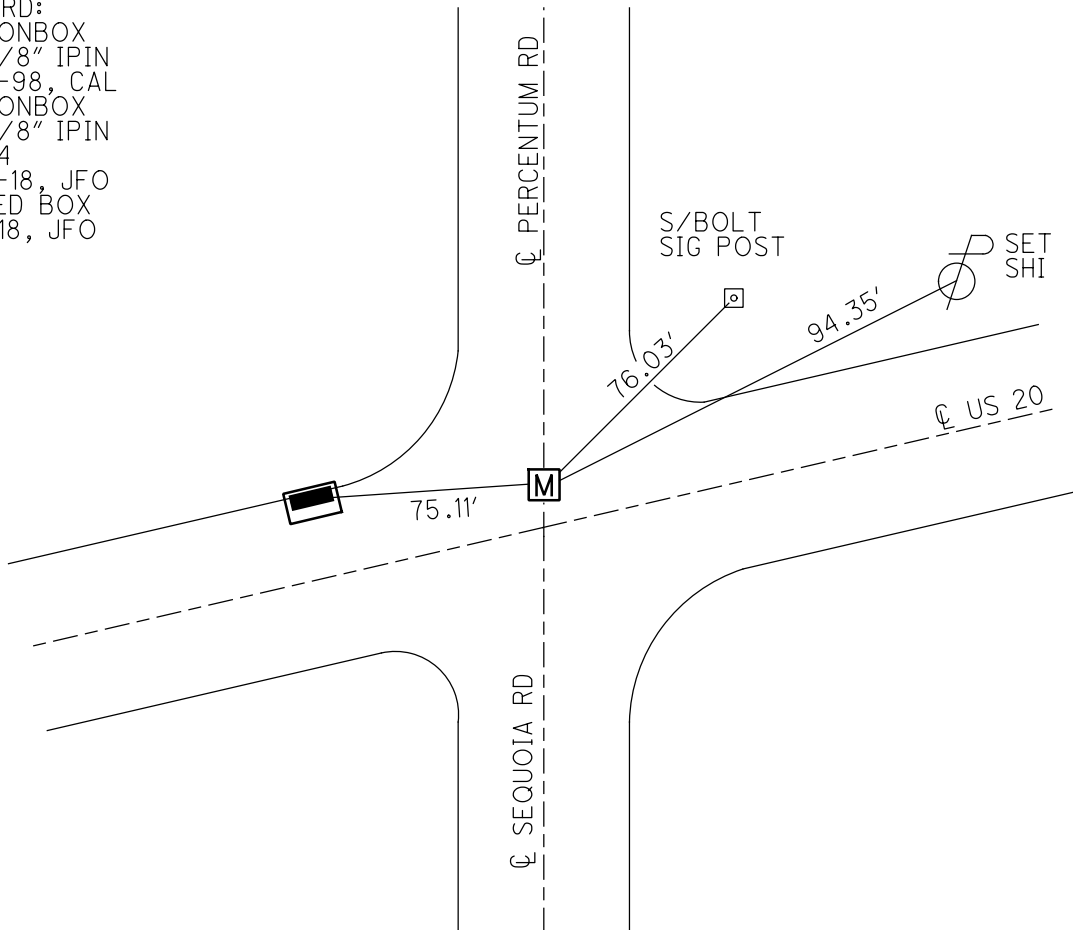

O.D.O.T. DISTRICT 2 SURVEY OFFICE (USE ONLY)

PERSONNEL

REFERENCE NO. 35

SHEET 15 OF 15

NOTES LOEHRKE

DATE 7/8/98

ROUTE US 20

H.C. HUSS

WEATHER HUMID

COUNTY LUCAS

R.C. CANTERBURY

TEMP. 78°

TOWNSHIP SYLVANIA

SECTION 21

DWG BY MILLER

PID 88252

T 9 N R 6 E

TYPE MONUMENT MONBOX

ON SURFACE - ~~BELOW~~ ON

OFFSET Q PAVEMENT 25' LT : ~~RT~~

- TO - EDGE PAVEMENT

STATION: 481+12

HORZ.DATUM: NAD83(2011)

GEOID: 2012A

GRID: NORTHING: 734083.475

EASTING: 1639828.110

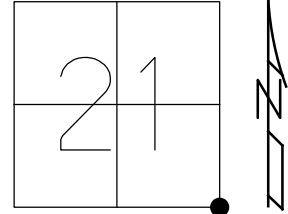

RECORD:
FD MONBOX
W/ 1" IPIN
REF35
7-23-15, JFO

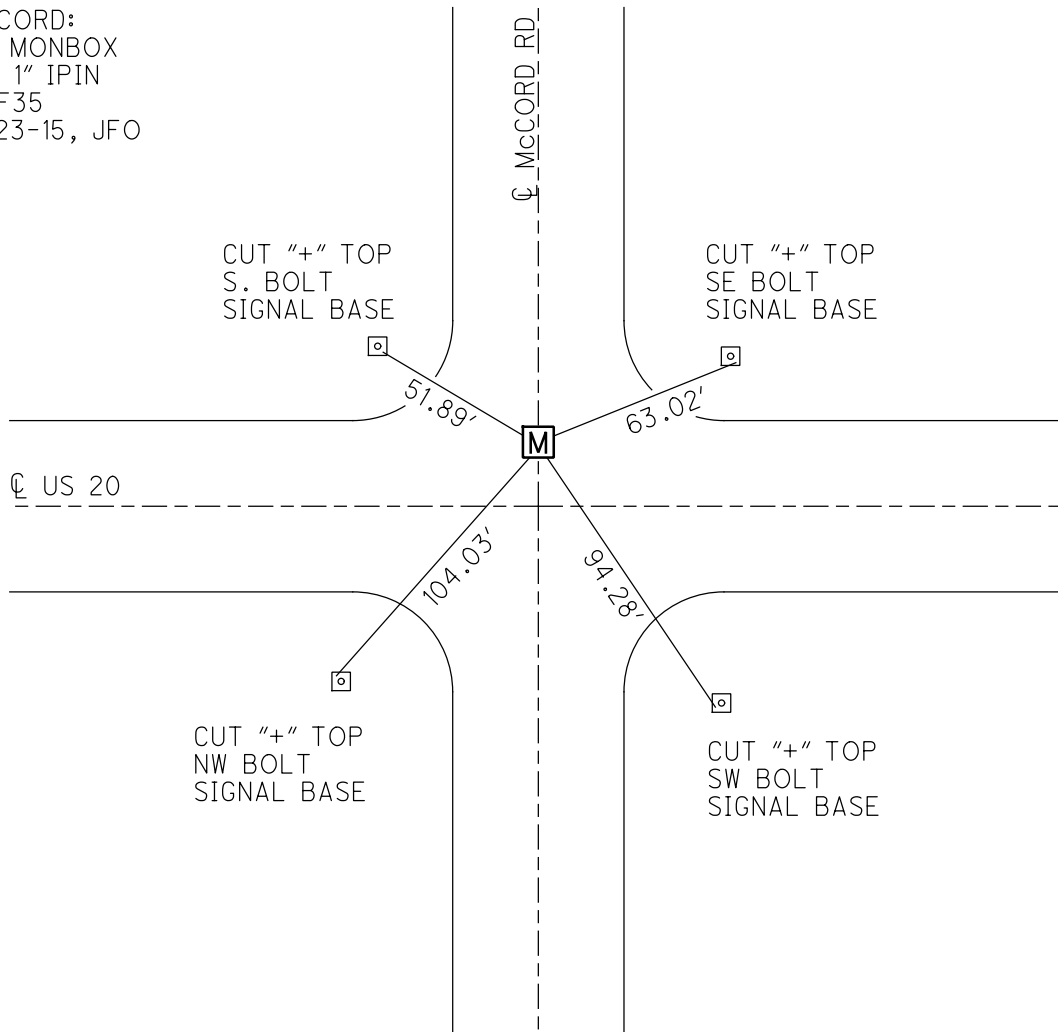

O.D.O.T. DISTRICT 2 SURVEY OFFICE

PERSONNEL _____

REFERENCE NO. 36

SHEET 23 OF 27

NOTES LOEHRKE

H.C. CANTERBURY

DATE 7-8-98

ROUTE U.S. 20

R.C. HELM

WEATHER HUMID

COUNTY LUCAS

TEMP. +82

TOWNSHIP SYLVANIA

SECTION 20

T. _____ R. _____

TYPE MONUMENT Mon Box

ON SURFACE - ~~BELOW~~ Yes

~~LEFT - & PAVT. - RIGHT~~ Yes - & Both

~~± 44.5 TO Rt EDGE PAVEMENT CURB~~

S.L.M. 484+71 ±350' East of McCord Rd.

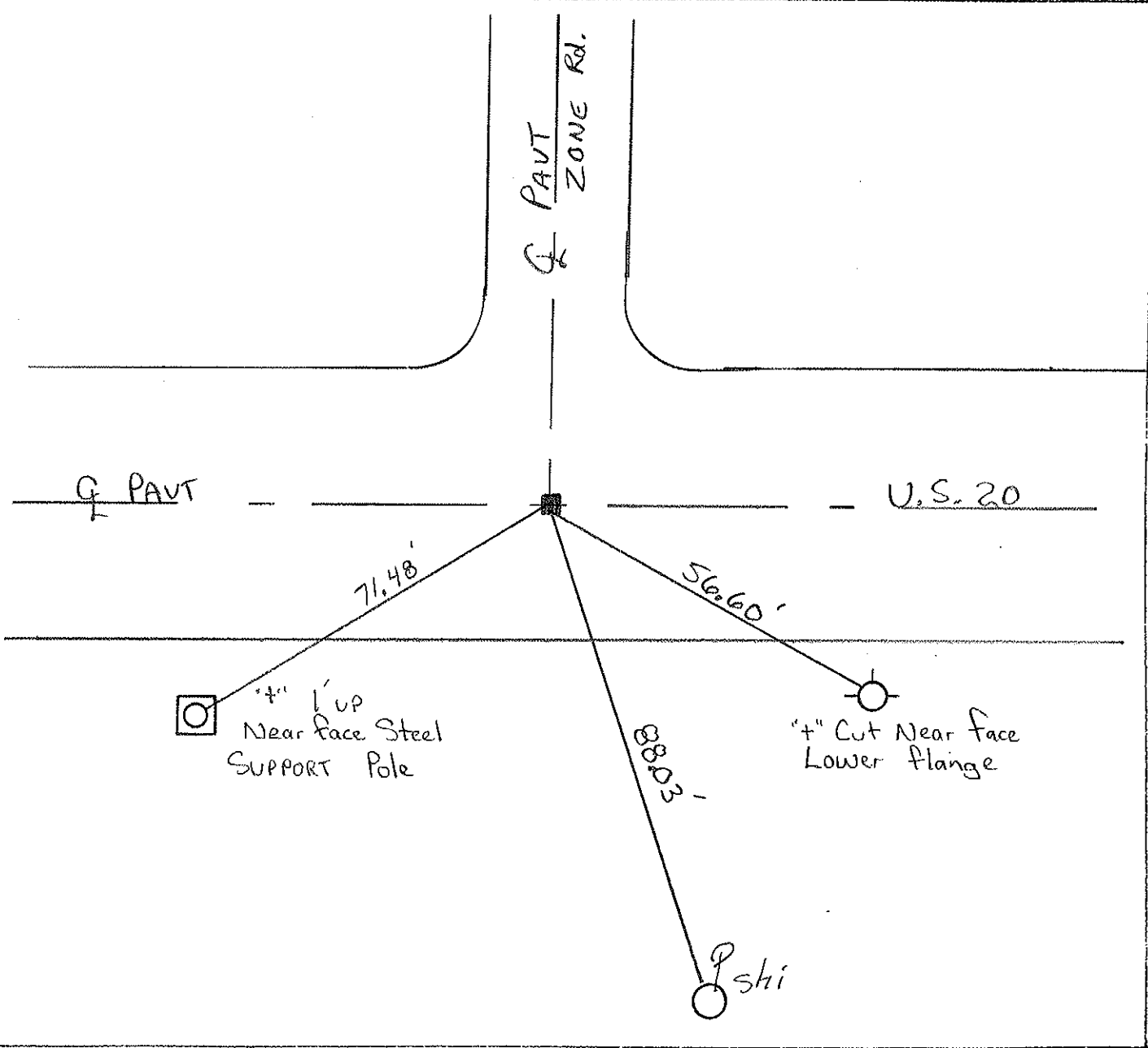
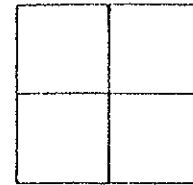

O.D.O.T. DISTRICT 2 SURVEY OFFICE

PERSONNEL

REFERENCE NO. 37

SHEET 24 OF 27

NOTES LOEHRKE

H.C. CANTERBURY

DATE 7-8-98

ROUTE U.S. 20

R.C. HELM

WEATHER Humid

COUNTY LUCAS

TEMP. +82

TOWNSHIP SYLVANIA

SECTION _____

T _____ R _____

TYPE MONUMENT MON Box - Possible P.T.

~~ON~~ SURFACE - BELOW Yes

~~LEFT~~ - PAV'T. - ~~RIGHT~~ Yes

40' TO LT CURB ~~EDGE~~ PAVEMENT

S.L.M. 486+95

