

LUC-24-26.41

MODEL: Sheet PAPER SIZE: 17x11 (in.) DATE: 4/26/2021 TIME: 2:10:24 PM USER: JeffHe S:\CIN\3500--3599\3599\020\Drawings\CAD\111022\400-Engineering\Roadway\Sheets\111022_GS003.dgn

STATION RANGE OR REFERENCE NO.			SHEET NO.	SIDE	DISTANCE (D)	AVERAGE WIDTH (W)	CADD GENERATED AREA	202	204	254	254	301	304	407	442	442	609	609												
					FT	FT	SQ YD	SQ YD	SQ YD	SQ YD	SQ YD	SQ YD	SQ YD	CU YD	CU YD	GAL	CU YD	CU YD	SQ YD	SQ FT										
1439+60	TO	1442+74	29	LT/RT	314.02	47.21	2990.29																							
104+80	TO	109+00	29	RT	420.00	26.85	1253.13	1276	1855			211	389	129	56	62	115	1333												
105+77	TO	106+54	29	LT	77.25	4.00	79.21	187	146			14	32	8	4	4														
1442+04	TO	1442+74	29	LT	70.39	23.86	186.60	56	269			38	60	20	9	10	31													
1440+30	TO	1440+74	29	LT/RT	43.60	4.00	51.19	152	160			14	36	7	5	3														
1442+00	TO	1442+47	29	LT/RT	47.00	4.00	53.53	175	181			15	40	8	5	3														
29+82	TO	31+22	29	LT/RT	140.74	4.00	103.95	215	308			23	54	12	6	6														
1442+74	TO	1444+56	30	LT/RT	182.24	95.24	1928.47	402	867	822		125	194	137	65	34	30													
	SW-3		29	LT/RT	52.82	10.00	527.02						17																	
	SW-4		29	LT/RT	47.37	10.00	482.57						16																	
TOTALS CARRIED TO GENERAL SUMMARY								2463	3786	3403	439	439	838	528	258	122	176	4885												

PAVEMENT SUBSUMMARY

DESIGN AGENCY

STRAND ASSOCIATES

DESIGNER
CJR

REVIEWER
JCH 01/14/21

PROJECT ID
111022

SHEET TOTAL
4 59

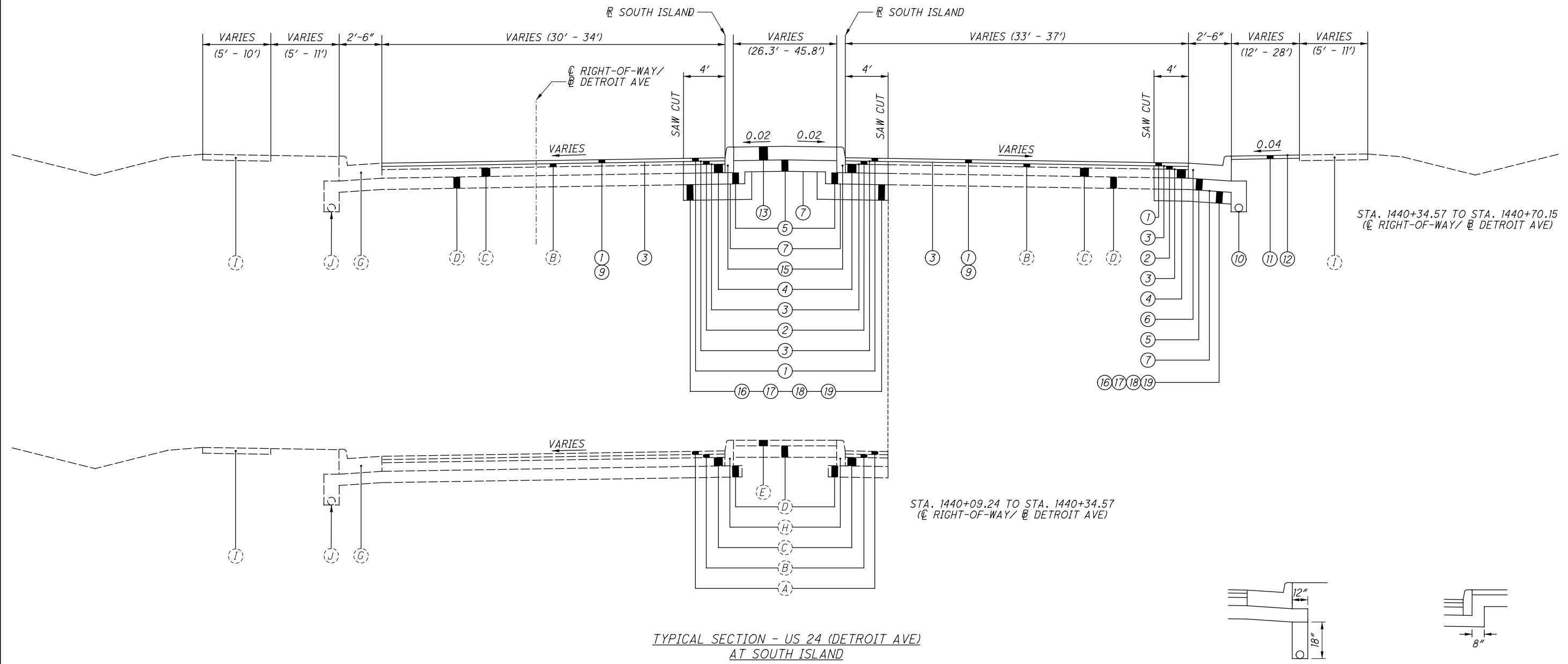

TYPICAL SECTION - US 24 (DETROIT AVE)
 AT SOUTH ISLAND

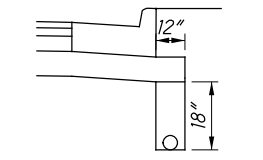

TYPICAL CURB AND GUTTER,
 TYPE 2 WITH UNDERDRAIN

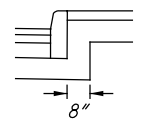

TYPICAL AGGREGATE BASE
 DETAIL BEHIND MEDIAN CURB

LEGEND

- | | | | | |
|---|--|--|--|---------------------------------|
| ① ITEM 442 - 1.50" ASPHALT CONCRETE SURFACE COURSE, 12.5mm, TYPE A (446) | ⑦ ITEM 204 - SUBGRADE COMPACTION | ⑬ ITEM 609 - MEDIAN, MISC.: PAVER ISLAND | ⑳ ITEM 608 - 6" CONCRETE WALK, AS PER PLAN | Ⓒ EX. CURB & GUTTER - CONCRETE |
| ② ITEM 442 - 1.75" ASPHALT CONCRETE INTERMEDIATE COURSE, 19mm, TYPE A (446) | ⑧ ITEM 608 - 4" CONCRETE WALK | ⑭ ITEM 609 - 4" CONCRETE TRAFFIC ISLAND, AS PER PLAN | Ⓐ EX. PAVEMENT - 1.5" ASPHALT | Ⓗ EX. CURB - CONCRETE |
| ③ ITEM 407 - NON-TRACKING TACK COAT | ⑨ ITEM 254 - 1.5" PAVEMENT PLANING, ASPHALT CONCRETE | ⑮ ITEM 609 - CURB, TYPE 6 | Ⓑ EX. PAVEMENT - 1.75" ASPHALT | Ⓘ EX. SIDEWALK - 4" CONCRETE |
| ④ ITEM 301 - 6" ASPHALT CONCRETE BASE, PG64-22 | ⑩ ITEM 605 - 6" BASE PIPE UNDERDRAINS WITH GEOTEXTILE FABRIC | ⑯ ITEM 204 - PROOF ROLLING | Ⓓ EX. PAVEMENT - 6" ASPHALT | Ⓝ EX. PIPE UNDERDRAIN - 6" PIPE |
| ⑤ ITEM 304 - 8" AGGREGATE BASE | ⑪ ITEM 653 - 4" TOPSOIL FURNISHED AND PLACED | ⑰ ITEM 204 - EXCAVATION OF SUBGRADE, AS PER PLAN | Ⓔ EX. PAVEMENT - 8" AGGREGATE BASE | Ⓚ EMBANKMENT |
| ⑥ ITEM 609 - CURB, MISC.: CITY OF TOLEDO CURB AND GUTTER TYPE B-1, MODIFIED | ⑫ ITEM 659 - SEEDING AND MULCHING | ⑱ ITEM 204 - GRANULAR MATERIAL, TYPE B, AS PER PLAN | Ⓕ EX. PAVEMENT - 4" NON-REINF. CONCRETE | Ⓛ EX. PAVER ISLAND |
| | | ⑲ ITEM 204 - GEOTEXTILE FACBRIC, AS PER PLAN | Ⓖ EX. PAVEMENT - 8" DECORATIVE REINF. CONCRETE | |

LUC-24-26.41

MODEL: Sheet PAPER SIZE: 11x17 (in.) DATE: 4/26/2021 TIME: 2:04:52 PM USER: Jeffrey He
 S:\CN\3500-3599\3589\2020 Drawings\CAD\11022\400-Engineering\Roadway\Sheets\11022.GY003.dgn

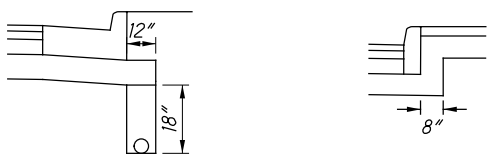
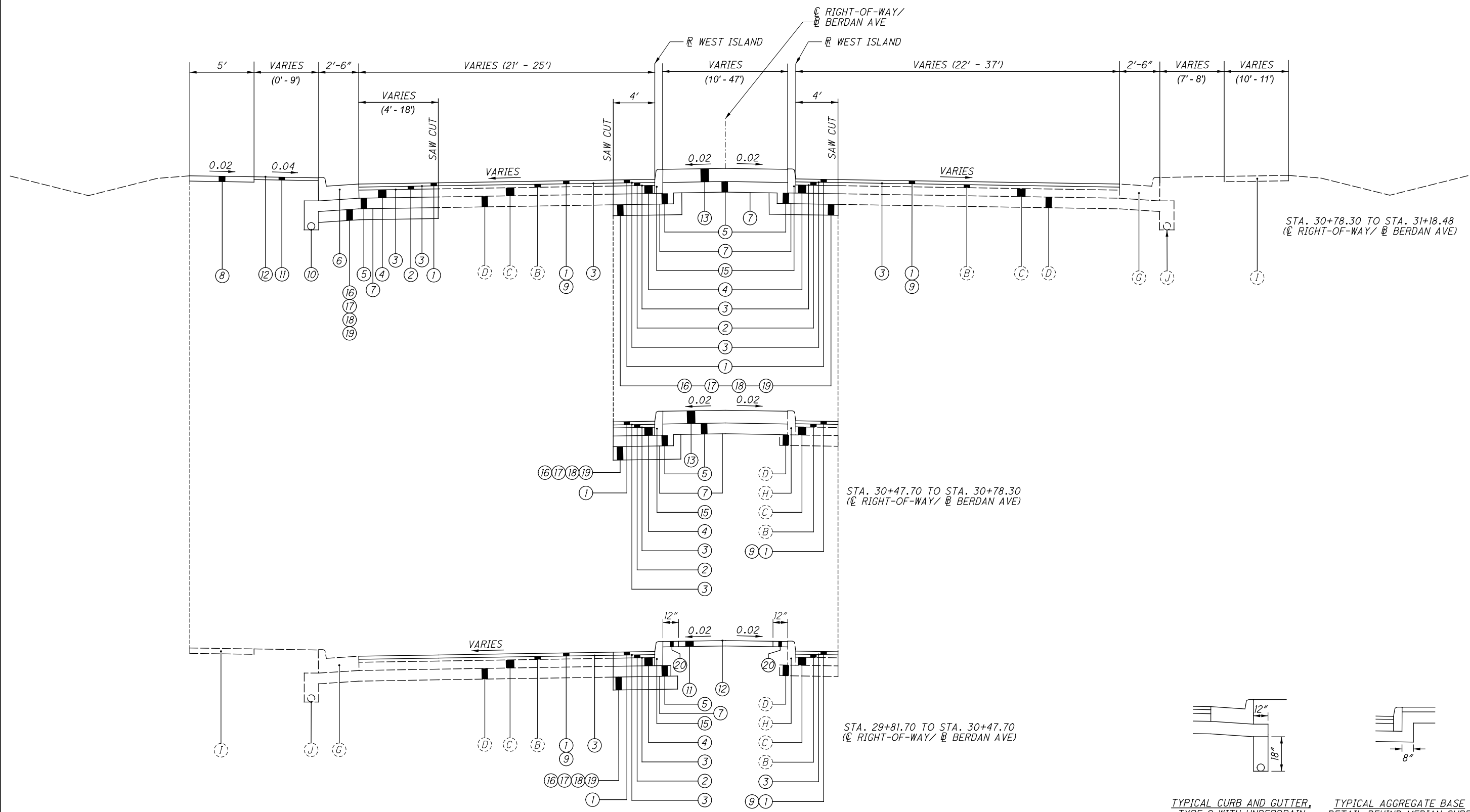

TYPICAL SECTION - BERDAN AVE AT WEST ISLAND

LEGEND

- | | | | | |
|---|---|---|--|-----------------------------------|
| (1) ITEM 442 - 1.50" ASPHALT CONCRETE SURFACE COURSE, 12.5mm, TYPE A (446) | (7) ITEM 204 - SUBGRADE COMPACTION | (13) ITEM 609 - MEDIAN, MISC.: PAVER ISLAND | (20) ITEM 608 - 6" CONCRETE WALK, AS PER PLAN | (G) EX. CURB & GUTTER - CONCRETE |
| (2) ITEM 442 - 1.75" ASPHALT CONCRETE INTERMEDIATE COURSE, 19mm, TYPE A (446) | (8) ITEM 608 - 4" CONCRETE WALK | (14) ITEM 609 - 4" CONCRETE TRAFFIC ISLAND, AS PER PLAN | (A) EX. PAVEMENT - 1.5" ASPHALT | (H) EX. CURB - CONCRETE |
| (3) ITEM 407 - NON-TRACKING TACK COAT | (9) ITEM 254 - 1.5" PAVEMENT PLANING, ASPHALT CONCRETE | (15) ITEM 609 - CURB, TYPE 6 | (B) EX. PAVEMENT - 1.75" ASPHALT | (I) EX. SIDEWALK - 4" CONCRETE |
| (4) ITEM 301 - 6" ASPHALT CONCRETE BASE, PG64-22 | (10) ITEM 605 - 6" BASE PIPE UNDERDRAINS WITH GEOTEXTILE FABRIC | (16) ITEM 204 - PROOF ROLLING | (C) EX. PAVEMENT - 6" ASPHALT | (J) EX. PIPE UNDERDRAIN - 6" PIPE |
| (5) ITEM 304 - 8" AGGREGATE BASE | (11) ITEM 653 - 4" TOPSOIL FURNISHED AND PLACED | (17) ITEM 204 - EXCAVATION OF SUBGRADE, AS PER PLAN | (D) EX. PAVEMENT - 8" AGGREGATE BASE | (K) EMBANKMENT |
| (6) ITEM 609 - CURB, MISC.: CITY OF TOLEDO CURB AND GUTTER TYPE B-1, MODIFIED | (12) ITEM 659 - SEEDING AND MULCHING | (18) ITEM 204 - GRANULAR MATERIAL, TYPE B, AS PER PLAN | (E) EX. PAVEMENT - 4" NON-REINF. CONCRETE | (L) EX. PAVER ISLAND |
| | | (19) ITEM 204 - GEOTEXTILE FACBRIC, AS PER PLAN | (F) EX. PAVEMENT - 8" DECORATIVE REINF. CONCRETE | |

TYPICAL SECTIONS - BERDAN AVE

DESIGN AGENCY

 DESIGNER
 CJR
 REVIEWER
 JCH 01/14/21
 PROJECT ID
 111022
 SHEET TOTAL
 7 59

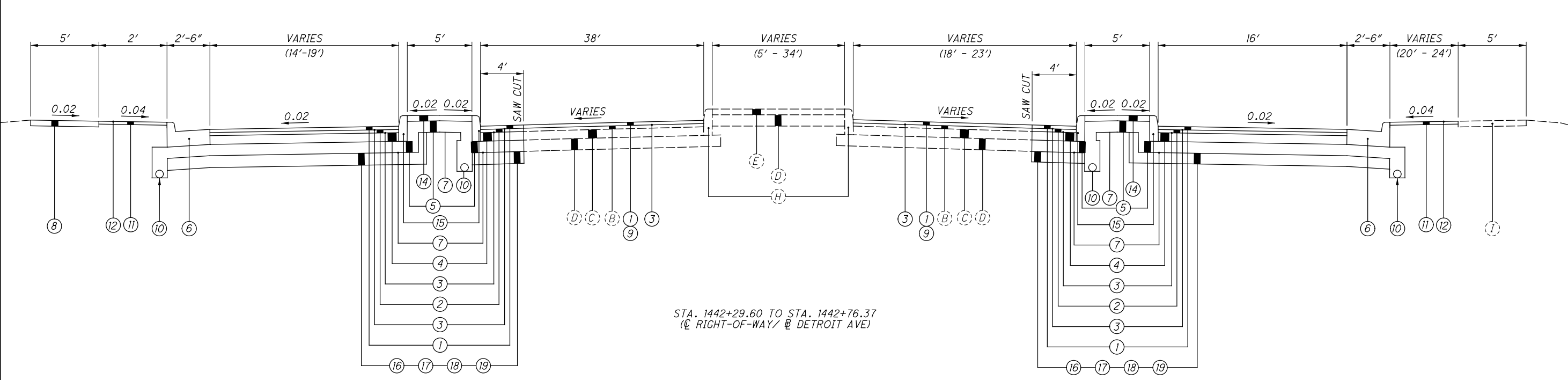

STA. 1442+29.60 TO STA. 1442+76.37
 (C RIGHT-OF-WAY/ B DETROIT AVE)

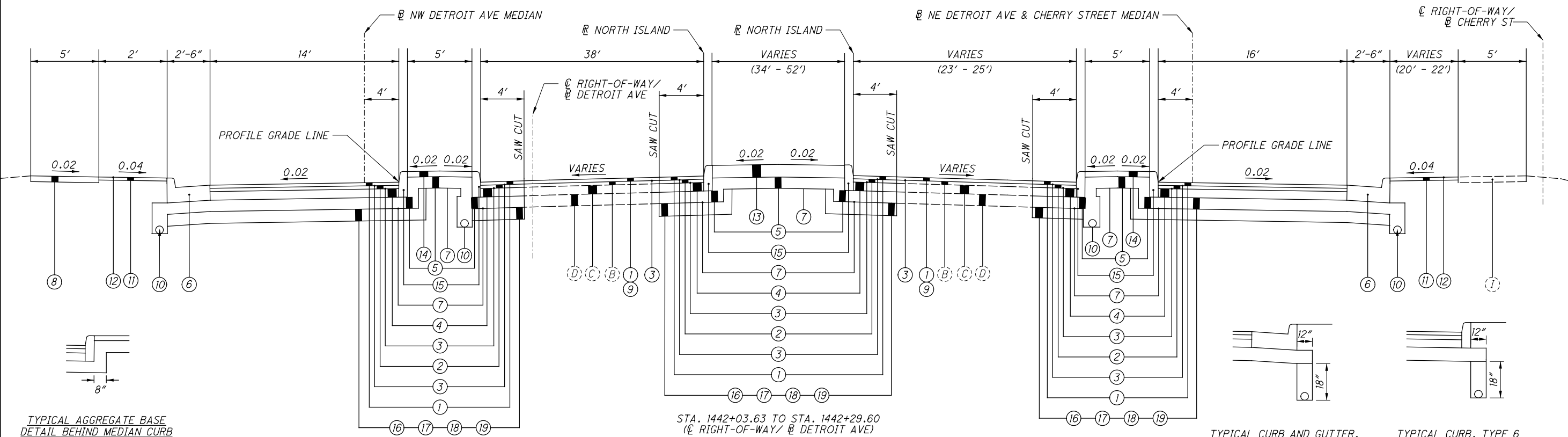

STA. 1442+03.63 TO STA. 1442+29.60
 (C RIGHT-OF-WAY/ B DETROIT AVE)
 TYPICAL SECTION - US 24 (DETROIT AVE)
 AT NORTH ISLAND

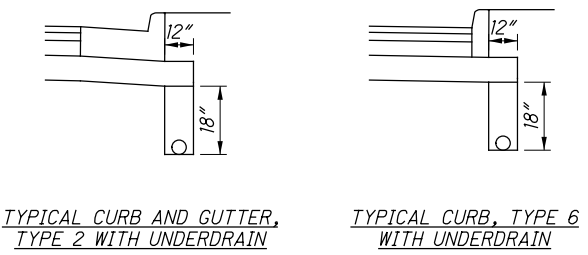

TYPICAL AGGREGATE BASE
 DETAIL BEHIND MEDIAN CURB

LEGEND

- | | | | | |
|---|---|---|--|-----------------------------------|
| (1) ITEM 442 - 1.50" ASPHALT CONCRETE SURFACE COURSE, 12.5mm, TYPE A (446) | (7) ITEM 204 - SUBGRADE COMPACTION | (13) ITEM 609 - MEDIAN, MISC.: PAVER ISLAND | (20) ITEM 608 - 6" CONCRETE WALK, AS PER PLAN | (G) EX. CURB & GUTTER - CONCRETE |
| (2) ITEM 442 - 1.75" ASPHALT CONCRETE INTERMEDIATE COURSE, 19mm, TYPE A (446) | (8) ITEM 608 - 4" CONCRETE WALK | (14) ITEM 609 - 4" CONCRETE TRAFFIC ISLAND, AS PER PLAN | (A) EX. PAVEMENT - 1.5" ASPHALT | (H) EX. CURB - CONCRETE |
| (3) ITEM 407 - NON-TRACKING TACK COAT | (9) ITEM 254 - 1.5" PAVEMENT PLANING, ASPHALT CONCRETE | (15) ITEM 609 - CURB, TYPE 6 | (B) EX. PAVEMENT - 1.75" ASPHALT | (I) EX. SIDEWALK - 4" CONCRETE |
| (4) ITEM 301 - 6" ASPHALT CONCRETE BASE, PG64-22 | (10) ITEM 605 - 6" BASE PIPE UNDERDRAINS WITH GEOTEXTILE FABRIC | (16) ITEM 204 - PROOF ROLLING | (C) EX. PAVEMENT - 6" ASPHALT | (J) EX. PIPE UNDERDRAIN - 6" PIPE |
| (5) ITEM 304 - 8" AGGREGATE BASE | (11) ITEM 653 - 4" TOPSOIL FURNISHED AND PLACED | (17) ITEM 204 - EXCAVATION OF SUBGRADE, AS PER PLAN | (D) EX. PAVEMENT - 8" AGGREGATE BASE | (K) EMBANKMENT |
| (6) ITEM 609 - CURB, MISC.: CITY OF TOLEDO CURB AND GUTTER TYPE B-1, MODIFIED | (12) ITEM 659 - SEEDING AND MULCHING | (18) ITEM 204 - GRANULAR MATERIAL, TYPE B, AS PER PLAN | (E) EX. PAVEMENT - 4" NON-REINF. CONCRETE | (L) EX. PAVER ISLAND |
| | | (19) ITEM 204 - GEOTEXTILE FACBRIC, AS PER PLAN | (F) EX. PAVEMENT - 8" DECORATIVE REINF. CONCRETE | |

LUC-24-26.41

MODEL: Sheet - PAPER SIZE: 11x17 (in.) DATE: 4/26/2021 TIME: 2:04:59 PM USER: JeffHe
 S:\CIN\3500-3599\3589\2020\Drawings\CAD\11022\400-Engineering\Roadway\Sheets\11022.GY005.dgn

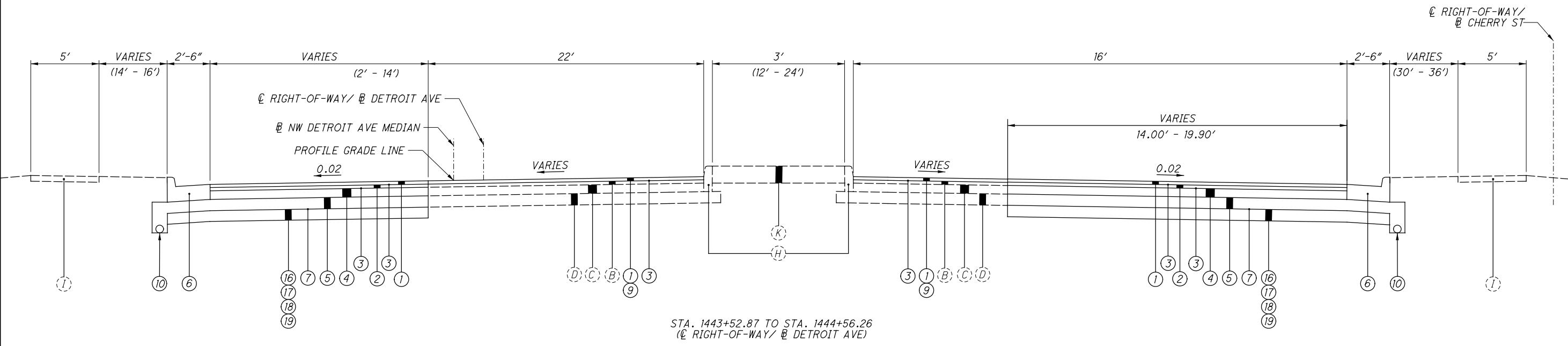

STA. 1443+52.87 TO STA. 1444+56.26
 (RIGHT-OF-WAY/ DETROIT AVE)

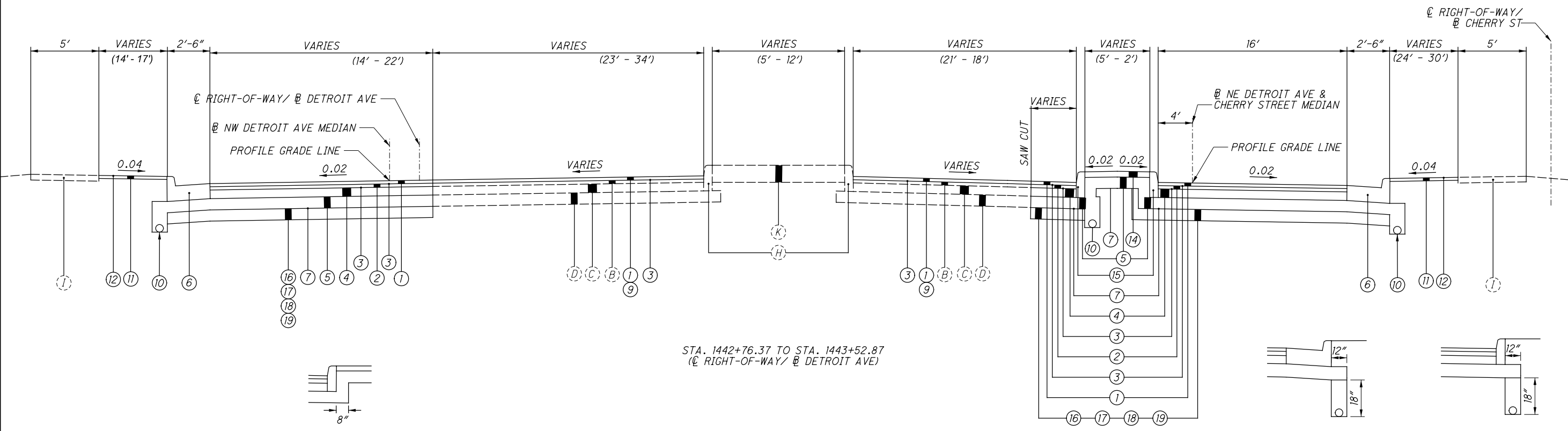

STA. 1442+76.37 TO STA. 1443+52.87
 (RIGHT-OF-WAY/ DETROIT AVE)

TYPICAL AGGREGATE BASE
 DETAIL BEHIND MEDIAN CURB

TYPICAL SECTION - US 24 (DETROIT AVE)
 AT NORTH ISLAND

TYPICAL CURB AND GUTTER,
 TYPE 2 WITH UNDERDRAIN

TYPICAL CURB, TYPE 6
 WITH UNDERDRAIN

LEGEND

- | | | | | |
|---|--|--|--|---------------------------------|
| ① ITEM 442 - 1.50" ASPHALT CONCRETE SURFACE COURSE, 12.5mm, TYPE A (446) | ⑦ ITEM 204 - SUBGRADE COMPACTION | ⑬ ITEM 609 - MEDIAN, MISC.: PAVER ISLAND | ⑳ ITEM 608 - 6" CONCRETE WALK, AS PER PLAN | ⓖ EX. CURB & GUTTER - CONCRETE |
| ② ITEM 442 - 1.75" ASPHALT CONCRETE INTERMEDIATE COURSE, 19mm, TYPE A (446) | ⑧ ITEM 608 - 4" CONCRETE WALK | ⑭ ITEM 609 - 4" CONCRETE TRAFFIC ISLAND, AS PER PLAN | ⓐ EX. PAVEMENT - 1.5" ASPHALT | ⓗ EX. CURB - CONCRETE |
| ③ ITEM 407 - NON-TRACKING TACK COAT | ⑨ ITEM 254 - 1.5" PAVEMENT PLANING, ASPHALT CONCRETE | ⑮ ITEM 609 - CURB, TYPE 6 | ⓑ EX. PAVEMENT - 1.75" ASPHALT | ⓓ EX. SIDEWALK - 4" CONCRETE |
| ④ ITEM 301 - 6" ASPHALT CONCRETE BASE, PG64-22 | ⑩ ITEM 605 - 6" BASE PIPE UNDERDRAINS WITH GEOTEXTILE FABRIC | ⑯ ITEM 204 - PROOF ROLLING | ⓒ EX. PAVEMENT - 6" ASPHALT | ⓔ EX. PIPE UNDERDRAIN - 6" PIPE |
| ⑤ ITEM 304 - 8" AGGREGATE BASE | ⑪ ITEM 653 - 4" TOPSOIL FURNISHED AND PLACED | ⑰ ITEM 204 - EXCAVATION OF SUBGRADE, AS PER PLAN | ⓓ EX. PAVEMENT - 8" AGGREGATE BASE | Ⓚ EMBANKMENT |
| ⑥ ITEM 609 - CURB, MISC.: CITY OF TOLEDO CURB AND GUTTER TYPE B-1, MODIFIED | ⑫ ITEM 659 - SEEDING AND MULCHING | ⑱ ITEM 204 - GRANULAR MATERIAL, TYPE B, AS PER PLAN | ⓔ EX. PAVEMENT - 4" NON-REINF. CONCRETE | Ⓛ EX. PAVER ISLAND |
| | | ⑲ ITEM 204 - GEOTEXTILE FACBRIC, AS PER PLAN | ⓕ EX. PAVEMENT - 8" DECORATIVE REINF. CONCRETE | |

TYPICAL SECTIONS - US 24 (DETROIT AVE)

DESIGN AGENCY

 DESIGNER
 CJR
 REVIEWER
 JCH 01/14/21
 PROJECT ID
 111022
 SHEET TOTAL
 9 59

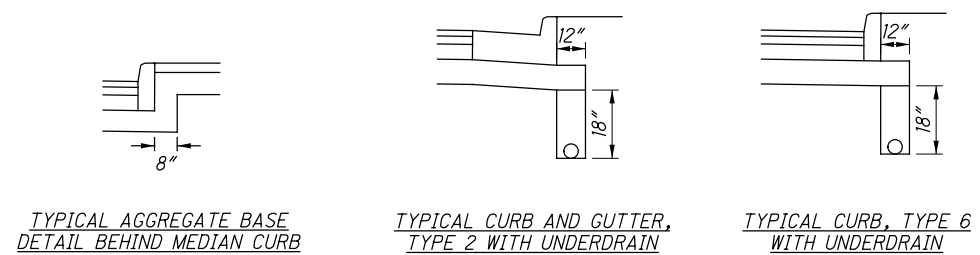
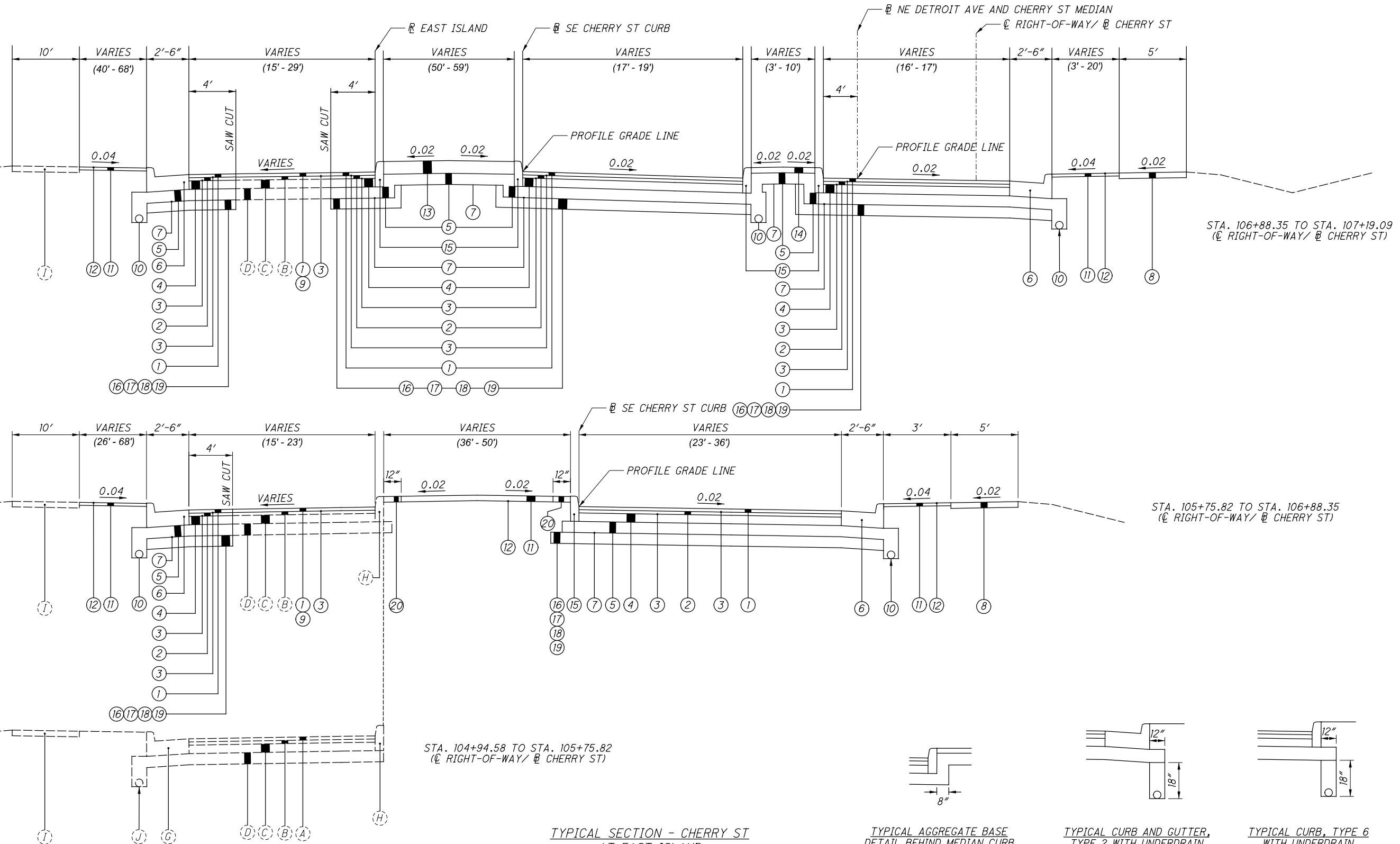

TYPICAL SECTION - CHERRY ST AT EAST ISLAND

TYPICAL AGGREGATE BASE DETAIL BEHIND MEDIAN CURB

TYPICAL CURB AND GUTTER, TYPE 2 WITH UNDERDRAIN

TYPICAL CURB, TYPE 6 WITH UNDERDRAIN

LEGEND

- | | | | | |
|---|--|--|--|---------------------------------|
| ① ITEM 442 - 1.50" ASPHALT CONCRETE SURFACE COURSE, 12.5mm, TYPE A (446) | ⑦ ITEM 204 - SUBGRADE COMPACTION | ⑬ ITEM 609 - MEDIAN, MISC.: PAVER ISLAND | ⑳ ITEM 608 - 6" CONCRETE WALK, AS PER PLAN | Ⓒ EX. CURB & GUTTER - CONCRETE |
| ② ITEM 442 - 1.75" ASPHALT CONCRETE INTERMEDIATE COURSE, 19mm, TYPE A (446) | ⑧ ITEM 608 - 4" CONCRETE WALK | ⑭ ITEM 609 - 4" CONCRETE TRAFFIC ISLAND, AS PER PLAN | Ⓐ EX. PAVEMENT - 1.5" ASPHALT | Ⓗ EX. CURB - CONCRETE |
| ③ ITEM 407 - NON-TRACKING TACK COAT | ⑨ ITEM 254 - 1.5" PAVEMENT PLANING, ASPHALT CONCRETE | ⑮ ITEM 609 - CURB, TYPE 6 | Ⓑ EX. PAVEMENT - 1.75" ASPHALT | Ⓘ EX. SIDEWALK - 4" CONCRETE |
| ④ ITEM 301 - 6" ASPHALT CONCRETE BASE, PG64-22 | ⑩ ITEM 605 - 6" BASE PIPE UNDERDRAINS WITH GEOTEXTILE FABRIC | ⑯ ITEM 204 - PROOF ROLLING | Ⓓ EX. PAVEMENT - 6" ASPHALT | ⓵ EX. PIPE UNDERDRAIN - 6" PIPE |
| ⑤ ITEM 304 - 8" AGGREGATE BASE | ⑪ ITEM 653 - 4" TOPSOIL FURNISHED AND PLACED | ⑰ ITEM 204 - EXCAVATION OF SUBGRADE, AS PER PLAN | Ⓔ EX. PAVEMENT - 8" AGGREGATE BASE | ⓶ EMBANKMENT |
| ⑥ ITEM 609 - CURB, MISC.: CITY OF TOLEDO CURB AND GUTTER TYPE B-1, MODIFIED | ⑫ ITEM 659 - SEEDING AND MULCHING | ⑱ ITEM 204 - GRANULAR MATERIAL, TYPE B, AS PER PLAN | Ⓕ EX. PAVEMENT - 4" NON-REINF. CONCRETE | ⓷ EX. PAVER ISLAND |
| | | | Ⓖ EX. PAVEMENT - 8" DECORATIVE REINF. CONCRETE | |

UTILITIES

LISTED BELOW ARE ALL UTILITIES LOCATED WITHIN THE PROJECT CONSTRUCTION LIMITS TOGETHER WITH THEIR RESPECTIVE OWNERS:

WATER
CITY OF TOLEDO - DIVISION OF WATER DISTRIBUTION
401 SOUTH ERIE STREET
TOLEDO, OH 43602
(419) 249-2849

ELECTRIC & LIGHTING **TELEPHONE**
TOLEDO EDISON AT&T
MS: A-HLOC-2332 130 N. ERIE STREET, ROOM 714
6099 ANGOLA ROAD TOLEDO, OH 43624
TOLEDO, OH 43528 (419) 245-7714
(419) 249-5218

GAS **CENTURYLINK**
COLUMBIA GAS OF OHIO 639 OLIVER STREET
2901 E. MANHATTAN BLVD TOLEDO, OH 43604
TOLEDO, OH 43611 (419) 304-5190
(419) 539-6061

FIBER OPTIC
NORTHERN BUCKEYE EDUCATION COUNCIL
209 NOLAN PARKWAY
P.O. BOX 407
ARCHIBOLD, OH 43502
(419) 267-5565

CABLE
BUCKEYE BROADBAND
2700 OREGON ROAD
NORTHWOOD, OH 43619
(419) 724-3713 - ATTN: MICHAEL SHEAHAN

CONSTRUCTION NOISE

ACTIVITIES AND LAND USE ADJACENT TO THIS PROJECT MAY BE AFFECTED BY CONSTRUCTION NOISE. IN ORDER TO MINIMIZE ANY ADVERSE CONSTRUCTION NOISE IMPACTS, DO NOT OPERATE POWER-OPERATED CONSTRUCTION-TYPE DEVICES BETWEEN THE HOURS OF 8 PM AND 8 AM. IN ADDITION, DO NOT OPERATE AT ANY TIME ANY DEVICE IN SUCH A MANNER THAT THE NOISE CREATED SUBSTANTIALLY EXCEEDS THE NOISE CUSTOMARILY AND NECESSARILY ATTENDANT TO THE REASONABLE AND EFFICIENT PERFORMANCE OF SUCH EQUIPMENT.

SURVEYING PARAMETERS

PRIMARY PROJECT CONTROL MONUMENTS GOVERN ALL POSITIONING ON ODOT PROJECTS. SEE SHEET 2 OF THE PLANS FOR A TABLE CONTAINING PROJECT CONTROL INFORMATION.

USE THE FOLLOWING VERTICAL POSITIONING AND HORIZONTAL POSITIONING PARAMETERS FOR ALL SURVEYING:

VERTICAL POSITIONING

ORTHOMETRIC HEIGHT DATUM: NAVD 88
GEOID: GEOID09 - HELD BM305 FROM LUC-DETROIT AVE PID 97266

HORIZONTAL POSITIONING

REFERENCE FRAME: NAD 83 (CORS96) - 00°00'09" COUNTER-CLOCKWISE FROM DETROIT AVE PID 97266

ELLIPSOID: GRS80
MAP PROJECTION: LAMBERT CONFORMAL CONIC
COORDINATE SYSTEM: OHIO NORTH ZONE (3401)
COMBINED SCALE FACTOR: 1.0000265645 HELD LUC-DETROIT AVE PID 97266

ORIGIN OF COORDINATE SYSTEM: EASTING (X): 0 NORTHING (Y): 0

USE THE POSITIONING METHODS AND MONUMENT TYPE USED IN THE ORIGINAL SURVEY TO RESTORE ALL MONUMENTS RELATED TO PRIMARY PROJECT CONTROL THAT ARE DAMAGED OR DESTROYED BY CONSTRUCTION ACTIVITIES. RESTORE THE DAMAGED OR DESTROYED MONUMENTS IN ACCORDANCE WITH CMS 623.

UNITS ARE IN U.S. SURVEY FEET.

WORK LIMITS

THE WORK LIMITS SHOWN ON THESE PLANS ARE FOR PHYSICAL CONSTRUCTION ONLY. PROVIDE THE INSTALLATION AND OPERATION OF ALL WORK ZONE TRAFFIC CONTROL AND WORK ZONE TRAFFIC CONTROL DEVICES REQUIRED BY THESE PLANS WHETHER INSIDE OR OUTSIDE THESE WORK LIMITS.

CLEARING AND GRUBBING

REMOVE ALL TREES AND STUMPS SPECIFICALLY MARKED FOR REMOVAL WITHIN THE CONSTRUCTION LIMITS UNDER THE LUMP SUM BID FOR ITEM 201, CLEARING AND GRUBBING. THE FOLLOWING IS AN APPROXIMATE ESTIMATE OF THE NUMBER OF TREES AND STUMPS TO BE REMOVED.

SIZES	NO. TREES	NO. STUMPS	TOTAL
4"	19	0	19

ITEM 204 - PROOF ROLLING

THE FOLLOWING QUANTITY IS PROVIDED IN THE GENERAL SUMMARY TO ADDRESS LOCATIONS REQUIRING PROOF ROLLING. SEE PLAN SHEET NOS. 39 & 30 FOR ADDITIONAL INFORMATION.

ITEM 204 - PROOF ROLLING 6 HOURS.

AIRWAY/HIGHWAY CLEARANCE FOR AIRPORTS AND HELIPORTS

THIS PROJECT HAS BEEN IDENTIFIED AS BEING WITHIN THE INFLUENCE AREA OF THREE (3) PRIVATE USE HELIPORTS. NO TEMPORARY STRUCTURES OR CONSTRUCTION EQUIPMENT, AT MAXIMUM OPERATING HEIGHT, SHALL EXCEED A HEIGHT OF 65 FT. IF ANY TEMPORARY STRUCTURES OR CONSTRUCTION EQUIPMENT WILL EXCEED THIS HEIGHT, COORDINATION WITH THE HELIPORT OWNERS AND THE ODOT OFFICE OF AVIATION WILL BE NECESSARY PRIOR TO ERECTING SUCH TEMPORARY STRUCTURES OR OPERATING SUCH EQUIPMENT ON THE PROJECT. NO TEMPORARY STRUCTURES OR CONSTRUCTION EQUIPMENT SHALL EXCEED THE PERMISSIBLE HEIGHT, UNTIL COORDINATION IS MET AND DOCUMENTATION HAS BEEN FURNISHED TO THE PROJECT ENGINEER. IF COORDINATION IS NOT OBTAINED, THEN THE PROJECT ENGINEER WILL HAVE THE AUTHORITY TO PROVIDE RESTRICTIONS AS REQUIRED.

ST. VINCENT HOSPITAL & MEDICAL CENTER HELIPORT
MERCY ST. VINCENTS MEDICAL CENTER
2213 CHERRY STREET
TOLEDO, OH 43608
(419) 251-2982
MANAGER: MIKE CONRAD (419) 251-4588

TOLEDO HOSPITAL HELIPORT
THE TOLEDO HOSPITAL
2142 N. COVE BOULEVARD
TOLEDO, OH 43606
(419) 471-4128

SCOTT PARK HELIPORT
UNIVERSITY OF TOLEDO
2801 WEST BANCROFT
TOLEDO, OH 43606
(419) 537-2072

REMOVALS

IN ALL SIDEWALK, DRIVE, OR PAVEMENT REMOVALS, EDGES SHALL BE CUT TO THE NEAREST JOINT WITH NEAT LINES BY USE OF A POWER SAW. SAW CUTS SHALL BE FULL DEPTH. REMOVALS SHALL BE MADE ONLY TO THE EXTENT APPROVED BY THE ENGINEER.

CONCRETE PAVEMENTS

THE CONTRACTOR SHALL NOT REMOVE ANY DRIVEWAYS OR SIDEWALKS THAT CANNOT BE REPLACED WITHIN 72 HOURS.

HAUL ROUTES

ALL HAUL ROADS AND STREETS WITHIN THE PROJECT LIMITS ON WHICH TRAFFIC IS TO BE MAINTAINED SHALL BE KEPT RELATIVELY FREE FROM DUST AND DIRT. IF THEY ARE NOT MAINTAINED TO THE SATISFACTION OF THE ENGINEER, HE/SHE MAY REQUIRE THE USE OF MECHANICAL CLEANING EQUIPMENT TO REMOVED DUST AND PARTICLES FROM THE ROADWAY SURFACE AND MINIMIZE THE CHANCE OF SUCH PARTICLES BECOMING AIR-BORNE.

PART-WIDTH CONSTRUCTION

BECAUSE OF THE NECESSITY TO BUILD THIS PROJECT UNDER TRAFFIC AND TO CONSTRUCT THE FULL PAVEMENT WIDTH IN STAGES, EXERCISE CARE TO PREVENT THE CONSTRUCTION OF A BUTT JOINT IN THE BASE COURSES. LAP LONGITUDINAL JOINTS AS SHOWN ON STANDARD CONSTRUCTION DRAWING BP-3.1.

PAVEMENT RESTORATION FOR PIPE INSTALLATIONS AND/OR REMOVALS

THE FOLLOWING QUANTITY HAS BEEN PROVIDED FOR PAVEMENT RESTORATION FOLLOWING INSTALLATION AND/OR REMOVAL OF PIPES.

ITEM 301 - ASPHALT CONCRETE BASE, PG64-22	3 CU. YDS.
ITEM 442 - 3" ASPHALT CONCRETE, INTERMEDIATE COURSE, 19mm, TYPE A (446)	2 CU. YDS.

THE ABOVE QUANTITY IS BASED ON A 301 THICKNESS OF 6 INCHES AND A 442 THICKNESS OF 3 INCHES AND A PAVEMENT RESTORATION WIDTH THAT INCLUDES THE TRENCH WIDTH PLUS TWO FEET ON EACH SIDE OF THE TRENCH.

PROVIDE ANY MATERIALS USED OUTSIDE THE LIMITS STATED ABOVE AT NO ADDITIONAL COST. THIS WORK SHALL BE PERFORMED IN A MAXIMUM OF 2 DAYS OVER A WEEKEND.

PAVEMENT RESTORATION FOR DRAINAGE STRUCTURE INSTALLATIONS

THE FOLLOWING QUANTITY IS PROVIDED FOR PAVEMENT RESTORATION FOLLOWING INSTALLATION OF ITEM 611, DRAINAGE STRUCTURES.

ITEM 301 - ASPHALT CONCRETE BASE, PG64-22	1 CU. YD.
ITEM 442 - 3" ASPHALT CONCRETE, INTERMEDIATE COURSE, 19mm, TYPE A (446)	1 CU. YD.

THE ABOVE QUANTITY IS BASED ON A 301 THICKNESS OF 6 INCHES AND A 442 THICKNESS OF 3 INCHES AND A WIDTH OF FOUR FEET AROUND THE PERIMETER OF THE DRAINAGE STRUCTURE.

PROVIDE ANY MATERIALS USED OUTSIDE THE LIMITS STATED ABOVE AT NO ADDITIONAL COST. THIS WORK SHALL BE PERFORMED IN A MAXIMUM OF 2 DAYS OVER A WEEKEND.

EXISTING SURVEY POINTS

SURVEY MONUMENTS, BENCH MARKS, AND EXISTING POINTS DAMAGED OR DISTURBED BY CONSTRUCTION SHALL BE REPLACED BY A REGISTERED LAND SURVEYOR AT THE CONTRACTOR'S EXPENSE. SHOULD CONTRACTOR FAIL TO PROPERLY REPLACE THESE POINTS, THE DIVISION OF ENGINEERING SERVICES WILL REPLACE THEM AT THE CONTRACTOR'S EXPENSE AFTER THREE WEEKS NOTICE.

ITEM 608 - 6" CONCRETE WALK, AS PER PLAN

THIS ITEM IS TO BE USED FOR THE 12" CONCRETE STRIP BETWEEN THE TYPE 6 CURB AND SEEDED SPLITTER ISLAND. THE CONCRETE IS TO BE COLORED WITH SOLOMON CONCRETE COLORING PRODUCTS 300 LIGHT BROWN (4 1/2 LBS/100 LBS OF CEMENT) OR APPROVED EQUAL AS APPROVED BY THE ENGINEER. THIS ITEM SHOULD MATCH THE EXISTING CONCRETE STRIP IN THE SPLITTER ISLANDS. THIS ITEM WILL INCLUDE ALL LABOR, MATERIALS, AND EQUIPMENT TO CONSTRUCT THE CONCRETE STRIP.



LUC-24-26.41

MODEL: Sheet PAPER: 17x11 (in.) DATE: 4/26/2021 TIME: 2:05:47 PM USER: JeffHe S:\CIN\3500-3899\3899\020\Drawings\CAD\111022\40-Engineering\Roadway\Sheets\111022_G5001.dgn

SHEET NUM.													PART.	ITEM	ITEM	GRAND	UNIT	DESCRIPTION	SEE SHEET NO.
4	11	12	13	14	15	27	28	34	35	39	40	54	01/SAF/OT	EXT	TOTAL				
ROADWAY																			
														201	11000	LS		CLEARING AND GRUBBING	
2,463								215					2,678	202	23000	2,678	SY	PAVEMENT REMOVED	
						3,384							3,384	202	30000	3,384	SF	WALK REMOVED	
						698							698	202	32000	698	FT	CURB REMOVED	
						1,105							1,105	202	32500	1,105	FT	CURB AND GUTTER REMOVED	
						471							471	202	35100	471	FT	PIPE REMOVED, 24" AND UNDER	
						5							5	202	58100	5	EACH	CATCH BASIN REMOVED	
							465						465	203	10000	465	CY	EXCAVATION	
							562						562	203	20000	562	CY	EMBANKMENT	
3,786								103					3,889	204	10000	3,889	SY	SUBGRADE COMPACTION	
													1,635	204	13001	1,635	CY	EXCAVATION OF SUBGRADE, AS PER PLAN	
													1,635	204	30011	1,635	CY	GRANULAR MATERIAL, TYPE B, AS PER PLAN	
	6												6	204	45000	6	HOUR	PROOF ROLLING	
													4,904	204	50001	4,904	SY	GEOTEXTILE FABRIC, AS PER PLAN	
						2,747							2,747	608	10000	2,747	SF	4" CONCRETE WALK	
						311							311	608	13001	311	SF	6" CONCRETE WALK, AS PER PLAN	
						710							710	608	52000	710	SF	CURB RAMP	
						188							188	608	53020	188	SF	DETECTABLE WARNING	
							1						1	623	38500	1	EACH	MONUMENT ASSEMBLY	
EROSION CONTROL																			
		18											18	601	21050	18	SY	TIED CONCRETE BLOCK MAT WITH TYPE 1 UNDERLAYMENT	
		258											258	659	00300	258	CY	TOPSOIL	
		2,320											2,320	659	00500	2,320	SY	SEEDING AND MULCHING, CLASS 1	
		116											116	659	14000	116	SY	REPAIR SEEDING AND MULCHING	
		116											116	659	15000	116	SY	INTER-SEEDING	
		0.33											0.33	659	20000	0.33	TON	COMMERCIAL FERTILIZER	
		0.48											0.48	659	31000	0.48	ACRE	LIME	
		13											13	659	35000	13	MGAL	WATER	
													832	15000	LS		STORM WATER POLLUTION PREVENTION PLAN		
													832	15002	LS		STORM WATER POLLUTION PREVENTION INSPECTIONS		
													832	15010	LS		STORM WATER POLLUTION PREVENTION INSPECTION SOFTWARE		
													18,000	832	30000	18,000	EACH	EROSION CONTROL	
ENVIRONMENTAL / REMEDIATION																			
		55											55	SPECIAL	69065016	55	TON	WORK INVOLVING PETROLEUM CONTAMINATED SOIL	
DRAINAGE																			
		300											300	605	13300	300	FT	6" UNCLASSIFIED PIPE UNDERDRAINS	
								1,383					1,383	605	14020	1,383	FT	6" BASE PIPE UNDERDRAINS WITH GEOTEXTILE FABRIC	
		300											300	611	01500	300	FT	6" CONDUIT, TYPE F	
									329				329	611	04401	329	FT	12" CONDUIT, TYPE B, AS PER PLAN	
									32				32	611	04601	32	FT	12" CONDUIT, TYPE C, AS PER PLAN	
									84				84	611	05901	84	FT	15" CONDUIT, TYPE B, AS PER PLAN	
									8				8	611	06101	8	FT	15" CONDUIT, TYPE C, AS PER PLAN	
									68				68	611	07601	68	FT	18" CONDUIT, TYPE C, AS PER PLAN	
									8				8	611	98150	8	EACH	CATCH BASIN, NO. 3	
									1				1	611	98470	1	EACH	CATCH BASIN, NO. 2-2B	
									1				1	611	98635	1	EACH	CATCH BASIN RECONSTRUCTED TO GRADE, AS PER PLAN	
									4				4	611	99574	4	EACH	MANHOLE, NO. 3	
									1				1	611	99654	1	EACH	MANHOLE ADJUSTED TO GRADE	
PAVEMENT																			
3,403													3,403	254	01000	3,403	SY	PAVEMENT PLANING, ASPHALT CONCRETE (1.5" DEEP)	
439													439	254	01000	439	SY	PAVEMENT PLANING, ASPHALT CONCRETE (VARIABLE DEPTH, 0" TO 2.5")	
439	4												443	301	46000	443	CY	ASPHALT CONCRETE BASE, PG64-22	
838													838	304	20000	838	CY	AGGREGATE BASE	
528													528	407	20000	528	GAL	NON-TRACKING TACK COAT	
258													258	442	10000	258	CY	ASPHALT CONCRETE SURFACE COURSE, 12.5 MM, TYPE A (446)	
122	3												125	442	10100	125	CY	ASPHALT CONCRETE INTERMEDIATE COURSE, 19 MM, TYPE A (446)	
								103					103	452	12010	103	SY	8" NON-REINFORCED CONCRETE PAVEMENT, CLASS QC 1P	
							1,826						1,826	609	26000	1,826	FT	CURB, TYPE 6	

GENERAL SUMMARY

DESIGN AGENCY

 DESIGNER
 CJR
 REVIEWER
 JCH 01/14/21
 PROJECT ID
 111022
 SHEET TOTAL
 23 59

SIDEWALK CURVE DATA

- T1
BEGIN STA/OFF: 1441+97.24, 82.29' LT
LENGTH: 31.81'
BEARING: N 62°18'38" W
END STA/OFF: 1441+97.55, 63.58' LT
- C1
BEGIN STA/OFF: 1441+97.55, 63.58' LT
LENGTH: 13.48'
RADIUS: 15.00'
END STA/OFF: 1442+03.40, 51.93' LT
- T2
BEGIN STA/OFF: 1442+03.40, 51.93' LT
LENGTH: 14.48'
BEARING: S 66°11'53" W
END STA/OFF: 1442+15.14, 42.90' LT
- C2
BEGIN STA/OFF: 1442+15.14, 42.90' LT
LENGTH: 36.72'
RADIUS: 70.50'
END STA/OFF: 1442+48.74, 29.08' LT
- T3
BEGIN STA/OFF: 1442+48.74, 29.08' LT
LENGTH: 10.79'
BEARING: N 36°21'19" E
END STA/OFF: 1442+59.08, 27.68' LT
- C3
BEGIN STA/OFF: 1442+59.08, 27.68' LT
LENGTH: 13.04'
RADIUS: 120.00'
END STA/OFF: 1442+72.08, 26.63' LT
- C4
BEGIN STA/OFF: 1441+91.50, 66.68' LT
LENGTH: 22.47'
RADIUS: 25.00'
END STA/OFF: 1442+01.25, 47.28' LT
- C5
BEGIN STA/OFF: 106+71.39, 13.05' LT
LENGTH: 34.21'
RADIUS: 150.00'
END STA/OFF: 107+04.16, 22.60' LT
- C6
BEGIN STA/OFF: 107+04.16, 22.60' LT
LENGTH: 19.24'
RADIUS: 245.00'
END STA/OFF: 107+23.25, 24.94' LT

LEGEND

598.00	MATCH EXISTING PAVEMENT ELEVATION
598.00	PROPOSED PAVEMENT ELEVATION

- NOTES:**
- ALL ELEVATIONS ARE SHOWN AT THE EDGE OF PAVEMENT OR AT PAVEMENT CROSS SLOPE TRANSITIONS.
 - PAVEMENT ELEVATION CALLOUTS AT CATCH BASINS REPRESENT WHAT WOULD BE THE EDGE OF PAVEMENT ELEVATION, NOT ACCOUNTING FOR CATCH BASIN DEPRESSION.
 - DISTANCE BETWEEN ELEVATION CALLOUTS IS 10 FEET UNLESS NOTED OTHERWISE

- VARIABLE DEPTH PLANING AND RESURFACING**
- ITEM 254- PAVEMENT PLANING, ASPHALT CONCRETE (VARIABLE DEPTH, 0.5" TO 3.5")
 - ITEM 442- ASPHALT CONCRETE, SURFACE COURSE, (2.5mm, TYPE A (446) (1.5"))



ROUNDABOUT DETAIL

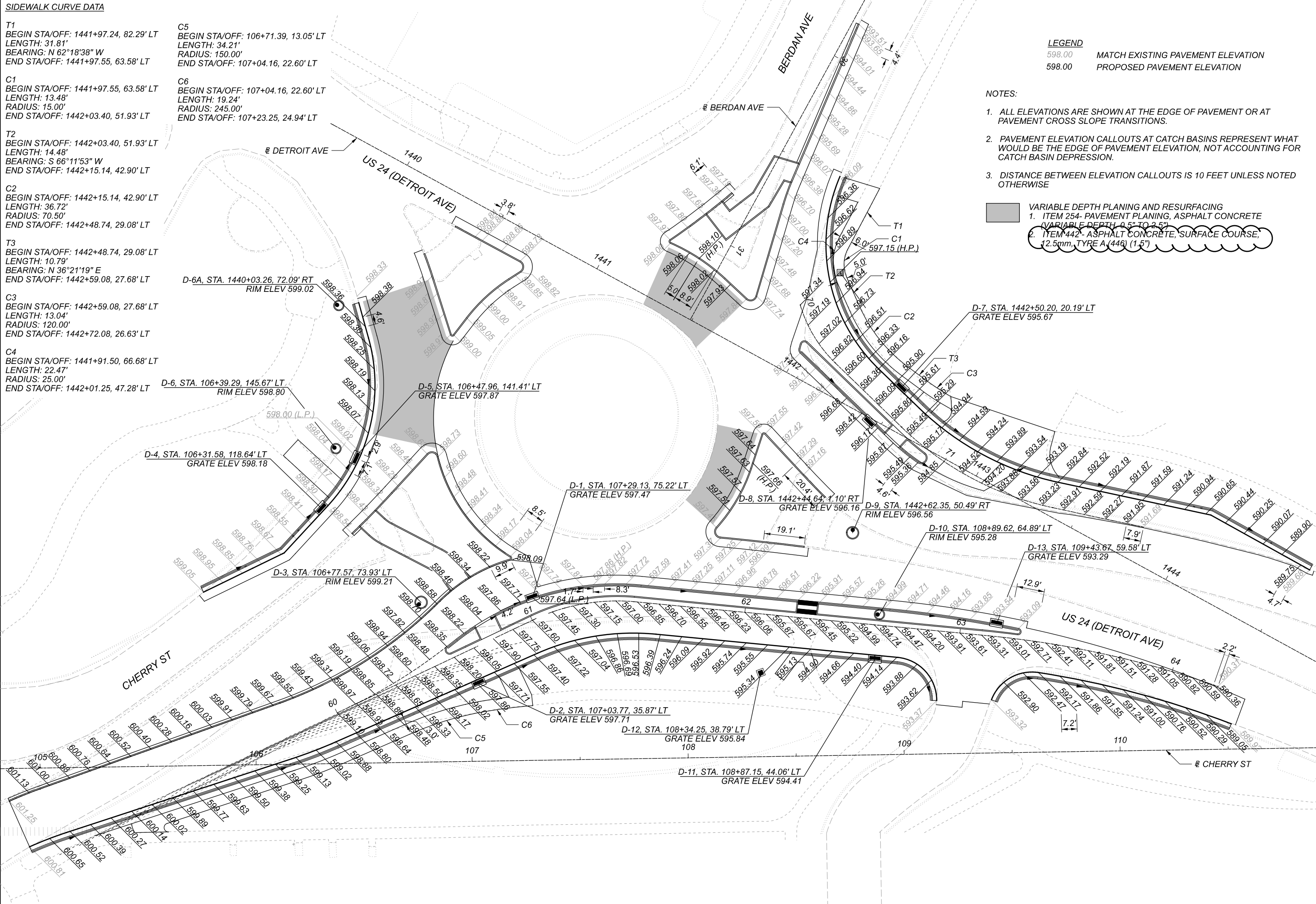

LUC-24-26.41

MODEL: Sheet PAPER SIZE: 11x17 (in.) DATE: 4/26/2021 TIME: 2:06:19 PM USER: JeffHe
S:\CIN\3500-3599\3589\020 Drawings\CAD\11022\400-Engineering\Roadway\Sheets\11022_GA001.dgn



DESIGN AGENCY	STRAND ASSOCIATES
DESIGNER	CJR
REVIEWER	JCH
PROJECT ID	01/14/21
SHEET	111022
TOTAL	33
	59