

M:\2002 (ODOT D2 - Structural)\Task 2C - LUC-20A-3.55 4.55 (PID 94407) Roundabouts\94407\_LUC-20A-3.55\Design\Roadway\Sheets\94407\_XS001.dgn Sheet 4/29/2020 8:40:34 AM SEA

SEEDING	
END WIDTH	SO. YDS.

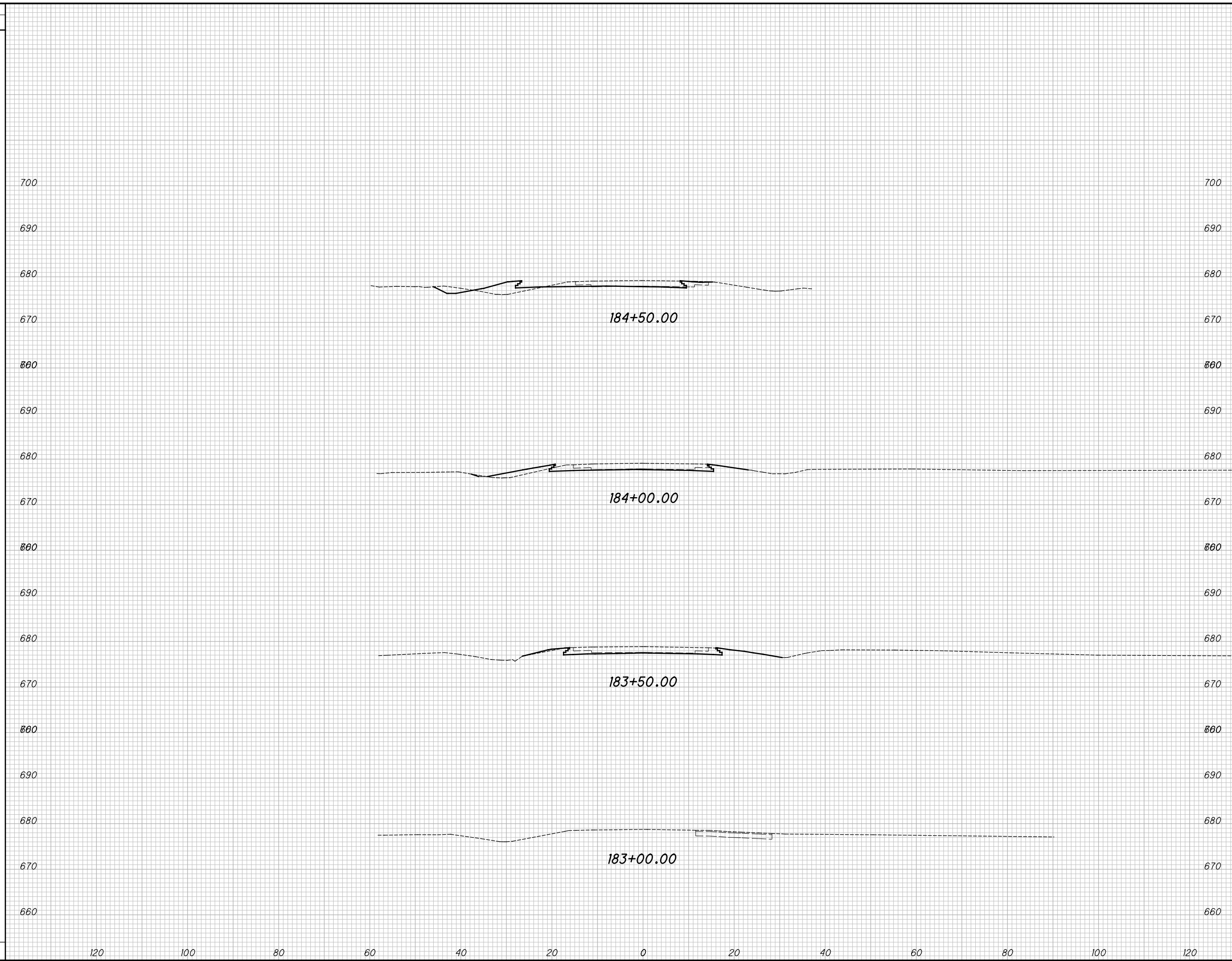

END AREA		VOLUME	
CUT	FILL	CUT	FILL

CALCULATED	CHECKED
XXX	XXX

LUC-20A - 3.55 / 4.55

CROSS SECTIONS US 20A  
STA. 183+00.00 TO STA. 184+50.00



M:\2002 (ODOT D2 - Structural)GES\Task 2C - LUC-20A-3.55 4.55 (PID 94407) Roundabouts\94407\_LUC-20A-3.55\Design\Roadway\Sheets\94407\_XS001.dgn Sheet 4/29/2020 8:40:35 AM SEA

SEEDING	
END WIDTH	SO. YDS.

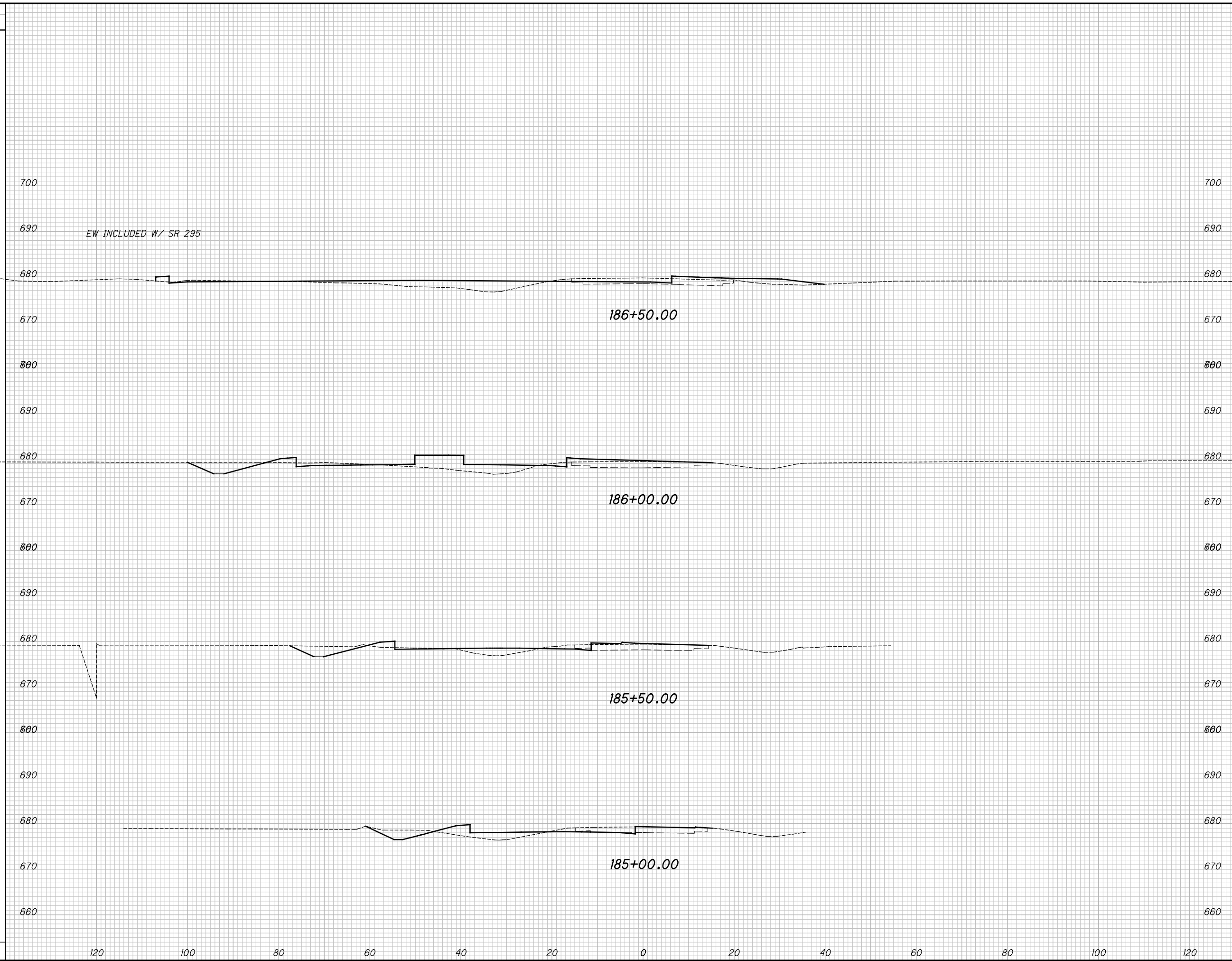

END AREA		VOLUME	
CUT	FILL	CUT	FILL

CALCULATED	CHECKED
XXX	XXX

**CROSS SECTIONS US 20A**  
**STA. 185+00.00 TO STA. 186+50.00**

**LUC-20A - 3.55 / 4.55**



M:\2002 (ODOT D2 - Structural)\Task 2C - LUC-20A-3.55 4.55 (PID 94407)\Roundabouts\94407\_LUC-20A-3.55\Design\Roadway\Sheets\94407\_XS001.dgn Sheet 4/29/2020 8:40:35 AM SEA

SEEDING	
END WIDTH	SO. YDS.

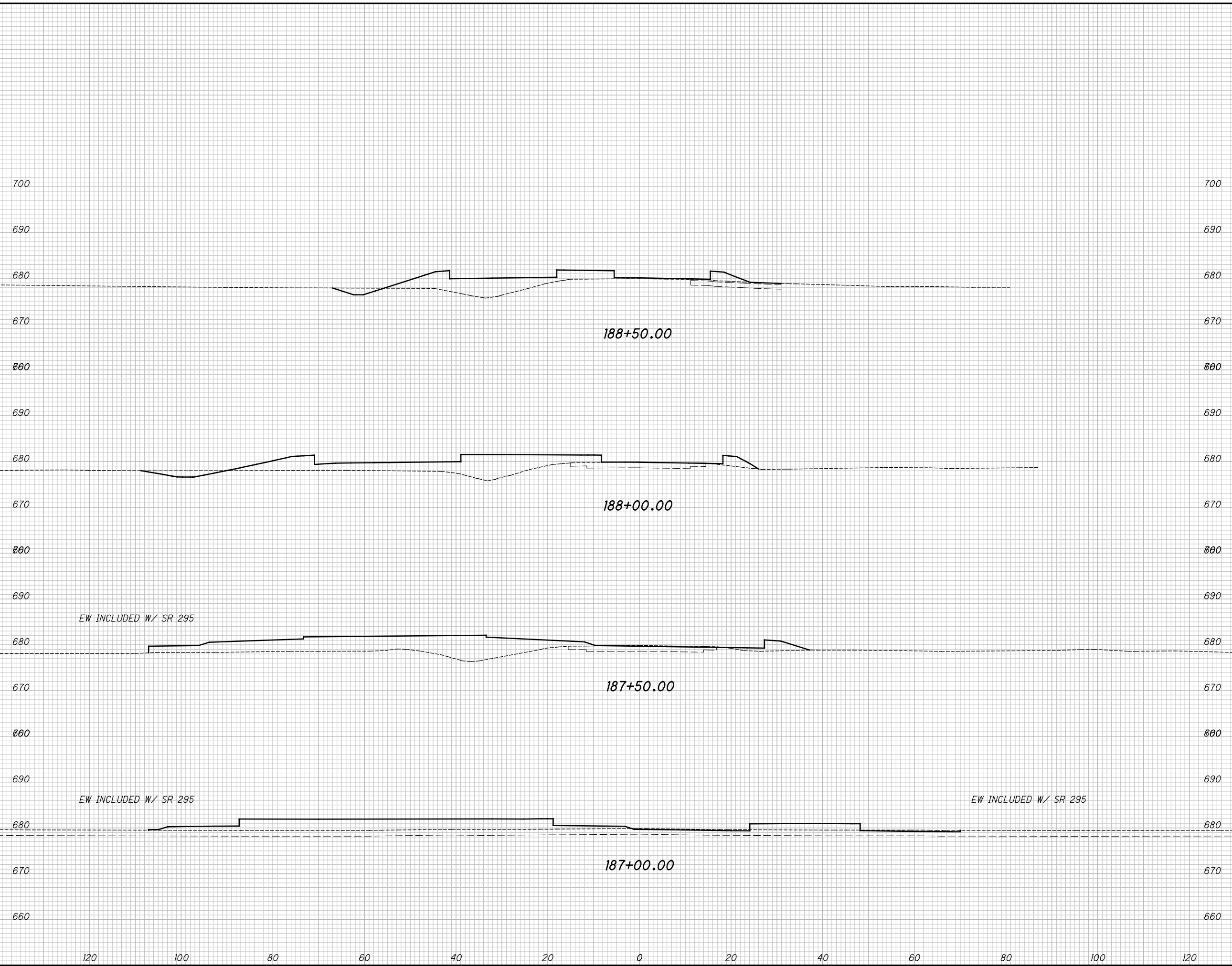

END AREA		VOLUME	
CUT	FILL	CUT	FILL

CALCULATED	CHECKED
XXX	XXX

**CROSS SECTIONS US 20A**  
**STA. 187+00.00 TO STA. 188+50.00**

**LUC-20A - 3.55 / 4.55**



M:\2002 (ODOT D2 - Structural)GES\Task 2C - LUC-20A-3.55 4.55 (PID 94407) Roundabouts\94407\_LUC-20A-3.55\Design\Roadway\Sheets\94407\_XS001.dgn Sheet 4/29/2020 8:40:35 AM SEA

SEEDING	
END WIDTH	SO. YDS.

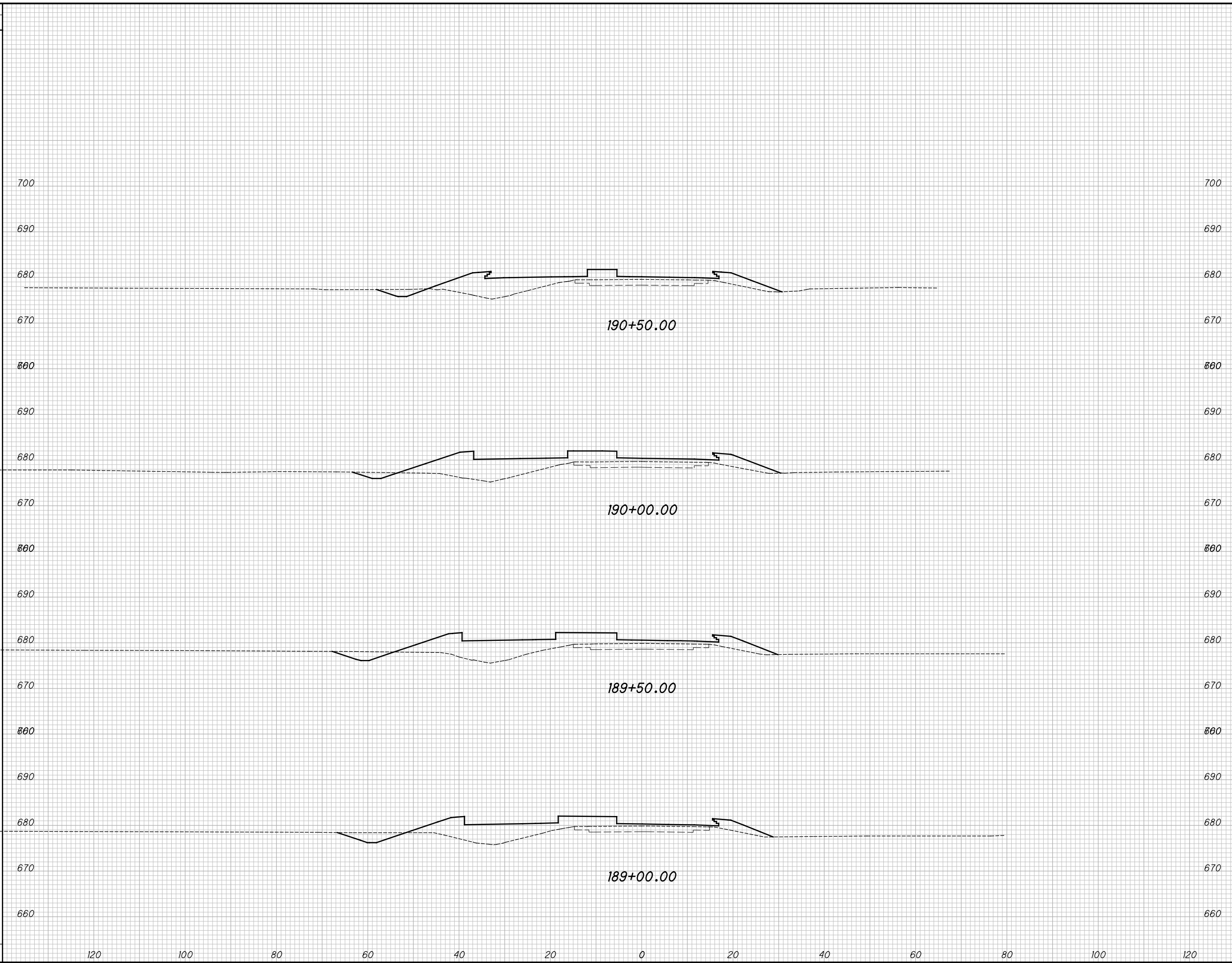

END AREA		VOLUME		CALCULATED XXX	CHECKED XXX
CUT	FILL	CUT	FILL		

**CROSS SECTIONS US 20A  
STA. 189+00.00 TO STA. 190+50.00**

**LUC-20A - 3.55 / 4.55**



M:\2002 (ODOT D2 - Structural)\Task 2C - LUC-20A-3.55 4.55 (PID 94407) Roundabouts\94407\_LUC-20A-3.55\Design\Roadway\Sheets\94407\_XS001.dgn Sheet 4/29/2020 8:40:35 AM SEA

SEEDING

END WIDTH	SO. YDS.

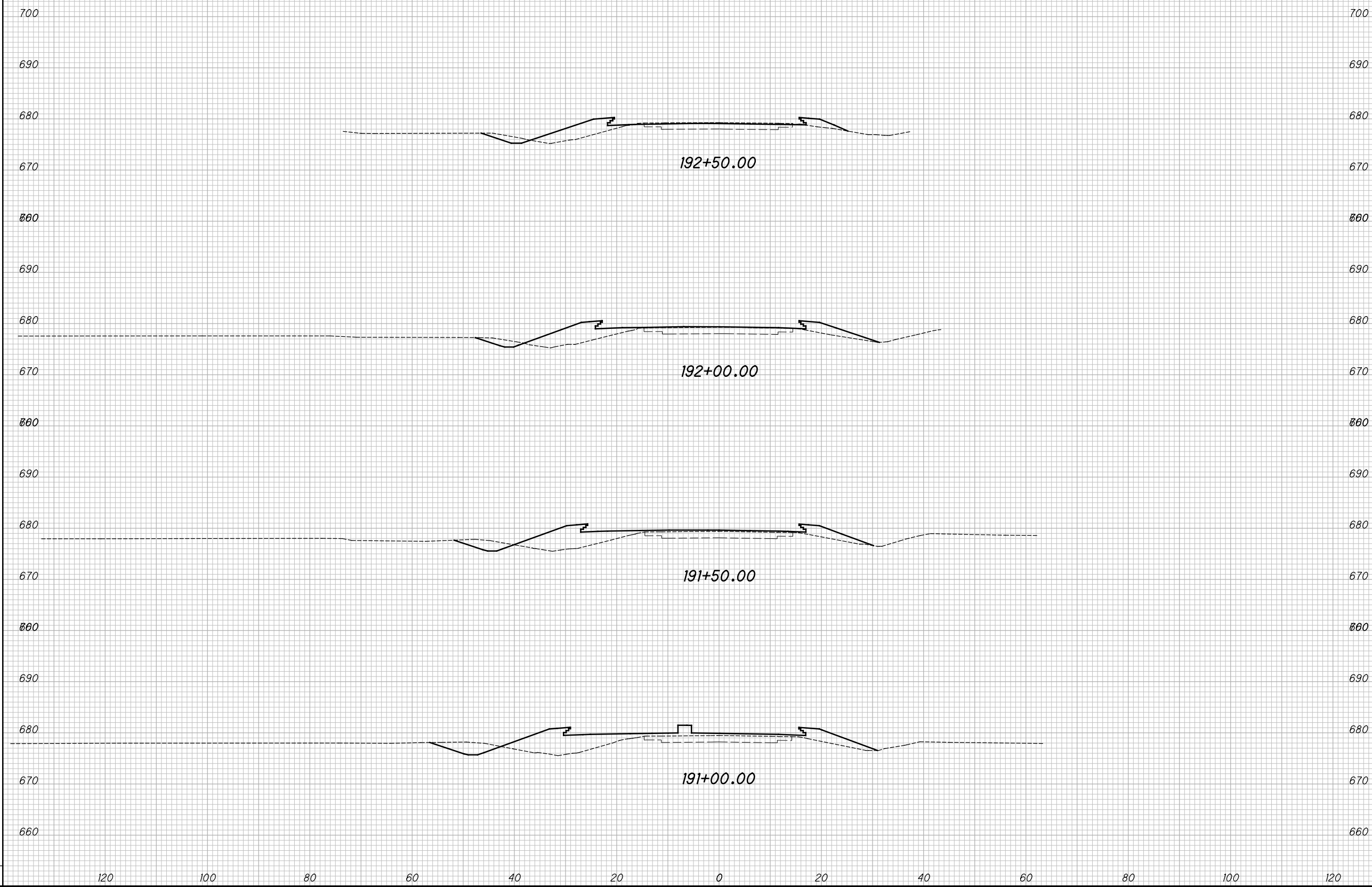

END AREA		VOLUME		CALCULATED	CHECKED
CUT	FILL	CUT	FILL	XXX	XXX

**CROSS SECTIONS US 20A**  
**STA. 191+00.00 TO STA. 192+50.00**

**LUC-20A - 3.55 / 4.55**

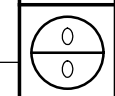

M:\2002 (ODOT D2 - Structural)\Task 2C - LUC-20A-3.55 4.55 (PID 94407) Roundabouts\94407\_LUC-20A-3.55\Design\Roadway\Sheets\94407\_XS001.dgn Sheet 4/29/2020 8:40:35 AM SEA

SEEDING	
END WIDTH	SO. YDS.

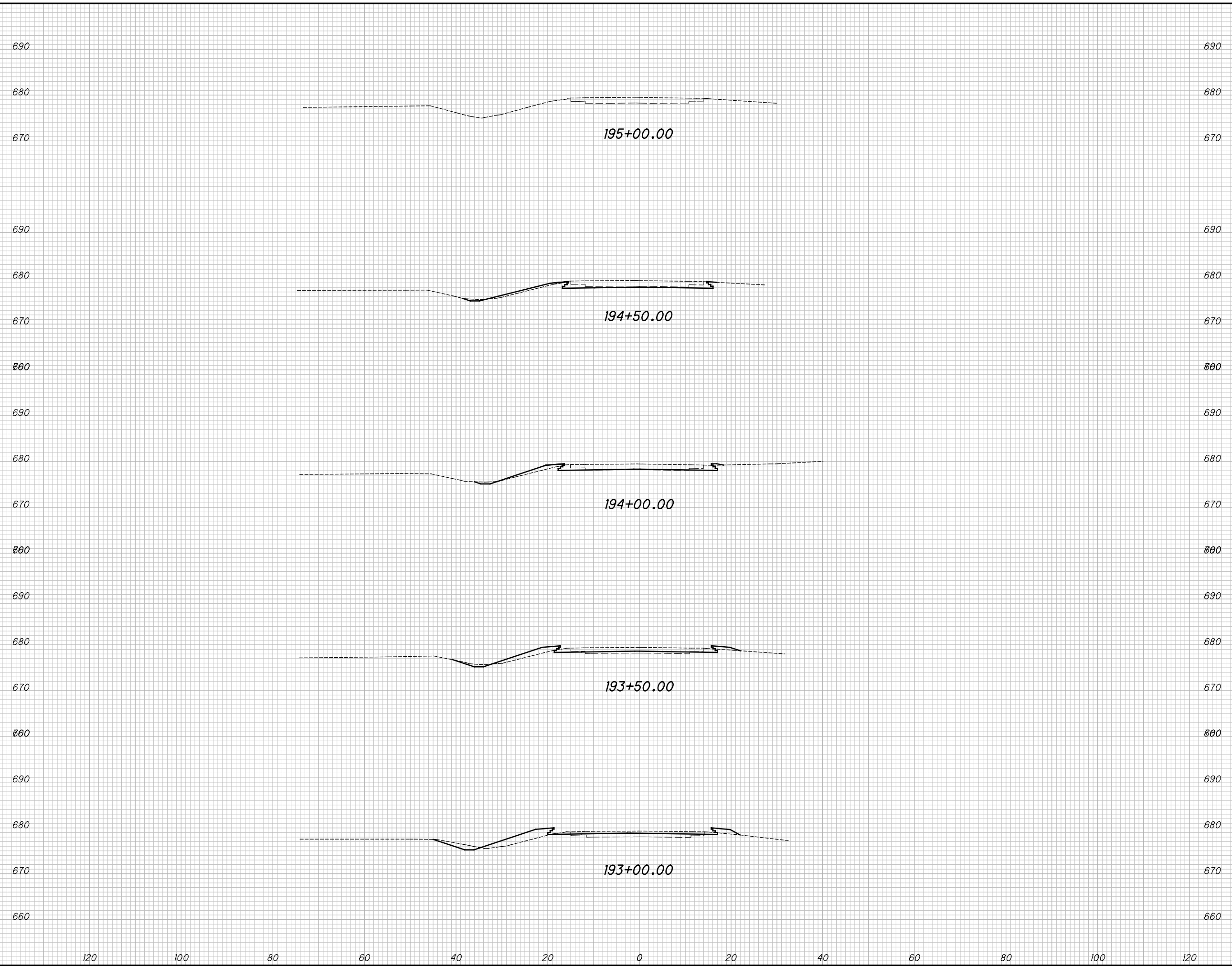

END AREA		VOLUME	
CUT	FILL	CUT	FILL

CALCULATED	CHECKED
XXX	XXX

**CROSS SECTIONS US 20A  
STA. 193+00.00 TO STA. 194+50.00**

**LUC-20A - 3.55 / 4.55**



M:\2002 (ODOT D2 - Structural)GES\Task 2C - LUC-20A-3.55 4.55 (PID 94407) Roundabouts\94407\_LUC-20A-3.55\Design\Roadway\Sheets\94407\_XS005.dgn\_Sheet 4/29/2020 8:40:36 AM SEA

SEEDING

END WIDTH	SO. YDS.
140	
120	
100	
80	
60	
40	
20	
0	
20	
40	
60	
80	
100	
120	
140	

680  
670  
660  
650  
680  
670  
660  
650  
680  
670  
660  
650  
680  
670  
660  
650  
680  
670  
660  
650

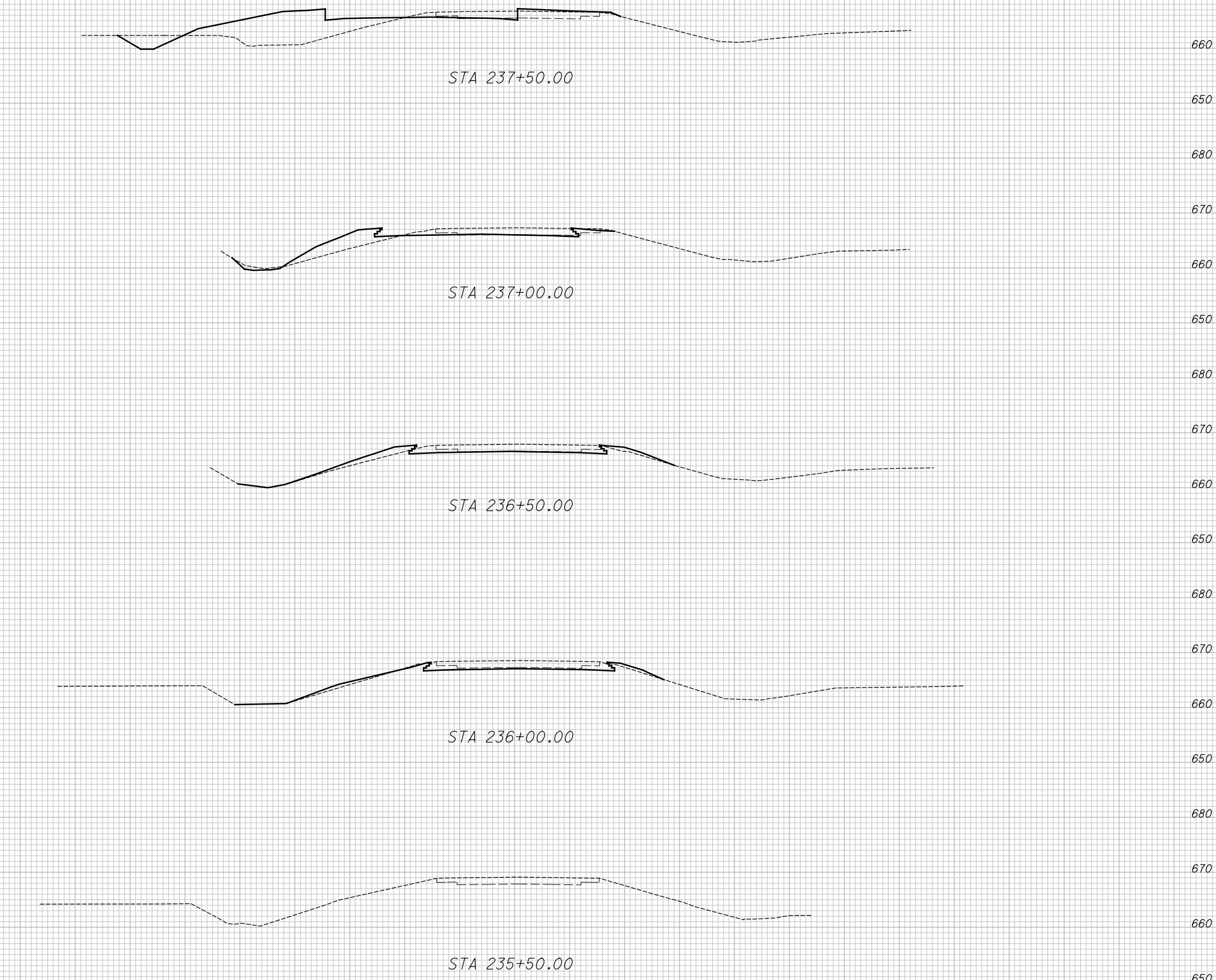

END AREA		VOLUME		CALCULATED	CHECKED
CUT	FILL	CUT	FILL	XXX	XXX
<b>CROSS SECTIONS US 20A</b>					
<b>STA. 235+50.00 TO STA. 237+50.00</b>					
<b>CTY - RTE - SECTION</b>					



M:\2002 (ODOT D2 - Structural)ES\Task 2C - LUC-20A-3.55 4.55 (PID 94407) Roundabouts\94407.LUC-20A-3.55\Design\Roadway\Sheets\94407\_XS005.dgn\_Sheet 4/29/2020 8:40:36 AM SEA

SEEDING	
END WIDTH	SO. YDS.

END AREA		VOLUME		CALCULATED		CHECKED	
CUT	FILL	CUT	FILL	XXX	XXX	XXX	XXX

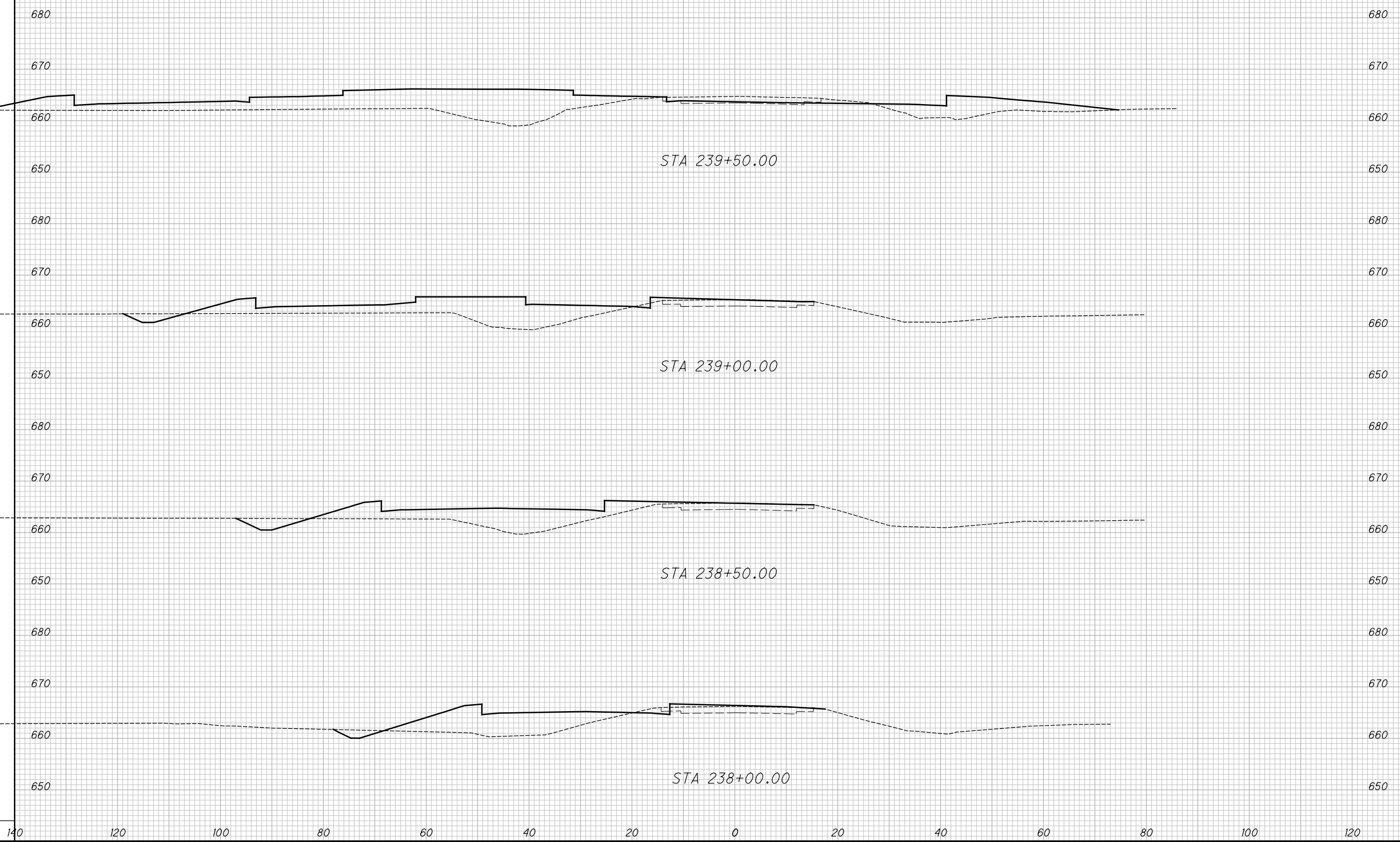

**CROSS SECTIONS US 20A**  
**STA. 238+00.00 TO STA. 239+50.00**

**CTY - RTE - SECTION**





M:\2002 (0001 D2 - Structural)\Task 2C - LUC-20A-3.55 4.55 (PID 94407) Roundabouts\94407\_LUC-20A-3.55\Design\Roadway\Sheets\94407\_XS002.dgn\_Sheet 4/29/2020 8:40:36 AM SEA

SEEDING	
END WIDTH	SO. YDS.

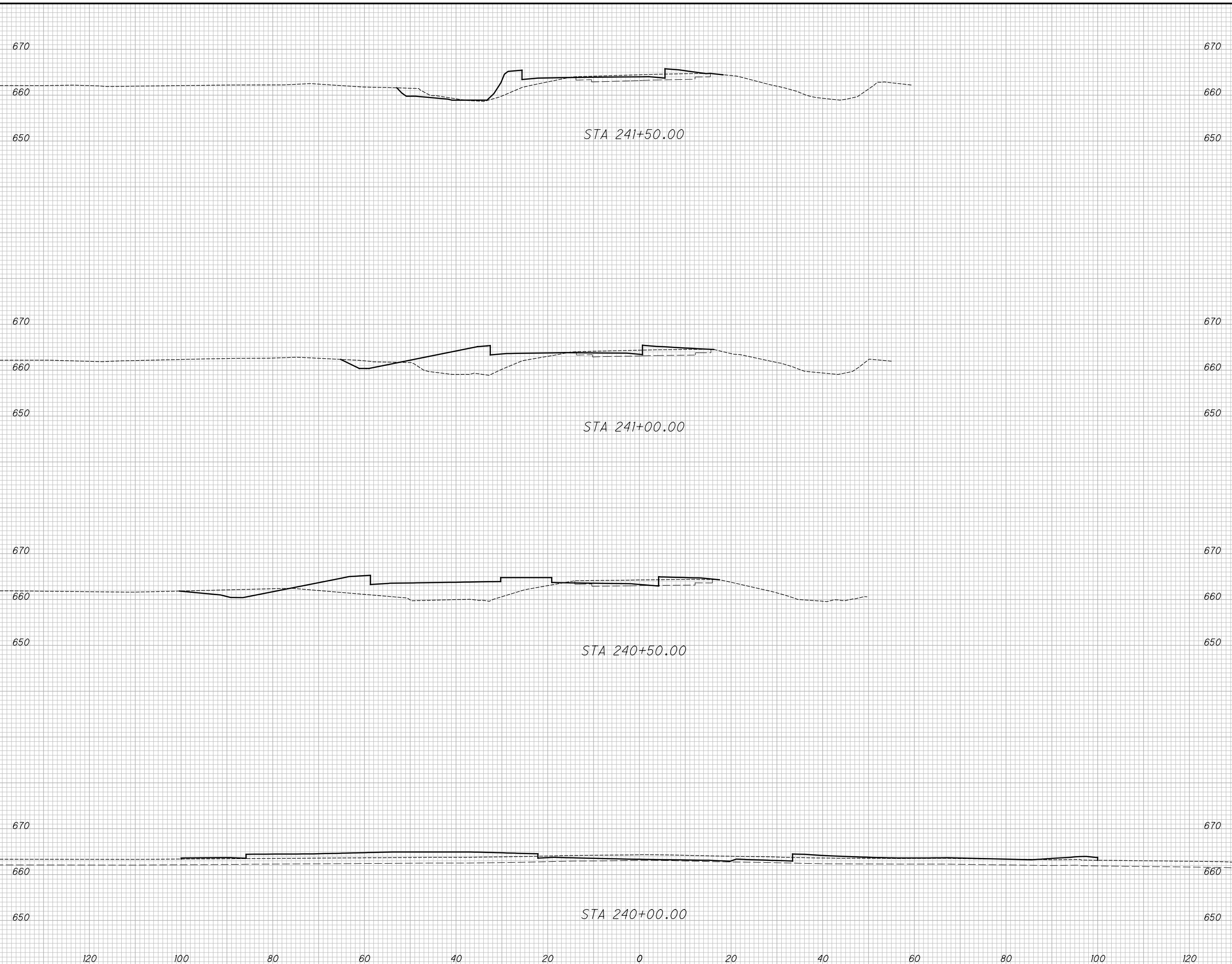

END AREA		VOLUME	
CUT	FILL	CUT	FILL

CALCULATED XXX  
 CHECKED XXX  
**CROSS SECTIONS US-20A**  
**STA. 240+00.00 TO STA. 241+50.00**  
**LUC-20A-3.55 / 4.55**



M:\2002 (0001 D2 - Structural)GES\Task 2C - LUC-20A-3.55 4.55 (PID 94407) Roundabouts\94407\_LUC-20A-3.55\Design\Roadway\Sheets\94407\_XS002.dgn Sheet 4/29/2020 8:40:36 AM SEA

SEEDING

END WIDTH	SO. YDS.

680  
670  
660  
670  
660  
650  
680  
670  
660  
670  
660  
670  
660  
650

120 100 80 60 40 20 0 20 40 60 80 100 120

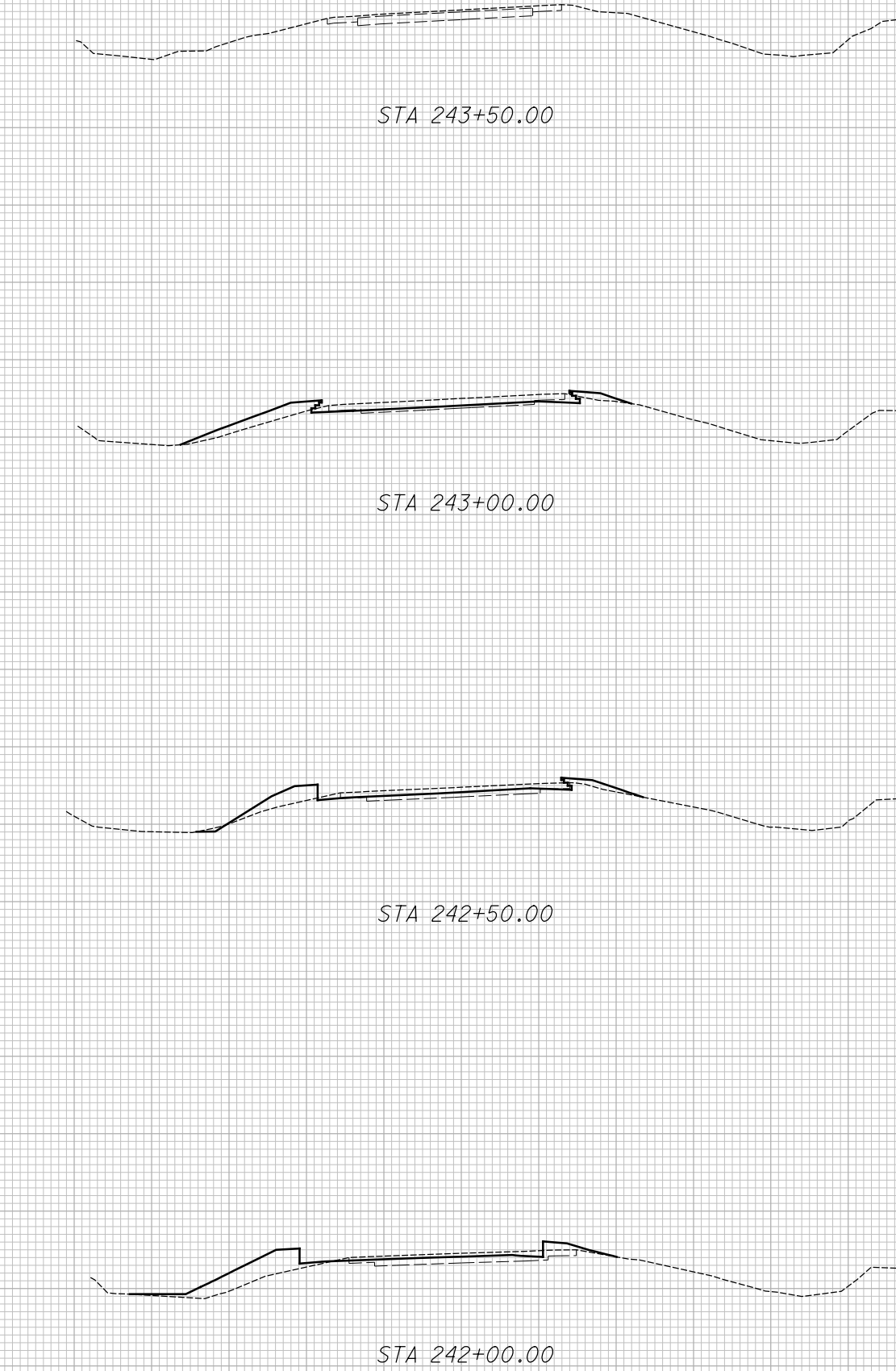

END AREA		VOLUME		CALCULATED	CHECKED
CUT	FILL	CUT	FILL	XXX	XXX

**CROSS SECTIONS US-20A**  
**STA. 242+00.00 TO STA. 243+50.00**

**LUC-20A - 3.55 / 4.55**



M:\2002 (ODOT D2 - Structural)\Task 2C - LUC-20A-3.55 4.55 (PID 94407) Roundabouts\94407\_LUC-20A-3.55\Design\Roadway\Sheets\94407\_XS003.dgn Sheet 4/29/2020 8:40:37 AM SEA

SEEDING	
END WIDTH	SO. YDS.

END AREA		VOLUME		CALCULATED	CHECKED
CUT	FILL	CUT	FILL	XXX	XXX

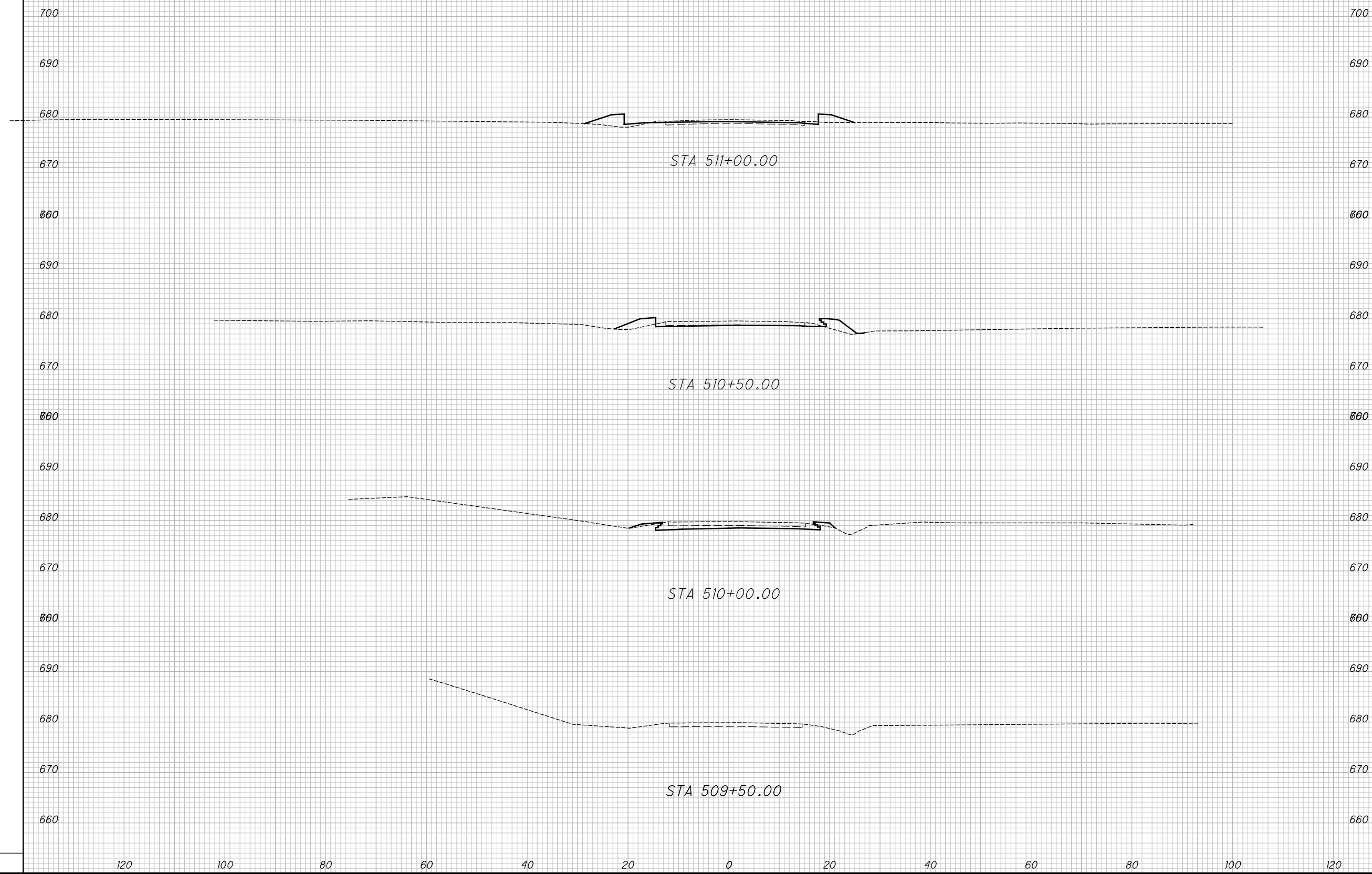

**CROSS SECTIONS SR 295  
STA. 509+50.00 TO STA. 511+00.00**

**LUC-20A - 3.55 / 4.55**



M:\2002 (ODOT D2 - Structural)\Task 2C - LUC-20A-3.55 4.55 (PID 94407) Roundabouts\94407\_LUC-20A-3.55\Design\Roadway\Sheets\94407\_XS003.dgn Sheet 4/29/2020 8:40:37 AM SEA

SEEDING	
END WIDTH	SO. YDS.
0	

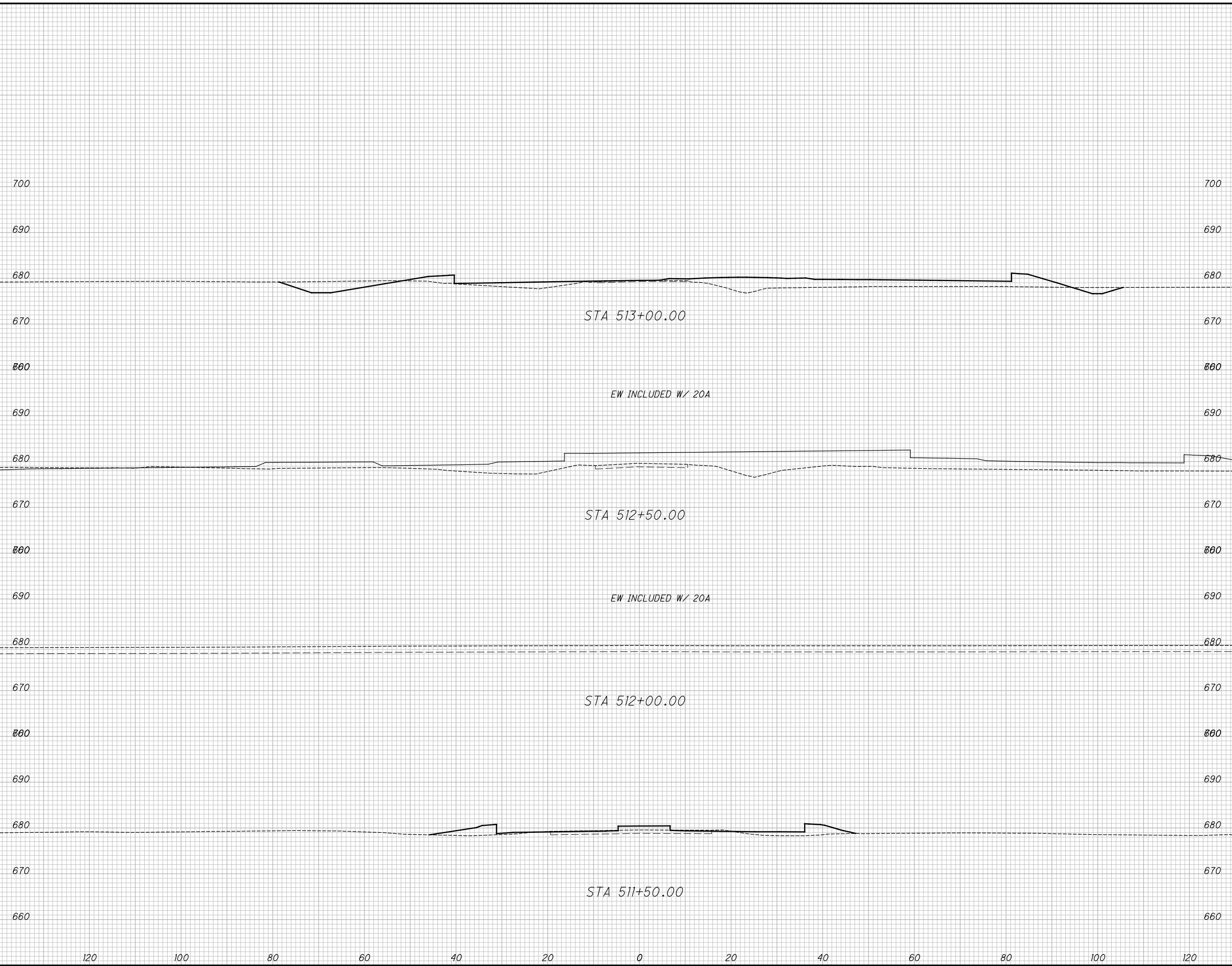

END AREA		VOLUME	
CUT	FILL	CUT	FILL
		0	0

CROSS SECTIONS SR 295  
 STA. 511+50.00 TO STA. 513+00.00  
 LUC-20A - 3.55 / 4.55



CALCULATED  
 XXX  
 CHECKED  
 XXX

M:\2002 (ODOT D2 - Structural)\Task 2C - LUC-20A-3.55 4.55 (PID 94407) Roundabouts\94407\_LUC-20A-3.55\Design\Roadway\Sheets\94407\_XS003.dgn Sheet 4/29/2020 8:40:37 AM SEA

SEEDING	
END WIDTH	SO. YDS.

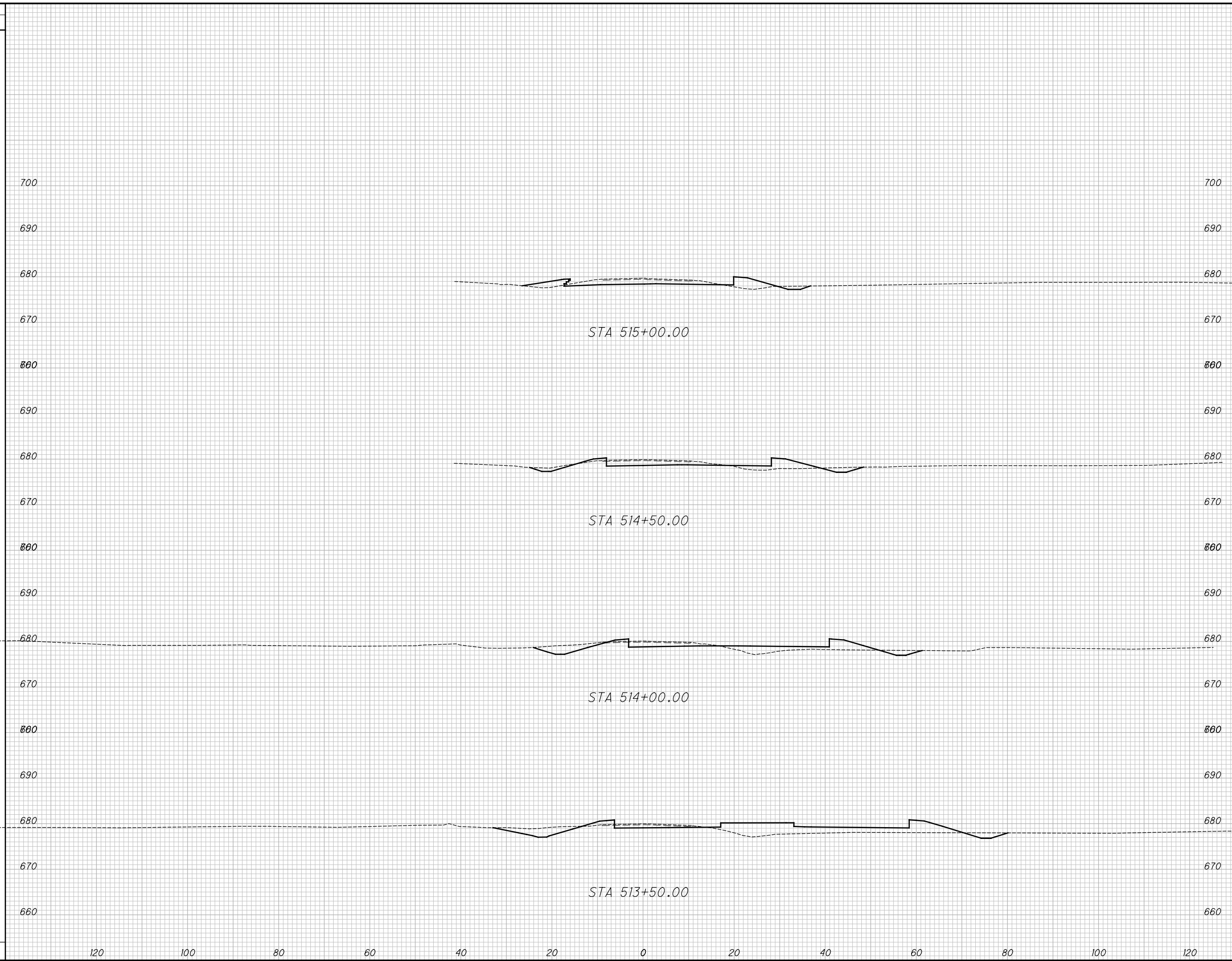

END AREA		VOLUME		CALCULATED XXX	CHECKED XXX
CUT	FILL	CUT	FILL		

**CROSS SECTIONS SR 295  
STA. 513+50.00 TO STA. 515+00.00**

**LUC-20A-3.55 / 4.55**



M:\2002 (0001 D2 - Structural)\Task 2C - LUC-20A-3.55 4.55 (PID 94407) Roundabouts\94407\_LUC-20A-3.55\Design\Roadway\Sheets\94407\_XS003.dgn Sheet 4/29/2020 8:40:37 AM SEA

SEEDING	
END WIDTH	SO. YDS.

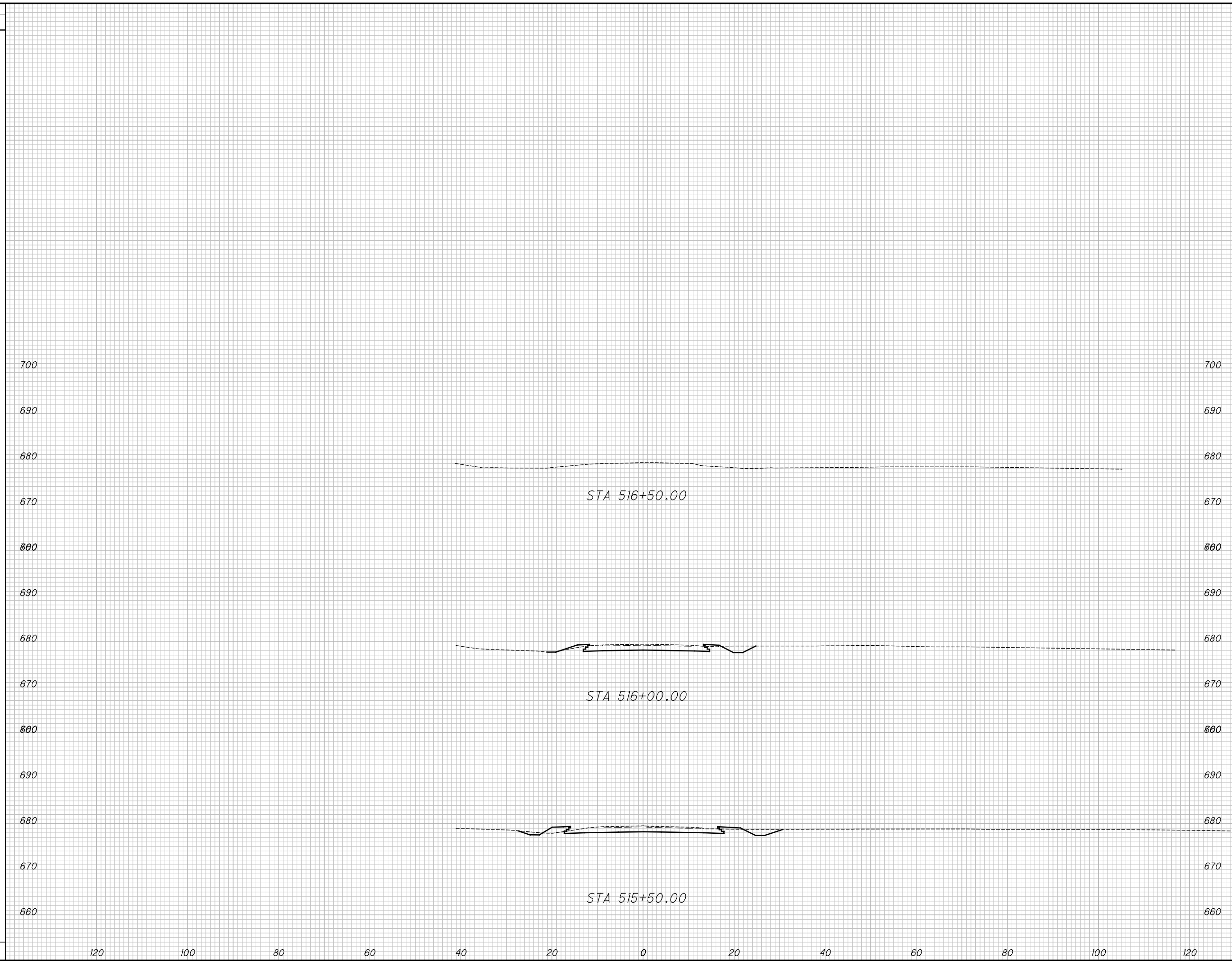

END AREA		VOLUME		CALCULATED XXX	CHECKED XXX
CUT	FILL	CUT	FILL		

**CROSS SECTIONS SR 295**  
**STA. 515+50.00 TO STA. 516+50.00**

**LUC-20A - 3.55 / 4.55**



M:\2002 (0001 D2 - Structural)\Task 2C - LUC-20A-3.55 4.55 (PID 94407) Roundabouts\94407\_LUC-20A-3.55\Design\Roadway\Sheets\94407\_XS004.dgn Sheet 4/29/2020 8:40:38 AM SEA

SEEDING	
END WIDTH	SO. YDS.

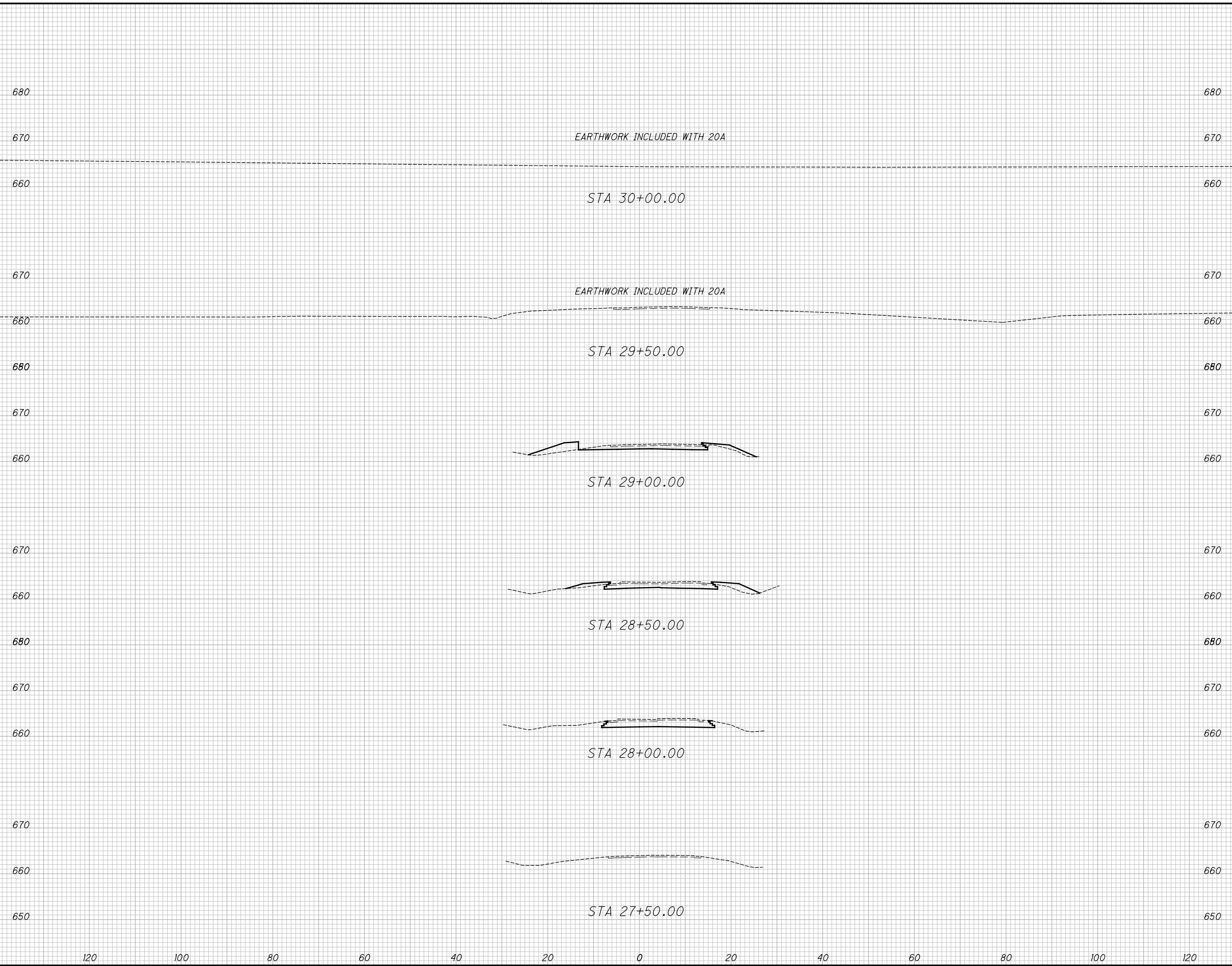

END AREA		VOLUME	
CUT	FILL	CUT	FILL

CALCULATED XXX	CHECKED XXX
<b>CROSS SECTIONS WHITEHOUSE SPENCER</b>	
<b>STA. 27+50.00 TO STA. 30+00.00</b>	
<b>LUC-20A-3.55 / 4.55</b>	

SEEDING	
END WIDTH	SO. YDS.

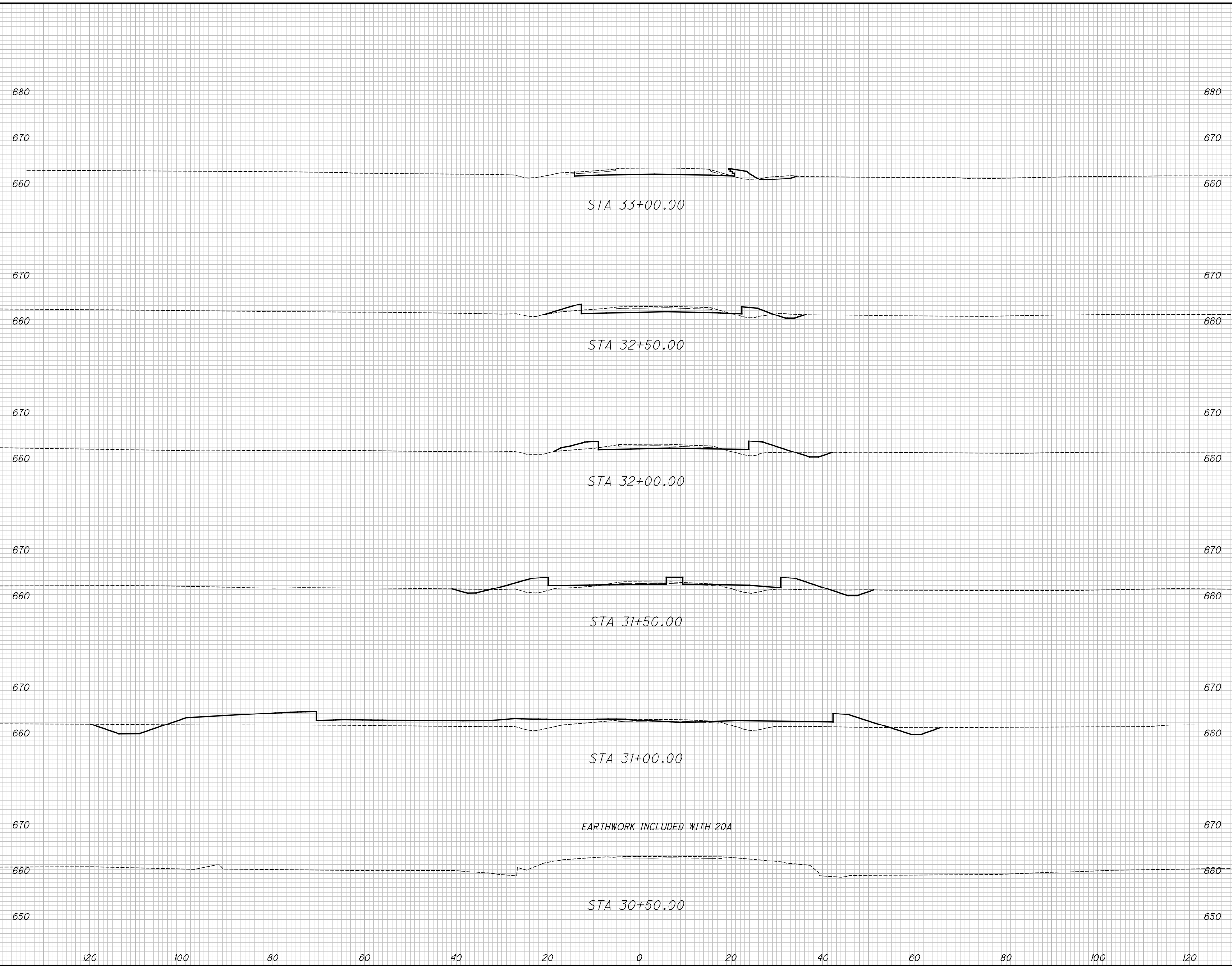

END AREA		VOLUME	
CUT	FILL	CUT	FILL

**CROSS SECTIONS WHITEHOUSE SPENCER**  
**STA. 30+50.00 TO STA. 33+00.00**

**LUC-20A - 3.55 / 4.55**

CALCULATED	XXX
CHECKED	XXX





SEEDING	
END WIDTH	SO. YDS.

END AREA		VOLUME		CALCULATED XXX	CHECKED XXX
CUT	FILL	CUT	FILL		



**CROSS SECTIONS WHITEHOUSE SPENCER**  
**STA. 33+50.00 TO STA. 34+00.00**

**LUC-20A - 3.55 / 4.55**

