



CALCULATED  
BAA  
CHECKED  
DMG

**STORM SEWER ANALYSIS  
DRAINAGE AREAS**

**MIA-C.R. 25A-3.54**



DRAINAGE AREA TO  
EX. CB, DRAINAGE  
AREA WITHIN EX. R/W,  
EX. C = 0.9 &  
PR. C = 0.9

EX2  
2.11 AC  
C = 0.30

D2  
0.30 AC  
C = 0.58

D4  
0.35 AC  
C = 0.60

D6  
0.35 AC  
C = 0.78

D3  
0.26 AC  
C = 0.90

D5  
0.27 AC  
C = 0.90

D7  
0.27 AC  
C = 0.90

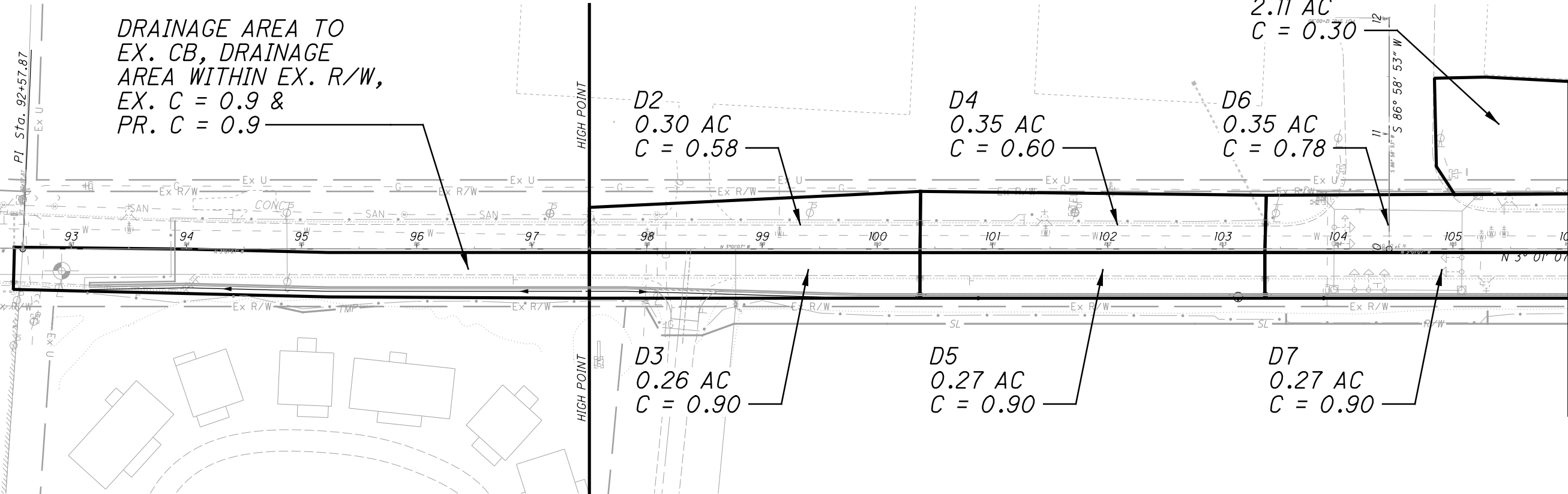

D6  
0.35 AC  
C = 0.78

D8  
0.34 AC  
C = 0.71

D10  
0.33 AC  
C = 0.60

EX2  
2.11 AC  
C = 0.30

D12  
0.32 AC  
C = 0.78

D14  
0.21 AC  
C = 0.78

D25  
0.08 AC  
C = 0.90

D15  
0.44 AC  
C = 0.9

D9  
0.27 AC  
C = 0.90

D11  
0.28 AC  
C = 0.90

D13  
0.28 AC  
C = 0.90

D23  
2.19 AC  
C = 0.30

D15  
0.44 AC  
C = 0.9

D25  
0.08 AC  
C = 0.90

D21  
0.16 AC  
C = 0.90

DITCH AREAS (TYP.),  
SEE DITCH CALCS  
FOR DETAILS

MATCH LINE STA. 106+00, SEE ABOVE

LOW POINT

LOW POINT

EQUATION:  
Sta 116+30.44 BK =  
Sta 7+98.00 AH

PC STA. 7+98.00