

MOE-TR2001-00.13

MODEL: Sheet PAPER SIZE: 17x11 (in.) DATE: 1/31/2023 TIME: 2:06:28 PM USER: harrifield  
 P:\ADRI\2022\22-089 MOE-TR2001-00.13 (PID 117522) Design Build Scope\117522-400-Engineering\Structures\SFN\_5630290\Sheets\117522\_SFN\_5630290\_SF001.dgn

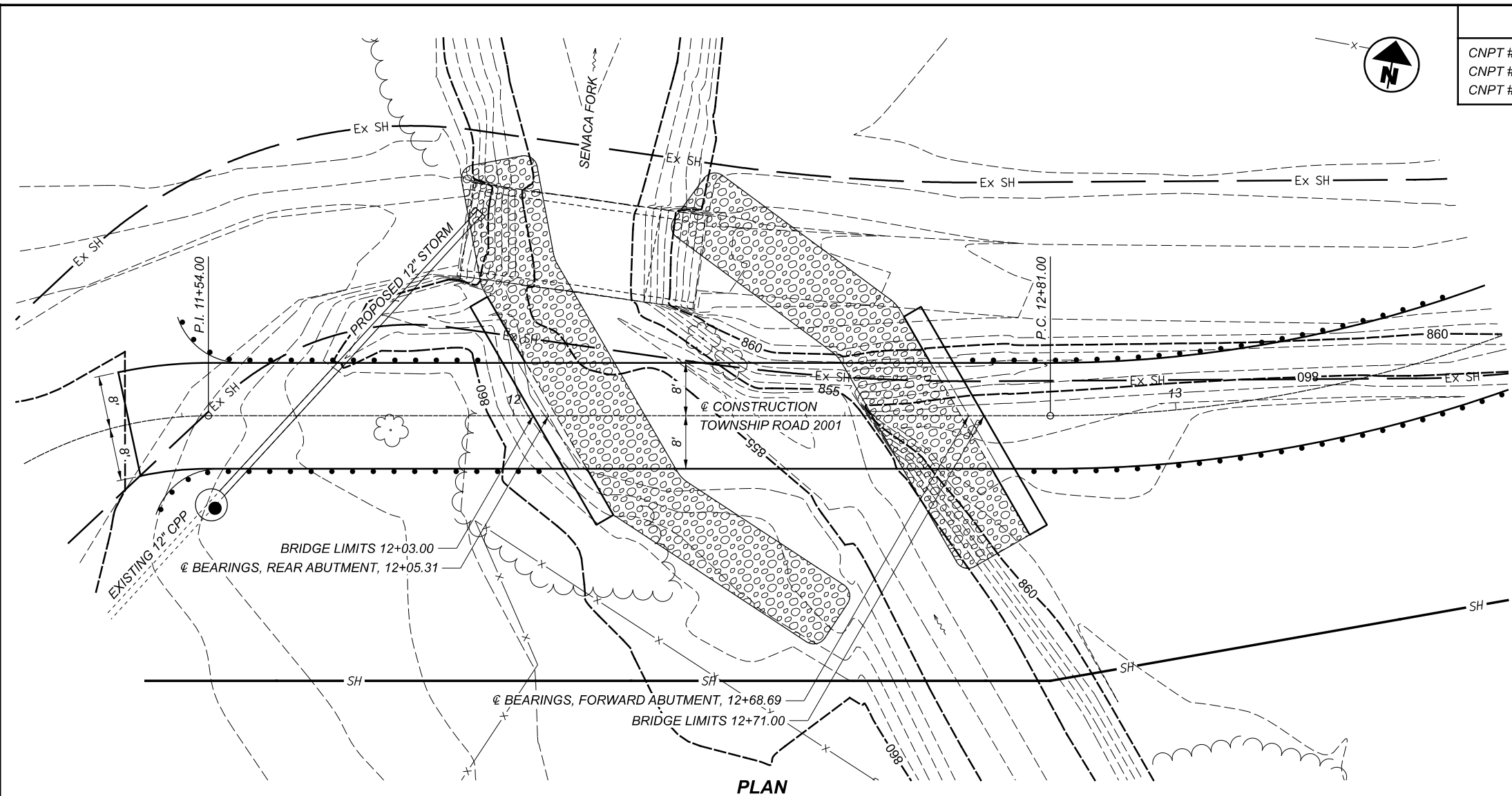

**PLAN**

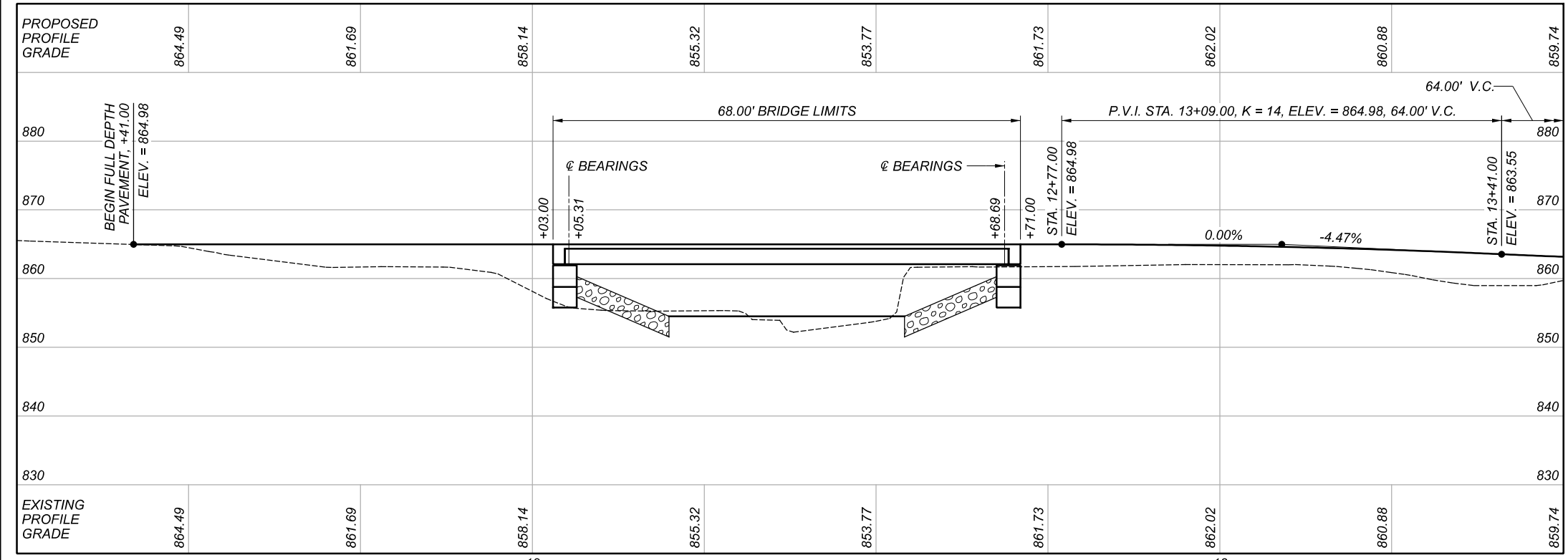

**PROFILE ALONG & CONSTRUCTION**

**CONTROL DATA TABLE**

CNPT #100	675,900.667 NORTH	2,314,733.256 WEST	ELEV. 861.31	REBAR SET
CNPT #101	676,175.676 NORTH	2,314,778.360 WEST	ELEV. 861.17	REBAR SET
CNPT #102	675,828.640 NORTH	2,314,476.319 WEST	ELEV. 864.24	REBAR SET

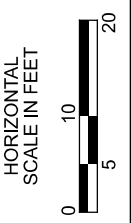

**NOTES**

DESIGN TRAFFIC:  
 2022 ADT = <400                      2022 ADTT = NOT AVAILABLE  
 2042 ADT = <400                      2042 ADTT = NOT AVAILABLE

**LEGEND**

ROCK CHANNEL PROTECTION.

**HYDRAULIC DATA**

DRAINAGE AREA = 16.9 SQUARE MILES  
 Q (10) = 2,590 CFS  
 Q (100) = 5,250 CFS

**EXISTING STRUCTURE**

TYPE: SINGLE SPAN ROLLED STEEL WITH STACKED STONE ABUTMENTS, H-PILE SUPPORTS, AND A TIMBER DECK.  
 SPANS: 28'-3"± FACE-TO-FACE ABUTMENT  
 ROADWAY: 14'-3"±  
 LOADING: H 20  
 SKEW: NONE  
 WEARING SURFACE: WOOD OR TIMBER  
 APPROACH SLABS: NONE  
 ALIGNMENT: TANGENT  
 CROWN: NONE  
 STRUCTURE FILE NUMBER: 5630290  
 DATE BUILT: 1900  
 DISPOSITION: TO BE REPLACED

**PROPOSED STRUCTURE**

TYPE: SINGLE SPAN STRUCTURE - COMPOSITE BOX BEAM WITH INTEGRAL ABUTMENT SHOWN  
 SPANS: 63.38' CENTER TO CENTER OF BEARINGS  
 ROADWAY: 16'-0" FACE TO FACE OF RAIL  
 LOADING: HL93 AND 0.06 KSF FUTURE WEARING SURFACE  
 SKEW: 30° RIGHT FORWARD  
 WEARING SURFACE: 1" MONOLITHIC CONCRETE  
 APPROACH SLABS: NONE  
 ALIGNMENT: TANGENT  
 CROWN: 0.016 FT/FT  
 DECK AREA: 1,088 SQUARE FEET  
 COORDINATES: LATITUDE 39°50'56.61" NORTH  
 LONGITUDE 81°16'02.48" WEST

**SITE PLAN**  
**BRIDGE NO. MOE-TR2001-00.13**  
**OVER SENECA FORK**

SFN	0
DESIGN AGENCY	
DESIGNER	JTH
CHECKER	BCK
REVIEWER	RBK
PROJECT ID	117522
SUBSET	TOTAL
1	1
SHEET	TOTAL
1	2