

STATE OF OHIO DEPARTMENT OF TRANSPORTATION

MRG-60-14.11 Center Lane

MORGAN COUNTY
MORGAN TOWNSHIP

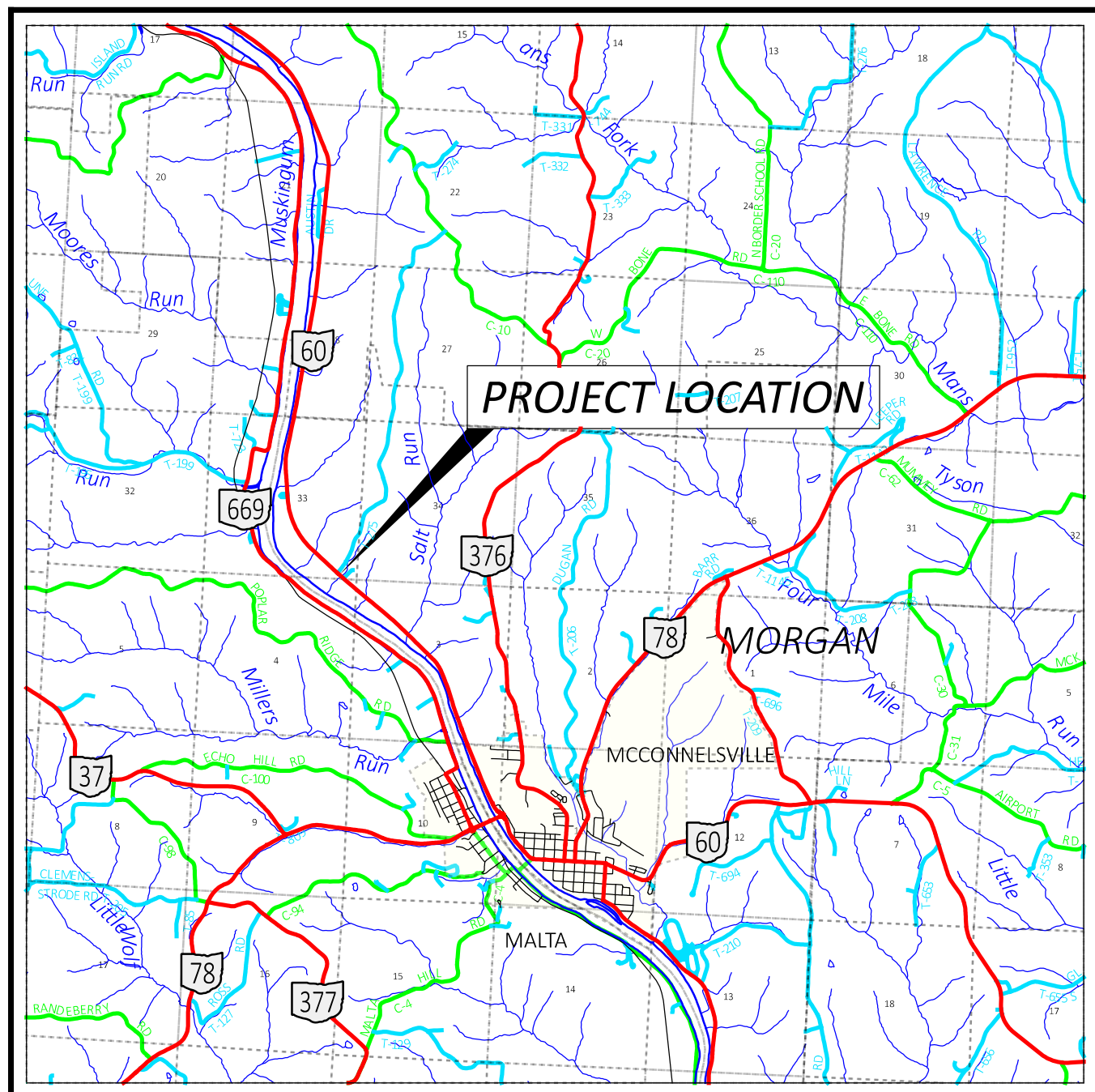

LOCATION MAP
LATITUDE: 39°40'30.8" LONGITUDE: 81°52'46.8"

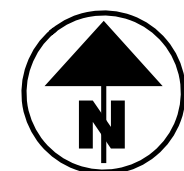

PORTION TO BE IMPROVED	=====
INTERSTATE HIGHWAY	=====
FEDERAL ROUTES	=====
STATE ROUTES	=====
COUNTY & TOWNSHIP ROADS	=====
OTHER ROADS	-----

DESIGN DESIGNATION

CURRENT ADT (2023)	5400
DESIGN YEAR ADT (2043)	5900
DESIGN HOURLY VOLUME (2043)	600
DIRECTIONAL DISTRIBUTION	69.2%
TRUCKS (24 HOUR B&C)	8%
DESIGN SPEED	55
LEGAL SPEED	55
DESIGN FUNCTIONAL CLASSIFICATION:	
MINOR ARTERIAL	
NHS PROJECT	NO

DESIGN EXCEPTIONS

NONE

ADA DESIGN WAIVERS

NONE

UNDERGROUND UTILITIES
Contact Two Working Days
Before You Dig

OHIO811.org
Before You Dig

OHIO 811, 8-1-1, or 1-800-362-2764
(Non members must be called directly)

PLAN PREPARED BY:
ODOT
DISTRICT 10
CAPITAL PROGRAMS

ENGINEER'S SEAL
ROADWAY

INDEX OF SHEETS:

TITLE SHEET	1
SCHEMATIC PLAN	2
TYPICAL SECTION	3-4
GENERAL NOTES	5-6
MAINTENANCE OF TRAFFIC	7-16
GENERAL SUMMARY	17-18
PAVEMENT CALCS./SUBSUMMARIES	19
PROJECT SITE PLAN	20
PLAN AND PROFILE	21-27
PLAN AND PROFILE SUBSUMMARY	28
CROSS SECTIONS	29-49
SUPERELEVATION TABLE	50
TR 275 DETAIL/DRIVE SUBSUMMARY	51
DRIVEWAY PLAN SHEETS	52-53
DRIVEWAY PROFILE SHEETS	54-55
TR 275/DRIVEWAY TYPICAL SECTIONS	56
DRIVEWAY CULVERT PROFILES	57-58
CULVERT DETAIL STA. 754+48.48	59
REINFORCED SLOPE SECTION	60
SIGN PLAN	61-62
RIGHT OF WAY	

STANDARD CONSTRUCTION DRAWINGS								SUPPLEMENTAL SPECIFICATIONS		SPECIAL PROVISIONS	
BP-3.1	1/21/22	HL-10.11	7/15/22	DM-1.1	7/17/20	MT-96.11	4/16/21	MGS-1.1	7/16/21	800 04/21/23	WATERWAY 6/12/23
BP-3.2	1/18/19	HL-10.12	1/20/23	DM-1.2	7/16/21	MT-97.10	4/19/19	MGS-2.1	1/19/18	832 07/15/22	
BP-4.1	7/19/13	HL-10.13	1/20/23	DM-1.3	7/18/14	MT-97.11	1/20/17	MGS-4.2	7/19/13	839 07/16/21	
		HL-20.11	10/21/22	DM-4.3	1/15/16	MT-99.30	1/17/20			939 01/17/20	
CB-2-2A, 2B, 2C	1/20/23	HL-30.11	1/15/21	DM-4.4	1/15/16	MT-101.70	4/26/23	RM-4.2	4/17/20		
CB-2-3, 2-4	1/20/23	HL-40.10	7/17/20			MT-101.75	1/17/20				
MH-3	7/16/21	HL-40.20	7/15/22			MT-101.90	7/17/20				
		HL-50.11	1/16/15			MT-102.10	1/17/20				
TC-41.20	10/18/13	HL-60.11	7/21/17								
TC-41.30	4/26/23	HL-60.12	7/16/21								
TC-42.20	10/18/13										
TC-61.30	7/19/19										
TC-65.10	1/17/14										
TC-65.11	7/15/22										

FEDERAL PROJECT NUMBER

NON-FEDERAL

RAILROAD INVOLVEMENT

NONE

PROJECT DESCRIPTION

WIDENING OF 0.4 MILES OF SR60, NORTH OF MCCONNELSVILLE IN MORGAN COUNTY, TO FACILITATE CONSTRUCTION OF A TWO-WAY CENTER LEFT TURN LANE. PROJECT INTENDS TO IMPROVE SAFETY AND MOVEMENT OF LEFT TURNING TRAFFIC TO ADJACENT MANUFACTURING PLANTS AND RETAIL BUSINESSES.

EARTH DISTURBED AREAS

PROJECT EARTH DISTURBED AREA:	1.94 ACRES
ESTIMATED CONTRACTOR EARTH DISTURBED AREA:	0.25 ACRES
NOTICE OF INTENT EARTH DISTURBED AREA:	2.28 ACRES

2023 SPECIFICATIONS

THE STANDARD SPECIFICATIONS OF THE STATE OF OHIO, DEPARTMENT OF TRANSPORTATION, INCLUDING SUPPLEMENTAL SPECIFICATIONS LISTED IN THE PLANS AND CHANGES LISTED IN THE PROPOSAL SHALL GOVERN THIS IMPROVEMENT.

I HEREBY APPROVE THESE PLANS AND DECLARE THAT THE MAKING OF THIS IMPROVEMENT WILL NOT REQUIRE THE CLOSING TO TRAFFIC OF THE HIGHWAY AND THAT PROVISIONS FOR THE MAINTENANCE AND SAFETY OF TRAFFIC WILL BE AS SET FORTH ON THE PLANS AND ESTIMATES.

Rich Oster
District 10 Deputy Director

Jack Marchbanks, PhD
Director, Department of Transportation





MRG-60-14.11

MODEL: Sheet PAPER: 34x22 (in.) DATE: 11/17/2023 TIME: 1:59:49 PM USER: mpenneck pvc:\ohiodot-pw-bentley.com\ohiodot-pw-02\Documents\01 Active Projects\District 10\Morgan\115604\400-Engineering\Roadway\Sheets\115604_GT001.dgn

MRG-60-14.11

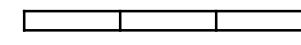
DESIGN AGENCY
DESIGNER
MVP
REVIEWER
EPR 07/07/23
PROJECT ID
115604
SHEET TOTAL
1 62

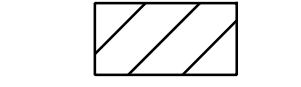
Legend

-  Portable Concrete Barrier, Unanchored
-  WORK ZONE IMPACT ATTENUATOR, 24" WIDE HAZARDS, (UNIDIRECTIONAL)
-  Phase 1 Construction
-  DRUMS SPACED AT 10' CENTER TO CENTER

****AS DIRECTED BY THE ENGINEER, IF IT IS DEEMED THAT THE MIN. 10' LANE WIDTH NEEDS WIDENED, THE FOLLOWING QUANTITY MAY BE USED TO EXPAND THE NORTH BOUND SHOULDER BY 2' FOR THE LENGTH OF THE PROJECT.**

ITEM 615 - PAVEMENT FOR MAINTAINING TRAFFIC, CLASS B - 2FT X 2248FT / 9 = 500 SY

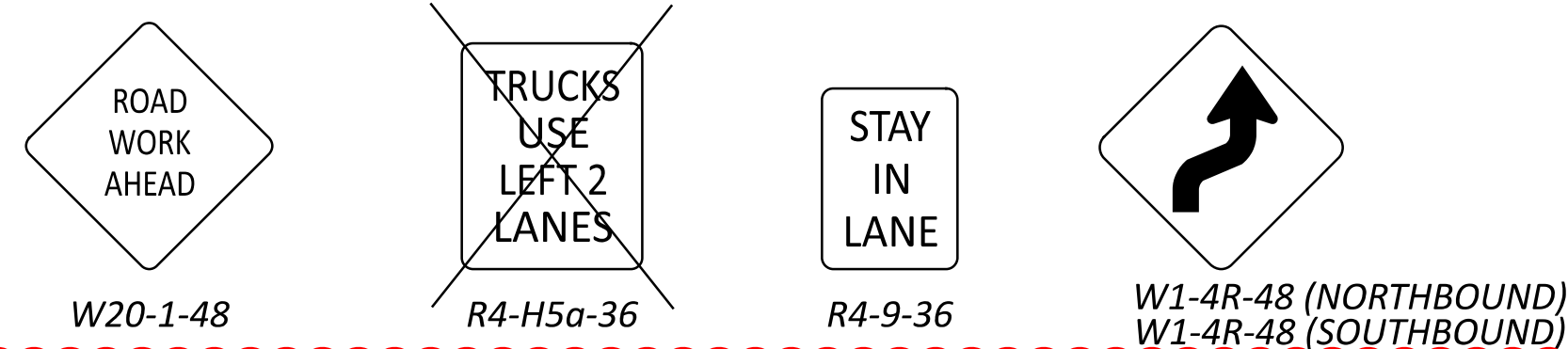

THE CONTRACTOR SHALL WORK WITH THE ENGINEER TO UTILIZE (2) EXISTING PORTABLE CHANGEABLE MESSAGE SIGNS OWNED BY DISTRICT 10 TO SERVE AS ADVANCED WARNING FOR "TRAFFIC PATTERN CHANGES", "LANE SHIFTS", "NARROW LANES", AND/OR ANY OTHER MESSAGES DEEMED APPROPRIATE BY THE ENGINEER. THE CONTRACTOR SHALL COORDINATE WITH RODNEY WECKBACHER, DISTRICT 10 TRAFFIC DEPT., 740-568-3976, A MINIMUM OF 30 DAYS PRIOR TO NEED FOR THESE MESSAGE BOARDS.

SHEET NO.	STATION		PHASE	614				615		616	622		626
				WORK ZONE IMPACT ATTENUATOR, 24" WIDE HAZARDS, (UNIDIRECTIONAL)	OBJECT MARKER, ONE WAY	WORK ZONE CENTER LINE, CLASS I, 740.06, TYPE I	WORK ZONE EDGE LINE, CLASS I, 740.06, TYPE I, 4"	PAVEMENT FOR MAINTAINING TRAFFIC, CLASS A, AS PER PLAN	PAVEMENT FOR MAINTAINING TRAFFIC, CLASS B	WATER	PORTABLE BARRIER, ANCHORED	PORTABLE BARRIER, UNANCHORED	BARRIER REFLECTOR, TYPE 1
				EACH	EACH	MILE	MILE	SY	SY	MGAL	FT	FT	EACH
1	743+64.32	747+68.24	1	5	6	0.10	0.20	SEE SHEET 7 MAINT. OF TRAFFIC NOTES	72	4		178	7
2	747+68.24	751+83.25	1	2	7	0.11	0.22		92	4		295	8
2	751+83.25	755+98.25	1	3	5	0.08	0.16		92	4	132	81	6
3	755+98.25	760+13.25	1	2	6	0.08	0.16		92	4		348	8
3	760+13.25	764+28.25	1	3	7	0.08	0.16	92	4		187	7	
4	764+28.25	766+12.86	1	1	6	0.09	0.18	59	3		125	7	
TOTALS CARRIED TO GEN SUM				16	37	0.54	1.07	500	24	132	1214	43	

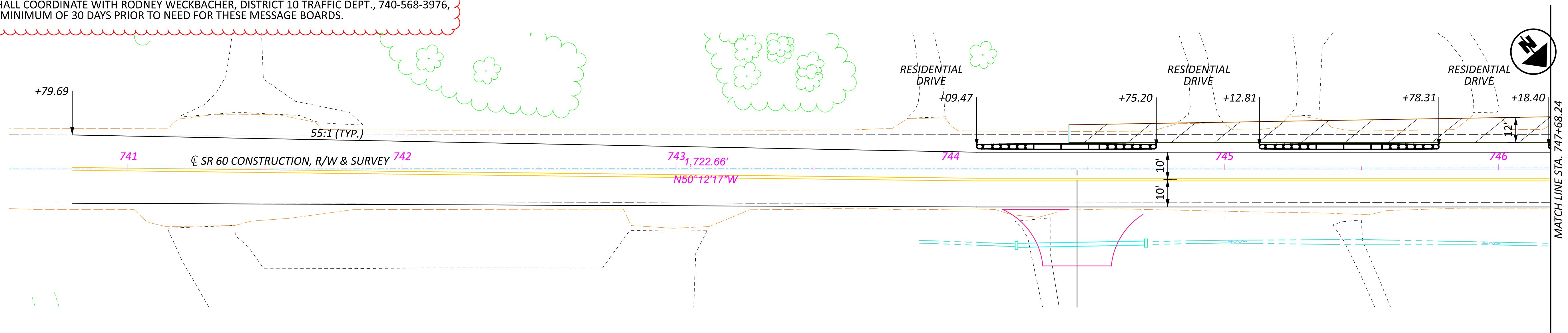

- 1 ITEM 441 - 1.75" ASPHALT CONCRETE INTERMEDIATE COURSE, TYPE 2, (448)
- 2 ITEM 301 - 6" BASE (449), PG64-22
- 3 ITEM 304 - AGGREGATE BASE (6")
- MT ITEM 615 - PAVEMENT FOR MAINTAINING TRAFFIC, CLASS A, AS PER PLAN
- A YEAR 1929 CONCRETE
- B 8.5" ± EXISTING ASPHALT
- C ITEM 615 - PAVEMENT FOR MAINTAINING TRAFFIC, CLASS B

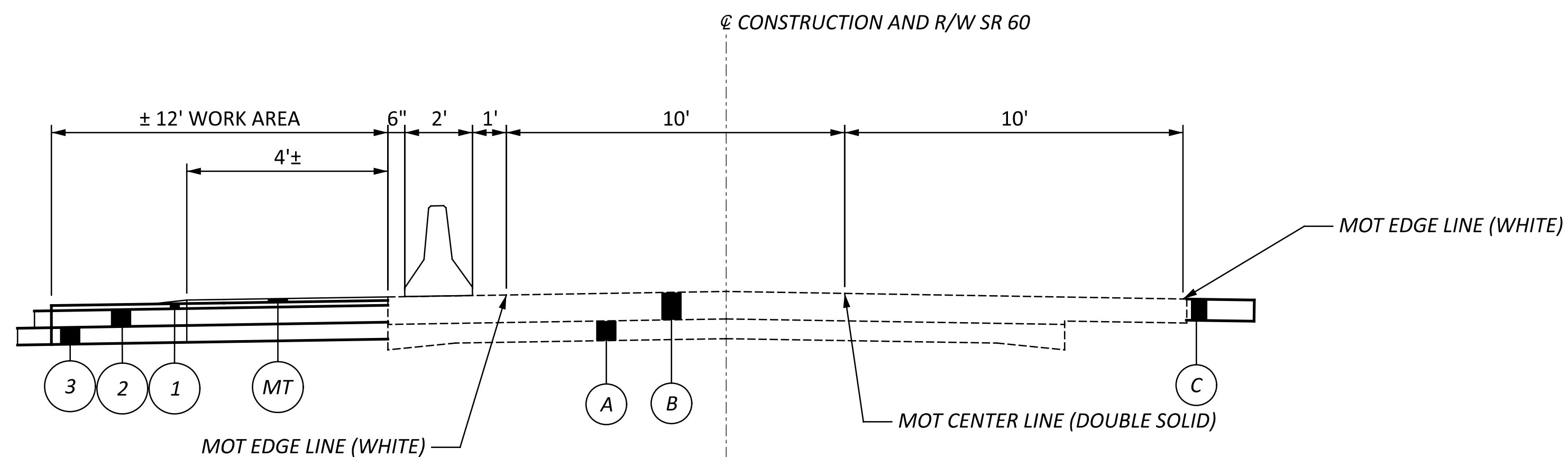

NOTE: CORRECTED PAVEMENT CROSS SLOPE SHALL BE ACHIEVED BY MILLING IN MOT PHASE 3. PAVEMENT FOR MAINTAINING TRAFFIC IN PHASE 1 WILL BE VARIABLE DEPTH AND WIDTH TO PROVIDE A REASONABLE PAVEMENT CROSS SLOPE FOR TRAFFIC IN PHASE 2. THIS MATERIAL WILL BE REMOVED IN PHASE 3 MILLING OPERATION ALONG WITH EXISTING PAVEMENT.







**MAINTENANCE OF TRAFFIC
PHASE 1**

DESIGN AGENCY

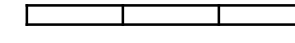

DESIGNER	MVP
REVIEWER	EPR
PROJECT ID	07/07/23
	115604
SHEET	TOTAL
8	62

Legend

-  Portable Concrete Barrier, Unanchored
-  WORK ZONE IMPACT ATTENUATOR, 24" WIDE HAZARDS, (UNIDIRECTIONAL)
-  Phase 2 Construction
-  DRUMS SPACED AT 10' CENTER TO CENTER

THE SHIFT OF 2-LANE TRAFFIC FOR THIS PROJECT SHALL FOLLOW THE COMBINED GUIDANCE OF SCD MT-96.11 AND MT-102.10.

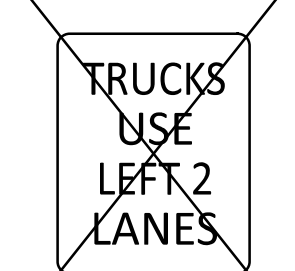
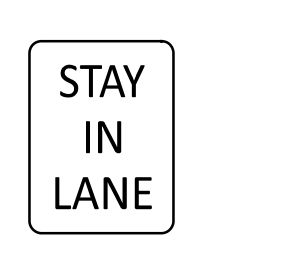
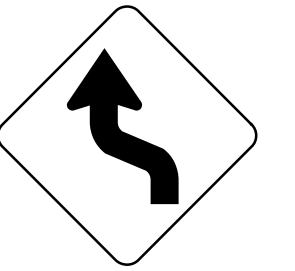
-  ROAD WORK AHEAD
W20-1-48
-  TRUCKS USE LEFT 2 LANES
R4-H5a-36
-  STAY IN LANE
R4-9-36
-  W1-4L-48 (NORTHBOUND)
W1-4R-48 (SOUTHBOUND)

THE CONTRACTOR SHALL WORK WITH THE ENGINEER TO UTILIZE (2) EXISTING PORTABLE CHANGEABLE MESSAGE SIGNS OWNED BY DISTRICT 10 TO SERVE AS ADVANCED WARNING FOR "TRAFFIC PATTERN CHANGES", "LANE SHIFTS", "NARROW LANES", AND/OR ANY OTHER MESSAGES DEEMED APPROPRIATE BY THE ENGINEER. THE CONTRACTOR SHALL COORDINATE WITH RODNEY WECKBACHER, DISTRICT 10 TRAFFIC DEPT., 740-568-3976, A MINIMUM OF 30 DAYS PRIOR TO NEED FOR THESE MESSAGE BOARDS.

SHEET NO.	STATION		PHASE	614				616	622	626
				WORK ZONE IMPACT ATTENUATOR, 24" WIDE HAZARDS, (UNIDIRECTIONAL)	OBJECT MARKER, ONE WAY	WORK ZONE CENTER LINE, CLASS 1, 740.06, TYPE 1	WORK ZONE EDGE LINE, CLASS 1, 740.06, TYPE 1, 4"	WATER	PORTABLE BARRIER, UNANCHORED	BARRIER REFLECTOR, TYPE 1
			EACH	EACH	MILE	MILE	MGAL	FT	EACH	
1	741+33.02	745+95.52	2	1	6	0.09	0.18	4	220	7
2	745+95.52	750+58.67	2	3	6	0.09	0.18	4	308	8
2	750+58.67	755+18.96	2	3	6	0.09	0.18	4	251	6
3	756+18.96	759+81.55	2	4	6	0.09	0.18	4	175	8
3	759+81.55	764+43.96	2	2	6	0.09	0.18	4	304	6
4	764+43.96	769+08.02	2	1	2	0.08	0.16	3	40	2
TOTALS CARRIED TO GEN SUM				14	32	0.53	1.06	26	1298	37

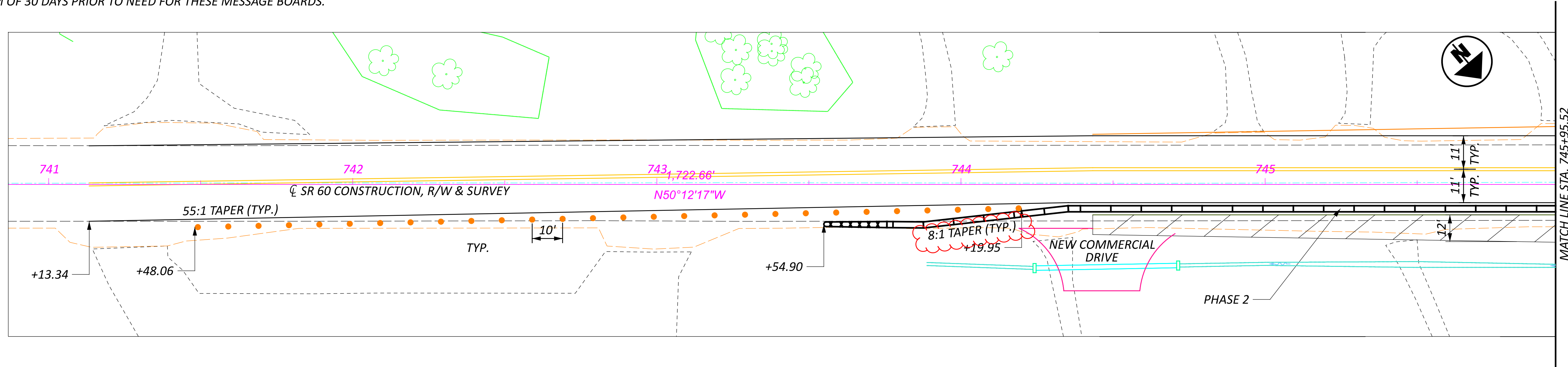

- 1 ITEM 441 - 1.75" ASPHALT CONCRETE INTERMEDIATE COURSE, TYPE 2, (448)
- 2 ITEM 301 - 6" BASE (449), PG64-22
- 3 ITEM 304 - AGGREGATE BASE (6")
- MT ITEM 615 - PAVEMENT FOR MAINTAINING TRAFFIC, CLASS A, APP (FROM PHASE 1)
- A YEAR 1929 CONCRETE
- B 8.5" ± EXISTING ASPHALT

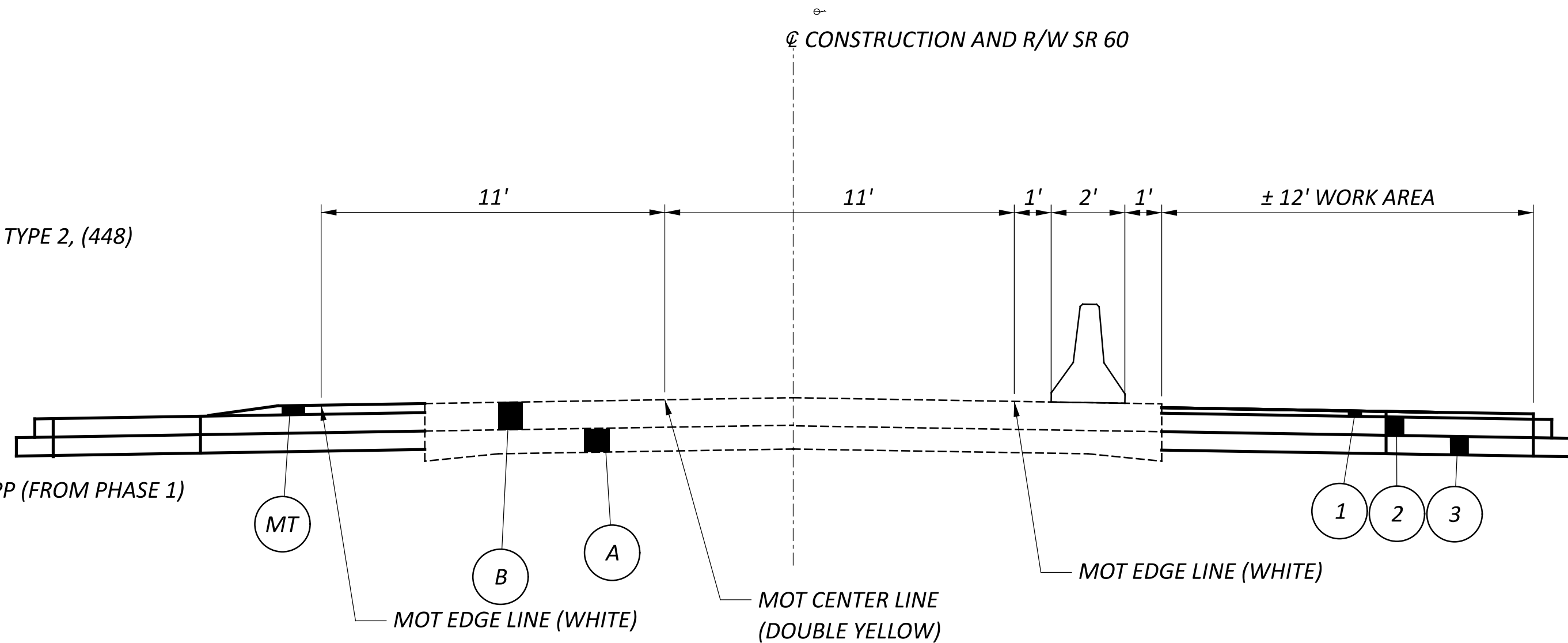

MAINTENANCE OF TRAFFIC
PHASE 2

DESIGN AGENCY



DESIGNER
MVP

REVIEWER

EPR 07/07/23

PROJECT ID

115604

SHEET TOTAL

12 62

MRG-60-14.11

MODEL: SHEET 2 PAPER SIZE: 34x22 (in.) DATE: 11/20/2023 TIME: 6:45:51 AM USER: mpennock
pvc:\ohiodot-pw-bentley.com\ohiodot-pw-02\Documents\01 Active Projects\District 10\Worgan\115604\400-Engineering\Roadway\Sheets\115604_G0001.dgn

SHEET NUM.												PART.	ITEM	ITEM	GRAND	UNIT	DESCRIPTION	SEE SHEET NO.
5	7	8	12	16	19	28	51	61	62			01/STR/44	ITEM	EXT	TOTAL			
					554		18						572	441	10000	572	CY	PAVEMENT ASPHALT CONCRETE SURFACE COURSE, TYPE 1, (446), PG64-22
					396		25						421	441	50300	421	CY	ASPHALT CONCRETE INTERMEDIATE COURSE, TYPE 2, (448)
							617						617	452	12050	617	SY	8" NON-REINFORCED CONCRETE PAVEMENT, CLASS QC MS
																		TRAFFIC CONTROL
													61	621	00100	61	EACH	RPM
													33	621	54000	33	EACH	RAISED PAVEMENT MARKER REMOVED
								3	5				8	630	85100	8	EACH	REMOVAL OF GROUND MOUNTED SIGN AND REERECTION
													0.49	642	00104	0.49	MILE	EDGE LINE, 6", TYPE 1
													0.92	642	00300	0.92	MILE	CENTER LINE, TYPE 1
													8	644	01300	8	EACH	LANE ARROW
													30	644	00500	30	FT	STOP LINE
													288	644	00700	288	FT	TRANSVERSE/DIAGONAL LINE
																		MAINTENANCE OF TRAFFIC
			16	14									30	614	12380	30	EACH	WORK ZONE IMPACT ATTENUATOR, 24" WIDE HAZARDS, (UNIDIRECTIONAL)
			37	32									69	614	13350	69	EACH	OBJECT MARKER, ONE WAY
			0.54	0.53									1.07	614	21000	1.07	MILE	WORK ZONE CENTER LINE, CLASS I
			1.07	1.06									2.13	614	22010	2.13	MILE	WORK ZONE EDGE LINE, CLASS I, 6"
	948												948	615	20001	948	SY	PAVEMENT FOR MAINTAINING TRAFFIC, CLASS A, AS PER PLAN
													500	615	25000	500	SY	PAVEMENT FOR MAINTAINING TRAFFIC, CLASS B
													50	616	10000	50	MGAL	WATER
													2,452	622	41100	2,452	FT	PORTABLE BARRIER, UNANCHORED
													132	622	41110	132	FT	PORTABLE BARRIER, ANCHORED
													80	626	00102	80	EACH	BARRIER REFLECTOR, TYPE 1 Bidirectional
																		INCIDENTALS
													LS	103	05000	LS		PREMIUM FOR CONTRACT PERFORMANCE BOND AND FOR PAYMENT BOND
													LS	614	11000	LS		MAINTAINING TRAFFIC
													LS	623	10000	LS		CONSTRUCTION LAYOUT STAKES AND SURVEYING
													LS	624	10000	LS		MOBILIZATION

GENERAL SUMMARY

DESIGN AGENCY



DESIGNER
MVP

REVIEWER
EPR 07/07/23

PROJECT ID
115604

SHEET TOTAL
18 | 62

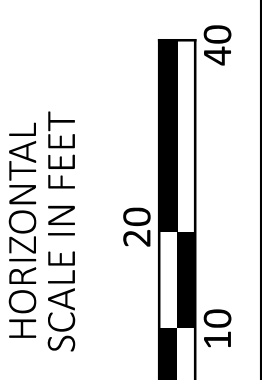
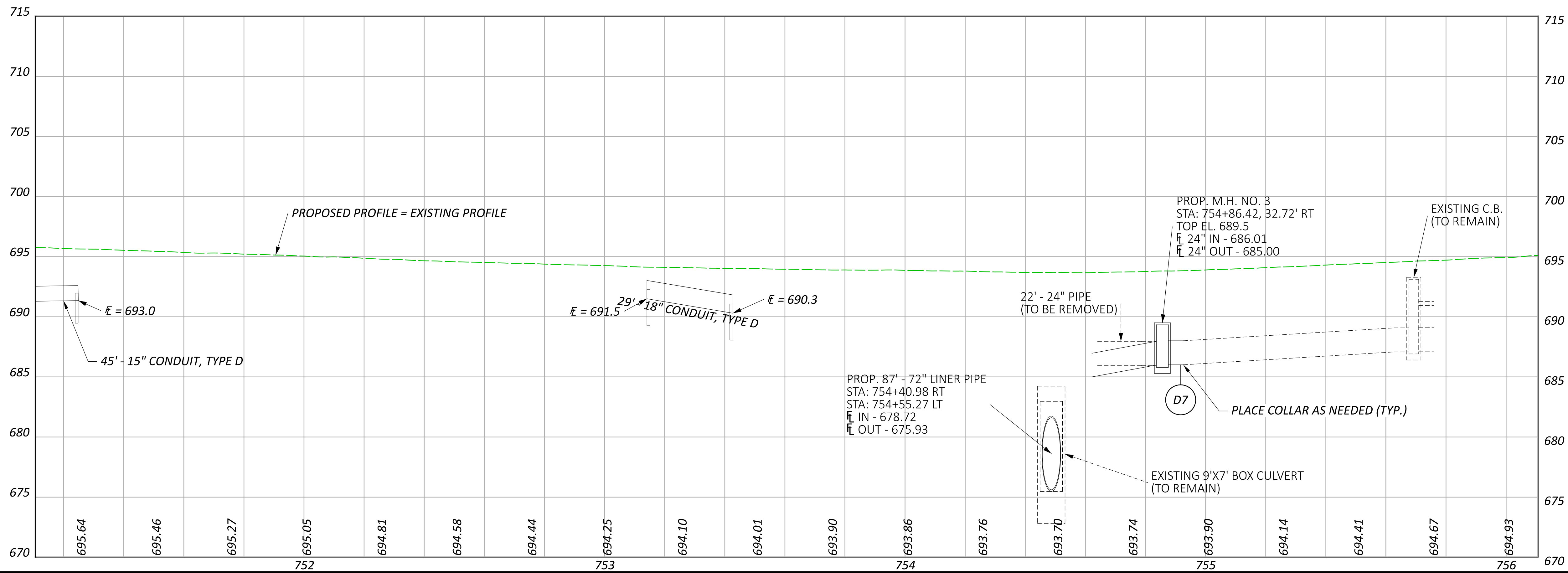
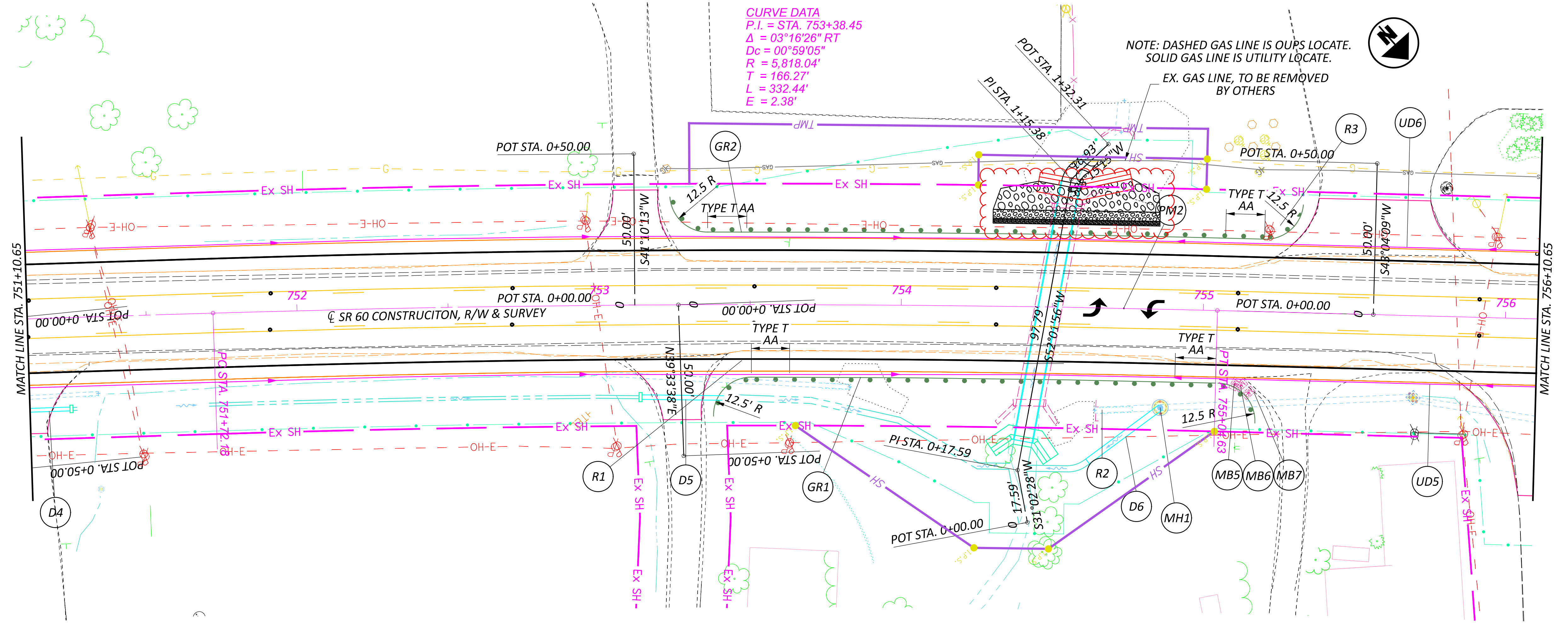

PLAN AND PROFILE
 STA. 751+10.65 TO 756+10.65

DESIGN AGENCY



DESIGNER	EPR
REVIEWER	JDC
DATE	06/14/23
PROJECT ID	115604
SHEET	23
TOTAL	62

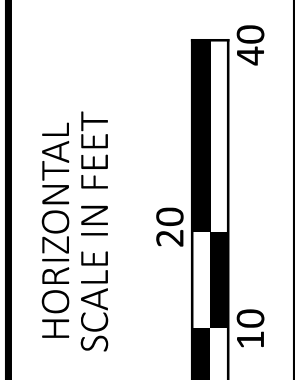
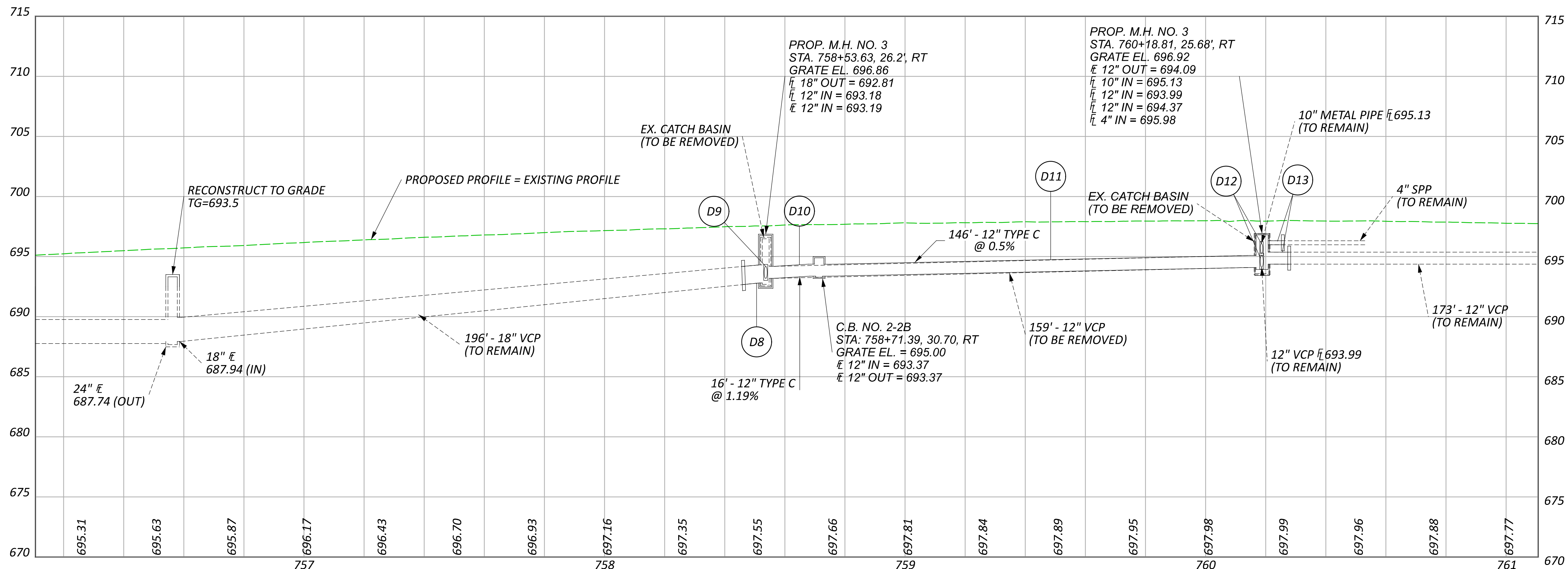
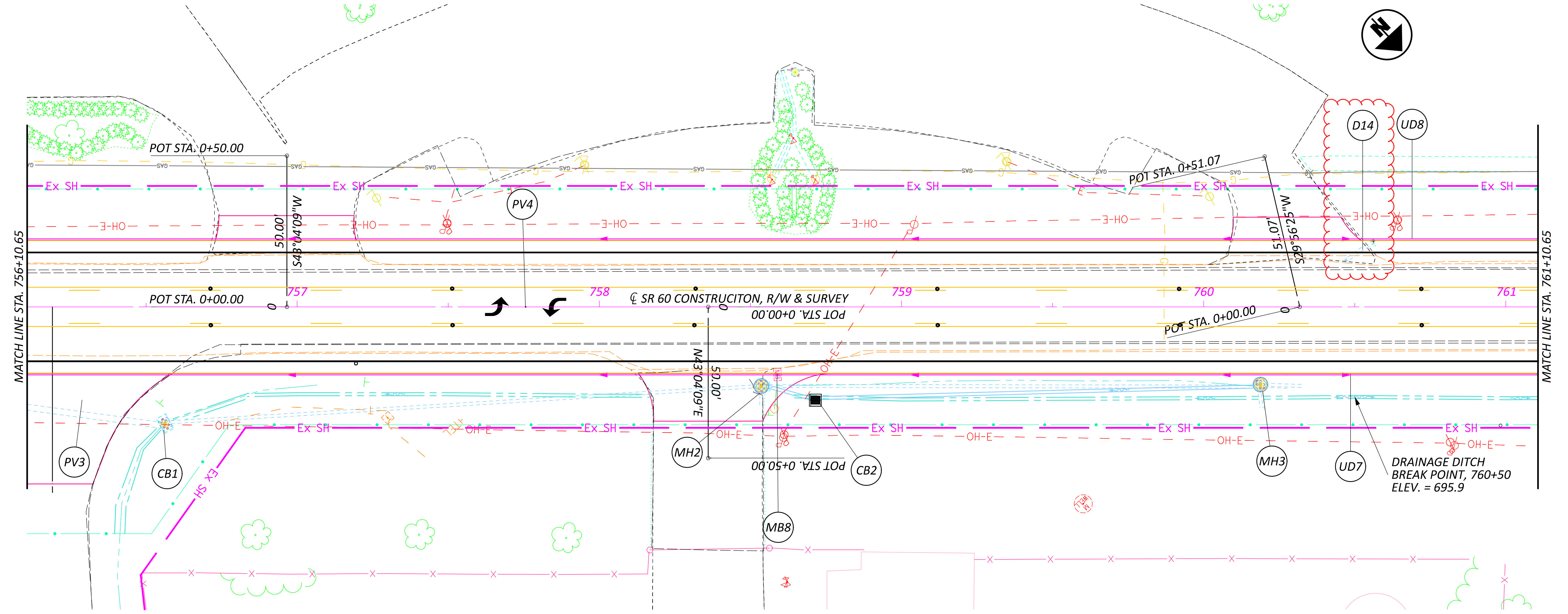

PLAN AND PROFILE
 STA. 756+10.65 TO 761+10.65

DESIGN AGENCY

DESIGNER
 EPR

REVIEWER
 JDC 06/14/23

PROJECT ID
 115604

SHEET TOTAL
 24 62

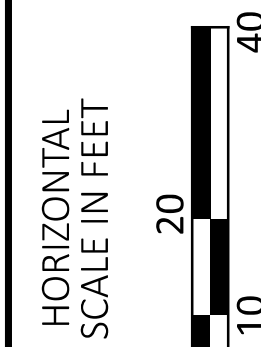
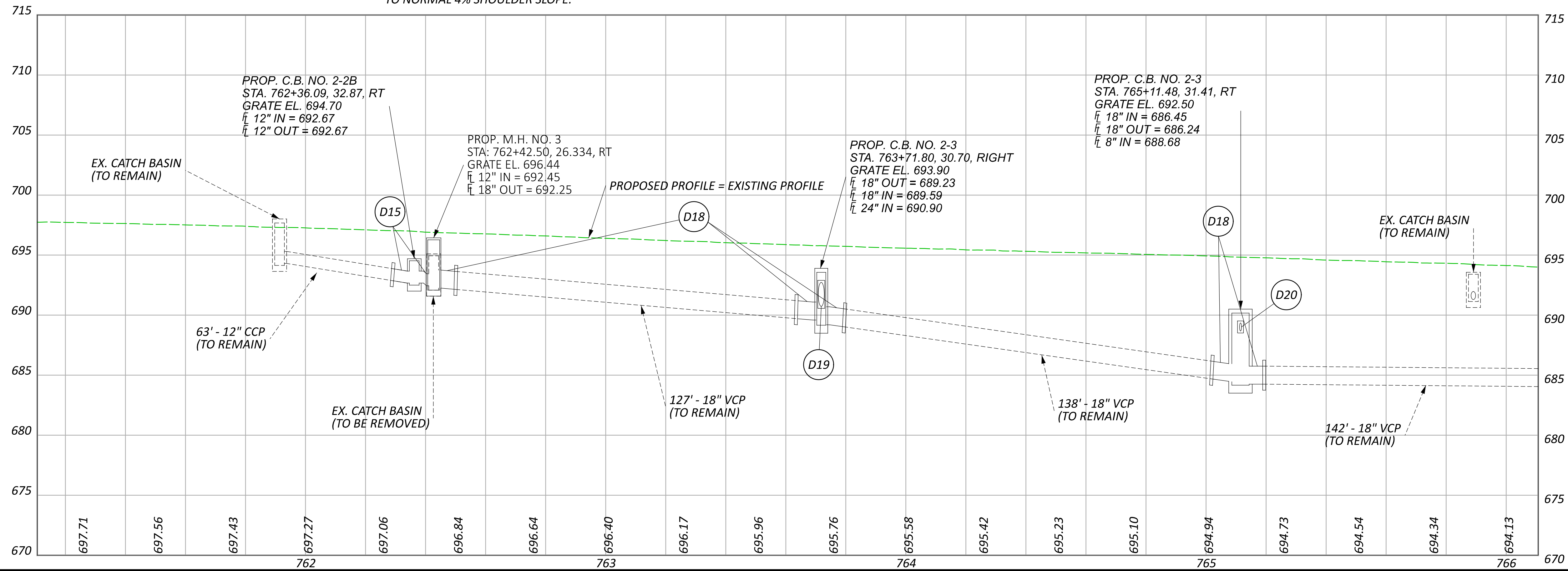
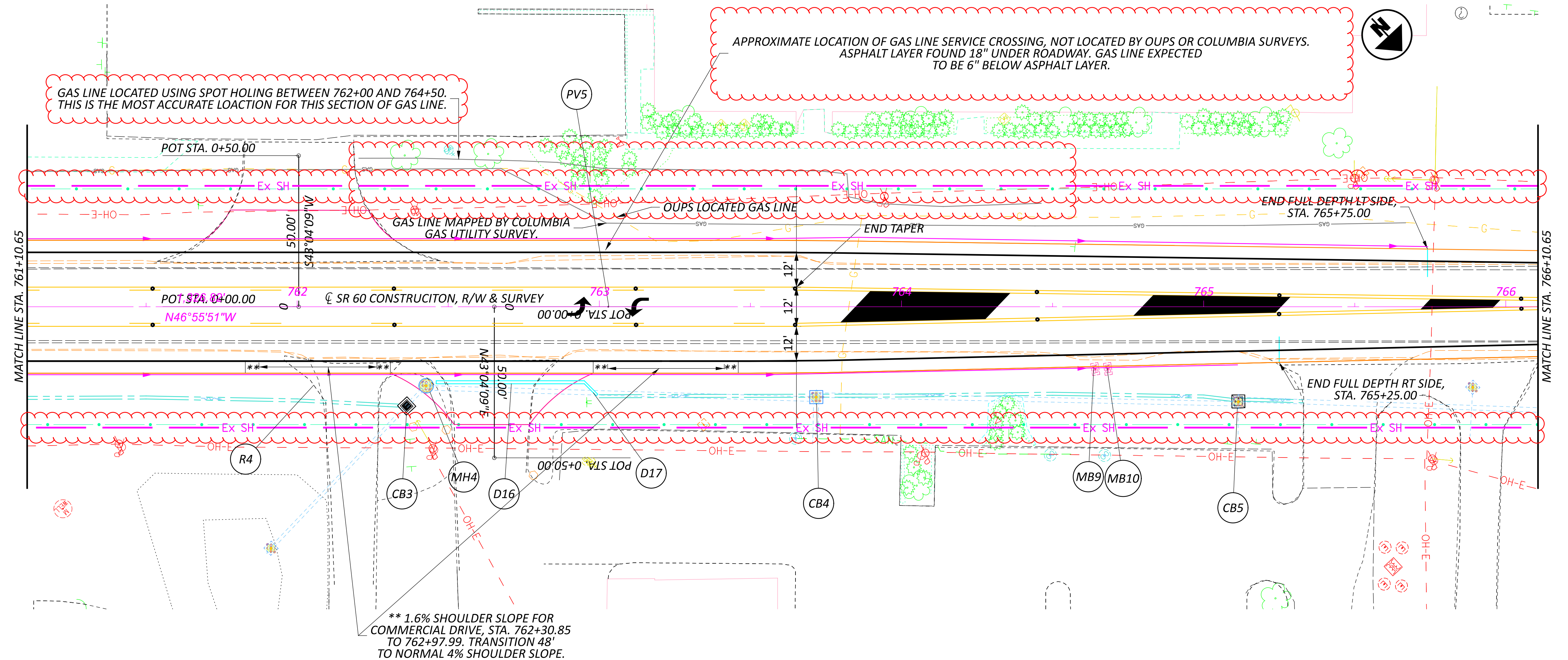

PLAN AND PROFILE
STA. 761+10.65 TO STA. 766+10.65

DESIGN AGENCY



DESIGNER
EPR

REVIEWER
JDC 06/14/23

PROJECT ID
115604

SHEET TOTAL
25 62