

EDGE STEP DETAIL

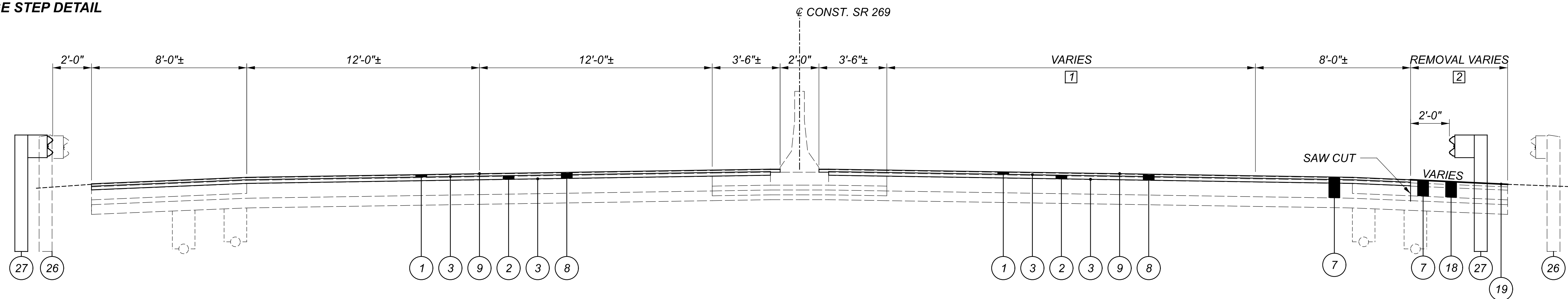

CONST. SR 269
RESURFACING
STA. 544+26.12 TO STA. 549+61.12

- 1 VARIES FROM 24' TO 15.1'
STA. 544+26.12 TO STA. 549+61.12
- 2 VARIES FROM 0' TO 8.8'
STA. 544+26.12 TO STA. 549+61.12

LEGEND

- | | | | |
|---|--|--|---|
| 1 ITEM 442 - 1 1/2" ASPHALT CONCRETE SURFACE COURSE, 12.5 MM, TYPE A (446) | 9 ITEM 875 - LONGITUDINAL JOINT ADHESIVE (@ COLD JOINTS) | 17 ITEM 203 - EXCAVATION | 25 ITEM 605 - 6" BASE PIPE UNDERDRAIN WITH GEOTEXTILE FABRIC, AS PER PLAN, 707.31 |
| 2 ITEM 442 - 2 1/4" ASPHALT CONCRETE INTERMEDIATE COURSE, 19 MM, TYPE A (446) | 10 ITEM 609 - CURB, TYPE 3-B, AS PER PLAN | 18 ITEM 203 - EMBANKMENT | 26 ITEM 202 - GUARDRAIL REMOVED |
| 3 ITEM 407 - TACK COAT | 11 ITEM 609 - COMBINATION CURB AND GUTTER, TYPE 3, AS PER PLAN | 19 ITEM 659 - SEEDING AND MULCHING | 27 ITEM 606 - GUARDRAIL, TYPE MGS |
| 4 ITEM 301 - 6" ASPHALT CONCRETE BASE, PG64-22, (449) | 12 ITEM 609 - COMBINATION CURB & GUTTER, TYPE 9, AS PER PLAN | 20 ITEM 657 - RIPRAP FOR TREE PROTECTION, AS PER PLAN & ITEM 204 - GEOTEXTILE FABRIC | 28 ITEM 653 - TOPSOIL FURNISHED AND PLACED, AS PER PLAN |
| 5 ITEM 304 - 6" AGGREGATE BASE | 13 ITEM 609 - COMBINATION CURB AND GUTTER, TYPE 2, AS PER PLAN | 21 ITEM 204 - 12" EXCAVATION OF SUBGRADE & ITEM 204 - 12" GRANULAR MATERIAL, TYPE D | |
| 6 ITEM 204 - SUBGRADE COMPACTION | 14 ITEM 452 - 8" NON-REINFORCED CONCRETE PAVEMENT CLASS QC 1P, AS PER PLAN | 22 ITEM 204 - GEOTEXTILE FABRIC, TYPE D, 712.09 | |
| 7 ITEM 202 - PAVEMENT REMOVED | 15 ITEM 206 - CEMENT STABILIZED SUBGRADE, 14 INCHES DEEP | 23 ITEM 202 - CONCRETE BARRIER REMOVED | |
| 8 ITEM 254 - PAVEMENT PLANING, ASPHALT CONCRETE, 3 1/4" | 16 ITEM 605 - 6" BASE PIPE UNDERDRAIN WITH GEOTEXTILE FABRIC, 707.31 | 24 ITEM 622 - BARRIER TRANSITION & ITEM 622 - CONCRETE BARRIER END SECTION, TYPE B | |

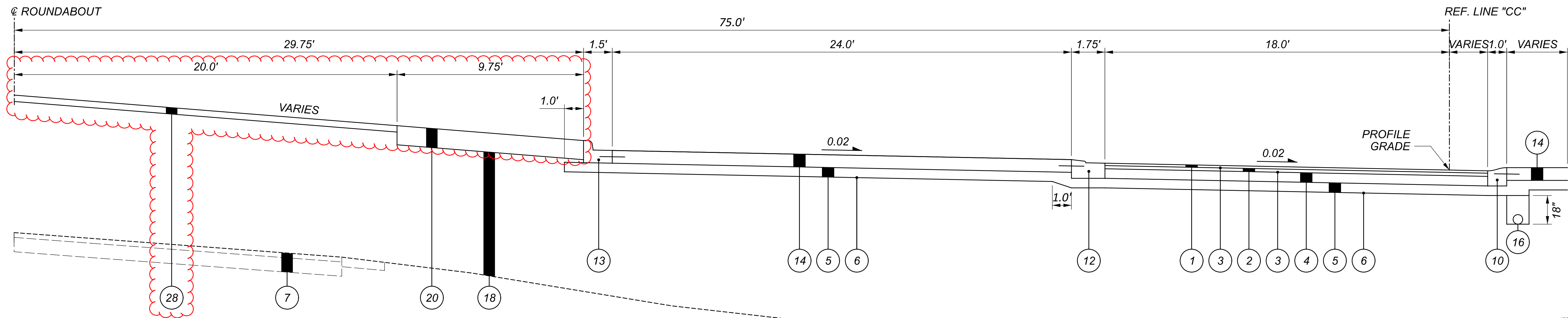

ROUNDAABOUT SECTION SR 269
REF. LINE "CC" STA. 0+00.00 TO STA. 4+71.24

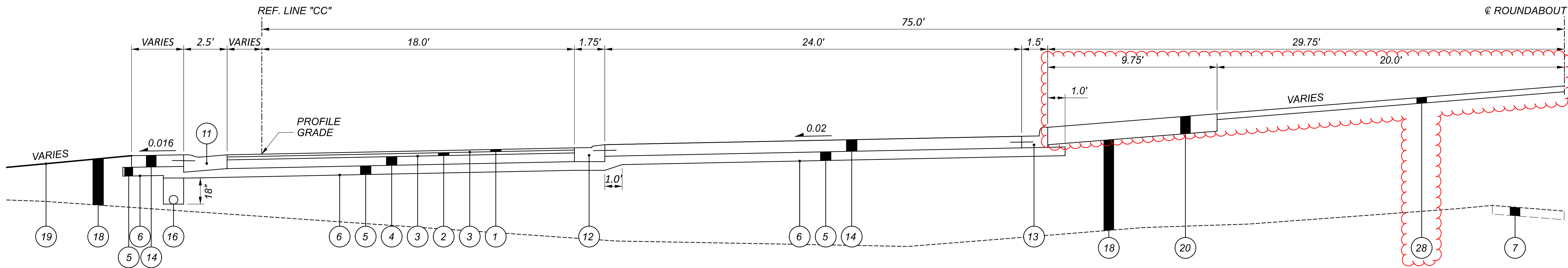

ROUNDAABOUT SECTION SR 269
REF. LINE "CC" STA. 4+71.24 TO STA. 0+00.00

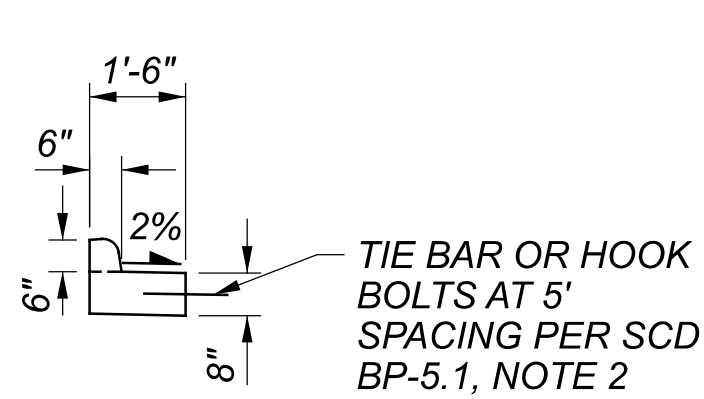

COMBINATION CURB AND GUTTER,
TYPE 2, AS PER PLAN

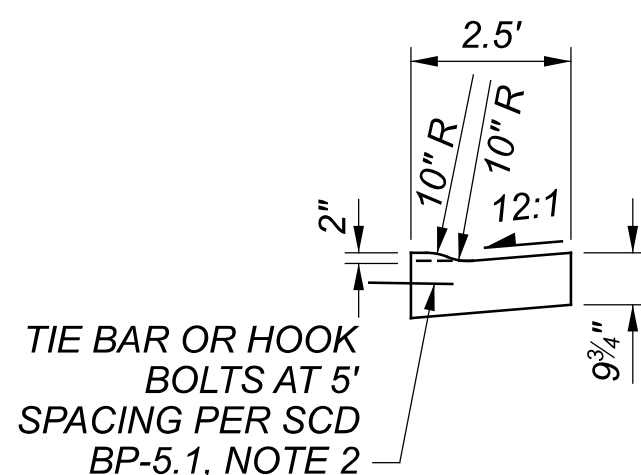

COMBINATION CURB AND GUTTER,
TYPE 3, AS PER PLAN

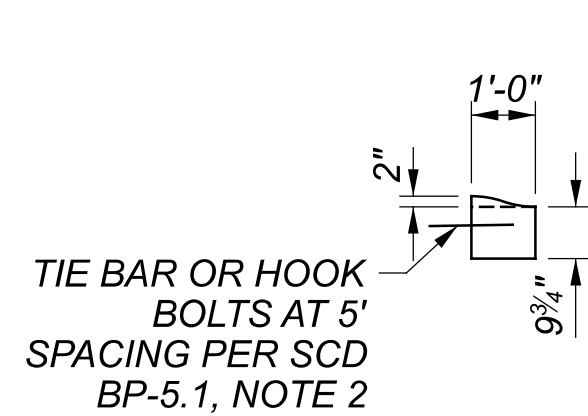

CURB TYPE 3-B, AS PER PLAN

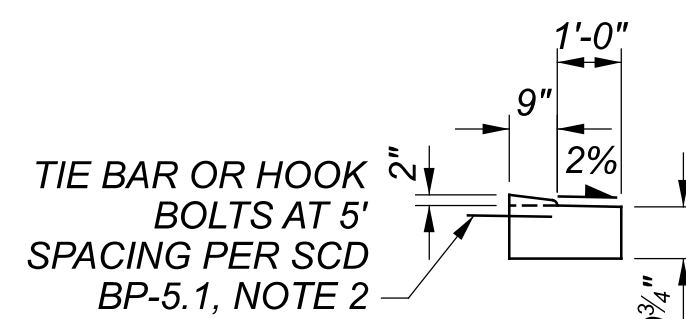

COMBINATION CURB AND GUTTER,
TYPE 9, AS PER PLAN

ITEM 253 - PAVMENT REPAIRS

THE FOLLOWING ESTIMATED QUANTITY IS TO BE USED FOR FULL DEPTH PAVEMENT REPAIR FOR SR 269 AS DIRECTED BY THE ENGINEER.

SR 269 SB SHOULDER (STA. 538+63 TO STA. 568+00)
SR 269 NB SHOULDER (STA. 538+63 TO STA. 551+46)
10% OF THE TOTAL AREA = (33,800 SQFT X 6"/12")/27 X 10% = 63 CU YD

DETAIL FOR CALCULATION PURPOSES ONLY.
PLACEMENT IS AT THE CONSTRUCTION ENGINEER'S DISCRETION.

ITEM 253 - PAVEMENT REPAIR 63 CU YD
QUANTITY CARRIED TO THE GENERAL SUMMARY.

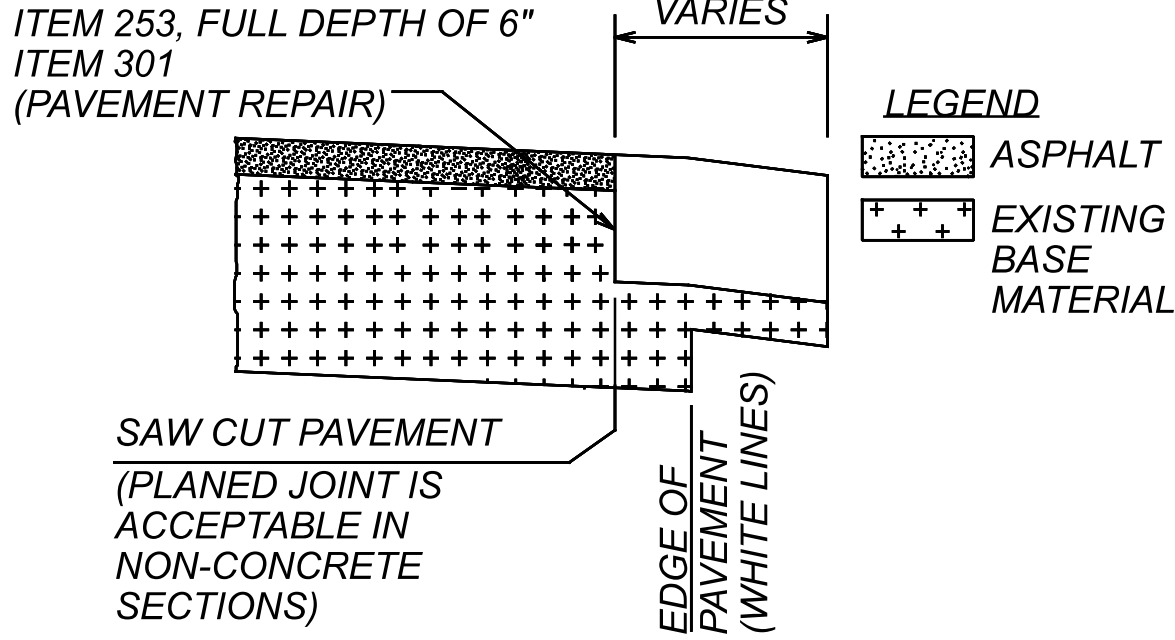

NOTE: THE ENGINEER SHALL FIELD VERIFY ALL LOCATIONS PRIOR TO THE BEGINNING OF WORK. ANY ADJUSTMENTS NECESSARY SHALL BE AS DIRECTED BY THE ENGINEER.

ITEM 255 - PAVEMENT REPAIR

THE FOLLOWING ESTIMATED QUANTITY IS TO BE USED FOR FULL DEPTH PAVEMENT REPAIR FOR SR 269 AS DIRECTED BY THE ENGINEER.

SR 269 (STA. 549+61 TO STA. 38+78)
NB SR-269 ADJACENT TO BRIDGE APPROACH SLAB = 62 SQ YD
SB SR-269 ADJACENT TO BRIDGE APPROACH SLAB = 73 SQ YD

ITEM 255 - FULL DEPTH PAVEMENT REMOVAL AND RIGID REPLACEMENT, TYPE 1, CLASS QC1 135 SQ YD

ITEM 255 - FULL DEPTH PAVEMENT SAWING 48 FT

PLACEMENT IS AT THE CONSTRUCTION ENGINEER'S DISCRETION.

QUANTITIES CARRIED TO THE GENERAL SUMMARY.

REMOVALS

IN ALL SIDEWALK, DRIVE, OR PAVEMENT REMOVALS, EDGES SHALL BE CUT TO THE NEAREST JOINT WITH NEAT LINES BY USE OF A POWER SAW. SAW CUTS SHALL BE FULL DEPTH. REMOVALS SHALL BE MADE ONLY TO THE EXTENT APPROVED BY THE ENGINEER.

EXISTING SURVEY MONUMENTS

SURVEY MONUMENTS, BENCH MARKS, AND EXISTING POINTS DAMAGED OR DISTURBED BY CONSTRUCTION SHALL BE REPLACED BY A REGISTERED LAND SURVEYOR AT THE CONTRACTOR'S EXPENSE. SHOULD CONTRACTOR FAIL TO PROPERLY REPLACE THESE POINTS, THE DIVISION OF ENGINEERING SERVICES WILL REPLACE THEM AT THE CONTRACTOR'S EXPENSE AFTER THREE WEEKS NOTICE.

ITEM 204 - SUBGRADE COMPACTION AND PROOF ROLLING

CONSTRUCT THE SUBGRADE AS FOLLOWS AND IN THE FOLLOWING SEQUENCE:

- SHAPE THE SUBGRADE TO WITHIN 0.2 FEET OF THE PLAN SUBGRADE ELEVATION.
- EXCAVATE AND REPLACE ANY UNSUITABLE SUBGRADE ENCOUNTERED BEFORE PROOF ROLLING. UNSUITABLE SUBGRADE INCLUDES UNSUITABLE SOIL (A-4B, A-2-5, A-5, A-7-5, AND SOIL WITH A LIQUID LIMIT GREATER THAN 65) AND ANY COAL, SHALE, OR ROCK WHICH NEEDS TO BE REMOVED ACCORDING TO SECTION 204.05 OF THE CONSTRUCTION AND MATERIAL SPECIFICATIONS (C&MS).

IF THERE IS UNSUITABLE SUBGRADE IN A SHALLOW FILL LOCATION, EXCAVATE AND REPLACE THE UNSUITABLE SUBGRADE BEFORE CONSTRUCTING THE SHALLOW FILL AND SHAPING THE SUBGRADE.

- COMPACT THE SUBGRADE ACCORDING TO C&MS 204.03.

- APPROXIMATE LIMITS FOR EXCAVATION OF UNSTABLE SUBGRADE ARE SHOWN AND LABELED ON THE TYPICAL SECTIONS AND CROSS SECTIONS. THE ENGINEER WILL IDENTIFY THE ACTUAL LIMITS OF EXCAVATION FOR UNSTABLE SUBGRADE BASED ON THE PROOF ROLLING RESULTS AND VISUAL OBSERVATIONS.

PROOF ROLL THE COMPACTED SUBGRADE ACCORDING TO C&MS 204.06.

- EXCAVATE UNSTABLE SUBGRADE AS DIRECTED BY THE ENGINEER AND STABILIZE BY REPLACING WITH THE SPECIFIED MATERIALS ACCORDING TO C&MS 204.07. EXCAVATIONS WILL EXTEND 18 INCHES BEYOND THE EDGE OF THE SURFACE OF THE PAVEMENT, PAVED SHOULDERS, OR PAVED MEDIANS.

- PROOF ROLL THE STABILIZED AREAS ACCORDING TO C&MS 204.06 TO VERIFY STABILITY.

- FINE GRADE THE SUBGRADE TO THE SPECIFIED GRADE.

THE QUANTITIES FOR EXCAVATING THE UNSUITABLE SUBGRADE AND UNSTABLE SUBGRADE ARE BOTH PAID UNDER ITEM 204, EXCAVATION OF SUBGRADE.

THE FOLLOWING QUANTITIES HAVE BEEN INCLUDED IN THE GENERAL SUMMARY FOR USE AS DIRECTED BY THE ENGINEER:

ITEM 204 - PROOF ROLLING	2 HR
ITEM 204 - EXCAVATION OF SUBGRADE	877 CYD
ITEM 204 - GRANULAR MATERIAL, TYPE D	877 CYD
ITEM 204 - GEOTEXTILE FABRIC, TYPE D, 712.09	2632 SYD

ITEM 206 - TEST ROLLING AND CEMENT STABILIZED SUBGRADE

IN THE PAVEMENT CONSTRUCTED IN MAINTANCE OF TRAFFIC PHASE 1, CONSTRUCT THE SUBGRADE AS FOLLOWS AND IN THE FOLLOWING SEQUENCE:

- SHAPE THE SUBGRADE TO WITHIN 0.2 FEET OF THE PLAN SUBGRADE ELEVATION.
- COMPACT THE SUBGRADE ACCORDING TO C&MS 204.03.
- TEST ROLL THE COMPACTED SUBGRADE ACCORDING TO C&MS 206.04.
- CHEMICALLY STABILIZE THE AREAS DIRECTED BY THE ENGINEER.
- PROOF ROLL THE STABILIZED AREAS ACCORDING TO C&MS 206.05.E TO VERIFY STABILITY.
- FINE GRADE THE SUBGRADE TO THE SPECIFIED GRADE.

SEE THE SUBSUMMARY FOR ESTIMATED QUANTITIES FOR CEMENT STABILIZATION. ESTIMATED CEMENT QUANTITIES WERE CALCULATED USING SPREADING PERCENTAGES PER C&MS 206.05.

THE FOLLOWING QUANTITIES HAVE BEEN INCLUDED IN THE GENERAL SUMMARY FOR USE AS DIRECTED BY THE ENGINEER:

ITEM 204 - PROOF ROLLING	2 HR
ITEM 206 - TEST ROLLING	5 HR

ITEM 452 - 8" NON-REINFORCED CONCRETE PAVEMENT CLASS QC 1P, AS PER PLAN

THIS ITEM SHALL BE CONSTRUCTED AS PER ITEM 452 EXCEPT THAT THE CONCRETE SHALL BE INTEGRALLY COLORED AND SHALL HAVE A STAMPED SURFACE. CONCRETE SHALL BE INSTALLED FOLLOWING THE INSTRUCTIONS FROM THE STAMPED COLORED CONCRETE PATTERN AND PIGMENT MANUFACTURER.

STAMPED PATTERN: COBBLESTONE 5" X 10"
COLOR: BUFF
RELEASE: LIGHT GREY

A CONCRETE COLORANT SHALL BE INTEGRALLY ADDED TO THE CONCRETE. THE CONTRACTOR SHALL SUBMIT THE TECHNICAL DATA AND A COLOR SAMPLE OF THE PIGMENT TO THE ENGINEER FOR APPROVAL NO LESS THAN 14 DAYS PRIOR TO USE. THE LIQUID COLORANT SHALL CONFORM TO ASTM C979.

THE COMPLETED STAMPED CONCRETE SHALL RESEMBLE THE COLORED STAMPED CONCRETE AT THE ROUNDABOUTS CONSTRUCTED UNDER OTT-53-1.67 (PID 110859) AT THE SR-2 AND SR-53 INTERCHANGE.

PROVIDE A FIELD EXAMPLE OF THE SURFACE COLORS, TEXTURES, AND PATTERNS SPECIFIED FOR APPROVAL BY THE ENGINEER BEFORE BEGINNING WORK. THE SAMPLE SHALL BE 4' X 4' IN SIZE AND BE CONSTRUCTED USING THE SAME TECHNIQUES AND MATERIAL INTENDED FOR THE FINAL PAVED SURFACE. THE COST TO CONSTRUCT THE FIELD EXAMPLE IS INCLUDED INCIDENTAL TO THIS ITEM AND WILL NOT BE PAID SEPARATELY.

RADIAL JOINTS HAVING A DEPTH OF 8 INCHES SHALL BE SAWED AT 15 FOOT SPACING WITHIN 24 HOURS OF CONCRETE PLACEMENT FOR THE INTERIOR TRUCK APRON.

RADIAL JOINTS HAVING A DEPTH OF 8 INCHES SHALL BE SAWED AT 4 FOOT SPACING WITHIN 24 HOURS OF CONCRETE PLACEMENT FOR THE EXTERIOR TRUCK APRONS.

AFTER PLACEMENT OF CONCRETE, THE CONTRACTOR SHALL APPLY AN ACRYLIC BASED CONCRETE SEALER AND CURING AGENT. THE SEALER SHALL HAVE A MEDIUM TO HIGH GLOSS AND BE APPLIED IN ACCORDANCE WITH THE MANUFACTURER'S SPECIFICATIONS. THE CONTRACTOR SHALL SUBMIT THE BRAND NAME AND TECHNICAL DATA FOR THE CONCRETE SEALER TO THE ENGINEER FOR APPROVAL NO LESS THAN 14 DAYS PRIOR TO USE.

PAYMENT SHALL BE MADE AT THE UNIT PRICE BID PER SQUARE YARD AS SHOWN IN THE WORK NOTED ABOVE.

ITEM 601 - TIED CONCRETE BLOCK MAT WITH TYPE 1 UNDERLAYMENT

TIED CONCRETE BLOCK MAT WITH TYPE 1 UNDERLAYMENT SHALL BE CONSTRUCTED AT THE LOCATIONS SHOWN IN THE PLANS AND PER C&MS 601 WITH THE TYPICAL SECTION SHOWN BELOW.

PAYMENT SHALL BE MADE AT THE UNIT BID PER SQUARE YARD OF ITEM 601 - TIED CONCRETE BLOCK MAT WITH TYPE 1 UNDERLAYMENT FOR THE WORK NOTED ABOVE.

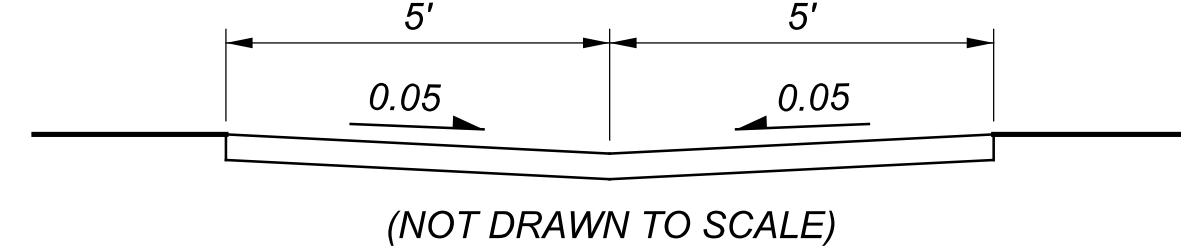

ITEM 606 - ANCHOR ASSEMBLY, MGS TYPE E

THIS ITEM SHALL CONSIST OF FURNISHING AND INSTALLING ANY OF THE GUARDRAIL END TERMINALS FOR TYPE MGS GUARDRAIL AS LISTED ON ROADWAY ENGINEERING'S WEB PAGE UNDER ROADSIDE SAFETY DEVICES FOR APPROVED GUARDRAIL END TREATMENTS. INSTALLATION SHALL BE AT THE LOCATIONS SPECIFIED IN THE PLANS, IN ACCORDANCE WITH THE MANUFACTURER'S SPECIFICATIONS.

THE FACE OF THE TYPE E IMPACT HEAD SHALL BE COVERED WITH A SHEET OF TYPE G REFLECTIVE SHEETING, PER CMS 730.19.

REFER TO THE MANUFACTURER'S INSTRUCTIONS REGARDING THE INSTALLATION OF, AND THE GRADING AROUND THE FOUNDATION TUBES AND GROUND STRUT. THE TOP OF ANY FOUNDATION TUBE SHOULD BE LESS THAN 4 INCHES ABOVE THE GROUND. THE PLACEMENT OF THE FOUNDATION TUBES SHOULD BE AN APPROPRIATE DEPTH BELOW THE LEVEL LINE IN ORDER TO MAINTAIN THE FINISHED GUARDRAIL HEIGHT OF 31 INCHES FROM THE EDGE OF THE SHOULDER.

ON-SITE GRADING IS REQUIRED IF THE TOP OF THE FOUNDATION TUBES OR TOP OF THE GROUND STRUT DOES PROJECT MORE THAN 4 INCHES ABOVE THE GROUND LINE.

PAYMENT FOR THE ABOVE WORK SHALL BE MADE AT THE UNIT PRICE BID FOR ITEM 606, ANCHOR ASSEMBLY, MGS TYPE E, MASH 2016, EACH, AND SHALL INCLUDE ALL LABOR, TOOLS, EQUIPMENT AND MATERIALS NECESSARY TO CONSTRUCT A COMPLETE AND FUNCTIONAL ANCHOR ASSEMBLY SYSTEM, INCLUDING ALL RELATED TRANSITIONS, REFLECTIVE SHEETING, HARDWARE, GRADING, EMBANKMENT AND EXCAVATION NOT SEPARATELY SPECIFIED, AS REQUIRED BY THE MANUFACTURER.

ITEM 623 - MONUMENTS

SETTING OF ALL MONUMENTS SHALL BE PERFORMED BY A SURVEYOR REGISTERED IN THE STATE OF OHIO. THE MONUMENT ASSEMBLIES AND REFERENCE MONUMENTS WILL BE INSTALLED BY THE CONTRACTOR AT THE TIME OF CONSTRUCTION. THE IRON PIN AND CAP (WHEN REQUIRED) ARE TO BE INSTALLED BY THE CONTRACTOR'S SURVEYOR.

SET PROPOSED MONUMENTS AT THE LOCATIONS LISTED IN THE PROJECT CONTROL TABLE ON P.2. CHANGES OR ALTERATIONS TO THE LOCATION OF ANY MONUMENTS SHOWN IN THIS TABLE, REQUIRE PRIOR APPROVAL FROM THE DISTRICT REAL ESTATE ADMINISTRATOR OF THE OHIO DEPARTMENT OF TRANSPORTATION. IN THE EVENT THAT CHANGES OR ALTERATIONS ARE APPROVED, A REVISED CENTERLINE PLAT WITH THE NEW LOCATIONS SHALL BE RECORDED IN THE APPLICABLE COUNTY RECORDS AND THE OHIO DEPARTMENT OF TRANSPORTATION. SPECIFICATIONS FOR MONUMENT ASSEMBLIES, REFERENCE MONUMENTS AND RIGHT OF WAY MONUMENTS ARE SHOWN ON STANDARD CONSTRUCTION DRAWING RM-1.1.

THE FOLLOWING ESTIMATED QUANTITIES HAVE BEEN INCLUDED IN THE GENERAL SUMMARY FOR THE WORK NOTED ABOVE:

ITEM 623 - MONUMENT ASSEMBLY, TYPE D	2 EACH
ITEM 623 - REFERENCE MONUMENT, TYPE A	1 EACH

DESIGN AGENCY

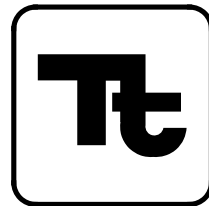

DESIGNER

JPH

REVIEWER

DTC 01/30/25

PROJECT ID

114099

SHEET

P.16

TOTAL

127

ITEM 611 - CATCH BASIN, NO. 6, AS PER PLAN

THIS ITEM CONSISTS OF FURNISHING AND INSTALLING A CATCH BASIN IN ACCORDANCE WITH ITEM 611 OF THE 2023 OHIO DEPARTMENT OF TRANSPORTATION CONSTRUCTION AND MATERIAL SPECIFICATIONS AND SCD CB-6 EXCEPT THE APRON WIDTH SHOWN IN SECTION B-B OF SCD CB-6 SHALL BE 6" INSTEAD OF 18".

ALL EQUIPMENT, MATERIALS, LABOR, TOOLS, AND INCIDENTALS NECESSARY TO COMPLETE THE WORK OUTLINED ABOVE AND PER C&MS 611 SHALL BE INCLUDED IN THE UNIT PRICE FOR ITEM 611 - CATCH BASIN, NO.6, AS PER PLAN.

ITEM 619 - FIELD OFFICE, TYPE C, AS PER PLAN

THIS ITEM SHALL BE IN ACCORDANCE WITH ITEM 619 OF THE 2023 OHIO DEPARTMENT OF TRANSPORTATION CONSTRUCTION AND MATERIAL SPECIFICATIONS. THE FIELD OFFICE SHALL BE PROVIDED AS SOON AS POSSIBLE AFTER AWARD OF THE CONTRACT AND IS ANTICIPATED TO RUN FROM JUNE 2025 TO AUGUST 2026.

THE FOLLOWING ESTIMATED QUANTITY HAS BEEN CARRIED TO THE GENERAL SUMMARY:

ITEM 619 - FIELD OFFICE, TYPE C, AS PER PLAN 14 MNTH

ITEM 620 - DELINEATOR, MISC.: HIGH INTENSITY RETRO-REFLECTIVE ISLAND BULLNOSE MARKER

THE CONTRACTOR SHALL USE A HIGH INTENSITY RETRO-REFLECTIVE ISLAND SURFACE MOUNTED BULLNOSE MARKER, WITH A MINIMUM OF 224 SQUARE INCHES OF SOLID YELLOW REFLECTIVE SHEETING ON EACH SIDE WITH A RANGE OF 28 INCHES TO 42 INCHES IN HEIGHT. DISTRIBUTION OF SAID PRODUCT SHALL COME FROM ONE OF THE FOLLOWING DISTRIBUTORS: QWICK KURB INC (L104 AIR MARKER), NATIONAL TRAFFIC SIGNS INC (42HIGHVIS-W-SM-DS), AND FLEXSTAKE INC. (SM 700 SERIES).

ITEM 622 - BARRIER MISC.: CONCRETE BARRIER, TYPE A1

CONSTRUCT THE CONCRETE BARRIER IN ACCORDANCE WITH CMS 622 EXCEPT CONSTRUCT THE SHAPE AND HEIGHT OF THE BARRIER TO MATCH THE EXISTING TYPE A1 BARRIER PER PLAN INSERT SHEET RM-4.3M.

CONNECT THE BARRIER TO THE EXISTING BARRIER WITH 3/4" DIA. BY 18" LONG EPOXY COATED DEFORMED DOWEL BARS AS PER CMS 622.02. BARS ARE TO BE DOWELED INTO THE EXISTING CONCRETE BARRIER PER CMS 510 AND PLACED AS SHOWN ON THE RACEWAY AND DOWEL BAR PLACEMENT DETAIL ON SCD RM-4.3.

ITEM 630 - GROUND MOUNTED SUPPORT, NO. 3 POST, AS PER PLAN

THIS ITEM SHALL CONSIST OF INSTALLING A GROUND MOUNTED NO. 3 POST WITH THE EMBEDMENT DEPTH OF A MINIMUM OF 48". ADDITIONAL EMBEDMENT DEPTH IS INCLUDED IN THE PLAN QUANTITY PRICE FOR:

ITEM 630, GROUND MOUNTED SUPPORT, NO. 3 POST, AS PER PLAN.

ITEM 630, SIGN POST REFLECTOR, AS PER PLAN

IN ADDITION TO THE POST SUPPORT, THE CONTRACTOR SHALL PROVIDE SIGN POST REFLECTORS IN ACCORDANCE WITH SCD TC-41.30 AS PART OF THIS PAY ITEM. THE SIGN POST SHALL BE REFLECTORIZED WITHIN 1" BELOW THE SIGN TO WITHIN 1' OF THE GROUND ELEVATION BELOW THE SIGN. THE REFLECTIVE SHEETING, TYPE AND MANUFACTURER, SHALL MATCH THAT OF THE PROPOSED SIGN TO INSURE THAT THE REFECTIVITY IS CONSISTENT. ONLY 36" LENGTH STRIPS SHALL BE USED.

SIGN COLOR LEGEND

USE THE FOLLOWING LEGEND FOR THE SIGNING SUBSUMMARIES.

BLK - BLACK	BLU - BLUE
BRN - BROWN	FYG - FLUROSCENT YELLOW GREEN
FY - FLUROSCENT YELLOW	G - GREEN
O - ORANGE	R - RED
W - WHITE	

ITEM 630, SIGNING, MISC., 4"x6" POST

THIS ITEM SHALL CONSIST OF INSTALLING A GROUND MOUNTED 4"x6" SOLID WOOD POST. FIGURE 298-26 OF THE TRAFFIC ENGINEERING MANUAL (P. 2-219) SHALL BE USED AS A GUIDE FOR INSTALLATION OF THE 4"x6" POST.

GRADE 2 SOUTHERN YELLOW PINE SHALL BE USED, AND SHALL BE PRESSURE TREATED WITH CCA PRESERVATIVE.

U-CHANNEL DRIVE POSTS OF THE SAME HEIGHTS AS THE SIGN, WILL BE ATTACHED TO THE WOOD POST WITH 5/8" SQUARE HEAD, GALVANIZED BOLTS, NUTS AND WASHERS. THE SIGNS WILL THEN BE INSTALLED USING STANDARD SIGN CLIPS.

ITEM 630, SIGNING, MISC., 6"x8" WOOD POST

THIS ITEM SHALL CONSIST OF INSTALLING A GROUND MOUNTED 6"x8" SOLID WOOD POST. FIGURE 298-26 OF THE TRAFFIC ENGINEERING MANUAL (P. 2-219) SHALL BE USED AS A GUIDE FOR INSTALLATION OF THE 6"x8" POST.

GRADE 2 SOUTHERN YELLOW PINE SHALL BE USED, AND SHALL BE PRESSURE TREATED WITH CCA PRESERVATIVE.

U-CHANNEL DRIVE POSTS OF THE SAME HEIGHTS AS THE SIGN, WILL BE ATTACHED TO THE WOOD POST WITH 5/8" SQUARE HEAD, GALVANIZED BOLTS, NUTS AND WASHERS. THE SIGNS WILL THEN BE INSTALLED USING STANDARD SIGN CLIPS.

ITEM 630 GROUND MOUNTED STRUCTURAL BEAM FOUNDATION, AS PER PLAN

FOUNDATIONS FOR WOOD POSTS SHALL BE CONCRETE AND SIZED AS SPECIFIED FOR W6X9 SIZE SUPPORTS IN SCD TC-41.10.

ITEM 657 RIPRAP FOR TREE PROTECTION, AS PER PLAN

DESCRIPTION: THIS WORK CONSISTS OF FURNISHING AND PLACING RIPRAP ON TOP OF THE GEOTEXTILE FABRIC WITHIN THE OUTER 9.75' RADIUS CIRCLE AREA OF THE ROUNDABOUT AS SHOWN IN THE PLANS.

MATERIALS: USE A NON-CRUSHED NATURAL RIVER ROCK GRAVEL, ROUND SHAPED AND VARIED IN COLOR. LIMESTONE IS NOT ACCEPTABLE. THE SOUNDNESS REQUIREMENTS OF 657.02 ARE WAIVED. THE GRADATION REQUIRED WILL BE WILL BE 100% PASSING A 4" SIEVE AND 0% PASSING A 3" SIEVE. PLACE STONES IN A 12" LIFT. MANUAL PLACING REQUIREMENTS PER 657.05 IS WAIVED.

METHOD OF MEASUREMENT AND PAYMENT: THE GEOTEXTILE FABRIC IS PAID SEPARATE AND UNDER ITEM 204 GEOTEXTILE FABRIC, TYPE B, 712.09. MEASUREMENT AND PAYMENT FOR THE GRAVEL MATERIAL SHALL BE BY THE SQUARE YARD, COMPLETE IN PLACE AND ACCEPTED BY THE ENGINEER AS PER ITEM 657 - RIPRAP FOR TREE PROTECTION, AS PER PLAN.

THE FOLLOWING ESTIMATED QUANTITIES HAVE BEEN INCLUDED IN THE GENERAL SUMMARY FOR THE WORK NOTED ABOVE:

ITEM 204 - GEOTEXTILE FABRIC, TYPE B, 712.09	169 \$Y
ITEM 657 - RIPRAP FOR TREE PROTECTION, AS PER PLAN	169 \$Y

ITEM 653 - TOPSOIL FURNISHED AND PLACED, AS PER PLAN

DESCRIPTION: THIS WORK CONSISTS OF FURNISHING AND PLACING TOPSOIL AT A THICKNESS OF 4 INCHES WITHIN THE CENTER CIRCLE AREA OF THE ROUNDABOUT AT A DIAMETER OF 40' AS SHOWN IN THE PLANS AND IN ACCORDANCE WITH C&MS 653. THE SOIL SHALL BE PLACED AND PREPARED FOR PLANTING AS DETAILED BELOW BY DECEMBER 1, 2025, AND SHOULD NOT BE DISTURBED BY THE CONTRACTOR AFTER PLANTING IS PERFORMED BY DANBURY TOWNSHIP.

MATERIALS: PROVIDE TOPSOIL IN ACCORDANCE WITH C&MS 653 THAT IS FREE OF DEBRIS, ROCK, AND OTHER FOREIGN MATERIALS AT THE SURFACE. THE TOPSOIL SHALL BE OPEN, BARE, AND MODERATLY COMPACTED. THE TOPSOIL SHALL NOT BE LOOSENEED OR FLUFFED THROUGH THE USE OF A ROTO-TILLER OR OTHER SIMILAR EQUIPMENT.

METHOD OF MEASUREMENT AND PAYMENT: THE TOPSOIL IS PAID UNDER ITEM 653 - TOPSOIL FURNISHED AND PLACED, AS PER PLAN. MEASUREMENT AND PAYMENT FOR THE TOPSOIL SHALL BE BY THE CUBIC YARD, COMPLETE IN PLACE AND ACCEPTED BY THE ENGINEER AS PER ITEM 653 - TOPSOIL FURNISHED AND PLACED, AS PER PLAN.

THE FOLLOWING ESTIMATED QUANTITIES HAVE BEEN INCLUDED IN THE GENERAL SUMMARY FOR THE WORK NOTED ABOVE:

ITEM 653 - TOPSOIL FURNISHED AND PLACED, AS PER PLAN	16 CY
--	-------

ITEM SPECIAL - MAILBOX SUPPORT

THIS WORK SHALL CONSIST OF FURNISHING AND ERECTING MAILBOX SUPPORTS AND ANY ASSOCIATED MOUNTING HARDWARE IN ACCORDANCE WITH PLAN DETAILS, AND ATTACHING AN OWNER-SUPPLIED MAILBOX AT LOCATIONS SPECIFIED IN THE PLAN, OR OTHERWISE ESTABLISHED BY THE ENGINEER.

WOOD POSTS SHALL BE NOMINAL 4 INCHES BY 4 INCHES SQUARE OR 4.5 INCHES DIAMETER ROUND, AND CONFORM TO 710.14.

STEEL POSTS SHALL BE NOMINAL PIPE SIZE 2 INCHES I.D., AND CONFORM TO AASHTO M 181.

ALL HARDWARE INCLUDING BUT NOT LIMITED TO PLATES, SCREWS, BOLTS, AND ETC. SHALL BE COMMERCIAL-GRADE GALVANIZED STEEL.

POSTS SHALL BE SET PER THE FIRST PARAGRAPH OF 606.03, AND SHALL IN NO INSTANCE BE ENCASED IN CONCRETE.

SUPPORT HARDWARE SHALL ACCOMMODATE EITHER A SINGLE OR A DOUBLE MAILBOX INSTALLATION, AND NO MORE THAN TWO BOXES MAY BE MOUNTED ON A SINGLE POST.

THE MAILBOX SHALL BE SECURELY AND NEATLY ATTACHED BY THE CONTRACTOR TO THE NEW SUPPORT. THE CONTRACTOR SHALL FURNISH ALL NECESSARY ATTACHMENT HARDWARE (NUTS, BOLTS, PLATES, SPACERS, AND WASHERS) AS NECESSARY TO ACCOMMODATE THE COMPLETE INSTALLATION.

IN THE ABSENCE OF A NEW BOX SUPPLIED BY THE OWNER, THE CONTRACTOR SHALL SALVAGE THE EXISTING BOX AND PLACE IT ON THE NEW SUPPORT. DUE CARE SHALL BE EXERCISED IN SUCH AN OPERATION, AND THE CONTRACTOR SHALL BE RESPONSIBLE FOR REPAIRING OR REPLACING ANY BOX DAMAGED BY IMPROPER HANDLING ON HIS PART, AS JUDGED AND DIRECTED BY THE ENGINEER.

THE CONTRACTOR SHALL BE RESPONSIBLE FOR COORDINATING WITH THE LOCAL POST MASTER REGARDING THE TIMING OF THE MOVEMENT OF ANY MAILBOX TO A NEW LOCATION.

PAYMENT UNDER THIS ITEM SHALL BE LIMITED TO FINAL PERMANENT INSTALLATIONS. TEMPORARY INSTALLATIONS SHALL BE IN ACCORDANCE WITH 107.10. HOWEVER, THE SAME MATERIAL AND SIZE LIMITATIONS AS FOR PERMANENT INSTALLATIONS SHALL APPLY.

MAILBOX SUPPORTS, COMPLETE IN PLACE, WILL BE PAID FOR AT THE CONTRACT UNIT PRICE PER EACH, FOR ITEM SPECIAL MAILBOX SUPPORT SYSTEM, (SINGLE).

DESIGN AGENCY

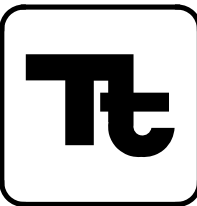

DESIGNER

GCB

REVIEWER

DTC 01/30/25

PROJECT ID

114099

SHEET

P.17

TOTAL

127

GENERAL

1. ALL WATER CONSTRUCTION SHALL BE IN ACCORDANCE WITH THE OTTAWA COUNTY SEWER DISTRICT PUBLIC WATER AND WASTEWATER RULES AND REGULATIONS, TEN STATE STANDARDS, O.D.O.T. STANDARDS, AND THE REQUIREMENTS OF THE OHIO E.P.A. ALL CONTRACTORS INSTALLING WATER IMPROVEMENTS MUST BE LICENSED WITH THE OTTAWA COUNTY SANITARY ENGINEERING DEPARTMENT (O.C.S.E.). THE OTTAWA COUNTY SEWER DISTRICT PUBLIC WATER AND WASTEWATER RULES AND REGULATIONS ARE AVAILABLE BY CONTACTING O.C.S.E. OP BY VISITING THE COUNTY'S WEBSITE @ <https://co.ottawa.oh.us/316/Regulations>

2. PERMITS SHALL BE SECURED FOR WATER IMPROVEMENTS FROM O.C.S.E. PRIOR TO COMMENCING CONSTRUCTION. THE PROPERTY OWNER SHALL BE REQUIRED TO SECURE ALL REQUIRED PERMITS. COPIES OF SAID PERMITS SHOULD BE KEPT ON THE CONSTRUCTION SITE AND AVAILABLE FOR REVIEW AT ANYTIME. CONTRACTORS SHALL BE REQUIRED TO PROVIDE A VALID PERMIT NUMBER WHEN REQUESTING INSPECTIONS.

3. CONTRACTORS SHALL BE RESPONSIBLE FOR COMPLYING WITH ALL FEDERAL, STATE, AND LOCAL SAFETY STANDARDS AND REGULATIONS. CONTRACTORS SHALL BE RESPONSIBLE FOR KEEPING THE CONSTRUCTION SITE SAFE FOR ITS EMPLOYEES, EMPLOYEES OF OTTAWA COUNTY, AND THE GENERAL PUBLIC.

4. ALL WATER IMPROVEMENTS SHALL BE INSPECTED AND APPROVED BY THE OTTAWA COUNTY SANITARY ENGINEERING FIELD OBSERVER PRIOR TO BACKFILLING THE IMPROVEMENTS. FORTY-EIGHT (48) HOURS NOTICE OF COMMENCING CONSTRUCTION SHALL BE GIVEN TO THE FIELD OBSERVER PRIOR TO STARTING WORK. O.S.C.E. NOTIFICATIONS:

FIELD OPERATIONS:
DANBURY WASTEWATER TREATMENT PLANT
AND REGIONAL WATER DIST. SYSTEM
5783 E. VON GLAHN RD.
LAKESIDE/MARBLEHEAD, OHIO 43440
PHONE: 419-734-5953
FAX: 419-734-7072
OFFICE OPERATIONS:
OTTAWA COUNTY SANITARY
ENGINEERING (OFFICE)
315 MADISON ST. ROOM 105
PORT CLINTON, OHIO 43452
PHONE: 419-734-6725
FAX: 419-734-6858

5. OTTAWA COUNTY RESERVES THE RIGHT TO REQUIRE FIELD CHANGES THAT ARE NOT NOTED IN THE IMPROVEMENT DRAWINGS, APPROVAL LETTER(S), OR IN THE RULES AND REGULATIONS INSURE THE INTEGRITY AND COMPATIBILITY OF THE PUBLIC WATER AND WASTEWATER TREATMENT SYSTEMS.

6. CONNECTIONS OF DWELLING OR TYPE OF STRUCTURES SHALL NOT BE PERMITTED UNTIL THE WATER MAINS ARE INSTALLED, INSPECTED, TESTED AND APPROVED FOR USE UNLESS OTHERWISE STATED ON THE PERMIT ISSUED BY THE OTTAWA COUNTY SANITARY ENGINEERING DEPARTMENT. CROSS-CONNECTION WITH AUXILIARY WATER SOURCES ARE PROHIBITED. WHERE APPLICABLE, OHIO EPA APPROVED BACKFLOW PREVENTERS ARE REQUIRED WITH INSTALLATION AND TESTING IN ACCORDANCE WITH THE COUNTY'S BACKFLOW PREVENTION REGULATIONS.

7. IT SHALL BE THE CONTRACTOR'S RESPONSIBILITY TO FIELD VERIFY ANY INFORMATION ON EXISTING WATER AND SANITARY SEWER IMPROVEMENTS OR ANY GENERAL FIELD INFORMATION PROVIDED BY THE O.C.S.E. PRIOR TO STARTING CONSTRUCTION OF THE IMPROVEMENTS.

8. THE CONTRACTOR SHALL BE RESPONSIBLE FOR PROPERLY RESTORING ANY DISTURBED AREAS AROUND EXISTING WATER AND/OR SANITARY SEWER INFRASTRUCTURE AS SOON AS REASONABLY POSSIBLE AFTER WORK HAS BEEN COMPLETED IN THAT IMMEDIATE AREA.

9. IT SHALL BE THE PROPERTY OWNER AND CONTRACTOR'S RESPONSIBILITY TO INSURE THAT ALL NECESSARY PERMITS OR APPROVALS ARE SECURED FROM ANY OTHER GOVERNMENTAL AGENCY, ASSOCIATION, OR ORGANIZATION THAT MAY HAVE THEIR JURISDICTION EFFECTED BY THE WATER AND/OR SANITARY SEWER IMPROVEMENTS.

10. THE LOCATION OF ALL EXISTING UTILITIES SHOWN ON THE PLANS ARE APPROXIMATE. THE EXACT LOCATION OF ALL UTILITIES SHALL BE THE RESPONSIBILITY OF THE CONTRACTOR. CONTRACTOR SHALL NOTIFY ALL UTILITIES TO LOCATE THEIR EXISTING FACILITIES AT LEAST TWO (2) WORKING DAYS PRIOR TO START OF CONSTRUCTION. CONTRACTOR SHALL BE RESPONSIBLE FOR ANY AND ALL DAMAGE TO UTILITIES CAUSED BY HIS OPERATIONS. THE OHIO UTILITIES PROTECTION SERVICE (OUPS) TOLL FREE TELEPHONE NUMBER IS: 1-800-362-2764.

11. THE CONTRACTOR SHALL BE RESPONSIBLE FOR ADHERING TO ALL O.S.H.A. SAFETY STANDARDS. OTTAWA COUNTY SHALL NOT BE HELD LIABLE FOR CONTRACTORS NOT ADHERING TO SAID STANDARDS.

12. THE DEVELOPER, AND THE DEVELOPER'S ENGINEER, SHALL BE RESPONSIBLE FOR PROVIDING THE OTTAWA COUNTY SANITARY ENGINEERING DEPARTMENT WITH A COMPLETE AND ACCURATE AS-BUILT SET OF PLANS OF THE WATER AND SANITARY SEWER MAIN LINE AND ALL APPURTENANCES INSTALLED BEFORE ANY CONNECTIONS ARE MADE.

CATHODIC TEST STATION BOXES

THE CONTRACTOR SHALL COORDINATE WITH THE OTTAWA COUNTY SANITARY ENGINEERING DEPARTMENT FOR THE FINAL GRADE ADJUSTMENTS OF THE EIGHT (8) CATHODIC TEST STATION BOXES WITHIN THE PROJECT AREA. ALL FINAL GRADE ADJUSTMENTS OF THE CATHODIC TEST STATION BOXES WILL BE PERFORMED BY THE OTTAWA COUNTY SANITARY ENGINEERING DEPARTMENT.

OTTAWA COUNTY SANITARY ENGINEERING DEPARTMENT
315 MADISON ST., ROOM 105
PORT CLINTON, OH 43452
(419) 734-6725

VALVE BOX ADJUSTED TO GRADE, AS PER PLAN

THIS ITEM IS INCLUDED FOR THE RAISING OR LOWERING OF EXISTING WATER VALVE BOXES AND CATHODIC TEST STATION BOXES TO GRADE. EXISTING CATHODIC TEST STATION BOXES ARE EAST JORDAN IRONWORKS #8550 10-T WITH A "TEST" LID. PLEASE CONTACT THE OTTAWA COUNTY SANITARY ENGINEERING DEPARTMENT TO COORDINATE EXTENDING THE TEST BOARD AND WIRES TO THE NEW ELEVATION. IT IS ANTICIPATED THAT SOME OF THE EXISTING BOXES WILL BE AT THE FINISHED GRADE AND WILL NOT NEED ADJUSTED. PAYMENT WILL BE BASED ON THE ACTUAL NUMBER THAT IS ADJUSTED. ALL OF THE VALVE BOXES ARE 5-1/4" BOXES AND THE CONTRACTOR SHALL SUPPLY RISERS AS NEEDED. ANY ADDITION OF MODIFICATION OF RISER BUILDUP WILL BE A PAYABLE ITEM. A LIMIT OF 3 RISERS AT A TOTAL OF 8 INCHES SHALL BE ACCEPTABLE. OF REQUIRED TO RAISE MORE THAN 3 RISERS OR 8 INCHES, THE BOX SHALL BE ADJUSTED BY EXCAVATING AROUND THE BOX AND TURNING THE TOP SECTION OF THE BOX TO ADJUST UP. THE OTTAWA COUNTY SANITARY ENGINEERING DEPARTMENT WILL PROVIDE A NEW TALLER VALVE BOX TOP SECTION IF IT IS REQUIRED. FINAL VALVE BOX TIPS SHALL BE NO MORE THAN 1/4 INCH BELOW THE ADJACENT FINISHED PAVEMENT. IT IS ANTICIPATED THAT ALL VALVE BOXES WILL BE ADJUSTED TO GRADE DURING PAVING OPERATIONS AND THEY WILL NOT BE DISTURBED AFTER PAVING HAS COMPLETED. USE CLASS QC FS CONCRETE AS NEEDED TO MEET REQUIRED MAINTENANCE OF TRAFFIC RESTRICTIONS. ALL LABOR AND MATERIAL NECESSARY SHALL BE DONE TO THE SATISFACTION OF THE OTTAWA COUNTY SANITARY ENGINEERING DEPARTMENT.

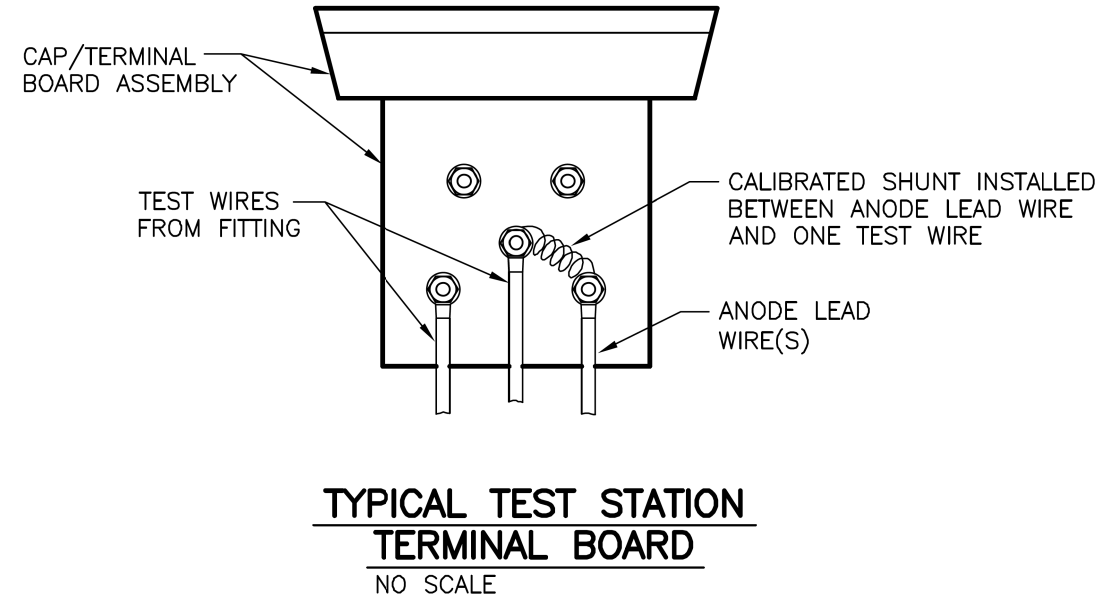
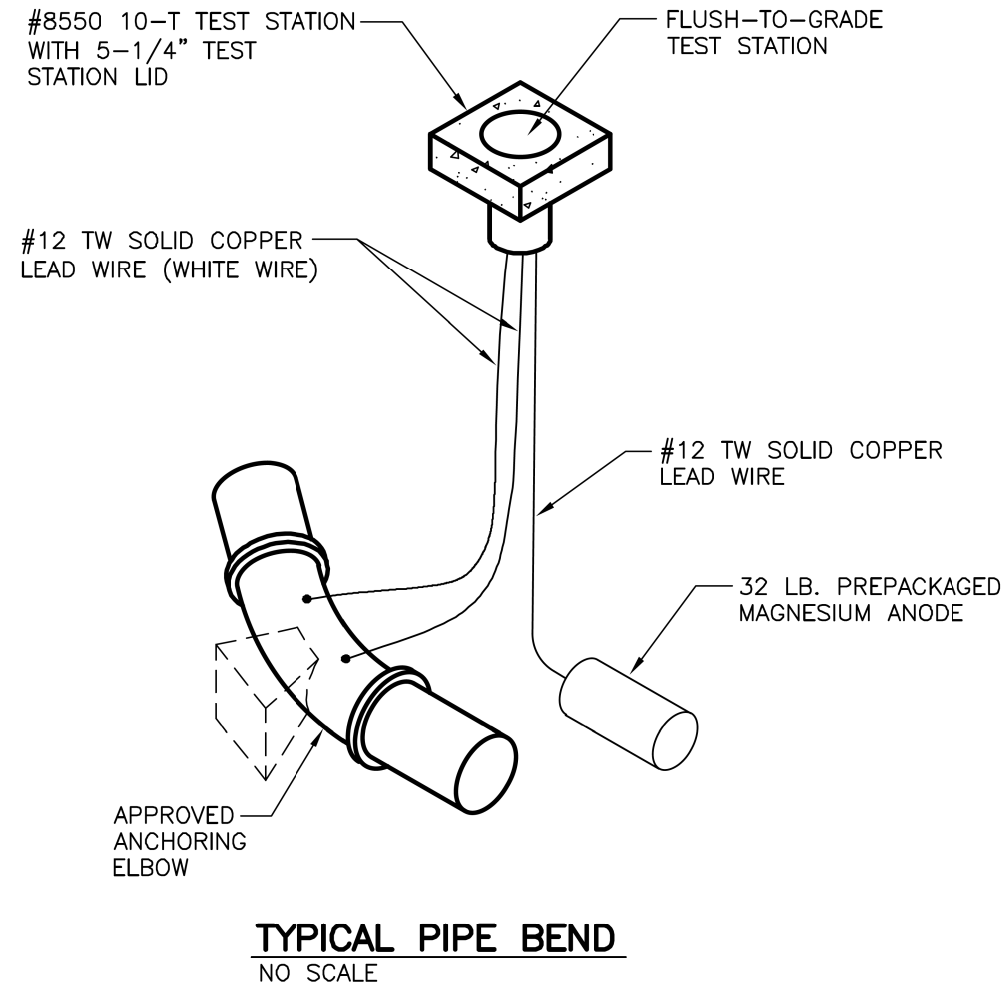
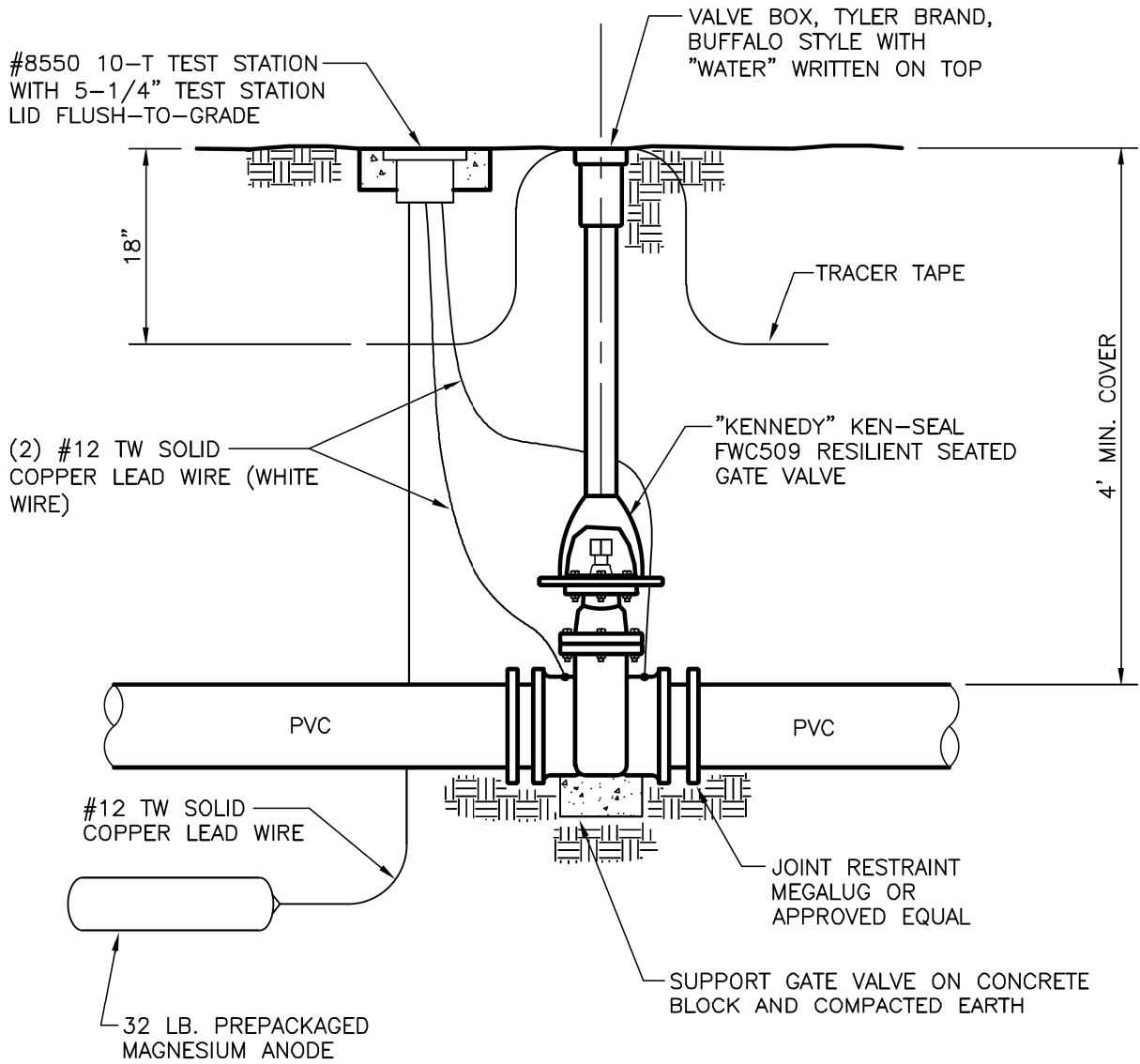
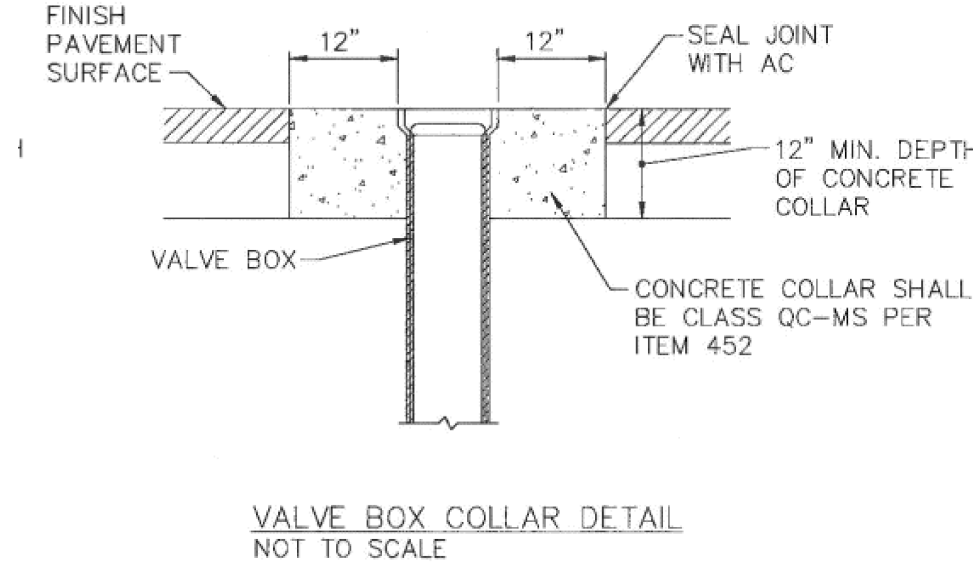

NOTE:
THIS EXAMPLE IS ONE CONFIGURATION
TO CONNECT ANODES THROUGH A SHUNT.
OTHER CONFIGURATIONS ARE POSSIBLE.

GENERAL NOTES

DESIGN AGENCY

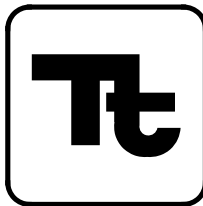

DESIGNER

GCB

REVIEWER

DTC 04/02/25

PROJECT ID

114099

SHEET

P.17A

TOTAL

127

ITEM 614, MAINTAINING TRAFFIC

A MINIMUM OF 1 LANE OF SOUTHBOUND SR 269 TRAFFIC SHALL BE MAINTAINED AT ALL TIMES USING THE EXISTING PAVEMENT, EXCEPT FOR A PERIOD NOT TO EXCEED 21 CONSECUTIVE CALENDAR DAYS, WHEN SOUTH SR 269 TRAFFIC MAY BE DETOURED AS DESCRIBED BELOW. 21 DAY CLOSURE MUST BE COMPLETED BY 6:00 PM FRIDAY MAY 15, 2026.

NORTHBOUND SR 269 AND S DANBURY NORTH ROAD TRAFFIC MAY BE DETOURED BETWEEN 12:00 AM TUESDAY SEPTEMBER 2, 2025 AND 6:00 PM FRIDAY MAY 15, 2026.

THE CONTRACTOR SHALL NOT PERFORM ANY WORK, EXCEPT FOR PREPARATORY WORK FOR THE ROAD CLOSURES, PRIOR TO 12:00 AM TUESDAY SEPTEMBER 2, 2025.

CONSTRUCTION OF THE ROUNDABOUT CENTER ISLAND AND PLACEMENT OF TOPSOIL WITHIN THE CENTER ISLAND AS SHOWN IN THE PLANS SHALL BE COMPLETED BY THE DECEMBER 1, 2025 INTERIM DATE.

ALL FINAL SURFACE COURSE PAVING AND PAVEMENT MARKINGS SHALL BE COMPLETED, AND LIGHTING INSTALLED AND OPERATIONAL, BY THE MAY 15, 2026 INTERIM DATE. FINAL PAVEMENT REMOVALS, GRADING AND SEEDING MAY BE COMPLETED AFTER THE MAY 15, 2026 INTERIM DATE.

SHOULD THE CONTRACTOR FAIL TO MEET ANY OF THESE REQUIREMENTS, THE CONTRACTOR SHALL BE ASSESSED A DISINCENTIVE PER THE LANE VALUE CONTRACT (PN 127).

LANE VALUE CONTRACT TABLE			
DESCRIPTION OF CRITICAL LANE TO BE MAINTAINED	RESTRICTED TIME PERIOD	TIME UNIT	DISINCENTIVE \$ PER TIME UNIT
1 LANE OF SOUTHBOUND SR-269	BEYOND 21 DAYS FULL CLOSURE	EACH CALENDAR DAY	\$5,000
1 LANE OF SOUTHBOUND SR-269, 1 LANE OF NORTHBOUND SR-269 & 1 LANE IN EACH DIRECTION OF S DANBURY NORTH ROAD	BEFORE 12:00 AM 9/2/2025 OR AFTER 6:00 PM 5/15/26	EACH CALENDAR DAY	\$5,000

DETOUR SIGNING:
THE CONTRACTOR WILL FURNISH, ERECT, MAINTAIN, AND SUBSEQUENTLY REMOVE THE SR-269 DETOUR ROUTE AND THE LOCAL DETOUR ROUTE SHOWN ON SHEET P.23 AND P.24.

THE CONTRACTOR WILL BE RESPONSIBLE FOR INSTALLING, MAINTAINING AND REMOVING SIGNS, BARRICADES AND DRUMS FOR CLOSURE OF THE EASTBOUND AND WESTBOUND SR-2 EXITS IN ACCORDANCE WITH SCD MT-98.29, INCLUDING THE "CLOSED" PLAQUES ON ALL OVERHEAD SIGNS SHOWN ON SHEET P.23.

PHASE CONSTRUCTION AS REQUIRED TO MAINTAIN ACCESS TO THE OTTAWA COUNTY SANITARY FACILITY AND THE RESIDENTS ON THE EAST SIDE OF S DANBURY NORTH ROAD AT ALL TIMES, UTILIZING EITHER EXISTING S DANBURY NORTH ROAD FROM THE SOUTH, OR SB SR-269 PAVEMENT FROM THE NORTH.

LENGTH AND DURATION OF LANE CLOSURES AND RESTRICTIONS SHALL BE AT THE APPROVAL OF THE ENGINEER. IT IS THE INTENT TO MINIMIZE THE IMPACT TO THE TRAVELING PUBLIC. LANE CLOSURES OR RESTRICTIONS OVER SEGMENTS OF THE PROJECT IN WHICH NO WORK IS ANTICIPATED WITHIN A REASONABLE TIME FRAME, AS DETERMINED BY THE ENGINEER, SHALL NOT BE PERMITTED. THE LEVEL OF UTILIZATION OF MAINTENANCE OF TRAFFIC DEVICES SHALL BE COMMENSURATE WITH THE WORK IN PROGRESS.

NOTICE OF CLOSURE SIGNS (W20-H13) SHALL BE ERECTED BY THE CONTRACTOR PRIOR TO THE SCHEDULED ROAD OR RAMP CLOSURE IN ACCORDANCE WITH THE NOTICE OF CLOSURE TIME TABLE BELOW.

THE SIGNS SHALL BE ERECTED ON THE RIGHT-HAND SIDE OF THE ROAD/RAMP FACING TRAFFIC. THEY SHALL BE PLACED SO AS NOT TO INTERFERE WITH THE VISIBILITY OF ANY OTHER TRAFFIC CONTROL SIGNS. ON ROADWAYS, THEY SHOULD BE ERECTED AT OR NEAR THE POINT OF CLOSURE. THE SIGNS MAY BE ERECTED ANYWHERE ON RAMPS AS LONG AS THEY ARE VISIBLE TO THE MOTORISTS USING THE RAMP. ON ENTRANCE RAMPS, THE SIGN SHALL BE ERECTED WELL IN ADVANCE OF THE MERGE AREA TO AVOID DISTRACTING MOTORISTS.

NOTICE OF CLOSURE SIGN TIME TABLE		
ITEM	DURATION OF CLOSURE	SIGN DISPLAYED TO PUBLIC
RAMP & ROAD CLOSURES	>=2 WEEKS	14 CALENDAR DAYS PRIOR TO CLOSURE
	> 12 HOURS & < 2 WEEKS	7 CALENDAR DAYS PRIOR TO CLOSURE
	<= 12 HOURS	2 BUSINESS DAYS PRIOR TO CLOSURE

THE SIGN SHALL DISPLAY THE DATE OF THE CLOSURE IN MMM-DD FORMAT AND THE NUMBER OF DAYS OF THE CLOSURE. THE LAST LINE OF THE W20-H13 SIGN LISTS A PHONE NUMBER WHICH A MOTORIST MAY CALL FOR ADDITIONAL INFORMATION. THIS IS TO BE A SPECIFIC OFFICE WITHIN THE DISTRICT RATHER THAN THE GENERAL SWITCHBOARD NUMBER.

THE FOLLOWING ESTIMATED QUANTITIES HAVE BEEN INCLUDED IN THE GENERAL SUMMARY FOR USE AS DETERMINED BY THE ENGINEER FOR THE MAINTENANCE OF TRAFFIC.

ITEM 410, TRAFFIC COMPACTED SURFACE, TYPE A OR B 100 CU. YD.

ITEM 614, ASPHALT CONCRETE FOR MAINTAINING TRAFFIC 10 CU. YD.

ALL WORK AND TRAFFIC CONTROL DEVICES SHALL BE IN ACCORDANCE WITH C&MS 614 AND OTHER APPLICABLE PORTIONS OF THE SPECIFICATIONS, AS WELL AS THE OHIO MANUAL OF UNIFORM TRAFFIC CONTROL DEVICES. PAYMENT FOR ALL LABOR, EQUIPMENT AND MATERIALS SHALL BE INCLUDED IN THE LUMP SUM CONTRACT PRICE FOR ITEM 614, MAINTAINING TRAFFIC, UNLESS SEPARATELY ITEMIZED IN THE PLAN.

NOTIFICATION OF TRAFFIC RESTRICTIONS

THROUGHOUT THE DURATION OF THE PROJECT, THE CONTRACTOR SHALL NOTIFY THE PROJECT ENGINEER IN WRITING OF ALL TRAFFIC RESTRICTIONS AND UPCOMING MAINTENANCE OF TRAFFIC CHANGES. THE CONTRACTOR SHALL ENSURE THE WRITTEN NOTIFICATION IS SUBMITTED IN A TIMELY MANNER TO ALLOW THE PROJECT ENGINEER TO MEET THE REQUIRED TIME FRAMES SET FORTH IN THE TABLE BELOW TO INFORM THE SPECIAL HAULING PERMITS SECTION (HAULING.PERMITS@DOT.OHIO.GOV) AND THE DISTRICT PUBLIC INFORMATION OFFICE (PIO). THIS NOTIFICATION SHALL BE RECEIVED BY THE PROJECT ENGINEER PRIOR TO THE PHYSICAL SETUP OF ANY APPLICABLE SIGNS OR MESSAGE BOARDS.

INFORMATION SHOULD INCLUDE, BUT IS NOT LIMITED TO, ALL CONSTRUCTION ACTIVITIES THAT IMPACT OR INTERFERE WITH TRAFFIC AND SHALL LIST THE SPECIFIC LOCATION, TYPE OF WORK, ROAD STATUS, DATE AND TIME OF RESTRICTION, DURATION OF RESTRICTION, NUMBER OF LANES MAINTAINED, NUMBER OF LANES CLOSED, MINIMUM VERTICAL CLEARANCE, MINIMUM WIDTH OF DRIVABLE PAVEMENT, DETOUR ROUTES, IF APPLICABLE, AND ANY OTHER INFORMATION REQUESTED BY THE PROJECT ENGINEER.

NOTIFICATION OF TRAFFIC RESTRICTIONS TIME TABLE		
TIME	DURATION OF CLOSURE	NOTIFICATION DUE TO PERMITS AND PIO
RAMP & ROAD CLOSURES	>=2 WEEKS	21 CALENDAR DAYS PRIOR TO CLOSURE
	> 12 HOURS & < 2 WEEKS	14 CALENDAR DAYS PRIOR TO CLOSURE
	<= 12 HOURS	4 CALENDAR DAYS PRIOR TO CLOSURE
LANE CLOSURES AND RESTRICTIONS	>=2 WEEKS	14 CALENDAR DAYS PRIOR TO CLOSURE
	< 2 WEEKS	5 BUSINESS DAYS PRIOR TO CLOSURE
START OF CONSTRUCTION & TRAFFIC PATTERN CHANGES	N/A	14 CALENDAR DAYS PRIOR TO IMPLEMENTATION

ANY UNFORESEEN CONDITIONS NOT SPECIFIED IN THE PLANS REQUIRING TRAFFIC RESTRICTIONS SHALL ALSO BE REPORTED TO THE PROJECT ENGINEER USING THE NOTIFICATION TIME TABLE.

ITEM 614, WORK ZONE IMPACT ATTENUATOR FOR 24" WIDE HAZARDS (UNIDIRECTIONAL OR BIDIRECTIONAL)

THIS ITEM SHALL CONSIST OF FURNISHING AND INSTALLING A NON-GATING IMPACT ATTENUATOR. FURNISH AN IMPACT ATTENUATOR FROM THE OFFICE OF ROADWAY ENGINEERING'S APPROVED LIST FOR WORK ZONE IMPACT ATTENUATORS, FROM THE ROADWAY STANDARDS APPROVED PRODUCTS WEB PAGE.

INSTALLATION SHALL BE AT THE LOCATIONS SPECIFIED IN THE PLANS IN ACCORDANCE WITH THE MANUFACTURER'S SPECIFICATIONS.

THE CONTRACTOR SHALL REPAIR OR REPLACE A DAMAGED UNIT WITHIN 24 HOURS OF A DAMAGING IMPACT.

WHEN BIDIRECTIONAL DESIGNS ARE SPECIFIED, THE CONTRACTOR SHALL SUPPLY APPROPRIATE TRANSITIONS.

WHEN GATING IMPACT ATTENUATORS ARE DESIRED, THE CONTRACTOR SHALL SUBMIT DOCUMENTATION TO THE ENGINEER FOR ACCEPTANCE.

THE COST FOR THE ADDITIONAL BARRIER REQUIRED FOR A GATING IMPACT ATTENUATOR SHALL BE INCLUDED IN THE COST OF THE GATING IMPACT ATTENUATOR.

PAYMENT FOR THE ABOVE WORK SHALL BE MADE AT THE UNIT PRICE BID AND SHALL INCLUDE ALL LABOR, TOOLS, EQUIPMENT AND MATERIALS NECESSARY TO CONSTRUCT AND MAINTAIN A COMPLETE AND FUNCTIONAL IMPACT ATTENUATOR SYSTEM, INCLUDING ALL RELATED BACKUPS, TRANSITIONS, LEVELING PADS, HARDWARE AND GRADING, NOT SEPARATELY SPECIFIED, AS REQUIRED BY THE MANUFACTURER.

CONSTRUCTION NOTIFICATION

THE CONTRACTOR WILL ADVISE THE PROJECT ENGINEER A MINIMUM OF EIGHTEEN (18) DAYS PRIOR TO THE FOLLOWING:

THE START OF CONSTRUCTION ACTIVITIES, LANE RESTRICTIONS, LANE CLOSURES, AND OR ROAD CLOSURES. THE PROJECT ENGINEER WILL FORWARD THIS INFORMATION TO THE FOLLOWING:

DISTRICT PUBLIC INFORMATION OFFICER (PIO) BY EMAIL AT D02.pip@dot.state.oh.us
DISTRICT PERMIT SECTION BY FAX AT 419-352-7524 OR EMAIL AT D02.permits@dot.state.oh.us

THE PIO WILL, IN TURN, NOTIFY THE PUBLIC, LOCAL SCHOOLS, POLICE FIRE, EMERGENCY SERVICES, BUS TRANSPORTATION DEPARTMENTS POST OFFICES, AND MEDIA OUTLETS (RADIO, NEWSPAPER, TV, ETC.) 15 DAYS PRIOR TO THE WORK BEGINNING, ANY MAJOR DISRUPTIVE, TIME DELAYING TRAFFIC CONTROL CHANGES, AND/OR DETOURS DURING CONSTRUCTION.

DESIGNATED LOCAL DETOUR ROUTE

IN ADDITION TO THE OFFICIAL, SIGNED DETOUR ROUTE, A LOCAL ROUTE HAS BEEN DETERMINED TO BE THE SECONDARY, UNSIGNED DETOUR ROUTE OR "DESIGNATED LOCAL DETOUR ROUTE." THIS ROUTE IS DESCRIBED BELOW. DURING THE TIME THAT TRAFFIC IS DETOURED, THE CONTRACTOR SHALL MAINTAIN THIS ROUTE IN A CONDITION WHICH IS REASONABLY SMOOTH AND FREE FROM HOLES, RUTS, RIDGES, BUMPS, DUST AND STANDING WATER. ONCE THE DETOUR IS REMOVED AND TRAFFIC RETURNED TO ITS NORMAL PATTERN, THE DESIGNATED LOCAL DETOUR ROUTE SHALL BE RESTORED TO A CONDITION THAT IS EQUIVALENT TO THAT WHICH EXISTED PRIOR TO ITS USE FOR THIS PURPOSE. ALL SUCH WORK SHALL BE PERFORMED WHEN AND AS DETERMINED BY THE ENGINEER.

CR-8 (STATE RD) TO CR-5 (EASTERN RD) BETWEEN SR-53 AND SR-269.

THE FOLLOWING ESTIMATED QUANTITIES ARE PROVIDED FOR USE AS DETERMINED BY THE ENGINEER TO MAINTAIN AND SUBSEQUENTLY RESTORE THE DESIGNATED LOCAL DETOUR ROUTE.

ITEM 614, ASPHALT CONCRETE FOR MAINTAINING TRAFFIC 10 CU. YD.
ITEM 617, COMPACTED AGGREGATE 75 CU. YD.

DUST CONTROL

THE CONTRACTOR SHALL FURNISH AND APPLY WATER FOR DUST CONTROL AS DIRECTED BY THE ENGINEER. THE FOLLOWING ESTIMATED QUANTITIES HAVE BEEN INCLUDED FOR DUST CONTROL PURPOSES:

ITEM 616, WATER 84 M. GAL.

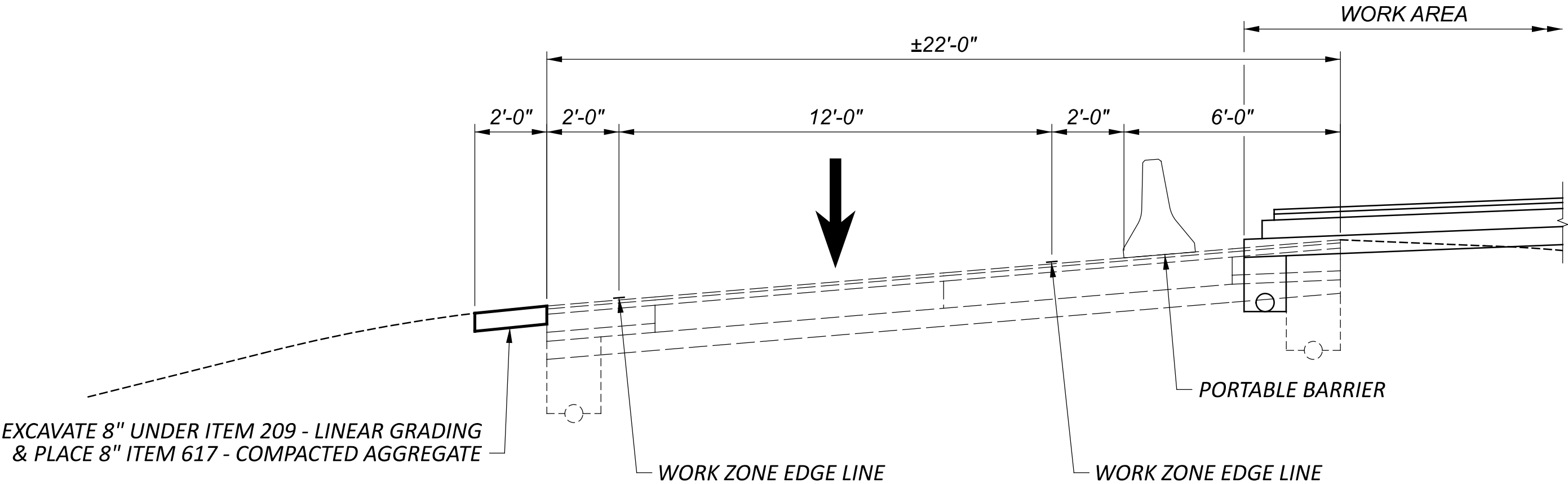

MAINTENANCE OF TRAFFIC TYPICAL SECTION
EXISTING RAMP SB

MODEL: Sheet PAPER SIZE: 34x22 (in.) DATE: 4/10/2025 TIME: 8:50:08 AM USER: GARRETT.BRENKE
 www.ohiohid-pw.bentley.com:ohiohid-pw-02/Documents/01 Active Projects/District 02/Ottawa/114099/401-Engineering_Tetra Tech/Roadway/Sheets/114099_GG001.dgn

GENERAL SUMMARY	
DESIGN AGENCY	
	
DESIGNER	
GCB	
REVIEWER	01/30/25
DTC	
PROJECT ID	
114099	
SHEET	TOTAL
P.33	127

SHEET NUMBER													PART.	ITEM	ITEM EXT	GRAND TOTAL	UNIT	DESCRIPTION	SEE SHEET NO.
16	37	40	41	42	43	116	117						01/SAF/21						
																		DRAINAGE	
			7										7	202	20010	7	EACH	HEADWALL REMOVED	
			430										430	202	35100	430	FT	PIPE REMOVED, 24" DIAMETER AND UNDER	
			3										3	202	58100	3	EACH	CATCH BASIN REMOVED	
			1										1	602	20000	1	CY	CONCRETE MASONRY	
				104									104	605	13410	104	FT	6" UNCLASSIFIED PIPE UNDERDRAINS WITH GEOTEXTILE FABRIC, 707.31	
													4,572	605	14020	4,572	FT	6" BASE PIPE UNDERDRAINS WITH GEOTEXTILE FABRIC, 707.31	
				4,572									2,055	605	14021	2,055	FT	6" BASE PIPE UNDERDRAINS WITH GEOTEXTILE FABRIC, AS PER PLAN, 707.31	15
				2,055									384	611	00510	384	FT	6" CONDUIT, TYPE F FOR UNDERDRAIN OUTLETS	
			60										60	611	04400	60	FT	12" CONDUIT, TYPE B	
			25										25	611	04600	25	FT	12" CONDUIT, TYPE C	
			128										128	611	07400	128	FT	18" CONDUIT, TYPE B	
			2										2	611	98371	2	EACH	CATCH BASIN, NO. 6, AS PER PLAN	17
			1										1	611	98630	1	EACH	CATCH BASIN ADJUSTED TO GRADE	
				7									7	611	99710	7	EACH	PRECAST REINFORCED CONCRETE OUTLET	
																		PAVEMENT	
63													63	253	02000	63	CY	PAVEMENT REPAIR	
		10,613											10,613	254	01000	10,613	SY	PAVEMENT PLANING, ASPHALT CONCRETE, 3 ¼"	
135													135	255	11000	135	SY	FULL DEPTH PAVEMENT REMOVAL AND RIGID REPLACEMENT, TYPE 1, CLASS QC1	
48													48	255	20000	48	FT	FULL DEPTH PAVEMENT SAWING	
		1,889											1,889	301	56000	1,889	CY	ASPHALT CONCRETE BASE, PG64-22, (449)	
													2,538	304	20000	2,538	CY	AGGREGATE BASE	
		2,499				39							2,948	407	10000	2,948	GAL	TACK COAT	
		2,938				10							7	441	70500	7	CY	ASPHALT CONCRETE SURFACE COURSE, TYPE 1, (449), (DRIVEWAYS)	
						7							7	441	70700	7	CY	ASPHALT CONCRETE INTERMEDIATE COURSE, TYPE 2, (449), (DRIVEWAYS)	
		909											909	442	10000	909	CY	ASPHALT CONCRETE SURFACE COURSE, 12.5 MM, TYPE A (446)	
													1,364	442	10100	1,364	CY	ASPHALT CONCRETE INTERMEDIATE COURSE, 19 MM, TYPE A (446)	
		1,364											2,610	452	12011	2,610	SY	8" NON-REINFORCED CONCRETE PAVEMENT, CLASS QC 1P, AS PER PLAN	16
		2,610											352	609	12001	352	FT	COMBINATION CURB AND GUTTER, TYPE 2, AS PER PLAN	9
	352												1,274	609	18001	1,274	FT	COMBINATION CURB AND GUTTER, TYPE 3, AS PER PLAN	9
	1,274												2,102	609	22001	2,102	FT	CURB, TYPE 3-B, AS PER PLAN	9
	2,102																		
													191	609	31001	191	FT	COMBINATION CURB AND GUTTER, TYPE 9, AS PER PLAN	9
		813											813	875	10000	813	LB	LONGITUDINAL JOINT ADHESIVE	
																		WATER WORK	
			1										1	638	10801	1	EACH	VALVE BOX ADJUSTED TO GRADE, AS PER PLAN	17A
																		LIGHTING	
							20						20	625	00450	20	EACH	CONNECTION, FUSED PULL APART	
							15						15	625	00480	15	EACH	CONNECTION, UNFUSED PERMANENT	
							10						10	625	10490	10	EACH	LIGHT POLE, CONVENTIONAL, AT22B35	
							10						10	625	14100	10	EACH	LIGHT POLE FOUNDATION, 24" X 8' DEEP	
							579						579	625	23200	579	FT	NO. 4 AWG 2400 VOLT DISTRIBUTION CABLE	
													1,860	625	23400	1,860	FT	NO. 10 AWG POLE AND BRACKET CABLE	
							1,679						1,679	625	24320	1,679	FT	1-1/2" DUCT CABLE WITH THREE NO. 4 AWG 2400 VOLT CABLES	
							173						173	625	25504	173	FT	CONDUIT, 3", 725.051	
							10						10	625	26253	10	EACH	LUMINAIRE, CONVENTIONAL, SOLID STATE (LED), AS PER PLAN, 17,500-18,200 LUMENS	116
							1,732						1,732	625	29002	1,732	FT	TRENCH, 24" DEEP	
							3						3	625	30700	3	EACH	PULL BOX, 725.08, 18"	
							1						1	625	30706	1	EACH	PULL BOX, 725.08, 24"	
							10						10	625	32000	10	EACH	GROUND ROD	
							1						1	625	34001	1	EACH	POWER SERVICE, AS PER PLAN	116
							1,732						1,732	625	36010	1,732	FT	UNDERGROUND WARNING/MARKING TAPE	
						LS							LS	625	39000	LS		TEMPORARY LIGHTING	
							1						1	625	76000	1	EACH	ARC FLASH CALCULATIONS AND LABEL, DISCONNECT SWITCH	
							1						1	625	76000	1	EACH	ARC FLASH CALCULATIONS AND LABEL, ENCLOSURE	

GENERAL SUMMARY

DESIGN AGENCY

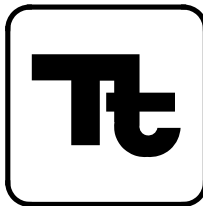

DESIGNER

GCB

REVIEWER

DTC 01/30/25

PROJECT ID

114099

SHEET

P.34

TOTAL

127

SHEET NUMBER														PART.	ITEM	ITEM EXT	GRAND TOTAL	UNIT	DESCRIPTION	SEE SHEET NO.
17	20	21	22	37	94	98								01/SAF/21						
																			TRAFFIC CONTROL	
						13								13	620	00500	13	EACH	DELINEATOR, POST GROUND MOUNTED (TYPE C)	
						3								3	620	70000	3	EACH	DELINEATOR, MISC.:HIGH INTENSITY RETRO-REFLECTIVE ISLAND BULLNOSE MARKER	17
					117									117	621	00100	117	EACH	RPM	
					34									34	621	54000	34	EACH	RAISED PAVEMENT MARKER REMOVED	
				28										28	626	00102	28	EACH	BARRIER REFLECTOR, TYPE 1 (BIDIRECTIONAL)	
														20	626	00110	20	EACH	BARRIER REFLECTOR, TYPE 2 (UNIDIRECTIONAL)	
				20		503								503	630	03101	503	FT	GROUND MOUNTED SUPPORT, NO. 3 POST, AS PER PLAN	17
						20								20	630	08601	20	EACH	SIGN POST REFLECTOR, AS PER PLAN	17
						16								16	630	75000	16	EACH	SIGN ATTACHMENT ASSEMBLY	
						277								277	630	80100	277	SF	SIGN, FLAT SHEET	
						64								64	630	80200	64	SF	SIGN, GROUND MOUNTED EXTRUSHEET	
						860								860	630	80224	860	SF	SIGN, OVERHEAD EXTRUSHEET	
						277								277	630	81100	277	SF	SIGN ERECTED, FLAT SHEET	
						924								924	630	81200	924	SF	SIGN ERECTED, EXTRUSHEET	
						4								4	630	84501	4	EACH	GROUND MOUNTED STRUCTURAL BEAM SUPPORT FOUNDATION, AS PER PLAN	17
						99								99	630	84900	99	EACH	REMOVAL OF GROUND MOUNTED SIGN AND DISPOSAL	
						66								66	630	86002	66	EACH	REMOVAL OF GROUND MOUNTED POST SUPPORT AND DISPOSAL	
						7								7	630	87400	7	EACH	REMOVAL OF OVERHEAD MOUNTED SIGN AND DISPOSAL	
						21								21	630	97900	21	FT	SIGNING, MISC.: 4" X 6" WOOD POST	17
						67								67	630	97900	67	FT	SIGNING, MISC.: 6" X 8" WOOD POST	17
					2.57									2.57	642	00104	2.57	MILE	EDGE LINE, 6", TYPE 1	
					0.38									0.38	642	00204	0.38	MILE	LANE LINE, 6", TYPE 1	
					0.35									0.35	642	00300	0.35	MILE	CENTER LINE, TYPE 1	
					33									33	644	00500	33	FT	STOP LINE	
					116									116	644	00700	116	FT	TRANSVERSE/DIAGONAL LINE	
						3								3	644	01300	3	EACH	LANE ARROW	
						3								3	644	01350	3	EACH	LANE REDUCTION ARROW	
						870								870	644	01510	870	FT	DOTTED LINE, 6"	
						54								54	644	20800	54	FT	YIELD LINE	
																			LANDSCAPING	
169														169	204	50000	169	SY	GEOTEXTILE FABRIC, TYPE B, 712.09	
169														169	657	10001	169	SY	RIPRAP FOR TREE PROTECTION, AS PER PLAN	17
16														16	653	10001	16	CY	TOPSOIL FURNISHED AND PLACED, AS PER PLAN	17
																			MAINTENANCE OF TRAFFIC	
			18											18	209	60200	18	STA	LINEAR GRADING	
	100													100	410	12000	100	CY	TRAFFIC COMPACTED SURFACE, TYPE A OR B	
		24												24	614	11110	24	HOUR	LAW ENFORCEMENT OFFICER WITH PATROL CAR FOR ASSISTANCE	
			1,340											1,340	614	11630	1,340	FT	INCREASED BARRIER DELINEATION	
			1											1	614	12384	1	EACH	WORK ZONE IMPACT ATTENUATOR, 24" WIDE HAZARDS, (BIDIRECTIONAL)	
														LS	614	12420	LS		DETOUR SIGNING	
			3											3	614	12500	3	EACH	REPLACEMENT SIGN	
			3											3	614	12600	3	EACH	REPLACEMENT DRUM	
	20													20	614	13000	20	CY	ASPHALT CONCRETE FOR MAINTAINING TRAFFIC	
			29											29	614	13310	29	EACH	BARRIER REFLECTOR, TYPE 1 (ONE-WAY)	
			29											29	614	13350	29	EACH	OBJECT MARKER, ONE WAY	
		19												19	614	18601	19	SNMT	PORTABLE CHANGEABLE MESSAGE SIGN, AS PER PLAN	21
			0.76											0.76	614	22010	0.76	MILE	WORK ZONE EDGE LINE, CLASS I, 6"	
			4											4	614	40051	4	EACH	BUSINESS ENTRANCE SIGN, AS PER PLAN	22
	84													84	616	10000	84	MGAL	WATER	
	75		88											163	617	10100	163	CY	COMPACTED AGGREGATE	
			1,370											1,370	622	41100	1,370	FT	PORTABLE BARRIER, UNANCHORED	
														LS	108	10000	LS		INCIDENTALS	
														LS	614	11000	LS		CPM PROGRESS SCHEDULE	
14														14	619	16021	14	MNTH	MAINTAINING TRAFFIC	17
														LS	623	10000	LS		FIELD OFFICE, TYPE C, AS PER PLAN	
														LS	624	10000	LS		CONSTRUCTION LAYOUT STAKES AND SURVEYING	
																			MOBILIZATION	

GENERAL SUMMARY

DESIGN AGENCY

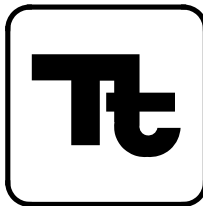

DESIGNER

GCB

REVIEWER

DTC 01/30/25

PROJECT ID

114099

SHEET

P.35

TOTAL

127

SHEET NO.	REF NO.	STATION TO STATION			SIDE	202	202	202	202	202	203	203	601	606	606	606	606	606	609	609	609	609	609	622	622	622	626	626	638	SPECIAL
						CONCRETE BARRIER REMOVED	GUARDRAIL REMOVED	ANCHOR ASSEMBLY REMOVED, TYPE E	BRIDGE TERMINAL ASSEMBLY REMOVED	MAILBOX REMOVED	EXCAVATION	EMBANKMENT	TIED CONCRETE BLOCK MAT WITH TYPE 1 UNDERLAYMENT	GUARDRAIL, TYPE MGS	ANCHOR ASSEMBLY, MGS TYPE E, MASH 2016	ANCHOR ASSEMBLY, MGS TYPE T	MGS BRIDGE TERMINAL ASSEMBLY, TYPE 1	MGS BRIDGE TERMINAL ASSEMBLY, TYPE 2	IMPACT ATTENUATOR, TYPE 2 (BIDIRECTIONAL), 60 MPH, 24" WIDTH	COMBINATION CURB AND GUTTER, TYPE 2, AS PER PLAN	COMBINATION CURB AND GUTTER, TYPE 3, AS PER PLAN	CURB, TYPE 3-B, AS PER PLAN	COMBINATION CURB AND GUTTER, TYPE 9, AS PER PLAN	BARRIER TRANSITION	CONCRETE BARRIER END SECTION, TYPE B	BARRIER, MISC.:CONCRETE BARRIER, TYPE A1	BARRIER REFLECTOR, TYPE 1 (BIDIRECTIONAL)	BARRIER REFLECTOR, TYPE 2 (UNIDIRECTIONAL)	VALVE BOX ADJUSTED TO GRADE, AS PER PLAN	MAILBOX SUPPORT SYSTEM, SINGLE
						FT	FT	EACH	EACH	EACH	CY	CY	SY	FT	EACH	EACH	EACH	EACH	EACH	FT	FT	FT	FT	EACH	EACH	FT	EACH	EACH	EACH	EACH
		S.R. 269																												
64		544+26.12	TO	546+00.00								10																		
65		547+00.00	TO	549+00.00								48																		
66		549+61.12	TO	550+50.00							23	106																		
67		551+00.00	TO	552+00.00							116	51																		
68		552+50.00	TO	553+50.00							211	85																		
69		554+00.00	TO	555+00.00							89	494																		
70		555+50.00	TO	556+50.00							23	1725																		
71		557+00.00	TO	557+77.78							49	8373																		
72		559+00.00	TO	560+00.00							175	2048																		
73		560+50.00	TO	561+50.00							52	1499																		
74		562+00.00	TO	563+00.00							29	737																		
75		563+50.00	TO	564+50.00							171	294																		
76		565+00.00	TO	566+00.00							87	219																		
77		566+50.00	TO	567+50.00							57	103																		
78		567+88.00	TO	568+00.00							38	5																		
		S DANBURY NORTH RD.																												
81		600+00.00	TO	601+00.00							76	13																		
82		601+50.00	TO	602+50.00							149	115																		
83		603+00.00	TO	604+00.00							143	375																		
		S.R. 269																												
47, 48	R-1	538+16.13	TO	542+80.95	LT		437.5		2																					
47	R-2	538+63.36	TO	538+93.36	LT/RT	30																								
47, 48	R-3	538+84.31	TO	542+74.03	RT		362.5		2																					
48, 49	R-4	543+14.65	TO	549+05.16	RT		562.5																							
48, 49	R-5	543+21.18	TO	549+24.62	LT		525	1																						
49, 50	R-6	550+96.12	TO	552+99.77	LT/RT	204																								
47	MB-1	538+63.36	TO	538+93.36	LT/RT																				30	2				
47-50	MB-2	538+93.36	TO	550+96.12	LT/RT																					24				
49, 50	MB-3	550+96.12	TO	551+46.12	LT/RT																		1	1		2				
50	IA-1	551+46.42	TO	551+66.80	LT/RT													1												

ROADWAY SUBSUMMARY

DESIGN AGENCY

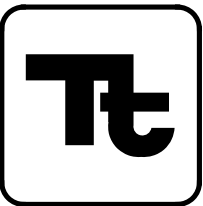

DESIGNER

GCB

REVIEWER

DTC 01/30/25

PROJECT ID

114099

SHEET

P.36

TOTAL

127

OTT-269-1.78

MODEL: Sheet PAPER SIZE: 34x22 (in.) DATE: 4/10/2025 TIME: 3:49:26 PM USER: GARRETT.BRENKE
pw:\bhidol-pw-bentley.com\bhidol-pw\02\Documents\01 Active Projects\District\02 Olawa\114099\401-Engineering_Tetra Tech\Roadway\Sheets\114099_GS007.dgn

[illegible]

ROADWAY SUBSUMMARY

DESIGN AGENCY

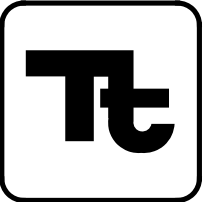

DESIGNER
GCB

REVIEWER
DTC 01/30/25

PROJECT ID
114099

SHEET	TOTAL
P.37	12

DITCH UNDERCUT AREA NO.	UNDERCUT & EMBANKMENT REPLACEMENT AREA	203	203
		EXCAVATION	EMBANKMENT
	SY	CY	CY
1	842	561	561
2	111	74	74
3	2203	1469	1469
4	376	251	251
5	73	49	49
6	655	437	437
7	539	359	359
TOTALS CARRIED TO GENERAL SUMMARY		3200	3200

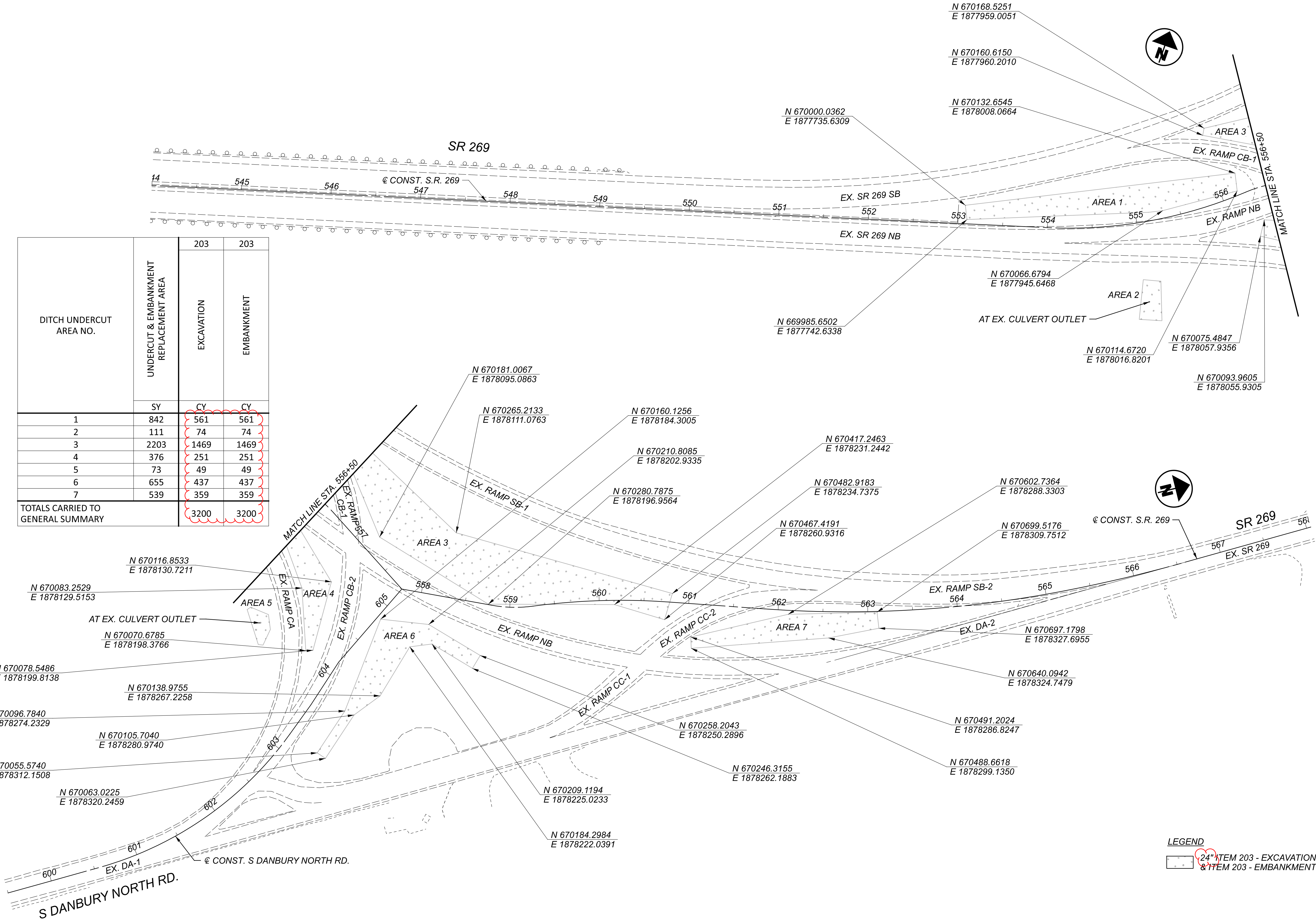

DITCH UNDERCUT PLAN

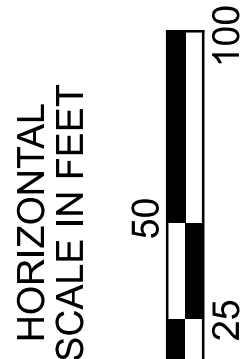

DESIGN AGENCY

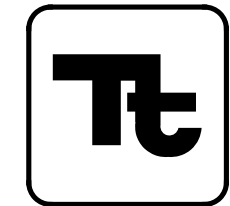

DESIGNER

JPH

REVIEWER

DTC 01/30/25

PROJECT ID

114099

SHEET

P.46

TOTAL

127

LEGEND

24" ITEM 203 - EXCAVATION
& ITEM 203 - EMBANKMENT

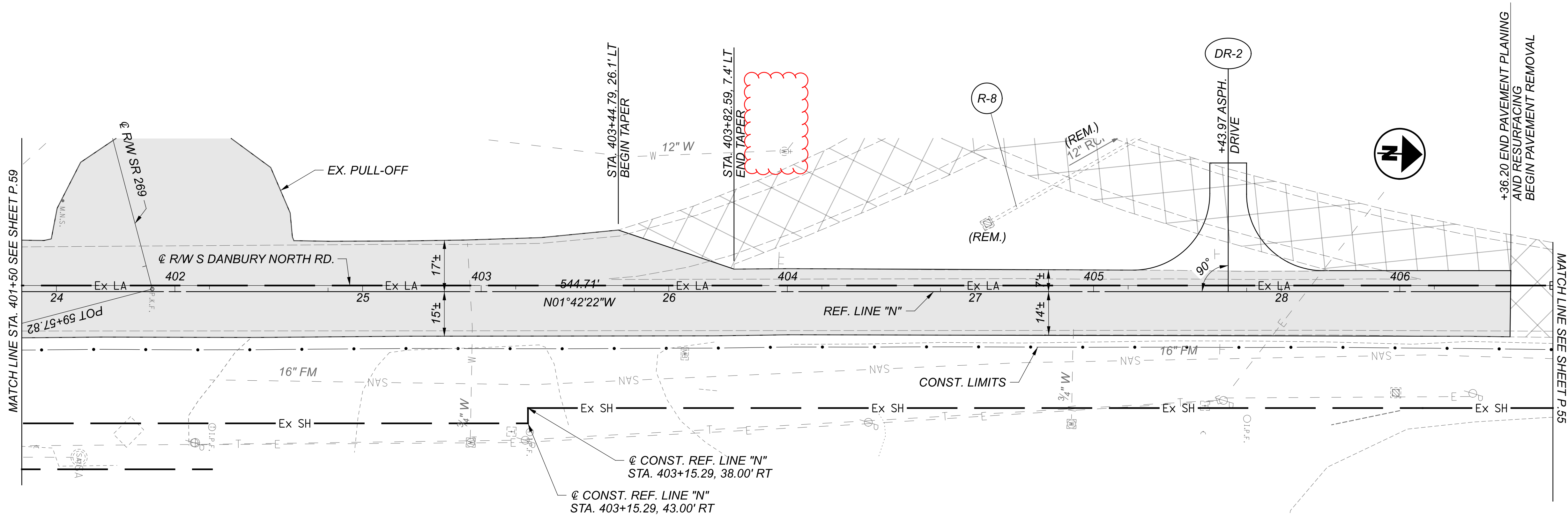

LEGEND

	PAVEMENT PLANING AND RESURFACING
	PAVEMENT REMOVED

NOTE:
4" GAS MAIN BEING INSTALLED BY COLUMBIA GAS
ALONG S. DANBURY NORTH RD. NOT SHOWN.

PLAN - S DANBURY NORTH RD. REF LINE "N"
STA. 401+50.00 TO STA. 406+36.20

DESIGN AGENCY

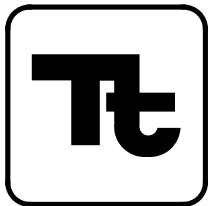

DESIGNER

JPH

REVIEWER

DTC 01/30/25

PROJECT ID

114099

SHEET

P.62

TOTAL

127



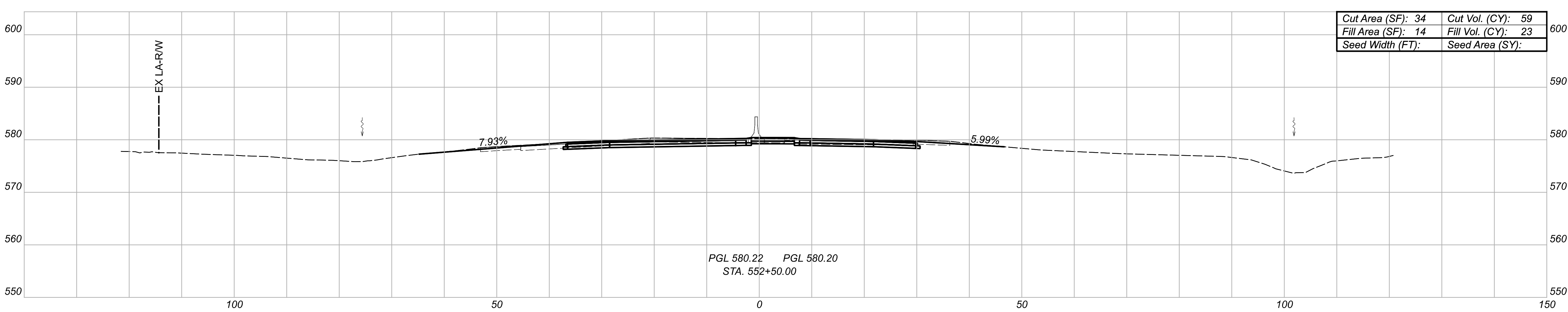
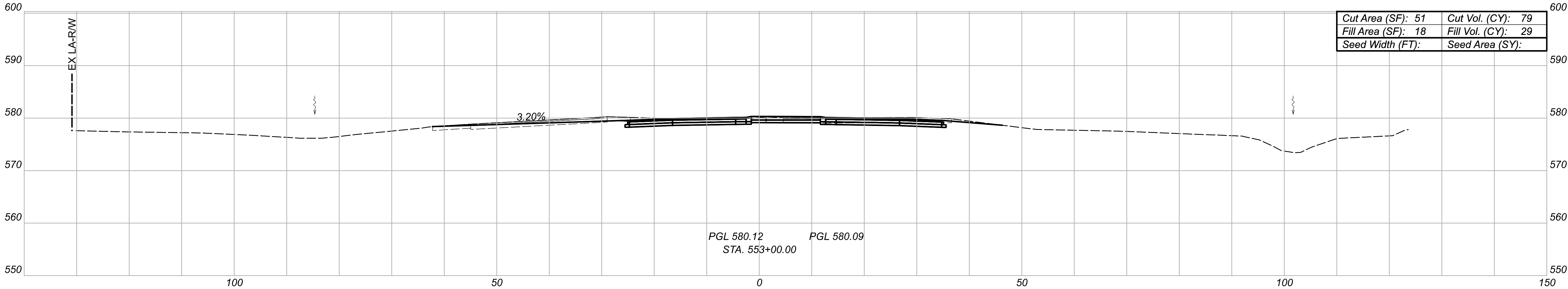
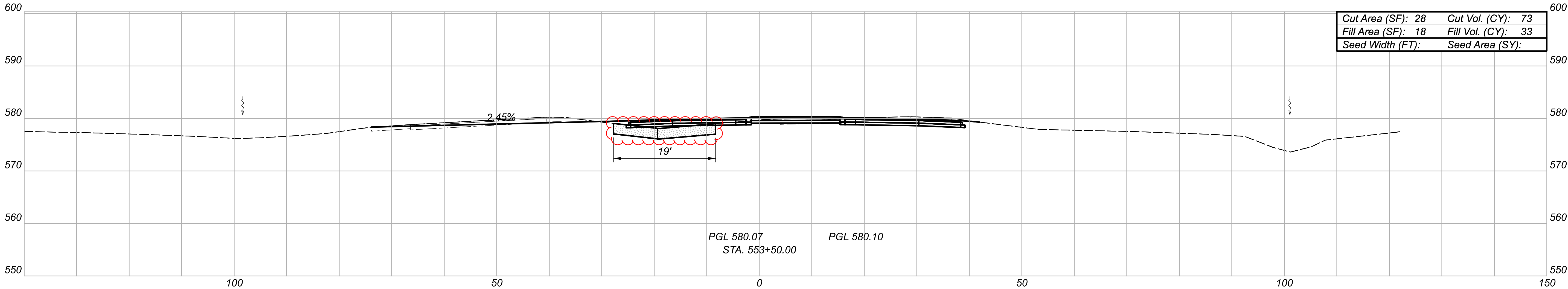

24" ITEM 203 - EXCAVATION
& ITEM 203 - EMBANKMENT

Sheet Totals		
Seeding	Cut	Fill
.	241	85

DESIGN AGENCY



DESIGNER

JPH

REVIEWER

DTC 01/30/25

PROJECT ID

114099

SHEET

P.68

TOTAL

127

CROSS SECTIONS - S.R. 269
STA. 552+50.00 TO STA. 553+50.00

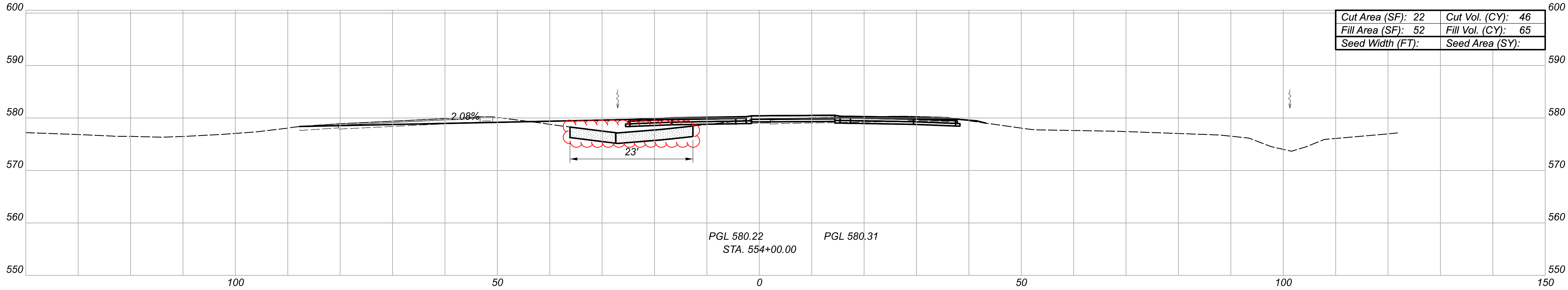
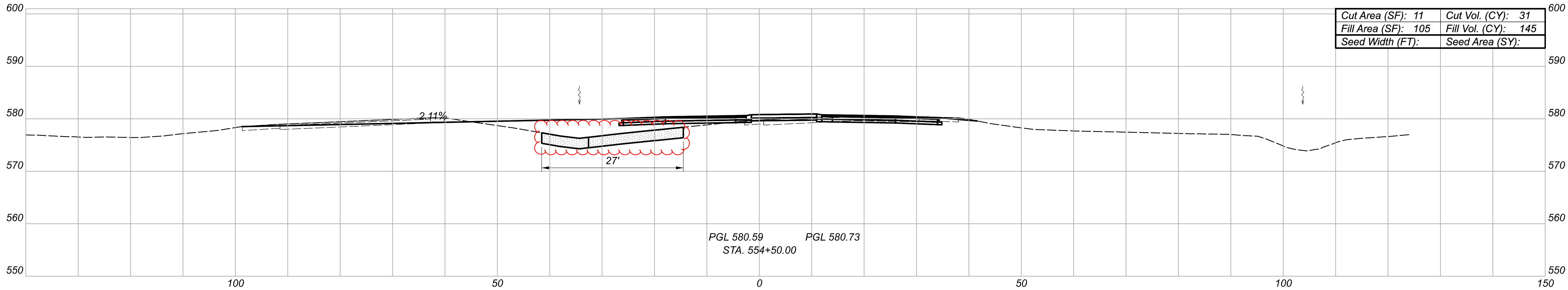
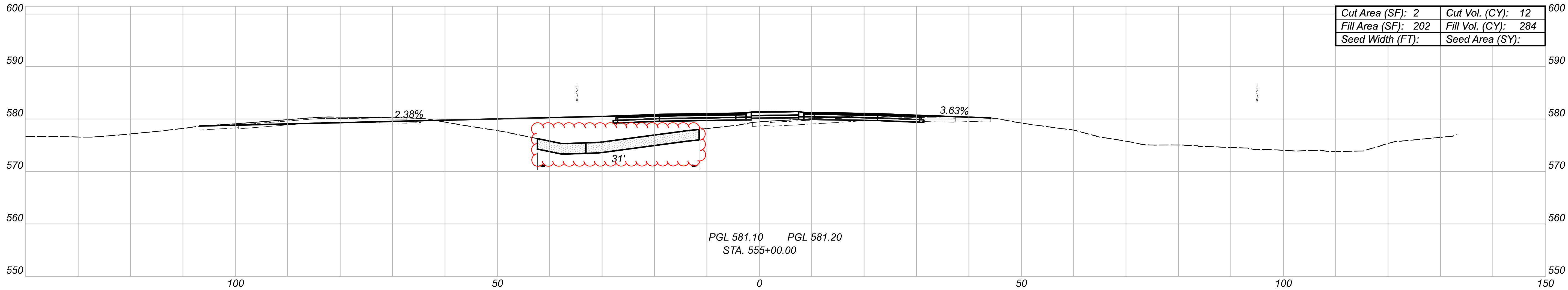

ITEM 203 - EXCAVATION
& ITEM 203 - EMBANKMENT

Sheet Totals		
Seeding	Cut	Fill
.	89	494

CROSS SECTIONS - S.R. 269
STA. 554+00.00 TO STA. 555+00.00

DESIGN AGENCY



DESIGNER
JPH

REVIEWER
DTC 01/30/25

PROJECT ID
114099

SHEET	TOTAL
P.69	127

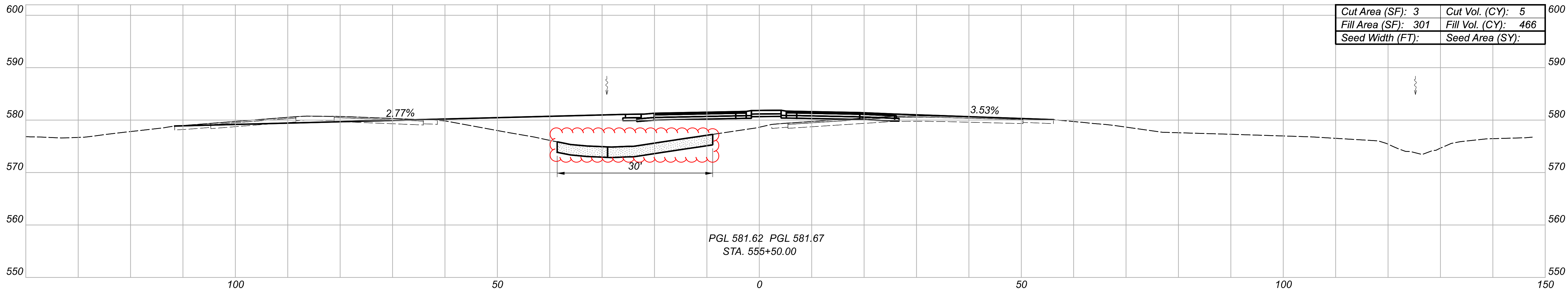
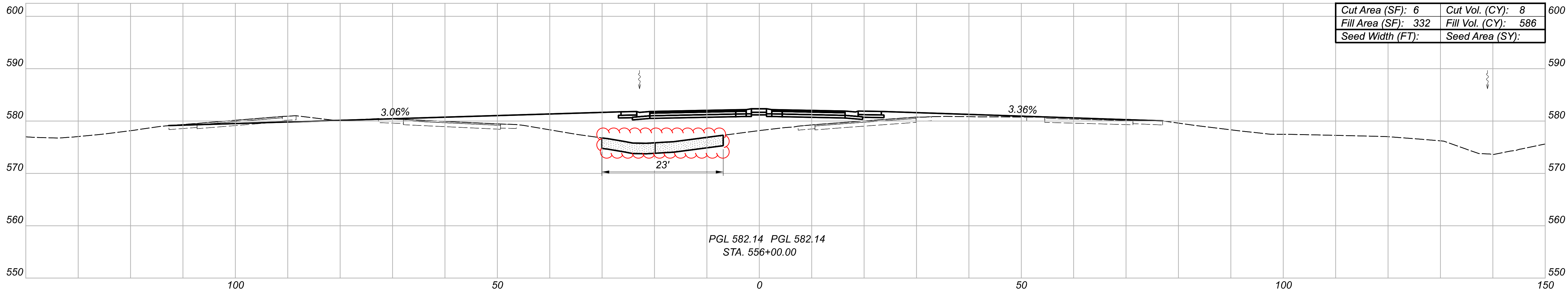
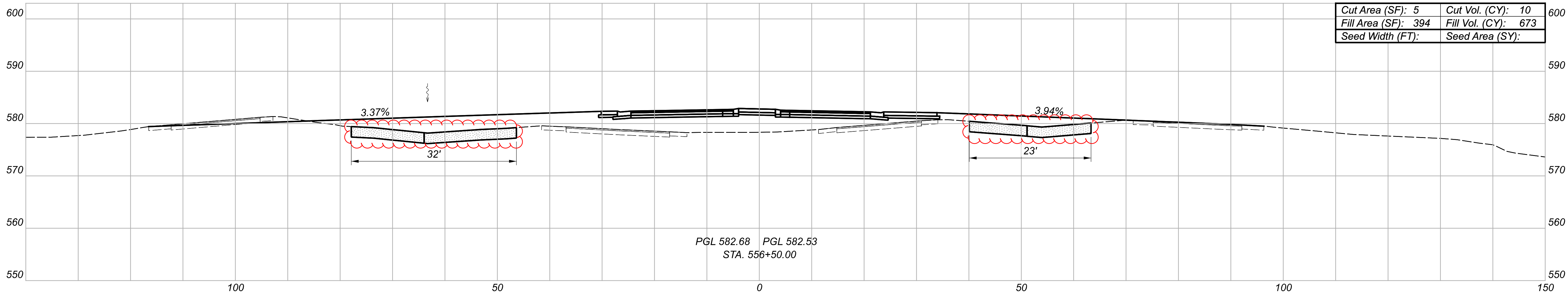

24" ITEM 203 - EXCAVATION
& ITEM 203 - EMBANKMENT

Sheet Totals		
Seeding	Cut	Fill
.	23	1725

SHEET	TOTAL
P.70	127

DESIGN AGENCY

Tt

DESIGNER
JPH

REVIEWER
DTC 01/30/25

PROJECT ID
114099

CROSS SECTIONS - S.R. 269
STA. 555+50.00 TO STA. 556+50.00

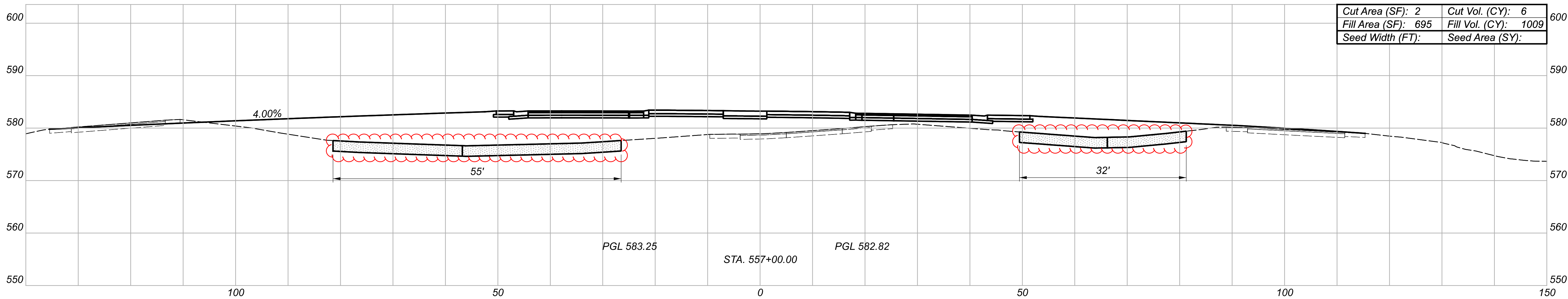
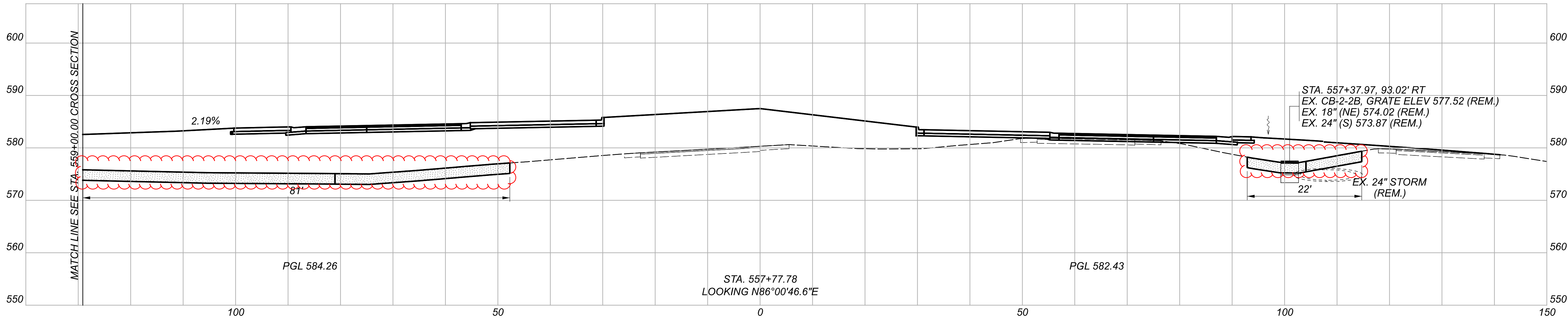
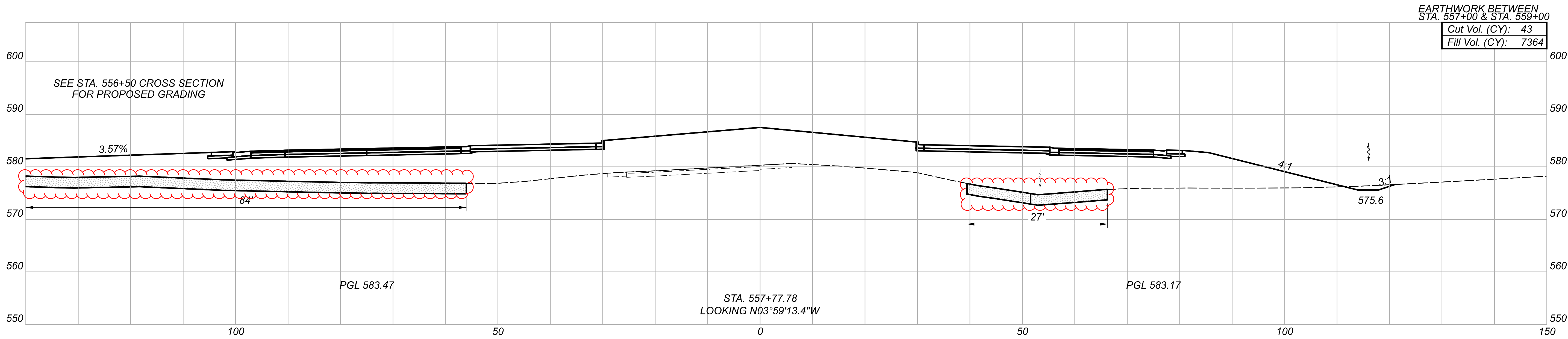

24" ITEM 203 - EXCAVATION
& ITEM 203 - EMBANKMENT

Sheet Totals			SHEET	TOTAL
Seeding	Cut	Fill		
.	49	8373	P.71	127

CROSS SECTIONS - S.R. 269
STA. 557+00.00 TO STA. 557+77.78

DESIGN AGENCY

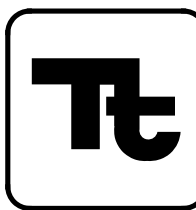

DESIGNER

JPH

REVIEWER

DTC 01/30/25

PROJECT ID

114099

SHEET

P.71

TOTAL

127

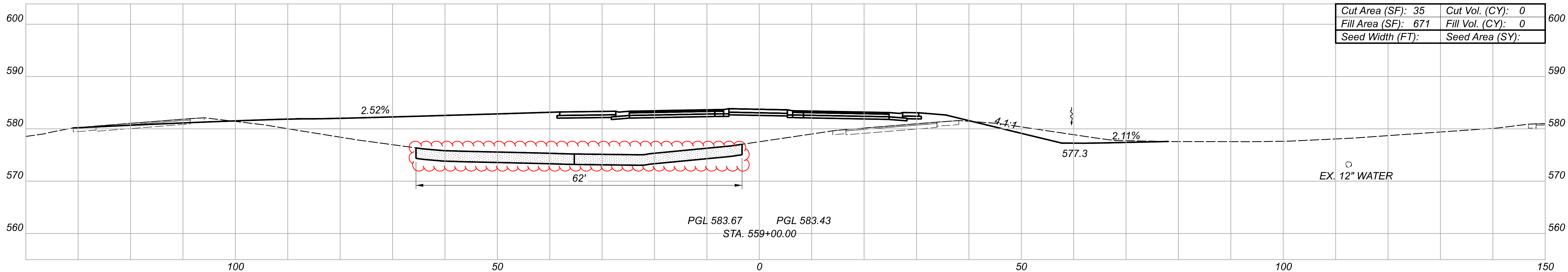
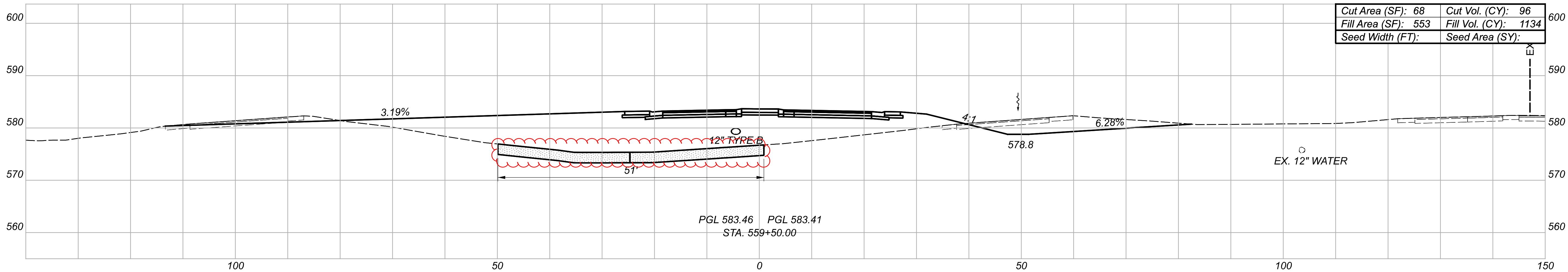
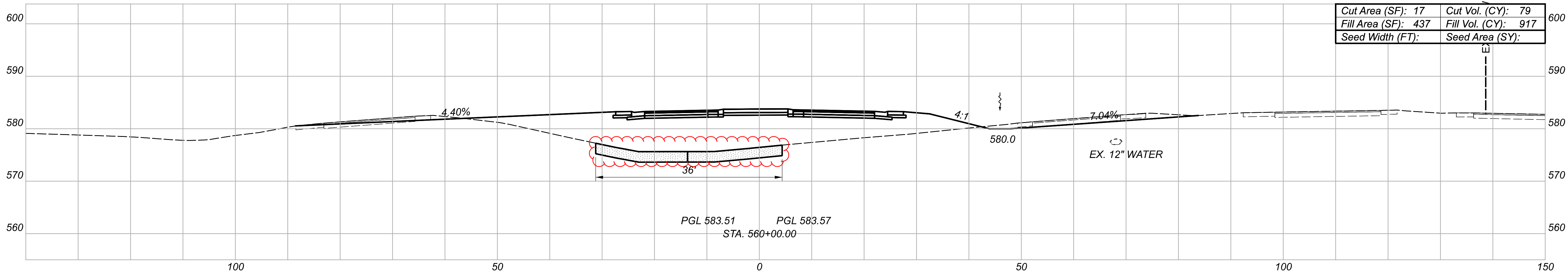

24" ITEM 203 - EXCAVATION
& ITEM 203 - EMBANKMENT

Sheet Totals		
Seeding	Cut	Fill
.	175	2048

DESIGN AGENCY

DESIGNER

JPH

REVIEWER

DTC 01/30/25

PROJECT ID

114099

SHEET

P.72

TOTAL

127

CROSS SECTIONS - S.R. 269
STA. 559+00.00 TO STA. 560+00.00

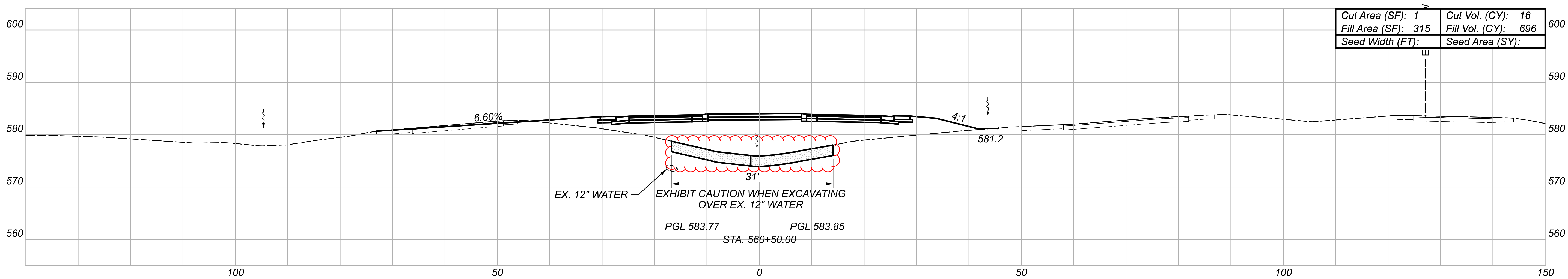
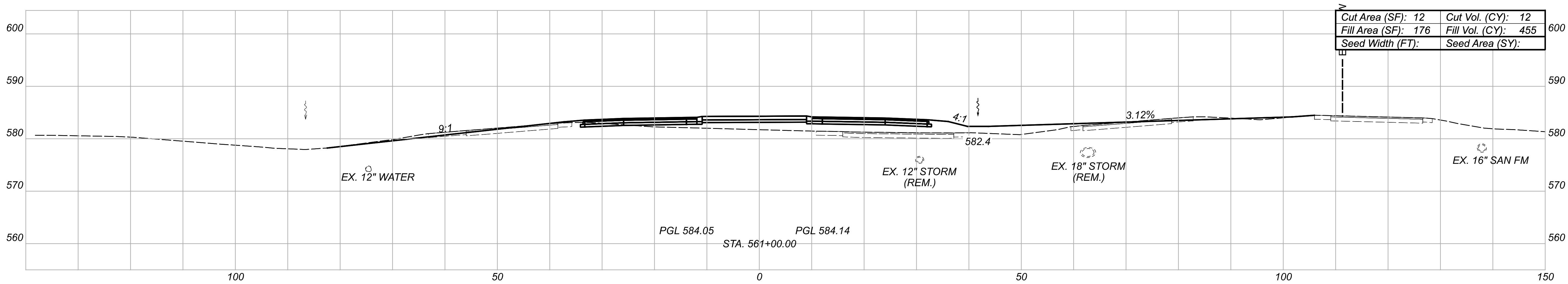
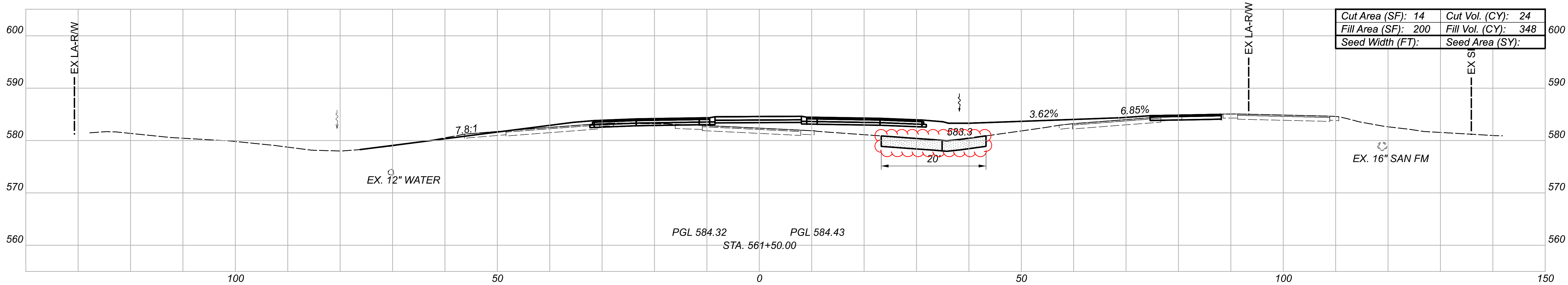

24" ITEM 203 - EXCAVATION
& ITEM 203 - EMBANKMENT

Sheet Totals		
Seeding	Cut	Fill
.	52	1499

CROSS SECTIONS - S.R. 269
STA. 560+50.00 TO STA. 561+50.00

DESIGN AGENCY

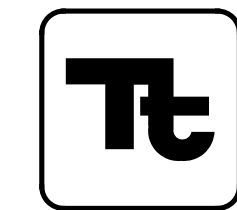

DESIGNER
JPH

REVIEWER
DTC 01/30/25

PROJECT ID
114099

SHEET
P.73

TOTAL
127

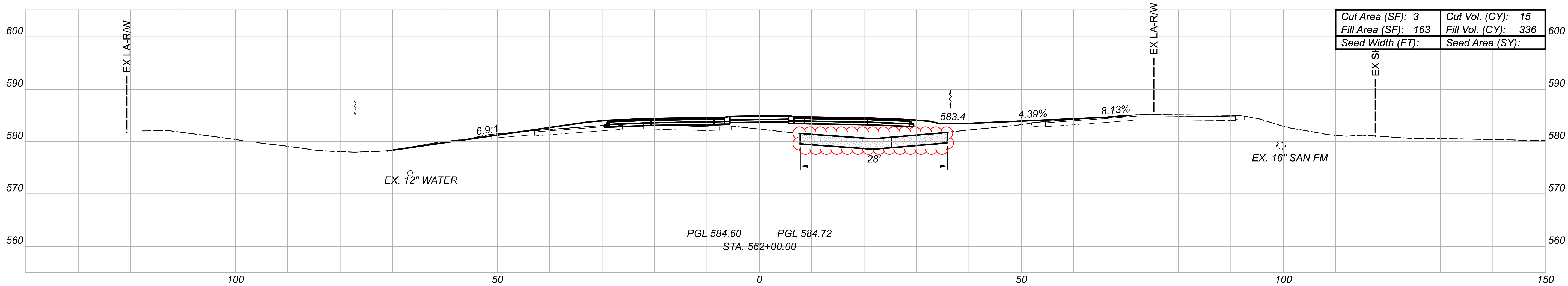
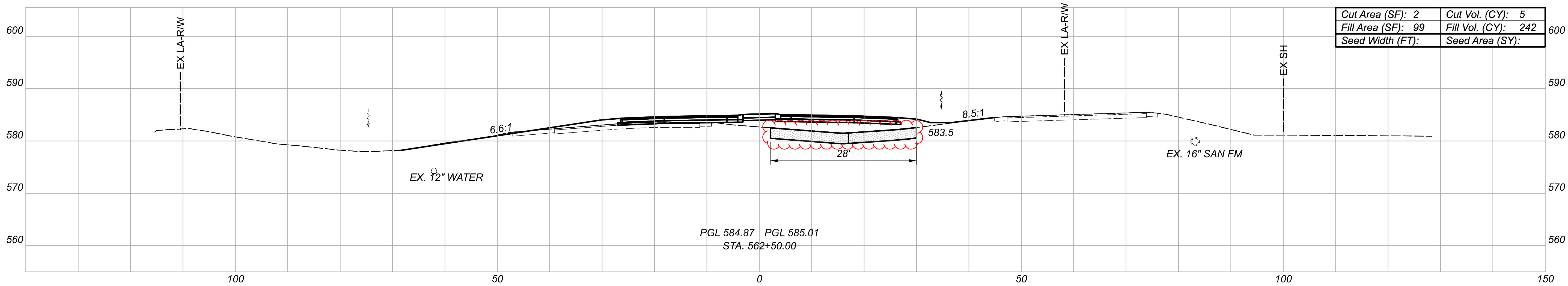
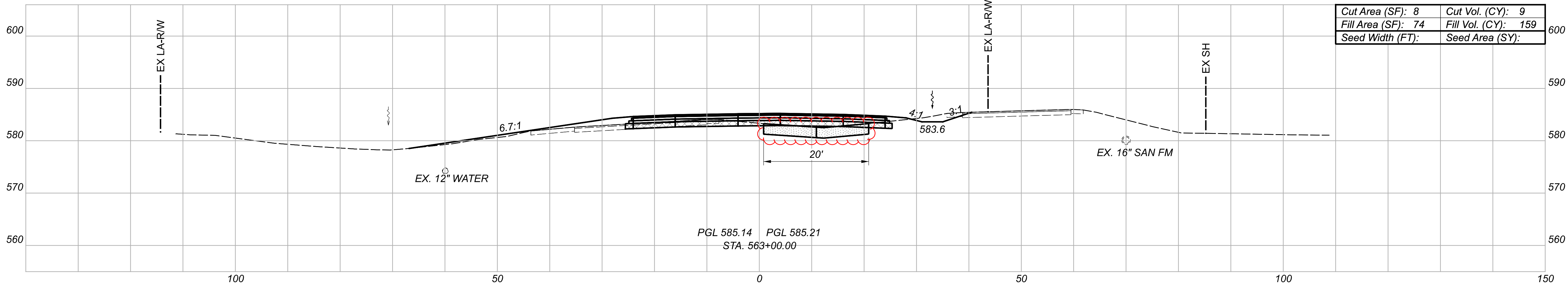

12" ITEM 204 - EXCAVATION OF SUBGRADE
& ITEM 204 - GRANULAR MATERIAL, TYPE D
24" ITEM 203 - EXCAVATION
& ITEM 203 - EMBANKMENT

Sheet Totals			SHEET	TOTAL
Seeding	Cut	Fill		
.	29	737	P.74	127

CROSS SECTIONS - S.R. 269
STA. 562+00.00 TO STA. 563+00.00

DESIGN AGENCY

DESIGNER

JPH

REVIEWER

DTC 01/30/25

PROJECT ID

114099

SHEET

P.74

TOTAL

127

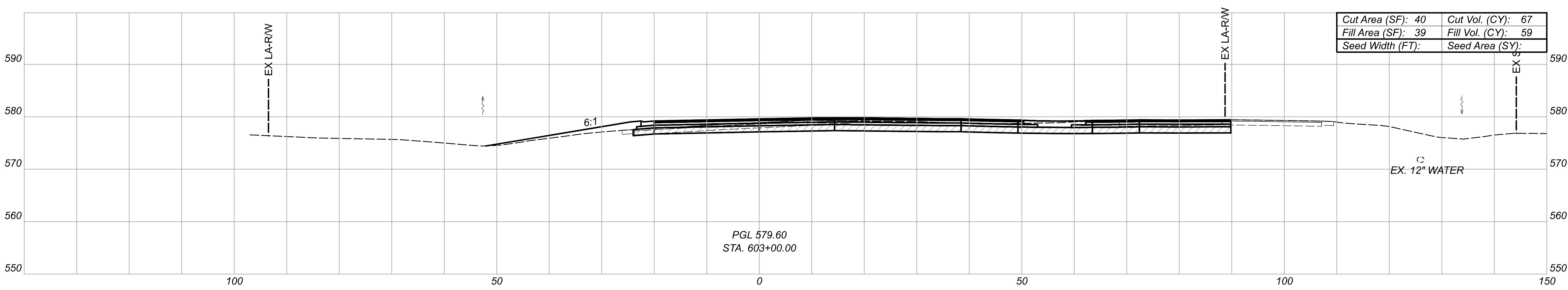
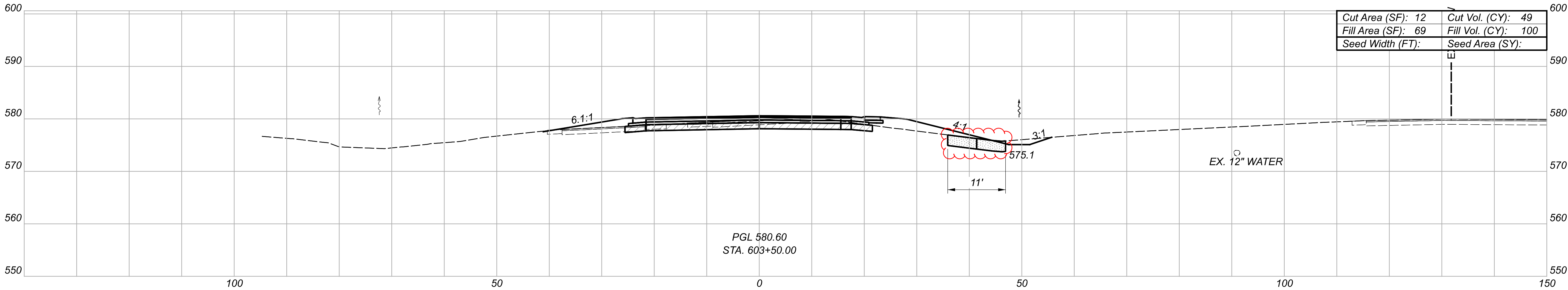
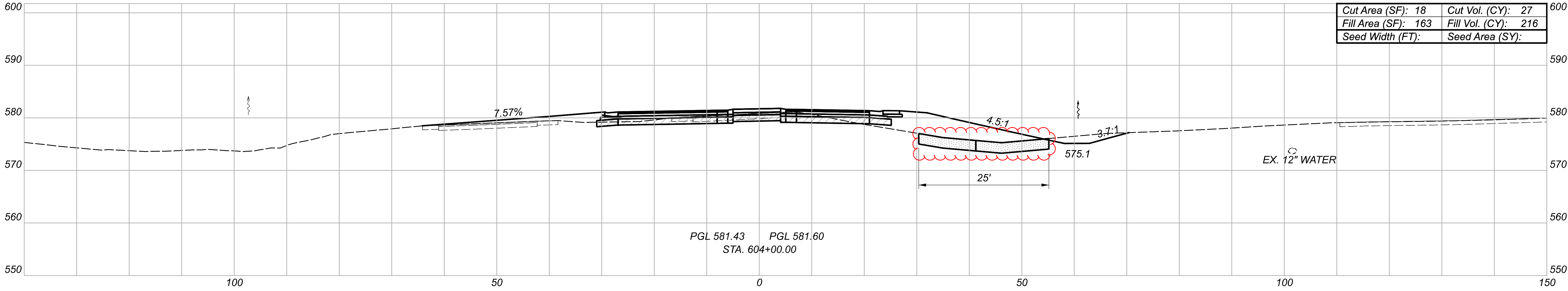

ITEM 204 - CEMENT STABILIZED
SUBGRADE, 14" DEEP
ITEM 203 - EXCAVATION
& ITEM 203 - EMBANKMENT

Sheet Totals		
Seeding	Cut	Fill
.	143	375

CROSS SECTIONS - S DANBURY NORTH RD.
STA. 603+00.00 TO STA. 604+00.00

DESIGN AGENCY

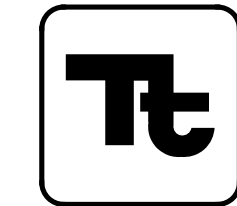

DESIGNER
JPH

REVIEWER
DTC 01/30/25

PROJECT ID
114099

SHEET	TOTAL
P.83	127

SHEET NO.	REF NO.	LOCATION	STATION	SIDE	CODE	SIZE (INCHES)	COLOR, SEE LEGEND, SHEET P.17	620	620	630	630	630	630	630	630	630	630	630	630	630	630	630					
								DELINEATOR, POST GROUND MOUNTED (TYPE C)	DELINEATOR, MISC.:HIGH INTENSITY RETRO-REFLECTIVE ISLAND BULLNOSE MARKER	GROUND MOUNTED SUPPORT, NO. 3 POST, AS PER PLAN	SIGN POST REFLECTOR, AS PER PLAN (RED)	SIGN POST REFLECTOR, AS PER PLAN (WHITE)	SIGN ATTACHMENT ASSEMBLY	SIGN, FLAT SHEET	SIGN, GROUND MOUNTED EXTRUSHEET	SIGN, OVERHEAD EXTRUSHEET	SIGN ERECTED, FLAT SHEET	SIGN ERECTED, EXTRUSHEET	GROUND MOUNTED STRUCTURAL BEAM SUPPORT FOUNDATION, AS PER PLAN	REMOVAL OF GROUND MOUNTED SIGN AND DISPOSAL	REMOVAL OF GROUND MOUNTED POST SUPPORT AND DISPOSAL	REMOVAL OF OVERHEAD MOUNTED SIGN AND DISPOSAL	SIGNING, MISC.: 4" X 6" WOOD POST	SIGNING, MISC.: 6" X 8" WOOD POST			
								EACH	EACH	FT	EACH	EACH	EACH	SF	SF	SF	SF	SF	EACH	EACH	EACH	EACH	FT	FT			
	R-43	NOT USED																									
111	R-44	S DANBURY NORTH RD.	600+09	RT	M3-3														11	1							
					M4-5																						
					M3-1																						
					M1-5-2																						
					M1-5-3																						
					M1-5-3																						
					M6-2L																						
					M6-2L																						
					M6-3																						
					M8-H7																						
111	R-45	S DANBURY NORTH RD.	600+19	RT	W3-1													1	2								
111	R-46	S DANBURY NORTH RD.	602+22	RT	R5-H10e													1	2								
111	R-47	S DANBURY NORTH RD.	602+41	RT	R5-1													1	2								
111	R-48	S DANBURY NORTH RD.	602+52	RT	R5-1													2	2								
				R1-1																							
111	R-49	S DANBURY NORTH RD.	602+56	RT	R4-7b													1	1								
111	R-50	S DANBURY NORTH RD.	602+98	RT	R5-1													2	2								
				R1-1																							
111	R-51	S DANBURY NORTH RD.	603+38	RT	W3-1													1	2								
111	S-26	S DANBURY NORTH RD.	596+68	RT	D1-H1a	72X12	G/W			14 / 14			6.0		6.0												
					D1-H1a	72X12	G/W						6.0		6.0												
111	S-27	S DANBURY NORTH RD.	599+35	RT	W3-1	36X36	BLK/FY						9.0		9.0												
					W2-6	36X36	BLK/FY				9.0		9.0														
					W16-H8P	36X8	BLK/FY				2.0		2.0														
					W13-1P	24X24	BLK/FY				4.0		4.0														
111	S-28	S DANBURY NORTH RD.	601+35	RT	M3-3	24X12	BLK/W						2.0		2.0		1										
					M4-5	24X12	BLK/W					2.0		2.0													
					M3-1	30X24	BLK/W					5.0		5.0													
					M1-5-2	24X24	BLK/W					4.0		4.0													
					M1-5-3	30X24	BLK/W					5.0		5.0													
					M1-5-3	30X24	BLK/W					5.0		5.0													
					M5-3	21X15	BLK/W					2.2		2.2													
					M5-3	21X15	G/W					2.2		2.2													
					M5-3	21X15	BLK/W					2.2		2.2													
M6-3	21X15	BLK/W					2.2		2.2																		
					M8-H7	24X24	G/W						4.0		4.0												
111	S-29	REF. LINE "N"	400+40	LT	R1-1	30X30	R/W			13.5	2		6.3		6.3												
111	S-30	REF. LINE "N"	400+60	RT	W14-1	30X30	BLK/FY			13			6.3		6.3												
111	DE-13	S DANBURY NORTH RD.	600+55	RT				1																			
111	DE-14	S DANBURY NORTH RD.	601+10	RT				1																			
111	DE-15	S DANBURY NORTH RD.	601+65	RT				1																			
111	DE-16	S DANBURY NORTH RD.	602+20	RT				1																			
TOTALS CARRIED FROM PREVIOUS SHEET								9	3	418	12	6	16	192.0	64.0	860.0	192.0	924.0	3	79	52	7	21	45			
TOTALS THIS SHEET								4		85	2			85			85		1	20	14		0	22			
TOTALS CARRIED TO GENERAL SUMMARY								13	3	503	14	6	16	277	64	860	277	924	4	99	66	7	21	67			

SIGNING SUBSUMMARY

DESIGN AGENCY

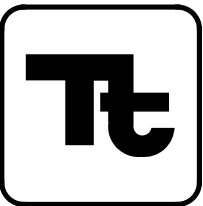

DESIGNER

GCE

REVIEWE

DTC 01/3

PROJECT ID

PROJECT ID
114000

114093

SHEET TOTAL

P.98

