

COUNTY:	STARK	
LOCATION:	S.R. 21 @ S.R. 93 - GORES	
S.L.M.:	18.324	
24" STOP LINE:		L.F.
12" CROSSWALK LINE:		L.F.
DOTTED LINE:	1125	L.F.
8" CHANNELIZING LINE:	780	L.F.
12" CHANNELIZING LINE:		L.F.
24" TRANSVERSE LINE (WT):		L.F.
24" TRANSVERSE LINE (YW):		L.F.
SYMBOL:		

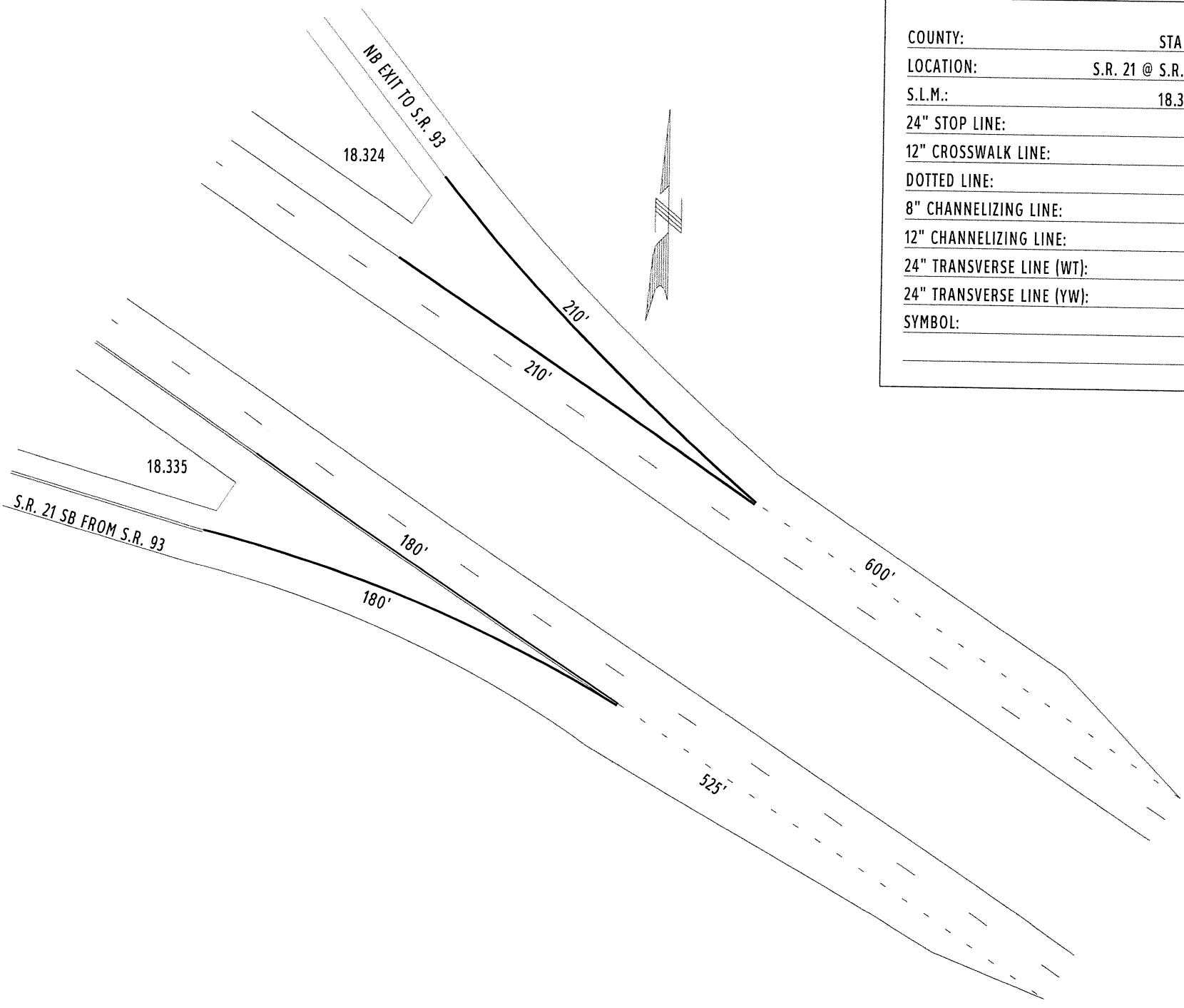

COUNTY:	STARK	
LOCATION:	S.R. 21 NB OFF RAMP @ S.R. 193	
S.L.M.:	18.49	
24" STOP LINE:	34	L.F.
12" CROSSWALK LINE:		L.F.
DOTTED LINE:		L.F.
8" CHANNELIZING LINE:	138	L.F.
12" CHANNELIZING LINE:		L.F.
24" TRANSVERSE LINE (WT):	88	L.F.
24" TRANSVERSE LINE (YW):		L.F.
SYMBOL: 2 - WRONG WAY ARROWS		

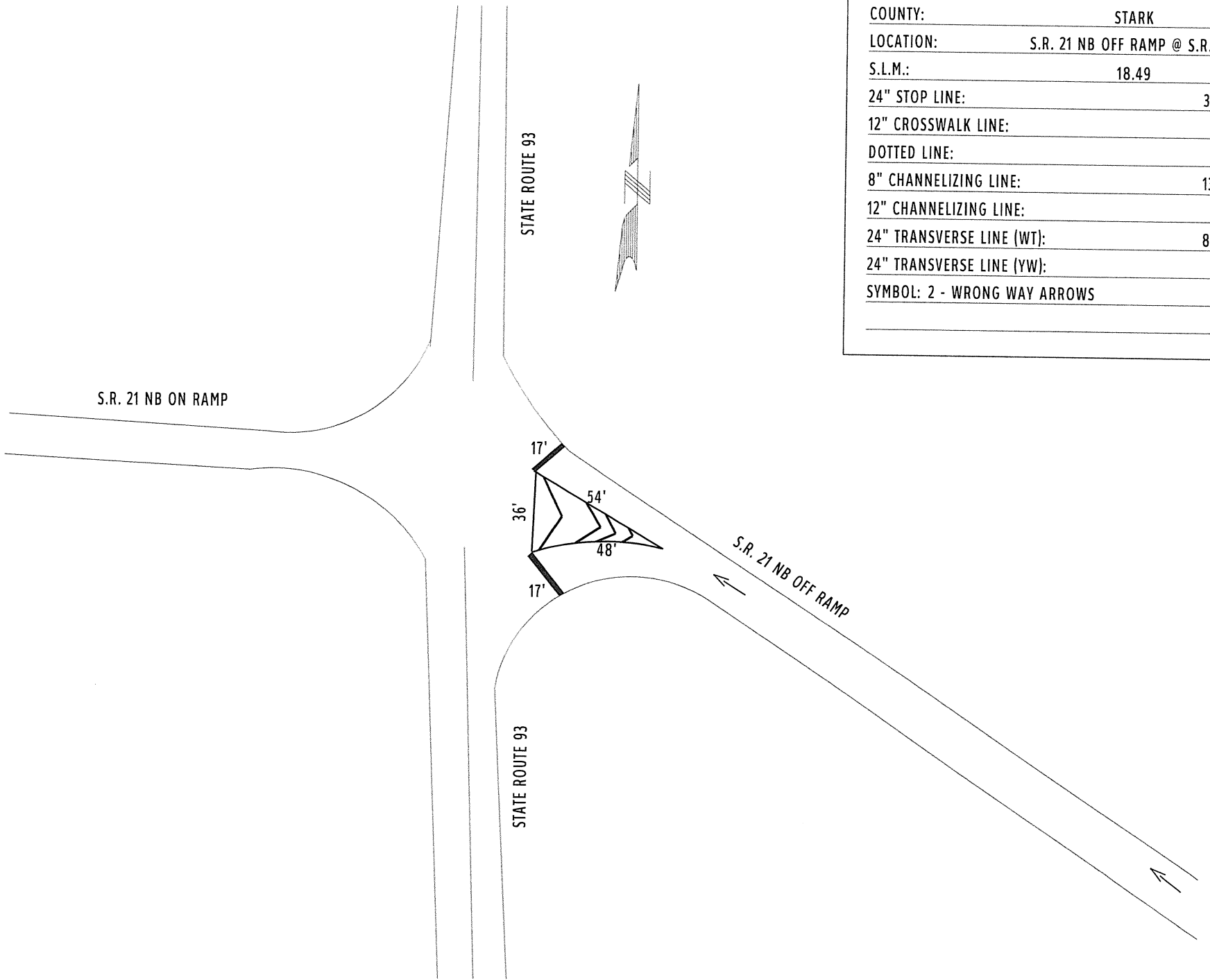

COUNTY:	STARK	
LOCATION:	S.R. 21 SB OFF RAMP @ S.R. 93	
S.L.M.:	18.51	
24" STOP LINE:	42	L.F.
12" CROSSWALK LINE:		L.F.
DOTTED LINE:		L.F.
8" CHANNELIZING LINE:	114	L.F.
12" CHANNELIZING LINE:		L.F.
24" TRANSVERSE LINE (WT):	60	L.F.
24" TRANSVERSE LINE (YW):		L.F.
SYMBOL: 2 - WRONG WAY ARROWS		

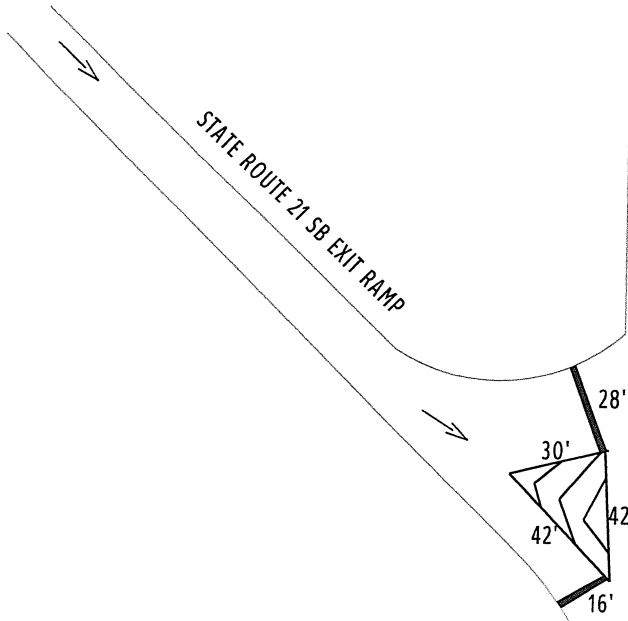

STATE ROUTE 93

STATE ROUTE 93

STATE ROUTE 21 SB ON RAMP



COUNTY:	STARK	
LOCATION:	S.R. 21 @ S.R. 93 - GORES	
S.L.M.:	18.574	
24" STOP LINE:		L.F.
12" CROSSWALK LINE:		L.F.
DOTTED LINE:	1710	L.F.
8" CHANNELIZING LINE:	820	L.F.
12" CHANNELIZING LINE:		L.F.
24" TRANSVERSE LINE (WT):		L.F.
24" TRANSVERSE LINE (YW):		L.F.
SYMBOL:		

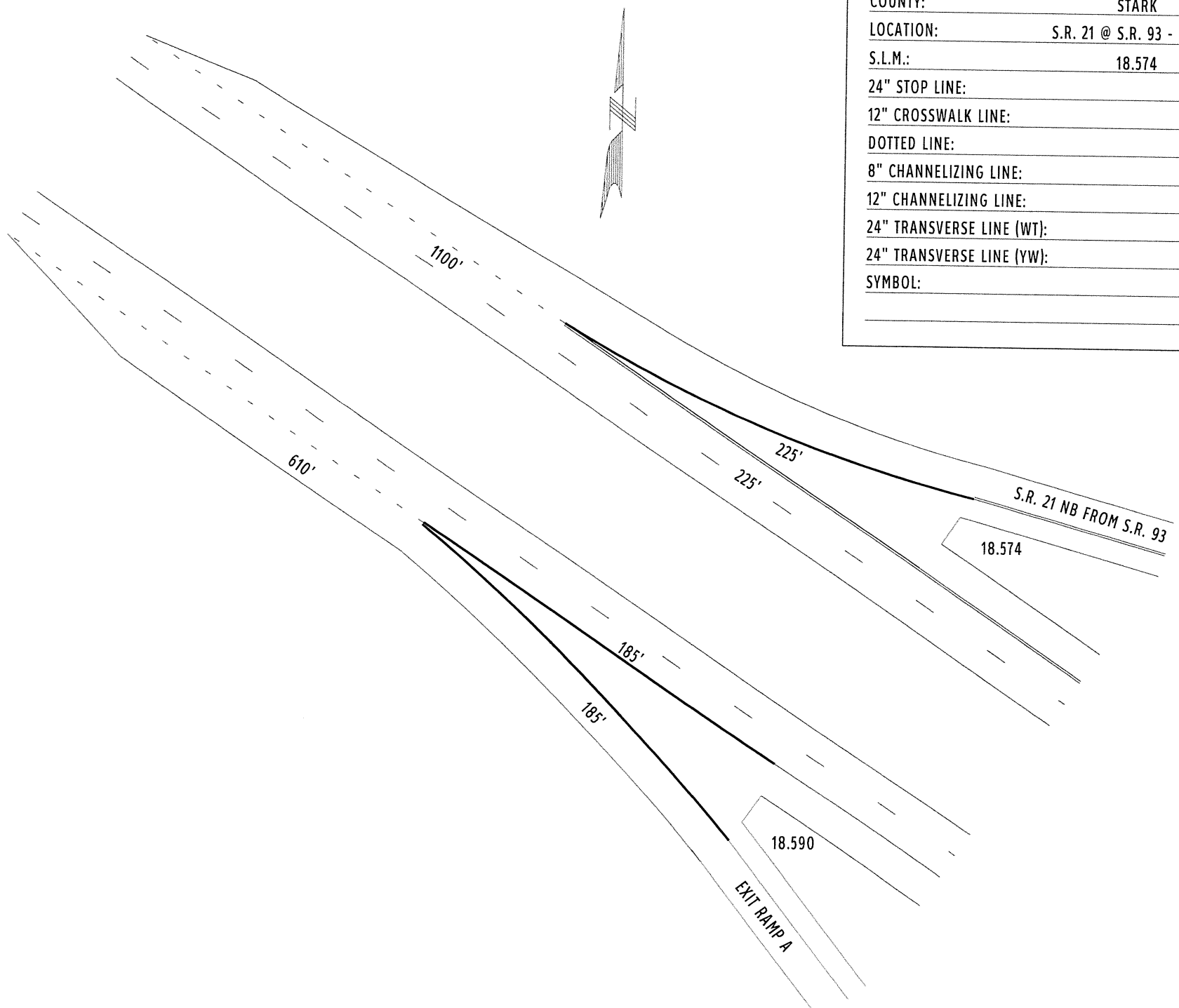

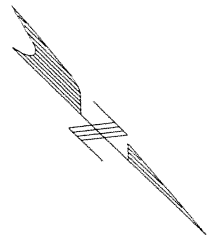

COUNTY:	STARK
LOCATION:	S.R. 21 @ MARSHALLVILLE RD. PARK N' RIDE
S.L.M.:	19.75
24" STOP LINE:	L.F.
12" CROSSWALK LINE:	L.F.
DOTTED LINE:	L.F.
8" CHANNELIZING LINE:	L.F.
12" CHANNELIZING LINE:	L.F.
24" TRANSVERSE LINE (WT):	L.F.
24" TRANSVERSE LINE (YW):	L.F.
SYMBOL: 4 - THRU ARROWS	
370 L.F. - PARKING STALL MKGS	

