

COUNTY:	STARK	
LOCATION:	S.R. 44 @ S.R. 43	
S.L.M.:	0.00	
24" STOP LINE:	14	L.F.
12" CROSSWALK LINE:		L.F.
DOTTED LINE:		L.F.
8" CHANNELIZING LINE:		L.F.
12" CHANNELIZING LINE:		L.F.
24" TRANSVERSE LINE (WT):		L.F.
24" TRANSVERSE LINE (YW):		L.F.
SYMBOL:		

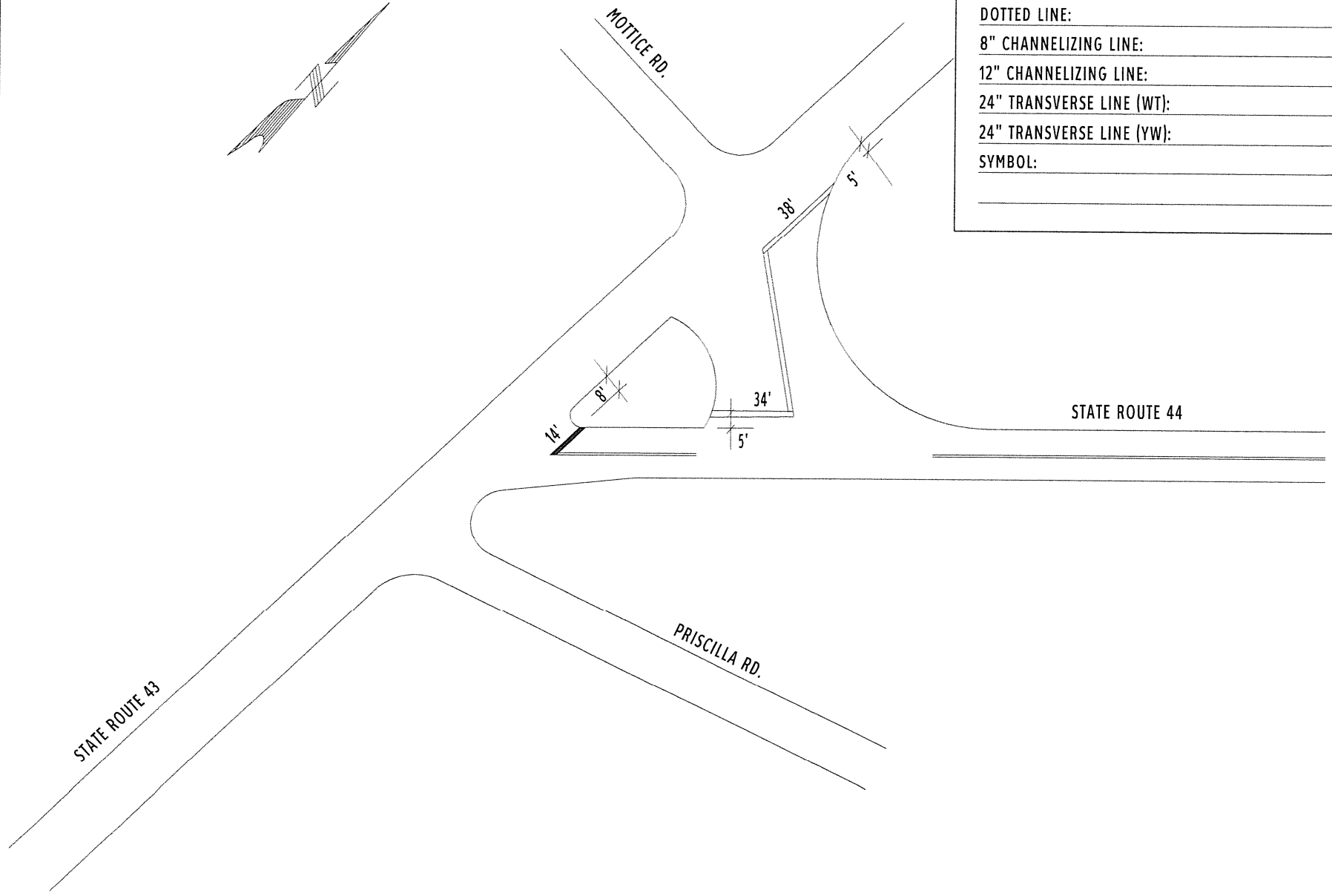

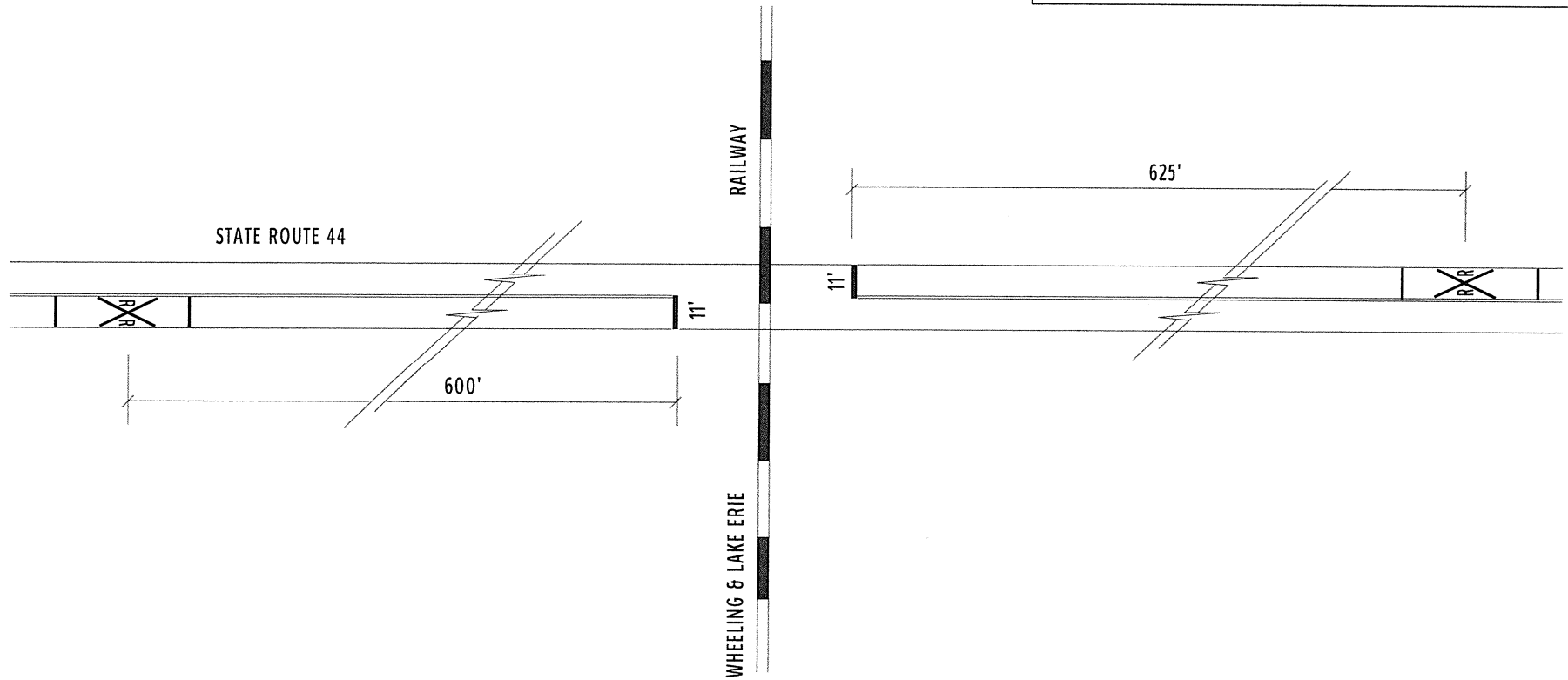

COUNTY:	STARK	
LOCATION:	S.R. 44 @ WHEELING & LAKE ERIE RAILWAY	
S.L.M.:	7.513	
24" STOP LINE:	22	L.F.
12" CROSSWALK LINE:		L.F.
DOTTED LINE:		L.F.
8" CHANNELIZING LINE:		L.F.
12" CHANNELIZING LINE:		L.F.
24" TRANSVERSE LINE (WT):		L.F.
24" TRANSVERSE LINE (YW):		L.F.
SYMBOL: 2 - RXR SYMBOLS		





COUNTY:	STARK	
LOCATION:	S.R. 44 @ U.S. ROUTE 30	
S.L.M.:	7.796	
24" STOP LINE:	14	L.F.
12" CROSSWALK LINE:		L.F.
DOTTED LINE:		L.F.
8" CHANNELIZING LINE:		L.F.
12" CHANNELIZING LINE:		L.F.
24" TRANSVERSE LINE (WT):		L.F.
24" TRANSVERSE LINE (YW):		L.F.
SYMBOL:		

