

PROJECT DESCRIPTION

MILLING AND ASPHALT RESURFACING,
FULL AND PARTIAL DEPTH REPAIRS,
PROJECT LENGTH OF 4.16 MILES

PROJECT EDA - N/A (MAINTENANCE PROJECT)
EST. CONTRACTOR EDA - N/A (MAINTENANCE PROJECT)
NOTICE OF INTENT EDA - N/A (MAINTENANCE PROJECT)

2002 SPECIFICATIONS

THE STANDARD SPECIFICATIONS OF THE STATE
OF OHIO, DEPARTMENT OF TRANSPORTATION,
INCLUDING CHANGES AND SUPPLEMENTAL SPECI-
FICATIONS LISTED IN THE PROPOSAL SHALL
GOVERN THIS IMPROVEMENT.

I HEREBY APPROVE THESE PLANS AND DECLARE
THAT THE MAKING OF THIS IMPROVEMENT WILL
NOT REQUIRE THE CLOSING TO TRAFFIC OF THE
HIGHWAY AND THAT PROVISIONS FOR THE
MAINTENANCE AND SAFETY OF TRAFFIC WILL BE
AS SET FORTH ON THE PLANS AND ESTIMATES

APPROVED *[Signature]*
DATE 6-12-03 DISTRICT DEPUTY DIRECTOR

APPROVED *[Signature]*
DATE 6-25-03 DIRECTOR, DEPARTMENT OF
TRANSPORTATION

STATE OF OHIO
DEPARTMENT OF TRANSPORTATION
SUM-59-5.38

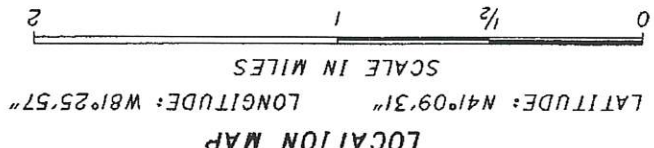
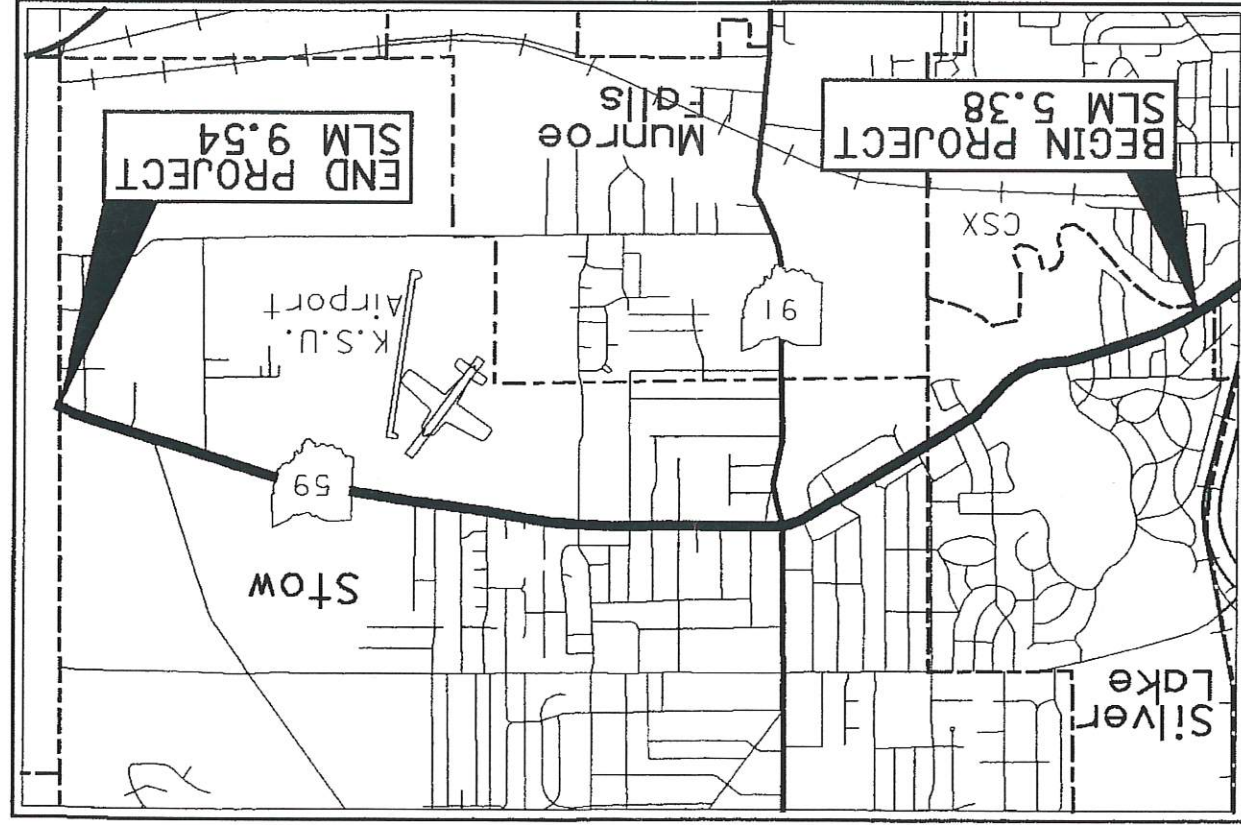

PORTION TO BE IMPROVED
INTERSTATE & DIVIDED HIGHWAY
UNDIVIDED STATE & FEDERAL ROUTES
OTHER ROADS

STANDARD CONSTRUCTION DRAWINGS

SUPPLEMENTAL SPECIFICATIONS	BP-3.1	07-28-00	TC-42.20	04-20-01	MT-95.31	04-19-02	832	02-12-03
	TC-41.20	01-19-01	MT-35.10	04-20-01			833	02-12-03
	TC-52.10	04-20-01	MT-95.32	04-19-02			908	04-18-03
	TC-52.20	02-20-01	MT-95.60	04-19-02				
	TC-71.10	04-19-02	MT-99.20M	01-30-95				
	TC-73.10	01-19-01	MT-105.10	10-18-02				
	TC-82.10	04-19-02	MT-105.11	10-18-02				
	DM-4.3	07-19-02						
	DM-4.4	07-19-02						
SPECIAL PROVISIONS								

ENGINEERS SEAL:

SIGNED: *[Signature]*
DATE: 06/12/03

UNDERGROUND UTILITIES
TWO WORKING DAYS
BEFORE YOU DIG (TOLL FREE)
CALL 1-800-362-2764 (TOLL FREE)
OHIO UTILITIES PROTECTION SERVICE
NON-MEMBERS
MUST BE CALLED DIRECTLY

PLAN PREPARED BY:

INDEX OF SHEETS:

1	TITLE SHEET
2	TYPICAL SECTIONS
3-5	GENERAL NOTES
6-7	MAINTENANCE OF TRAFFIC NOTES
8	GENERAL SUMMARY
9-10	ASPHALT CONCRETE SHEETS
11	PAVEMENT MARKING SUB-SUMMARY
12-18	PAVEMENT MARKING SHEETS

DESIGN EXCEPTIONS
NONE
DESIGN FUNCTIONAL CLASSIFICATION -
OTHER PRINCIPAL ARTERIAL

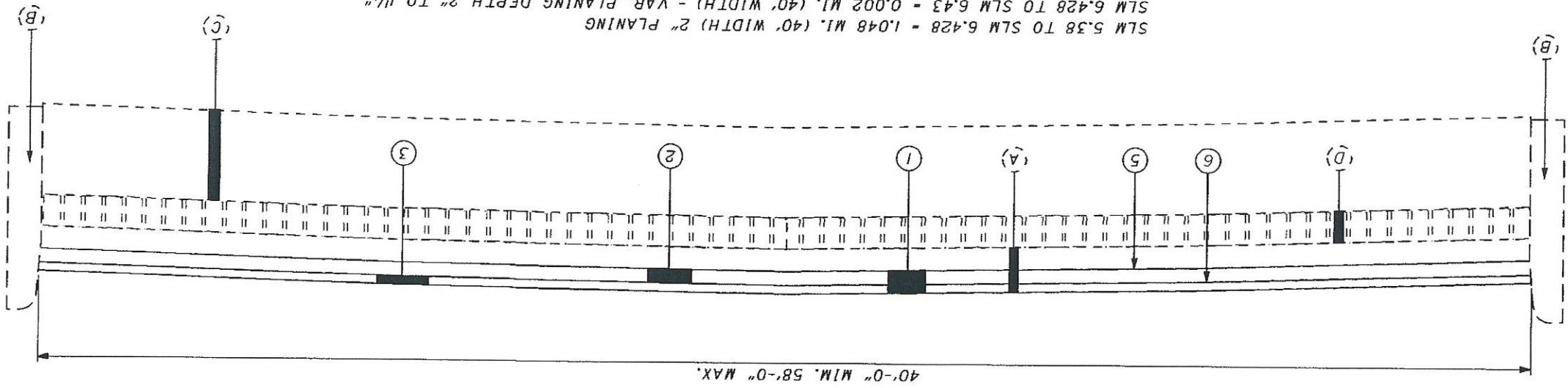

SLM 5.38 TO SLM 6.428 - 1.048 MI. (40' WIDTH) 2" PLANING
 SLM 6.428 TO SLM 6.43 - 0.002 MI. (40' WIDTH) - VAR. PLANING DEPTH 2" TO 1 1/4"
 SLM 6.43 TO SLM 6.91 - 0.48 MI. (40' WIDTH) - 1 1/4" PLANING DEPTH
 SLM 6.91 TO SLM 6.93 - 0.02 MI. (40' TO 47' WIDTH) 1 1/4" PLANING DEPTH
 SLM 6.93 TO SLM 6.932 - 0.002 MI (47' TO 48' WIDTH) VAR. PLANING DEPTH 1 1/4" TO 2"
 SLM 6.932 TO SLM 6.96 - 0.028 MI. (48' TO 58' WIDTH) 2" PLANING
 SLM 6.96 TO SLM 6.982 - 0.022 MI. (58' WIDTH) 2" PLANING
 SLM 6.982 TO SLM 7.019 - 0.037 MI. (SUSPEND WORK)
 SLM 7.019 TO SLM 7.12 - 0.101 MI. (58' WIDTH) 2" PLANING
 SLM 7.12 TO SLM 7.145 - 0.025 MI. (58' TO 48' WIDTH) 2" PLANING
 SLM 7.145 TO SLM 8.53 - 1.385 MI. (48' WIDTH) 2" PLANING
 SLM 8.53 TO SLM 8.57 - 0.04 MI. (48' TO 58' WIDTH) 2" PLANING
 SLM 8.57 TO SLM 9.025 - 0.455 MI. (58' WIDTH) 2" PLANING
 SLM 9.025 TO SLM 9.268 - 0.243 MI. (SUSPEND WORK)
 SLM 9.268 TO SLM 9.51 - 0.242 MI. (48' WIDTH) 2" PLANING
 SLM 9.51 TO SLM 9.53 - 0.02 MI. (48' TO 40' WIDTH) 2" PLANING
 SLM 9.53 TO SLM 9.54 - 0.01 MI. (40' WIDTH) 2" PLANING

TOTAL - 4.16 MI.

- ITEM 254 - PAVEMENT PLANING, ASPHALT CONCRETE, AS PER PLAN
- ITEM 448 - 1 1/4" ASPHALT CONCRETE SURFACE COURSE, TYPE I, PG 64-22
- ITEM 448 - VAR. THICKNESS ASPHALT CONCRETE SURFACE COURSE, TYPE I, PG 64-22
- ITEM 854 - 3/4" FINE GRADED POLYMER ASPHALT CONCRETE, TYPE B
- ITEM 407 - TACK COAT
- ITEM 407 - TACK COAT FOR INTERMEDIATE COURSE

LEGEND

- (A) PAVEMENT
- (B) CURB
- (C) CONCRETE BASE
- (D) BRICK

SIDE STREET AND COMMERCIAL DRIVE DETAILS

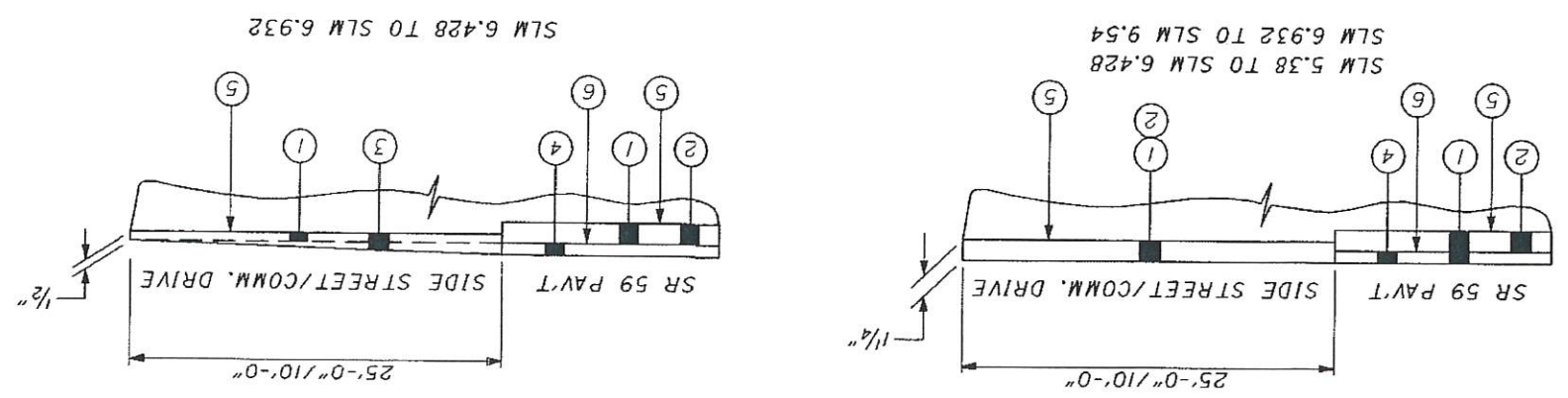

SR 59 FEATHER DETAIL

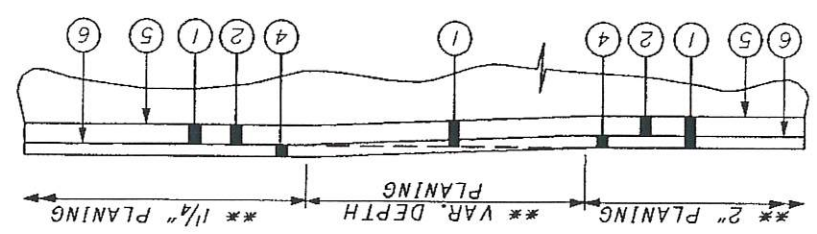

** SEE BELOW FOR LIMITS

UTILITIES
THE CONTRACTOR SHALL USE THE FOLLOWING PROCEDURE AT EACH LOCATION WHERE WORK IS PERFORMED, IN ACCORDANCE WITH SECTIONS 105.07 AND 107.16 IN THE CONSTRUCTION AND MATERIALS SPECIFICATIONS:

THE CONTRACTOR SHALL NOTIFY THE PROJECT ENGINEER, THE OHIO UTILITIES PROTECTION SERVICE (OUPS), THE OHIO & GAS PROCEDURES UNDERGROUND PROTECTION SERVICE (OGPPS), THE OHIO DEPARTMENT OF TRANSPORTATION DISTRICT 4 HEADQUARTERS AND ALL NON REGISTERED UTILITY OWNERS AT LEAST TWO (2) WORKING DAYS PRIOR TO COMMENCING CONSTRUCTION OPERATIONS IN ALL AREAS.

OUPS 1-800-362-2764 (CONTACT LIMITED BASIS PARTICIPANTS DIRECTLY)
OGPPS 1-800-925-0988
ODOT 330-297-0801 KEN GREENE EXT. 305

THE LOCATION OF THE UNDERGROUND UTILITIES ARE NOT SHOWN ON THE PLANS, BUT CAN BE OBTAINED FROM THE OWNERS OF THE UTILITIES.

LISTED BELOW ARE ALL UTILITIES LOCATED WITHIN THE PROJECT CONSTRUCTION LIMITS TOGETHER WITH THEIR RESPECTIVE OWNERS:

*Denotes Limited Basis Member - must be contacted directly

B P OIL
4421 BRADLEY ROAD
CLEVELAND, OHIO 44109
PHONE: (216) 586-2050
CONTACT: TOM COYNE

DOMINION EAST OHIO
1000 WEST WILBETH ROAD
AKRON, OHIO 44314
PHONE: (330) 798-7104
CONTACT: GEORGE TURNER

OHIO EDISON
1910 WEST MARKET STREET, BLDG 1
AKRON, OHIO 44313
PHONE: (330) 384-4714
CONTACT: NICK TOUSSANT

SBC AMERITECH
50 WEST BOWERY STREET, 4TH FLOOR
AKRON, OHIO 44308
PHONE: (330) 384-8057
CONTACT: SABRENA LAMPLEY

SUNOCO PIPELINE ENGINEERING DEPT.
* CITY OF STOW
3760 DARROW ROAD
STOW, OHIO 44224
PHONE: (330) 689-2719
CONTACT: JIM MCCLEARY

TIME WARNER CABLE
1200 BROWNSTONE AVENUE
AKRON, OHIO 44310
PHONE: (330) 490-2506
CONTACT: TOD DEAN

BANCEQUITY PETROLEUM
10512 NORTHFIELD ROAD, SUITE 5
NORTHFIELD, OHIO 44067
PHONE: (330) 468-5935
CONTACT: TOM FISCHIELTA

CONTINGENCY QUANTITIES
THE CONTRACTOR SHALL NOT ORDER MATERIALS OR PERFORM WORK FOR ITEMS DESIGNATED BY PLAN NOTE TO BE USED "AS DIRECTED BY THE ENGINEER" UNLESS AUTHORIZED BY THE ENGINEER. THE ACTUAL WORK LOCATIONS AND QUANTITIES USED FOR SUCH ITEMS SHALL BE INCORPORATED INTO THE FINAL CHANGE ORDER GOVERNING COMPLETION OF THIS PROJECT.

WORK LIMITS

THE WORK LIMITS SHOWN ON THESE PLANS ARE FOR PHYSICAL CONSTRUCTION ONLY. THE INSTALLATION AND OPERATION OF ALL TEMPORARY TRAFFIC CONTROL AND TEMPORARY TRAFFIC CONTROL DEVICES REQUIRED BY THESE PLANS SHALL BE PROVIDED BY THE CONTRACTOR WHETHER INSIDE OR OUTSIDE THESE WORK LIMITS.

PROFILE AND ALIGNMENT

THE PROPOSED PAVEMENT RESURFACING SHALL FOLLOW THE ALIGNMENT AND PROFILE OF THE EXISTING PAVEMENT. THE PROPOSED ASPHALT CONCRETE OVERLAY SHALL BE AS SHOWN ON THE TYPICAL SECTIONS.

INTERSECTIONS AND COMMERCIAL DRIVES

INTERSECTIONS SHALL BE RESURFACED A MINIMUM OF 25 FEET BEYOND THE PAVEMENT EDGE, AND COMMERCIAL DRIVES 10', WITH ITEM 448 ASPHALT CONCRETE SURFACE COURSE, TYPE I, PG 64-22 UNLESS OTHERWISE DIRECTED BY THE ENGINEER OR INDICATED IN THE PLAN. INTERSECTIONS AND COMMERCIAL DRIVES SHALL BE PAVED AFTER COMPLETION OF THE SURFACE COURSE. INTERSECTIONS AND COMMERCIAL DRIVES ADJACENT TO THE PROPOSED 2" PLANING SHALL BE PLANED A DEPTH OF 1/4" AND PAVED A THICKNESS OF 1/4". INTERSECTIONS AND COMMERCIAL DRIVES ADJACENT TO THE PROPOSED 1/4" PLANING SHALL BE PLANED TO A DEPTH OF 3/4" AND PAVED A VARIABLE THICKNESS (7/8" AVERAGE). A BUTT JOINT AT THE TERMINUS, AS THE RESULT OF THE PLANING, SHALL PROVIDE A SMOOTH TRANSITION TO THE EXISTING PAVEMENT. ANY GRADING OR PRIME NECESSARY TO ACCOMPLISH HIS WORK SHALL BE INCLUDED IN THE COST OF ITEM 448. (SEE TYPICAL SECTION SHEET NO. 2 FOR LOCATIONS AND DETAILS)

CONVERSION OF STANDARD CONSTRUCTION DRAWINGS

THE METRIC STANDARD DRAWINGS REFERENCED IN THIS PLAN SHALL BE CONVERTED TO ENGLISH UNITS USING THE SI (METRIC) TO ENGLISH CONVERSION FACTORS PROVIDED IN SECTION 109.011 OF THE 1997 CONSTRUCTION AND MATERIALS SPECIFICATIONS. THE APPENDIX OF ASTM E 380 SHALL BE UTILIZED FOR ANY ADDITIONAL CONVERSION FACTORS REQUIRED. CONVERSIONS SHALL BE APPROPRIATELY PRECISE AND SHALL REFLECT STANDARD INDUSTRY ENGLISH VALUES WHERE SUITABLE.

AIRPORT NOTIFICATION

THE CONTRACTOR SHALL NOTIFY THE KENT STATE AIRPORT MANAGER WHEN WORKING WITHIN ONE QUARTER MILE OF AIRPORT PROPERTY. PHONE: (330)672-2640

AIRWAY/HIGHWAY CLEARANCE FOR AIRPORTS AND HELIPORTS

THIS PROJECT HAS BEEN IDENTIFIED AS BEING WITHIN THE INFLUENCE AREA OF A PUBLIC USE AIRPORT OR HELIPORT. THE CONTRACTOR IS ADVISED THAT NO TEMPORARY STRUCTURES OR CONSTRUCTION EQUIPMENT AT MAXIMUM OPERATING HEIGHT SHALL EXCEED A HEIGHT OF 28 FEET. IF ANY TEMPORARY STRUCTURES OR CONSTRUCTION EQUIPMENT WILL EXCEED THIS HEIGHT, THE CONTRACTOR IS ADVISED THAT COORDINATION WITH THE FEDERAL AVIATION ADMINISTRATION (FAA) WILL BE NECESSARY PRIOR TO ERECTING SUCH TEMPORARY STRUCTURES OR OPERATING SUCH EQUIPMENT ON THE PROJECT. THE CONTRACTOR WILL BE REQUIRED TO SUBMIT FORM 7460-1 TO THE FAA. A COPY OF THE SUBMISSION AND TWO COPIES OF FORM 7460-1 SHALL BE FORWARDED TO THE ODOT OFFICE OF AVIATION THE CONTRACTOR IS ADVISED THAT NO TEMPORARY STRUCTURES OR CONSTRUCTION EQUIPMENT SHALL EXCEED THE PERMISSIBLE HEIGHT, UNTIL A COPY OF THE FAA APPROVAL AND THE ODOT OFFICE OF AVIATION PERMIT HAS BEEN FURNISHED TO THE PROJECT ENGINEER.

THE FEDERAL AVIATION ADMINISTRATION
GREAT LAKES REGIONAL OFFICE
AIR TRAFFIC DIVISION AG-530
2300 EAST DEVON AVENUE
DES PLAINES, ILLINOIS 60018
(847) 294-7566

OHIO DEPARTMENT OF TRANSPORTATION
OFFICE OF AVIATION
2829 WEST DUBLIN-GRANVILLE ROAD

ITEM 254 PAVEMENT PLANING, ASPHALT CONCRETE, AS PER PLAN

THIS ITEM OF WORK WILL INCLUDE:

PLANING TO A DEPTH OF 2", OR TO THE EXISTING BRICK BASE, WHICH DEPTH VARIES FROM 4" TO 2"± THROUGHOUT THE PROJECT.

PLANING TO A DEPTH OF 1/4" IN THE AREA OF NEW CURB TO ALLEVIATE A 7" REVEAL, AND THE VARIABLE DEPTH PLANING TO TRANSITION FROM THE 2" TO 1/4" DEPTH.

PLANING OF THE SIDE STREETS AND COMMERCIAL DRIVES AT DIFFERENT DEPTHS, IN THE ABOVE AREAS, DUE TO THE APPLICATION OF ONLY THE 448 SURFACE COURSE.

SEE TYPICAL SECTION SHEET NO. 2 FOR LIMITS AND DETAILS.

ITEM 604 - MONUMENT ASSEMBLY, AS PER PLAN

ADJUSTABLE MONUMENT ASSEMBLIES AS SHOWN ON STANDARD CONSTRUCTION DRAWING "RM-11", REVISED APRIL 18, 2003, WILL BE PLACED BY THE CONTRACTOR AT THE TIME OF CONSTRUCTION.

THE CONTRACTOR WILL BE PROVIDED A LOCATION LIST OF EXISTING MONUMENTATION WHICH IS TO BE REPLACED WITH NEW ADJUSTABLE MONUMENT BOX ASSEMBLIES AT THE PRE-CONSTRUCTION MEETING. THIS LIST MAY INCLUDE BOTH EXPOSED AND BURIED MONUMENTATION AND MAY ALSO INCLUDE SOME TIES TO AID IN RECOVERY.

THE CONTRACTOR SHALL HAVE A PROFESSIONAL SURVEYOR, LICENSED IN THE STATE OF OHIO, REFERENCE ALL DATUM POINT LOCATIONS WITH CROSS TIES PRIOR TO DISTURBING ANY EXISTING MONUMENTATION AND PRIOR TO THE INSTALLATION OF THE NEW ADJUSTABLE MONUMENT BOX ASSEMBLIES. PAYMENT FOR SAID CROSS TIES SHALL BE INCLUDED IN THE UNIT PRICE BID FOR ITEM 604, DEPENDING ON SITE CONDITIONS AND DEPTH, INSTALLATION OF THE NEW MONUMENT BOX MAY NOT REQUIRE THE REMOVAL OF THE EXISTING MONUMENT BOX, UNLESS UNAVOIDABLE, REMOVAL AND PLACEMENT OF THE NEW MONUMENT BOX SHALL NOT DISTURB THE EXISTING DATUM POINT.

SHOULD REMOVAL, IF REQUIRED, OF THE EXISTING BOX OR PLACEMENT OF THE NEW BOX DISTURB THE DATUM POINT, THE REFERENCE TIES ESTABLISHED BY THE CONTRACTOR'S SURVEYOR SHALL BE USED TO RESET THE DATUM POINT. THE ACTUAL PLACEMENT OF THE DATUM POINT WITHIN THE MONUMENT ASSEMBLY SHALL BE DIRECTLY AND PHYSICALLY SUPERVISED IN THE FIELD BY THE CONTRACTOR'S LICENSED PROFESSIONAL SURVEYOR. SURVEY NOTES VERIFYING THE ACCURACY OF ANY RESET DATUM POINTS AS WELL AS VERIFICATION THAT ANY DATUM POINTS THAT WERE NOT RESET WERE NOT DISTURBED SHALL BE SEALED BY THE SURVEYOR AND RETURNED TO THE DISTRICT 4 SURVEY OPERATIONS MANAGER. ANY REQUEST FOR NON-PERFORMANCE SHALL BE DIRECTED IN WRITING TO THE DISTRICT 4 PRODUCTION ADMINISTRATOR OR SURVEY OPERATIONS MANAGER AND MUST INCLUDE PROPER WRITTEN JUSTIFICATION.

PAYMENT FOR THE REMOVAL OF ANY EXISTING MONUMENT ASSEMBLIES SHALL ALSO BE INCLUDED IN THIS ITEM.

QUANTITY THAT WILL BE CARRIED TO THE GENERAL SUMMARY:

ITEM 604 - MONUMENT ASSEMBLY, AS PER PLAN 7 EACH - SILVER LAKE
18 EACH - CITY OF STOW

SUSPEND AND RESUME WORK

THIS PROJECT WILL BE SUSPENDED AT SLM 6.98 AND RESUMED AT SLM 7.02 TO COORDINATE WORK WITH THE CITY OF STOW ON THEIR FUTURE PAVING PROJECT, ON SR 91, IN 2005. THE ACTUAL LIMITS OF THE WORK SUSPENSION, ALONG SR 59, ARE 93.89' WEST AND 98.11' EAST OF THE INTERSECTION OF THE CENTERLINES OF SR 91 AND SR 59.

THE SUSPEND WORK AT SLM 9.025 AND RESUME WORK AT SLM 9.268 IS AT THE REQUEST OF THE CITY OF STOW DUE TO THE RECENT RECONSTRUCTION OF FISHCREEK ROAD. THE ACTUAL LIMITS OF THE WORK SUSPENSION, ALONG SR 59, ARE 844.82' WEST AND 440.49' EAST OF THE INTERSECTION OF THE CENTERLINES OF FISHCREEK ROAD AND SR 59.

ITEMS - 642 STOP LINE, TYPE 2, AS PER PLAN & 642 CROSSWALK LINE, TYPE 2, AS PER PLAN

THESE ITEMS ARE TO BE USED, AS DIRECTED BY THE ENGINEER, TO INSTALL OR REPLACE STOP BARS AND CROSSWALK LINES AT INTERSECTING ROADWAYS. THE FOLLOWING ESTIMATED QUANTITIES ARE CARRIED TO THE GENERAL SUMMARY AND ARE IN ADDITION TO QUANTITIES SHOWN IN THE PAVEMENT MARKINGS DETAIL SHEETS.

ITEM 642 STOP LINE, TYPE 2, AS PER PLAN - 96 LF - SILVER LAKE
289 LF - CITY OF STOW

ITEM 642 CROSSWALK LINE, TYPE 2, AS PER PLAN - 84 LF - SILVER LAKE
266 LF - CITY OF STOW

PAVEMENT MARKINGS, AS PER PLAN

IN LIEU OF THE REQUIREMENTS OF 642.04, THE APPLICATION RATES OF 614.I.B.3 SHALL BE USED IN PLACING PERMANENT PAVEMENT MARKINGS.

ITEM 642- PAVEMENT MARKINGS, TYPE 1, AS PER PLAN

ALL PAVEMENT MARKINGS EDGE LINE, LANE LINE AND CENTERLINE, TYPE 1, FOR THIS PROJECT SHALL BE WATERBORNE FAST DRY TRAFFIC PAINTS, CHOSEN FROM NTPEP, 60 SECOND DRY TIME. THE PAINT SHALL BE CHOSEN FROM THE APPROVED LIST.

ITEM 604 - MANHOLE ADJUSTED TO GRADE & ITEM 638 - VALVE BOX ADJUSTED TO GRADE

THE FOLLOWING ESTIMATED QUANTITIES HAVE BEEN PROVIDED AND CARRIED TO THE GENERAL SUMMARY AND SHALL BE USED AS DIRECTED BY THE ENGINEER:

604 - MANHOLE ADJUSTED TO GRADE - 28 EACH - SILVER LAKE
82 EACH - CITY OF STOW

638 - VALVE BOX ADJUSTED TO GRADE - 9 EACH - SILVER LAKE
26 EACH - CITY OF STOW

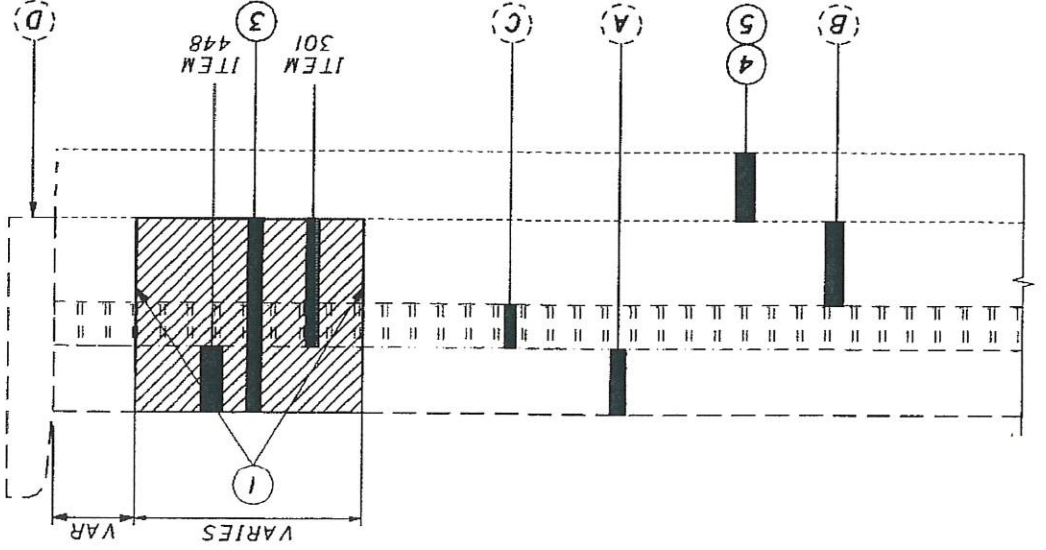

ITEM 253 PAVEMENT REPAIR
 A QUANTITY OF THIS ITEM SHALL BE PROVIDED FOR USE AS DIRECTED BY THE ENGINEER. THIS ITEM SHALL CONSIST OF REMOVING DETERIORATED PAVEMENT FULL DEPTH AND PLACING 12"± 301 ASPHALT CONCRETE BASE OF WHICH THE MAXIMUM COMPACTED DEPTH OF ANY ONE LAYER SHALL BE 6.00 INCHES AND 4"± 448 ASPHALT CONCRETE.

PAVEMENT SHALL BE BASED ON THE ACTUAL NUMBER OF CUBIC YARDS OF PAVEMENT REMOVED AND REPLACED TO THE LIMITS DESIGNATED BY THE ENGINEER. THE FOLLOWING ESTIMATED QUANTITY HAS BEEN CARRIED TO THE GENERAL SUMMARY:
 ITEM 253 PAVEMENT REPAIR - 375 CY - VILLAGE OF SILVER LAKE
 12 CY - CITY OF STOW

ITEM 203 EXCAVATION
 THIS ITEM OF WORK SHALL CONSIST OF REMOVING AND DISPOSING OF ALL UNSUITABLE MATERIAL BY EXCAVATING THE EXISTING SUBGRADE AND SUBBASE TO AN AVERAGE DEPTH OF 6 INCHES OR AS DIRECTED BY THE ENGINEER. EXACT LIMITS OF REMOVAL SHALL BE DETERMINED BY THE ENGINEER. ALL EQUIPMENT, LABOR, TOOLS, AND INCIDENTALS NECESSARY TO COMPLETE THIS ITEM SHALL BE INCLUDED IN THE UNIT PRICE BID FOR ITEM 203 EXCAVATION. THE FOLLOWING ESTIMATED QUANTITY HAS BEEN CARRIED TO THE GENERAL SUMMARY:
 ITEM 203 EXCAVATION - 140 CY - VILLAGE SILVER LAKE
 5 CY - CITY OF STOW

ITEM 304 AGGREGATE BASE
 THE FOLLOWING ESTIMATED QUANTITY HAS BEEN PROVIDED AND SHALL BE USED AS DIRECTED BY THE ENGINEER TO BACKFILL AREAS WHICH WERE EXCAVATED UNDER ITEM 203 EXCAVATION.
 ITEM 304 AGGREGATE BASE - 140 CY - VILLAGE SILVER LAKE
 5 CY - CITY OF STOW

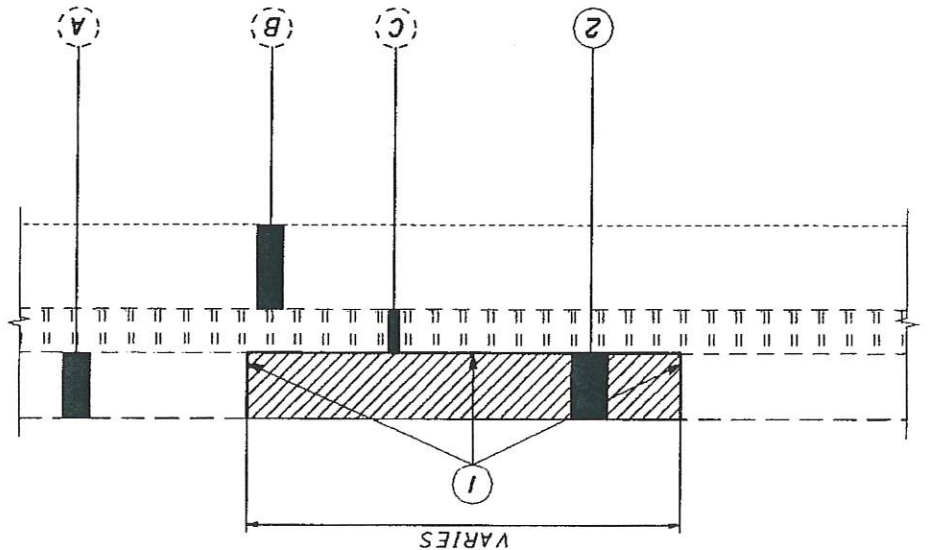

ITEM 251 PARTIAL DEPTH PAVEMENT REPAIR
 A QUANTITY OF THIS ITEM SHALL BE PROVIDED FOR USE AS DIRECTED BY THE ENGINEER. THE ITEM SHALL CONSIST OF REPAIRING EXISTING LOCATIONS EXHIBITING SURFACE DETERIORATION AND PLACING 4"± OF ITEM 448 ASPHALT CONCRETE. THE ASPHALT CONCRETE SHALL BE COMPACTED WITH A TYPE 1 PNEUMATIC TIRE ROLLER AND A STEEL WHEEL ROLLER AS PER 401.13.

PAVEMENT SHALL BE BASED ON THE ACTUAL NUMBER OF CUBIC YARDS OF PAVEMENT REPAIR. THE FOLLOWING ESTIMATED QUANTITY HAS BEEN CARRIED TO THE GENERAL SUMMARY:
 ITEM 251 PARTIAL DEPTH PAVEMENT REPAIR - 320 CY - VILLAGE SILVER LAKE
 25 CY - CITY STOW

LEGEND

407	①	TACK COAT
251	②	PARTIAL DEPTH PAVEMENT REPAIR
253	③	PAVEMENT REPAIR
203	④	EXCAVATION
304	⑤	6" AVG. AGGREGATE BASE

①	A	EXISTING ASPHALT PAVEMENT (4"± MAX. - 2"± MIN.)
②	B	EXISTING CONCRETE BASE 8"±
③	C	EXISTING BRICK
④	D	EXISTING CURB

MAINTENANCE OF TRAFFIC
THIS ITEM SHALL CONSIST OF MAINTENANCE OF TRAFFIC ON EXISTING ROADWAYS AND RAMP IN ACCORDANCE WITH THE OHIO MANUAL OF UNIFORM TRAFFIC CONTROL DEVICES FOR STREETS AND HIGHWAYS, CURRENT EDITION, LATEST REVISION, THE SPECIFICATIONS AND THE FOLLOWING:

1. A MINIMUM OF ONE TEN FOOT LANE IN EACH DIRECTION SHALL BE MAINTAINED ON THE EXISTING PAVEMENT OR COMPLETED PAVEMENT DURING CONSTRUCTION OF THE WORK.
2. THE CONTRACTOR SHALL INFORM THE DISTRICT OFFICE ((330) 297-0801 EXT 209, EIGHTEEN (18) DAYS PRIOR TO THE BEGINNING OF WORK.
3. CONES SHALL NOT BE ACCEPTABLE TRAFFIC CONTROL DEVICES FOR LANE RESTRICTIONS OR LANE REDUCTIONS THAT ARE IN OPERATION ONE-HALF HOUR AFTER SUNSET OR ONE HALF-HOUR BEFORE SUNRISE. ALL NIGHTTIME LANE RESTRICTIONS SHALL REQUIRE DRUMS OR BARRICADES AT A MAXIMUM SPACING OF FIFTY (50) FEET. WEIGHTED CHANNELIZERS MAY BE USED IN ACCORDANCE WITH THE ADDITIONAL NOTE HEREIN.
4. LANE RESTRICTIONS OR LANE REDUCTIONS SHALL NOT BE PERMITTED AFTER NORMAL WORKING HOURS. NORMAL WORKING HOURS SHALL BE THOSE HOURS DURING WHICH THE CONTRACTOR HAS A FULL COMPLIMENT OF EMPLOYEES AND EQUIPMENT ACTIVELY REMOVING AND/OR PLACING PAVEMENT MATERIALS.
5. THE CONTRACTOR SHALL FURNISH, ERECT, MAINTAIN AND SUPPORTS AND FURNISH AND MAINTAIN ALL FLAGGERS, WATCHERS AND INCIDENTALS RELATED THERETO.
6. ALL FULL DEPTH PAVEMENT REMOVAL AND REPLACEMENT OPERATIONS SHALL BE COMPLETED THE SAME DAY THE EXCAVATION IS MADE. IF THE CONTRACTOR CANNOT COMPLETE THE WORK, THE EXCAVATION SHALL BE BACKFILLED.
7. UNDER NO CIRCUMSTANCES SHALL THE CONTRACTOR BE PERMITTED TO HAVE SUCCESSIVE WORK ZONES UNLESS THE DISTANCE BETWEEN THE DRUMS, BARRICADES OR CONES EXCEEDS TWO (2) MILES RURAL OR ONE (1) MILE URBAN.
8. NO WORK SHALL BE PERFORMED BETWEEN 10PM AND 6AM DAILY.
9. IN ADDITION TO THE REQUIREMENTS OF 614 WORK ZONE PAVEMENT MARKINGS (614.11), AT THE END OF EACH DAY OF WORK, THE CONTRACTOR SHALL REPLACE (WITH TEMPORARY MARKINGS) ALL LANE, CENTER, STOP OR CHANNELIZING LINES THAT WERE REMOVED OR COVERED DURING THE PAVEMENT REMOVAL OR PLACEMENT OPERATIONS. QUANTITIES FOR SUCH REPLACEMENT ARE CARRIED AS PART OF THE ITEMS LISTED UNDER 614 WORK ZONE PAVEMENT MARKINGS.
10. A QUANTITY OF 15 CU. YDS. OF 614 ASPHALT CONCRETE FOR MAINTAINING TRAFFIC (STOW) AND 5 CU. YDS. OF 614 ASPHALT CONCRETE FOR MAINTAINING TRAFFIC (SILVER LAKE) SHALL BE PROVIDED FOR USE IN MAINTAINING PAVEMENT, SHOULDERS AND OTHER LOCATIONS PRIOR TO RESURFACING, AS DIRECTED BY THE ENGINEER.
11. PRIOR TO OPENING TO TRAFFIC, EACH LANE SHALL BE IN A SAFE, PASSABLE CONDITION. ALL TRANSVERSE JOINTS SHALL EXTEND ACROSS THE FULL LANE AND SHOULDERS WITH EACH LANE SHALL BE FREE FROM UNEVEN LONGITUDINAL JOINTS. THE CONTRACTOR SHALL PROVIDE ASPHALT WEDGES FOR TRANSVERSE JOINTS WHEREVER THERE ARE PAVEMENT ELEVATION DIFFERENCES.
12. A QUANTITY OF ITEM 614 WORK ZONE MARKING SIGN HAS BEEN INCLUDED IN THE PLAN. THIS QUANTITY SHALL INCLUDE, BUT NOT BE LIMITED TO, THE FOLLOWING SIGNS: OW-62 (BUMP), OW-71 (TWO-WAY TRAFFIC), OW-167 (NO EDGE LINES), OW-171 (UNEVEN LANES SYMBOL). THESE QUANTITIES SHALL BE AS PER 614.04.

THE FOLLOWING QUANTITIES SHALL BE USED FOR THE MAINTENANCE OF TRAFFIC ON THIS PROJECT:

- ITEM 614 WORK ZONE CENTER LINE, CLASS 1 10.44 MILE
- ITEM 614 WORK ZONE LANE LINE, CLASS 1 17.01 MILE
- ITEM 614 WORK ZONE STOP LINE, CLASS 1 1836 FT.
- ITEM 614 WORK ZONE CHANNELIZING LINE, CLASS 1 3765 FT.
- ITEM 614 WORK ZONE MARKING SIGN 14 EACH

SILVER LAKE
ITEM 614 WORK ZONE CENTER LINE, CLASS 1 3.36 MILE
ITEM 614 WORK ZONE LANE LINE, CLASS 1 7.26 MILE
ITEM 614 WORK ZONE STOP LINE, CLASS 1 225 FT.
ITEM 614 WORK ZONE MARKING SIGN 6 EACH

WINTER TRAFFIC LIMITATIONS
ALL EXISTING LANES SHALL BE OPEN TO TRAFFIC BETWEEN NOVEMBER 15 AND APRIL 1. NOVEMBER 14 SHALL BE CONSIDERED TO CONSTITUTE AN INTERIM COMPLETION DATE AND LIQUIDATED DAMAGES AS SPECIFIED IN 108.07 SHALL BE ASSESSED FOR EACH CALENDAR DAY THAT THE ROADWAY REMAINS CLOSED TO TRAFFIC BEYOND THE SPECIFIED LIMIT. THE CONTRACTOR MAY CLOSE LANES PRIOR TO APRIL 1 WITH WRITTEN APPROVAL FROM THE DISTRICT CONSTRUCTION ENGINEER.

WEIGHTED CHANNELIZERS
THE WEIGHTED CHANNELIZER SHALL BE PREDOMINATELY ORANGE IN COLOR AND SHALL BE MADE OF A LIGHTWEIGHT, FLEXIBLE, AND DEFORMABLE MATERIAL. THEY SHALL BE AT LEAST 42 INCHES IN HEIGHT WITH A WEIGHTED BASE. THEY MAY HAVE A "HANDLE" OR LIFTING DEVICE WHICH EXTENDS ABOVE THE 42" MINIMUM HEIGHT.

THE MARKINGS ON THE WEIGHTED CHANNELIZER SHALL BE HORIZONTAL, CIRCUMFERENTIAL, ALTERNATING ORANGE AND WHITE RETROREFLECTIVE STRIPES 6 INCHES WIDE. EACH WEIGHTED CHANNELIZER SHALL HAVE A MINIMUM OF TWO ORANGE AND TWO WHITE STRIPES. ANY NON-RETROREFLECTIVE SPACES BETWEEN THE HORIZONTAL ORANGE AND WHITE STRIPES SHALL NOT EXCEED 2 INCHES WIDE. THE WEIGHTED CHANNELIZER SHALL HAVE A 4-INCH MINIMUM WIDTH, REGARDLESS OF ORIENTATION. ON FREEWAYS AND MULTILANE HIGHWAYS:

USE OF WEIGHTED CHANNELIZERS ON FREEWAYS AND MULTILANE HIGHWAYS SHALL BE LIMITED TO SHORT-TERM OPERATION, GENERALLY TWELVE HOURS OR LESS, FOR EITHER DAY OR NIGHT. UPON COMPLETION OF WORK WITHIN THE ABOVE NOTED TIME PERIOD, THE WEIGHTED CHANNELIZERS SHALL BE REMOVED. THE WEIGHTED CHANNELIZERS MAY AGAIN BE PLACED ON THE HIGHWAY WHEN THE WORK IS TO RESUME ON THE FOLLOWING DAY OR NIGHT. ANY LANE CLOSURE USING CHANNELIZATION DEVICES, EXPECTED TO REMAIN FOR MORE THAN TWELVE HOURS, SHALL REQUIRE THE USE OF DRUMS OR BARRIERS.

WHEN USED AT NIGHT, WEIGHTED CHANNELIZERS SHALL ONLY BE PLACED IN THE "TANGENT AREA". THE "TANGENT AREA" IS DEFINED AS THE AREA AFTER THE TRANSITION TAPER WHERE THE WORK TAKES PLACE. DRUMS SHALL BE USED IN THE TRANSITION TAPERS FOR NIGHT OPERATIONS.

ON OTHER HIGHWAYS:

THERE ARE NO DURATIONS OF WORK RESTRICTIONS FOR USE OF WEIGHTED CHANNELIZERS ON ALL OTHER TYPES OF HIGHWAYS. DAY OR NIGHT, ON THESE ROADWAYS THE WEIGHTED CHANNELIZER MAY BE USED IN THE TRANSITION TAPERS AS WELL AS IN THE TANGENT AREAS, DAY OR NIGHT.

MAXIMUM SPACING OF THE WEIGHTED CHANNELIZER SHALL BE 40 FEET.

STEPS SHOULD BE TAKEN TO ENSURE THAT THE WEIGHTED CHANNELIZERS WILL NOT BE BLOWN OVER OR DISPLACED BY WIND OR MOVING TRAFFIC. BALLASTS SHOULD NOT PRESENT A HAZARD IF THE WEIGHTED CHANNELIZERS ARE INADVERTENTLY STRUCK. CHANNELIZERS, ALL BALLASTS USED SHOULD BE IN ACCORDANCE WITH THE MANUFACTURER'S SPECIFICATIONS.

ADVANCE NOTICE TO PAVE
THE CONTRACTOR SHALL SUBMIT FOR APPROVAL TO THE DISTRICT CONSTRUCTION ENGINEER A DETAILED SCHEDULE 15 DAYS PRIOR TO THE PLACEMENT OF THE OVERLAY COURSES, ON HOW THEY PROPOSE TO PROSECUTE THE PAVING OPERATIONS. THE DETAILS SHALL SHOW THE ORDER OF PERFORMANCE OF EACH STAGE (START TO FINISH) OF THE WORK INCLUDING THE MAINTENANCE OF TRAFFIC THAT WILL BE USED.

CONTRACTOR'S EQUIPMENT - OPERATION AND STORAGE
A QUALIFIED FLAGGER SHALL BE EMPLOYED WHERE THE CONTRACTOR'S EQUIPMENT MUST MERGE WITH THE TRAFFIC STREAM. THE CONTRACTOR'S EQUIPMENT SHALL BE EQUIPPED WITH AT LEAST ONE AMBER FLASHING LIGHT. PLOWERS, ROLLERS AND OTHER EQUIPMENT MAY BE PARKED IN AREAS ALONG THE HIGHWAY WHEN PAVING OPERATIONS ARE SCHEDULED TO CONTINUE WITHIN THE NEXT WORKDAY. OTHERWISE, THE EQUIPMENT SHALL BE STORED AT A STORAGE AREA OUTSIDE THE R/W, THE LOCATION OF WHICH SHALL HAVE PRIOR APPROVAL OF THE ENGINEER. WHEN PARKING ALONG THE HIGHWAY, THE EQUIPMENT SHALL BE PLACED AND DELINEATED AS PER 614.03. NO EQUIPMENT SHALL BE PARKED IN THE MIDDLE OF THE HIGHWAY. ADEQUATE BARRICADES AND LIGHTS SHALL BE PLACED ON THE PAVEMENT SIDE OF THE EQUIPMENT TO IDENTIFY THE LIMITS OF THE EQUIPMENT. ALL OTHER EQUIPMENT, INCLUDING PRIVATE VEHICLES, SHALL BE STORED AT THE APPROVED CONTRACTOR'S STORAGE AREA. NO EQUIPMENT SHALL BE PARKED ON PRIVATE PROPERTY UNLESS PRIOR APPROVAL OF THE OWNER AND THE PROJECT ENGINEER/SUPERVISOR HAS BEEN GRANTED.

TRAFFIC CONTROL INSPECTOR
THE CONTRACTOR SHALL DESIGNATE AN INDIVIDUAL OTHER THAN THE SUPERINTENDENT AND SUBJECT TO THE APPROVAL OF THE ENGINEER, TO CONTINUOUSLY INSPECT ALL TRAFFIC CONTROL DEVICES WHENEVER CONSTRUCTION WORK IS BEING PERFORMED WITHIN THE WORK LIMITS OF THE PROJECT. THE DESIGNATED INDIVIDUAL SHALL ALSO INSPECT ALL TRAFFIC DEVICES AT THE BEGINNING AND AT THE END OF EACH WORK DAY. THE DESIGNATED INDIVIDUAL OR A QUALIFIED REPRESENTATIVE SHALL ALSO BE AVAILABLE ON AN AROUND THE CLOCK BASIS TO REPAIR AND/OR REPLACE DAMAGED OR MISSING TRAFFIC CONTROL DEVICES. THESE INDIVIDUALS SHALL BE EQUIPPED WITH CELLULAR PHONES AND THEIR NAMES AND PHONE NUMBERS SHALL BE GIVEN TO THE PROJECT ENGINEER AT THE PRE-CONSTRUCTION MEETING.

USE OF WEIGHTED CHANNELIZERS ON FREEWAYS AND MULTILANE HIGHWAYS SHALL BE LIMITED TO SHORT-TERM OPERATION, GENERALLY TWELVE HOURS OR LESS, FOR EITHER DAY OR NIGHT. UPON COMPLETION OF WORK WITHIN THE ABOVE NOTED TIME PERIOD, THE WEIGHTED CHANNELIZERS SHALL BE REMOVED. THE WEIGHTED CHANNELIZERS MAY AGAIN BE PLACED ON THE HIGHWAY WHEN THE WORK IS TO RESUME ON THE FOLLOWING DAY OR NIGHT. ANY LANE CLOSURE USING CHANNELIZATION DEVICES, EXPECTED TO REMAIN FOR MORE THAN TWELVE HOURS, SHALL REQUIRE THE USE OF DRUMS OR BARRIERS.

WHEN USED AT NIGHT, WEIGHTED CHANNELIZERS SHALL ONLY BE PLACED IN THE "TANGENT AREA". THE "TANGENT AREA" IS DEFINED AS THE AREA AFTER THE TRANSITION TAPER WHERE THE WORK TAKES PLACE. DRUMS SHALL BE USED IN THE TRANSITION TAPERS FOR NIGHT OPERATIONS.

NO WORK SHALL BE PERFORMED AND ALL EXISTING LANES SHALL BE OPEN TO TRAFFIC DURING THE FOLLOWING DESIGNATED HOLIDAYS OR EVENTS:

CHRISTMAS	NEW YEARS
MEMORIAL DAY	FOURTH OF JULY
LABOR DAY	THANKSGIVING

THE PERIOD OF TIME THAT THE LANES ARE TO BE OPEN DEPENDS ON THE DAY OF THE WEEK ON WHICH THE HOLIDAY OR EVENT FALLS. THE FOLLOWING SCHEDULE SHALL BE USED TO DETERMINE THIS PERIOD:

DAY OF THE WEEK

TIME ALL LANES MUST BE OPEN TO TRAFFIC

SUNDAY	12:00N FRIDAY THROUGH 12:00N MONDAY
MONDAY	12:00N FRIDAY THROUGH 12:00N TUESDAY
TUESDAY	12:00N MONDAY THROUGH 12:00N WEDNESDAY
WEDNESDAY	12:00N TUESDAY THROUGH 12:00N THURSDAY
THURSDAY	12:00N WEDNESDAY THROUGH 12:00N MONDAY
FRIDAY	12:00N THURSDAY THROUGH 12:00N MONDAY
SATURDAY	12:00N FRIDAY THROUGH 12:00N MONDAY

NO EXTENSIONS OF TIME SHALL BE GRANTED FOR DELAYS IN MATERIAL DELIVERIES, UNLESS SUCH DELAYS ARE INDUSTRY-WIDE, OR FOR LABOR STRIKES, UNLESS SUCH STRIKES ARE AREA-WIDE. SHOULD THE CONTRACTOR FAIL TO MEET ANY OF THESE REQUIREMENTS, THE CONTRACTOR SHALL BE ASSESSED LIQUIDATED DAMAGES IN ACCORDANCE WITH 108.07.

LOOP DETECTOR REPLACEMENT

THE CONTRACTOR SHALL CONTACT THE DISTRICT OFFICE (330-297-0801 EXT 386) THREE WORKING DAYS PRIOR TO ANY PLANNING OR TRENCHING AT THE INTERSECTIONS LISTED BELOW. LOOP DETECTORS DISTURBED BY PAVEMENT PLANING OR TRENCHING SHALL BE ABANDONED IN PLACE. THE LOOP DETECTOR WIRE WILL BE CUT INTO THE PAVEMENT AFTER THE PROPOSED SURFACE COURSE HAS BEEN PLACED. EACH DETECTOR SHALL BE REPLACED IN KIND, AT THE SAME LOCATION AS EXISTING. THE QUANTITIES LISTED BELOW HAVE BEEN CARRIED TO THE GENERAL SUMMARY. THE NEW LOOP DETECTOR WIRES SHALL BE RUN INTO THE EXISTING CONTROL BOX OR THE EXISTING PULLBOX. INCLUDED IN THIS ITEM IS THE POURED EPOXY TYPE CABLE SPLICE KIT CONFORMING TO 225.15 THAT MUST BE USED IN MAKING THESE CONNECTIONS.

ALL NECESSARY MATERIAL, LABOR, SPLICE KITS AND EQUIPMENT SHALL BE INCIDENTAL TO PAYMENT OF THESE ITEMS.

ITEM 632 DETECTOR LOOP 56 EACH (STOW), 3 EACH (SILVER LAKE)

SILVER LAKE BLVD. - 1 EACH, 6' x 30'; 1 EACH, 6' x 20'; 1 EACH, 6' x 8'

SYCAMORE DR. - 1 EACH, 6' x 30'; 1 EACH, 8' x 21'; 4 EACH, 6' x 8'

SR-91 (DARROW RD.) - 4 EACH, 6' x 8'

ORCHARD/SCHOOL DR. - 1 EACH, 8' x 20'; 1 EACH, 6' x 20'; 1 EACH, 6' x 12'; 4 EACH, 6' x 8'

HIWOOD AVE. - 2 EACH, 8' x 20'; 4 EACH, 6' x 8'

CHARMING CROSS DR. - 2 EACH, 8' x 20'; 4 EACH, 6' x 8'

STOW-GLEN ENTRANCE DRIVE - 6 EACH, 6' x 30'; 4 EACH, 6' x 8'

K-MART ENTRANCE/EXIT - 2 EACH, 8' x 20'; 2 EACH, 6' x 30'; 1 EACH, 6' x 17'; 4 EACH, 6' x 8'

MARSH RD. - 2 EACH, 6' x 30'; 2 EACH, 6' x 20'; 4 EACH, 6' x 8'

PAVEMENT REPAIRS

ALL EXISTING PAVEMENT REPAIRS SHALL BE COMPLETED PRIOR TO NOVEMBER 14. NOVEMBER 14 SHALL BE CONSIDERED TO CONSTITUTE AN INTERIM COMPLETION DATE AND LIQUIDATED DAMAGES AS SPECIFIED IN 108.07 SHALL BE ASSESSED FOR EACH CALENDAR DAY BEYOND NOVEMBER 14.

A CONTINGENCY QUANTITY HAS BEEN PROVIDED FOR ADDITIONAL PAVEMENT REPAIRS REQUIRED IN THE SPRING. THIS WORK SHALL BE PERFORMED AFTER THE PAVEMENT PLANING. THE DETAILS SHOWN IN THE GENERAL NOTES SHALL APPLY EXCEPT THAT THE REPAIR SHALL EXTEND FROM THE PLANNED SURFACE AND THE DIMENSIONS SHOWN SHALL BE REDUCED BY THE THICKNESS OF THE PLANING.

ITEM 251 PARTIAL DEPTH REPAIR - 32 CY - SILVER LAKE 3 CY - CITY OF STOW

ITEM 253 PAVEMENT REPAIR - 40 CY - SILVER LAKE 2 CY - CITY OF STOW

ITEM 252 FULL DEPTH PAVEMENT SAWING - 315 CY - SILVER LAKE 10 CY - CITY OF STOW

ITEM 230 EXCAVATION - 14 CY - SILVER LAKE 1 CY - CITY OF STOW

ITEM 304 AGGREGATE BASE - 14 CY - SILVER LAKE 1 CY - CITY OF STOW

ITEM 614 PORTABLE CHANGEABLE MESSAGE SIGN, AS PER PLAN

THE CONTRACTOR SHALL FURNISH, INSTALL, MAINTAIN AND REMOVE, WHEN NO LONGER NEEDED, 2 PORTABLE CHANGEABLE MESSAGE SIGNS (PCMS), ON SITE, FOR THE DURATION OF TIME TO FURNISH, INSTALL, MAINTAIN AND REMOVE A PCMS UNIT ON THIS PROJECT SHALL NOT IN ANY WAY RELIEVE THE CONTRACTOR OF HIS RESPONSIBILITIES AS OUTLINED IN 614.02.

PAYMENT FOR THE ABOVE DESCRIBED ITEM SHALL BE AT THE CONTRACT UNIT PRICE BID FOR EACH SIGN MONTH OF ITEM 614 PORTABLE CHANGEABLE MESSAGE SIGN, AS PER PLAN AND SHALL INCLUDE ALL LABOR, MATERIALS, EQUIPMENT, FUELS, LUBRICATING OILS, SOFTWARE, HARDWARE AND INCIDENTALS TO PERFORM THE ABOVE DESCRIBED WORK.

ITEM 614 PORTABLE CHANGEABLE MESSAGE SIGN, AS PER PLAN 4 SIGN MONTH (STOW) 2 SIGN MONTH (SILVER LAKE)

ITEM 614 - LAW ENFORCEMENT OFFICER (WITH PATROL CAR) IN ADDITION TO THE REQUIREMENTS OF 614 AND THE LATEST EDITION OF THE OHIO MANUAL OF UNIFORM TRAFFIC CONTROL DEVICES (OMUCD), A UNIFORMED LAW ENFORCEMENT OFFICER (AND OFFICIAL PATROL CAR WITH WORKING TOP MOUNTED EMERGENCY FLASHING LIGHTS) SHALL BE PROVIDED FOR CONTROLLING TRAFFIC FOR THE FOLLOWING TASKS:

FOR LANE CLOSURES: DURING INITIAL SET-UP PERIODS, TEARDOWN PERIODS, SUBSTANTIAL SHIFTS OF A CLOSURE POINT, OR WHEN NEW LANE CLOSURE ARRANGEMENTS ARE INITIATED. LAW ENFORCEMENT OFFICERS (LEOS) SHOULD NOT BE USED WHERE THE OMUCD INTENDS THAT FLAGGERS BE USED. THE LEOS ARE CONSIDERED TO BE EMPLOYED BY THE CONTRACTOR AND THE CONTRACTOR SHALL BE RESPONSIBLE FOR THEIR ACTIONS. ALTHOUGH THEY ARE EMPLOYED BY THE CONTRACTOR, THE PROJECT ENGINEER SHALL HAVE CONTROL OVER THEIR PLACEMENT. THE OFFICIAL CAR SHALL BE A PUBLIC SAFETY VEHICLE AS REQUIRED BY THE OHIO REVISIED CODE.

THE CONTRACTOR SHALL MAKE ARRANGEMENTS FOR THESE SERVICES WITH:

CANTON PATROL POST 4710 SHUFFEL ROAD 44720 330-433-6200

ITEM 614 - LAW ENFORCEMENT OFFICER WITH PATROL CAR 240 HOURS (SILVER LAKE) 480 HOURS (STOW)

THE HOURS PAID SHALL INCLUDE MINIMUM SHOW-UP TIME REQUIRED BY THE LAW ENFORCEMENT AGENCY INVOLVED.

TRENCHING

IF THE CONTRACTOR WISHES TO UTILIZE LEOS FOR FLAGGING AND TRAFFIC CONTROL OTHER THAN THAT REQUIRED IN THESE PLANS, HE MAY DO SO AT HIS OWN EXPENSE. PAYMENT FOR THE EXCESS ABOVE CONTRACT REQUIREMENTS WILL BE INCLUDED UNDER ITEM 614 MAINTAINING TRAFFIC.

ITEM 614 - LAW ENFORCEMENT OFFICER (WITH PATROL CAR)

THE CONTRACTOR SHALL BE RESPONSIBLE FOR 24 HOURS PER DAY OPERATION AND MAINTENANCE OF THESE SIGNS ON THE PROJECT FOR THE DURATION OF THE PHASES. THE REQUIREMENT TO FURNISH, INSTALL, MAINTAIN AND REMOVE A PCMS UNIT ON THIS PROJECT SHALL NOT IN ANY WAY RELIEVE THE CONTRACTOR OF HIS RESPONSIBILITIES AS OUTLINED IN 614.02.

PAYMENT FOR THE ABOVE DESCRIBED ITEM SHALL BE AT THE CONTRACT UNIT PRICE BID FOR EACH SIGN MONTH OF ITEM 614 PORTABLE CHANGEABLE MESSAGE SIGN, AS PER PLAN AND SHALL INCLUDE ALL LABOR, MATERIALS, EQUIPMENT, FUELS, LUBRICATING OILS, SOFTWARE, HARDWARE AND INCIDENTALS TO PERFORM THE ABOVE DESCRIBED WORK.

ITEM 614 PORTABLE CHANGEABLE MESSAGE SIGN, AS PER PLAN 4 SIGN MONTH (STOW) 2 SIGN MONTH (SILVER LAKE)

ITEM 614 - LAW ENFORCEMENT OFFICER (WITH PATROL CAR) IN ADDITION TO THE REQUIREMENTS OF 614 AND THE LATEST EDITION OF THE OHIO MANUAL OF UNIFORM TRAFFIC CONTROL DEVICES (OMUCD), A UNIFORMED LAW ENFORCEMENT OFFICER (AND OFFICIAL PATROL CAR WITH WORKING TOP MOUNTED EMERGENCY FLASHING LIGHTS) SHALL BE PROVIDED FOR CONTROLLING TRAFFIC FOR THE FOLLOWING TASKS:

FOR LANE CLOSURES: DURING INITIAL SET-UP PERIODS, TEARDOWN PERIODS, SUBSTANTIAL SHIFTS OF A CLOSURE POINT, OR WHEN NEW LANE CLOSURE ARRANGEMENTS ARE INITIATED. LAW ENFORCEMENT OFFICERS (LEOS) SHOULD NOT BE USED WHERE THE OMUCD INTENDS THAT FLAGGERS BE USED. THE LEOS ARE CONSIDERED TO BE EMPLOYED BY THE CONTRACTOR AND THE CONTRACTOR SHALL BE RESPONSIBLE FOR THEIR ACTIONS. ALTHOUGH THEY ARE EMPLOYED BY THE CONTRACTOR, THE PROJECT ENGINEER SHALL HAVE CONTROL OVER THEIR PLACEMENT. THE OFFICIAL CAR SHALL BE A PUBLIC SAFETY VEHICLE AS REQUIRED BY THE OHIO REVISIED CODE.

THE CONTRACTOR SHALL MAKE ARRANGEMENTS FOR THESE SERVICES WITH:

CANTON PATROL POST 4710 SHUFFEL ROAD 44720 330-433-6200

ITEM 614 - LAW ENFORCEMENT OFFICER WITH PATROL CAR 240 HOURS (SILVER LAKE) 480 HOURS (STOW)

THE HOURS PAID SHALL INCLUDE MINIMUM SHOW-UP TIME REQUIRED BY THE LAW ENFORCEMENT AGENCY INVOLVED.

TRENCHING

IF THE CONTRACTOR WISHES TO UTILIZE LEOS FOR FLAGGING AND TRAFFIC CONTROL OTHER THAN THAT REQUIRED IN THESE PLANS, HE MAY DO SO AT HIS OWN EXPENSE. PAYMENT FOR THE EXCESS ABOVE CONTRACT REQUIREMENTS WILL BE INCLUDED UNDER ITEM 614 MAINTAINING TRAFFIC.

CALCULATED

MJH

222

MAINTENANCE OF TRAFFIC GENERAL NOTES

SUM-59-5-38

18

PART	ROUTE	LOG POINT TO LOG POINT		MILES	AVG. FEET WP	PAVEMENT AREA	AS PER PLAN	TACK COAT @ 0.15 gal./s.y.	TACK COAT FOR INTERMEDIATE COURSE @ 0.04 gal./s.y.	THICK INCHES	CU. YD.	AVG. THICK INCHES	CU. YD.	THICK INCHES	CONCRETE SURFACE COURSE, TYPE I PG 64-22	POLYMER ASPHALT FINE GRADED	854	
		LENGTH																
SR 59	5.38 TO 6.428	1.48	553.44	40	24593.07	2	24593.07	2	24593.07	1/4	853.93	3/4	512.36	0.98				
SR 59	6.428 TO 6.43	0.002	10.56	40	46.93	2-1/4	46.93	7.04	1.88	1/4	1.63							
SR 59	6.43 TO 6.91	0.48	2534.40	40	11264.00	1/4	11264.00	1689.60	450.56	1/4	391.11			234.67				
SR 59	6.91 TO 6.93	0.02	105.60	43.5	510.40	1/4	510.40	76.56	20.42	1/4	17.72			10.63				
SR 59	6.93 TO 6.932	0.002	10.56	47.5	55.73	1/4-2	55.73	8.36	2.23	1/4	1.94			1.16				
SR 59	6.932 TO 6.96	0.028	147.84	53	870.61	2	870.61	130.59	34.82	1/4	30.23			18.14				
SR 59	6.96 TO 6.98	0.022	116.16	58	748.59	2	748.59	112.29	29.94	1/4	25.99			15.60				
SR 59	7.02 TO 7.12	0.101	533.28	58	3436.69	2	3436.69	515.50	137.47	1/4	119.33			71.60				
SR 59	7.12 TO 7.145	0.025	132.00	53	777.33	2	777.33	116.60	31.09	1/4	26.99			16.19				
SR 59	7.145 TO 7.46	0.315	1663.20	48	8870.40	2	8870.40	1330.56	354.82	1/4	308.00			184.80				
TOTALS TO GENERAL SUMMARY																		
INTERSECTIONS																		
COMMERCIAL DRIVES																		
2046																		
1913																		
1066																		

PAVEMENT DATA

CITY OF STOW BEGIN PROJECT 5.38	VILLAGE OF SILVER LAKE
FULMER DR 5.43	
PARKWOOD DR 5.51	
N PARK DR 5.64	
LODGE AVE 5.70	
MAIDEN LN 5.76	
SILVER LAKE BLVD 5.84	
CHURCH ST 5.85	
COMMERCIAL DR 5.93	
OUT LOOK DR 5.72	
S PARK DR	
THOMAS DR	
HARRIET 6.26	
MCCORMICK RD 6.33	
VILLAGE OF SILVER LAKE CITY OF STOW	
ENGLEWOOD DR 6.48	
PATTY ANN 6.52	
DEGRUCHY 6.15 (NO WORK)	
PARK DR 6.65	
COMMERCIAL DR 6.73	
COMMERCIAL DR 6.775	
OAK DR 6.79	
COMMERCIAL DR 6.81	
COMMERCIAL DR 6.835	
COMMERCIAL DR 6.85	
COMMERCIAL DR 6.905	
ELM RD 6.93	
SUSPEND WORK 6.982	
RD 7.00	
RESUME WORK 7.019	
WILLIAMSON 7.11	
FRANKLIN 7.22	
ORCHARD AVE 7.31	
AVE 7.36	
AVE 7.45	
MARCELLA	
SANFORD	
ORCHARD AVE 7.32	
YUKON RD 7.06	
SR 91 DARROW	
GEORGE PARK BLVD 6.88	
SYCAMORE RD	



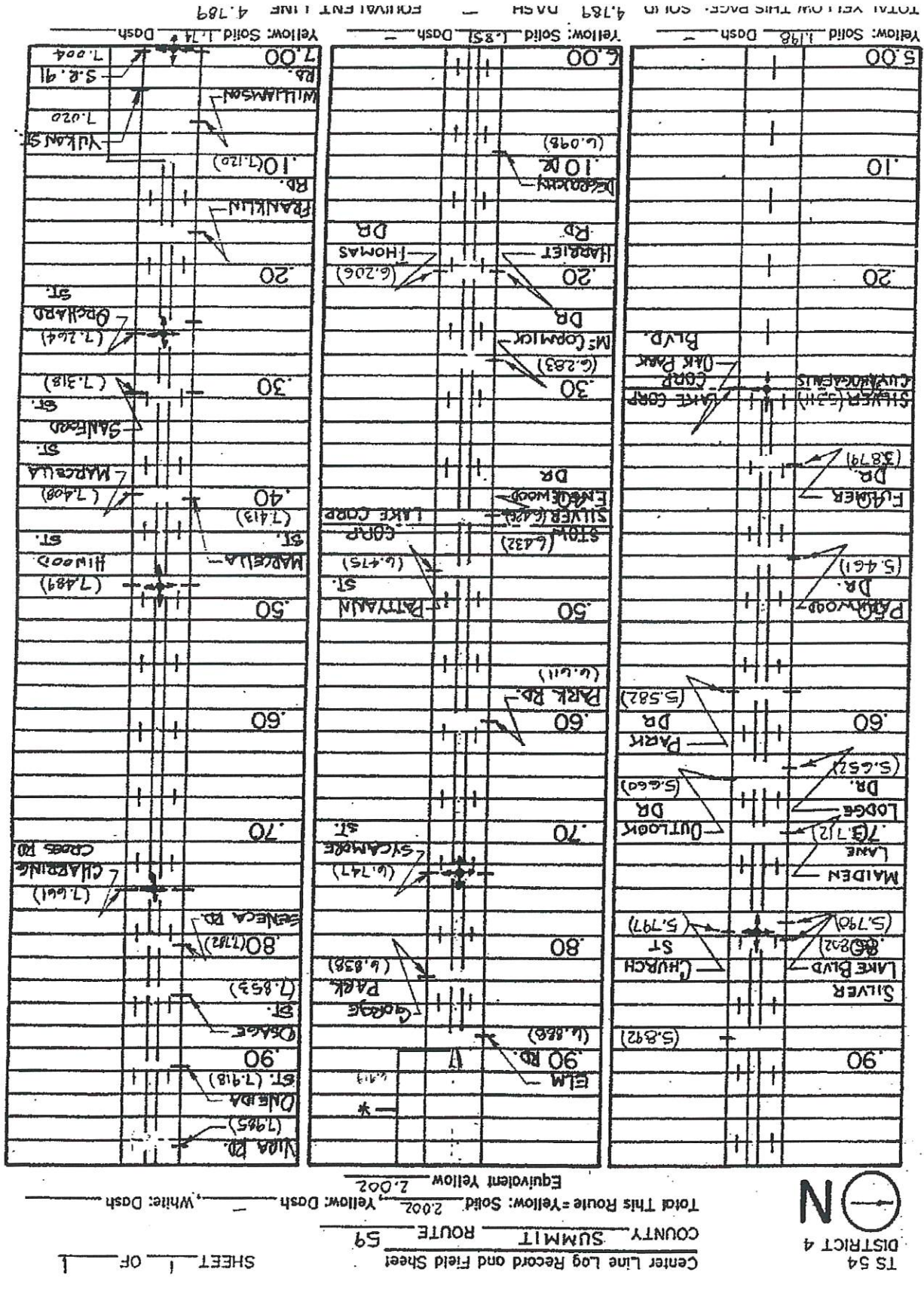
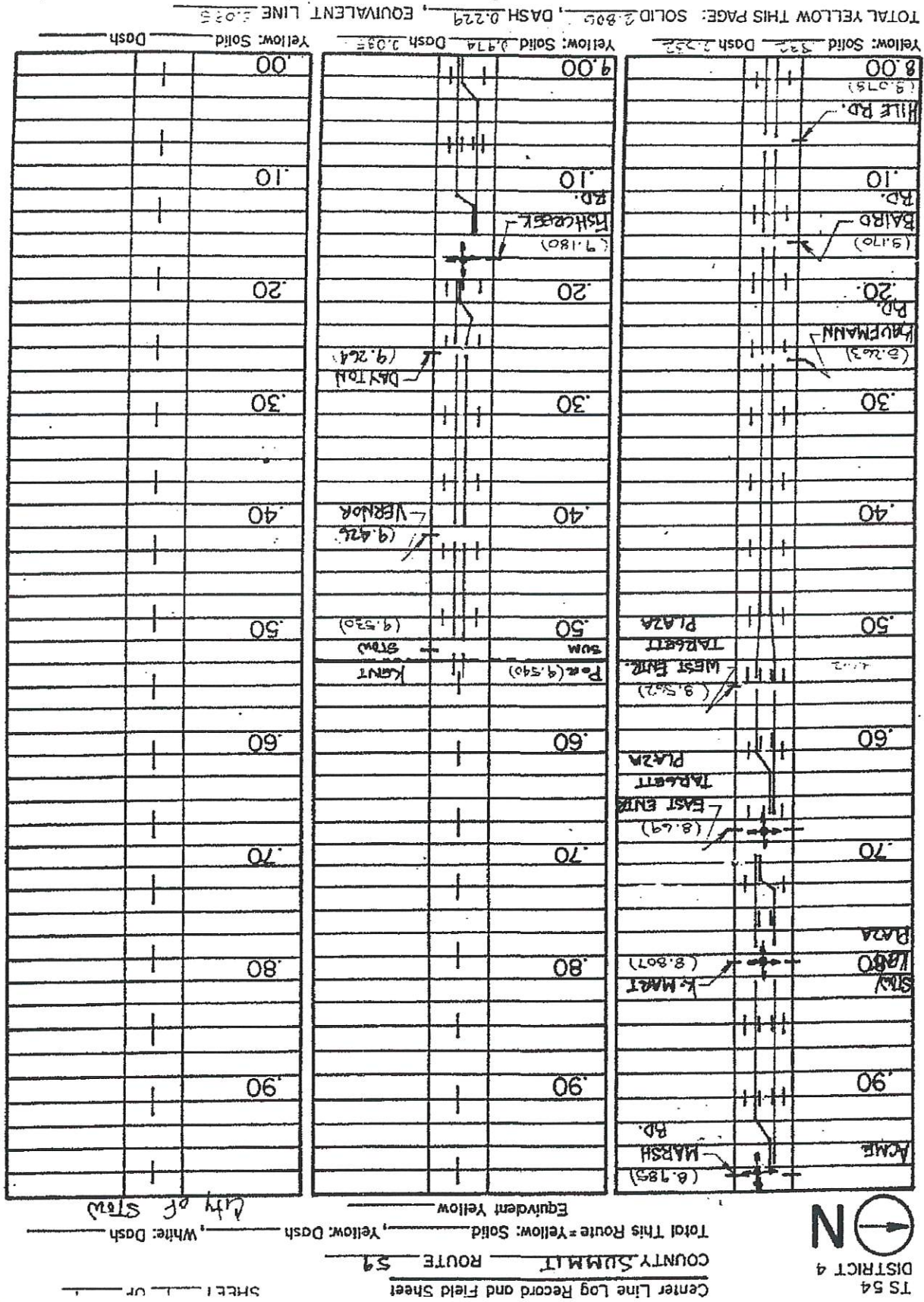

* See Auxiliary Pavement Marking Detail

* See Auxiliary Pavement Marking Detail

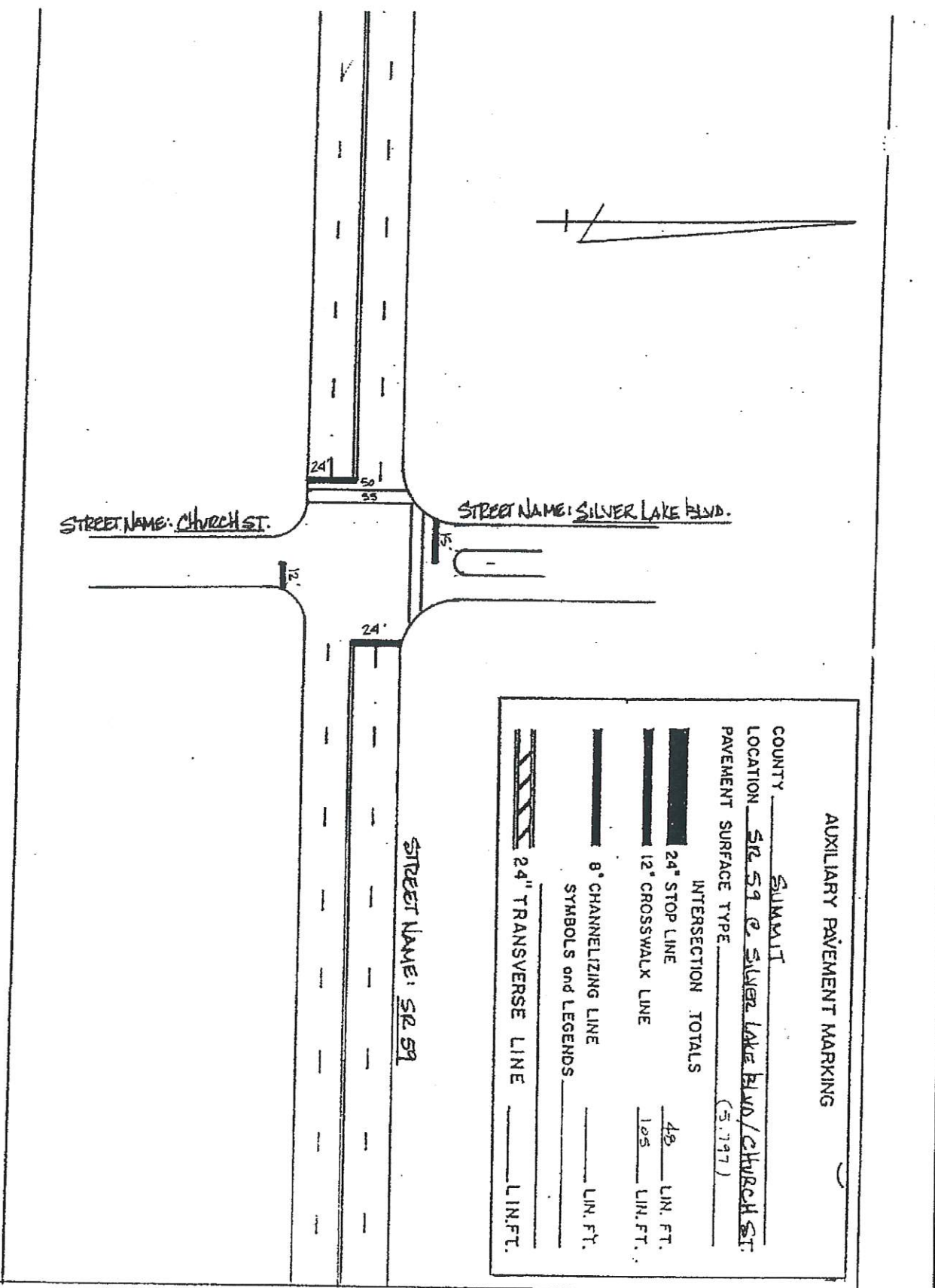

AUXILIARY PAVEMENT MARKING

COUNTY SUMMIT
 LOCATION SILVER LAKE BLVD/CHURCH ST.
 PAVEMENT SURFACE TYPE (5.197)

INTERSECTION TOTALS

24" STOP LINE	48	LIN. FT.
12" CROSSWALK LINE	125	LIN. FT.
8" CHANNELIZING LINE		LIN. FT.
SYMBOLS and LEGENDS _____ LIN. FT.		
24" TRANSVERSE LINE		LIN. FT.

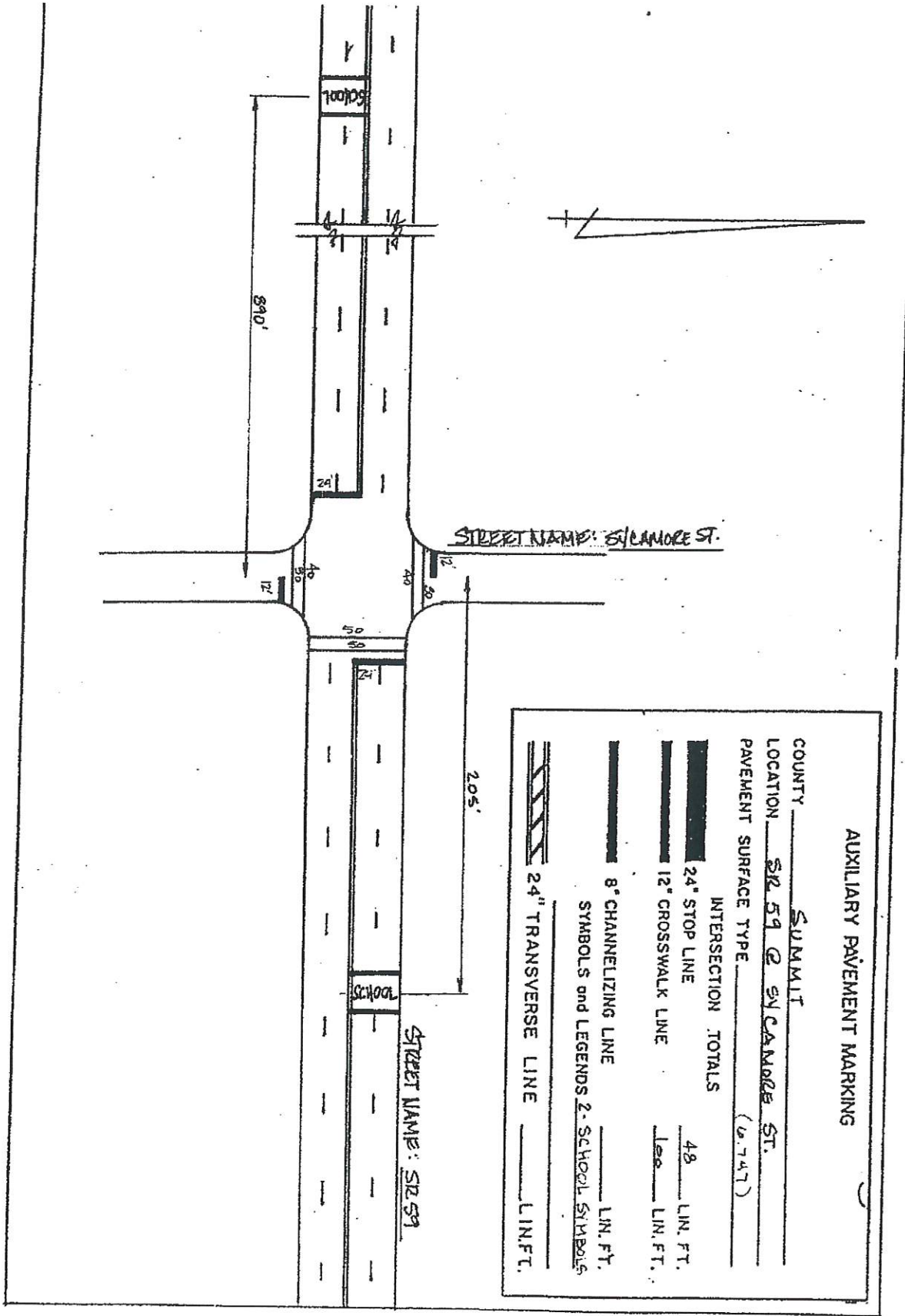

AUXILIARY PAVEMENT MARKING

COUNTY SUMMIT
 LOCATION SILVER LAKE BLVD/SCHOOL ST.
 PAVEMENT SURFACE TYPE (6.747)

INTERSECTION TOTALS

24" STOP LINE	48	LIN. FT.
12" CROSSWALK LINE	125	LIN. FT.
8" CHANNELIZING LINE		LIN. FT.
SYMBOLS and LEGENDS 2. SCHOOL SYMBOLS _____ LIN. FT.		
24" TRANSVERSE LINE		LIN. FT.

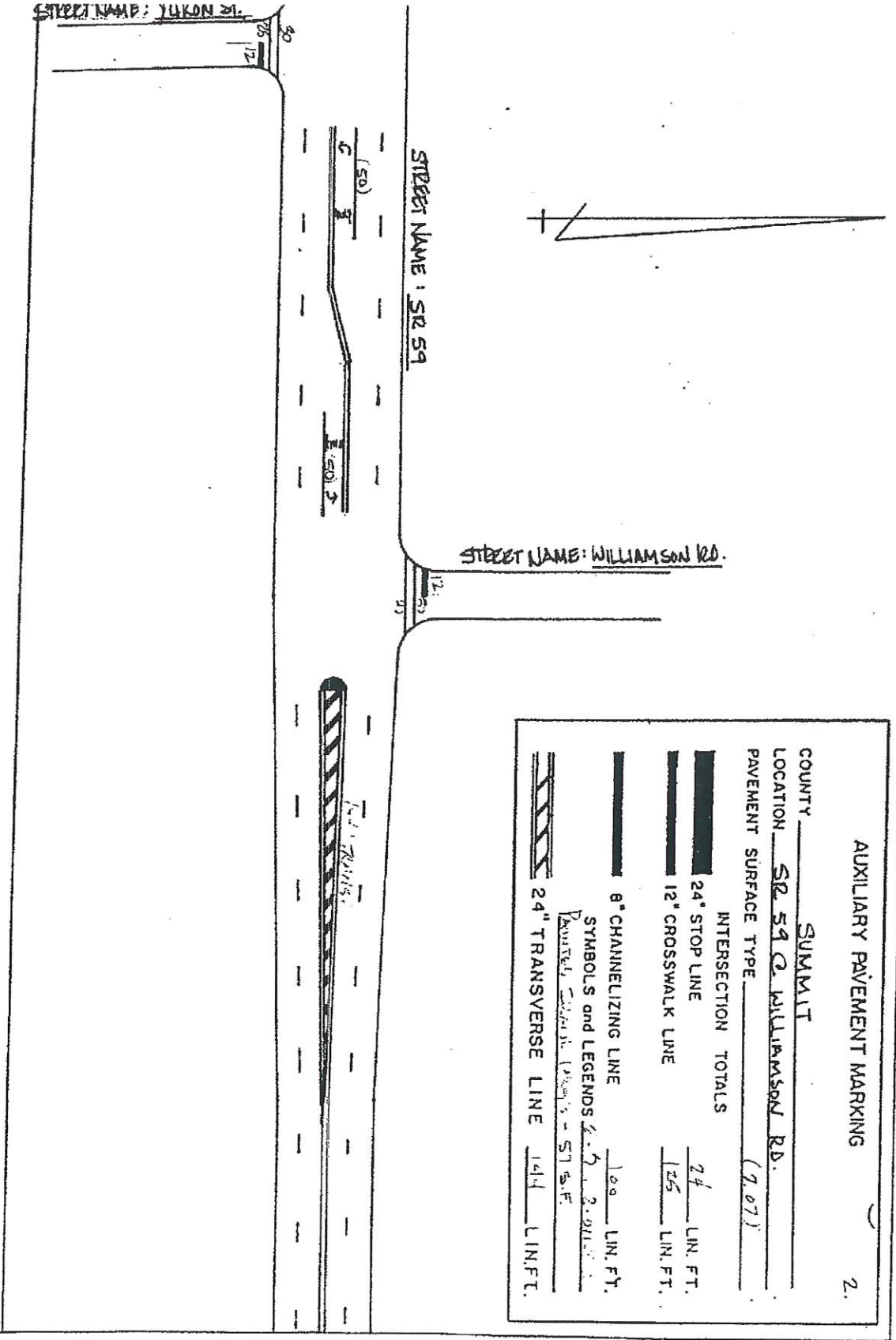
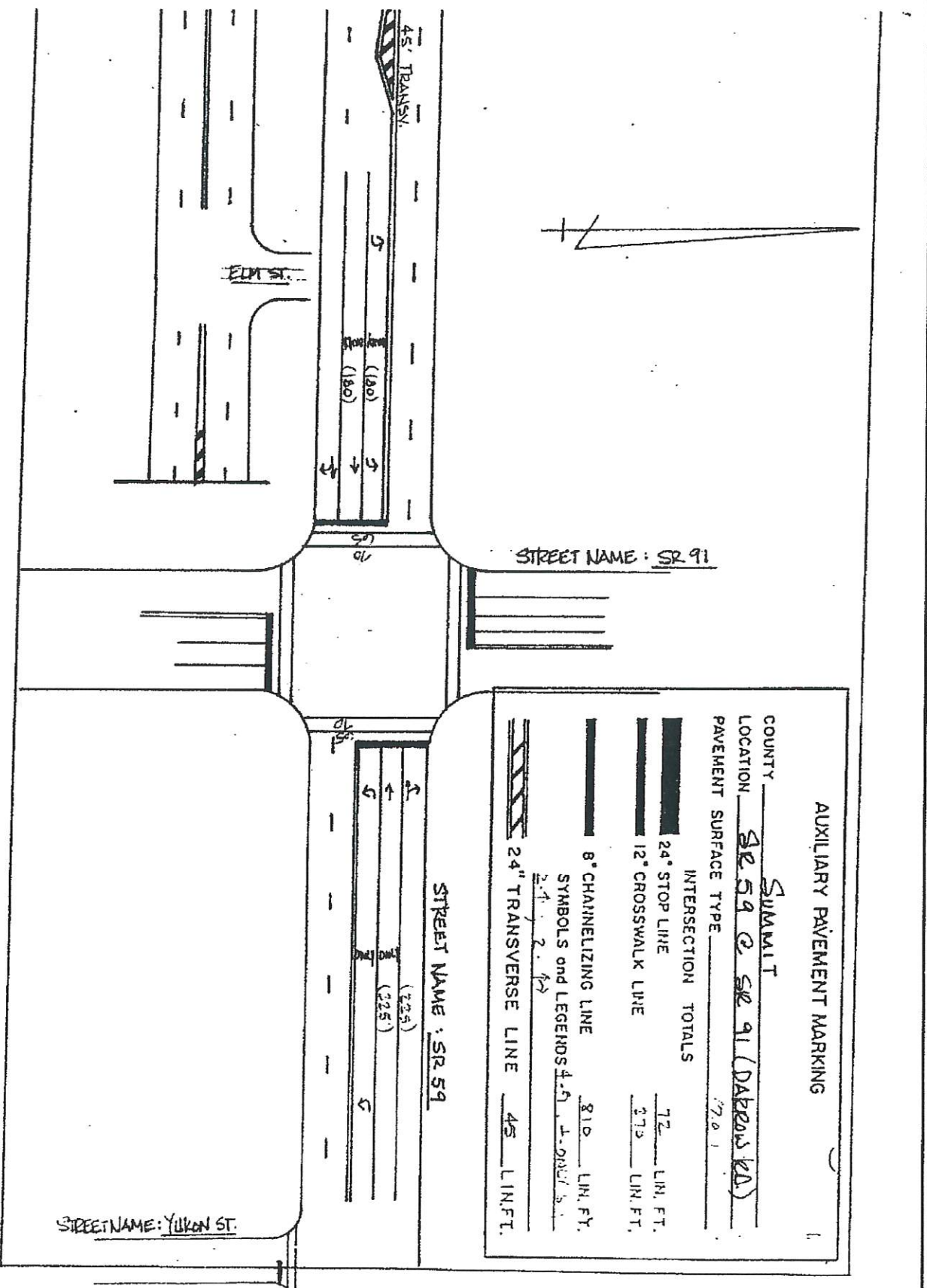

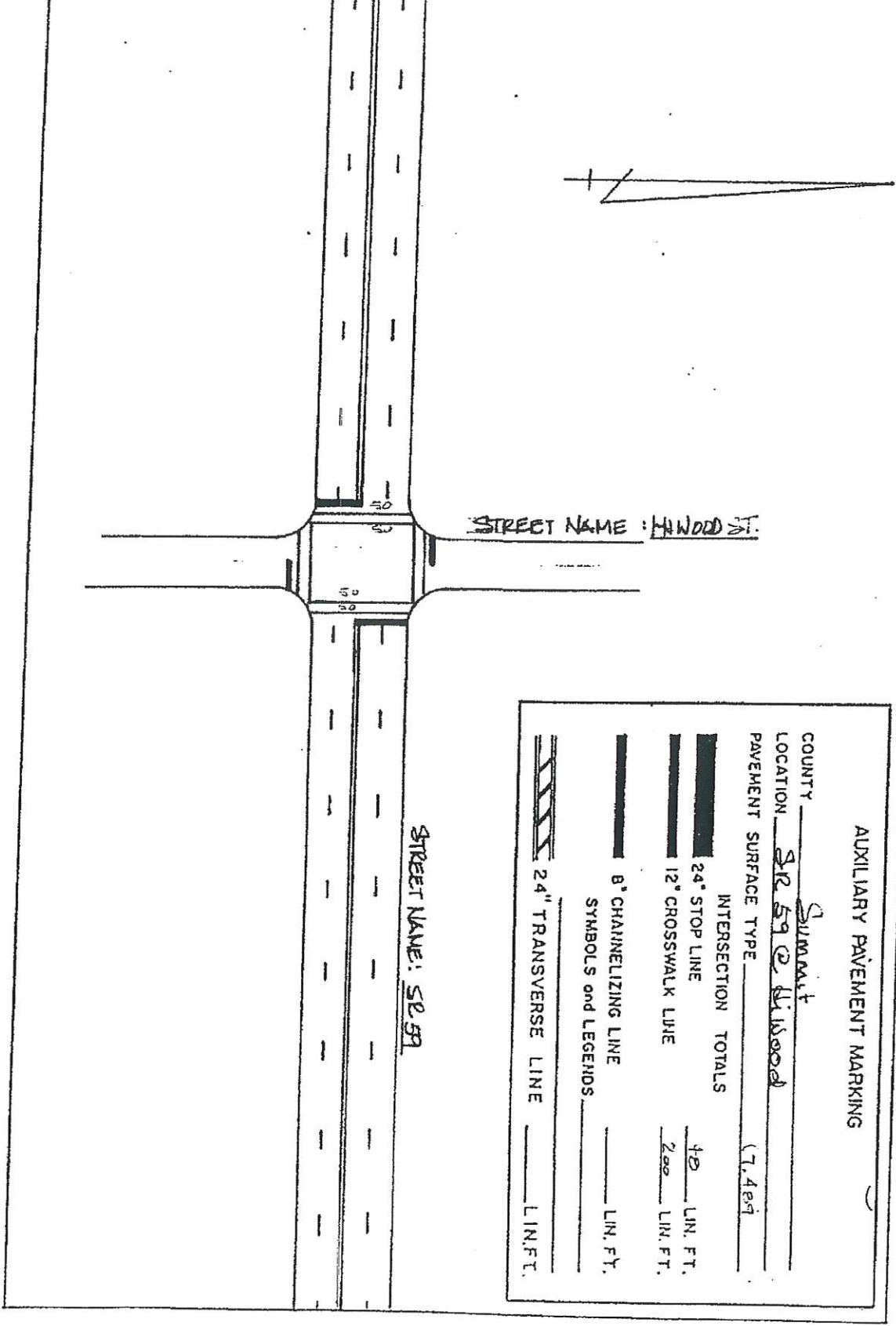
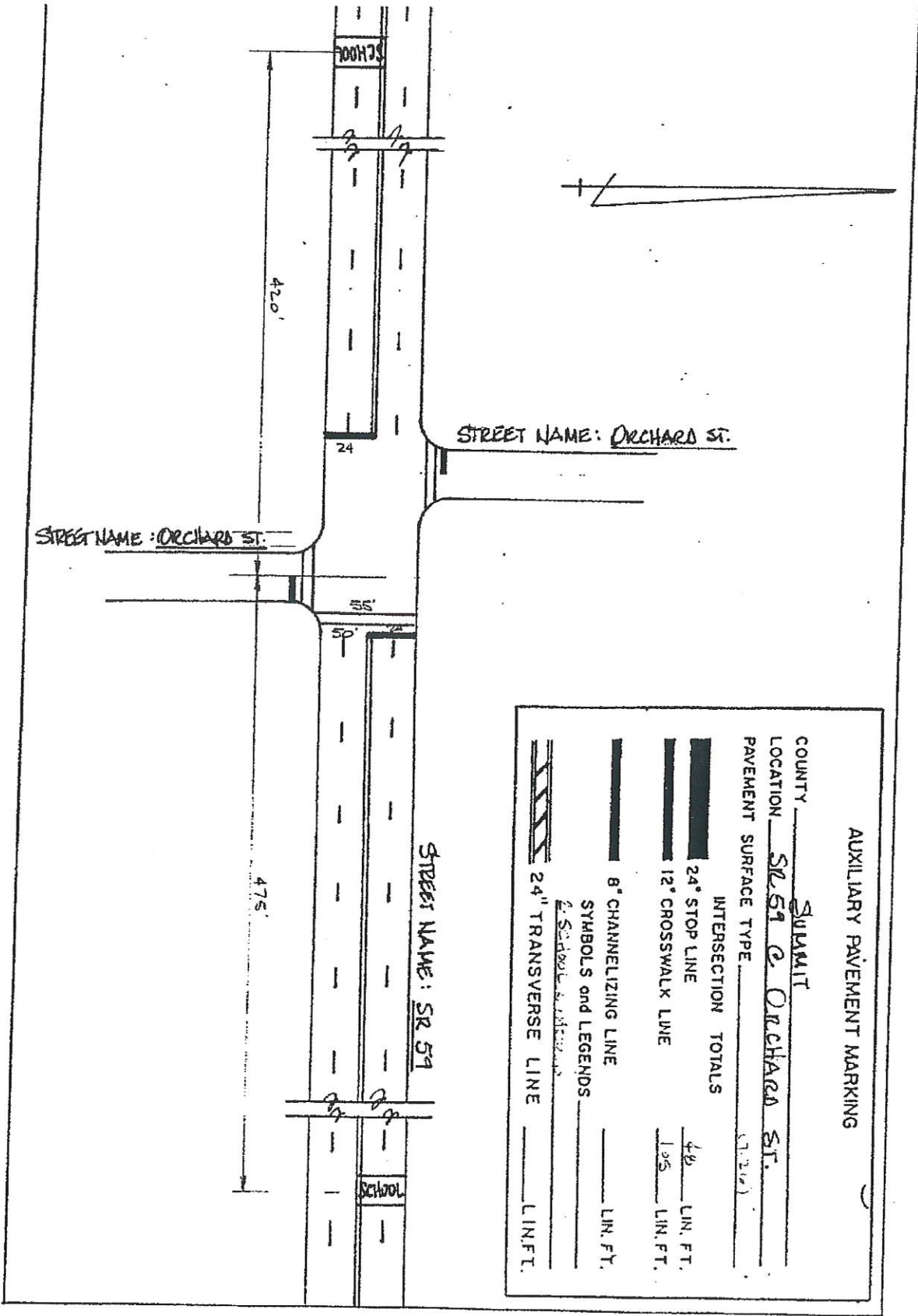

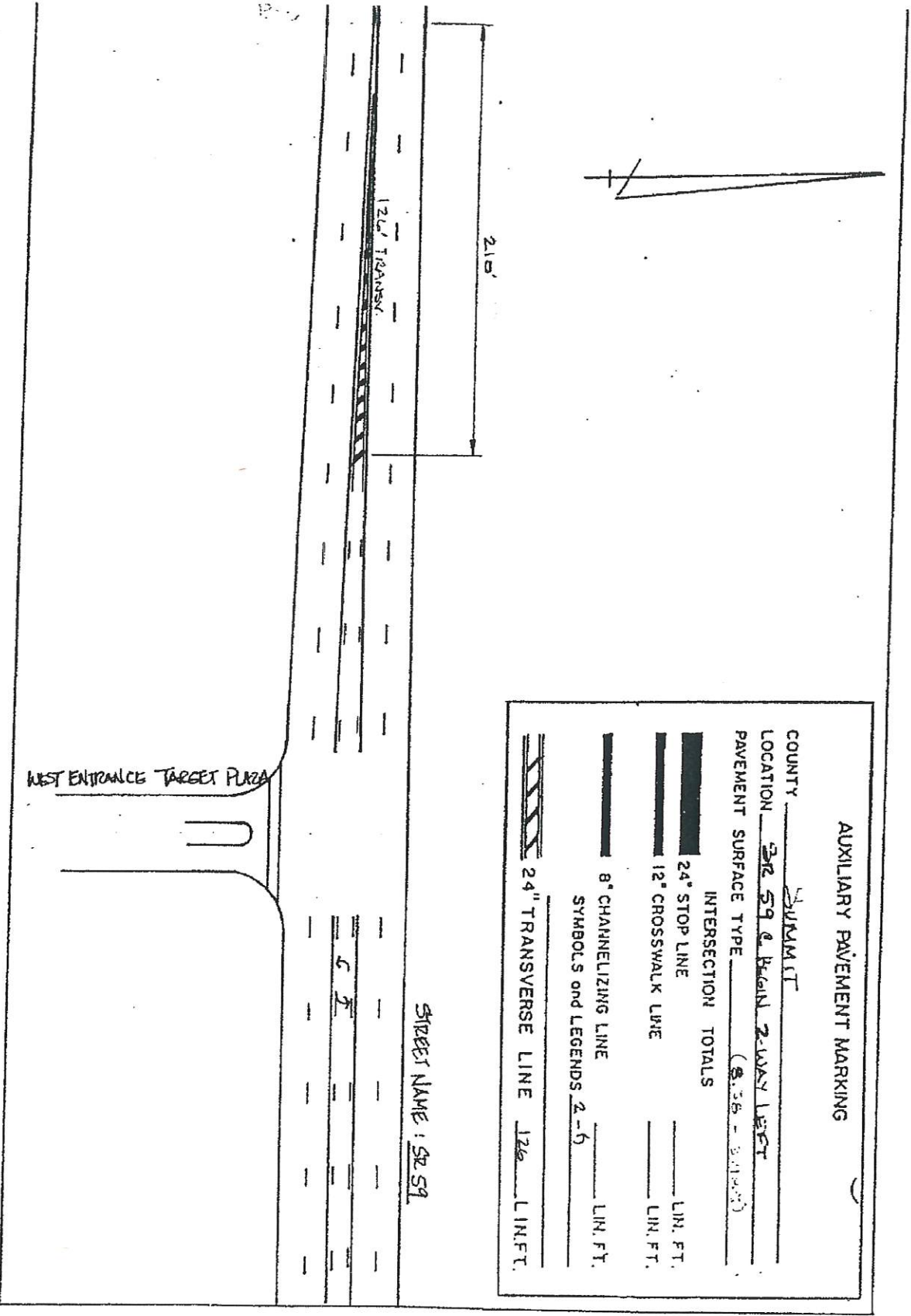
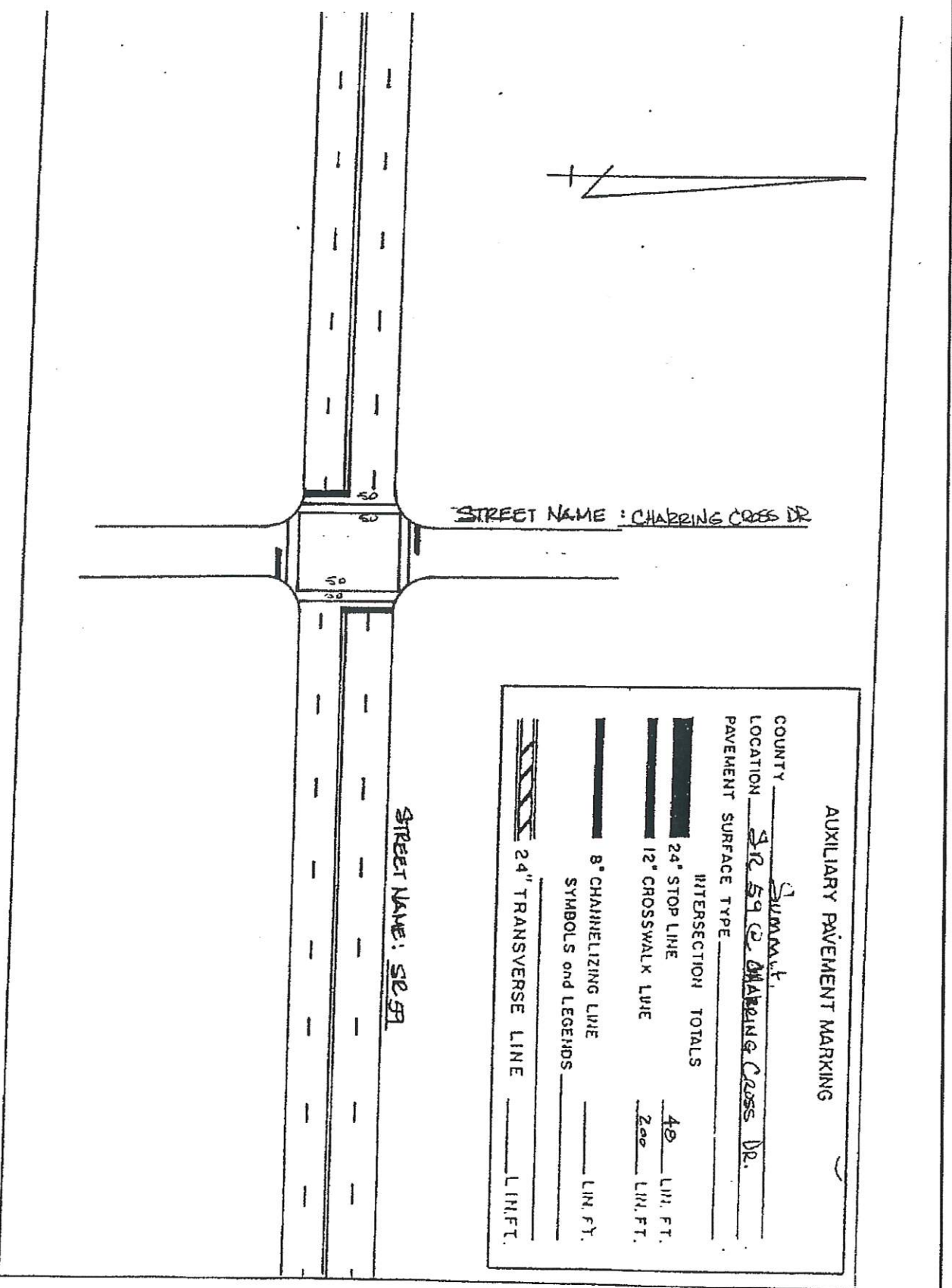

18
16

SUM-59-5.38

PAVEMENT MARKINGS

CALCULATED
LTS
DRENCO

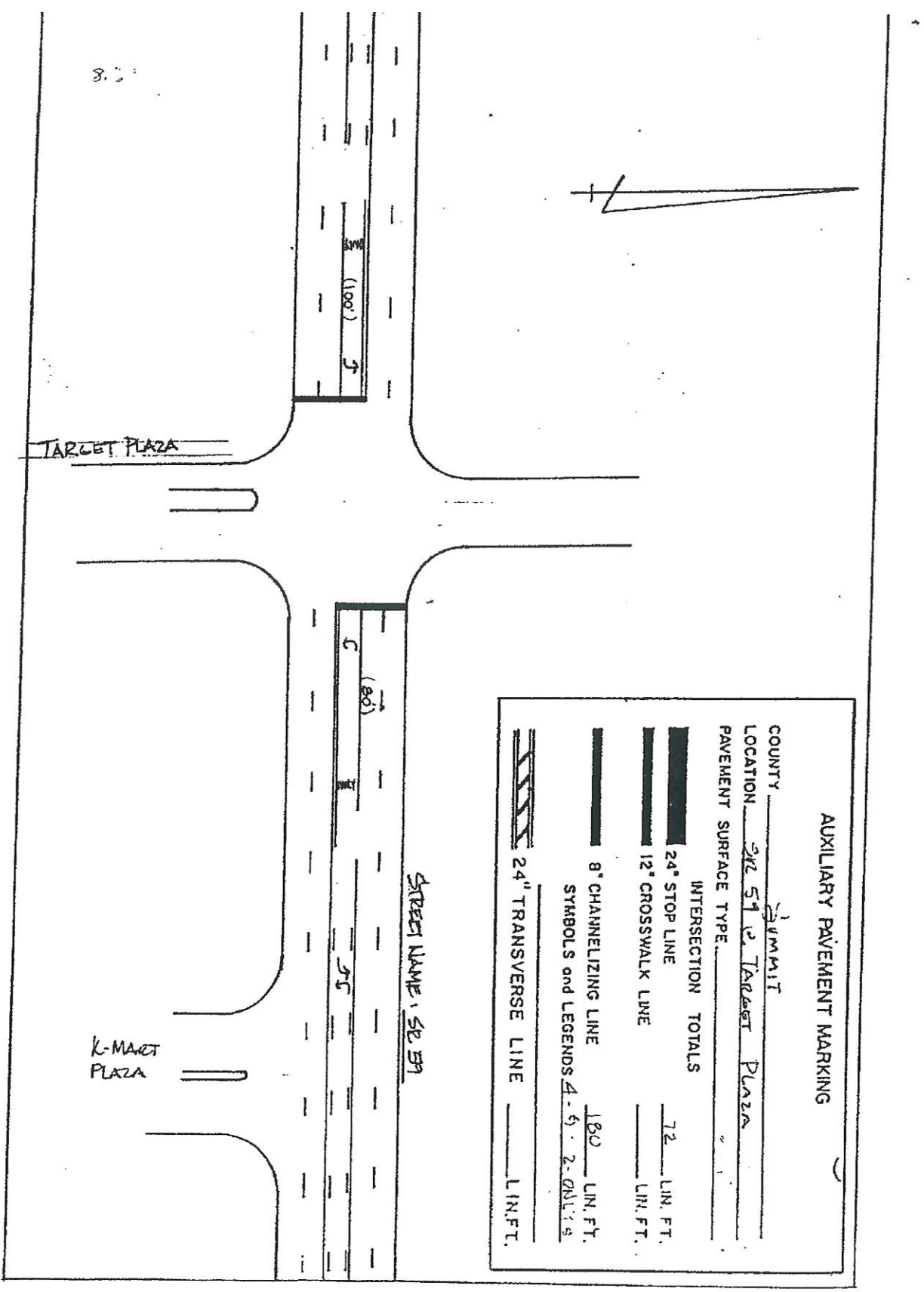

AUXILIARY PAVEMENT MARKING

COUNTY SUMMIT
 LOCATION SR 59 @ Target Plaza
 PAVEMENT SURFACE TYPE _____

INTERSECTION TOTALS

24" STOP LINE	72	LN. FT.
12" CROSSWALK LINE		LN. FT.
8" CHANNELIZING LINE	180	LN. FT.
SYMBOLS and LEGENDS	4.5	2.0x1.5
24" TRANSVERSE LINE		LN. FT.

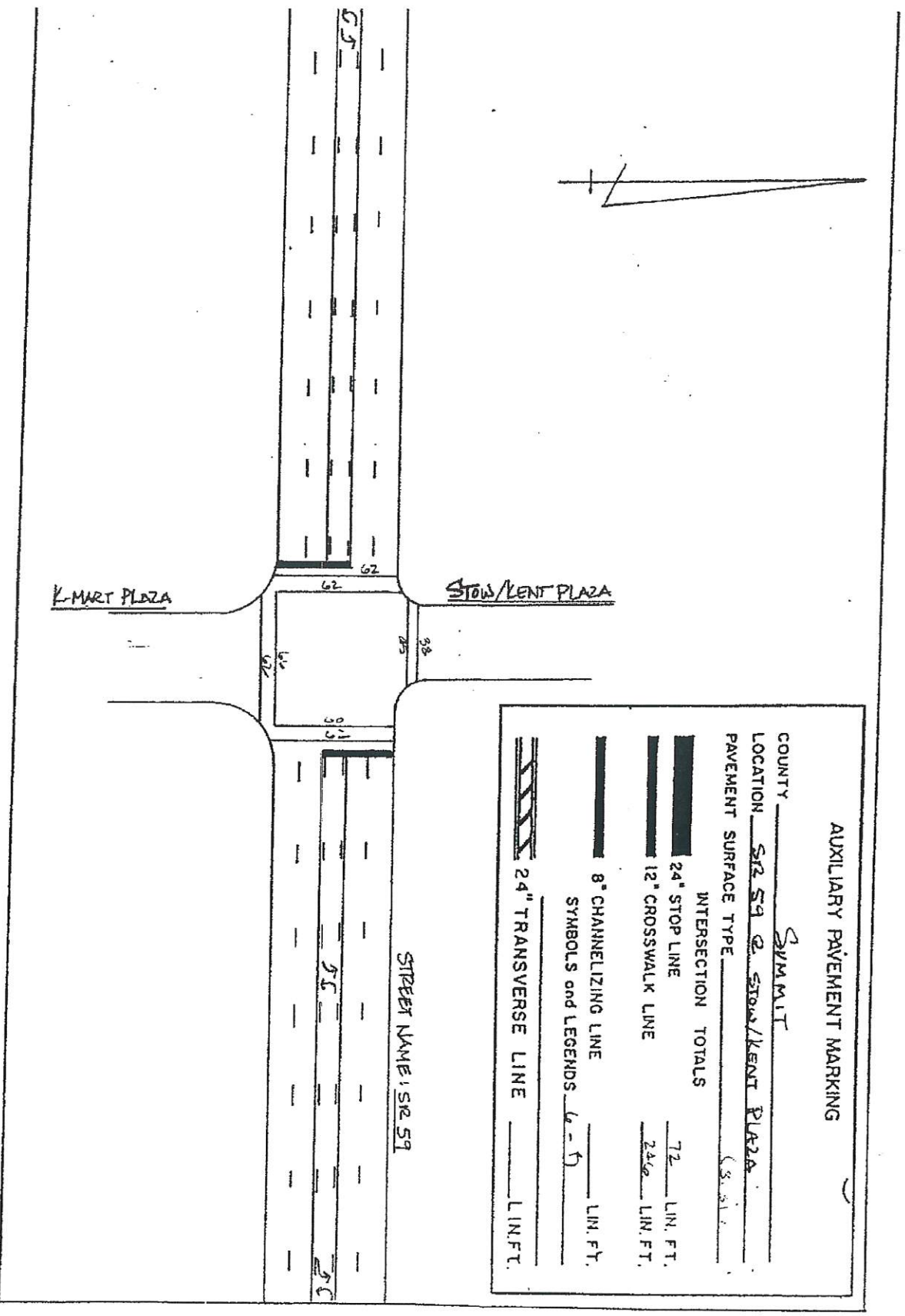

AUXILIARY PAVEMENT MARKING

COUNTY SUMMIT
 LOCATION SR 59 @ Stow/Lent Plaza
 PAVEMENT SURFACE TYPE _____

INTERSECTION TOTALS

24" STOP LINE	72	LN. FT.
12" CROSSWALK LINE	24	LN. FT.
8" CHANNELIZING LINE		LN. FT.
SYMBOLS and LEGENDS	4.5	LN. FT.
24" TRANSVERSE LINE		LN. FT.

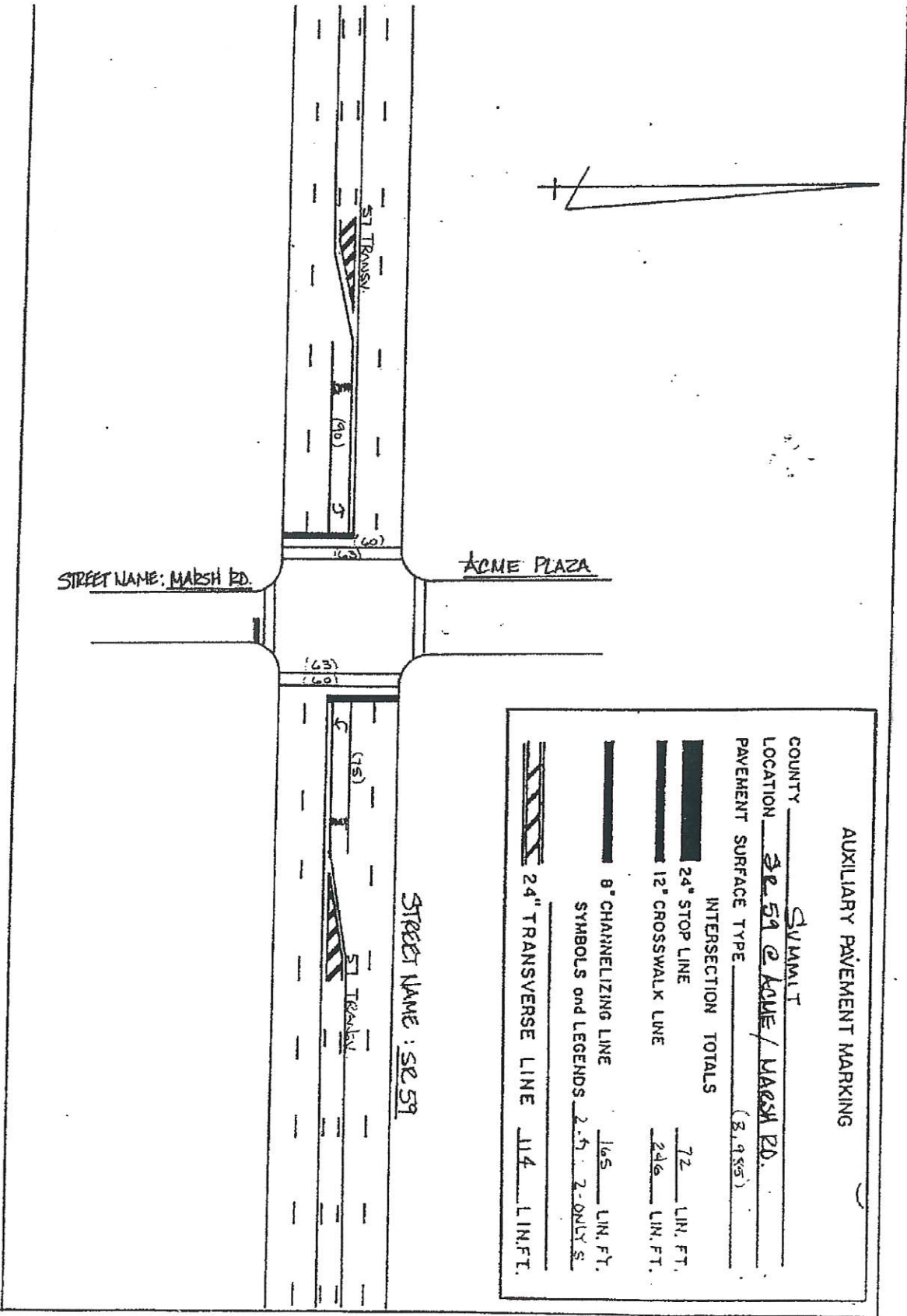

18

SUM-59-5.38

PAVEMENT MARKINGS

CALCULATED
 LLS
 CHECKED