

| | | |
|---------------------------|---------------------------------|------|
| COUNTY: | SUMMIT | |
| LOCATION: | S.R. 21 AT MINOR ROAD | |
| S.L.M.: | 6.50 | |
| 24" STOP LINE: | | L.F. |
| 12" CROSSWALK LINE: | | L.F. |
| DOTTED LINE: | 2475 | L.F. |
| 8" CHANNELIZING LINE: | 2250 | L.F. |
| 12" CHANNELIZING LINE: | | L.F. |
| 24" TRANSVERSE LINE (WT): | 200 | L.F. |
| 24" TRANSVERSE LINE (YW): | | L.F. |
| SYMBOL: | 8 - LEFT TURN ARROWS | |

RIGHT

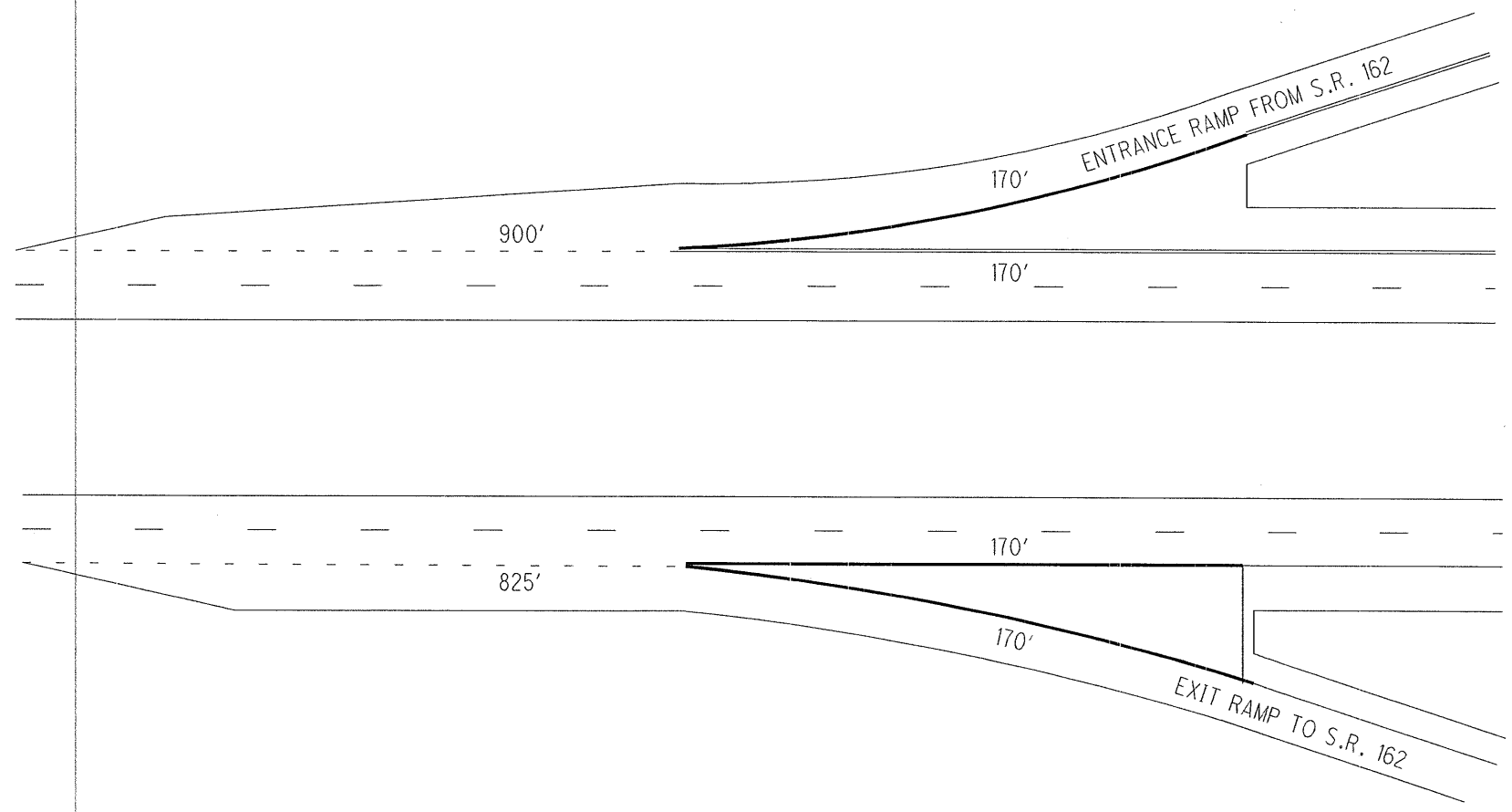

| | |
|---------------------------|---------------------|
| COUNTY: | SUMMIT |
| LOCATION: | S.R. 21 AT S.R. 162 |
| S.L.M.: | 7.72 |
| 24" STOP LINE: | L.F. |
| 12" CROSSWALK LINE: | L.F. |
| DOTTED LINE: | 1725 L.F. |
| 8" CHANNELIZING LINE: | L.F. |
| 12" CHANNELIZING LINE: | 680 L.F. |
| 24" TRANSVERSE LINE (WT): | L.F. |
| 24" TRANSVERSE LINE (YW): | L.F. |
| SYMBOL: | |



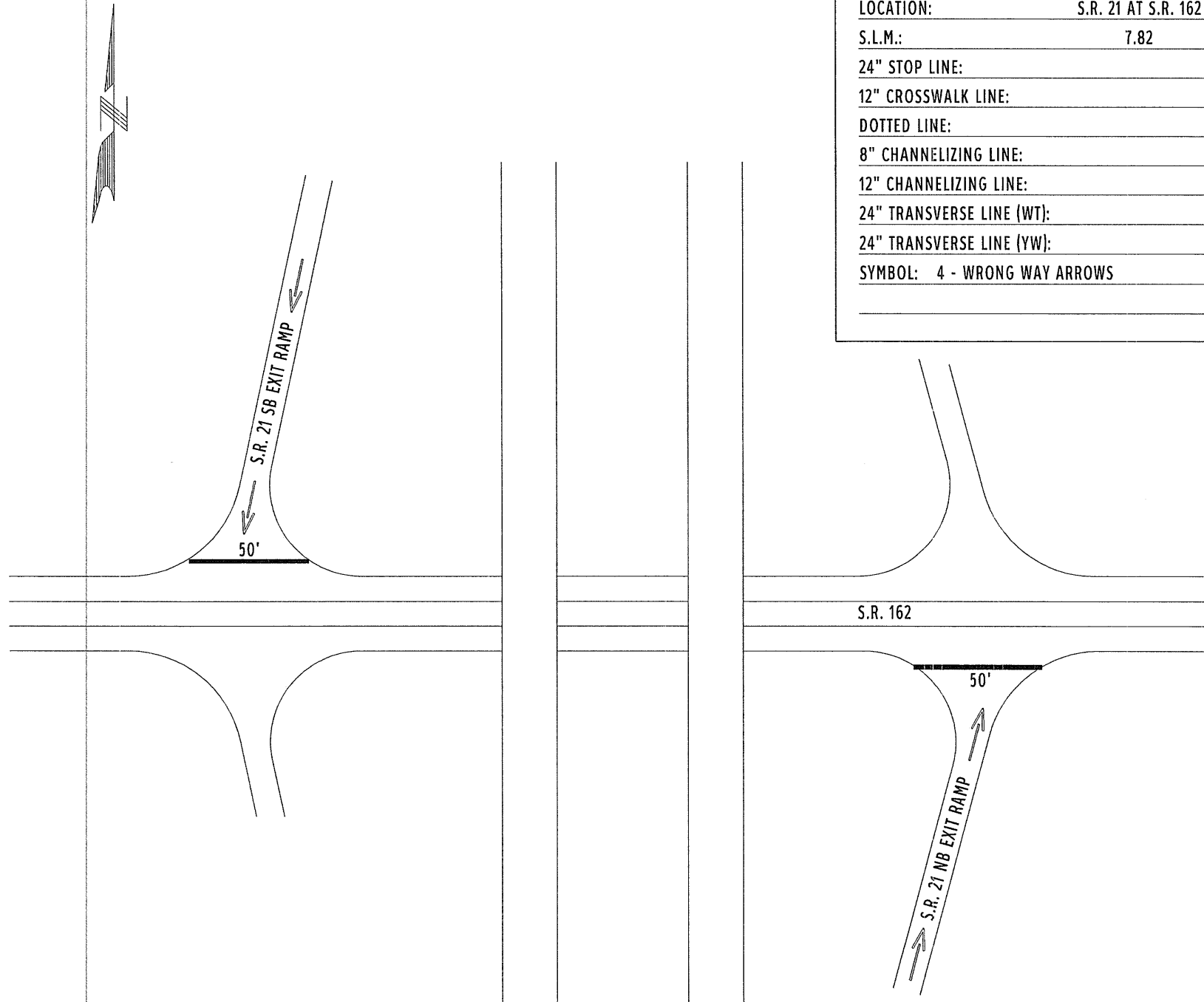

| | | |
|---------------------------|----------------------|------|
| COUNTY: | SUMMIT | |
| LOCATION: | S.R. 21 AT S.R. 162 | |
| S.L.M.: | 7.82 | |
| 24" STOP LINE: | 100 | L.F. |
| 12" CROSSWALK LINE: | | L.F. |
| DOTTED LINE: | | L.F. |
| 8" CHANNELIZING LINE: | | L.F. |
| 12" CHANNELIZING LINE: | | L.F. |
| 24" TRANSVERSE LINE (WT): | | L.F. |
| 24" TRANSVERSE LINE (YW): | | L.F. |
| SYMBOL: | 4 - WRONG WAY ARROWS | |



| | |
|---------------------------|---------------------|
| COUNTY: | SUMMIT |
| LOCATION: | S.R. 21 AT S.R. 162 |
| S.L.M.: | 7.92 |
| 24" STOP LINE: | L.F. |
| 12" CROSSWALK LINE: | L.F. |
| DOTTED LINE: | 950 L.F. |
| 8" CHANNELIZING LINE: | L.F. |
| 12" CHANNELIZING LINE: | 1000 L.F. |
| 24" TRANSVERSE LINE (WT): | L.F. |
| 24" TRANSVERSE LINE (YW): | L.F. |
| SYMBOL: | |

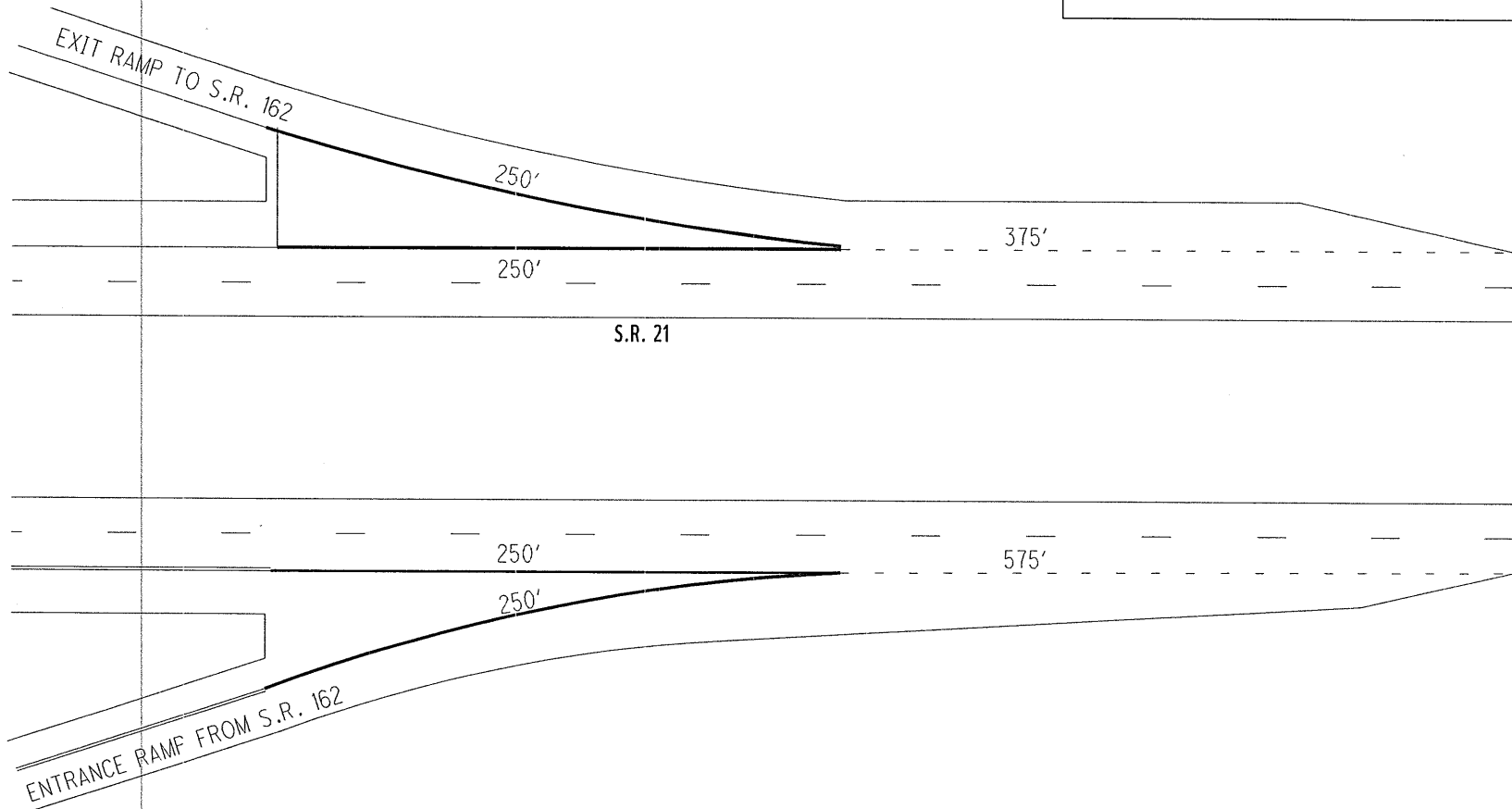



| | |
|---------------------------|--------------------|
| COUNTY: | SUMMIT |
| LOCATION: | S.R. 21 AT I.R. 77 |
| S.L.M.: | 9.18 |
| 24" STOP LINE: | L.F. |
| 12" CROSSWALK LINE: | L.F. |
| DOTTED LINE: | 1100 L.F. |
| 8" CHANNELIZING LINE: | L.F. |
| 12" CHANNELIZING LINE: | 1800 L.F. |
| 24" TRANSVERSE LINE (WT): | L.F. |
| 24" TRANSVERSE LINE (YW): | L.F. |
| SYMBOL: | |

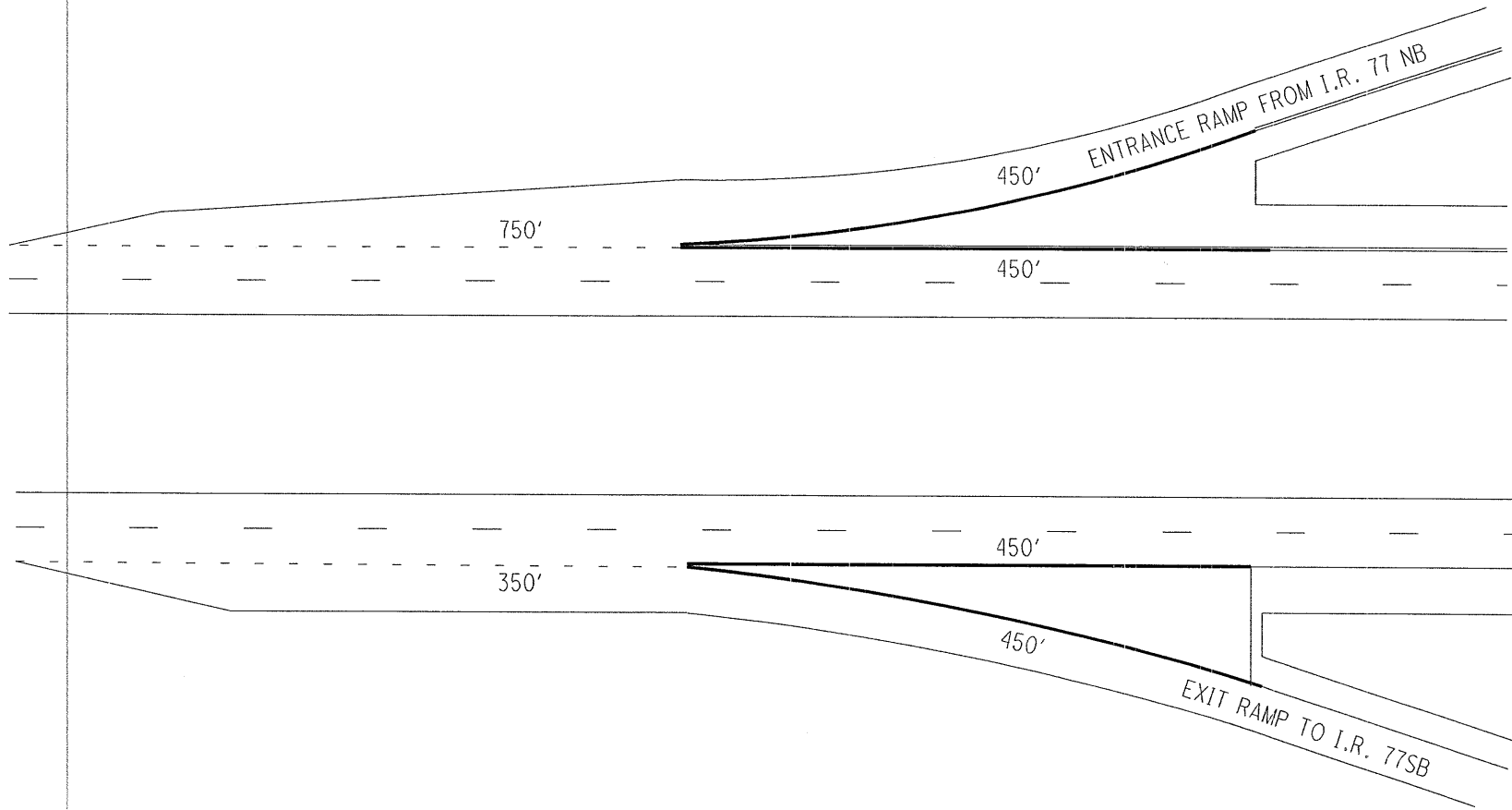

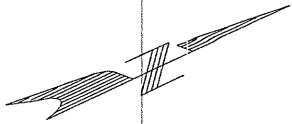

| | |
|---------------------------|--------------------------|
| COUNTY: | SUMMIT |
| LOCATION: | S.R. 21 SB TO I.R. 77 SB |
| S.L.M.: | 19.37 |
| 24" STOP LINE: | L.F. |
| 12" CROSSWALK LINE: | L.F. |
| DOTTED LINE: | L.F. |
| 8" CHANNELIZING LINE: | 470 L.F. |
| 12" CHANNELIZING LINE: | L.F. |
| 24" TRANSVERSE LINE (WT): | L.F. |
| 24" TRANSVERSE LINE (YW): | L.F. |
| SYMBOL: | |

RAMP G - TO I-77 SB

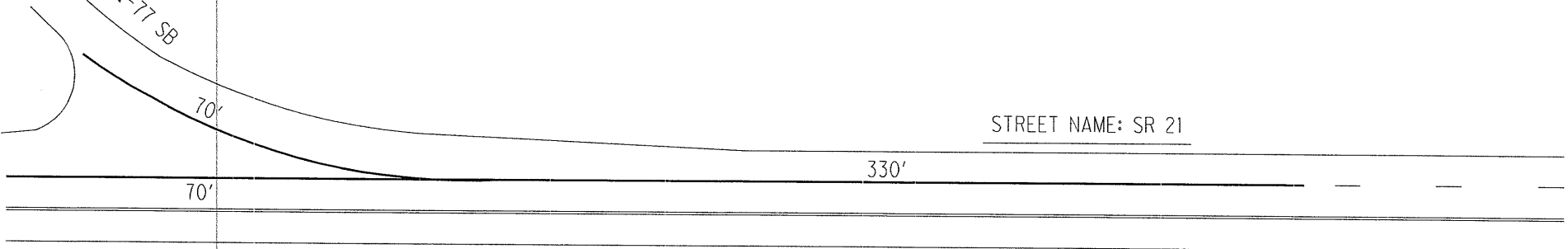

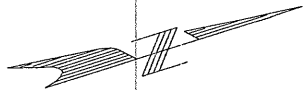

| | |
|---------------------------|----------------------------|
| COUNTY: | SUMMIT |
| LOCATION: | S.R. 21 NB FROM I.R. 77 NB |
| S.L.M.: | 19.59 |
| 24" STOP LINE: | L.F. |
| 12" CROSSWALK LINE: | L.F. |
| DOTTED LINE: | L.F. |
| 8" CHANNELIZING LINE: | 190 L.F. |
| 12" CHANNELIZING LINE: | L.F. |
| 24" TRANSVERSE LINE (WT): | L.F. |
| 24" TRANSVERSE LINE (YW): | L.F. |
| SYMBOL: | |

STREET NAME: SR 21

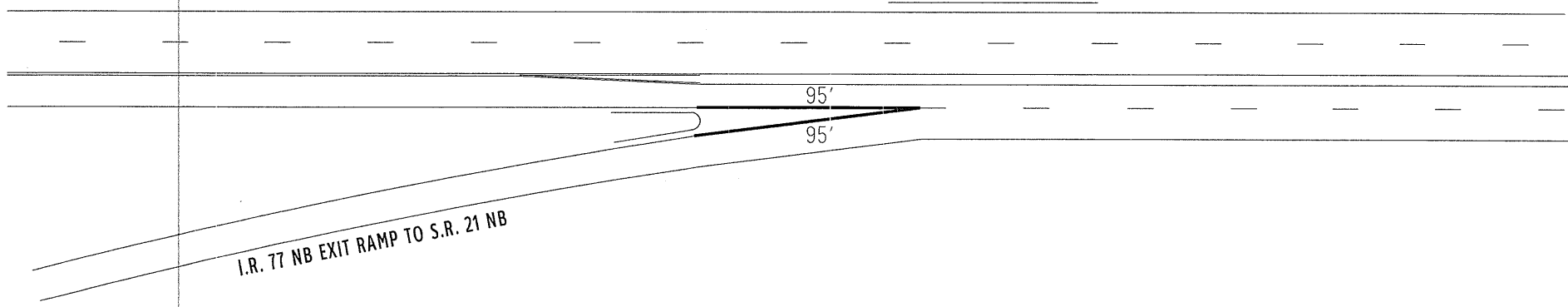

I.R. 77 NB EXIT RAMP TO S.R. 21 NB

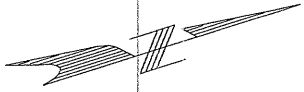

| | |
|---------------------------|------------------------------|
| COUNTY: | SUMMIT |
| LOCATION: | S.R. 21 AT BOSTON MILLS ROAD |
| S.L.M.: | 19.70 |
| 24" STOP LINE: | L.F. |
| 12" CROSSWALK LINE: | L.F. |
| DOTTED LINE: | L.F. |
| 8" CHANNELIZING LINE: | L.F. |
| 12" CHANNELIZING LINE: | L.F. |
| 24" TRANSVERSE LINE (WT): | L.F. |
| 24" TRANSVERSE LINE (YW): | L.F. |
| SYMBOL: | 57 S.F. - ISLAND MARKING |

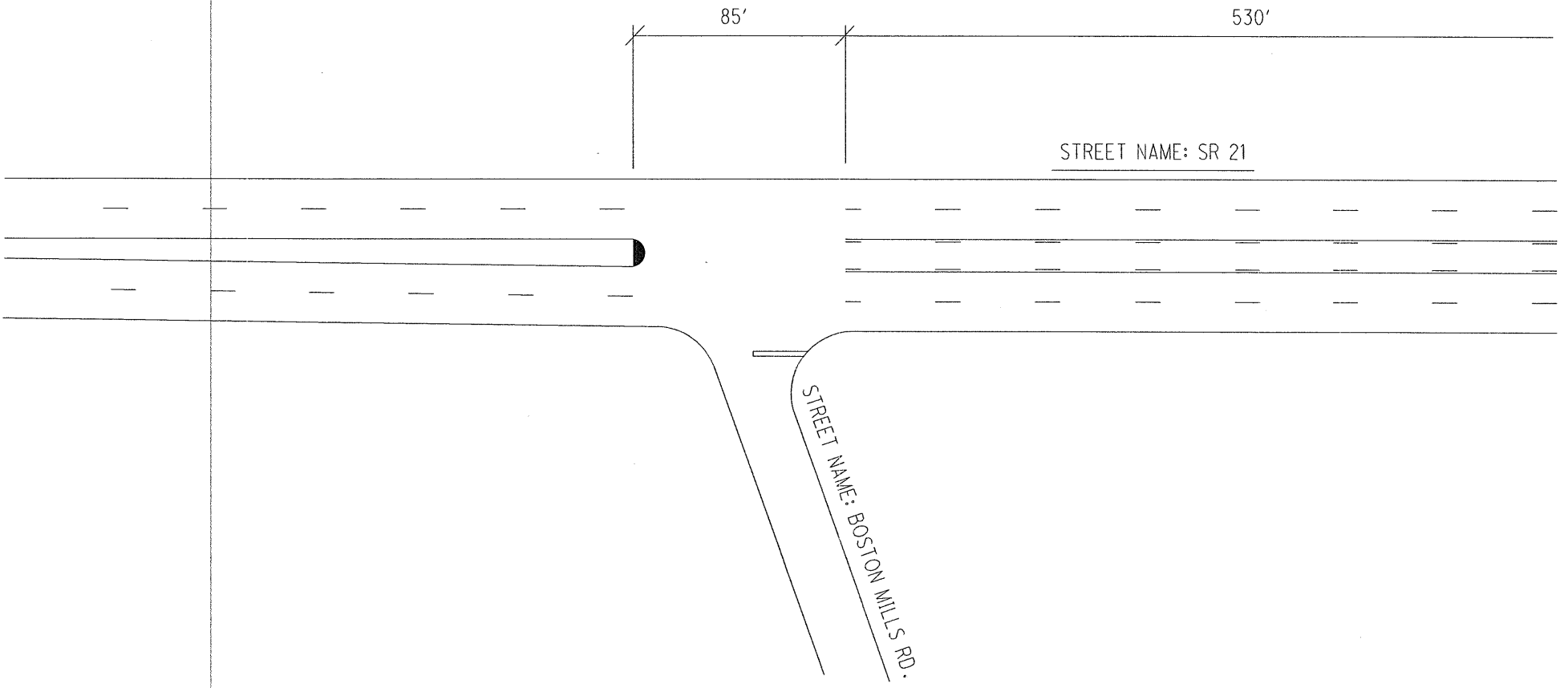

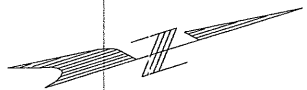

| | |
|---------------------------|----------------------|
| COUNTY: | SUMMIT |
| LOCATION: | S.R. 21 TWLT |
| S.L.M.: | 20.05 |
| 24" STOP LINE: | L.F. |
| 12" CROSSWALK LINE: | L.F. |
| DOTTED LINE: | L.F. |
| 8" CHANNELIZING LINE: | L.F. |
| 12" CHANNELIZING LINE: | L.F. |
| 24" TRANSVERSE LINE (WT): | L.F. |
| 24" TRANSVERSE LINE (YW): | L.F. |
| SYMBOL: | 2 - LEFT TURN ARROWS |

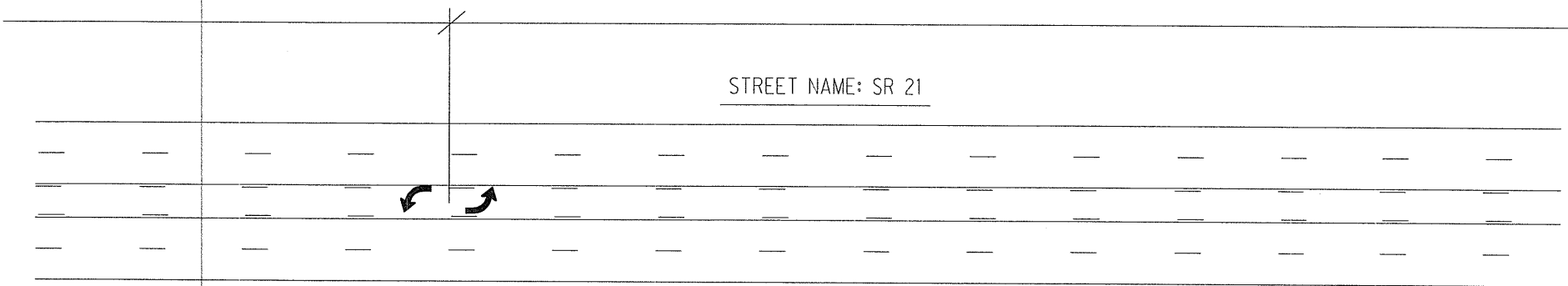



| | |
|---------------------------|----------------------|
| COUNTY: | SUMMIT |
| LOCATION: | S.R. 21 TWLT |
| S.L.M.: | 20.59 |
| 24" STOP LINE: | L.F. |
| 12" CROSSWALK LINE: | L.F. |
| DOTTED LINE: | L.F. |
| 8" CHANNELIZING LINE: | L.F. |
| 12" CHANNELIZING LINE: | L.F. |
| 24" TRANSVERSE LINE (WT): | L.F. |
| 24" TRANSVERSE LINE (YW): | L.F. |
| SYMBOL: | 2 - LEFT TURN ARROWS |

STREET NAME: SR 21

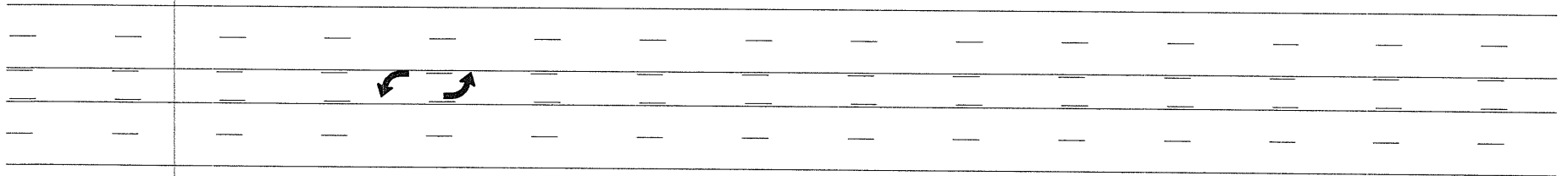

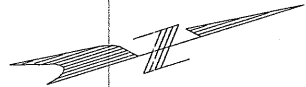

STREET NAME: BRUSHWOOD RD.

STREET NAME: SR 21

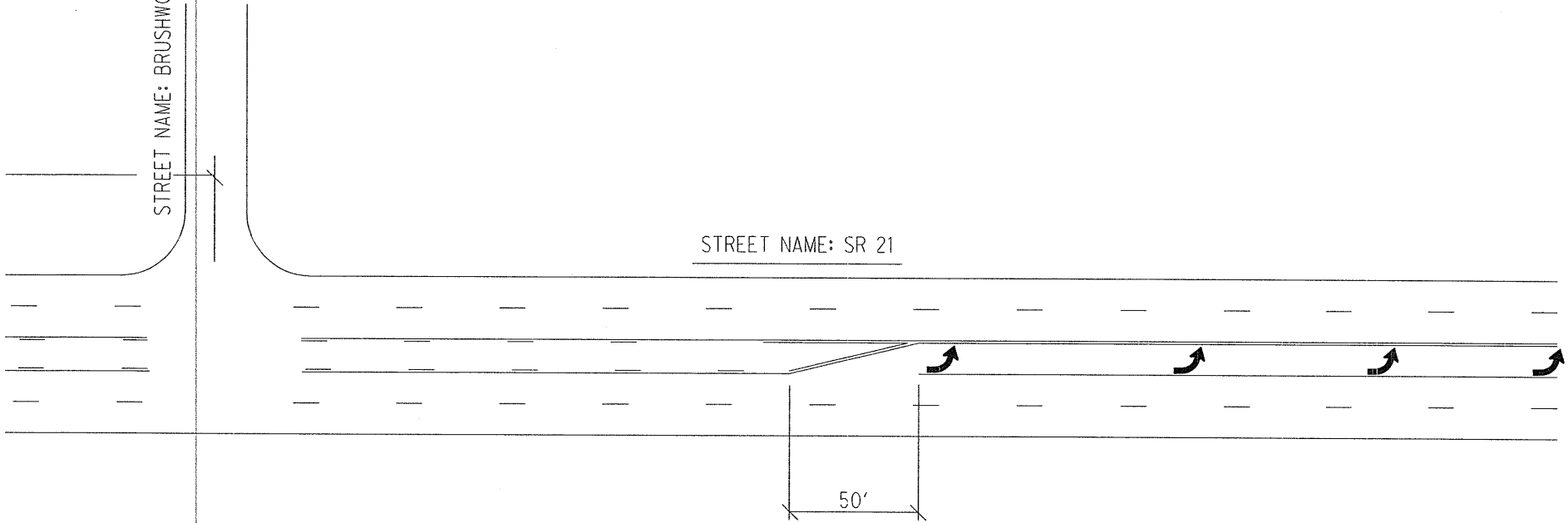

| | |
|---------------------------|--------------------------|
| COUNTY: | SUMMIT |
| LOCATION: | S.R. 21 AT BRUSHWOOD RD. |
| S.L.M.: | 21.15 |
| 24" STOP LINE: | L.F. |
| 12" CROSSWALK LINE: | L.F. |
| DOTTED LINE: | L.F. |
| 8" CHANNELIZING LINE: | L.F. |
| 12" CHANNELIZING LINE: | L.F. |
| 24" TRANSVERSE LINE (WT): | L.F. |
| 24" TRANSVERSE LINE (YW): | L.F. |
| SYMBOL: | 4 - LEFT TURN ARROWS |

| | |
|---------------------------|------------------------------|
| COUNTY: | SUMMIT |
| LOCATION: | S.R. 21 AT OTC RAMPS (SOUTH) |
| S.L.M.: | 20.272 |
| 24" STOP LINE: | L.F. |
| 12" CROSSWALK LINE: | L.F. |
| DOTTED LINE: | L.F. |
| 8" CHANNELIZING LINE: | 350 L.F. |
| 12" CHANNELIZING LINE: | L.F. |
| 24" TRANSVERSE LINE (WT): | L.F. |
| 24" TRANSVERSE LINE (YW): | L.F. |
| SYMBOL: | 5 - LEFT TURN ARROWS |



OHIO TURNPIKE

STREET NAME: SR 21

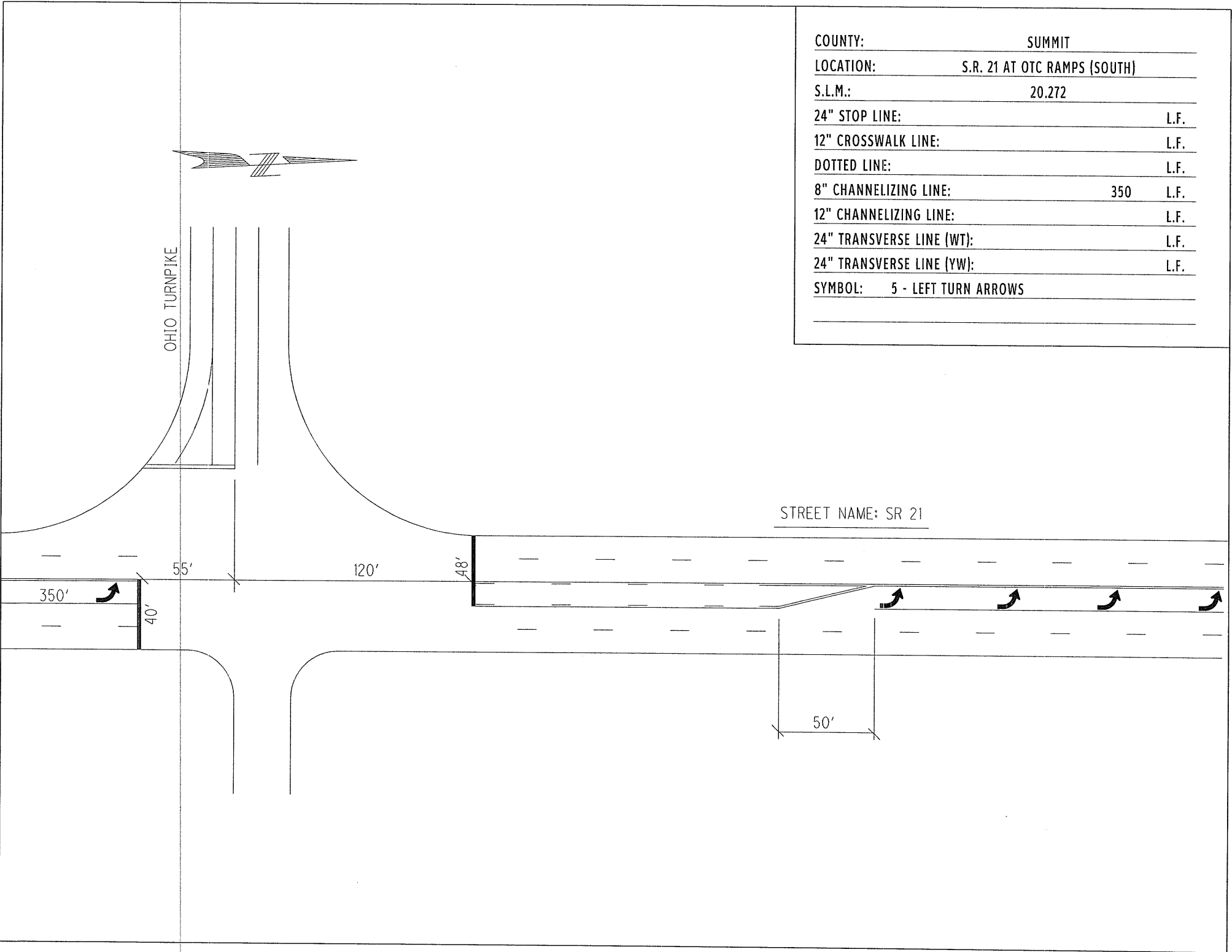



OHIO TURNPIKE

| | | |
|---------------------------|------------------------------|------|
| COUNTY: | SUMMIT | |
| LOCATION: | S.R. 21 AT OTC RAMPS (NORTH) | |
| S.L.M.: | 20.41 | |
| 24" STOP LINE: | 125 | L.F. |
| 12" CROSSWALK LINE: | | L.F. |
| DOTTED LINE: | | L.F. |
| 8" CHANNELIZING LINE: | 475 | L.F. |
| 12" CHANNELIZING LINE: | | L.F. |
| 24" TRANSVERSE LINE (WT): | | L.F. |
| 24" TRANSVERSE LINE (YW): | | L.F. |
| SYMBOL: | 6 - LEFT TURN ARROWS | |

STREET NAME: SR 21

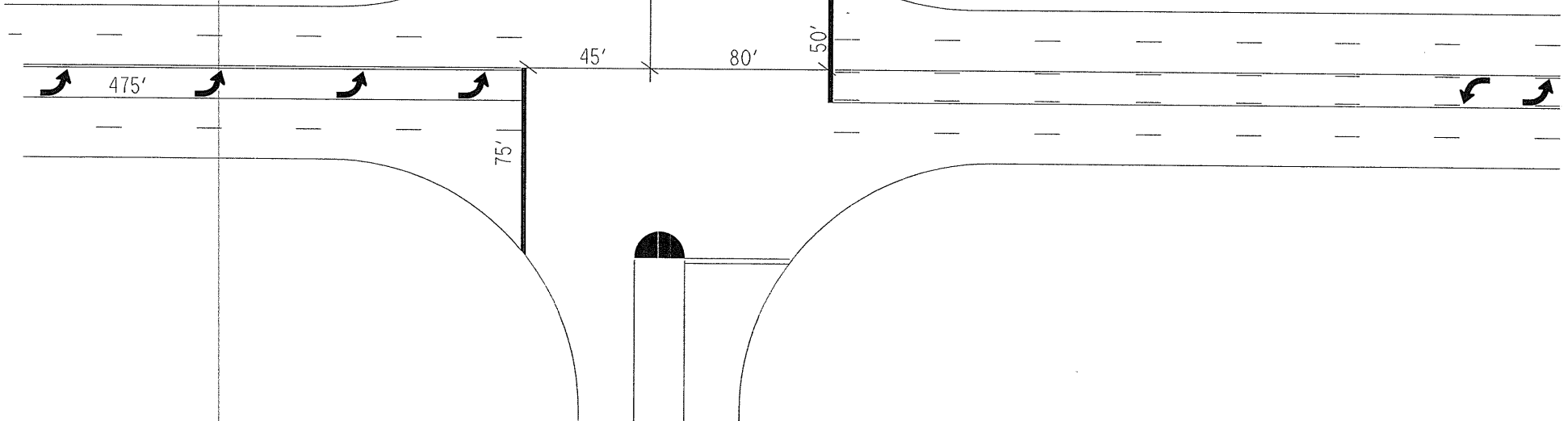

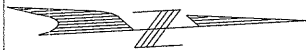

| | | |
|---------------------------|--------------------------|------|
| COUNTY: | SUMMIT | |
| LOCATION: | S.R. 21 AT COLUMBIA ROAD | |
| S.I.M.: | 20.73 | |
| 24" STOP LINE: | 80 | L.F. |
| 12" CROSSWALK LINE: | | L.F. |
| DOTTED LINE: | | L.F. |
| 8" CHANNELIZING LINE: | 560 | L.F. |
| 12" CHANNELIZING LINE: | | L.F. |
| 24" TRANSVERSE LINE (WT): | | L.F. |
| 24" TRANSVERSE LINE (YW): | | L.F. |
| SYMBOL: | 9 - LEFT TURN ARROWS | |

