

STATE OF OHIO

DEPARTMENT OF TRANSPORTATION

**SUM / WAY - 21 / 585 -
0.00 / VAR PART 1**

CITY OF NORTON, CHIPPEWA TOWNSHIP

SUMMIT, WAYNE COUNTY

FOR PART 2, SEE SUM / WAY -
585 - 0.00 / 18.47 PART 2

PROJECT DESCRIPTION

RESURFACING SUM STATE ROUTE 21 FROM 0.00 TO 5.14 AND SUM STATE ROUTE 585 FROM 0.13 TO 1.28 INCLUDING RAMP AT THE SR 21/585 INTERCHANGE. ALSO INCLUDES MINOR BRIDGE WORK TO SEVERAL STRUCTURES

EARTH DISTURBED AREAS

PROJECT EDA: N/A (MAINTENANCE PROJECT)
ESTIMATED CONTRACTOR EDA: N/A (MAINTENANCE PROJECT)
NOTICE OF INTENT EDA: N/A (MAINTENANCE PROJECT)

LIMITED ACCESS (SR-21,I-76)

THIS IMPROVEMENT IS ESPECIALLY DESIGNED FOR THROUGH TRAFFIC AND HAS BEEN DECLARED A LIMITED ACCESS HIGHWAY OR FREEWAY BY ACTION OF THE DIRECTOR IN ACCORDANCE WITH THE PROVISIONS OF SECTION 5511.02 OF THE OHIO REVISED CODE.

2019 SPECIFICATIONS

THE STANDARD SPECIFICATIONS OF THE STATE OF OHIO, DEPARTMENT OF TRANSPORTATION, INCLUDING SUPPLEMENTAL SPECIFICATIONS LISTED IN THE PLANS AND CHANGES LISTED IN THE PROPOSAL SHALL GOVERN THIS IMPROVEMENT.

I HEREBY APPROVE THESE PLANS AND DECLARE THAT THE MAKING OF THIS IMPROVEMENT WILL NOT REQUIRE THE CLOSING TO TRAFFIC OF THE HIGHWAY EXCEPT AS NOTED ON SHEETS 9-15, AND THAT PROVISIONS FOR THE MAINTENANCE AND SAFETY OF TRAFFIC WILL BE AS SET FORTH ON THE PLANS AND ESTIMATES.

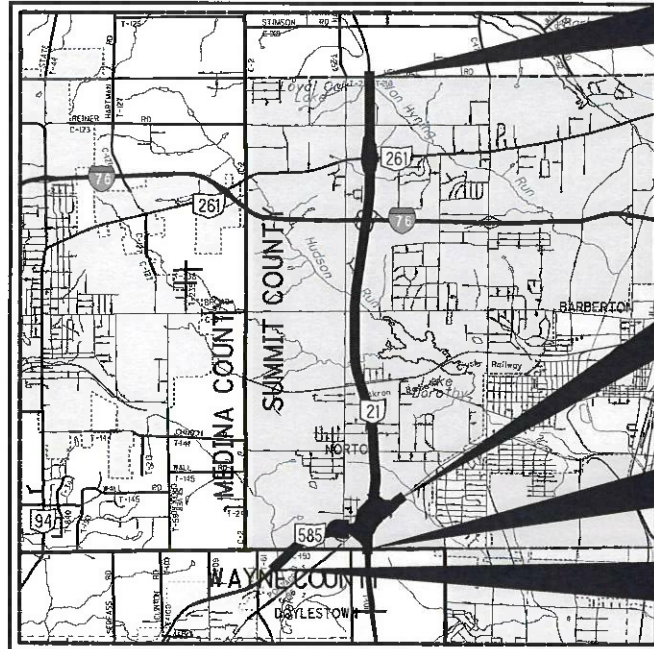

LOCATION MAP

LATITUDE: N41°1'23" LONGITUDE: W81°39'56"

SCALE IN MILES

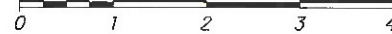

| | |
|-------------------------|-------|
| PORTION TO BE IMPROVED | ————— |
| INTERSTATE HIGHWAY | ===== |
| FEDERAL ROUTES | ————— |
| STATE ROUTES | ————— |
| COUNTY & TOWNSHIP ROADS | ————— |
| OTHER ROADS | ————— |

DESIGN DESIGNATION

DESIGN FUNCTIONAL CLASSIFICATION:

- SR 21 - URBAN FREEWAY AND EXPRESSWAY / NHS: YES
- IR 76 - URBAN FREEWAY AND EXPRESSWAY / NHS: YES
- SR 261 - URBAN MINOR ARTERIAL / NHS: NO
- SR 585 - URBAN FREEWAY AND EXPRESSWAY / NHS: NO

DESIGN EXCEPTIONS

NONE

INDEX OF SHEETS:

| | |
|-----------------------------|-------|
| TITLE SHEET | 1 |
| SCHEMATIC | 2 |
| TYPICAL SECTIONS | 3 |
| GENERAL NOTES | 4-5 |
| MAINTENANCE OF TRAFFIC | 6-15 |
| GENERAL SUMMARY | 16-17 |
| PAVEMENT CALCULATIONS | 18 |
| RPM SUBSUMMARY | 19 |
| PAVEMENT MARKING SUBSUMMARY | 20-21 |
| PART 2 SUBSUMMARIES | 22 |
| STRUCTURES | 23-31 |

UNDERGROUND UTILITIES
Contact Two Working Days Before You Dig

OHIO811.org
Before You Dig

OHIO811, 8-1-1, or 1-800-362-2764
(Non-members must be called directly)

PLAN PREPARED BY:
ODOT DISTRICT 4 PLANNING & ENGINEERING
2088 SOUTH ARLINGTON RD
AKRON, OH 44306

ENGINEERS SEAL:

SIGNED: *M. Andrasik*
DATE: 11/19/19

| STANDARD CONSTRUCTION DRAWINGS (PART 1 AND PART 2) | | | | | | | | | | SUPPLEMENTAL SPECIFICATIONS | SPECIAL PROVISIONS | | |
|--|---------|----------|---------|-----------|----------|----------|----------|----------|---------|-----------------------------|--------------------|-----|---------|
| BP-3.1 | 7/18/14 | MGS-1.1 | 1/19/18 | MT-98.10 | 1/20/17 | TC-41.20 | 10/18/13 | HL-30.21 | 1/17/14 | 800-2019 | 10/18/19 | WPC | 2/21/20 |
| BP-4.1 | 7/19/13 | MGS-2.1 | 1/19/18 | MT-98.11 | 4/19/19 | TC-41.50 | 10/18/13 | HL-30.22 | 1/17/14 | 808 | 1/18/19 | | |
| BP-6.1 | 7/19/13 | MGS-3.1 | 1/19/18 | MT-98.20 | 4/19/19 | TC-42.10 | 10/18/13 | HL-40.20 | 7/19/19 | 821 | 4/20/12 | | |
| BP-9.1 | 1/18/19 | MGS-3.2 | 1/18/13 | MT-98.22 | 1/20/17 | TC-42.20 | 10/18/13 | HL-50.11 | 1/16/15 | 832 | 10/19/18 | | |
| | | MGS-4.2 | 7/19/13 | MT-98.28 | 1/20/17 | TC-52.10 | 10/18/13 | HL-60.11 | 7/21/17 | 872 | 7/19/19 | | |
| HW-1.1 | 7/20/18 | MGS-4.3 | 1/18/13 | MT-98.29 | 1/20/17 | TC-52.20 | 7/20/18 | HL-60.12 | 7/15/16 | 908 | 10/20/17 | | |
| HW-2.2 | 7/20/18 | MGS-5.2 | 7/15/16 | MT-98.30 | 7/21/17 | TC-65.10 | 1/17/14 | HL-60.31 | 1/18/19 | 921 | 4/20/12 | | |
| | | MGS-5.3 | 7/15/16 | MT-99.20 | 4/19/19 | TC-65.11 | 7/21/17 | | | 875 | 1/18/19 | | |
| DM-1.1 | 7/21/17 | | | MT-101.60 | 1/20/17 | TC-71.10 | 1/19/18 | TC-41.10 | 7/19/13 | 813 | 10/19/18 | | |
| DM-4.3 | 1/15/16 | EXJ-2-81 | 7/19/02 | MT-101.70 | 7/20/18 | TC-72.20 | 7/20/18 | | | 825 | 1/18/19 | | |
| DM-4.4 | 1/15/16 | | | MT-101.75 | 7/15/16 | | | | | 913 | 4/21/17 | | |
| | | MT-95.30 | 4/19/19 | MT-101.90 | 7/21/17 | HL-10.11 | 7/19/19 | | | | | | |
| F-2.1 | 7/20/18 | MT-95.40 | 1/20/17 | MT-102.20 | 4/19/19 | HL-10.12 | 1/20/17 | | | | | | |
| F-3.3 | 7/19/13 | MT-95.45 | 4/19/19 | MT-104.10 | 10/16/15 | HL-10.13 | 7/20/18 | | | | | | |
| F-3.4 | 7/19/13 | MT-95.50 | 7/21/17 | MT-105.10 | 7/19/13 | HL-20.11 | 4/21/17 | | | | | | |
| | | MT-97.10 | 4/19/19 | | | HL-30.11 | 7/19/19 | | | | | | |

APPROVED: *[Signature]*
DATE: 11/19/19 DISTRICT DEPUTY DIRECTOR

APPROVED: _____
DATE: _____ DIRECTOR, DEPARTMENT OF TRANSPORTATION

FEDERAL PROJECT NO.
E140837

PID NO.
94123

CONSTRUCTION PROJECT NO.

RAILROAD INVOLVEMENT
ABC RAIL ROAD

SUM / WAY - 21 / 585
0.00 / VAR PART 1

I:\Prj\ojectData\SUM\94123-21-585-P2\Design\Roadway\Sheets\94123-CT001.dgn Sheet 11/19/2019 7:18:42 AM mandrasi

MAINTENANCE OF TRAFFIC

THIS ITEM SHALL CONSIST OF MAINTENANCE OF TRAFFIC ON EXISTING ROADWAYS AND RAMPS IN ACCORDANCE WITH THE OHIO MANUAL OF UNIFORM TRAFFIC CONTROL DEVICES FOR STREETS AND HIGHWAYS, CURRENT EDITION, LATEST REVISION, THE SPECIFICATIONS AND THE FOLLOWING:

1. A MINIMUM OF ONE TWELVE FOOT LANE IN EACH DIRECTION SHALL BE MAINTAINED ON THE EXISTING PAVEMENT OR COMPLETED PAVEMENT DURING CONSTRUCTION OF THE WORK.
2. THE CONTRACTOR SHALL INFORM THE DISTRICT OFFICE (330) 786-2208, EIGHTEEN (18) DAYS PRIOR TO THE BEGINNING OF WORK.
3. LANE RESTRICTIONS OR LANE REDUCTIONS SHALL NOT BE PERMITTED AFTER NORMAL WORKING HOURS. NORMAL WORKING HOURS SHALL BE THOSE HOURS DURING WHICH THE CONTRACTOR HAS A FULL COMPLEMENT OF EMPLOYEES AND EQUIPMENT ACTIVELY REMOVING AND/OR PLACING PAVEMENT MATERIALS.
4. ALL FULL DEPTH PAVEMENT REMOVAL AND REPLACEMENT OPERATIONS SHALL BE COMPLETED THE SAME DAY THE EXCAVATION IS MADE. IF THE CONTRACTOR CANNOT COMPLETE THE WORK, THE EXCAVATION SHALL BE BACKFILLED OR PROTECTED AS PER STANDARD CONSTRUCTION DRAWING MT-101.90.
6. TRUCK MOUNTED ATTENUATORS [TMA'S] SHALL BE USED AS SHOWN IN THE STANDARD CONSTRUCTION DRAWINGS.
7. UNDER NO CIRCUMSTANCES SHALL THE CONTRACTOR BE PERMITTED TO HAVE SUCCESSIVE WORK ZONES UNLESS THE DISTANCE BETWEEN THE DRUMS, BARRICADES OR CONES EXCEEDS ONE [1] MILE .
8. FOR ROUTES NOT ON THE PERMITTED LANE CLOSURE CHART, ONLY DURING OFF-PEAK PERIODS (ie ANY PERIOD OTHER THAN 6-8AM AND 3-6PM) SHALL THE CONTRACTOR INSTALL AND SUBSEQUENTLY RESET ALL TRAFFIC CONTROL NECESSARY FOR THE WORK ZONE FOR EACH CONSTRUCTION PHASE.
9. IN ADDITION TO THE REQUIREMENTS OF 614.11 WORK ZONE PAVEMENT MARKINGS, AT THE END OF EACH DAY OF WORK, THE CONTRACTOR SHALL REPLACE (WITH WORK ZONE MARKINGS) ALL LANE, CENTER, STOP OR CHANNELIZING LINES THAT WERE REMOVED OR COVERED DURING THE PAVEMENT REMOVAL OR PLACEMENT OPERATIONS. QUANTITIES FOR SUCH PLACEMENT ARE CARRIED AS PART OF THE ITEMS LISTED UNDER 614 WORK ZONE PAVEMENT MARKINGS.
10. A QUANTITY OF 15 CU. YDS. OF ITEM 614 ASPHALT CONCRETE FOR MAINTAINING TRAFFIC SHALL BE PROVIDED FOR USE IN MAINTAINING PAVEMENT, SHOULDERS AND OTHER LOCATIONS AS DIRECTED BY THE ENGINEER.
11. PRIOR TO OPENING TO TRAFFIC EACH LANE SHALL BE IN A SAFE, PASSABLE CONDITION. ALL TRANSVERSE JOINTS SHALL EXTEND ACROSS THE FULL LANE AND SHOULDER WIDTH AND EACH LANE SHALL BE FREE FROM UNEVEN LONGITUDINAL JOINTS. THE CONTRACTOR SHALL PROVIDE ASPHALT WEDGES FOR TRANSVERSE JOINTS WHEREVER THERE ARE PAVEMENT ELEVATION DIFFERENCES.

12. THE CONTRACTOR SHALL PLACE THE SIGNS: W8-1 [BUMP] PER OMUTCD 2C.28; W8-11 [UNEVEN LANES] PER OMUCTD 6F.45; AND W6-3 [TWO-WAY TRAFFIC] PER OMUTCD 6F.32. PAYMENT FOR THESE SIGNS SHALL BE INCIDENTAL TO THE LUMP SUM ITEM 614-MAINTAINING TRAFFIC. A QUANTITY OF ITEM 614 WORK ZONE MARKING SIGNS HAS BEEN INCLUDED IN THE PLANS PER CMS 614.04.

13. THE CONTRACTOR SHALL SET A WORK ZONE AT THE REQUEST OF THE ENGINEER TO ALLOW THE LAYOUT OF THE PARTIAL/FULL DEPTH PAVEMENT REPAIR AREAS. THIS WORK IS INCIDENTAL TO ITEM 614 MAINTAINING TRAFFIC.

THE FOLLOWING QUANTITIES SHALL BE USED FOR THE MAINTENANCE OF TRAFFIC ON THIS PROJECT:

PHASE I - PLANED SURFACE

- 614, WORK ZONE CENTER LINE, CLASS I, 0.06 MILE
- 614, WORK ZONE LANE LINE, CLASS I, 6", 12.77 MILE
- 614, WORK ZONE STOP LINE, CLASS I, 263 FT
- 614, WORK ZONE CHANNELIZING LINE, 12", CLASS I, 9480 FT
- 614, WORK ZONE MARKING SIGN, 60 EACH (ALL PHASES)

PHASE II - SURFACE COURSE

- 614, WORK ZONE CENTERLINE, CLASS III, 642 PAINT 0.06 MILE
- 614, WORK ZONE LANE LINE, CLASS III, 6", 642 PAINT 12.77 MILE
- 614, WORK ZONE STOP LINE, CLASS III, 642 PAINT 263 FT
- 614, WORK ZONE CHANNELIZING LINE, CLASS III, 12", 642 PAINT 9480 FT

TO BE USED AS DIRECTED BY THE ENGINEER

- 614, WORK ZONE EDGE LINE, CLASS III, 642 PAINT, 30.76 MILE

TRAFFIC CONTROL INSPECTOR

THE CONTRACTOR SHALL DESIGNATE AN INDIVIDUAL OTHER THAN THE SUPERINTENDENT AND SUBJECT TO THE APPROVAL OF THE ENGINEER, TO CONTINUOUSLY INSPECT ALL TRAFFIC CONTROL DEVICES WHENEVER CONSTRUCTION WORK IS BEING PERFORMED WITHIN THE WORK LIMITS OF THE PROJECT. THE DESIGNATED INDIVIDUAL SHALL ALSO INSPECT ALL TRAFFIC DEVICES AT THE BEGINNING AND AT THE END OF EACH WORK DAY. THE DESIGNATED INDIVIDUAL OR A QUALIFIED REPRESENTATIVE SHALL ALSO BE AVAILABLE ON AN AROUND THE CLOCK BASIS TO REPAIR AND/OR REPLACE DAMAGED OR MISSING TRAFFIC CONTROL DEVICES. THESE INDIVIDUALS SHALL BE EQUIPPED WITH CELLULAR PHONES AND THEIR NAMES AND PHONE NUMBERS SHALL BE GIVEN TO THE PROJECT ENGINEER AT THE PRE-CONSTRUCTION MEETING. THE DESIGNATED INDIVIDUAL SHALL HAVE NO OTHER CONSTRUCTION RELATED DUTIES. PAYMENT FOR THE SERVICES OF THE TRAFFIC CONTROL INSPECTOR SHALL BE INCLUDED IN THE LUMP SUM PRICE BID FOR ITEM 614 MAINTAINING TRAFFIC.

ADVANCED NOTICE TO PAVE

THE CONTRACTOR SHALL SUBMIT FOR APPROVAL TO THE DISTRICT CONSTRUCTION ENGINEER A DETAILED SCHEDULE 15 DAYS PRIOR TO THE PLACEMENT OF THE OVERLAY COURSES, ON HOW THEY PROPOSE TO PROSECUTE THE PAVING OPERATIONS. THE DETAILS SHALL SHOW THE ORDER OF PERFORMANCE OF EACH STAGE (START TO FINISH) OF THE WORK INCLUDING THE MAINTENANCE OF TRAFFIC THAT WILL BE USED.

TIME LIMITATION, TRAFFIC ON A MILLED SURFACE

THE MAXIMUM ALLOWABLE TIME FOR TRAFFIC TO BE PLACED ON A MILLED SURFACE SHALL BE 7 CONSECUTIVE CALENDAR DAYS. SHOULD THE CONTRACTOR FAIL TO MEET THIS REQUIREMENT, THE CONTRACTOR SHALL BE ASSESSED A DISINCENTIVE IN THE AMOUNT OF \$3,000 PER DAY THAT THE TRAFFIC IS PLACED ON A MILLED SURFACE BEYOND THE SPECIFIED LIMIT.

LANE CLOSURES (SR-21, IR-76)

DURATION OF LANE CLOSURES AND RESTRICTIONS SHALL BE AS PER THE PERMITTED LANE CLOSURE CHART. THE PERMITTED LANE CLOSURE CHART USED FOR THIS PROJECT SHALL BE THE MOST CURRENT CHART AVAILABLE ON THE DATE THIS PROJECT SELLS.

THE CHART CAN BE FOUND AT:

<http://plcm.dot.state.oh.us>

SHOULD THE CONTRACTOR FAIL TO MEET ANY OF THE REQUIREMENTS IN THE CHART, THE CONTRACTOR SHALL BE ASSESSED DISINCENTIVES IN THE AMOUNT OF \$3000 PER HOUR OR PORTION THEREOF THAT THE LANE REDUCTION REMAINS BEYOND THE SPECIFIED LIMIT.

TEMPORARY PAVEMENT WEDGES

TEMPORARY PAVEMENT WEDGES SHALL BE PROVIDED AT ALL TIMES WHERE TRAFFIC IS REQUIRED TO TRAVEL FROM OR ONTO A SURFACE OF A DIFFERENT ELEVATION IN THE DIRECTION OF TRAVEL (JOINTS, MANHOLES, CATCH BASINS, VALVE BOXES, MONUMENT BOXES, ETC.). THE TAPER RATE OF THE TEMPORARY PAVEMENT WEDGES SHALL BE AS PER THE REQUIREMENTS IN THE CHART BELOW. TEMPORARY PAVEMENT WEDGES SHALL BE REMOVED PRIOR TO PLACING THE SPECIFIED PAVEMENT COURSE. PAYMENT FOR THIS WORK SHALL BE CONSIDERED INCIDENTAL TO THE LUMP SUM BID ITEM FOR ITEM 614 - MAINTAINING TRAFFIC.

| SPEED | LESS THAN 45 MPH | DURATION | |
|-------|-------------------|----------------|------------------|
| | | 7 DAYS OR LESS | MORE THAN 7 DAYS |
| | 45 MPH OR GREATER | 36:1 | 60:1 |
| | | 60:1 | 120:1 |

NOTIFICATION OF TRAFFIC RESTRICTIONS

THROUGHOUT THE DURATION OF THE PROJECT, THE CONTRACTOR SHALL NOTIFY THE PROJECT ENGINEER IN WRITING OF ALL TRAFFIC RESTRICTIONS AND UPCOMING MAINTENANCE OF TRAFFIC CHANGES. THE CONTRACTOR SHALL ENSURE THE WRITING OF ALL TRAFFIC RESTRICTIONS AND UPCOMING MAINTENANCE OF TRAFFIC CHANGES. THE CONTRACTOR SHALL ENSURE THE WRITTEN NOTIFICATION IS SUBMITTED IN A TIMELY MANNER TO ALLOW THE PROJECT ENGINEER TO MEET THE REQUIRED TIME FRAMES SET FORTH IN THE TABLE BELOW TO INFORM THE SPECIAL HAULING PERMITS SECTION (HAULING.PERMITS@DOT.OHIO.GOV) AND THE DISTRICT PUBLIC INFORMATION OFFICE (PIO). THIS NOTIFICATION SHALL BE RECEIVED BY THE PROJECT ENGINEER PRIOR TO THE PHYSICAL SETUP OF ANY APPLICABLE SIGNS OR MESSAGE BOARDS.

INFORMATION SHOULD INCLUDE, BUT IS NOT LIMITED TO, ALL CONSTRUCTION ACTIVITIES THAT IMPACT OR INTERFERE WITH TRAFFIC AND SHALL LIST THE SPECIFIC LOCATION, TYPE OF WORK, ROAD STATUS, DATE AND TIME OF RESTRICTION, DURATION OF RESTRICTION, NUMBER OF LANES MAINTAINED, NUMBER OF LANES CLOSED, MINIMUM VERTICAL CLEARANCE, MINIMUM WIDTH OF DRIVABLE PAVEMENT, DETOUR ROUTES, IF APPLICABLE, AND ANY OTHER INFORMATION REQUESTED BY THE PROJECT ENGINEER.

| NOTIFICATION TIME TABLE | | |
|--|------------------------|--|
| ITEM | DURATION OF CLOSURE | NOTICE DUE TO PERMITS & PIO |
| ROAD & RAMP CLOSURES | >= 2 WEEKS | 21 CALENDAR DAYS PRIOR TO CLOSURE |
| | > 12 HOURS & < 2 WEEKS | 14 CALENDAR DAYS PRIOR TO CLOSURE |
| | < 12 HOURS | 4 BUSINESS DAYS PRIOR TO CLOSURE |
| LANE CLOSURES & RESTRICTIONS | >= 2 WEEKS | 14 CALENDAR DAYS PRIOR TO CLOSURE |
| | < 2 WEEKS | 2 BUSINESS DAYS PRIOR TO CLOSURE |
| START OF CONSTRUCTION & TRAFFIC PATTERNS CHANGES | N/A | 14 CALENDAR DAYS PRIOR TO IMPLEMENTATION |

ANY UNFORESEEN CONDITIONS NOT SPECIFIED IN THE PLANS REQUIRING TRAFFIC RESTRICTIONS SHALL ALSO BE REPORTED TO THE PROJECT ENGINEER USING THE NOTIFICATION TIME TABLE.

ITS MESSAGE BOARDS

THE EXISTING ITS MESSAGE BOARDS IN THE VICINITY OF THE PROJECT WILL BE UTILIZED TO PROVIDE SUPPLEMENTAL INFORMATION TO THE TRAVELING PUBLIC. THE CONTRACTOR WILL NOTIFY THE PROJECT ENGINEER ONE [1] WEEK IN ADVANCE OF ANY PHASE CHANGE ON SR 21 OR IR 76 . THE PROJECT ENGINEER WILL COORDINATE WITH RAY MARSCH AT 330-786-2208 TO GET THE ITS MESSAGE BOARDS ADJUSTED.

I:\ProjectData\SUM\94123_2L\583_P2\Design\Roadway\Sheets\94123_MN001.dgn_Sheet_1 2/21/2020 10:07:54 AM brossi

STRUCTURE PROPOSED WORK TABLE

| BRIDGE NUMBER | SFN | FEATURE INTERSECTED | DECK SEALING | DECK PATCHING (CONCRETE) | CONCRETE PATCHING (NON-DECK) | EPOXY URETHANE SEALING OF CONCRETE SURFACES | APPROACH GUARDRAIL WORK | EROSION / SCOUR / SLOPE PROTECTION REPAIR | FIELD PAVING PIPE INVERT | APPROACH ASPHALT RESURFACING | CLEARING & GRUBBING | NEW STRUCTURE ID SIGNS | OTHER WORK |
|---------------|---------|--------------------------|--------------|--------------------------|------------------------------|---|-------------------------|---|--------------------------|------------------------------|---------------------|------------------------|------------|
| SUM-21-0028L | 7701055 | OVER SUM SR-585 | X | | SUB | SUB; PARA | | | | | X | X | |
| SUM-21-0030R | 7701144 | OVER SUM SR-585 | X | | SUB | SUB; PARA | FR | | | | X | X | |
| SUM-21-0181L | 7701209 | OVER DOROTHY ST & ABC RR | X | X | SUB | SUB; PARA | RL | | | | X | X | EXP JNT |
| SUM-21-0181R | 7701233 | OVER DOROTHY ST & ABC RR | X | X | SUB; PARA | SUB; PARA | FR | | | | X | X | |
| SUM-21-0207 | 7701268 | UT TO HUDSON CREEK | | | | | | X | X | | X | X | |
| SUM-21-0274 | 7701322 | HUDSON CREEK | | | | | | | X | | X | X | CHANNEL |
| SUM-21-0814 | 7701713 | PIGEON CREEK | | | | | | X | | | X | X | |
| SUM-21-0863 | 7701748 | UNDER RIDGEWOOD RD | | | | SUB; PARA; ABUT; PIER | | | | | X | | |
| SUM-76-0010 | 7704860 | UNDER MEDIANA LINE ROAD | X | X | | | RR, RL | | | | X | X | |
| SUM-76-0109 | 7704925 | UNDER HAMETOWN ROAD | | | | | F, R | | | X | X | X | SPALL |
| SUM-76-0128 | 7705018 | OVER SUM SR-21 | X | | | | | | | | X | X | |
| SUM-76-0263 | 7705078 | UNDER CLEVE-MASS ROAD | X | | | | | | | | X | X | |
| SUM-76-0416 | 7705132 | OVER BARBER ROAD | X | | | | | | | | X | X | |
| SUM-76-0427 | 7705191 | OVER WOLF CREEK | X | | | | | | | | X | X | |
| SUM-261-0135 | 7708467 | OVER SUM SR-21 | X | | | | | | | X | X | X | |
| SUM-585-0062 | 7710895 | UNDER HAMETOWN ROAD | X | X | | | | | | | X | X | |
| SUM-585-0107 | 7710992 | RAMP A OVER WOOSTER ROAD | X | X | SUB; PARA | SUB; PARA | FR, FL, RL | | | | X | X | |

DECK SEALING

- SEAL EXISTING WEARING SURFACE AND APPROACH SLABS WITH GRAVITY FED RESIN CONCRETE TREATMENT.

DECK PATCHING (CONCRETE)

- REPAIR VISIBLY UNSOUND OR PREVIOUSLY PATCHED AREAS OF THE EXISTING DECK AND APPROACH SLAB.

CONCRETE PATCHING (NON-DECK)

- PATCH ALL UNSOUND AREAS AT THE LOCATIONS NOTED IN THE STRUCTURE PROPOSED WORK TABLE.
- SEAL ALL REPAIRED AREAS WITH EPOXY URETHANE.

SUB - SUBSTRUCTURE

PARA - PARAPETS

ABUT - ABUTMENTS

WW - WINGWALL

PIER - PIERS

EPOXY SEALING OF CONCRETE

- REMOVE EXISTING SEALER IF PRESENT AND SEAL THE EXPOSED CONCRETE SURFACES WITH WITH EPOXY URETHANE CONCRETE SEALER. SEE SHEETS 7/9 FOR DETAILS.

APPROACH GUARDRAIL WORK

- REPAIR DAMAGED APPROACH GUARDRAIL AT THE LOCATIONS DESCRIBED IN THE STRUCTURE PROPOSED WORK TABLE

F - FORWARD

FR - FORWARD RIGHT

FL - FORWARD LEFT

R - REAR

RR - REAR RIGHT

RL - REAR LEFT

EROSION/SCOUR/SLOPE PROTECTION REPAIR

- REPAIR EROSION AT THE LOCATION DESCRIBED IN THE STRUCTURE PROPOSED WORK TABLE AND IN THE EROSION REPAIR NOTE ON SHEET 2/9

FIELD PAVING PIPE INVERT

-PAVE EXISTING INVERT WITH CONCRETE

APPROACH ASPHALT RESURFACING

-RESURFACE 50' (SUM-76-0109) / 160' SUM-261-0135 OF THE FORWARD AND REAR APPROACH ASPHALT CONCRETE (SEE SHEET 18/30)

CLEARING AND GRUBBING

-CLEARING AND GRUBBING 15' AROUND THE STRUCTURE TO REMOVE VEGETATION.

NEW STRUCTURE ID SIGNS

-PROVIDE NEW AND CORRECT STRUCTURE IDENTIFICATION SIGNS

OTHER WORK:

SUM-21-0181L

-REMOVE AND REPLACE THE EXISTING FORWARD AND REAR EXPANSION JOINT GLAND.

SUM-21-0274

-CHANNEL CLEANOUT

SUM-76-0109

-REMOVE ALL SPALLED AREAS OF THE DECK FLOOR AND SEAL WITH EPOXY URETHANE.

STANDARD DRAWINGS AND SUPPLEMENTAL SPECIFICATIONS

REFER TO THE FOLLOWING STANDARD BRIDGE DRAWING(S):
EXJ-2-81 DATED (REVISED) 7/19/02

DESIGN SPECIFICATIONS

THIS STRUCTURE CONFORMS TO THE "LRFD BRIDGE DESIGN SPECIFICATIONS" ADOPTED BY THE AMERICAN ASSOCIATION OF STATE HIGHWAY AND TRANSPORTATION OFFICIALS, 17TH EDITION, INCLUDING THE 2002 INTERIM SPECIFICATIONS AND THE ODOT BRIDGE DESIGN MANUAL, 2007.

EXISTING STRUCTURE VERIFICATION

DETAILS AND DIMENSIONS SHOWN ON THESE PLANS PERTAINING TO THE EXISTING STRUCTURE HAVE BEEN OBTAINED FROM PLANS OF THE EXISTING STRUCTURE AND FROM FIELD OBSERVATIONS AND MEASUREMENTS. CONSEQUENTLY, THEY ARE INDICATIVE OF THE EXISTING STRUCTURE AND THE PROPOSED WORK BUT THEY SHALL BE CONSIDERED TENTATIVE AND APPROXIMATE. THE CONTRACTOR IS REFERRED TO CMS SECTIONS 102.05, 105.02 AND 513.04.

BASE CONTRACT BID PRICES UPON A RECOGNITION OF THE UNCERTAINTIES DESCRIBED ABOVE AND UPON A PREBID EXAMINATION OF THE EXISTING STRUCTURE. HOWEVER, THE DEPARTMENT WILL PAY FOR ALL PROJECT WORK BASED UPON ACTUAL DETAILS AND DIMENSIONS WHICH HAVE BEEN VERIFIED IN THE FIELD.

CLEARING AND GRUBBING

ALTHOUGH THERE ARE NO TREES OR STUMPS SPECIFICALLY MARKED FOR REMOVAL WITHIN THE LIMITS OF THE PROJECT, A LUMP SUM QUANTITY IS INCLUDED IN THE ESTIMATED QUANTITIES FOR ITEM 201, CLEARING AND GRUBBING. ALL PROVISIONS AS SET FORTH IN THE SPECIFICATIONS UNDER THIS ITEM ARE INCLUDED IN THE LUMP SUM PRICE BID FOR ITEM 201, CLEARING AND GRUBBING.

DESIGN AGENCY
ODOT --- DISTRICT 4
PLANNING AND ENGINEERING

DATE
MM/DD/YY
XXX
STRUCTURE FILE NUMBER
00000

DRAWN
XXX
REVIEWED
XXX

DESIGNED
BFR
CHECKED
MJA

STRUCTURE GENERAL NOTES

SUM SR-21: 0028L, 0030R, 0181L&R, 0207, 0274, 0814
SUM IR-76: 0010, 0109, 0128, 0207, 0274, 0814
SUM SR-585: 0062, 0107

SUM / WAY - 21 / 585 -
0.00 / VAR PART 1
PID No. 94123

1 / 9

23
31

I:\ProjectData\SUM\94123_2L_583_P2\Design\Structures\SUM02L_0028L_Sheets\02L_0028L_S0001.dgn Sheet 1 2/21/2020 10:22:58 AM brossi

CALC: BFR DATE: 9/5/2019
 CHECKED: DATE:

| ESTIMATED QUANTITIES | | | | | | | | | | | | | |
|--------------------------------------|--------------------------------------|--------------------------------------|--------------------------------------|-------------------------------------|-------------------------------------|-------------------------------------|-------------------------------------|-------------------------------------|---------|-----------|------|---|-----------|
| BRIDGE NO. / STRUCTURE FILE NO. | | | | | | | | | | | | | |
| SUM-21-0028L 7701055 03/NHS/BR | SUM-21-0030R 7701144 03/NHS/BR | SUM-21-0181L 7701209 03/NHS/BR | SUM-21-0181R 7701233 03/NHS/BR | SUM-21-0207 7701268 03/NHS/BR | SUM-21-0274 7701322 03/NHS/BR | SUM-21-0814 7701713 04/NHS/BR | SUM-21-0863 7701748 03/NHS/BR | SUM-76-0010 7704860 01/IMS/BR | ITEM | EXTENSION | UNIT | DESCRIPTION | SEE SHEET |
| LS | LS | LS | LS | LS | LS | LS | LS | LS | 201 | 11000 | | CLEARING AND GRUBBING | |
| | 62.5 | 125 | 125 | | | | | 50 | 202 | 38000 | FT | GUARDRAIL REMOVED | |
| | | | | 584 | 452 | | | | SPECIAL | 20270130 | FT | PIPE CLEANOUT OVER 48" | 2 |
| | | | | | LS | | | | 202 | 98000 | | REMOVAL MISC.:CHANNEL CLEANOUT | 2 |
| | | | | | | 10 | | | 203 | 40000 | CY | BORROW | |
| | | | | LS | LS | | | | 503 | 11100 | | COFFERDAMS AND EXCAVATION BRACING | |
| | | | | | | | 146 | | 512 | 10050 | SY | SEALING OF CONCRETE SURFACES (NON-EPOXY) | |
| 268 | 268 | 252 | 323 | | | | 1102 | | 512 | 10100 | SY | SEALING OF CONCRETE SURFACES (EPOXY-URETHANE) | |
| 1800 | 1400 | 1028 | 1349 | | | | | 1042 | 512 | 73500 | SY | TREATING CONCRETE BRIDGE DECKS WITH GRAVITY FED RESIN | |
| 243 | 243 | 232 | 283 | | | | | 1248 | 512 | 74000 | SY | REMOVAL OF EXISTING COATINGS FROM CONCRETE SURFACES | |
| | | 71 | | | | | | | 516 | 10901 | FT | ELASTOMERIC COMPRESSION SEAL, AS PER PLAN | 2 |
| 200 | 200 | 150 | 300 | | | | | | 519 | 11101 | SF | PATCHING CONCRETE STRUCTURE, AS PER PLAN | 2 |
| | | 6 | 8 | | | | | | 519 | 12304 | SY | PATCHING CONCRETE BRIDGE DECK - TYPE C | |
| | | | | 15 | | 20 | | | 601 | 32100 | CY | ROCK CHANNEL PROTECTION, TYPE B WITH FILTER | |
| | 62.5 | 125 | 125 | | | | | 50 | 606 | 15100 | FT | GUARDRAIL, TYPE MGS WITH LONG POSTS | |
| | | | | 584 | | | | | 611 | 96550 | FT | FIELD PAVING OF EXISTING PIPE (TWIN 12' CMP) | |
| | | | | | 452 | | | | 611 | 96550 | FT | FIELD PAVING OF EXISTING PIPE (15'-10"X9'-10" CMP ARCH) | |
| | | | | 5 | 5 | | | | 613 | 41200 | CY | LOW STRENGTH MORTAR BACKFILL | |
| 21 | 21 | 21 | 21 | 14 | 14 | 14 | | 42 | 630 | 02100 | FT | GROUND MOUNTED SUPPORT, NO. 2 POST | |
| 6 | 6 | 6 | 6 | | | | | 12 | 630 | 80100 | SF | SIGN, FLAT SHEET | |
| 1 | 1 | 1 | 1 | 2 | 2 | 2 | | 2 | 630 | 80100 | SF | SIGN, FLAT SHEET, 730.20 | |
| 3 | 3 | 3 | 3 | 2 | 2 | 2 | | 6 | 630 | 84900 | EACH | REMOVAL OF GROUND MOUNTED SIGN AND DISPOSAL | |
| 2 | 2 | 2 | 2 | 2 | 2 | 2 | | 4 | 630 | 86002 | EACH | REMOVAL OF GROUND MOUNTED POST SUPPORT AND DISPOSAL | |

DESIGN AGENCY: ODOT --- DISTRICT 4
 PLANNING AND ENGINEERING

DATE: MM/DD/YY
 XXX MM/DD/YY
 STRUCTURE FILE NUMBER: 00000

DRAWN: XXX
 CHECKED: XXX

DESIGNED: BFR
 CHECKED: MJA

STRUCTURE ESTIMATED QUANTITIES
 SUM SR-21: 0028L, 0030R, 0181L&R, 0207, 0274, 0814 SUM IR-76: 0010, 0109, 0128,
 SUM IR-76: 0263, 0416, 0427 SUM-261-0135, SUM SR-585: 0062, 0107

SUM / WAY - 21 / 585 -
 0.00 / VAR PART 1
 PID No. 94123

4 / 9

26 / 31

STRUCTURE SUM-21-0207 SITE PLAN

FOR REFERENCE ONLY

NOTE: HISTORICAL PATH OF UT TO HUDSON CREEK SHOWN. CURRENT PATH OF UT TO HUDSON CREEK FLOW THROUGH SUM-21-0207 STRUCTURE

MICROFILMED
JUL 6 1987

Drainage Area 4.0 Square Miles
Estimated Runoff 50 Year Frequency
Q 50 = 2400 Cu. Ft per Sec.
Bridge Upstream of Hametown Rd.
28' span - 9.4' headroom

| FED. RD. DIVISION | STATE | PROJECT | TYPE FUNDS |
|-------------------|-------|-----------|------------|
| 2 | OHIO | F-1010(2) | |

SUM. 21-023

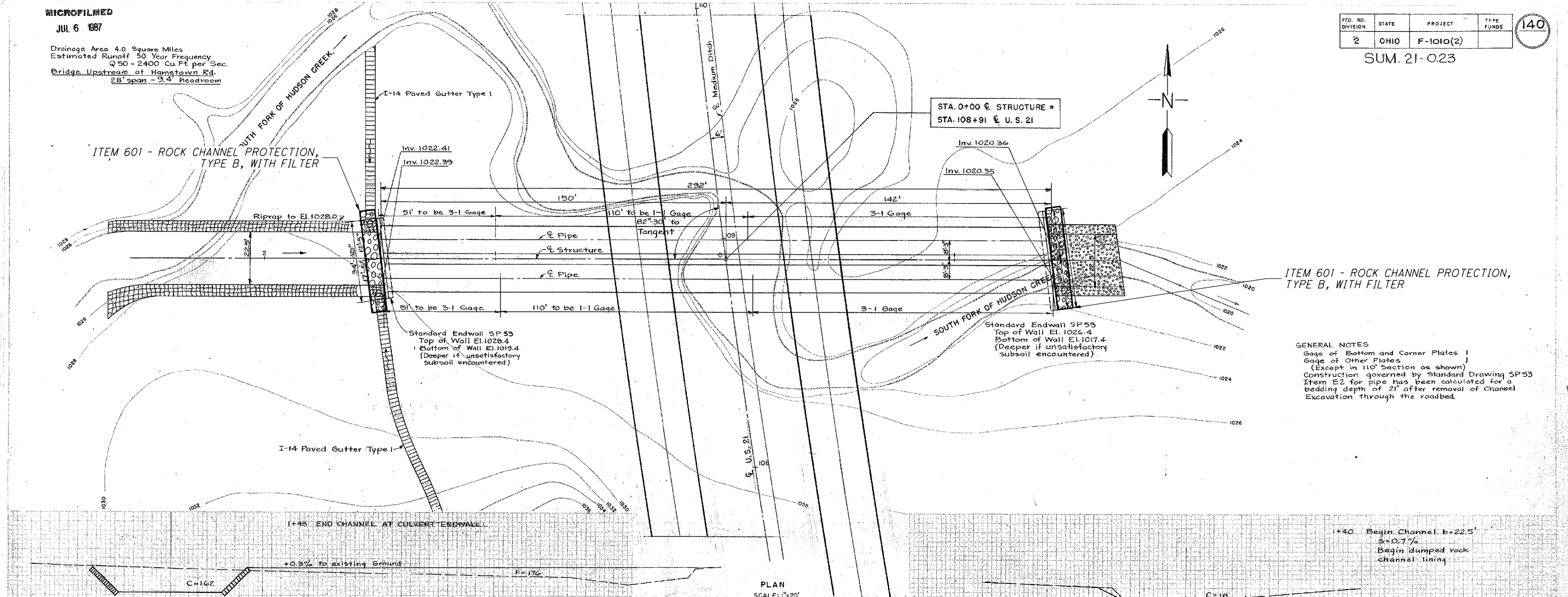

GENERAL NOTES:
Gage of Bottom and Corner Plates & Gage of Other Plates (Except in 110' Section as shown) Construction governed by Standard Drawing SP 53 Item E2 for pipe has been calculated for a bedding depth of 21' after removal of channel excavation through the roadbed.

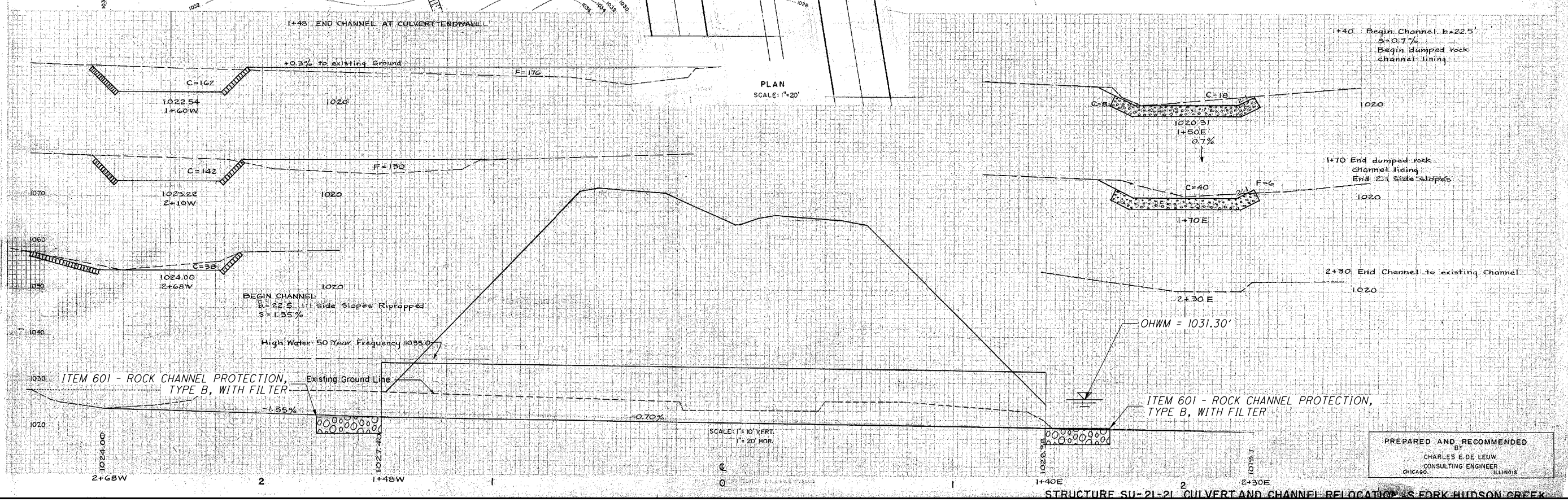

PREPARED AND RECOMMENDED BY
CHARLES E. DE LEUW
CONSULTING ENGINEER
CHICAGO, ILLINOIS

I:\ProjectData\SUM\94123_21_583_P2\Design\Structures\SUM021_00281_Sheets\021_00281_SP001.dgn Sheet 1 2/21/2020 10:23:42 AM crossi

DESIGN AGENCY: ODOT --- DISTRICT 4
PLANNING AND ENGINEERING

DATE: MM/DD/YY
REVIEWED: XXX
DRAWN: XXX
DESIGNED: BFR
CHECKED: MJA

STRUCTURE FILE NUMBER: 7701268
REVISED: XXX

SUMMIT STA. STA.

SITE PLAN
BRIDGE NO: SUM-21-0207
FEATURE INTERSECTED: BRANCH HUDSON CREEK

SUM / WAY - 21 / 585 -
0.00 / VAR PART 1
PID No. 94123

8 / 9

30
31

I:\ProjectData\SUM\94123_2L\583_P2\Design\Structures\SUM02L\0028L_Sheets\02L_0028L_SF001.dgn Copy of Sheet 2 2/21/2020 10:23:38 AM brossi

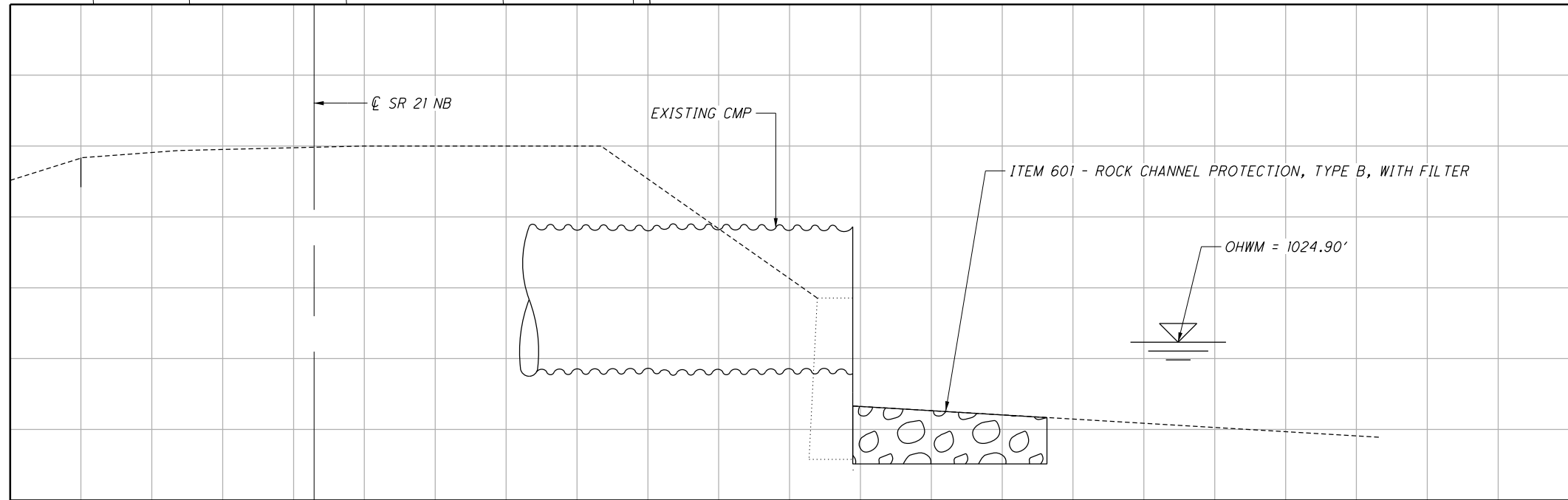
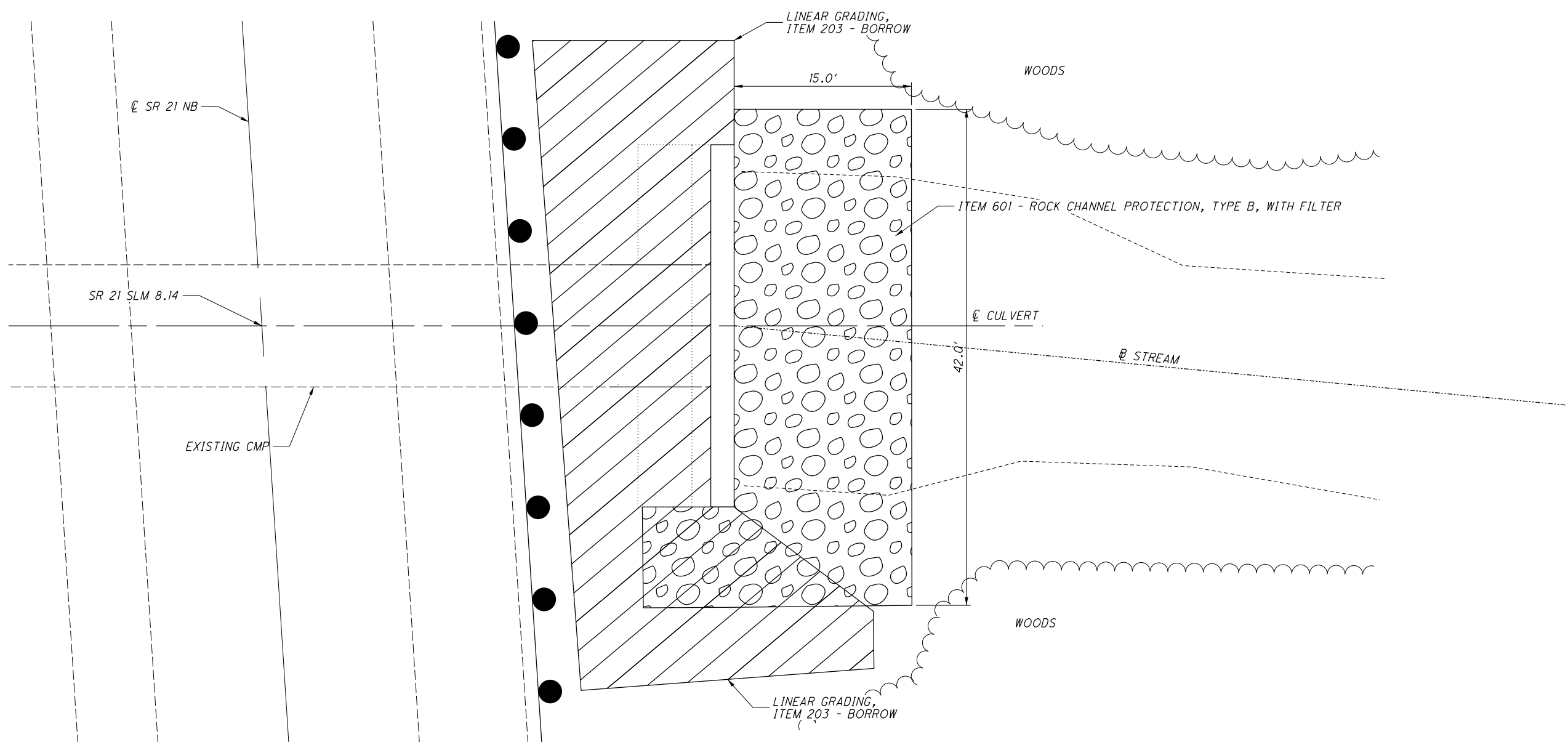

METAL PIPE PROFILE

STRUCTURE
SUM-21-0814
SITE PLAN

| | | | | | | | | |
|--|--|--|------------------------|-----------------------------------|--------------------------------|---|----------------------------|--|
| SUM / WAY - 21 / 585 - 0.00 / VAR PART 1 PID No. 94123 | SITE PLAN BRIDGE NO: SUM-21-0814 FEATURE INTERSECTED: PIGEON CREEK | | SUMMIT STA. STA. | DESIGNED BFR CHECKED MJA | DRAWN XXX REVISED XXX | REVIEWED XXX STRUCTURE FILE NUMBER 7701713 | DATE MM/DD/YY 7/7/13 | DESIGN AGENCY ODOT --- DISTRICT 4 PLANNING AND ENGINEERING |
| | <div style="text-align: center;"> </div> | | | | | | | |

I:\ProjectData\SUM\07165_585_0\00\Design\Roadway\Sheets\07165_IP001.dgn Sheet 2 2/4/2020 10:49:04 AM mandrasi

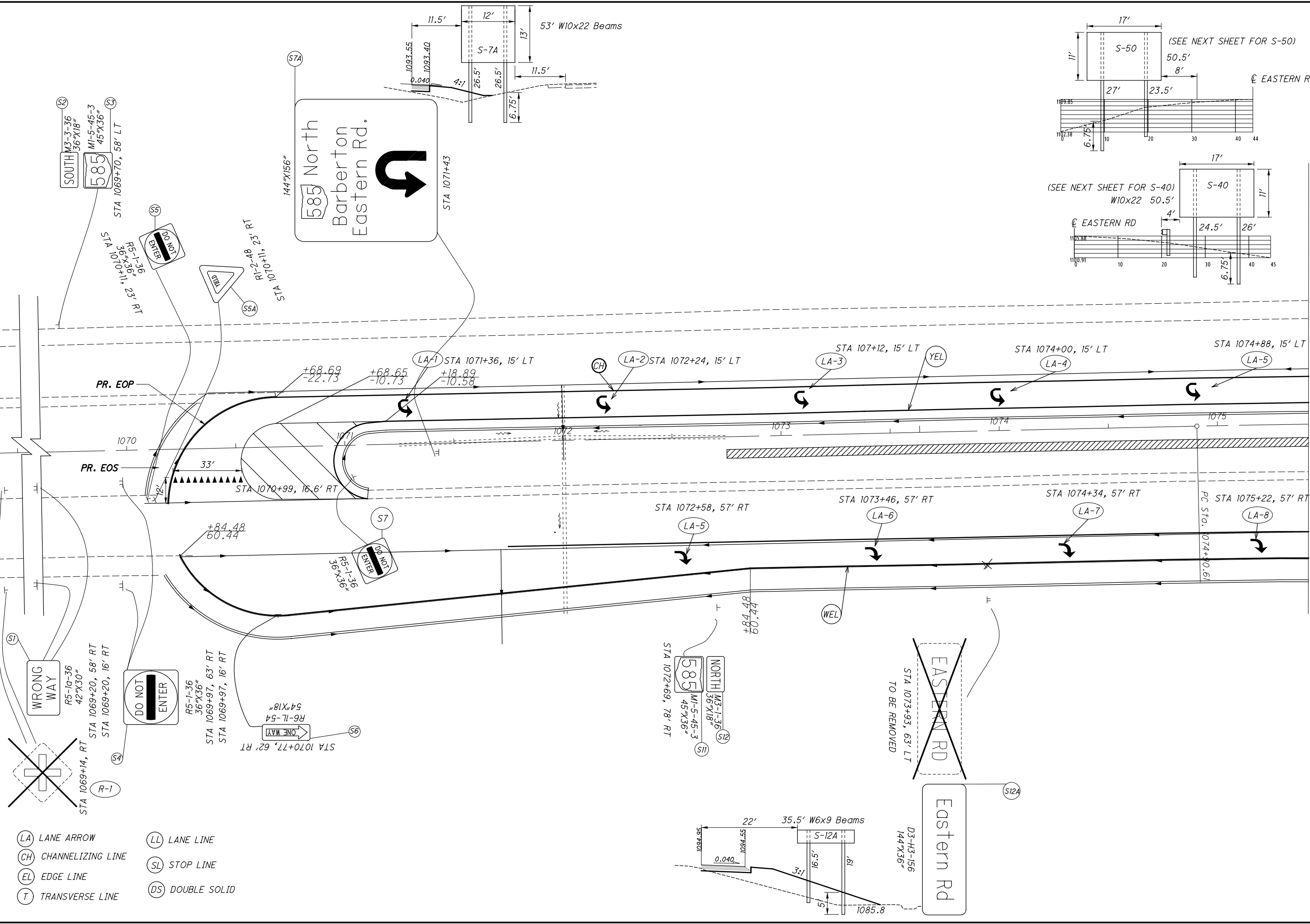

- (LA) LANE ARROW
- (CH) CHANNELIZING LINE
- (EL) EDGE LINE
- (T) TRANSVERSE LINE
- (LL) LANE LINE
- (SL) STOP LINE
- (DS) DOUBLE SOLID

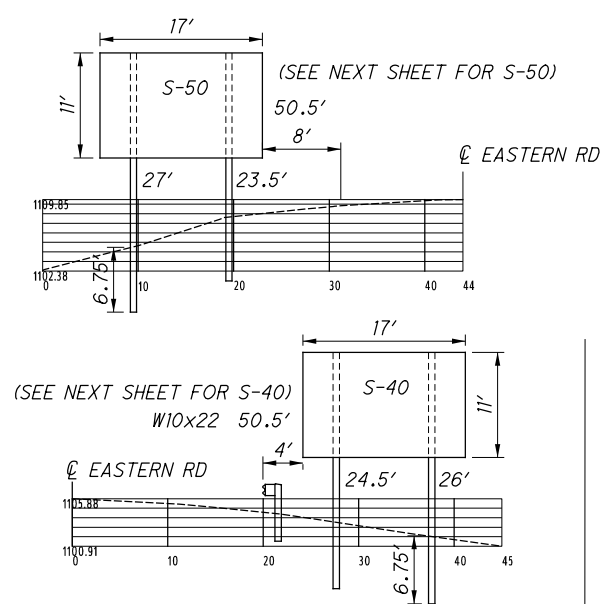

CALCULATED
SAK

CHECKED
RMB

SIGNING PLAN

STA. 1070 TO STA. 1075+50

SUM / WAY -585 -

0.00 / 18.47 PART 2

32
43

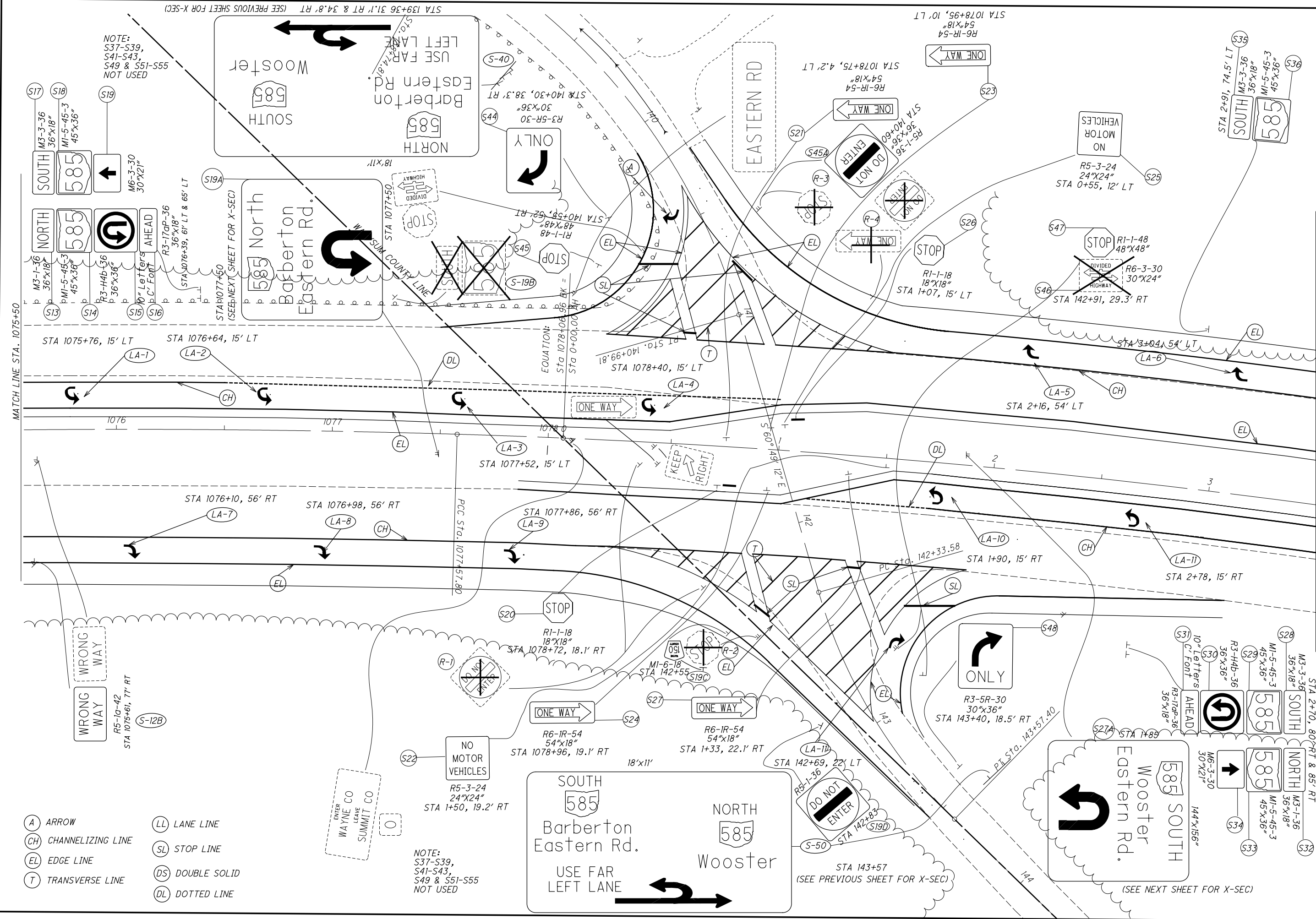

NOTE:
S37-S39,
S41-S43,
S49 & S51-S55
NOT USED

NOTE:
S37-S39,
S41-S43,
S49 & S51-S55
NOT USED

- (A) ARROW
- (CH) CHANNELIZING LINE
- (EL) EDGE LINE
- (T) TRANSVERSE LINE
- (LL) LANE LINE
- (SL) STOP LINE
- (DS) DOUBLE SOLID
- (DL) DOTTED LINE

CALCULATED
SAK
CHECKED
RMB

0 20 40
HORIZONTAL
SCALE IN FEET

SIGNING PLAN
STA. 1075+50 TO STA. 3+50

SUM / WAY - 585 -
0.00 / 18.47 PART 2

I:\ProjectData\SUM\07165_585_0.00\Design\Roadway\Sheets\07165_TP001.dgn Sheet 4 2/4/2020 11:02:45 AM mandrasi

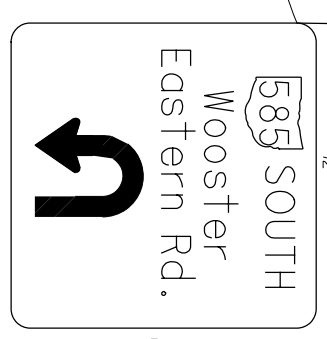
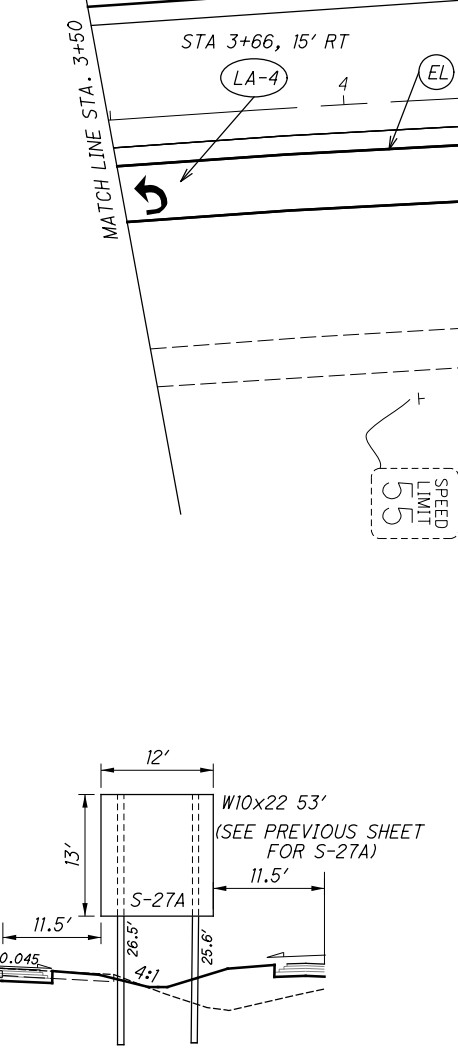
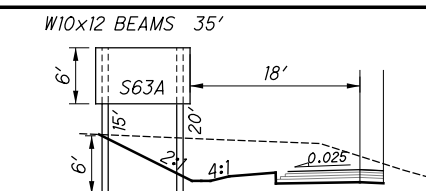
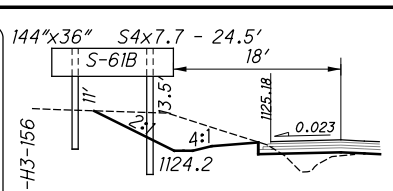
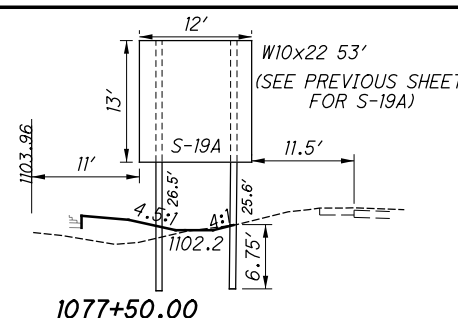
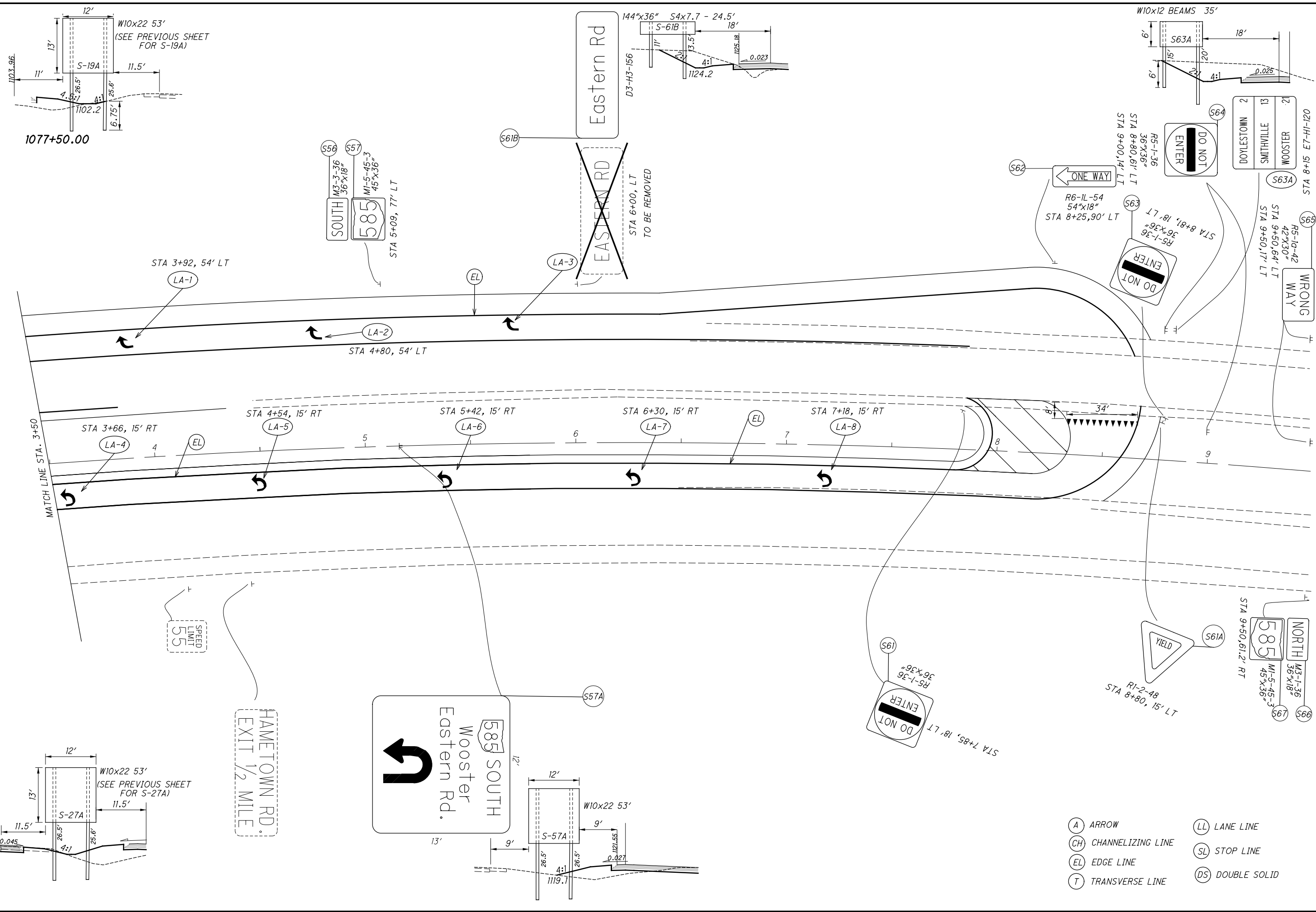

- (A) ARROW
- (CH) CHANNELIZING LINE
- (EL) EDGE LINE
- (T) TRANSVERSE LINE
- (LL) LANE LINE
- (SL) STOP LINE
- (DS) DOUBLE SOLID

SIGNING PLAN
STA. 3+50 TO STA. 9+50

SUM / WAY - 585 -
0.00 / 18.47 PART 2

34
43

CALCULATED: SAK
CHECKED: RMB

HORIZONTAL SCALE IN FEET: 1" = 40'