

No Passing Zone Log (TRU)

Route: 0046R (STRUSR00046**C)
 Length: 26.273 Direction: North

From: 0.000 LEAVE MAH CO
 To: 26.273 ENTER ATB CO

Length	Left	C/L	Right	Length	Control Points	Scale: 1.00 mile/page
0.077	8.925					
	8.848		8.853	0.080	8.856 T1144 ANDERSON LT 8.841 T1144 ANDERSON SPUR LT	
			8.773			
	8.724					
			8.644		8.653 C0363 SQUIRES LANE RT	
0.481					8.518 T1051 OLD FARM TRAIL RT	
					8.481 T0980 FAIRHILL LT	
				0.480		
					8.328 8.326 T1184 DEER CREEK RT	↑ 45mph
	8.243				8.269 T0586 WOODLAND LT	
			8.164		8.240 T0469 DARLINGTON RT	
	8.059					
0.059	8.000					

No Passing Zone Log (TRU)

Route: 0046R (STRUSR00046**C)

From: 0.000 LEAVE MAH CO

Length: 26.273

Direction: North

To: 26.273 ENTER ATB CO

Length	Left	C/L	Right	Length	Control Points	Scale: 0.50 mile/page
	9.500		9.500		9.485 C0158 KING GRAVES RT	
0.420						
				0.498	9.281 T1391 STONECREEK RT	
					9.189 T1212 CARRIAGE HILL RT	
	9.080				9.073 T1149 BROOKWOOD LT	
					9.026 Mile Post = 009	
			9.002			

Route: 0046R (STRUSR00046**C)

Length: 26.273

Direction: North

From: 0.000 LEAVE MAH CO

To: 26.273 ENTER ATB CO

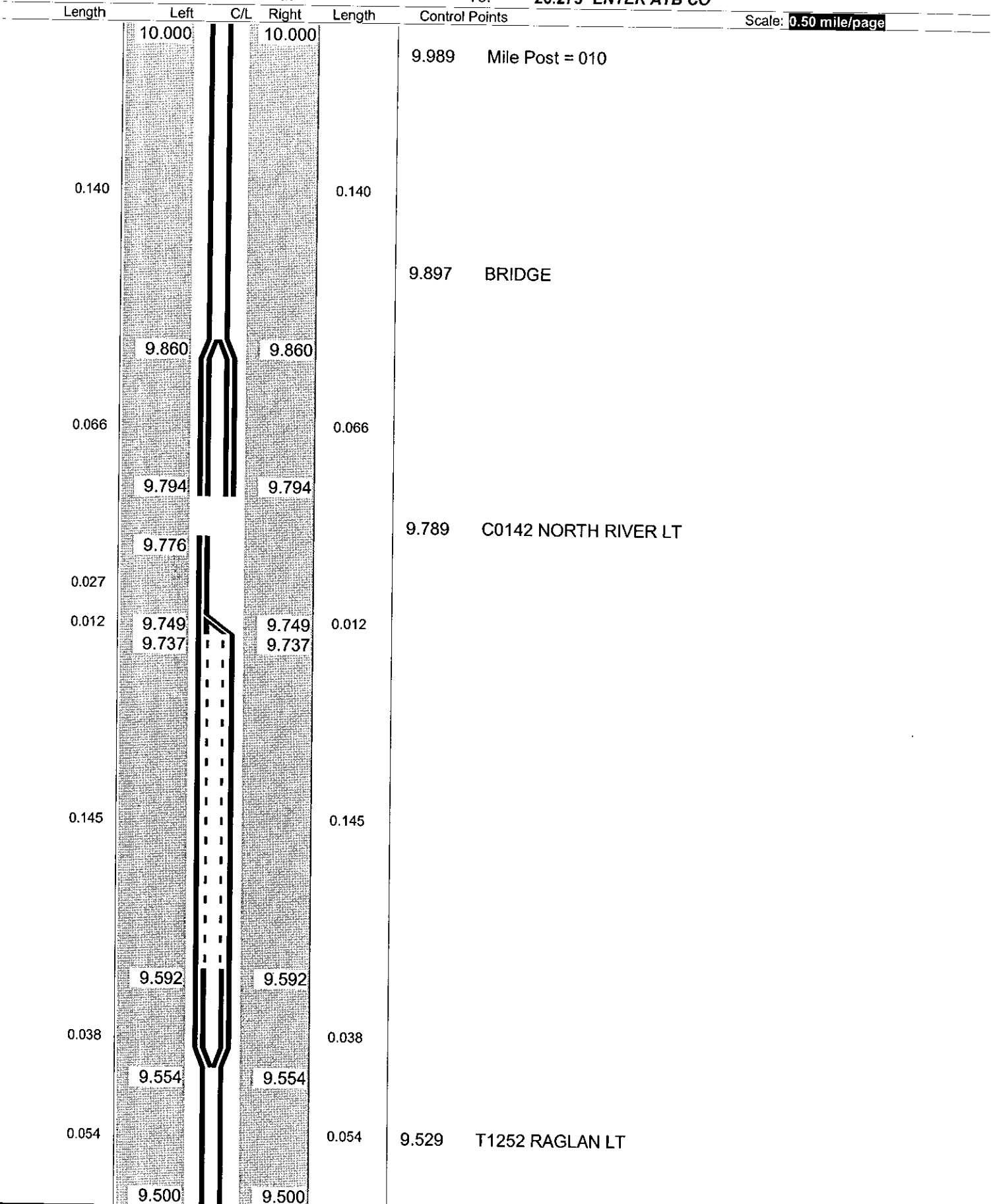

Sheet total equivalent length of solid line: 1.269

Accum. total: 9.380

No Passing Zone Log (TRU)

Route: 0046R (STRUSR00046**C)

From: 0.000 LEAVE MAH CO

Length: 26.273

Direction: North

To: 26.273 ENTER ATB CO

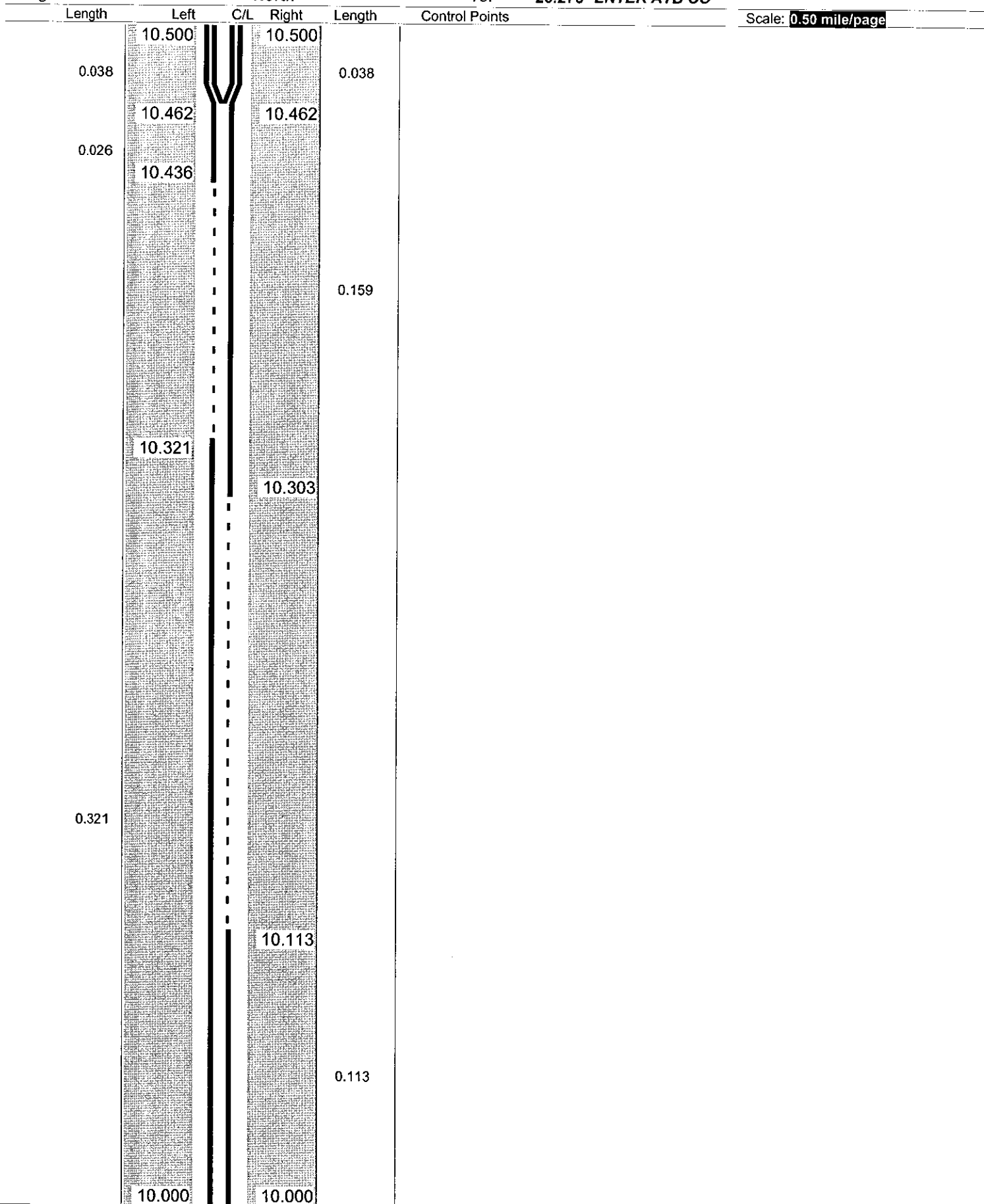

Sheet total equivalent length of solid line: 0.847

Accum. total: 10.227

No Passing Zone Log (TRU)

Route: **0046R (STRUSR00046**C)**

Length: **0.499** Direction: **North**

From: **10.500 LEAVE MAH CO**

To: **10.999 ENTER ATB CO**

11 21

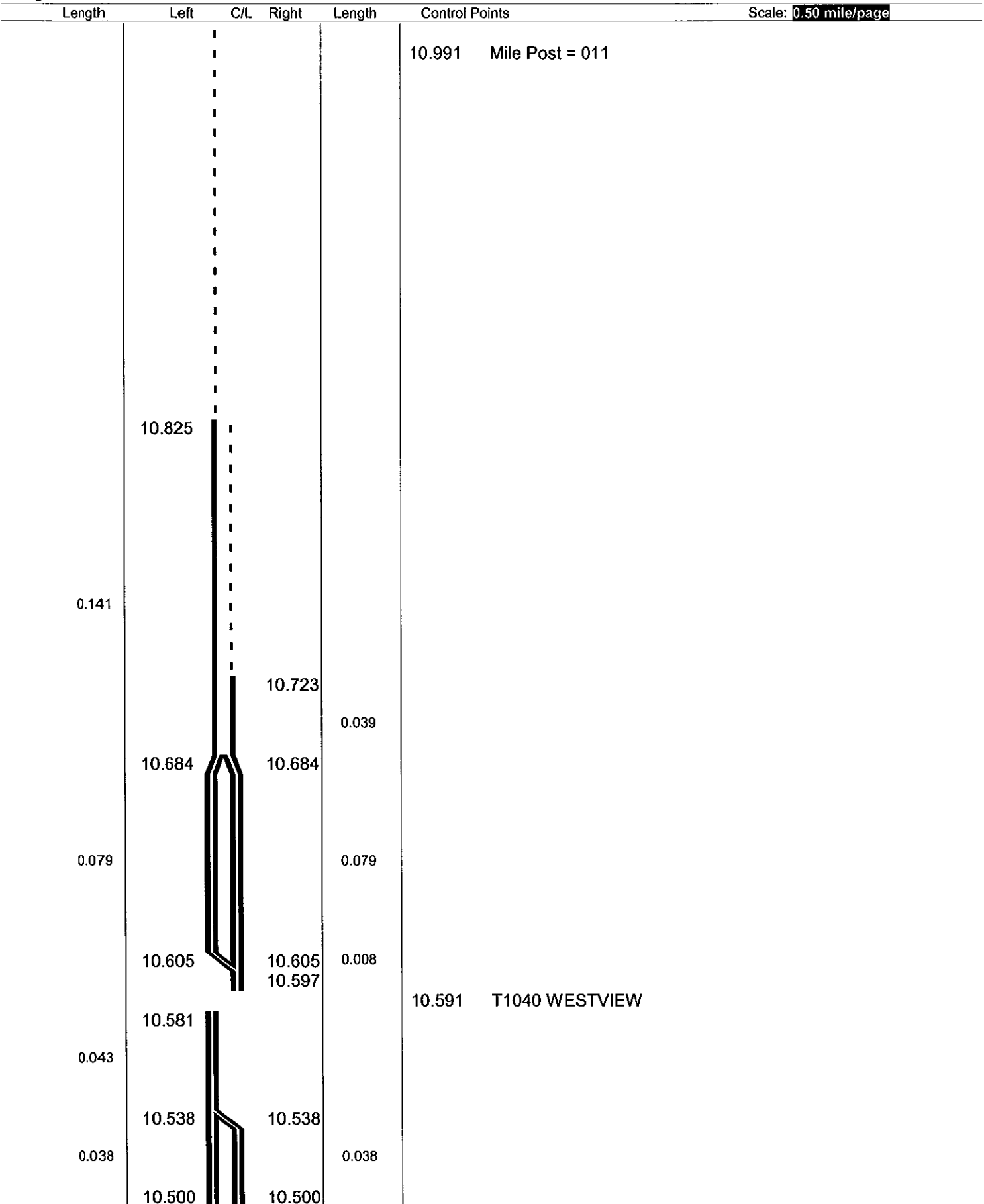

Sheet total equivalent length of solid line: 0.821

Accum. total: 0.821

No Passing Zone Log (TRU)

12-9-7

Route: 0046R (STRUSR00046**C)

From: 11.000 LEAVE MAH CO

Length: 1.000 Direction: North

To: 12.000 ENTER ATB CO

Length	Left	C/L	Right	Length	Control Points	Scale: 1.00 mile/page
			12.000			
				0.075		
			11.925			
			11.645		11.645 T1499 SADDLEBROOK LT	
				0.060		
11.584			11.585			
					11.491 T0141 NORTHVIEW RT	
			11.451			
0.420						
				0.420	11.246 BRIDGE	
11.164					11.173 T0196 CADWALLANDER SONG RT	
					11.096 T0196 CADWALLADER SONK LT	
			11.031			

No Passing Zone Log (TRU)

13 21

Route: 0046R (STRUSR00046**C)

From: 12.000 LEAVE MAH CO

Length: 0.500 Direction: North

To: 12.500 ENTER ATB CO

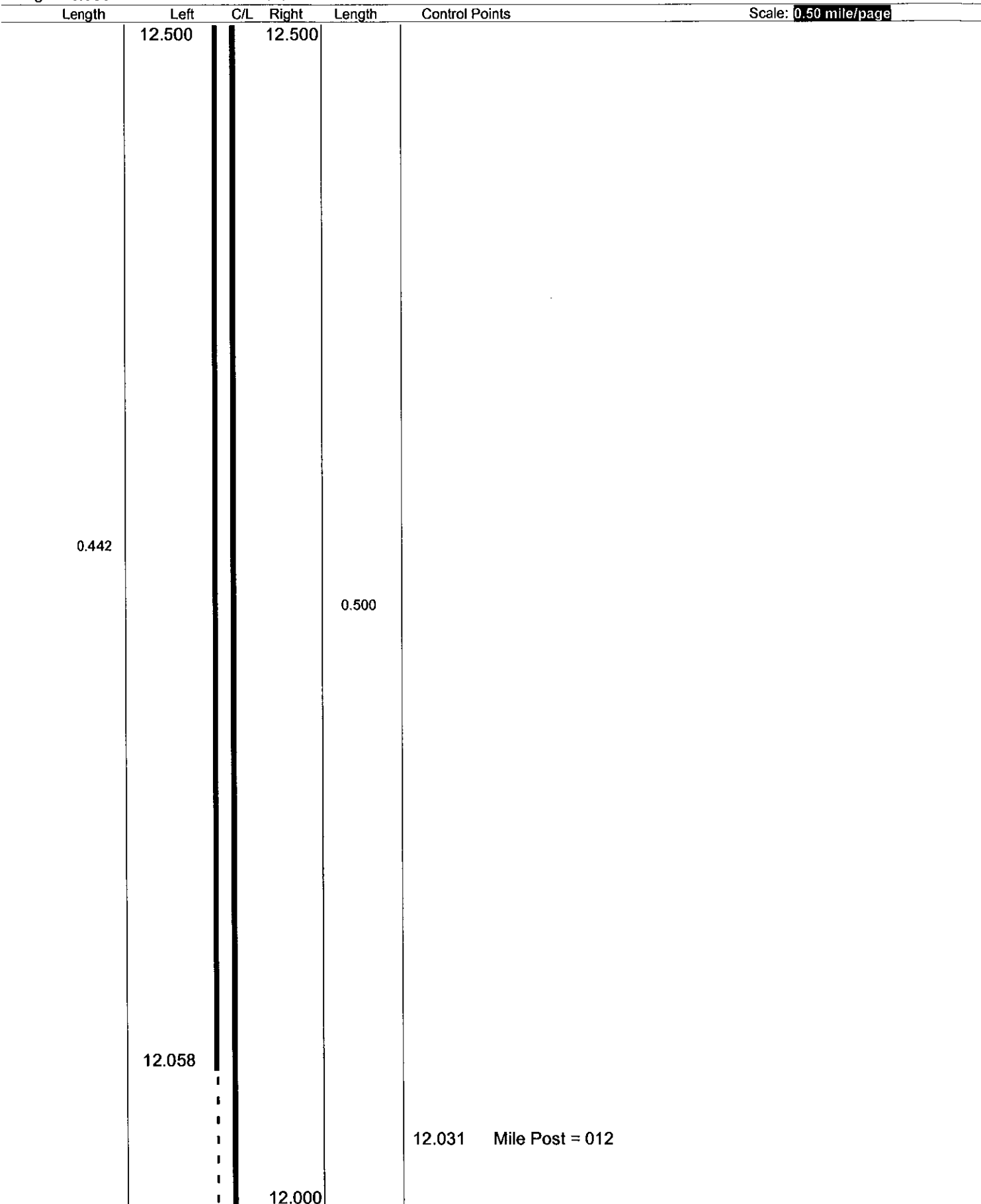

Sheet total equivalent length of solid line: 0.957

Accum. total: 0.957

No Passing Zone Log (TRU)

Route: 0046R (STRUSR00046**C)

From: 0.000 LEAVE MAH CO

Length: 26.273 Direction: North

To: 26.273 ENTER ATB CO

Length	Left	C/L	Right	Length	Control Points	Scale: 0.50 mile/page
	13.000		13.000		12.995 Mile Post = 013	
0.051				0.051		
	12.949		12.949			
0.073				0.073		
	12.876		12.876			
				0.058		
			12.818		12.810 S0305R	
	12.801					
0.038				0.038		
	12.763		12.763			
0.090				0.090		
	12.673		12.673			
			12.666	0.007		
0.173				0.173		
			12.508			
	12.500		12.500	0.008		

No Passing Zone Log (TRU)

Route: 0046R (STRUSR00046**C)

From: 0.000 LEAVE MAH CO

Length: 26.273

Direction: North

To: 26.273 ENTER ATB CO

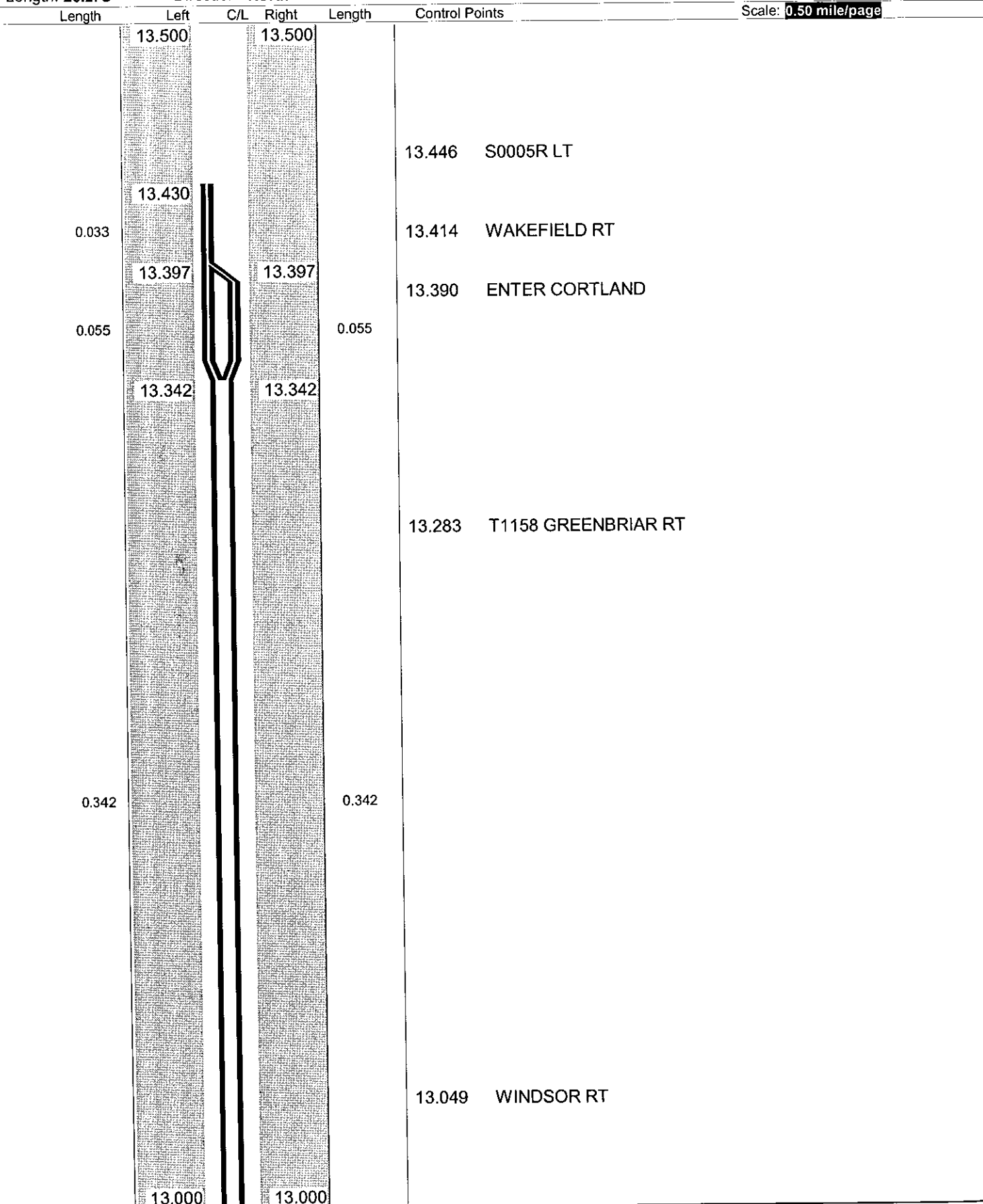

Scale: 0.50 mile/page