

**ROUNDING**

THE ROUNDING AT SLOPE BREAKPOINTS SHOWN ON THE TYPICAL SECTIONS APPLIES TO ALL CROSS-SECTIONS EVEN THOUGH OTHERWISE SHOWN.

**UTILITIES**

LISTED BELOW ARE ALL UTILITIES LOCATED WITHIN THE PROJECT CONSTRUCTION LIMITS TOGETHER WITH THEIR RESPECTIVE OWNERS:

BUCKEYE CABLEVISION  
2700 OREGON RD.  
NORTHWOOD, OH 43519  
419-724-3713

COLUMBIA GAS OF OHIO, INC.  
2901 E. MANHATTAN BLVD.  
TOLEDO, OH 43611  
419-539-6066

CENTURYLINK  
175 ASHLAND RD.  
MANSFIELD, OH 44902  
419-755-7183

FRONTIER COMMUNICATIONS  
300 WEST GYPSY LANE RD.  
BOWLING GREEN, OH 43402  
419-354-9452

HANCOCK-WOOD ELECTRIC COOP.  
P.O. BOX 190  
NORTH BALITMORE, OH 45872  
419-257-5015

NORTH COAST GAS TRANSMISSION  
445 HUTCHINSON AVE. #830  
COLUMBUS, OH 43215  
281-770-3143

NORTHWESTERN WATER & SEWER  
P.O. BOX 348  
BOWLING GREEN, OH 43402  
419-354-9090

TOLEDO EDISON  
6099 ANGOLA RD.  
HOLLAND, OH 43528  
419-249-5218

VILLAGE OF BRADNER  
130 NORTH MAIN ST.  
P.O. BOX 599  
BRADNER, OH 43406  
419-288-2890

**WORK LIMITS**

THE WORK LIMITS SHOWN ON THESE PLANS ARE FOR PHYSICAL CONSTRUCTION ONLY. PROVIDE THE INSTALLATION AND OPERATION OF ALL WORK ZONE TRAFFIC CONTROL AND WORK ZONE TRAFFIC CONTROL DEVICES REQUIRED BY THESE PLANS WHETHER INSIDE OR OUTSIDE THESE WORK LIMITS.

**PROFILE AND ALIGNMENT**

PLACE THE PROPOSED PAVEMENT TO FOLLOW THE ALIGNMENT AND PROFILE OF THE EXISTING PAVEMENT. PLACE THE PROPOSED ASPHALT CONCRETE OVERLAY AS SHOWN ON THE TYPICAL SECTIONS.

**ASPHALT CONCRETE FOR DRIVEWAYS AND MAILBOX APPROACHES**

THE FOLLOWING ESTIMATED QUANTITY FOR ASPHALT CONCRETE IS TO BE USED FOR ADJUSTING DRIVEWAYS & ANY MAILBOX APPROACHES AS DIRECTED BY THE ENGINEER:

ITEM 442 - ASPH. CONC. SURFACE, 12.5MM, TYPE A (446) 200 CU. YARD

TOTALS CARRIED TO GENERAL SUMMARY

THE PROJECT WILL NOT BE CONSIDERED COMPLETE UNTIL ALL DRIVEWAYS HAVE BEEN TREATED AS DIRECTED BY THE ENGINEER.

**ELEVATION DATUM**

ALL ELEVATIONS ARE ORTHOMETRIC HEIGHTS USING THE NORTH AMERICAN VERTICAL DATUM OF 1998 (NAVD88) AND GEOID03 GEOID (GPS DERIVED). HORIZONTAL POSITIONS ARE BASED ON THE OHIO STATE PLANE NORTH ZONE, A LAMBERT CONFORMAL CONIC MAP PROJECTION, THE NORTH AMERICAN DATUM OF 1983 ADJUSTED TO THE NATIONAL SPATIAL REFERENCE SYSTEM OF 2011 (NAD 83(NSRS 2011)), AND THE GRS80 ELLIPSOID.

**EXISTING MONUMENT BOXES**

DURING CONSTRUCTION, IF THE CONTRACTOR REMOVES OR DISTURBS ANY MONUMENT BOX ASSEMBLIES, THE CONTRACTOR SHALL HAVE A REGISTERED SURVEYOR CERTIFY THAT THE MONUMENTS HAVE BEEN RESET AT THE ORIGINAL LOCATION AS PER OHIO ADMINISTRATIVE CODE, CHAPTER 4733-37, STANDARDS FOR BOUNDARY SURVEYS. THE CONTRACTOR SHALL FORWARD A COPY OF SAID CERTIFICATION TO THE PROJECT ENGINEER, AND THE DISTRICT SURVEY OPERATIONS MANAGER FOR REVIEW. THE CERTIFICATION SHALL BE SIMILAR TO THE FOLLOWING:

I, JOHN D. DOE, P.S. HEREBY CERTIFY THAT THE CENTERLINE MONUMENTATION HAS BEEN RESET AT THE PRECONSTRUCTION LOCATIONS DURING PROJECT CTY-RT-SEC, PID 000000. ALL OF MY WORK CONTAINED HEREIN WAS CONDUCTED IN ACCORDANCE WITH OHIO ADMINISTRATIVE CODE 4733-37 COMMONLY KNOWN AS "A MINIMUM STANDARDS FOR BOUNDARY SURVEYS IN THE STATE OF OHIO" UNLESS OTHERWISE NOTED. THE WORDS I AND MY, AS USED HEREIN, ARE TO MEAN MYSELF OR SOMEONE UNDER MY DIRECT SUPERVISION.

ALL SURVEY MONUMENTS SET AND/OR RESET BY THE CONTRACTOR'S SURVEYOR SHALL BE CONSTRUCTED ACCORDING TO SCD RM-1.1.

ALL COSTS ASSOCIATED WITH THE RE-SETTING OF THE MONUMENT BOXES SHALL BE AT THE CONTRACTORS' EXPENSE.

**ITEMS ADJUSTED TO GRADE**

THE FOLLOWING ITEMS HAVE BEEN CARRIED IN THE PLANS AS CONTINGENCY QUANTITIES AND SHOULD BE USED AS DIRECTED BY THE ENGINEER.

ITEM 623, MONUMENT BOX ADJUSTED TO GRADE 1 EACH

**ITEM 644, CROSSWALK LINE, AS PER PLAN**

24" WHITE LONGITUDINAL LINES SHALL BE PLACED PARALLEL TO TRAFFIC FLOW AS SHOWN IN FOLLOWING DETAIL. THE MARKING DESIGN SHOULD AVOID THE WHEEL PATHS.

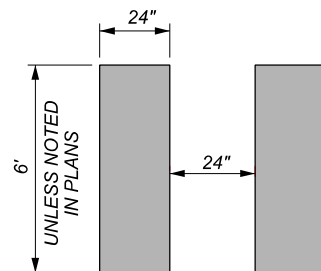

**ITEM 253, PAVEMENT REPAIR**

PAVEMENT SHALL BE PLANED BEFORE PAVEMENT REPAIRS ARE PERFORMED.

THE FOLLOWING ESTIMATED QUANTITIES ARE TO BE USED FOR 6" PAVEMENT REPAIR ON U.S. 23 AS DIRECTED BY THE ENGINEER BASED ON 15% OF THE PAVEMENT AREA.

ITEM 253, PAVEMENT REPAIR 2556 CU. YARDS

ESTIMATED QUANTITIES CARRIED TO THE GENERAL SUMMARY.

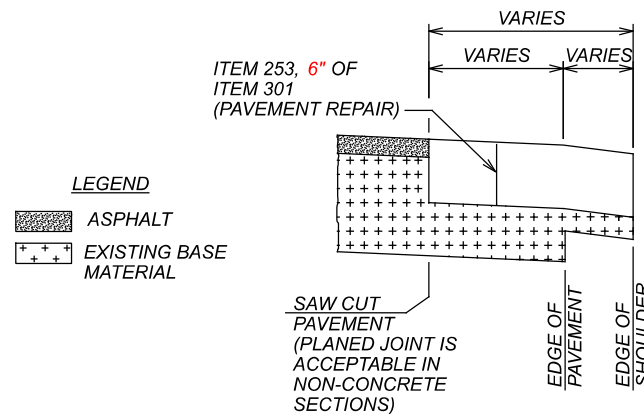

NOTE: THE ENGINEER SHALL FIELD VERIFY ALL LOCATIONS PRIOR TO THE BEGINNING OF WORK. ANY ADJUSTMENTS NECESSARY SHALL BE AS DIRECTED BY THE ENGINEER.

**SAFETY EDGE**

ITEM 442 - ASPH. CONC. SURFACE, 12.5MM, TYPE A (446)  
ITEM 442 - ASPH. CONC. INTERMEDIATE CONC., 19MM, TYPE A (446)

THE FOLLOWING QUANTITIES HAVE BEEN CARRIED TO THE GENERAL SUMMARY FOR CONSTRUCTION OF THE SAFETY EDGE:

WOOD - U.S. 23 (6.02-11.84)  
ITEM 442 - ASPH. CONC. SURFACE, 12.5MM, TYPE A (446) 26 CU. YD.  
ITEM 442 - ASPH. CONC. INTERMEDIATE CONC., 19MM, TYPE A (446) 62 CU. YD.

**ITEM 209, PREPARING SUBGRADE FOR SHOULDER PAVING**

THE FOLLOWING QUANTITIES HAVE BEEN CARRIED TO THE GENERAL SUMMARY FOR ITEM 209, PREPARING SUBGRADE FOR CONSTRUCTION OF THE SAFETY EDGE:

WOOD - U.S. 23 (6.02-11.84)  
11.64 MILES  
-1.34 MILES (GUARDRAIL, DRIVE & CURB AREAS)  
10.30 MILES

A QUANTITY OF 10.30 MILES HAS BEEN CARRIED TO THE GENERAL SUMMARY FOR PREPARING SUBGRADE FOR SHOULDERS.

**ITEM 611, CATCH BASIN ADJUSTED TO GRADE, AS PER PLAN**

ALL WORK TO BE DONE UNDER THIS ITEM, TOGETHER WITH ALL THE MATERIALS FURNISHED, SHALL CONFORM TO ODOT ITEM 611. THE CATCH BASIN GRATE WILL BE REPLACED WITH A BICYCLE SAFE GRATE. THE COST OF ALL MATERIAL AND LABOR SHALL BE INCLUDED AS PART OF THE UNIT PRICE BID FOR ITEM 611, CATCH BASIN ADJUSTED TO GRADE, AS PER PLAN.

**ITEM 611, CATCH BASIN REMOVED, AS PER PLAN**

REMOVE PORTIONS OF CATCH BASINS TO AN ELEVATION BELOW THE EXISTING SUBGRADE AND UNTIL SOLID CONCRETE/MASONRY WALLS ARE ENCOUNTERED. PLUG ALL OUTLETS. REMOVE ALL FOREIGN DEBRIS FROM BASIN. IN CONJUNCTION WITH THE CONDUIT, FILL AND PLUG ITEM, FILL THE REMAINING BASIN WITH LSM. BACKFILL ABOVE THE LSM WITH ITEM 304, AGGREGATE BASE COMPACTED IN 6" LIFTS TO SUBBASE LEVEL. REPLACEMENT OF ASPHALT PAVEMENT IN AREA OF BASIN REMOVAL WILL BE COVERED UNDER APPROPRIATE PAY ITEMS FOR PAVEMENT REPAIRS.

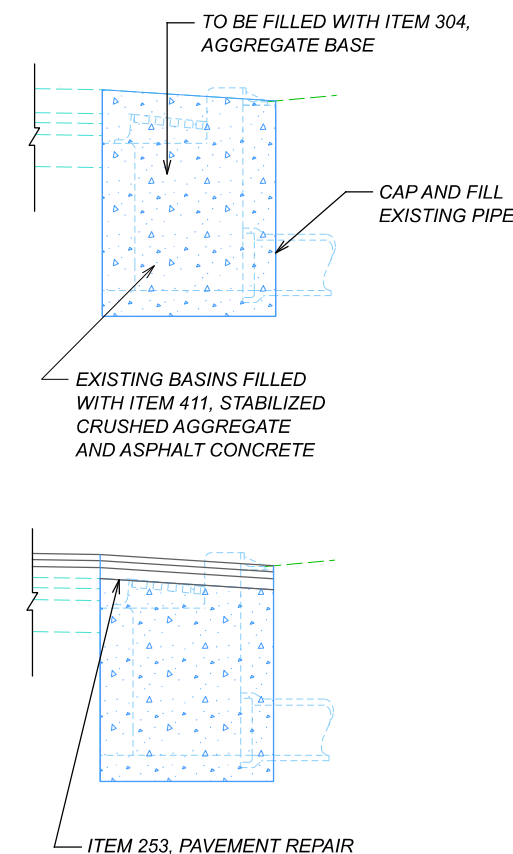

**ITEM 202, CURB AND GUTTER REMOVED, AS PER PLAN**

ITEM 202 CURB AND GUTTER REMOVED, AS PER PLAN SHALL INCLUDE THE REMOVAL OF THE CURB & GUTTER AND REPLACING THE VOID WITH ASPHALT UP TO THE EXISTING ELEVATION. THE ASPHALT WILL BE PAID FOR UNDER ITEM 253, PAVEMENT REPAIR.

GENERAL NOTES

DESIGN AGENCY



DESIGNER

TLM

REVIEWER

JMF 11-02-20

PROJECT ID

102922

SHEET TOTAL

P.5 20

SHEET NUM.						PART.		ITEM	ITEM EXT	GRAND TOTAL	UNIT	DESCRIPTION	SEE SHEET NO.	
		5	6	9	10	11	12							01/NHS/PV
												<b>ROADWAY</b>		
							444	444	202	30000	444	SF	WALK REMOVED	
								40	202	32501	40	FT	CURB AND GUTTER REMOVED, AS PER PLAN	5
								150	202	38000	150	FT	GUARDRAIL REMOVED	
								1	202	58700	1	EACH	MANHOLE ABANDONED	
								4	202	58101	4	EACH	CATCH BASIN REMOVED, AS PER PLAN	5
							523	523	SPECIAL	20270000	523	FT	FILL AND PLUG EXISTING CONDUIT, 12"	
				12				12	209	60500	12	MILE	LINEAR GRADING	
		10.3						10.3	209	72050	10.3	MILE	PREPARING SUBGRADE FOR SHOULDER PAVING	
								163	606	15050	163	FT	GUARDRAIL, TYPE MGS	
								2	606	26550	2	EACH	ANCHOR ASSEMBLY, MGS TYPE T	
							280	280	608	10000	280	SF	4" CONCRETE WALK	
							51	51	608	52000	51	SF	CURB RAMP	
							485	485	608	52001	485	SF	CURB RAMP, AS PER PLAN	9
		1						1	623	39500	1	EACH	MONUMENT BOX ADJUSTED TO GRADE	
													<b>EROSION CONTROL</b>	
								1,000	832	30000	1,000	EACH	EROSION CONTROL	
													<b>DRAINAGE</b>	
								3	611	98630	3	EACH	CATCH BASIN ADJUSTED TO GRADE	
								1	611	98631	1	EACH	CATCH BASIN ADJUSTED TO GRADE, AS PER PLAN	5
								3	611	99654	3	EACH	MANHOLE ADJUSTED TO GRADE	
													<b>PAVEMENT</b>	
		2,556						2,556	253	02000	2,556	CY	PAVEMENT REPAIR	
					103,700			103,700	254	01000	103,700	SY	PAVEMENT PLANING, ASPHALT CONCRETE, 3 1/4"	
					14,520			14,520	407	20000	14,520	GAL	NON-TRACKING TACK COAT	
		226			4,322			4,548	442	10000	4,548	CY	ASPHALT CONCRETE SURFACE COURSE, 12.5 MM, TYPE A (446)	
		62			5,042			5,104	442	10100	5,104	CY	ASPHALT CONCRETE INTERMEDIATE COURSE, 19 MM, TYPE A (446)	
							16	16	609	26000	16	FT	CURB, TYPE 6	
					1,848			1,848	617	10100	1,848	CY	COMPACTED AGGREGATE	
					11			11	618	41000	11	MILE	RUMBLE STRIPES, EDGE LINE (ASPHALT CONCRETE)	
					6			6	618	43000	6	MILE	RUMBLE STRIPES, CENTER LINE (ASPHALT CONCRETE)	
					30,684			30,684	6	20000	30,684	FT	LONGITUDINAL JOINT PREPARATION	
													<b>WATER WORK</b>	
								1	638	10800	1	EACH	VALVE BOX ADJUSTED TO GRADE	
													<b>TRAFFIC CONTROL</b>	
								340	621	00100	340	EACH	RPM	
								126	621	54000	126	EACH	RAISED PAVEMENT MARKER REMOVED	
								11.6	642	00104	11.6	MILE	EDGE LINE, 6", TYPE 1	
								11.6	642	00300	11.6	MILE	CENTER LINE, TYPE 1	
								26	644	00500	26	FT	STOP LINE	
								360	644	00601	360	FT	CROSSWALK LINE, AS PER PLAN	5
													<b>MAINTENANCE OF TRAFFIC</b>	
					72			72	614	12460	72	EACH	WORK ZONE MARKING SIGN	
					5			5	614	12500	5	EACH	REPLACEMENT SIGN	
					5			5	614	12600	5	EACH	REPLACEMENT DRUM	
					34.8			34.8	614	21400	34.8	MILE	WORK ZONE CENTER LINE, CLASS II	
					34.8			34.8	614	21550	34.8	MILE	WORK ZONE CENTER LINE, CLASS III, 642 PAINT	
								78	614	26610	78	FT	WORK ZONE STOP LINE, CLASS III, 642 PAINT	



**DRAINAGE CALCULATIONS**

REF NO.	SHEET NO.	STATION TO STATION		202	202	202	SPECIAL			611	611	611		638						
				CURB AND GUTTER REMOVED, AS PER PLAN	MANHOLE ABANDONED	CATCH BASIN REMOVED, AS PER PLAN	FILL AND PLUG EXISTING CONDUIT			CATCH BASIN ADJUSTED TO GRADE, AS PER PLAN (WITH BICYCLE SAFE GRATE)	CATCH BASIN ADJUSTED TO GRADE	MANHOLE ADJUSTED TO GRADE		VALVE BOX ADJUSTED TO GRADE						
				FT	EACH	EACH	EACH			EACH	EACH	EACH		EACH						
DR-1	14	366+90																		
DR-2	15	371+05								1										
DR-3	15	374+13									1									
DR-4	15	377+86									1									
DR-5	15	384+10												1						
DR-6	19	574+97	TO	575+10				45												
DR-7	19	575+10	TO	577+08		1		175												
DR-8	19	577+08	TO	577+06	10			28												
DR-9	19	577+06			10			1												
DR-10	20	580+65			10			1												
DR-11	20	580+65			10			1												
<b>TOTALS CARRIED TO GENERAL SUMMARY</b>				40	1	4	523			1	3	3		1						

**GUARDRAIL CALCULATIONS**

REF NO.	SHEET NO.	STATION TO STATION		202	606	606															
				GUARDRAIL REMOVED	GUARDRAIL, TYPE MGS	ANCHOR ASSEMBLY, MGS TYPE T															
				FT	FT	EACH															
GR-1	11	392+00	TO	393+50	150	162.5	2														
<b>TOTALS CARRIED TO GENERAL SUMMARY</b>				150	163	2															

SUBSUMMARIES

DESIGN AGENCY



DESIGNER

TLM

REVIEWER

JMF 11-02-20

PROJECT ID

102922

SHEET

P.11

TOTAL

20

MATCH LINE - STA. 531+50

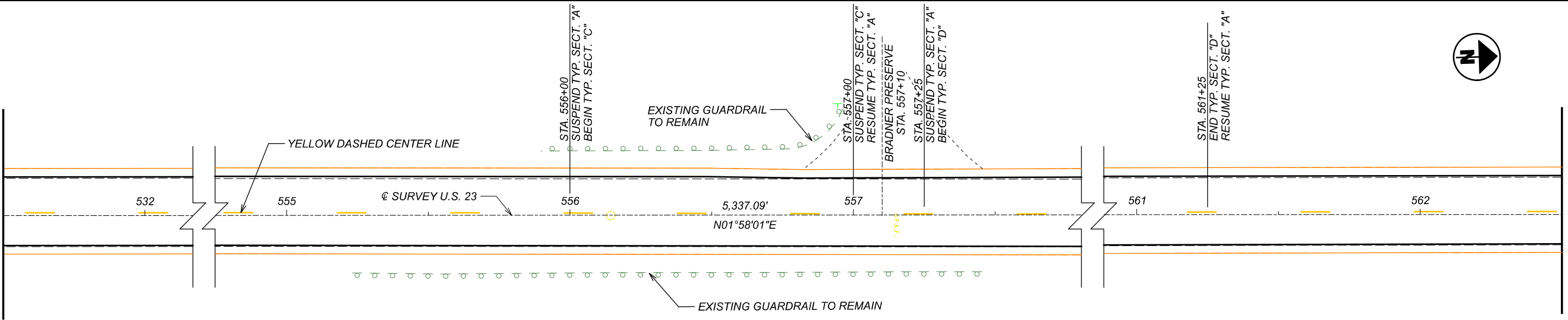

MATCH LINE - STA. 562+50

MATCH LINE - STA. 562+50

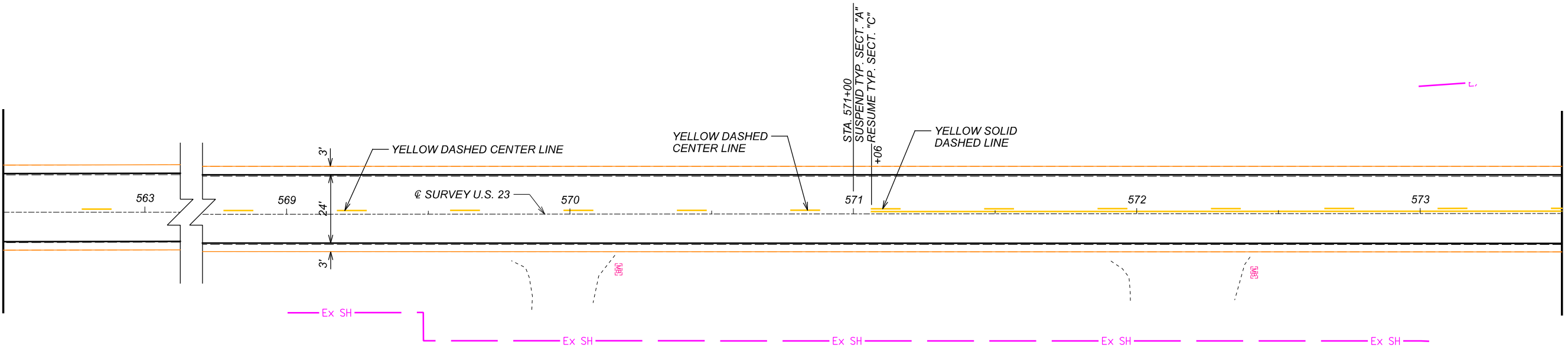

MATCH LINE - STA. 573+50

MATCH LINE - STA. 573+50

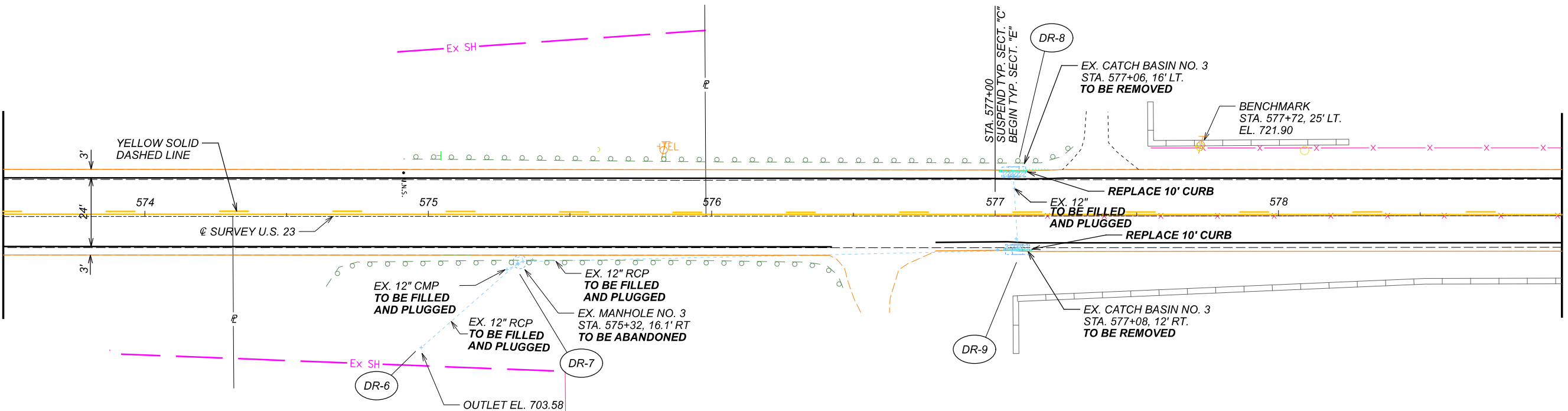

MATCH LINE - STA. 579+00

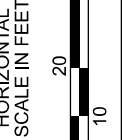

PLAN SHEET  
STA. 531+50 TO STA. 579+00

DESIGN AGENCY



DESIGNER  
TLM

REVIEWER  
JMF 11-02-20

PROJECT ID  
102922

SHEET	TOTAL
P.19	20