



CUY-90-14.90

PID 77332/85531

APPENDIX UT-17

**Potential Utility Conflicts – CCG3
(Reference Document)**

State of Ohio
Department of Transportation
Jolene M. Molitoris, Director

**Innerbelt Bridge
Construction Contract Group 1 (CCG1)**

PUBLIC UTILITY CONFLICTS - CONTRACT GROUP 3														
* CONFLICTS WITH BRIDGE PIERS WILL BE DETERMINED DURING BRIDGE DESIGN														
CONFLICTS WITH U.G. ELECTRIC FOR ROADWAY LIGHTING IS NOT SHOWN														
CONFLICT I.D.	ALIGNMENT	ROADWAY	STATIONING		AFFECTED UTILITY					PROPOSED CONSTRUCTION				
			Begin	End	GAS	WATER	TELE	STEAM	ELECTRIC	COVER REDUCTION/ DEEP FILL	RETAINING WALL	PAVEMENT WIDENING	BRIDGE REPLACEMENT	BRIDGE PIERS*
3-1	17777WOO	I-77 NB TO WOODLAND (RAMP H1)	146+90					(2) STD				X		
3-2	I77WOO	WOODLAND AVE.	724+80	728+50		16"	(6) STD (2)		(9) TILE 4"		X			
3-3	I77ORA	ORANGE AVE.	423+20	426+65	20"	8"				3' CUT				
3-4	I7777E22	I-77 EB TO E. 22ND ST. (RAMP H2)	359+50	363+00		16"	(6) FD 4" (FO)		(9) TILE 4"	20' FILL	X			
						6"	(6) FD 4" (FO)							
						2"								
3-5	I7790ORA	I-90 WB TO ORANGE AVE. (RAMP J2)	5440+15		6"						X			
3-6	I7790ORA	I-90 WB TO ORANGE AVE. (RAMP J2)	5440+15		20"						X			
3-7	I7777E90	I-77 NB TO I-90 EB (RAMP H5)	977+96				(12) SP (6) SP				X			
3-8	I7777E90	I-77 NB TO I-90 EB (RAMP H5)	978+71				(1) SP				X			
3-9	I7777E18	I-77 NB TO E. 18TH ST. (RAMP H4)	779+40	781+00			(12) SP (6) SP (2) SP			2' CUT				
3-10	I7777E90	I-77 NB TO I-90 EB (RAMP H5)	982+28				(8) PD 2" (FO)				X			
3-11	NWVE22	E. 22ND ST.	32+75	35+65	12"	24"	(6) MTD	12" & 16"	(12) FD 4"			X		
3-12	NEV90E22	I-90 EB TO E. 22ND ST. (RAMP M6)	1618+59				(3) FD				X			
3-13	PCLE90	I-90 EB	194+40				(15) STD				X			
3-14	PCLE90	I-90 EB	194+30				(15) STD			4' CUT				
3-15	NWVE21S77	E. 21ST ST. TO I-77 SB (RAMP A1)	305+91		6"						X			
3-16	NWV90S77	I-90 WB TO I-77 SB (RAMP A2)	409+87				(15) STD				X			
3-17	NWV90S77	I-90 WB TO I-77 SB (RAMP A2)	410+10		6"						X			
3-18	NWV90S77	I-90 WB TO I-77 SB (RAMP A2)	410+30			10"					X			
3-19	NWV90S77	I-90 WB TO I-77 SB (RAMP A2)	410+81			HYDRANT					X			
3-20	NWVE18 NWVE14NB	E. 18TH ST. E. 14TH NB	24+80 17+44	21+66 14+25		6" & 10"	MANY MULTI-DUCT LINES			0.4' TO 2.8' CUT 2.8' TO 22' CUT				
3-21	NNHE14W90	E. 14TH ST. TO I-90 WB (RAMP A3)	504+40				(2) STD				X			
3-22	NEV90E9	I-90 EB TO E. 9TH ST. (RAMP B5)	1518+00	1519+00			(12) MTD (12) SP (6) SP			5' CUT				
3-23	NNHE9	E. 9TH ST.	33+20	40+00			MANY MULTI-DUCT LINES			1' TO 4.5' CUT				
3-24	NWVCAR	CARNEGIE AVE.	27+00	30+00	8"	SERVICE					X			
3-25	NNHE9W90	E. 9TH TO I-90 WB	604+45				(15) SP 4" (6) STD				X X			
3-26	NNHE9W90	E. 9TH TO I-90 WB	604+85				(15) SP 4" (6) STD				X X			

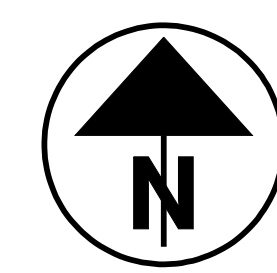

**CONTRACT GROUP 3
POTENTIAL UTILITY CONFLICTS
SHEET 1**



**DECEMBER 23, 2009
DRAFT**

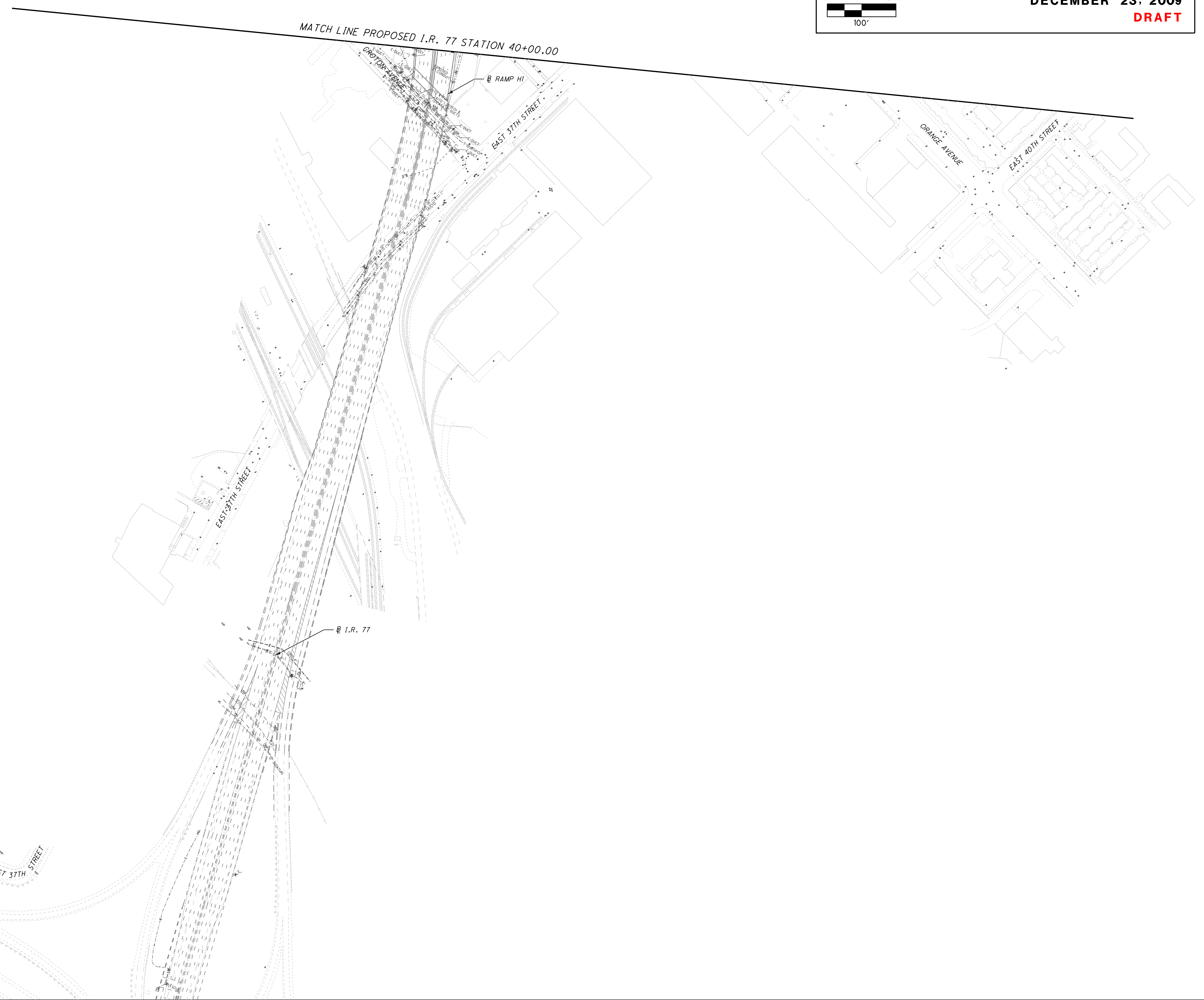

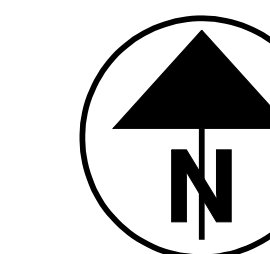

**CONTRACT GROUP 3
POTENTIAL UTILITY CONFLICTS
SHEET 2**

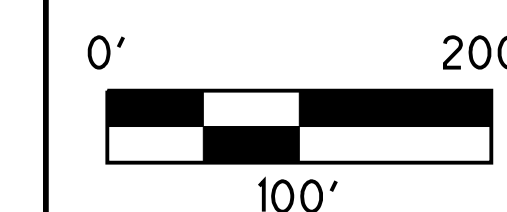

DECEMBER 23, 2009

DRAFT

MATCH LINE PROPOSED I.R. 77 STATION 70+00.00

STA. 66+33.19 I.R. 77 =
STA. 367+62.07 RAMP H2

3-4

3-3

3-2

3-1

MATCH LINE PROPOSED I.R. 77 STATION 40+00.00

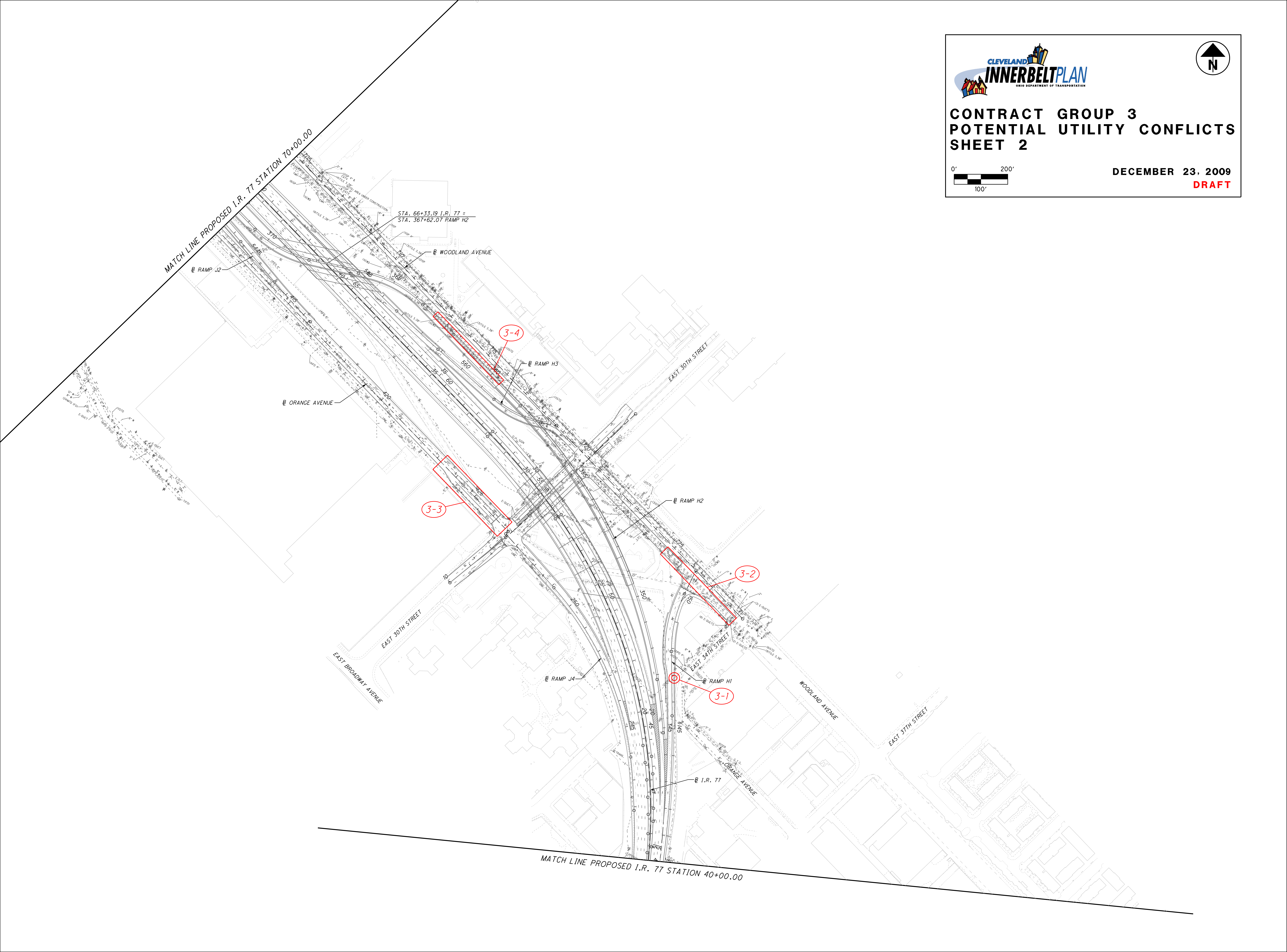

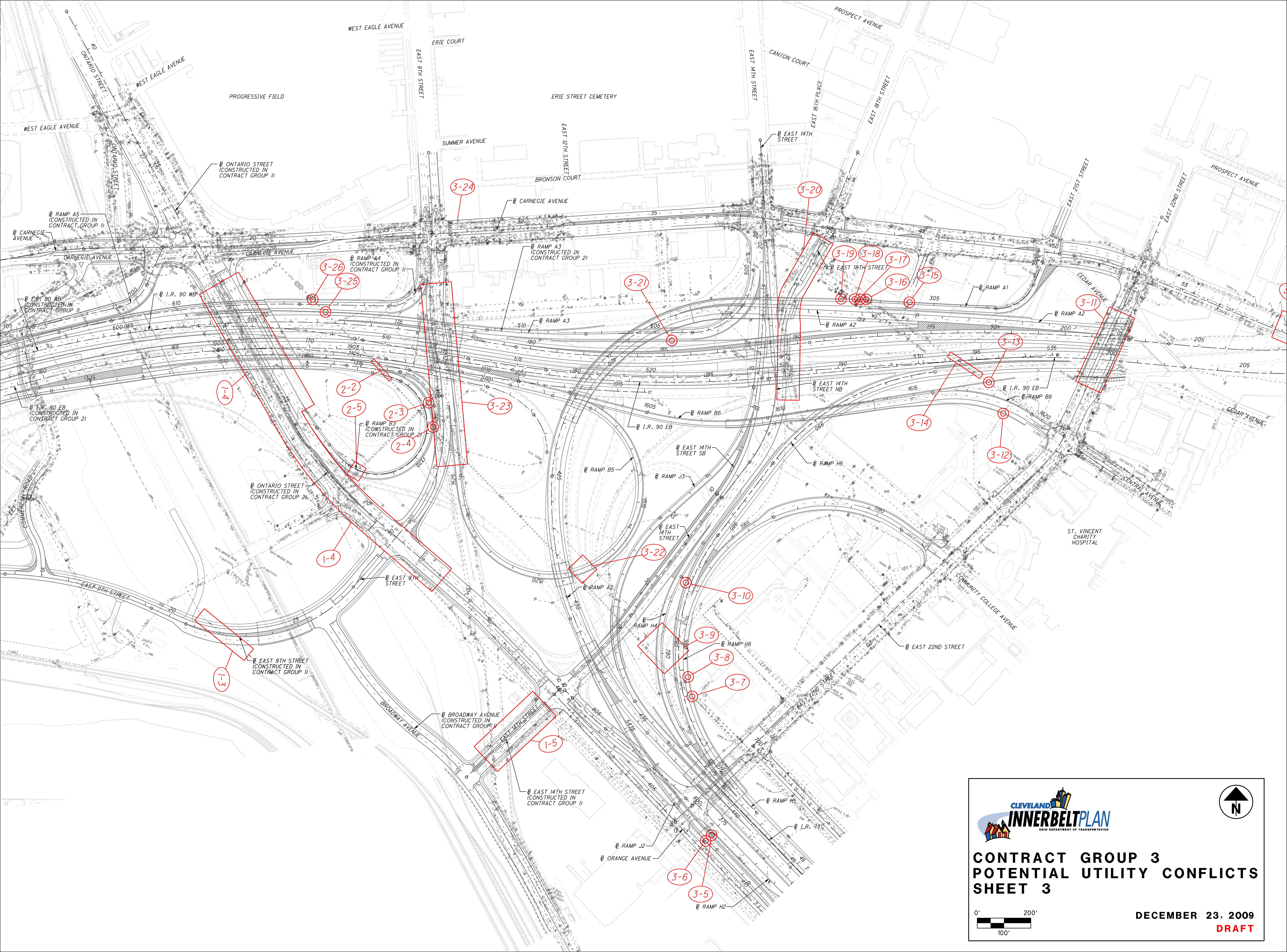



**CLEVELAND
INNERBELT PLAN**
OHIO DEPARTMENT OF TRANSPORTATION

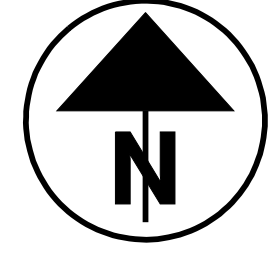

N

**CONTRACT GROUP 3
POTENTIAL UTILITY CONFLICTS
SHEET 3**

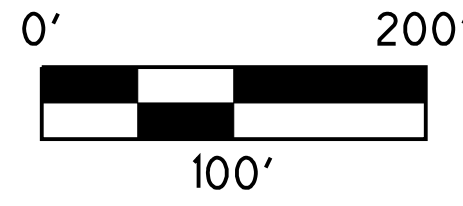

0' 100' 200'

DECEMBER 23, 2009
DRAFT