

O.D.O.T. DISTRICT 2 SURVEY OFFICE (USE ONLY)

PERSONNEL

REFERENCE NO. 20 B

SHEET 20 OF 22

NOTES LOEHRKE

DATE 7/18/88

ROUTE SR 795

H.C. REED

WEATHER PARTLY CLOUDY

COUNTY WOOD

R.C. BARNHISEL

TEMP. 85°

TOWNSHIP LAKE

HOFFMAN

SECTION 22

DWG BY NIESE PID                     

T 7 N R 12 E

TYPE MONUMENT MONBOX

~~ON SURFACE~~ - BELOW -

OFFSET  $\angle$  PAVEMENT 9.2' ~~LT~~ : RT

1.8' TO RT EDGE PAVEMENT

STATION: 472+83

HORZ.DATUM:                      GEOID:                     

GRID: NORTHING:                      EASTING:                     

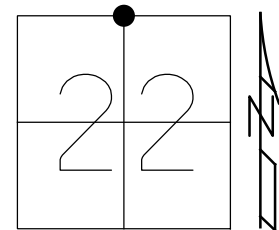

RECORD: P.I.  
STA 472+83  
 $\angle$  CONSTRUCTION  
FD MONBOX  
BELOW SURFACE  
7/18/88, CAL

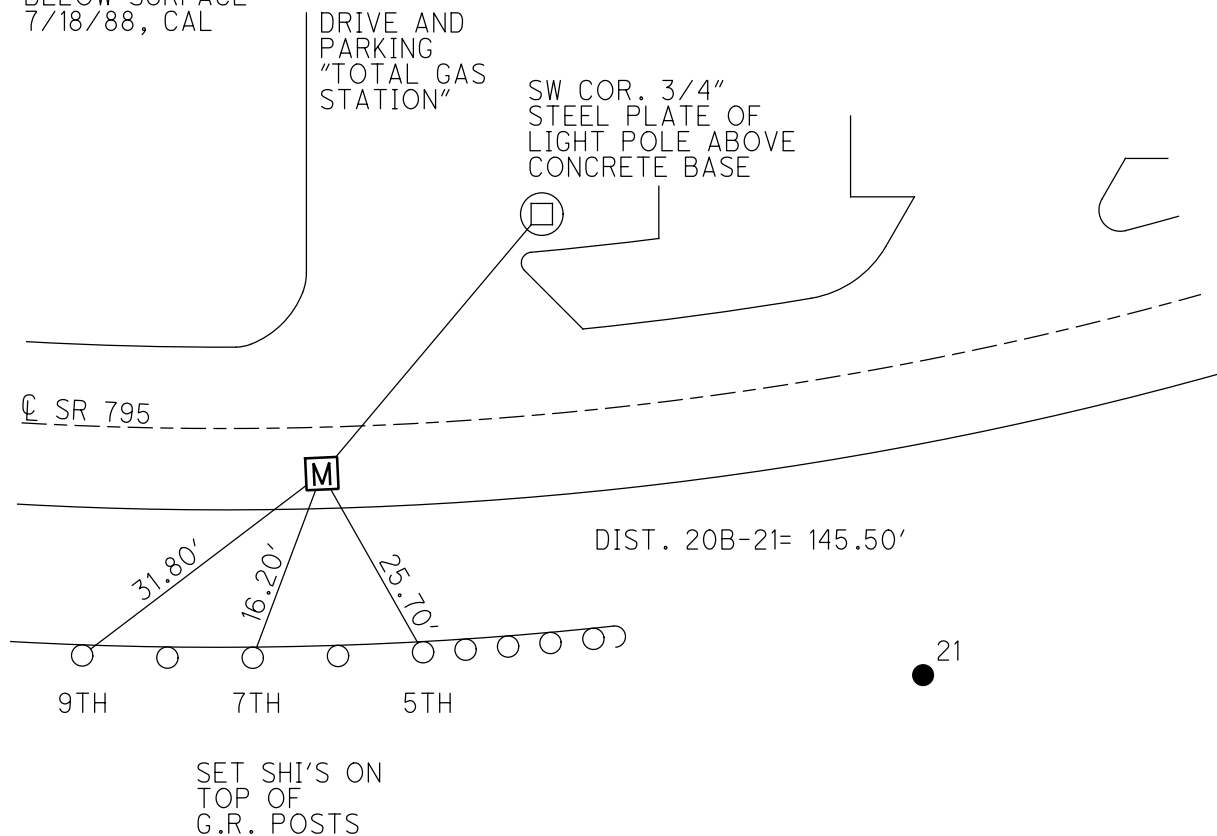

O.D.O.T. DISTRICT 2 SURVEY OFFICE

## PERSONNEL

REFERENCE NO. 21

SHEET OF

NOTES Loehrk

H.C. *Rev*

R.C. Bohmer

  
 Digitally signed by A. K. Singh, DN: cn=A. K. Singh, o=, ou=, email=ak.singh@bhu.ac.in, c=IN

DATE 7-18-88

WEATHER 1st Clear Day

TEMP. 48.5

ROUTE SR 795

COUNTY Wood

TOWNSHIP LAKE

SECTION \_\_\_\_\_

T2NR12E

TYPE MONUMENT 1" IRON PIPE  
ON SURFACE - BELOW 3" BELOW GROUND

LEFT - C. PAV'T. - RIGHT

TO SOUTH EDGE PAVEMENT

S.L.M. 472 (83) Mod Box

