

STATE OF OHIO
DEPARTMENT OF TRANSPORTATION

HAM-71-3.81

CITY OF CINCINNATI HAMILTON COUNTY

BUILDABLE UNIT 1B

PROPOSED WORK - BUILDABLE UNIT 1B

PRE-PHASE AND PHASE 1 MOT
MEDIAN SHOULDER RECONSTRUCTION
MEDIAN DRAINAGE
MEDIAN TRAFFIC CONTROL
MEDIAN LIGHTING
CONRAIL BRIDGE REMOVAL OVER NB IR 71

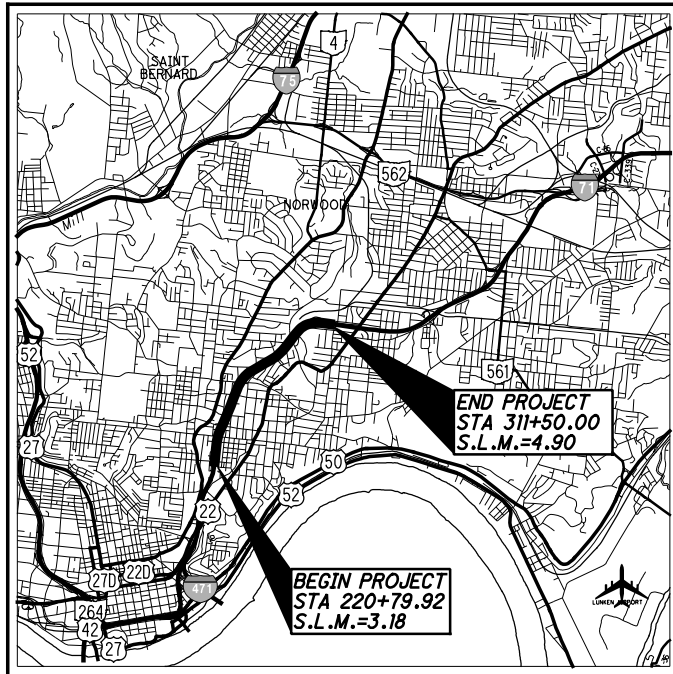

LOCATION MAP

LATITUDE: 39°08'05" LONGITUDE: 84°29'36"

SCALE IN MILES

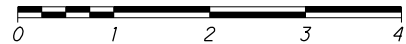

PORTION TO BE IMPROVED	-----	=====
INTERSTATE HIGHWAY	-----	=====
FEDERAL ROUTES	-----	=====
STATE ROUTES	-----	=====
COUNTY & TOWNSHIP ROADS	-----	=====
OTHER ROADS	-----	=====

DESIGN DESIGNATION

CURRENT ADT (2019)	IR 71	147,760
DESIGN YEAR ADT (2039)		159,330
DESIGN HOURLY VOLUME (2039)		16,530
DIRECTIONAL DISTRIBUTION		51%
TRUCKS (24 HOUR B&C)		8%
DESIGN SPEED		60 MPH
LEGAL SPEED		55 MPH
DESIGN FUNCTIONAL CLASSIFICATION:		
URBAN INTERSTATE		
NHS PROJECT		YES

DESIGN EXCEPTIONS

DESIGN FEATURE	APPROVAL DATE	SHEETS
SHOULDER WIDTH	12/10/13	8

UNDERGROUND UTILITIES

CONTACT BOTH SERVICES
CALL TWO WORKING DAYS
BEFORE YOU DIG

CALL
1-800-362-2764
(TOLL FREE)

OHIO UTILITIES PROTECTION SERVICE
NON-MEMBERS
MUST BE CALLED DIRECTLY

OIL & GAS PRODUCERS UNDERGROUND
PROTECTION SERVICE CALL: **1-800-925-0988**

ENGINEERS SEAL:

SIGNED: *Dennis C. Jennings*
DATE: 7-28-2014

ENGINEERS SEAL:

SIGNED: _____
DATE: _____

INDEX OF SHEETS:

TITLE SHEET	1
LOCATION PLAN	2
TYPICAL SECTIONS	3 - 8
GENERAL NOTES	9
MAINTENANCE OF TRAFFIC	10 - 34
PLAN AND PROFILE	35 - 72
CROSS SECTIONS	73 - 77
DRAINAGE PROFILES	78
TRAFFIC CONTROL	79 - 86
LIGHTING	87 - 93
CONCRETE BARRIER DETAIL	94
BARRIER TRANSITION DETAIL	95
I-3-B A.P.P. DETAIL	96 - 97

PLAN PREPARED BY:
HDR ENGINEERING, INC.
9987 CARVER ROAD, SUITE 200
CINCINNATI, OHIO 45242
513-984-7500

STANDARD CONSTRUCTION DRAWINGS

STANDARD CONSTRUCTION DRAWINGS										SUPPLEMENTAL SPECIFICATIONS	SPECIAL PROVISIONS	
DM-1.1	1/18/13	MT-101.70	1/17/14	HL-30.11	1/17/14	TC-7.65	10/18/13	TC-51.11	1/17/14	800	1/17/14	DESIGN BUILD
DM-1.2	1/18/13	MT-101.90	7/19/13	HL-30.21	1/17/14	TC-12.30	10/18/13	TC-51.12	1/17/14	832	1/17/14	3/11/14
BP-2.5	7/19/13	MT-102.10	7/19/13	HL-30.22	1/17/14	TC-15.115	10/18/13	TC-52.10	10/18/13			
MT-95.30	7/19/13	MT-102.20	7/19/13	HL-30.41	7/18/14	TC-21.10	10/18/13	TC-52.20	1/17/14			
MT-98.10	7/19/13	MT-102.30	7/19/13	HL-40.10	1/17/14	TC-21.50	10/18/13					
MT-98.11	7/19/13	MT-105.10	7/19/13	HL-40.20	1/17/14	TC-22.20	1/17/14					
MT-98.20	7/19/13			HL-50.21	1/17/14	TC-41.10	7/19/13					
MT-98.28	7/19/13	HL-10.11	1/17/14	HL-60.11	1/17/14	TC-41.15	10/18/13					
MT-98.29	7/19/13	HL-10.12	1/17/14	HL-60.12	1/17/14	TC-41.20	10/18/13					
MT-99.30	7/19/13	HL-10.13	1/17/14	HL-60.31	1/17/14	TC-41.30	10/18/13					
MT-99.50	7/19/13	HL-20.11	1/17/14			TC-42.10	10/18/13					
MT-101.60	7/19/13	HL-20.13	5/1/95	TC-7.65	10/18/13	TC-42.20	10/18/13					

PROJECT DESCRIPTION

THE PROJECT CONSISTS OF CONSTRUCTION OF A NEW INTERCHANGE AT IR-71 AND MARTIN LUTHER KING DRIVE, RECONSTRUCTION OF RAMPS AT McMILLAN STREET AND TAFT ROAD, PAVEMENT RESTORATION OF IR-71, AND CONSTRUCTION TO THE SURROUNDING LOCAL STREET NETWORK. CONSTRUCTED FEATURES WILL INCLUDE ADDING LANES ALONG IR-71, WIDENING OF LOCAL STREETS, DRAINAGE, LIGHTING, TRAFFIC SIGNALS, ITS (ARTIMIS), RAMP METERS, AND SIGNING AND STRIPING. THE PROJECT LENGTH ALONG IR-71 IS 1.71 MILES.

EARTH DISTURBED AREAS

PROJECT EARTH DISTURBED AREA: 95.7 ACRES
ESTIMATED CONTRACTOR EARTH DISTURBED AREA: 12.0 ACRES
NOTICE OF INTENT EARTH DISTURBED AREA: NOT REQUIRED;
100% OF RUNOFF IS COLLECTED IN COMBINED SEWERS

LIMITED ACCESS

THIS IMPROVEMENT IS ESPECIALLY DESIGNED FOR THROUGH TRAFFIC AND HAS BEEN DECLARED A LIMITED ACCESS HIGHWAY OR FREEWAY BY ACTION OF THE DIRECTOR IN ACCORDANCE WITH THE PROVISIONS OF SECTION 5511.02 OF THE OHIO REVISED CODE.

2013 SPECIFICATIONS

THE STANDARD SPECIFICATIONS OF THE STATE OF OHIO, DEPARTMENT OF TRANSPORTATION, INCLUDING CHANGES AND SUPPLEMENTAL SPECIFICATIONS LISTED IN THE PROPOSAL SHALL GOVERN THIS IMPROVEMENT.

I HEREBY APPROVE THESE PLANS AND DECLARE THAT THE MAKING OF THIS IMPROVEMENT WILL REQUIRE THE CLOSING TO TRAFFIC OF THE HIGHWAY AND THAT DETOURS WILL BE PROVIDED AS INDICATED ON SHEET 14 - 19

UNDER AUTHORITY OF SECTION 4511.21, DIVISION (H) OF THE OHIO REVISED CODE, THE REVISED PRIMA FACIE SPEED LIMITS AS INDICATED HEREIN ARE DETERMINED TO BE REASONABLE AND SAFE, AND ARE HEREBY ESTABLISHED FOR THE DURATION OF THIS PROJECT. THE PRIMA FACIE SPEED LIMIT OF LIMITS HEREBY ESTABLISHED SHALL BECOME EFFECTIVE WHEN APPROPRIATE SIGNS GIVING NOTICE THEREOF ARE ERECTED.

APPROVED _____
DATE _____ DISTRICT DEPUTY DIRECTOR

APPROVED _____
DATE _____ DIRECTOR, DEPARTMENT OF TRANSPORTATION

NO.	DATE	DESCRIPTION
4	2/10/16	RFI 87
3	2/17/15	NDC 9
2	2/15/15	NDC 5
1	11/24/14	NDC 1
0	7/29/14	RFC PLANS BU 1B
B	7/11/14	FINAL SUBMITTAL BU 1B
A	6/2/14	INTERIM SUBMITTAL BU 1
ISSUE RECORD		

AMENDED RELEASE FOR CONSTRUCTION 2/10/16

FEDERAL PROJECT NO. E040(889)
PID NO. 77628
CONSTRUCTION PROJECT NO. (13)3026
RAILROAD INVOLVEMENT NONE
HAM-71-3.81
1/97

CONDUIT EXPANSION AND DEFLECTION

EXPANSION FITTINGS SHALL BE OZ TYPE AX, CROUSE HINDS TYPE XJG, APPLETON TYPE AX, OR APPROVED EQUAL. EACH EXPANSION FITTING SHALL PROVIDE EITHER 4 OR 8 INCHES (100 OR 200 MILLIMETERS) TOTAL MOVEMENT AS SPECIFIED BY THE PLAN DETAILS AND SHALL HAVE AN EXTERNAL COPPER BONDING JUMPER, UNLESS SPECIFIED OTHERWISE BY THE PLAN DETAILS. DEFLECTION COUPLINGS SHALL BE OZ TYPE DX, CROUSE HINDS TYPE XD, APPLETON TYPE DF, OR EQUAL. EACH DEFLECTION COUPLING SHALL HAVE AN EXTERNAL COPPER BONDING JUMPER, UNLESS SPECIFIED OTHERWISE BY THE PLAN DETAILS.

LAMPS

HIGH PRESSURE SODIUM LAMPS SHALL BE GENERAL ELECTRIC LUCALOX, OSRAM SYLVANIA LUMALUX, PHILIPS CERAMALUX, OR EQUAL.

PADLOCKS AND KEYS

PADLOCKS FURNISHED SHALL BE EITHER BRASS OR BRONZE, EQUAL TO MASTER NO. 4BKA OR WILSON BOHANNAN 660A, AND SHALL BE KEYED IN ACCORDANCE WITH CMS 631.06.

ITEM 625 - LUMINAIRE, BY TYPE

LUMINAIRES, CONVENTIONAL (TYPE III, 310W HPS 480 VOLT), AS PER PLAN
LUMINAIRES FOR CONVENTIONAL LIGHTING UNITS WITH AN IES III DISTRIBUTION AND 310 WATT HIGH PRESSURE SODIUM LAMPS SHALL BE GENERAL ELECTRIC "M-400" WITH PHOTOMETRIC DISTRIBUTION 1010, OR EQUAL.

LUMINAIRES, UNDERPASS (100W HPS 480 VOLT), AS PER PLAN

IN ADDITION TO THE REQUIREMENTS OF ODOT'S CONSTRUCTION AND MATERIAL SPECIFICATIONS, LUMINAIRES FOR UNDERPASS LIGHTING UNITS SHALL BE 100W HIGH PRESSURE SODIUM AND SHALL BE AS FOLLOWS: LUMINAIRES FOR UNDERPASS LIGHTING UNITS SHALL BE GENERAL ELECTRIC VERSAFLOOD 2 WALLIGHTER WITH TYPE IV DISTRIBUTION OR EQUAL. LUMINAIRES SHALL HAVE A CWI OR MAG-REG BALLAST. LUMINAIRES FOR UNDERPASS LIGHTING UNIT WHICH ARE WALL MOUNTED SHALL BE FURNISHED WITH AN INTEGRAL FUSE HOLDER AND 10-AMPERE FUSES.

ITEM 625 - SERVICE TO UNDERPASS LIGHTING, AS PER PLAN

SERVICE TO UNDERPASS LIGHTING SHALL PROVIDE A COMPLETE ELECTRICAL SYSTEM FOR THE UNDERPASS LIGHTING SYSTEM, EXCEPT FOR LUMINAIRES AND STRUCTURE GROUNDING. LIQUIDTIGHT FLEXIBLE METAL CONDUIT SHALL BE SUNLIGHT RESISTANT AND SUPPORTED AT INTERVALS NOT TO EXCEED 3 FEET, INCLUDING SUPPORTS BY AN APPROVED MEANS WITHIN 12" OF A JUNCTION BOX OR OTHER CONDUIT FITTING. SERVICE TO UNDERPASS LIGHTING, AS PER PLAN SHALL INCLUDE ALL CONDUIT, CONDUIT GROUNDING, MOUNTINGS, FITTINGS, JUNCTION BOXES, DISCONNECT SWITCHES, CABLES AND ALL INCIDENTALS NECESSARY TO COMPLETE THE INSTALLATION ARE INCLUDED AS PART OF THE SERVICE TO UNDERPASS LIGHTING, AS PER PLAN.

ITEM 625 - POWER SERVICE, AS PER PLAN

IN ADDITION TO THE REQUIREMENTS OF THE SPECIFICATIONS, THE FOLLOWING IS ADDED:

THE POWER SUPPLYING AGENCY ON THIS PROJECT IS:

DUKE ENERGY CORP.
5445 AUDRO DRIVE
CINCINNATI, OH 45239
CONTACT: DAVE BOSSE
TELEPHONE NO. (513)-287-1416

ODOT SHALL ENSURE THAT EACH POWER ELECTRICAL ENERGY ACCOUNT IS IN THE NAME OF AND THAT THE BILLING ADDRESS IS TO THE MAINTAINING AGENCY NOTED IN THE PLANS. THIS SHALL BE DONE NOT ONLY FOR EACH NEW POWER SERVICE ESTABLISHED BY THIS PROJECT BUT ALSO FOR EACH EXISTING POWER SERVICE, SINCE THERE MAY BE A RE-ASSIGNMENT OF THE RESPONSIBILITY FOR AN EXISTING SERVICE AS A RESULT OF THE WORK PERFORMED BY THIS PROJECT.

THE CONTRACTOR IS RESPONSIBLE TO OBTAIN THE RESPONSIBLE UTILITY OWNER'S SPECIFICATIONS AS IT RELATES TO AN ACCEPTED POWER SERVICE. IN ADDITION TO THE ITEMS INCLUDED UNDER ITEM 625, "POWER SERVICE", THE CONTRACTOR SHALL SUPPLY AND INSTALL ALL APPURTENANCES REQUIRED BY THE POWER COMPANY, INCLUDING BUT NOT LIMITED TO A SECOND DISCONNECT SWITCH.

THE ELECTRIC COMPANY WILL SUPPLY 240/480 VOLT OR 120/240 VOLT SINGLE PHASE, 3 WIRE GROUNDED NEUTRAL POWER SERVICES AS INDICATED BY THE PLAN.

THE CONTRACTOR SHALL MAINTAIN ALL NEW OR MODIFIED STREET CIRCUITS, INCLUDING ENERGY COSTS, ONCE THEY HAVE BEEN INSTALLED OR MODIFIED, WITH THE RESPONSIBILITY TURNED OVER TO THE MAINTAINING AGENCY ONLY WHEN ACCEPTED BY THE ENGINEER.

ITEM 625 - LIGHT POLE (INSTALLATION ONLY), AS PER PLAN

THIS ITEM OF WORK SHALL CONSIST OF INSTALLING AN EXISTING LIGHT POLE REMOVED FROM A PREVIOUS LOCATION ON THE PROJECT SITE OR SUPPLIED TO THE PROJECT SITE BY OTHERS. THE LIGHT POLE WILL BE INSTALLED ON A NEW FOUNDATION AS INDICATED IN THE PLAN.

WHERE THE POLE WILL BE INSTALLED ON A NEW FOUNDATION, NEW ANCHOR BOLTS SHALL BE FURNISHED.

THE EXISTING LIGHT POLE IDENTIFICATION DECAL SHALL BE REMOVED, AND A NEW DECAL FOR THE NEW IDENTIFICATION NUMBER FURNISHED AND INSTALLED.

ITEM 625 - POWER SERVICE REMOVED, AS PER PLAN

THIS ITEM OF WORK SHALL CONSIST OF THE REMOVAL AND DISPOSAL OF AN EXISTING POWER SERVICE.

INCLUDED FOR REMOVAL WILL BE ALL POWER SERVICE COMPONENTS, INCLUDING THE WEATHER HEAD AND ALL ABOVE GRADE WIRING, CONTROL CENTER ENCLOSURE, PHOTOELECTRIC CELL AND ALL OTHER APPURTENANCES, WITH THE EXCEPTION OF THE WOOD POLE TO BE REUSED BY A FUTURE POWER SERVICE. THE CABLE ENCLOSED IN THE 2-INCH CONDUIT WHICH RUNS INTO THE GROUND SHALL BE CUT WHERE IT EXITS THE 2-INCH CONDUIT, APPROXIMATELY 2 FEET BELOW THE GROUND, AND SHALL BE REMOVED WITH THE 2-INCH CONDUIT. THE REMAINING BURIED CABLE SHALL BE ABANDONED. ALL DISTURBED AREAS SHALL BE RESTORED TO MATCH THE SURROUNDING AREA.

ALL POWER SERVICE COMPONENTS, INCLUDING THE CONTROL CENTER, PHOTOELECTRIC CELL, 2-INCH CONDUIT, WEATHER HEAD AND ALL ABOVE-GROUND WIRING SHALL BECOME THE PROPERTY OF THE CONTRACTOR AND SHALL BE PROPERLY DISPOSED OF OFF THE PROJECT SITE.

THIS ITEM WILL ALSO COMPENSATE THE CONTRACTOR FOR COORDINATING WITH THE POWER COMPANY TO INSURE THAT THE COMPANY DISCONNECTS THE SERVICE, AND THAT ITEMS WHICH BELONG TO THE POWER COMPANY AND ARE REMOVED BY THE CONTRACTOR SUCH AS THE METER BASE SHALL BE RETURNED TO THE POWER COMPANY.

c:\pwworking\pitt\d088591\776281\N001.dgn 7/30/2014 11:39:25 AM CWahlbri

RELEASED FOR CONSTRUCTION 7/29/14

LIGHTING GENERAL NOTES

HAM-71-3.81

CALCULATED
JCS
CHECKED
MDW

NO.	DATE	DESCRIPTION
0	7/29/14	RFC PLANS BU 1B
B	7/11/14	FINAL SUBMITTAL BU 1B
A	6/2/14	INTERIM SUBMITTAL BU 1B
ISSUE RECORD		

87
97



CALCULATED JCS CHECKED MDW

RELEASED FOR CONSTRUCTION 7 / 29 / 14

LIGHTING SCHEMATIC PLAN
STA. 235+00 TO STA. 297+00

HAM-71-3.81

88
97

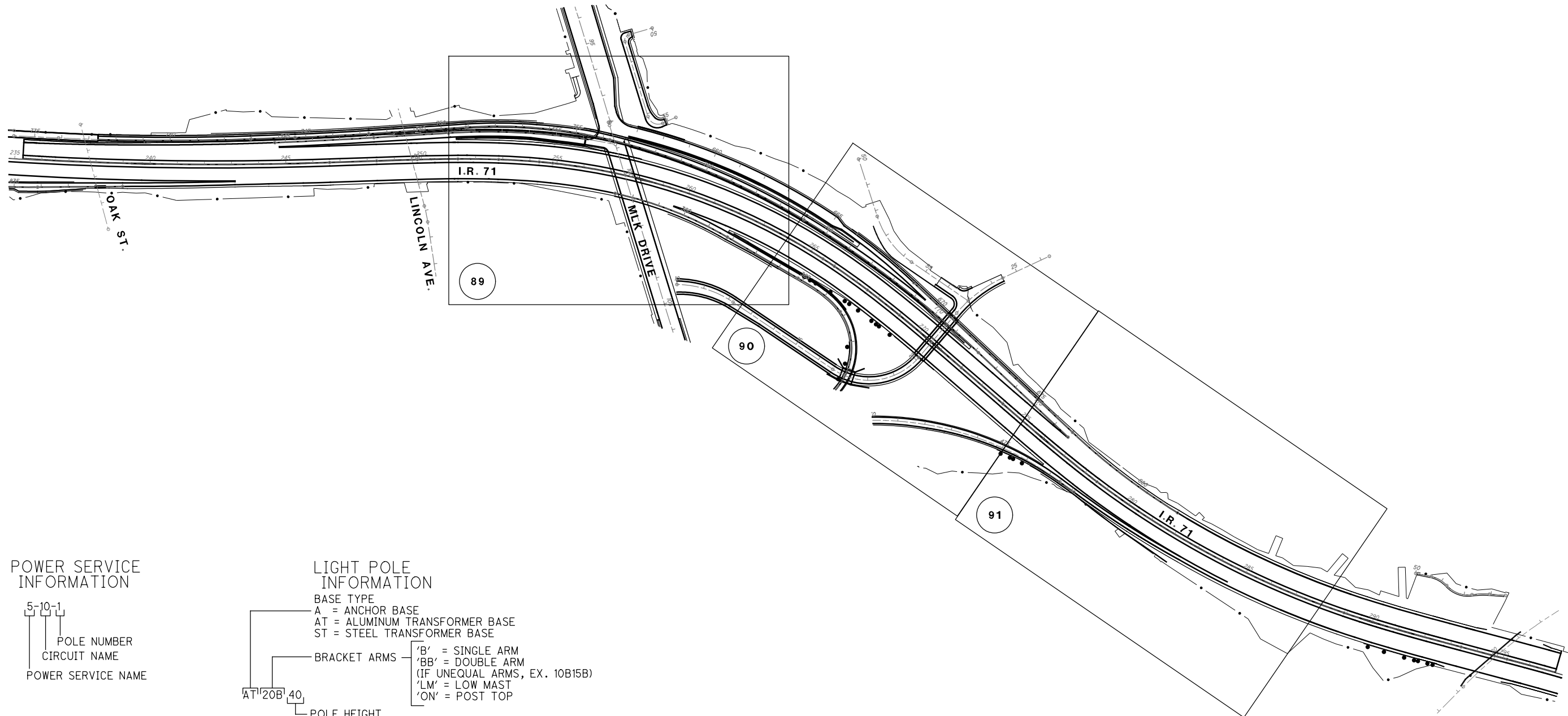

POWER SERVICE INFORMATION

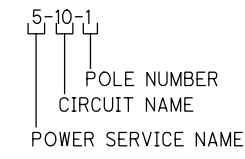

LIGHT POLE INFORMATION

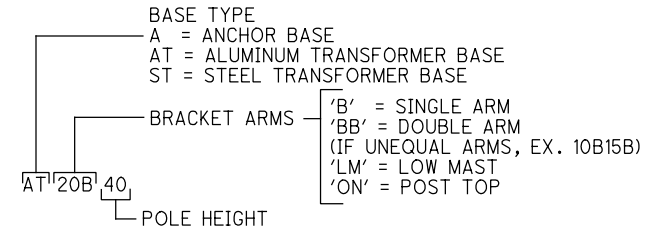

LEGEND

	NEW DOUBLE ARM CONVENTIONAL LIGHT POLE, IES TYPE III DISTRIBUTION WITH TWO 310W HPS LUMINAIRES, 480V.		NEW LIGHTING CIRCUIT, NUMBER OF CONDUCTORS (HASHES), CIRCUIT NAME AND CONDUCTOR SIZE.
	EXISTING DOUBLE ARM CONVENTIONAL LIGHT POLE, IES TYPE III DISTRIBUTION WITH TWO 310W HPS LUMINAIRES, 480V.		PROPOSED LIGHTING CONDUIT, 3", 725.04, IN 36" TRENCH (UNLESS NOTED OTHERWISE)
	NEW UNDERPASS LUMINAIRE, 480V, 150W HPS, IES TYPE III DISTRIBUTION		PROPOSED LIGHTING CONDUIT, 3", 725.04 (UNLESS NOTED OTHERWISE), JACKED OR DRILLED UNDER PAVEMENT.
	NEW POWER SERVICE, SERVICE REQUIREMENTS AS NOTED.		POLE IDENTIFICATION NUMBER (NEW CONSTRUCTION)
	EXISTING POWER SERVICE		POLE IDENTIFICATION NUMBER (EXISTING)
	NEW LIGHTING PULL BOX (PB), BARRIER JUNCTION BOX (BJB) OR MEDIAN JUNCTION BOX (MJB)		
	EXISTING LIGHTING PULL BOX (PB), BARRIER JUNCTION BOX (BJB) OR MEDIAN JUNCTION BOX (MJB)		

NO.	DATE	DESCRIPTION
0	7/29/14	RFC PLANS BU 1B
B	7/11/14	FINAL SUBMITTAL BU 1B
A	6/2/14	INTERIM SUBMITTAL BU 1
ISSUE RECORD		

c:\pwworking\pitt\d088591\776281_B001.dgn 7/30/2014 11:39:28 AM CWahlbr



CALCULATED JCS
CHECKED MDW

RELEASED FOR CONSTRUCTION 7/29/14

LIGHTING PLAN - I.R. 71
STA. 251+00 TO STA. 264+00

HAM-71-3.81

89
97

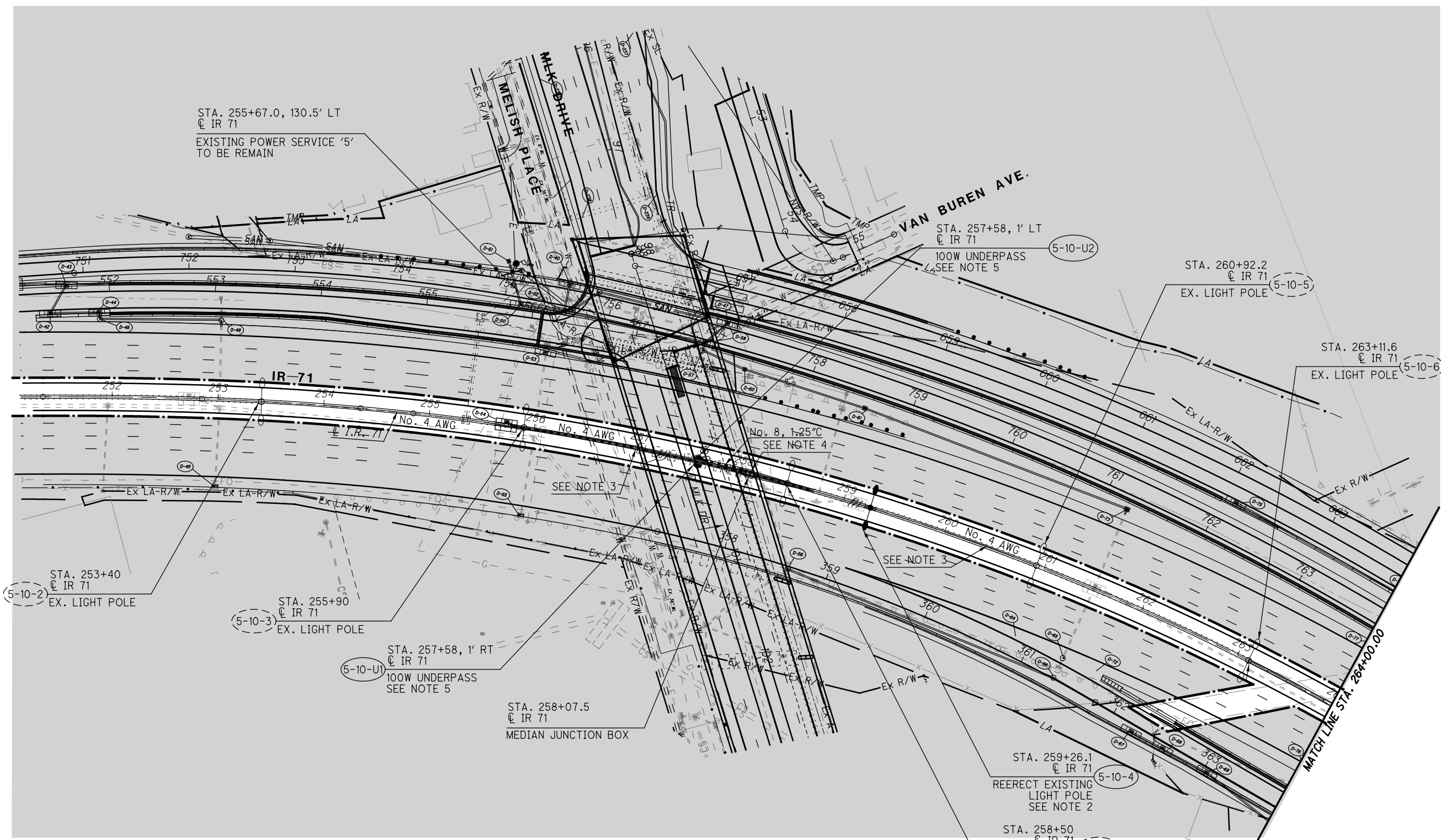

- NOTES:
1. REMOVE EXISTING LIGHT POLE AND STORE FOR RE-ERECTION. CUT ANCHOR BOLTS FLUSH WITH TOP OF MEDIAN FOUNDATION.
 2. PROVIDE NEW MEDIAN LIGHT POLE FOUNDATION AND RE-ERECT EXISTING LIGHT POLE (NOTE 1) TO BE RELOCATED.
 3. REMOVE EXISTING CIRCUIT BETWEEN EXISTING LIGHT POLE 5-10-3 AND LIGHT POLE 5-10-5. AFTER INSTALLATION OF NEW MEDIAN BARRIER AND RELOCATION OF LIGHT POLES, PULL NEW CIRCUIT CONDUCTORS TO REPLACE THOSE REMOVED AND CONNECT TO LIGHT POLES, ENSURING CIRCUIT CONTINUITY.
 4. NEW MEDIAN JUNCTION BOX. CONDUIT TO UNDERPASS LIGHTING SHALL STUB OUT OF MEDIAN BARRIER ADJACENT TO NEW BRIDGE SUPPORT COLUMN. 1-1/4" CONDUIT TO BE SURFACE MOUNTED TO COLUMN AND RUN UP TO PIER. RUN CONDUIT ALONG PIER TO NEW UNDERPASS LUMINAIRES. SEE SHEET 92 FOR ELEVATIONS.
 5. UNDERPASS LUMINAIRES TO BE SURFACE MOUNTED ON PIER, WITH BOTTOM OF LUMINAIRE 2" ABOVE BOTTOM OF PIER.

NO.	DATE	DESCRIPTION
0	7/29/14	RFC PLANS BU 1B
B	7/11/14	FINAL SUBMITTAL BU 1B
A	6/2/14	INTERIM SUBMITTAL BU 1
ISSUE RECORD		

c:\pwworking\pitt\d088591\776281_P001.dgn 7/30/2014 11:39:43 AM C:\wambri

c:\pwworking\pitt\d088591\776281_P002.dgn 2/11/2016 12:56:29 PM MLORENZ

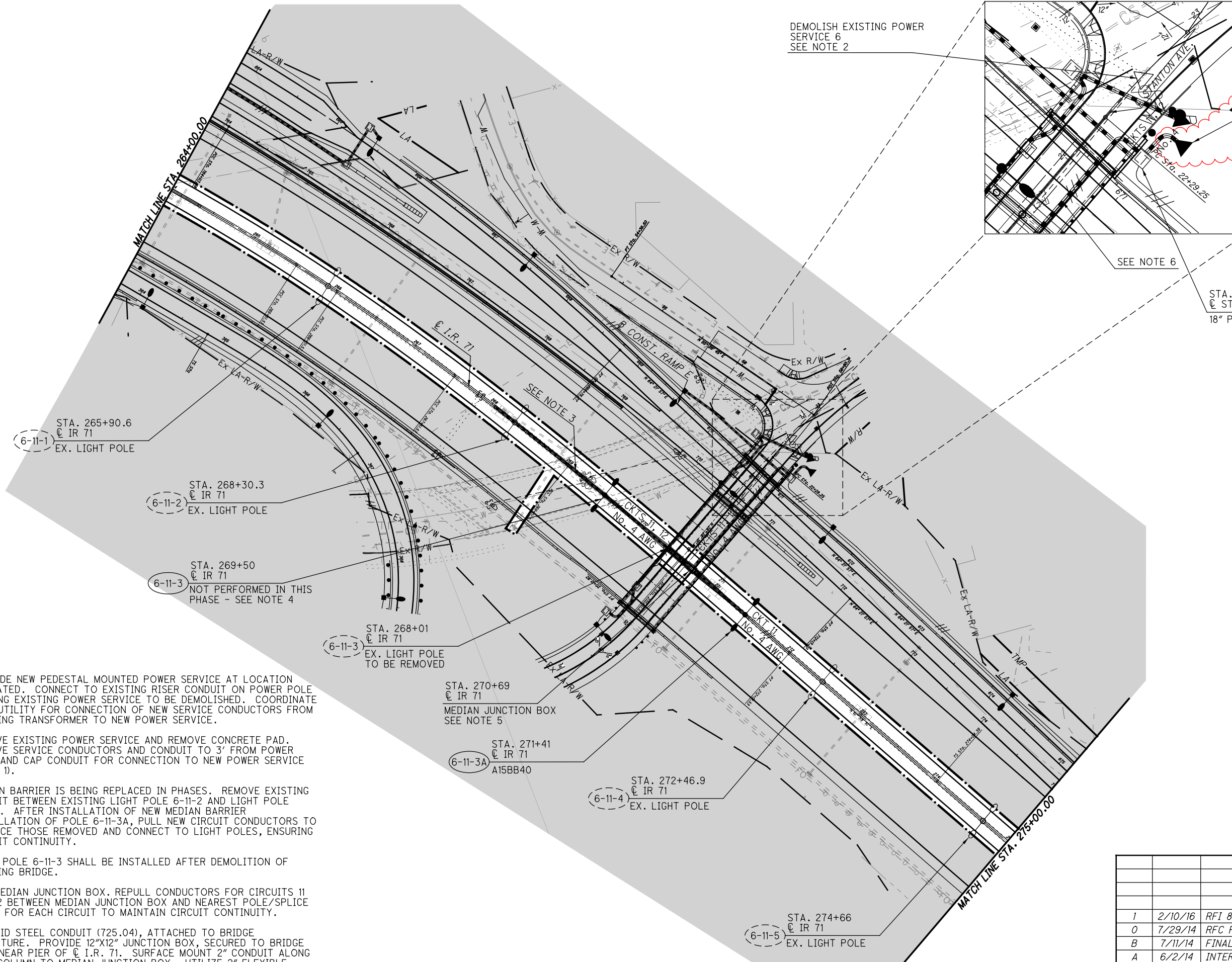

DEMOLISH EXISTING POWER SERVICE 6 SEE NOTE 2

STA. 22+45.0, 40.0' RT
 CL STANTON AVE.
 NEW POWER SERVICE '6'
 240/480V, 1PH, 3W
 SEE NOTE 1

SEE NOTE 6

STA. 22+25, 28.4' RT
 CL STANTON AVE.
 18" PULL BOX

6-11-1
 STA. 265+90.6
 CL IR 71
 EX. LIGHT POLE

6-11-2
 STA. 268+30.3
 CL IR 71
 EX. LIGHT POLE

6-11-3
 STA. 269+50
 CL IR 71
 NOT PERFORMED IN THIS PHASE - SEE NOTE 4

6-11-3
 STA. 268+01
 CL IR 71
 EX. LIGHT POLE TO BE REMOVED

6-11-3B
 STA. 270+69
 CL IR 71
 MEDIAN JUNCTION BOX
 SEE NOTE 5

6-11-3A
 STA. 271+41
 CL IR 71
 A15BB40

6-11-4
 STA. 272+46.9
 CL IR 71
 EX. LIGHT POLE

6-11-5
 STA. 274+66
 CL IR 71
 EX. LIGHT POLE

- NOTES:
1. PROVIDE NEW PEDESTAL MOUNTED POWER SERVICE AT LOCATION INDICATED. CONNECT TO EXISTING RISER CONDUIT ON POWER POLE FEEDING EXISTING POWER SERVICE TO BE DEMOLISHED. COORDINATE WITH UTILITY FOR CONNECTION OF NEW SERVICE CONDUCTORS FROM EXISTING TRANSFORMER TO NEW POWER SERVICE.
 2. REMOVE EXISTING POWER SERVICE AND REMOVE CONCRETE PAD. REMOVE SERVICE CONDUCTORS AND CONDUIT TO 3' FROM POWER POLE AND CAP CONDUIT FOR CONNECTION TO NEW POWER SERVICE (NOTE 1).
 3. MEDIAN BARRIER IS BEING REPLACED IN PHASES. REMOVE EXISTING CIRCUIT BETWEEN EXISTING LIGHT POLE 6-11-2 AND LIGHT POLE 6-11-4. AFTER INSTALLATION OF NEW MEDIAN BARRIER INSTALLATION OF POLE 6-11-3A, PULL NEW CIRCUIT CONDUCTORS TO REPLACE THOSE REMOVED AND CONNECT TO LIGHT POLES, ENSURING CIRCUIT CONTINUITY.
 4. LIGHT POLE 6-11-3 SHALL BE INSTALLED AFTER DEMOLITION OF EXISTING BRIDGE.
 5. NEW MEDIAN JUNCTION BOX. REPULL CONDUCTORS FOR CIRCUITS 11 AND 12 BETWEEN MEDIAN JUNCTION BOX AND NEAREST POLE/SPLICE POINT FOR EACH CIRCUIT TO MAINTAIN CIRCUIT CONTINUITY.
 6. 2" RIGID STEEL CONDUIT (725.04), ATTACHED TO BRIDGE STRUCTURE. PROVIDE 12"x12" JUNCTION BOX, SECURED TO BRIDGE DECK NEAR PIER OF CL I.R. 71. SURFACE MOUNT 2" CONDUIT ALONG PIER COLUMN TO MEDIAN JUNCTION BOX. UTILIZE 2" FLEXIBLE LIQUIDTIGHT CONDUIT FROM JUNCTION BOX TO PIER CONDUIT.



CALCULATED JCS
 CHECKED MDW

AMENDED RELEASE FOR CONSTRUCTION 2/10/16
 LIGHTING PLAN - I.R. 71
 STA. 264+00 TO STA. 275+00
 HAM-71-3.81

NO.	DATE	DESCRIPTION
1	2/10/16	RFI 87
0	7/29/14	RFC PLANS BU 1B
B	7/11/14	FINAL SUBMITTAL BU 1B
A	6/2/14	INTERIM SUBMITTAL BU 1
ISSUE RECORD		

90
 97

NO.	DATE	DESCRIPTION
1	2/15/15	NDC 5
0	7/29/14	RFC PLANS BU 1B
B	7/11/14	FINAL SUBMITTAL BU 1B
A	6/2/14	INTERIM SUBMITTAL BU 1
ISSUE RECORD		

CALCULATED JCS
 CHECKED MDW
 HORIZONTAL SCALE IN FEET
 0 25 50 100

AMENDED RELEASE FOR CONSTRUCTION 2/15/15
LIGHTING PLAN - I.R. 71
STA. 275+00 TO STA. 288+00

HAM-71-3.81
 91
 97

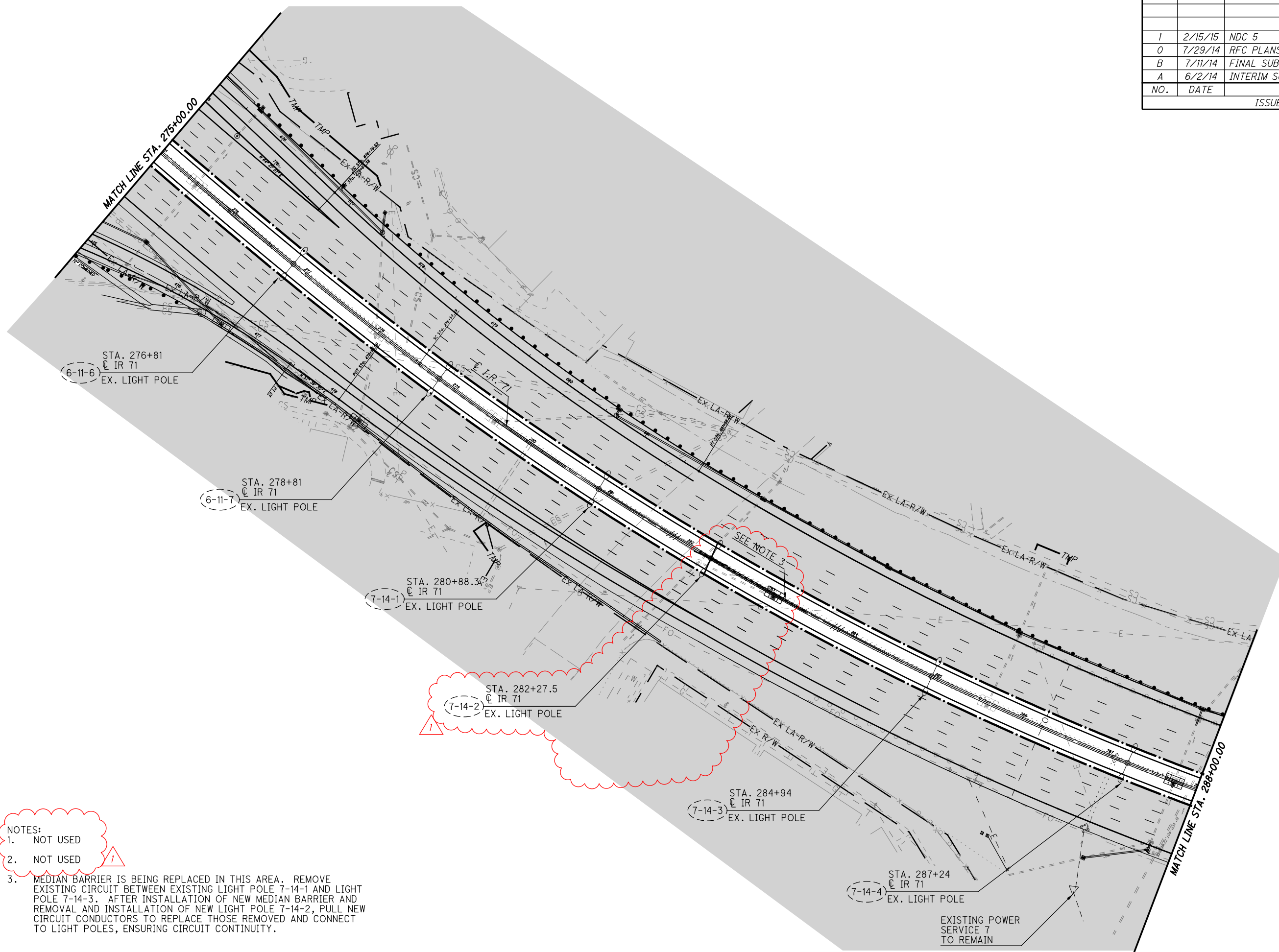

NOTES:
 1. NOT USED
 2. NOT USED
 3. MEDIAN BARRIER IS BEING REPLACED IN THIS AREA. REMOVE EXISTING CIRCUIT BETWEEN EXISTING LIGHT POLE 7-14-1 AND LIGHT POLE 7-14-3. AFTER INSTALLATION OF NEW MEDIAN BARRIER AND REMOVAL AND INSTALLATION OF NEW LIGHT POLE 7-14-2, PULL NEW CIRCUIT CONDUCTORS TO REPLACE THOSE REMOVED AND CONNECT TO LIGHT POLES, ENSURING CIRCUIT CONTINUITY.

c:\pwworking\pitt\d088591\776281_P003.dgn 4/17/2015 11:07:51 AM CWahibri

c:\pwworking\pitt\088591\77628LE001.dgn 7/30/2014 11:40:26 AM CWahlbr

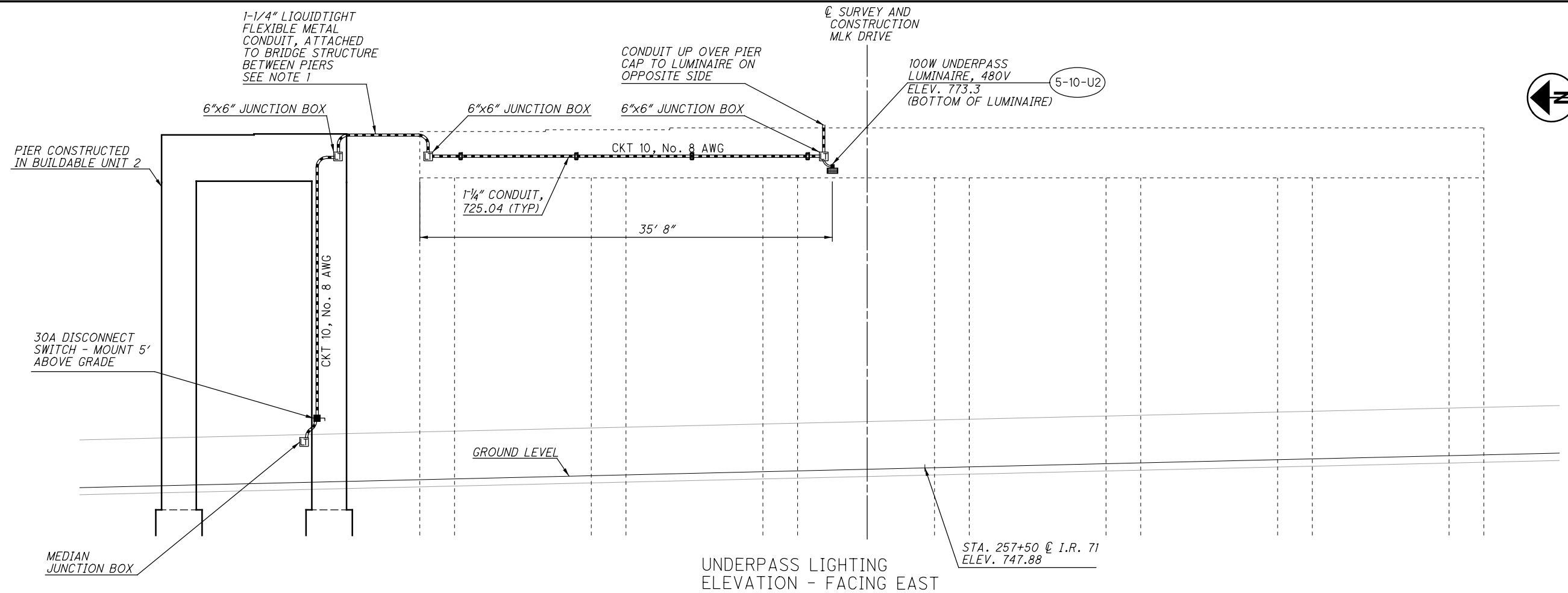

UNDERPASS LIGHTING ELEVATION - FACING EAST

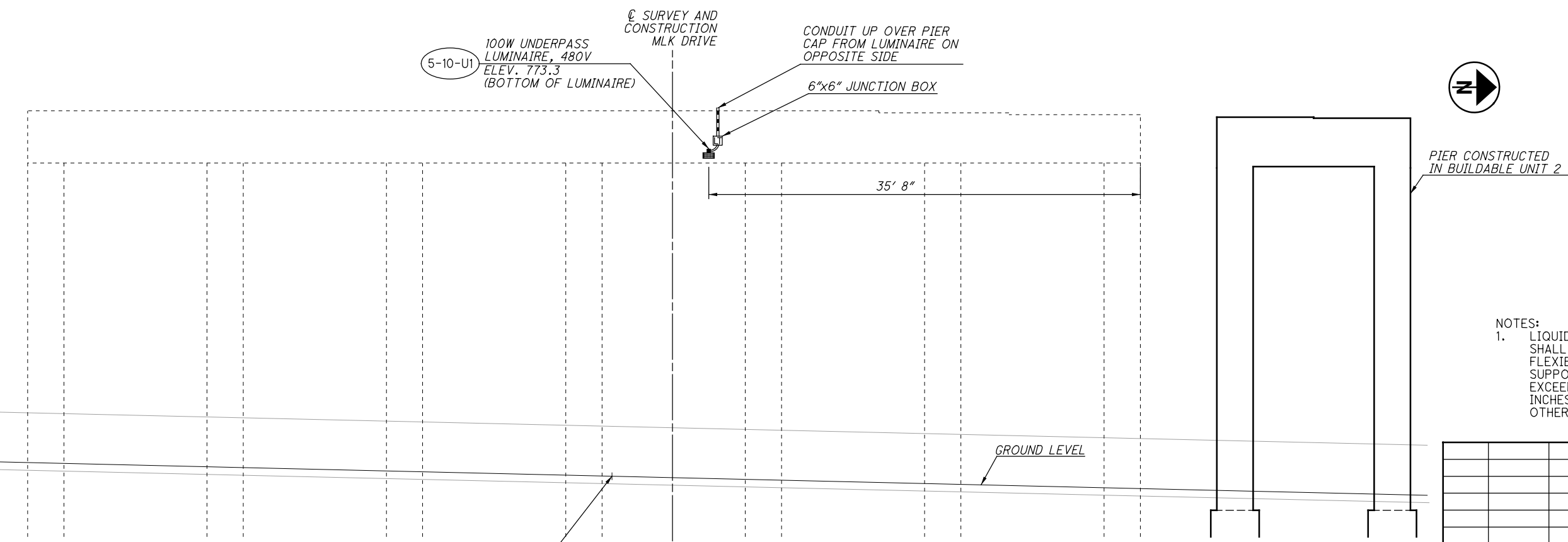

UNDERPASS LIGHTING ELEVATION - FACING WEST

NOTES:
 1. LIQUIDTIGHT FLEXIBLE CONDUIT SHALL BE SUNLIGHT RESISTANT. FLEXIBLE CONDUIT MUST BE SUPPORTED AT INTERVALS NOT EXCEEDING 3 FEET AND WITHIN 12 INCHES OF EACH JUNCTION BOX OR OTHER CONDUIT FITTING.

NO.	DATE	DESCRIPTION
0	7/29/14	RFC PLANS BU 1B
A	7/11/14	FINAL SUBMITTAL BU 1B
ISSUE RECORD		

RELEASED FOR CONSTRUCTION 7 / 29 / 14

HAM-71-3.81

LIGHTING ELEVATIONS
 I.R. 71 UNDER MARTIN LUTHER KING DR.

CALCULATED JCS
 CHECKED MDW
 HORIZONTAL SCALE IN FEET

92
97

c:\pwworking\pitt\0885911\776281\C001.dgn 7/30/2014 11:40:32 AM CWahbri

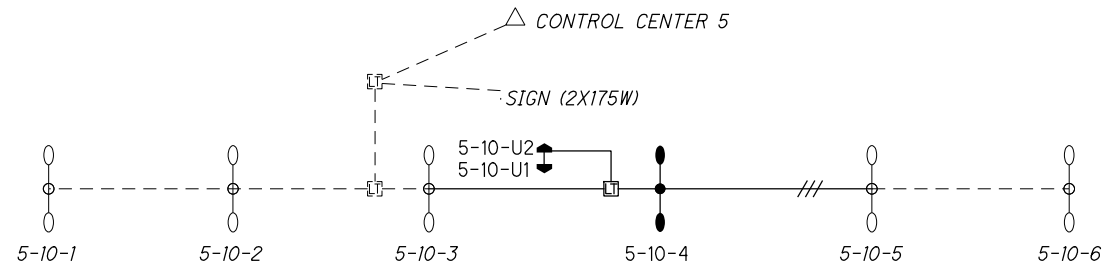

POWER SERVICE DATA									
POWER SERVICE/CONTROL CENTER	LINE VOLTAGE, PHASE	CONNECTED LOAD (KVA)	ENCLOSURE RATING (AMPS)	ENTRANCE CONDUCTOR SIZE (AWG)	CIRCUIT NAME	CIRCUIT LOAD (AMPS)	CIRCUIT FUSE SIZE (AMPS)	CIRCUIT CABLE SIZE (AWG)	MAINTAINING AGENCY
EXISTING '5'	240/480V 1 PHASE 3 WIRE	5.33 KVA	60A	#4 AWG	10	11.1 A	20A	#4 AWG	ODOT
EXISTING '6'	240/480V 1 PHASE 3 WIRE	7.15 KVA	60A	#4 AWG	11	12.9 A	20A	#4 AWG	ODOT
					12	2.0 A	20A	#4 AWG	ODOT
EXISTING '7'	240/480V 1 PHASE 3 WIRE	9.74 KVA	60A	#2 AWG	14	20.3 A	30 A*	#2 AWG	ODOT

*VERIFY FUSE SIZE AND REPLACE AS REQUIRED

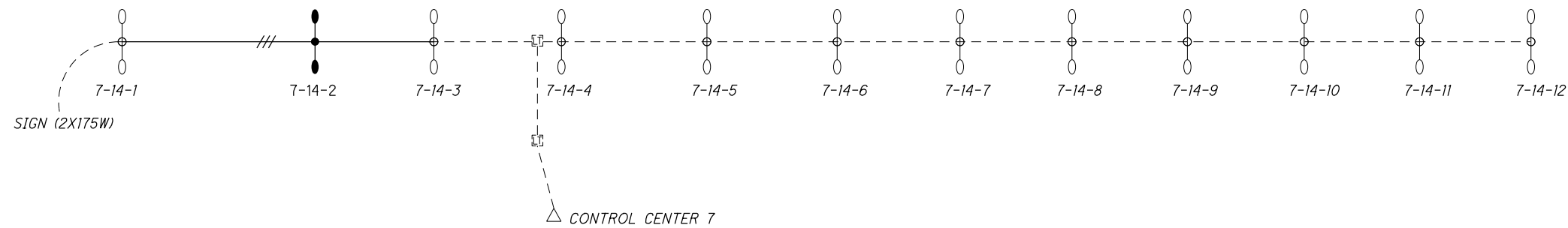
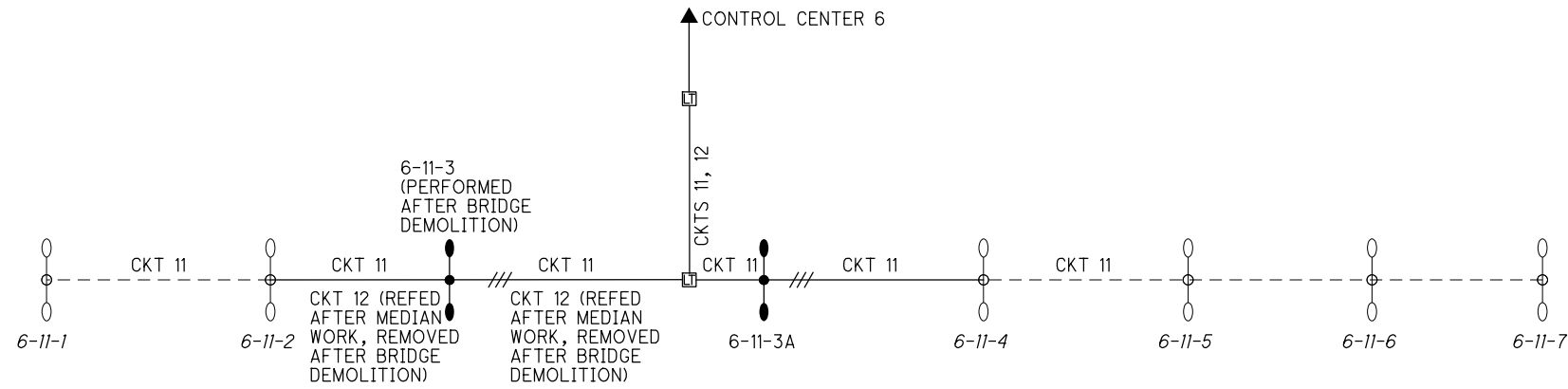

0
CALCULATED
JCS
CHECKED
MDW
HORIZONTAL SCALE IN FEET

RELEASED FOR CONSTRUCTION 7/29/14

LIGHTING CIRCUIT MAP
INTERSTATE 71

HAM-71-3.81

NO.	DATE	DESCRIPTION
0	7/29/14	RFC PLANS BU 1B
A	7/11/14	FINAL SUBMITTAL BU 1B
ISSUE RECORD		

93
97