

SR 528
SLM 17.82

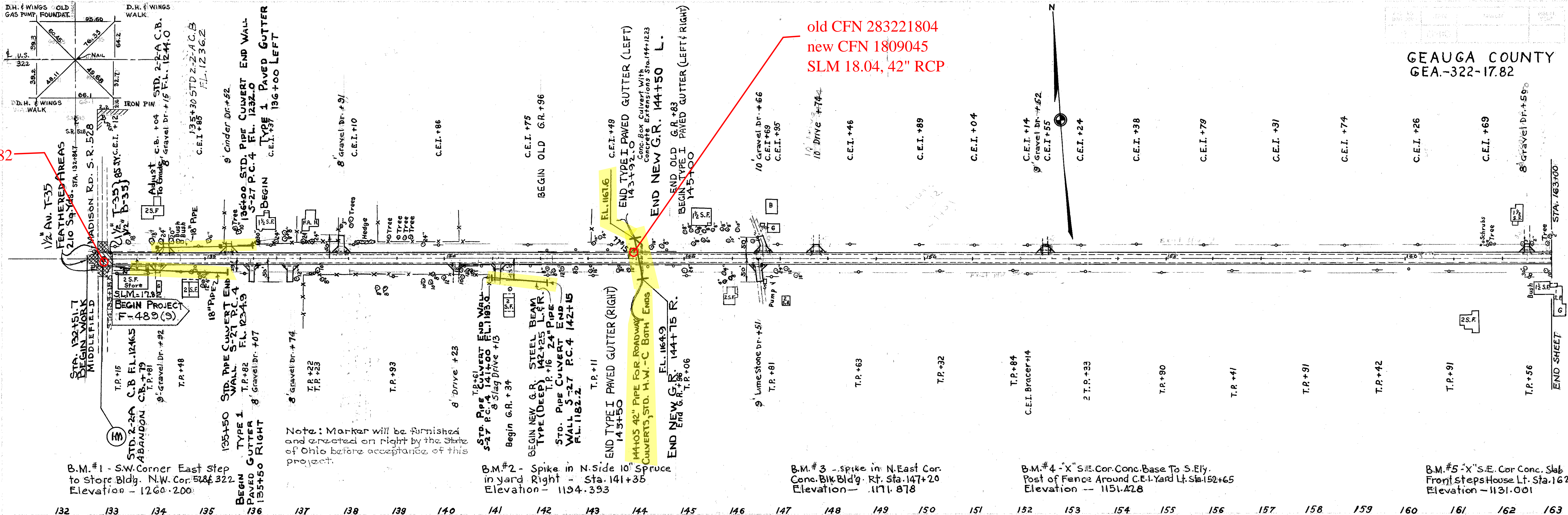

Note: Marker will be furnished and erected on right by the State of Ohio before acceptance of this project.

B.M.#1 - SW Corner East Step to Store Bldg. N.W. Cor. Sta. 528 & 322 Elevation - 1260.200
 B.M.#2 - Spike in N. Side of Spruce in yard Right Sta. 141+35 Elevation - 1194.393
 B.M.#3 - spike in N. East Cor. Conc. Bldg. Bldg. Rt. Sta. 147+20 Elevation - 1171.878
 B.M.#4 - "X" S.E. Cor. Conc. Base To S. Fly. Post of Fence Around C.E.I. Yard Lt. Sta. 152+65 Elevation - 1151.428
 B.M.#5 - "X" S.E. Cor. Conc. Slab Front Steps House Lt. Sta. 162+27 Elevation - 1131.001

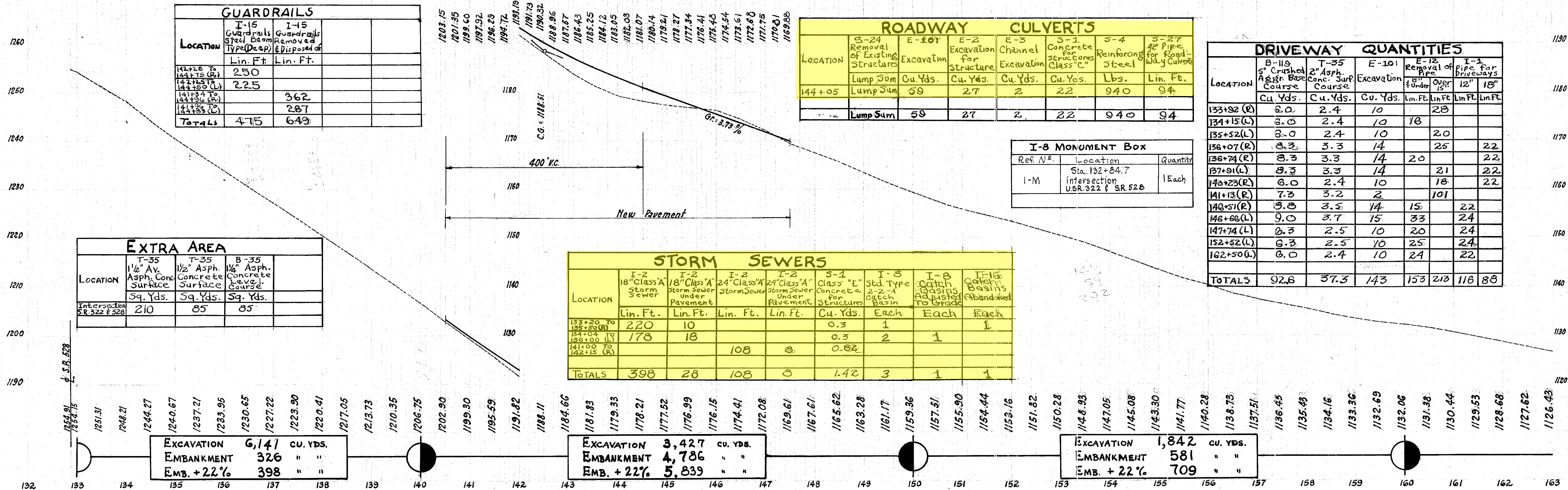

GUARDRAILS	
Location	Lin. Ft.
142+15 to 142+25 (R)	250
142+25 to 142+50 (L)	225
141+32 to 141+50 (R)	362
141+50 to 141+55 (L)	287
Totals	475

ROADWAY CULVERTS						
LOCATION	S-24 Removal of Existing Structures Lump Sum	E-101 Excavation Cu. Yds.	E-2 Excavation for Structure Cu. Yds.	E-3 Channel Excavation Cu. Yds.	S-1 Concrete Structures Class "C" Cu. Yds.	S-4 Reinforcing for Roadway Culverts Lbs.
144+05	Lump Sum	59	27	2	22	940
						94
	Lump Sum	59	27	2	22	940

DRIVEWAY QUANTITIES						
LOCATION	B-110 5" Crushed Aggr. Base Course Cu. Yds.	T-35 2" Asp. Conc. Surf. Course Cu. Yds.	E-101 Excavation Cu. Yds.	E-12 Removal of Pipe 15" Over 12" Lin. Ft.	I-1 Pipe for Driveways 12" Lin. Ft.	I-1 Pipe for Driveways 18" Lin. Ft.
133+02 (R)	8.0	2.4	10		28	
134+15 (L)	8.0	2.4	10	18		
135+52 (L)	8.0	2.4	10		20	
138+07 (R)	8.3	3.3	14		25	22
138+74 (R)	8.3	3.3	14	20		22
137+91 (L)	8.3	3.3	14		21	22
140+23 (R)	8.0	2.4	10	18		22
141+13 (R)	7.3	3.2	2		101	
148+51 (R)	9.0	3.5	14	15		22
148+68 (L)	9.0	3.7	15	33		24
147+74 (L)	8.3	2.5	10	20		24
152+82 (L)	8.3	2.5	10	25		24
162+50 (L)	8.0	2.4	10	24		22
TOTALS	92.6	37.3	143	153	218	116

I-8 MONUMENT BOX		
Ref. N ^o .	Location	Quantity
I-M	Sta. 132+84.7 intersection USR 322 & SR 528	1 Each

STORM SEWERS								
LOCATION	I-2 18" Class "A" Storm Sewer Lin. Ft.	I-2 18" Class "A" Storm Sewer Under Pavement Lin. Ft.	I-2 24" Class "A" Storm Sewer Lin. Ft.	I-2 24" Class "A" Storm Sewer Under Pavement Lin. Ft.	S-1 Class "E" Concrete for Structures Cu. Yds.	I-8 Std. Type 2-2-1 Catch Basin Each	I-8 Catch Basins Adjusted to Grade Each	I-115 Catch Basins Abandoned Each
133+20 to 135+00 (R)	220	10			0.3	1		1
134+04 to 136+00 (L)	178	18			0.3	2	1	
141+00 to 142+15 (R)			108	8	0.82			
TOTALS	398	28	108	8	1.42	3	1	1

EXTRA AREA			
LOCATION	T-35 1/2" Av. Asp. Conc. Surface Sq. Yds.	T-35 1/2" Asp. Concrete Surface Sq. Yds.	B-35 1/2" Asp. Concrete Curb Sq. Yds.
Intersection SR 322 & 528	210	85	85

EXCAVATION 6,141 CU. YDS.
 EMBANKMENT 326 " "
 EMB. + 22% 398 " "

EXCAVATION 3,427 CU. YDS.
 EMBANKMENT 4,786 " "
 EMB. + 22% 5,839 " "

EXCAVATION 1,842 CU. YDS.
 EMBANKMENT 581 " "
 EMB. + 22% 709 " "